



MAKE A DIFFERENCE

Front Bumper

BXG.4227-S
(INSTALLATION INSTRUCTION)

ATTENTION • Please verify all parts are present and read instructions carefully before starting installation.
Please feel free to contact your distributor if you have any kind of question about your purchase.

CONTENTS

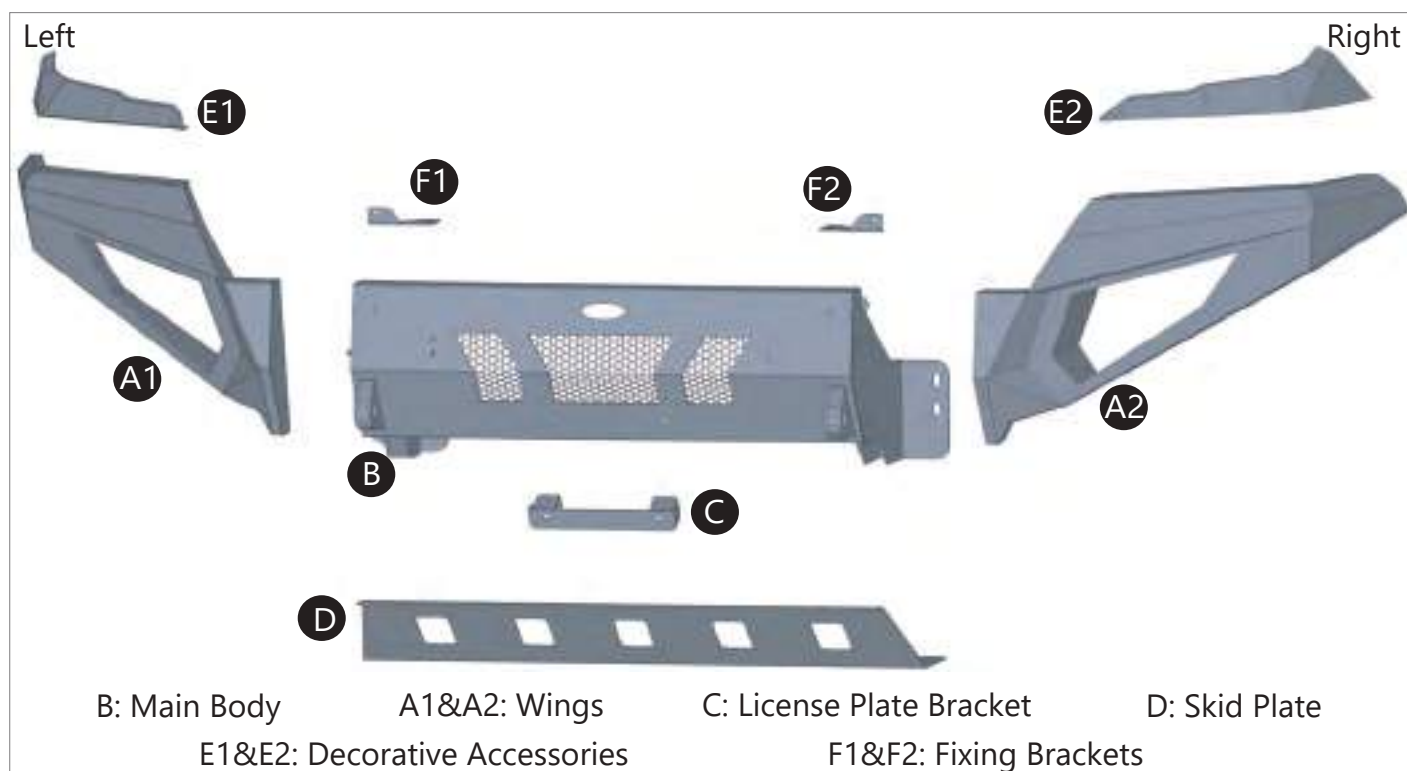

B: Main Body

A1&A2: Wings

C: License Plate Bracket

D: Skid Plate

E1&E2: Decorative Accessories

F1&F2: Fixing Brackets

Qty	Part Name	Size(mm)	Picture	Qty	Part Name	Size(mm)	Picture
8	Hex Bolt	M10*25		6	Flat Washer	M8*20*1.5	
6	Button Bolt	M8*20		4	Flat Washer	M6*16*1.5	
2	Button Bolt	M6*16		2	Flat Washer	M6*16*1	
4	Button Bolt	M6*12		2	Hex Nut	M10	
2	Phillips Screw	M4*14		2	Flange Hex Lock Nut	M8	
8	Split Lock Washer	D10		2	Flange Hex Lock Nut	M6	
10	Flat Washer	M10*25*2		1	Rubber Strip	3M	
2	EVA						

2 TOOLS REQUIRED

◆ Drive Ratchet Handle

◆ 14mm, 17mm Wrench

◆ 4mm, 5mm Hex Bit Socket

◆ Phillips Screwdriver

To view online instruction, please scan the QR code.



3 INSTALLATION INSTRUCTION

Step 1

Place the vehicle in park and remove the factory bumper from the frame. Keep the factory screws and nuts.

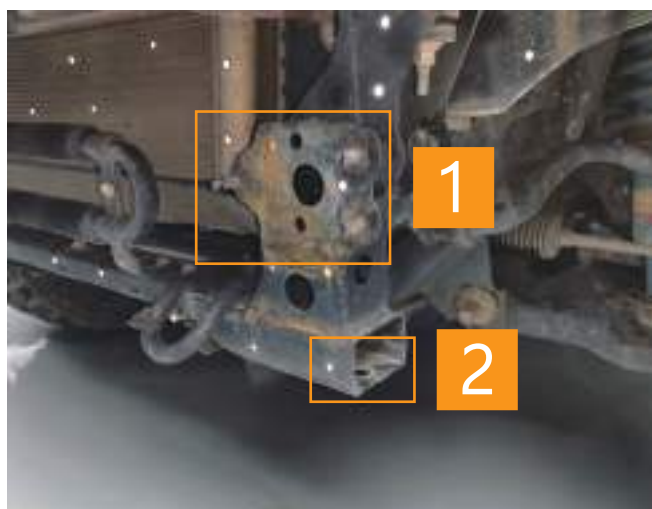

Step 1



Step 2

Use the provided fixing bracket to connect the grille to the vehicle. Use the factory bolts and screws **or the provided phillips screws**. Repeat this step for the opposite of the vehicle. Tighten up all bolts and screws.



Step 3

Stick the EVA to the bumper and install the left wing to the main body using (3) M10x25mm hex bolts, (3) D10 lock washers, (3) M10x25x2mm flat washers. Repeat this step for the opposite of the bumper. Tighten up all bolts.

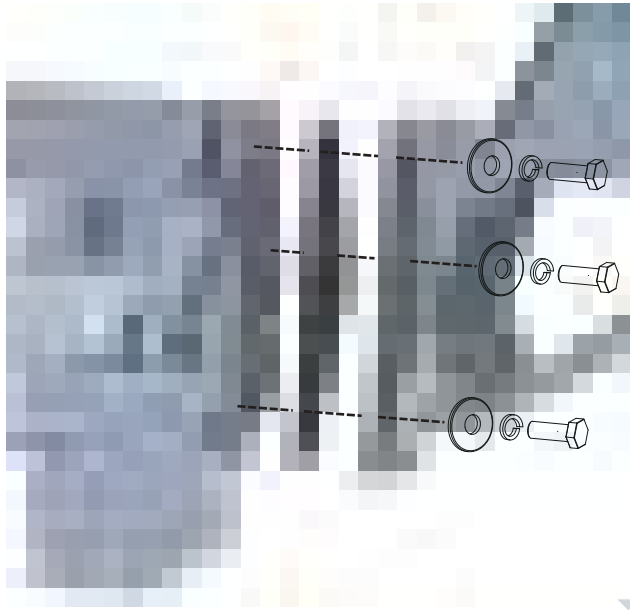

Step 4

Install the decorative accessory to the left wing using (2) M6x12mm button bolts, (2) M6x16x1.5mm flat washers. Repeat this step for the opposite of the bumper. Tighten up all bolts.

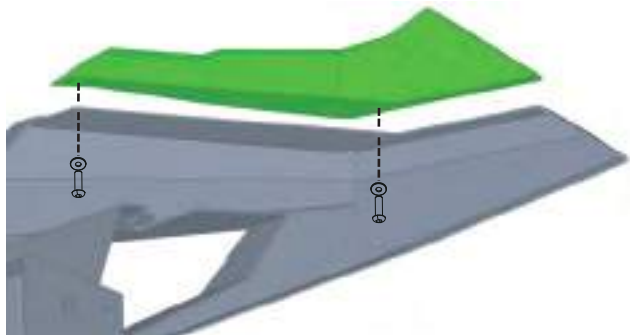

Step 5

Install the license plate bracket to the bumper using the (2) M8x20mm button bolts, (2) M8x20x1.5mm flat washers, (2) M8 flange lock nuts. Tighten up all bolts.

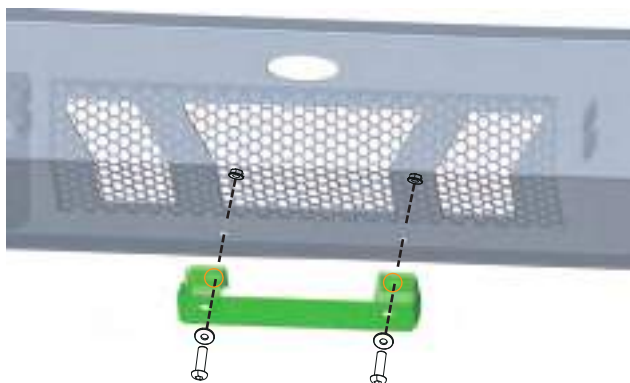

Step 6

Install the bumper to the vehicle using the factory nuts. Repeat this step for the opposite of the bumper. Adjust the bumper to the desired location. Tighten up all bolts.



Step 7

Install the skid plate to the bumper using the (4) M8x20mm button bolts, (4) M8x20x1.5mm flat washers. Do not tighten the hardware at this time.

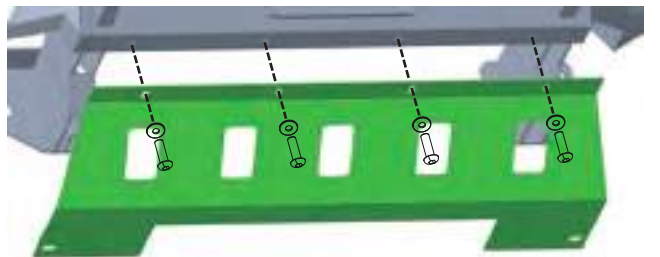

Connect the skid plate and the frame of vehicle using the (1) M10x25mm hex bolts, (1) D10 lock washers, (2) M10x25x2mm flat washers, (1) M10 hex nuts. Repeat this step for the opposite of the bumper. **At last, tighten up all bolts.**

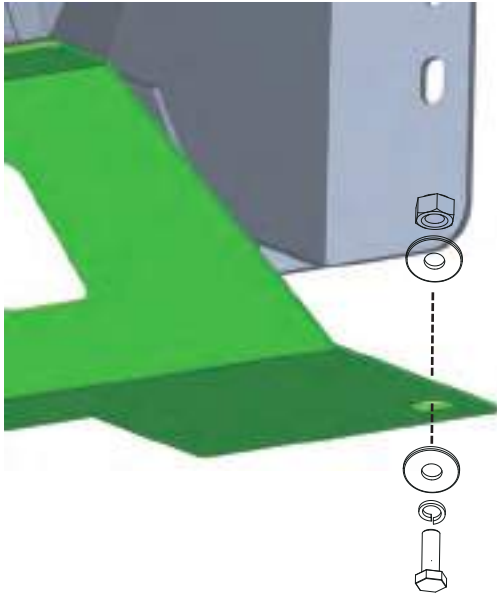

The installation is complete. We hope you enjoy a wonderful off-road life with this quality Hooke Road product!

