

尺寸：105x148.5mm 材质：100g书纸 工艺：单黑双面印刷 折页方式：骑马钉

SEENDA

Wired ergonomic
illuminated keyboard

User Manual

Model: KUW01

All Seenda products come with a 12-months warranty policy, please do not hesitate to contact us if you have any questions. Our support team will try our best to provide you with a pleasant shopping experience.

Our email: support@seenda.com
Our website: www.seenda.com

Product Features

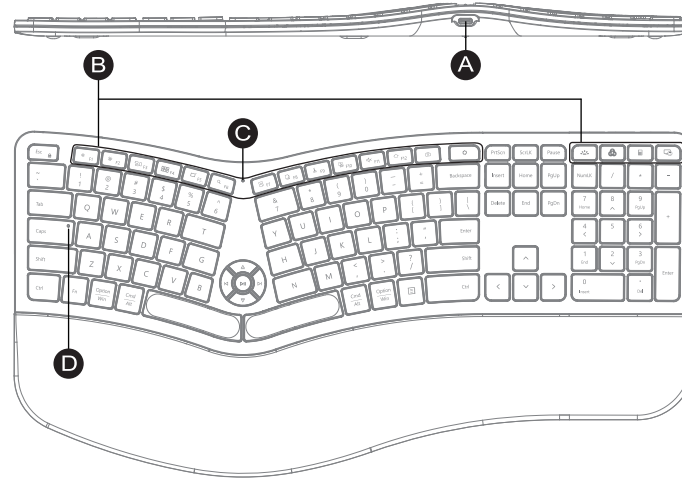

A Type-C data transmission interface

B Multimedia Shortcut Keys

C FN Lock Green Indicator Light

1. When the FN lock indicator light is on, press the multimedia function keys directly to activate their multimedia functions.
2. When the FN lock indicator light is off, pressing the keys will perform the standard F-key functions.

D Caps Lock Green Indicator Light

Wired Connection Usage

Connect one end of the USB A or USB C data cable to the computer, and plug the other end of the USB C connector into the keyboard. The keyboard backlight will light up and you can use the keyboard.

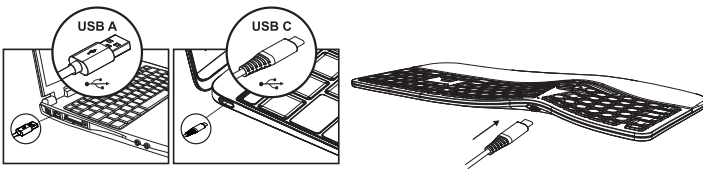

Keyboard Backlight Settings

Keyboard backlight color setting

The keyboard defaults to white backlight after powering on. To change the backlight color, simply click the " " key. The backlight color will cycle in the following order: white → red → yellow → green → cyan → blue → purple → white.

Keyboard Backlight Brightness Setting

When the computer is turned on, the keyboard defaults to the second level of backlight brightness. After pressing the " " key, the backlight brightness will be adjusted in the following order: Level 2 → Level 3 → Level 1 → Off.

Multimedia Function Keys

Key	Mac OS	Windows
Esc	FN lock	FN lock
* F1	Brightness -	Brightness -
* F2	Brightness +	Brightness +
☰ F3	Task Center	Switch Task Windows
☰ F4	Switch Task Windows	Task View
☑ F5	Return to Desktop	Return to Desktop
🔍 F6	Search	Search
📄 F7	Select All	Select All
📄 F8	Copy	Copy
✂ F9	Cut	Cut
📄 F10	Paste	Paste
🔇 F11	Mute	Mute
☰ F12	Task Center	Web Page
📷	Screenshot	Screenshot
⚙	No Function	Settings
📊	No Function	Calculator
🔒	Lock Screen	Lock Screen
☰	No Function	Menu

Note: By using the FN lock key, you can switch between the standard functions and multimedia functions of the F1 to F12 keys.

Product Parameters

Working Current (Backlight off)	≤5mA
Working Current (Backlight on maximum)	≤170mA
Sleep Current	20uA
Wake Up Way	Press any key
Dimension	480x244x26mm
System Requirements	Windows XP, Windows 7~11 systems; Mac Book system

Tips

1. When you restart the computer, the backlight setting will not be remembered, but when you wake up from sleep mode, the backlight setting will be retained.
2. In order to save power and protect the environment, if there is no key operation within 10 minutes, the keyboard will automatically enter sleep mode and turn off the backlight. To turn the backlight back on, just press any key.

Sleep Mode

1. The keyboard will automatically enter the sleep mode after 10 minutes of inactivity and the indicator light will be off.
2. Please press any key to wake up the keyboard. The indicator will light up again and starts to work within 1 second.

Packaging Content

- Keyboard *1
- USB & USB-C Combo to Type-C Data Cable *1
- User Manual *1

Safety Warning

IMPORTANT: To reduce risk of fire, electric shock, or injury, follow these safety instructions.

- ⚠ Heat Exposure: Avoid leaving the item in high-temperature environments or in direct sunlight, which could result in a fire hazard.
- ⚠ Liquid Exposure: Keep the item away from water and liquids. Do not use if wet until thoroughly dried.
- ⚠ Damage and Leakage: Cease usage and consult customer service if the item is damaged or the battery leaks.
- ⚠ Correct Disposal: Follow local regulations for disposing of electronic devices and batteries. Do not dispose of with household waste.
- ⚠ Radio Frequency Interference: This device may cause interference with other electronics. Keep a safe distance from sensitive devices.
- ⚠ Child Safety: Keep the item and its components out of reach of children to avoid choking or battery ingestion hazards. Never allow children to handle the item unsupervised.

CAUTION: Non-compliance with the above warnings can lead to serious injury or property damage.

For further assistance or information, please contact our customer service.

Email: support@seenda.com