

Robot Vacuum Cleaner Instructions

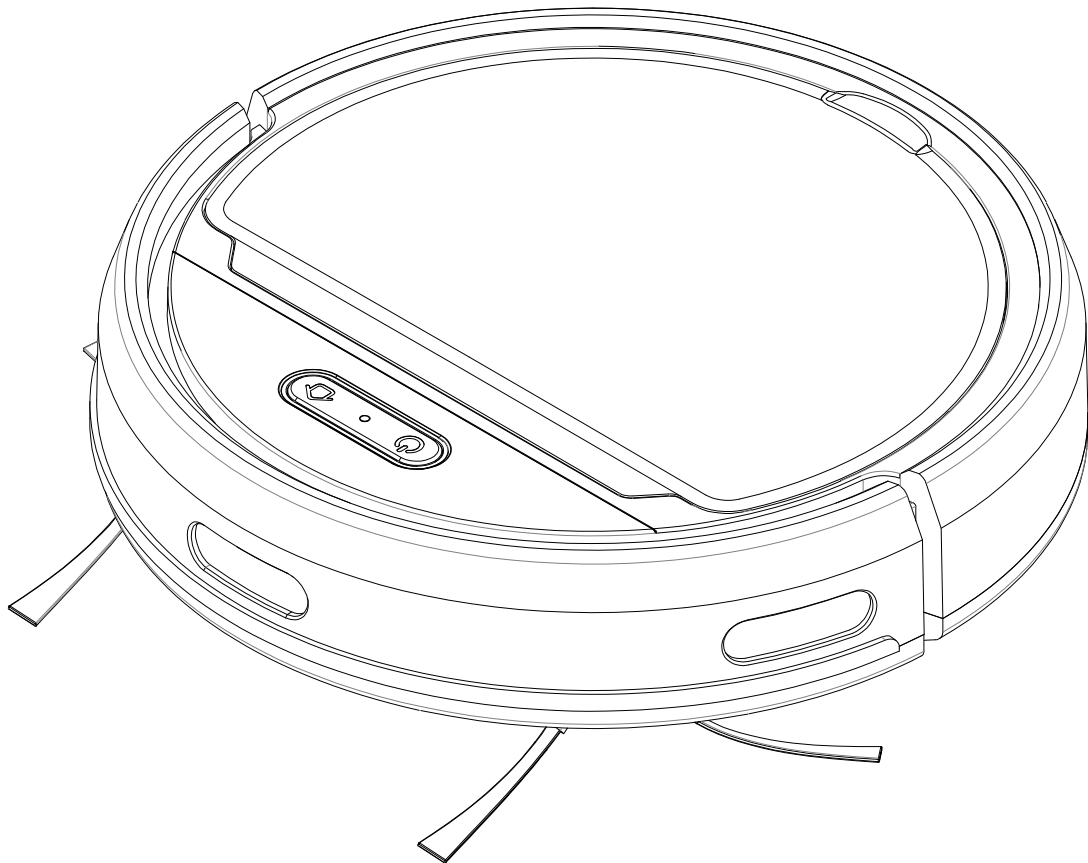

User Manual

Model No.:P1

Thanks for buying this product,before using it, please read the following instructions carefully and keep it well.

Table of Contents

1. Security Information.....	1-2
2. Product Composition.....	3
2.1 Product Parts Display.....	3
2.2 Product Parts Name.....	3
3. Product Usage.....	4
3.1 Press Buttons Description.....	4
3.2 Light Indication.....	4
3.3 Charging the Robot Vacuum Cleaner.....	5
3.4 Battery Installation and Disassembly Steps.....	5-6
3.5 Installation and Disassembly Steps of Side Brush.....	6
3.6 Mopping Holder Installation and Usage Steps.....	6-7
3.7 APP Connection Steps.....	7-9
4. Cleaning and Maintenance of Product.....	10
4.1 Dust Box and HEPA Cleaning Steps.....	10
4.2 Dust Suction Mouth Cleaning Steps.....	10-11
4.3 Side Brushes Cleaning Steps.....	11
5. Analysis of Product Faults.....	12
6. Warranty Specifications of Product.....	13

1. Safety Regulations

Before using this product, please read the following safety instructions and follow all routine safety precautions.

Please read the instructions carefully, please keep the instructions .

Any Operation inconsistent with this instruction manual may cause damage to this product.



Note

1. Only authorized technicians can disassemble this product. Users are not recommended to disassemble this product by themselves.
2. This product can only use the power adapter provided by the factory. If other adapters are used, the product may be damaged.
3. Do not touch wires, sockets or body parts to roll into the product drive wheels.
4. Do not use cloth curtains or body parts to roll into the product drive wheels.
5. Do not place this product near cigarette butts, lighters and other smoldering fires.
6. Please clean the product after charging.
7. Do not bend wires excessively or place heavy objects and sharp objects on the machine.
8. This product is an indoor household product. Do not use it outdoors.
9. Do not sit on the product.
10. Do not use this product in wet environment (e.g. bathroom).
11. Before using this product, please remove all vulnerable items (e.g. glasses, lamps, etc.) on the ground as well as items (e.g. glasses, lamps, etc.) on the ground as well as items (e.g. wires, paper sheets, curtains) that may entangle the side brushes and air suction passages.
12. Do not put this product in a place where it is easy to fall (e.g. on desks and chairs).
13. Please carefully check whether the power adapter is connected to the socket before use, otherwise the battery may be damaged.
14. To prevent tripping, please inform others of the house when this product works.
15. Please empty the dust box before using this product when the dust box is full.
16. The temperature used for this product is 0 to 40 degrees Celsius.
17. Do not use this product in high temperature environment.
18. Please remove the battery from the machine before the product is scrapped.
19. Please make sure that this product is not powered on when removing the battery.
20. Please recycle the discarded batteries safely.



Warning

1. Use only the original rechargeable battery and charging seat specially equipped by the manufacturer. Non-rechargeable batteries are structure prohibited, please refer to "product parameters" for battery specification information.
2. It is forbidden to use products in environments with open flames or fragile objects.
3. It is forbidden to use product in extremely hot (above 40°C) or extremely cold (below 0°C) .
4. It is forbidden for human hair, clothes, fingers and other parts to approach the opening and operating parts of the product.
5. It is forbidden to use product on wet or stagnant ground.
6. It is forbidden for products to absorb any articles such as stone and waste paper that may clog products.
7. It is forbidden for products to absorb any inflammable substances, such as petrol, toner and for printers or photocopies. Prohibit the use of products in clean areas with flammable items.
8. It is forbidden for products to absorb any burning articles, such as cigarettes, matches, ashes and other articles that may cause fire.
9. It is forbidden to place articles at the suction opening. Do not use the product when the suction port is blocked. Clean up dust, cotton wool, hair, etc. at the suction opening to ensure smooth air circulation at the suction opening.
10. Use the power cord carefully to avoid damage. It is forbidden to use the power cord to drag or pull the product and the product charging seat. It is forbidden to use the power cord as a handle. It is forbidden to clamp the power cord in the crack of the door. It is forbidden to pull the power cord at sharp corners and corners. It is forbidden for the product to run on the power cord while the power cord should be far away from the heat source.
11. Do not use damaged charging seat.
12. Even if the product has been severely damaged, burning of the product is prohibited, which may lead to explosion of the battery of the product.

2. Product Composition

Product Host and Parts Display

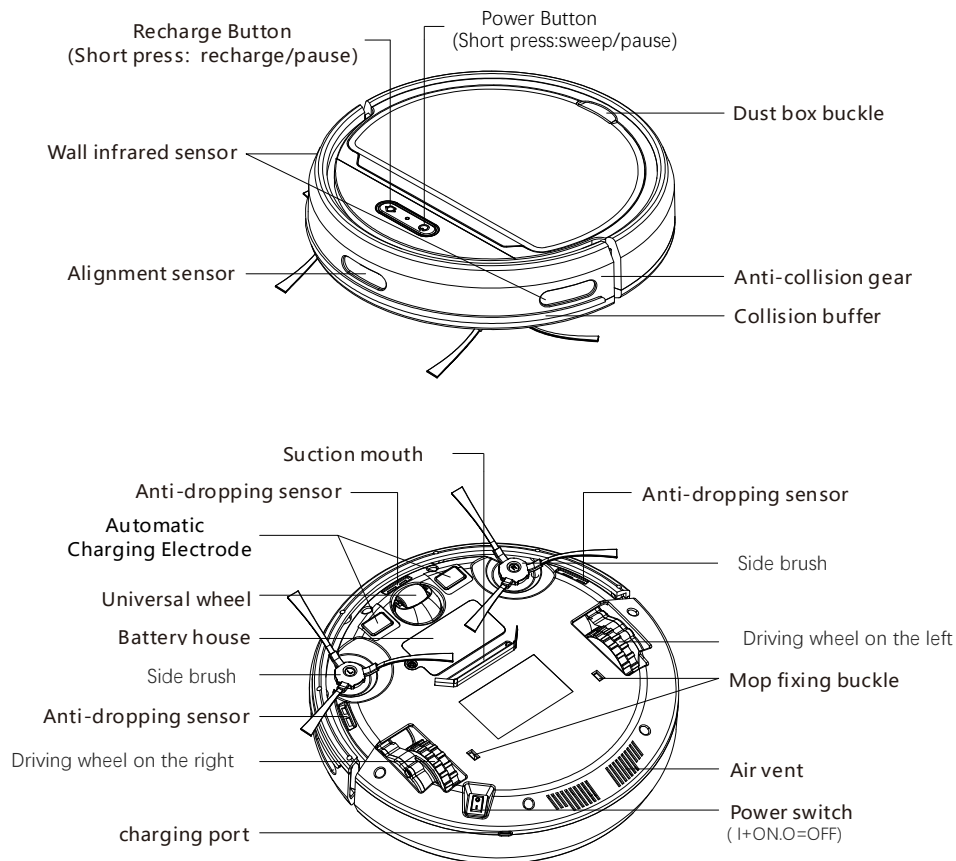

Product Host and Parts Name

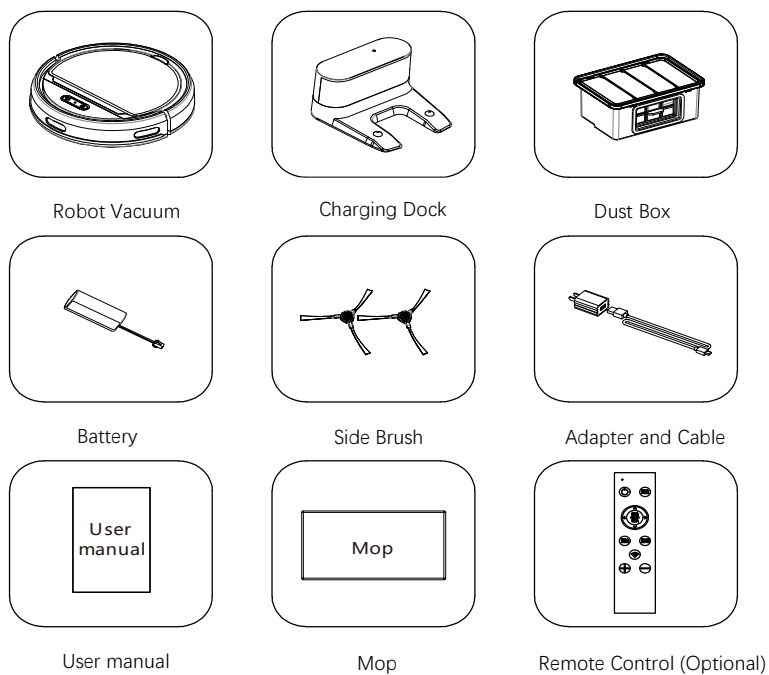



3. Product Usage

Instructions of Press Button Functions

- (1)  Power key

The power key is at the bottom of this robot, “ | ” Power on key, “ o ” Power off key。Before using this product, make sure that the power switch is on.

- (2)  Automatic cleaning key

At first, make sure that the power switch at the bottom of this product is on, and then click “” key, the zigzag cleaning mode starts automatically; During the cleaning process, click “” key, the product pauses.

- (3)  Recharging/APP Connection Key

Click “” key, Recharging mode starts.Turn on the power switch and press the recharge key for 3 seconds, the APP connection mode starts. Please refer to app operation instruction for specific distribution network mode.

Indicator Status Definition and Comparison Table

Product Status	Indicator Status
Power on	Red and green indicators flash for 3 seconds
Standby	Red and green indicators are on continuously,then the sleeping mode starts after 5 minutes
Automatic Cleaning Mode	The green indicator flashes and the red indicator goes out
Spot cleaning mode	The red and green indicator flash alternately
Recharging Status	Double flashing both red and green indicators
Charging Status	The red indicator flashes, the green indicator goes out
Full charging Status	The red indicator is off and the green indicator is on

Charging Instructions

(1) Automatic Charging: Please place the charging base against the wall, remove all obstacles 1 meter on the left and right and 2 meters in front of it, and then connect the power supply. When the power is insufficient, robot cleaner will automatically source the recharge seat to charge; In the selection mode (power on status), press the recharge button on the host panel, and it will automatically source the recharge base for charging, as shown in Figure 1 and 2.

(2) Manual Charging: Plug the power adapter directly into the charging port of robot vacuum cleaner, and connect the other end to the power supply.

Figure 1

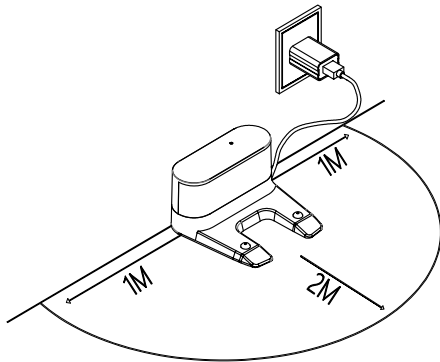
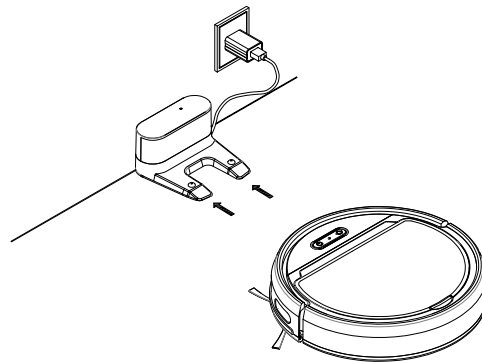

Figure 2



Attentions:

- A. In order to ensure the maximum efficiency and prolong the life of battery, please use the original adapter to charge this product. It is recommended to charge it for 6-7 hours for the first charging.
- B. When it is charging, the red indicator on host panel is flashing, and the green indicator is off, it means the charging is happening; If the green indicator is always on and the red indicator is off, it means robot cleaner had been fully charged.
- C. After robot cleaner is fully charged, please turn it off when it does not need to work. If it is overcharged or not used for too long time, it is easy for the battery to be broken.

Battery Installation and Disassembly Steps

- (1) The battery has been installed well before leaving factory. If it needs to be disassembled, please do it under the guidance of the manufacturer or customer service.
- (2) After the screw is loosened (use a crossing screwdriver), open the cover of battery house (As shown in Figure 3 and Figure 4). Put the battery in the slot at right place, and lock the screw after the cover of battery house is closed.

(3) Please turn off the power switch of robot vacuum cleaner before installing or removing the rechargeable battery.

Figure 3

Figure 4

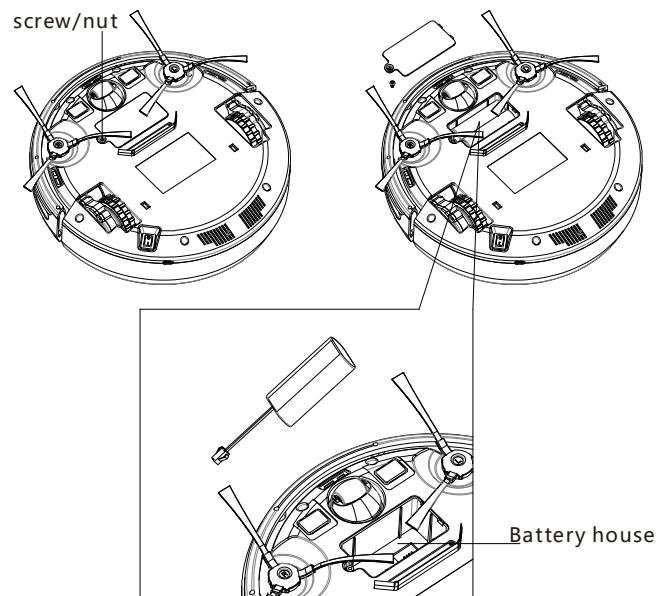

Installation and Removal Steps of Side Brushes

(1) Installation Step: press side brush directly into the center convex shaft of the brush holder to complete the installation.(As shown in Figure 5)

(2) Disassembly Step: hold side brush and pull the central convex shaft from the Brush holder.(As Shown in Figure 6)

Press downward firmly to install
the left and right brushes

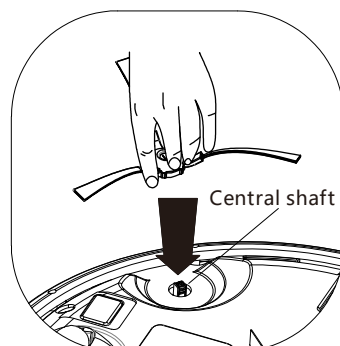

Figure 5

Pull out upward to take
down the side brushes

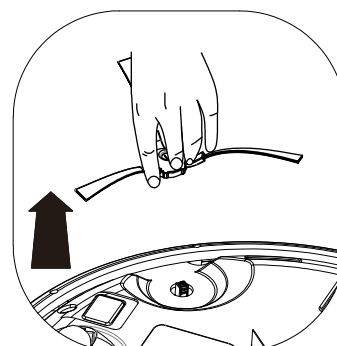

Figure 6

Instructions of Mop Usage

Attention: Please do not have the mopping function happen on the carpet or environments with carpet.

- (1) Please take the mop carriage and fix it on right position , as shown in Figure 7
- (2) Soak the mop cloth in water.
- (3) Stick the mop to the corresponding position as shown in the figure.
- (4) Disassemble mop: Just rip it off the MOP board

Warm tips: please clean the mop cloth in time after mopping the floor each time.

Figure 7

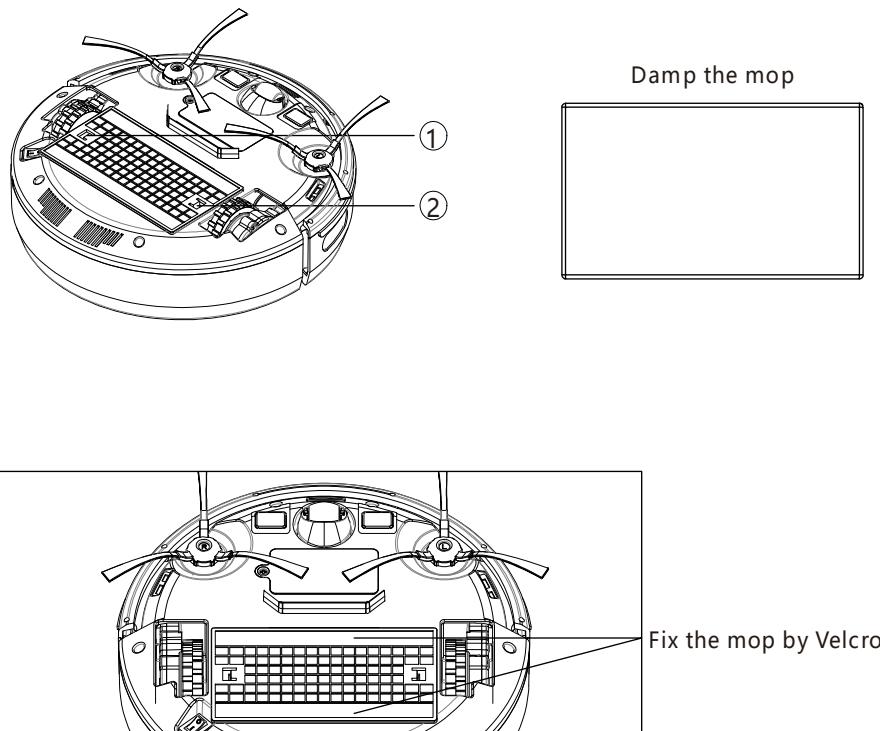

APP Connection Steps

- (1) Please source and download "Tuya Smart" in the APP store of your cell phone.
- (2) Open the "Tuya Smart" application and carry out the distribution network according to the following steps:
 - ① After creating a new account, log in and turn on the Bluetooth function of your cell phone:
 - ② Firstly click the "+" in the upper right corner; secondly click the small appliances on the left, and then click the WiFi; as shown in the figure below.

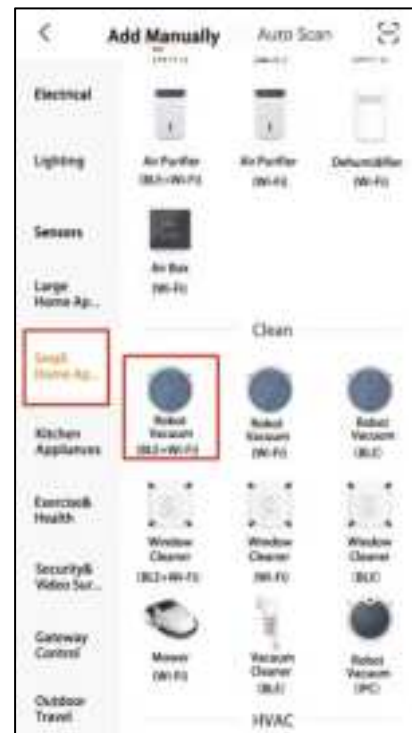
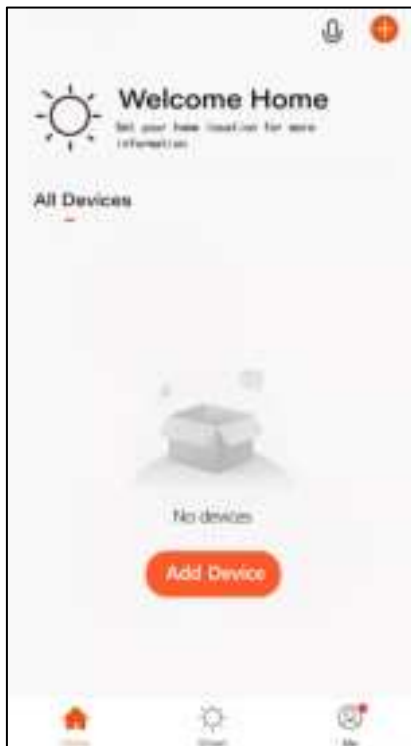

(2) Turn on the switch key at the bottom of robot cleaner and press the recharge key for 3 seconds. At this moment the red indicator goes out and the green indicator flashes quickly, indicating that the WiFi has been turned on, the mode of fast distribution network is ready, and waiting for the connection to be established. After that, click the "confirm that the indicator is flashing" option, and connect according to the app prompts in turn; as shown in the following figure:

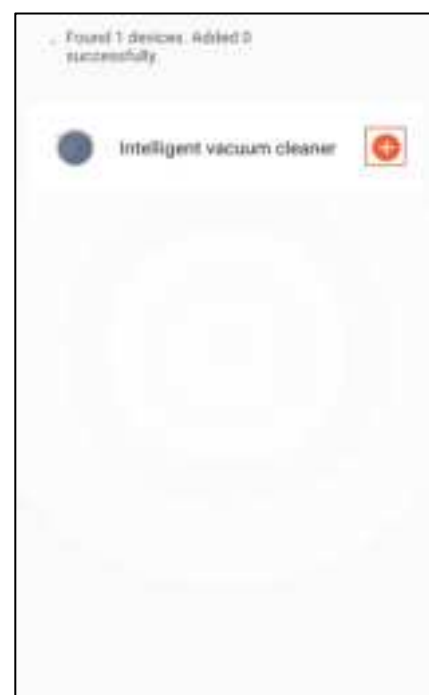



(3) After the distribution network of WiFi is completed, you can start to operate robot cleaner; as shown in the figure below.

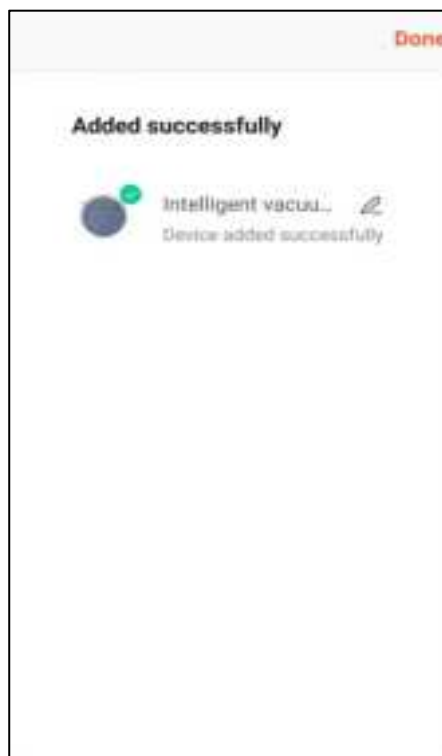

4. Cleaning and Maintenance of Product

Cleaning of Dust Box and HEPA

Warm tips: in order to achieve the best cleaning effect, please check and clean the foreign matters on HEPA before use product, and keep the HEPA unblocked.

- (1) Open the upper cover, put your fingers into the groove of the dust box, hold the dust box tightly and take it out upward. As shown in below figure.
- (2) Open the dust box cover, take out filter HEPA in it, and then empty the debris and dirt in dust box.
- (3) Wash the dust box under the tap. Do not put it into the washing machine, dishwasher or other machines.
- (4) Clean the surface of filter HEPA gently with a brush regularly; After washing, the dust box should be dried before use again; otherwise it will affect the effect of dust collection.
- (5) After the dust box is dry, please Install the filter HEPA and dust box cover in turn. Put the dust box into right position and cover it (Before starting robot cleaner, please make sure that the filter HEPA in the dust box has been installed correctly. If not, the robot c cleaner may be broken if you have the robot cleaner start directly).

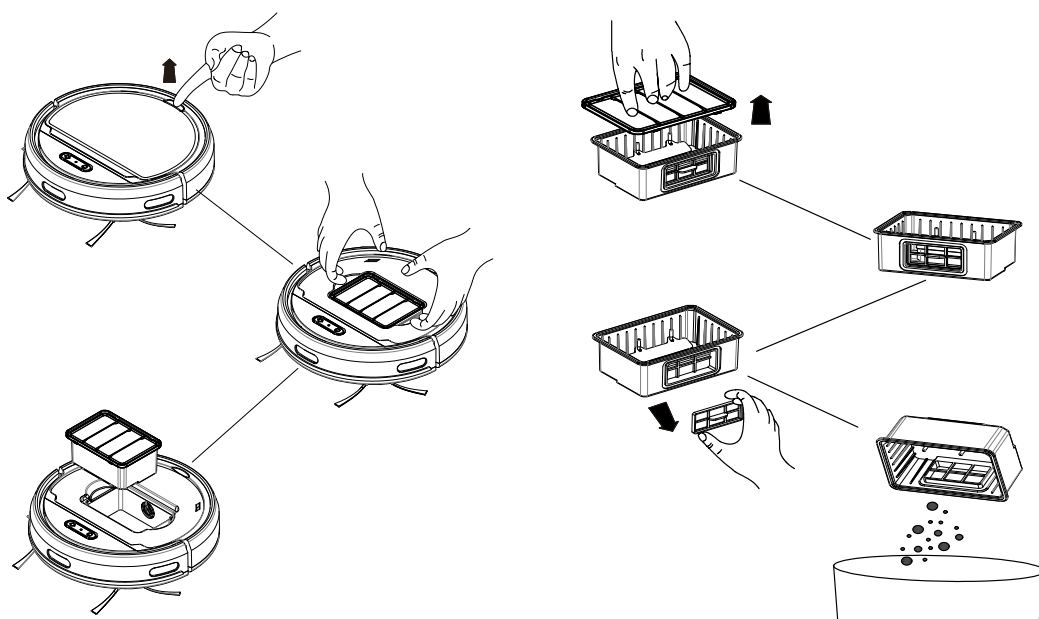

Cleaning of Suction Mouth

- (1) Firstly, turn off robot cleaner.
- (2) Clean up the dust and dirt accumulated in suction mouth.

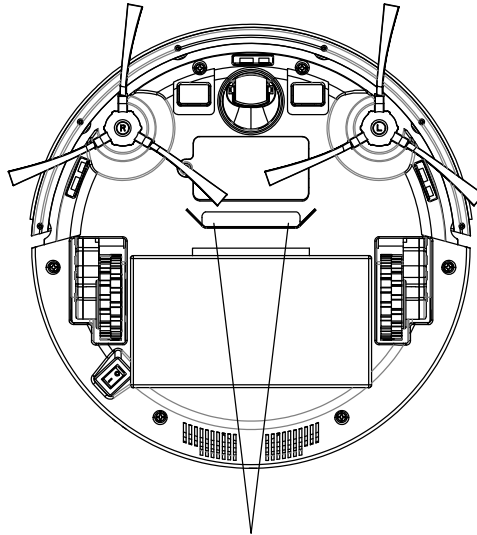

Clean the foreign matters at the dust suction port

Cleaning of Side Brush

- (1) Turn off the switch of robot cleaner, place the bottom of robot cleaner on the flat ground or desktop, hold the side brush tightly and pull it up to remove it.
- (2) After cleaning side brushes, press side brush into the center convex shaft of brush holder and install it on right position
- (3) If side brush is worn out, please replace it with a new one to achieve the best cleaning effect.

5. Analysis of Product Faults

1. The robot cleaner can not work or the cleaning ability is weakened

- (1). Check whether the switch of robot cleaner is on.
- (2). Check whether the dust box is clean and whether the side brushes are good
- (3). Check whether the voltage of battery drops seriously.
- (4). Check whether HEPA in the dust box is blocked by foreign matters

2. The robot cannot be charged

- (1). Check whether the power adapter is connected with the charger well and whether the power indicator of the charging base is on.
- (2). Check whether the power percentage of battery is too small. If it is too small, please use the adapter to charge robot cleaner to get enough power.

3. Excessive noise during Robot Cleaner Operation

- (1). Check whether the dust box is installed in a proper position
- (2). Check whether the left and right brushes are entangled with foreign matter

4. The robot cleaner stops working suddenly in operation

- (1). Check whether regular cleaning is set and the cleaning time is over

5. Analysis of Product Faults

No.	Faults Type	Faults Prompt	Faults Handling
1	anti-collision bar gets stuck	The buzzer rings quickly every 5 seconds	If the front anti-collision bar is stuck, put it back in place
2	The robot cleaner is suspended	The buzzer rings 2 times every 5 seconds	If the robot cleaner is suspended, pick it up and put it into proper position.
3	Excessive current for side brush	The buzzer rings 2 times every 5 seconds	If side brush is entangled stuck, clear up dirt and make it work well.
4	Excessive current for wheels	The buzzer rings 2 times every 5 seconds and 1 time every 1 second	If wheel is entangled stuck, clear up dirt and make it work well.

Warnings about battery



You must not remove (or attempt to remove) the battery incorporated in this product On your own. To replace the battery, you must contact your service provider or an independent qualified professional. These instructions have been prepared for the exclusive use of your service.

Provider or independent qualified professional.

FOR YOUR OWN SAFETY, DO NOT ATTEMPT TO REMOVE THE BATTERY ON YOUR OWN OR DISPOSE OF IT IN FIRE. DO NOT DISASSEMBLE,

Warning

CRUSH OR PUNCTURE THE BATTERY



Correct disposal of batteries in this product

(Applicable in countries with separate battery return systems.)

The marking on the battery, manual or packaging indicates that the battery in this product should not be disposed of with other household waste. Where marked, the chemical symbols Hg, Cd or Pb indicate that the battery contains mercury, cadmium or lead above the reference levels in EC Directive 2006/66. The battery incorporated in this product is not user replaceable. For information on its replacement, please contact your service provider. Do not attempt to remove the battery or dispose it in a fire. Do not disassemble, crush, or puncture the battery. If you intend to discard the product, the waste collection site will take the appropriate measures for the recycling and treatment of the product, including the battery.

* Due to the continuous improvement of the product, this information product is subject to the physical object, and our company reserves the right to update the product.

FCC Statement

This equipment has been tested and found to comply with the limits for a Class B digital device, pursuant to part 15 of the FCC Rules. These limits are designed to provide reasonable protection against harmful interference in a residential installation. This equipment generates, uses and can radiate radio frequency energy and, if not installed and used in accordance with the instructions, may cause harmful interference to radio communications. However, there is no guarantee that interference will not occur in a particular installation. If this equipment does cause harmful interference to radio or television reception, which can be determined by turning the equipment off and on, the user is encouraged to try to correct the interference by one or more of the following measures:

- Reorient or relocate the receiving antenna.
- Increase the separation between the equipment and receiver.
- Connect the equipment into an outlet on a circuit different from that to which the receiver is connected.
- Consult the dealer or an experienced radio/ TV technician for help.

This device complies with part 15 of the FCC Rules. Operation is subject to the following two conditions: (1) This device may not cause harmful interference, and (2) this device must accept any interference received, including interference that may cause undesired operation.

Caution

Any changes or modifications not expressly approved by the party responsible for compliance could void the user's authority to operate the equipment.

FCC Radiation Exposure Statement

This equipment must be installed and operated in accordance with provided instructions and the antenna(s) used for this transmitter must be installed to provide a separation distance of at least 20 cm from all persons and must not be co-located or operating in conjunction with any other antenna or transmitter. End-users and installers must be provided with antenna installation instructions and transmitter operating conditions for satisfying RF exposure com

FCC ID:2BC6P-P1