

hiboy

S2 SE

Electric Scooter



The manufacturer reserves the right to make changes to the product and update this manual at any time.

USER MANUAL



Contents

| | | |
|----|---|----|
| 1 | Package Contents | 01 |
| 2 | Product Overview | 02 |
| 3 | Installation Instructions | 03 |
| 4 | Charging | 04 |
| 5 | Operation Instructions..... | 04 |
| 6 | Important Safety Instructions | 06 |
| 7 | Moving and Storage Instructions | 10 |
| 8 | Dangerous Actions (No Attempting!) | 11 |
| 9 | Safety Reminder | 13 |
| 10 | Folding and Carrying | 14 |
| 11 | Daily Care and Maintenance | 16 |
| 12 | Specifications | 20 |
| 13 | Instructions of Seat Assembly(Optional) | 21 |
| 14 | Limited Warranty Statement | 22 |
| 15 | Q&A and Trouble shooting | 24 |
| 16 | Contact Us | 27 |

1. Package Contents



Allen Wrench



4 x Screws







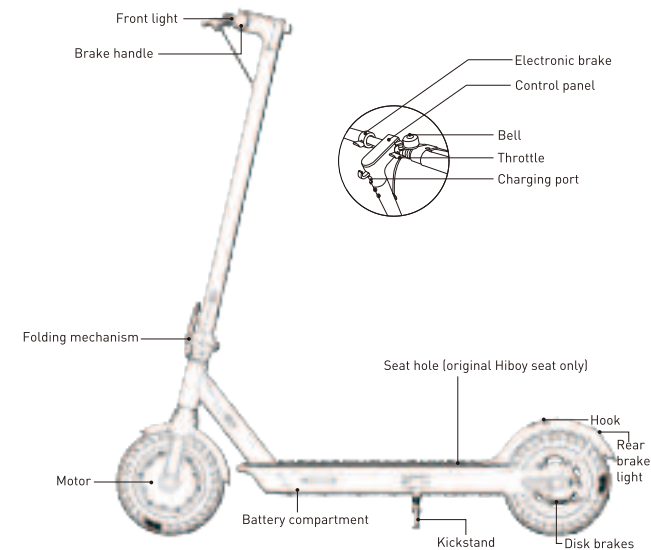

Charger

Carefully check package contents, if anything is missing or damaged, please contact Hiboy customer service for support: support@hiboy.com.

2. Product Overview



Control Panel

-  Power Button
-  Light
-  Mode
-  Temperature
-  Cruise Control
-  Battery Indicator

When the scooter is off, press the button to turn on the scooter; When the scooter is on, press and hold for 3 seconds to turn off the scooter.

After the scooter is turning on, press the button to turn on or off all the lights (the front light, side LED lights and rear light).

Press twice to switch the speed mode, Red S indicates Sport mode (max speed 19 mph), and Green S indicates Drive mode (max speed 13 mph)

When the icon lights up, please pull over to the side of the road to cool down the scooter.

Quick press the power button 3 times to turn on (you will hear "Bi Bi") or turn off (you will hear "Bi") the cruise control function.

The power level is indicated by five power lights on the control panel. As power is consumed, the lights will change from solid to flashing, and finally turn off. When all 5 power lights are on, the battery level is between 80%-100%; When 4 lights are solid, the battery level is between 60%-80%, and so on. When the last power light flashes, it indicates low power. Please recharge soon for further use.

3. Installation Instructions

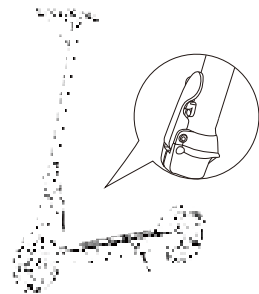

1. Unfold the stem and push the folding lever until you hear a click. Then unfold the kickstand to support the scooter.

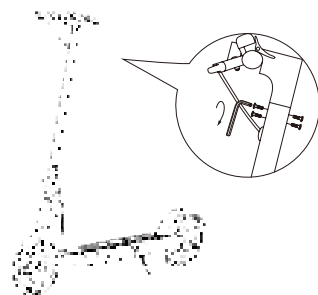

3. Use the Allen wrench to fix 4 screws, make sure it's tightened.

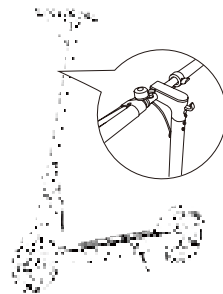

2. Attach the handlebar to the stem. Make sure it's right way round.

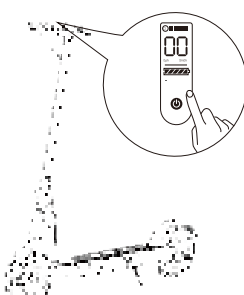

4. Ensure your scooter powers on and off.

4. Charging

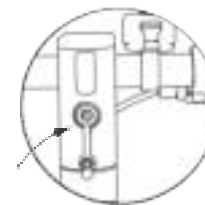
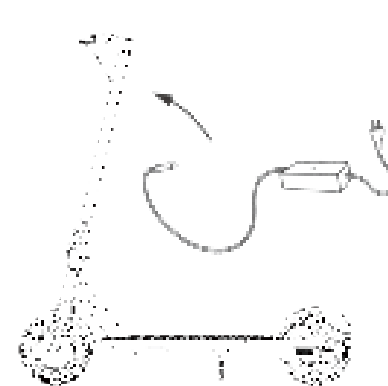

Open the rubber cover

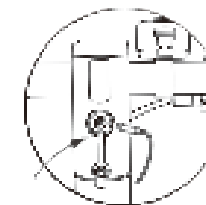

Insert the charger plug in

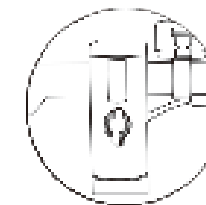

Fill and fix the rubber plug after the charging

Your scooter will be fully charged when the LED light on the charger changes from red (charging) to green (fully charged). After a period of full charge, it will automatically cut off the charging. Even so, we still don't recommend to charge your scooter for a long time. Do not connect the charger if the charging port is wet. Cover the charging port when not use. Leave it indoor when charging or not riding. Charging of the escooter shall only be performed with the manufacturer's recommended charger

5. Operation Instructions



Always wear a helmet and safety gear so to avoid falling and injury during the driving learning, as shown in the figure.

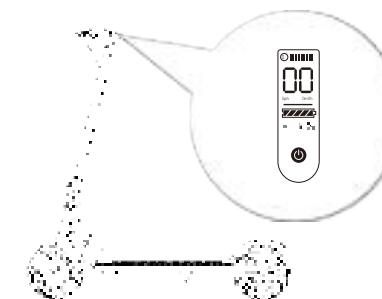

1. Turn the power on, and check the power indicator. Note: The scooter can not be turned on during charging

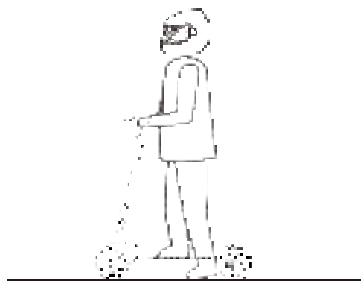

2. Step on the deck with one foot, and slowly kicks off the other on the ground.

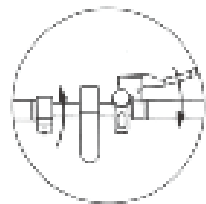

4. Release the throttle to reduce the speed slowly. Squeeze the brake lever for a sudden brake.

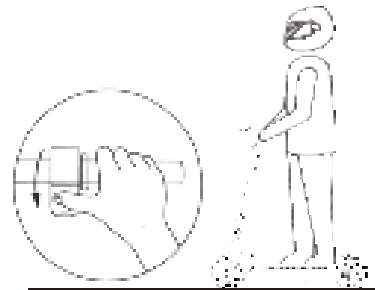

3. When the scooter starts to coast, put both feet on the deck and press the throttle (the throttle initiates once the coasting speed exceeds 3.1 mph).

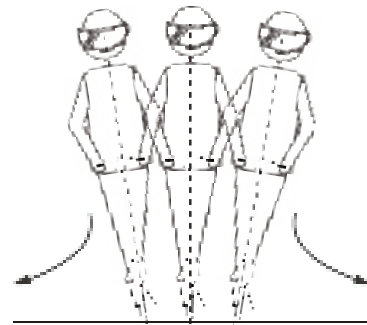

5. Tilt your body to the steering direction as you turn, and turn the handlebar slowly.

6. Important Safety Instructions



Do not ride in the rain.

*Ne pas rouler sous la pluie

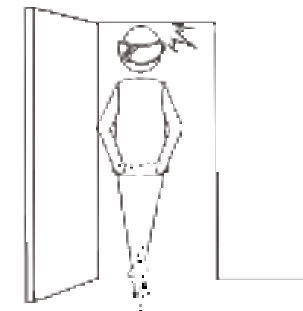

Look out for doors, elevators and other overhead obstacles.

*Attention aux portes, aux ascenseurs et aux autres obstacles aériens.



Keep your speed between 3.1-6.2 mph when you ride through speed bumps, elevator door sills, bumpy roads or other uneven surfaces. Slightly bend your knee to better adjust mentioned surfaces

*Maintenez votre vitesse entre 3,1 et 6,2 mph lorsque vous traversez des ralentisseurs, des seuils de porte d'ascenseur, des routes cahoteuses ou d'autres surfaces irrégulières. Pliez légèrement le genou pour mieux ajuster les surfaces mentionnées.



Do not accelerate when you go downhill.

*N'accélérez pas dans les descentes.

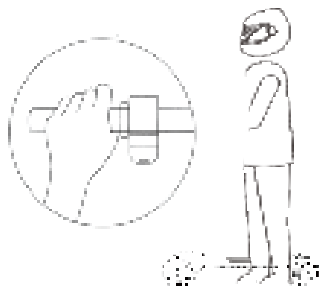

Do not press the throttle when you're walking alongside the scooter.

*N'appuyez pas sur l'accélérateur lorsque vous poussez le scooter à marcher.

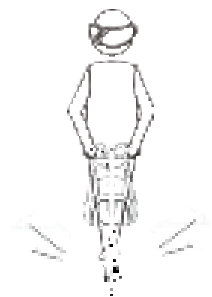

Do not hang bags or other heavy stuff on the handlebar.

*Ne pas accrocher de sacs ou d'autres objets lourds au guidon.



Always steer clear of obstacles.

*Toujours rester à l'écart des obstacles



Keep both feet on the deck all time.

*Garder les deux pieds sur le pont en permanence.

WARNING - When using this product, basic precautions should always be followed,

including the following:

- 1) Read all the instructions before using the product.
 - 2) To reduce the risk of injury, close supervision is necessary when the product is used near children.
 - 3) Do not put fingers or hands into the product.
 - 4) Do not use this product if the flexible power cord or output cable is frayed, has broken insulation, or any other signs of damage.
 - 5) This equipment is not intended to be used at ambient temperatures less than -10°C (14°F) or above ambient temperatures of 45°C (113°F). The equipment's recommended storage temperature is between 10°C (50°F) and 45°C (113°F).
 - 6) The battery is intended to be charged when the ambient temperature is between 10°C (50°F) and 40°C (104°F). Never charge the battery when ambient temperatures are outside this range.
- The battery is not intended to be used at ambient temperature less than -10°C (14°F) or above ambient temperature of 45°C (113°F). The battery's recommended storage temperature is between 15°C (59°F) and 25°C (77°F) .

ATTENTION - Lors de l'utilisation de ce produit, des précautions de base doivent toujours être suivies,

notamment les suivantes :

1)Lisez toutes les instructions avant d'utiliser le produit.

2)Pour réduire le risque de blessures, une surveillance étroite est nécessaire lorsque le produit est utilisé près d'enfants.

3)Ne mettez pas les doigts ou les mains dans le produit.

4)N'utilisez pas ce produit si le cordon d'alimentation flexible ou le câble de sortie est effiloché,

a une isolation brisée ou tout autre signe de dommage.

5)Cet équipement n'est pas destiné à être utilisé à des températures ambiantes inférieures à -10°C (14°F) ou supérieures à des températures ambiantes de 45°C (113°F). La température de stockage recommandée de l'équipement se situe entre 10°C (50°F) et 45°C (113°F).

6)La batterie doit être chargée lorsque la température ambiante est comprise entre 10°C (50°F) et 40°C (104°F).

Ne chargez jamais la batterie lorsque les températures ambiantes sont en dehors de cette plage.

La batterie n'est pas destinée à être utilisée à une température ambiante inférieure à -10°C (14°F) ou supérieure à

une température ambiante de 45°C (113°F). La température de stockage recommandée de la batterie se situe entre 15°C (59°F)

et 25°C (77°F).

7. Moving and Storage Instructions

Moving warning:

When transporting the electric scooter, ensure that the device is in the off position to avoid accidental activation by inadvertent switch contact.

Advise users to adopt the correct lifting posture by raising the electric scooter vertically to prevent the device from tilting or falling. When handling, please hold it gently.

Lors du transport de la trottinette électrique, assurez-vous que l'appareil est éteint pour éviter une activation accidentelle par contact involontaire avec l'interrupteur.

Conseillez aux utilisateurs d'adopter la posture de levage correcte en soulevant la trottinette électrique verticalement pour éviter que l'appareil ne bascule ou ne tombe.

Storage warning:

When the electric scooter not in use, keep it indoors where it is dry and cool.

Do not put it outdoors for a long time.

Excessive sunlight, overheating and overcooling accelerate tire aging and compromise the electric bike and the battery pack's lifespan.

Lorsque le vélo électrique n'est pas utilisé, conservez-le à l'intérieur dans un endroit sec et frais.

Ne le laissez pas à l'extérieur pendant une longue période.

L'exposition excessive au soleil, la surchauffe et le refroidissement excessif accélèrent le vieillissement des pneus et compromettent la durée de vie du vélo électrique et de la batterie.

8. Dangerous Actions (No Attempting!)

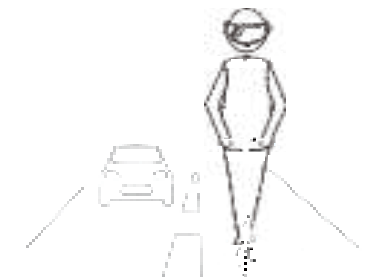

Do not ride in traffic lanes or residential areas where vehicles and pedestrians are both allowed.

**Ne pas rouler sur les voies de circulation ou dans les zones résidentielles où les véhicules et les piétons sont autorisés à circuler.*



Do not ride in a ponding that is higher than 0.78 inches.

**Ne pas rouler dans une flaque d'eau supérieure à 0,78 pouces.*

11

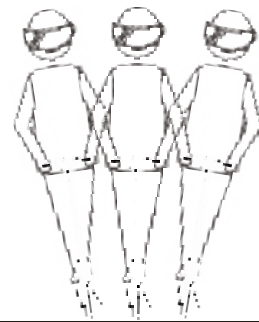

Do not turn the handlebar violently during high-speed riding

**Ne tournez pas violemment le guidon lorsque vous roulez à grande vitesse*



Do not ride with anyone else, including children.

**Ne pas rouler avec quelqu'un d'autre, y compris des enfants.*



Do not keep your feet on the rear mudguard.

**Ne gardez pas les pieds sur le garde-boue arrière.*



Do not keep your hands away from handlebar.

**Ne pas garder les mains éloignées du guidon*

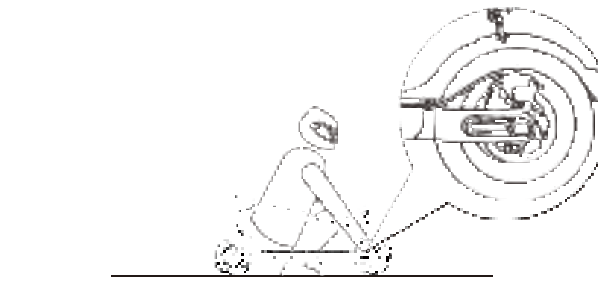

Do not touch the disc brake.

**Ne pas toucher le frein à disque*



Do not try riding up or down stairs, and jumping over obstacles

**N'essayez pas de monter ou de descendre des escaliers, ni de sauter par-dessus des obstacles.*

12

9. Safety Reminder

- This electric scooter is a leisure device. But once they're in a public area, they'll be seen as vehicles, subjecting to any risks faced by vehicles. For your safety, please follow instructions in the manual and traffic laws and regulations set forth by government and regulatory agencies. (Pour votre sécurité, veuillez suivre les instructions contenues dans le manuel et les lois sur la circulation et les règlements énoncés par les organismes gouvernementaux et réglementaires).

- At the same time, you should understand that risks cannot be entirely avoided as others may violate traffic regulations and drive incautiously, and you're exposed to road accidents just as when you're walking or biking. The faster the scooter is, the longer it takes to stop. On a smooth surface, the scooter may slip, lose balance, and even result in a fall. Thus it is crucial that you use caution, keep proper speed and distance, especially so when you're unfamiliar with the place.

- Respect pedestrians' Right of Way. Try not to startle them while driving, especially children. When you ride from behind pedestrians, ring your bell to give them a heads-up and slow your scooter to pass from their left (applicable to countries where vehicles drive on the right). When you ride across pedestrians, keep to the right at a low speed. When you drive across pedestreains, keep the lowest speed or getting off the vehicle

- Closely follow the safety instructions in the manual especially in the countries that lack relevant laws and regulations regarding electric scooters. Hiboy shall not be liable for any financial losses, physical injuries, accidents, legal disputes and other interest conflicts resulted from actions that violate user instructions.

- Do not lend your scooter to whoever doesn't know the operations. And when you do lend it to your friends, please take the responsibility to ensure he/she knows the operation and wears the safety gear.

- Check the scooter before every use. When you note loosen parts, low battery alerts, excessive wear, strange sounds, malfunctions and other abnormal conditions, stop riding immediately and call for professional support.

- Devices are not intended for use at elevations greater than 2000 m above sea level Prolonged Exposure to UV Rays, Rain and the Elements May Damage the Enclosure Materials, Store Indoors When Not in Use

- **WARNING – Risk of Fire – No User Serviceable Parts.**

- **AVERTISSEMENT – Risque d'incendie – Aucune des pièces ne peut être réparée par l'utilisateur**

10. Folding and Carrying

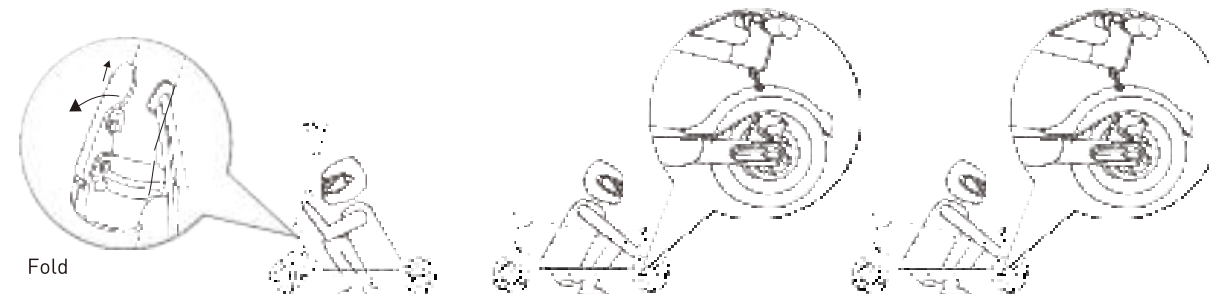

Fold

Make sure that the scooter's turned off. To fold, unlock the folding mechanism, and bend the handlebar stem to hook the clamp on the rear fender. To open, unhook from the clamp, erect the handlebar and lock the folding structure.



Carry

Hold the handlebar stem with either one hand or both hands to carry.



If the brake is too tight, use the allen wrench to loosen the screws on the caliper, and slightly send back the brake cable to shorten the exposed length, then tighten the screws. If the brake is too loose, loosen the screws, and slightly pull out the brake cable to lengthen the exposed length, then tighten the screws.



If the handlebar and its stem sway during riding, please tighten the screws on the folding mechanism.

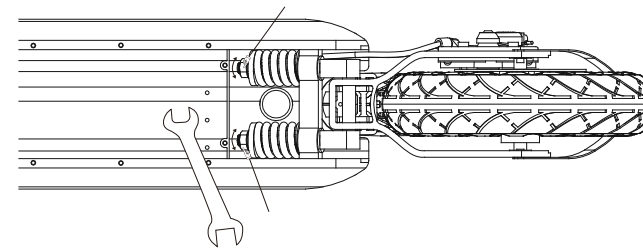

We have pre-adjusted the rear suspension to make it be workable for 165 lbs+ users, if you feel the suspension is too loosen or tight, then please use No. 14 wrench to adjust the two nuts on the suspension and make it more tight or loosen until you feel the suspension is working well for your weight.

11. Daily Care and Maintenance

Cleaning

If you see stains on the scooter's body, wipe them off with a damp cloth. If the stains won't scrub off, put on some toothpaste, and brush them with a toothbrush, then wipe them off with a damp cloth. If you see scratches on plastic parts, use sandpaper or other abrasive materials to polish them.

Notes: do not clean the scooter with alcohol, gasoline, kerosene or other corrosive and volatile chemical solvents to prevent dire damage. Do not wash the scooter with a high-pressure water spray. During cleaning, make sure that the scooter's turned off, the charging cable is unplugged, and the rubber flap is closed as water leakage may result in electric shock or other major problems.



WARNING!

Battery maintenance

1. Use original battery packs, use of other models or brands may bring about safety issues;
2. Do not touch the contacts. Do not dismantle or puncture the casing. Keep the contacts away from metal objects to prevent short circuit which may result in battery damage or even injuries and deaths;
3. **Use original power adapter to avoid potential damage or fire;**
4. Mishandling of used batteries may do tremendous harm to the environment. To protect natural environment, please follow local regulations to properly dispose used batteries;
5. **After every use, fully charge the battery to prolong its lifespan.**

Do not place the battery in an environment where the ambient temperature is higher than 104°F or lower than 14°F (e.g., do not leave the scooter or the battery pack in a car under direct sunlight for an extended time). Do not throw the battery pack into fire as it may lead to battery failure, battery overheating, and even another fire. **If the scooter is expected to be left idle for more than 30 days, please fully charge the battery and place it in a dry and cool place. Keep in mind to recharge it every 60 days to protect the battery from potential damage which is beyond limited warranty.**

Always charge before exhausting the battery to prolong the battery's lifespan. The battery pack performs better at normal temperature, and poor when it is below 32°F. For instance, when it is below -4°F, the riding range is only half or less at normal state. When the temperature rises, the riding range restores.

The damage caused by prolonged no charge is irreversible and is beyond limited warranty. Once the damage is done, the battery can not be recharged.

ISED Canada Statement:

This device contains licence-exempt transmitter(s)/receiver(s) that comply with Innovation, Science and Economic Development Canada 's licence exempt RSS(s). Operation is subject to the following two conditions:

(1)this device may not cause interference and

(2)this device must accept any interference, including interference that may cause undesired operation of the device.

Radiation Exposure: This equipment complies with Canada radiation exposure limits set forth for an uncontrolled environment

To maintain compliance with IC's RF Exposure guidelines, this equipment should be installed and operated with minimum distance of 5mm the radiator your body. This device and its antenna(s) must not be co-located or operation in conjunction with any other antenna or transmitter

Déclaration de l'ISED Canada:

Cet appareil contient des émetteurs / récepteurs exempts de licence qui sont conformes aux RSS exemptes de licence d'Innovation, Sciences et Développement économique Canada. L'opération est sous réserve des deux conditions suivantes :

(1)cet appareil ne peut pas causer d'interférences et

(2)ce dispositif doit accepter toute interférence, y compris peut provoquer le fonctionnement indésirable de l'appareil.

Exposition aux rayonnements: Cet équipement est conforme aux radiations du Canada limites d'exposition pour un environnement incontrôlé Pour maintenir le respect des guides d'exposition RF d'IC, cquipment doit être installé et actionné avec une distance minimale de 5mm le radiateur de votre corps. Cet appareil et ses antennes ne doivent pas être co-localisé ou en opération en conjonction avec toute autre antenne ou émetteur

FCC Warning

This device complies with Part 15 of the FCC Rules. Operation is subject to the following two conditions:
(1) This device may not cause harmful interference, and (2) this device must accept any interference received, including interference that may cause undesired operation.

NOTE 1: This equipment has been tested and found to comply with the limits for a Class B digital device, pursuant to part 15 of the FCC Rules. These limits are designed to provide reasonable protection against harmful interference in a residential installation. This equipment generates, uses and can radiate radio frequency energy and, if not installed and used in accordance with the instructions, may cause harmful interference to radio communications. However, there is no guarantee that interference will not occur in a particular installation. If this equipment does cause harmful interference to radio or television reception, which can be determined by turning the equipment off and on, the user is encouraged to try to correct the interference by one or more of the following measures:

- Reorient or relocate the receiving antenna.
- Increase the separation between the equipment and receiver.
- Connect the equipment into an outlet on a circuit different from that to which the receiver is connected.
- Consult the dealer or an experienced radio/TV technician for help.

NOTE 2: Any changes or modifications to this unit not expressly approved by the party responsible for compliance could void the user's authority to operate the equipment.

The device has been evaluated to meet general RF exposure requirement. The device can be used in portable exposure condition without restriction.

12. Specifications

| S2 SE | Items | Specifications |
|---------------------|---------------------------------------|--|
| Dimensions | L × W × H [1] | 46.1*16.5*48.8 inch [117*42*12.4 cm] |
| | After folding: L × W × H | 46.1*16.5*20.1 inch [117*42*51.5 cm] |
| Weight | Item weight | 37.8 lbs [17.15 kg] |
| Riding requirements | Max. load[2] | 220 lbs [100 kg] |
| | Age | 16-50 |
| Main parameters | Max. speed | 19 mph[30 km/h] |
| | Max. range[3] | 17 mile [27 km] |
| | Max. climbing angle (%) | Approx. 15 |
| | Operating temperature | 14~104 (°F) |
| | Storage temperature | 14~104 (°F) |
| | IP rating | IPX4 for the whole vehicle, IPX5 for the battery pack and controller |
| Battery pack | Rated voltage | 36V DC |
| | Max. input voltage | 42V DC |
| | Rated capacity | 7.8 Ah |
| | Intelligent battery management system | Unusual temperature/short circuit/under voltage/over current protections...etc |
| Wheel Motor | Rated power | 350W |
| | Max. power | 430W |
| Charging adapter | Output power | 63W |
| | Input voltage | 100~ 240 V |
| | Output voltage | 42V DC |
| | Output current | 1.5 A |
| | Charging time | 5.5-6.5 hours |

[1] Item height: from the ground to the top of the scooter;
[2] Max. load: the maximum allowable weight shall be kept within 220 lbs [driver and objects included] in any case. Consider an extra weight of the clothes or other accessories with us during the trip and the gravity generated by speed, the scooter will not support it if this load limit is exceeded.
[3] MAX range: measured when it is no wind and at 77°F, the scooter's fully charged to ride at a even speed of 11.4 mph (18.4 km/h) on a at surface with a load of 165 pounds (75 kg).
The real battery life vary with different factors of the load , humidity , wind speed and operation habits...etc.

13. Instructions of Seat Assembly(Optional)

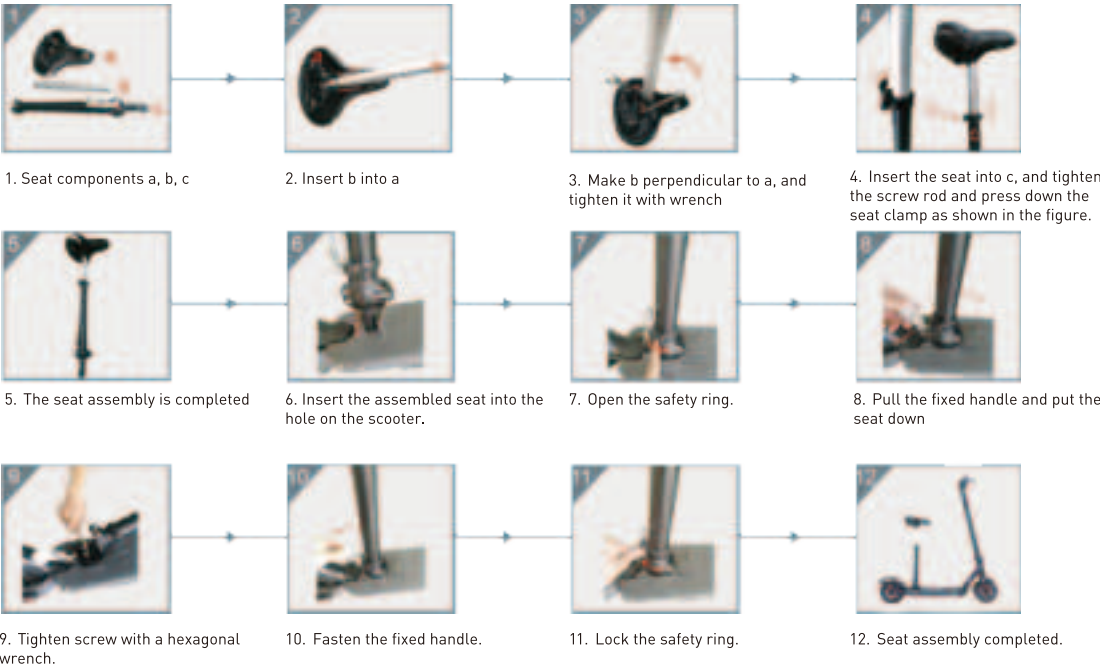

* The seat is not included, please purchase separately from hiboy store*

14. Limited Warranty Statement

30 DAY SATISFACTION GUARANTEED RETURN POLICY

If you are unsatisfied with your purchase, Hiboy's return policy allows you to return your undamaged Hiboy product purchased on the Authorization channel within 30 days counting from the date of receipt of shipment, and request a refund from the Authorization channel for any reason. Note: The cost of return shipping will be borne by the customer if the product has no quality issue.

For the return request, Hiboy is not responsible for lost packages due to the carrier, or products received that cannot be verified. Received products that have damage determined to have been caused by the end-user may be subject to denial of the return request.

TO QUALIFY FOR A REFUND, ALL THE FOLLOWING CONDITIONS MUST BE MET:

- 1.A Return Merchandise Authorization (RMA) must be requested from Hiboy within 30 days from the date of receipt of shipment. To request an RMA, contact Hiboy Service Team at support@hiboy.com.
- 2.The cost of return shipping will be borne by the customer.
- 3.For warranty service, please keep your receipt and/or invoice to validate proof of purchase.
- 4.Returned product must be in good physical condition (not physically broken or damaged).
- 5.All accessories originally included with your purchase must be included with your return.
- 6.If you return a product to Hiboy, (a) without an RMA from Hiboy(b) without all parts included in the original package, Hiboy retains the right to refuse delivery of such return.

LIMITED PRODUCT WARRANTY

Hiboy product basically will be free from defects in materials and workmanship under normal use for a period aforementioned. Hiboy does not warrant the operation of the product will be uninterrupted or error-free. Hiboy is not responsible for damage arising from failure to follow instructions relating to the product's usage.

REMEDIES

If a hardware defect is found and a valid claim is received by Hiboy within the Warranty Period, Hiboy will, at its option and to the extent permitted by law, either (1) repair the product at no charge, using new or refurbished replacement parts or, (2) replace the product with a new or refurbished product. In the event of a defect, to the extent permitted by law, these are your sole and exclusive remedies. Shipping and handling charges may apply except where prohibited by applicable law. This Limited Warranty is valid only in the jurisdictions where the products are sold by www.hiboy.com, and is valid to the extent permitted by the applicable laws of such jurisdictions. Any replacement hardware product will be warranted for the remainder of the original warranty period or thirty (30) days, whichever is longer, or for any additional period of time that may be applicable in your jurisdiction.

HOW TO OBTAIN WARRANTY SERVICE

A Warranty Service Order must be requested from Hiboy within Warranty Period from the date of receipt of shipment. To request a Warranty Service Order, contact Hiboy Service Team support@hiboy.com.

To obtain warranty service, you must deliver the product, in either its original packaging or packaging providing an equal degree of protection, to the address specified by Hiboy. In accordance with applicable law, Hiboy may require the customer to furnish proof of purchase details and/or comply with registration requirements before receiving warranty service. period or thirty (30) days, whichever is longer, or for any additional period of time that may be applicable in your jurisdiction.

LIMITATION OF DAMAGES

Except to the extent prohibited by applicable law, Hiboy shall not be liable for any incidental, indirect, special, or consequential damages, including but not limited to loss of profits, revenue or data, resulting from any breach of express or implied warranty or condition, or under any other legal theory even when Hiboy has been advised of the possibility of such damages. Some jurisdictions do not allow the exclusion or limitation of special, indirect, incidental or consequential damages, so the above limitation or exclusion may not apply to you.

15. Question & Answer

1. Is there any necessary information need to be included before contacting with Hiboy Support Team?
A: Yes, if you need any support from Hiboy, please contact us at support@hiboy.com, and please always include your order number, correct model No., descriptions of the problem, pictures, and videos that can show details about the issue in the email, thanks.

2. My scooter can't be turned on, what can I do?
A: First please make sure you are not turning on the scooter during charging, because for safety consideration, we have set the scooter can't be turned on during charging. Second please make sure the scooter has been charged for a while to have enough battery to support it can be turned on, otherwise please contact us at support@hiboy.com for further support.

3. I can't charge my scooter, what's the problem?
A: Please note if the scooter is charging, then the led on the charger will show red color, if the scooter is fully charged, then the led on the charger will show green color. So please help to verify if the charger is defective first: Plug the charger into the socket but not connecting to scooter, if the charger led is NOT on or it is NOT green color, then it means the charger is defective. If the charger is not defective, please contact us at support@hiboy.com for further support.

4. What if the E-Scooter arrived missing accessory or broken part?
A: Please take a photo and send to Hiboy Support Team's email: support@hiboy.com, Hiboy Support Team will reply you soon and send correct accessory or part replacement.

5. How to attach the seat?
A: Please refer to the assembly steps in this manual, and you can also search for "how to assemble Hiboy seat" on Google, and then you can find some Youtube tutorial videos.

6. Is that possible to replace some components for example the rear fender?
A: Yes, please take a photo and send to Hiboy Support Team's email: support@hiboy.com, Hiboy Support Team will reply you soon.

7. My scooter is stolen, can you help me?
A: I'm sorry we can't track on the location or serial number of the scooter, please call the local policeman and ask them for help.

8. I have written several emails to support@hiboy.com, but no responses received, why?
A: Our Hiboy Support Team will reply to you within 1 working day, if you didn't receive any reply from us, please also kindly check your spam box, and add support@hiboy.com on your whitelist to make sure our reply is not blocked. In addition, you can also contact us on the platform where you purchased the scooter for example Amazon chat box, leave message on hiboy.com website, eBay chat box...etc.
- 24

9. When I press on the throttle, why the scooter is not moving?

A: Please note our scooter is set with a kick-off start function considering safety factors, which means you need to stand on the scooter, kick it off to reach a certain minimum speed 3.1 mph, then when you press down the throttle, the scooter will accelerate further, you can check about this kick-off start operation description in the user manual, too.

10 . Why the speed can't reach 19 mph?

A: Please make sure you have double clicked the power button to set the speed mode to Sport mode, because we have two speed modes, one is green S mode with max speed 13 mph, the other one is red S mode with max speed 19 mph.

11 . Why the max distance is lower than advertised max distance?

A: Please note the max distance is measured when it is no wind and at 77°F, the scooter's fully charged to ride at a even speed of 11.4 mph [18.4 km/h] on a at surface with a load of 165 pounds [75 kg]. The real battery life vary with different factors of the load , humidity , wind speed and operation habits...etc.

12 . Can I ride the scooter in the rainy days?

A: Kindly note the scooter waterproof level is IPX4, we don't suggest you to ride it in the rainy days.

13. Is there any caution for storing the scooter if I need to go out for a long time vacation?

A: Please make sure the scooter is stored in a dry & cool place, do not put it outdoors for long time, and if the scooter is expected to be left idle for more than 30 days, please fully charge the battery, keep in mind to recharge it every 60 days to protect the battery from potential damage which is beyond limited warranty.

Trouble shooting

| Error code | Error description | Solution |
|------------|--|--|
| E1 / F1 | Brake error | Need to replace the disc brake lever |
| E2 / F2 | Throttle error | Need to replace the throttle |
| E3 | There is problem for the communication between the top display and controller inside the frame | Need to replace the top display PCB and the display-controller connection cable |
| E4 | Over current protection, when E4 appears, both electronic brake and throttle will stop working | Normally the E4 will disappear automatically after cool down the scooter for a while, if the E4 continues to show up frequently, then need to replace the controller |
| E5 | Low voltage protection, when the battery voltage is lower than 30V, it will show up E5 | First charge the scooter and see if E5 disappears, if E5 doesn't disappear after charging, then need to replace the battery |
| E6 | Over voltage protection, when the battery voltage is higher than 46V, it will show up E6 | When E6 shows up, please do not brake suddendly or climb / go down slopes, just consume some power of the battery, then it will be back to the normal |
| E7 | Motor hall error | Need to check if the motor hall cables are connecting well first, if any cable is not connecting well, re-connect it and see if the E7 error disappears; After re-connecting the haul cables and E7 still exists, then need to replace the motor. |
| E8 | Motor phase error | Need to replace the motor. |
| E9 | Hardware error | Restart the scooter for several times and see if the E9 disappears, otherwise need to replace the controller |

16. Contact Us

Contact us if you experience issues relating to riding, maintenance and safety, or errors/faults with your Hiboy S2 SE

E-mail Service: support@hiboy.com



@Hiboy_Official



@Hiboy Official



@Hiboy



www.hiboy.com