

Paintable spotlight

INSTRUCTIONS

INCLUDED

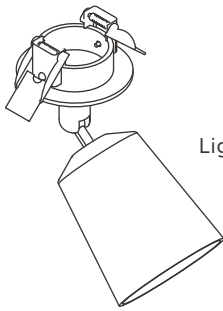

Light body x1

TOOLS YOU'LL NEED

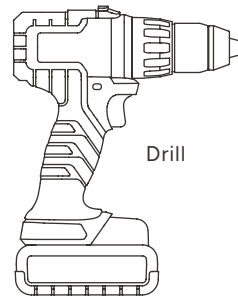

Drill

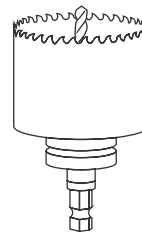

50mm hole saw

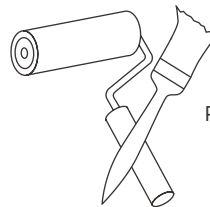

Painting equipment

Paintable spotlight instructions

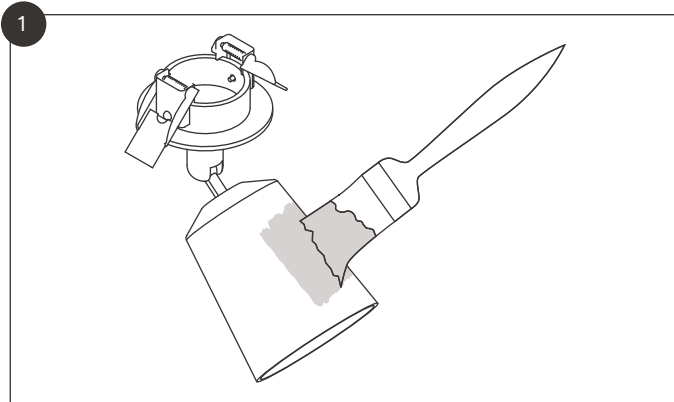

Paint the spotlight with any interior paint. Some emulsions may require two coats.

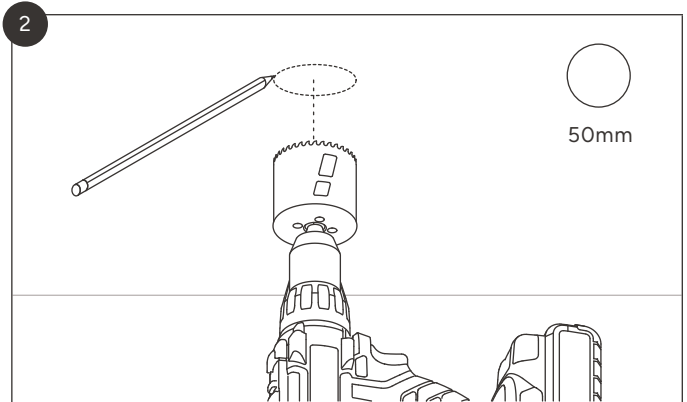

Drill a 50mm hole in the ceiling.

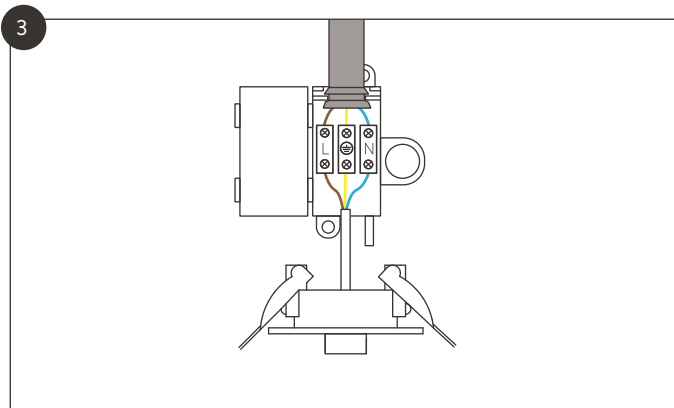

Make the connections from the supply to the light fitting in the terminal box provided.

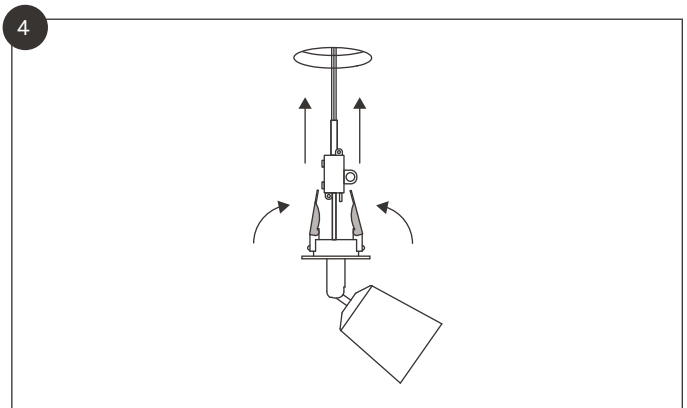

Fold the two spring clips in and push the connected light into the ceiling cavity.

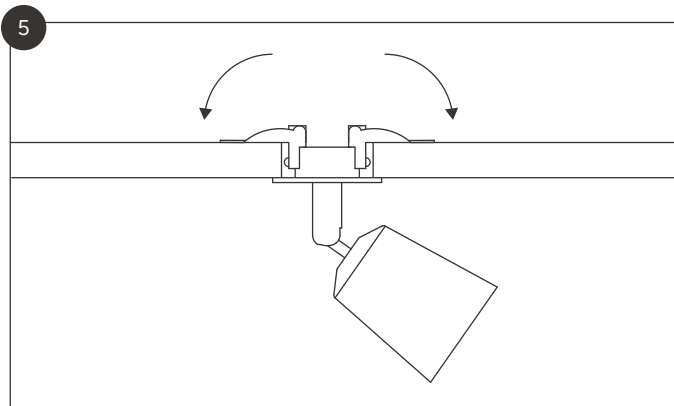

The spotlight should be pushed up into the ceiling until the springs fall into position.

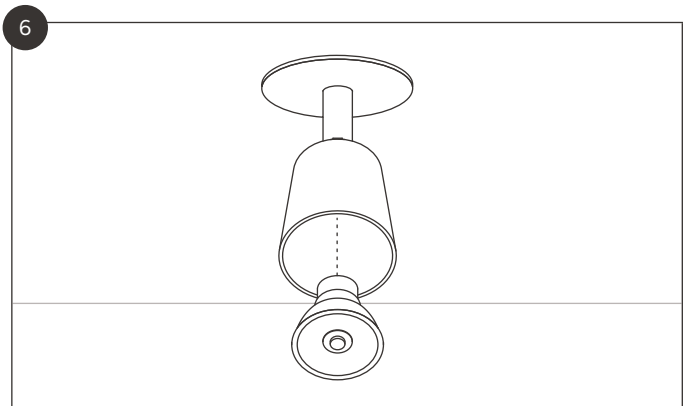

Fit the GU10 bulb.