

XKDUN

USER MANUAL



Xkdun-N2
Wireless Sport Earbuds

Customer Service

Email: support@xkdun.com



FCC ID : 2A4XTXKD-N2

Package Contents

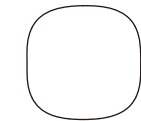

Charging Case * 1PC

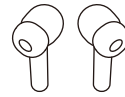

Earbuds * 1 Pair

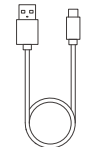

Type-C Charging
Cable* 1PC



Silicon Ear
Cushion *3 Size



User Manual * 1 PC

01

Product Overview

Multi-function
Button(MFB)

Earbuds LED Light

Built-in Mic

Built-in Mic

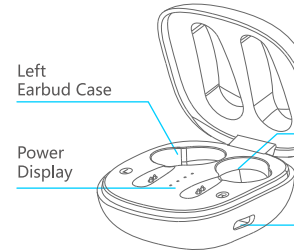

Left
Earbud Case

Power
Display

Right
Earbud Case

Type-C Port

02

First-time use

- Fully charge both earbuds and charging case when first-time use.
- Keep the charging port dry before charging.
- Use the provided Type-C charging cable, or upright the charging case on a wireless charger to get charge.

Warnings

- Keep away from liquids and extreme heat.
- Keep the earbuds out of children's reach.
- Do not throw and drop the earbuds to avoid damage.
- Do not disassemble the earbuds, or make any modifications to the structure or any part of it.
- Please charge with a rated voltage charger.
- Low Battery Remind :

The TWS chips with low battery remind while the battery life less than 3.2V (10-15% capacity), besides you will hear a tone prompt voice "dudu" every, it will auto power off while the battery life less than 3V.

03

Charging

a. Charging for TWS earbuds

put the earbuds into the charging case ,which will auto-charging for the earbuds

Battery life display:

When the tws earbuds connected with mobile phone, you can check the battery life from it.

Note: The TWS earbuds chips with low battery remind function, while the battery life of earbuds less than 3.2V (10%-15% of battery capacities) you will hear a voice--"low battery" form the tws earbuds , and it will auto-power off while the battery life less than 3V.

b. Charging for Charging case

When the charging case in Charging statu, 4 of LED light will light up in turn, they are respectively represent the current battery capacity, after fully charged, the LED light became constant (solid) blue.

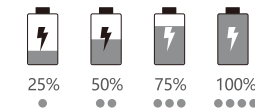

04

Power On/Off

Automatically Power On/Off

The earbuds will automatically power on when take it out of the charging case and Auto-power off when placed them back into the charging case.

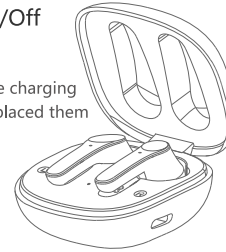

FCC Compliance Notice

This device complies with part 15 of the FCC Rules. Operation is subject to the following two conditions:

- (1) This device may not cause harmful interference, and
- (2) This device must accept any interference received, including interference that may cause undesired operation.

Any changes or modifications not expressly approved by the party responsible for compliance could void the user's authority to operate the equipment.

05

This equipment has been tested and found to comply with the limits for a Class B digital device, pursuant to part 15 of the FCC Rules. These limits are designed to provide reasonable protection against harmful interference in a residential installation. This equipment generates, uses and can radiate radio frequency energy and, if not installed and used in accordance with the instructions, may cause harmful interference to radio communications. However, there is no guarantee that interference will not occur in a particular installation. If this equipment does cause harmful interference to radio or television reception, which can be determined by turning the equipment off and on, the user is encouraged to try to correct the interference by one or more of the following measures:

- Reorient or relocate the receiving antenna.
 - Increase the separation between the equipment and receiver.
 - Connect the equipment into an outlet on a circuit different from that to which the receiver is connected.
 - Consult the dealer or an experienced radio/TV technician for help.
- FCC Radiation Exposure Statement
This equipment complies with FCC radiation exposure limits set forth for an uncontrolled environment .
This transmitter must not be co-located or operating in conjunction with any other antenna or transmitter.

06

Bluetooth Connection

1. Open the lid of the Charging Case, and take two earbuds out of Charging case, both earbuds will automatically power on and enter pairing mode.

(There is blue light flashes for 1 sec; then master earbuds fast flash Blue and red light and slave earbuds Flash blue light,.)



2. Activate the Bluetooth setting on your phone, search and connect "Xkdun-N2". (You will hear a prompt "du" and the Blue light will turn off, which means they paired successfully.)



07

Single Mode

- When on dual mode, put one earbud into the charging case.
- Only take one earbud out of the charging case and connect it.

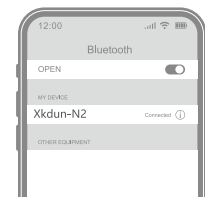

Other Instructions

- Each time you use your earbuds, it will automatically connect to your last successfully connected device.
- The earbuds will automatically power off if without any connections within 5 mins.

08

Factory Restore Setting

When should I reset?

When only one side plays music.

When you can't use the two earbuds together.

When both earbuds fail to pair with each other or occur connection related issues.

How to reset?

1. Delete the paired device name "Xkdun-N2" from the Bluetooth menu on your phone and put two earbuds back into the charging case.
2. Take out both earbuds, make sure it is not paired with any device.
3. Both earbuds will power on and auto-connect with each other, then enter into the Bluetooth pairing mode again.
4. Now open the Bluetooth on your device and select the device name "Xkdun-N2" make them pair with your phone or other enable device and connect it.

09

Multi-function Operations

Music Mode



Play/Pause

Quick-press Earbud(L/R) once



Next Track

Quick-press Earbud(L/R) twice



Previous Track

Quick-press Earbud(R) twice



Volume Up

Quick press Earbud(L) Thrice



Volume down

Quick Press Earbud(R) Thrice

10

Incoming Call



Answer/
End a call

Quick-press Earbud(L/R) once



Reject a call

Hold the Earbud(L/R) for 2 sec



Wake up Siri

Quick-press Earbud(L/R) 4 times

Voice Assistant

Activate Siri or other voice assistant:

Quick Press Either L or R Earbud Four Times

11

Specifications

Earbud (each)

Model Name: Xkdun-N2

Bluetooth Version: V 5.1+EDR

Bluetooth Range: 10m/33ft (without obstacles)

Technology: HSP/HFP/A2DP/AVRCP

Frequency Range: 20HZ-20KHZ

Earbud Weight: 3.9g

Charging Time: 1 hour

Battery Capacity: 40mAh

Play time: appr.6 hrs (varies from volume level and song types)

Charging Case

Weight: 35.2g

Size: 56*56*31 mm

Charging Time: 2hrs

Batter Capacity: 350mAh

12

FAQ

Q1: Why does one earbud consume so much power than the other earphone?

A1: The main earbud is the intermediary between the accessory ear and the mobile phone. It is normal that the power consumption is greater than that of the accessory ear.

Q2: Why does the TWS earbuds turn off automatically ?

A2: If the earbuds not connected to any device within 5 minutes, it will automatically enter the shutdown state.

Q3: How compatible is the headset?

A3: iOS : iPhone13/12/11/iPad/Mac book/iPhone8/7/6 etc...

Android phones /Notebook / Laptop

Window phones / Notebook / Laptop

Q4: How to contact XKDUN Customer service?

A4: Email: support@xkdun.com

Web: www.xkdun.com

13