

# Using the DWC-INTCAM02 Door Station IP Camera with DW Spectrum Mobile App



## DOORBELL PUSH NOTIFICATION – SPECTRUM (CAMERA RULES)

| Event   | Action  |
|---|---|
| <b>When:</b> Input Signal on Device<br><b>Av:</b> 2. DWC-INTCAM02<br><b>Input ID:</b> <automatic> | <b>Do:</b> Send mobile notification<br><b>Interval of action:</b> Instant<br><b>To:</b> brandark@digital-watchdog.com<br><b>Custom notification content:</b><br><b>Header:</b> Doorbell<br><b>Body:</b> someone at the front door of DW<br><input checked="" type="checkbox"/> Add source device name in body |

### WHEN

- Input signal detected at <INTCAM> (Input ID: automatic or Input 2).

### ACTION

- Send a mobile notification instantly or at a user-defined interval.
- Allow custom notification content:
  - Add a header.
  - Include the source device name in the body (optional).

## DOORBELL PUSH NOTIFICATION – SPECTRUM MOBILE

**IMPORTANT NOTES:** Ensure Spectrum notifications are enabled in both your phone's system settings and the mobile app.

- Notification Test:** Create an event by pressing the doorbell button.
- Playback Verification:** Confirm the event is received and playback is accessible for review.

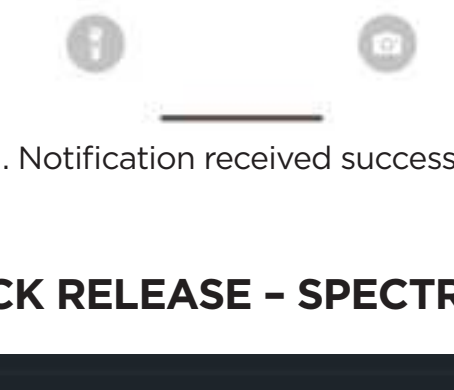

1. Notification received successfully.

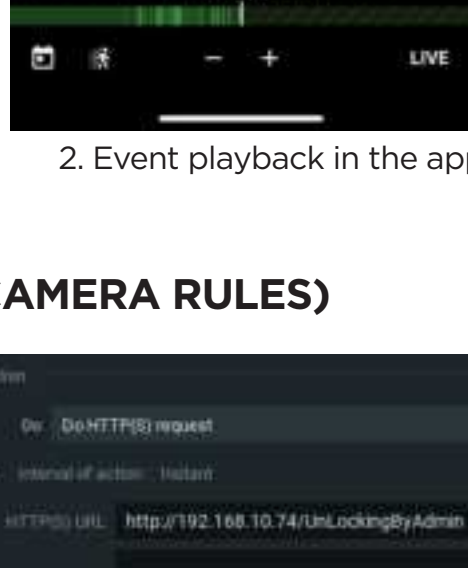

2. Event playback in the app.

## DOOR LOCK RELEASE – SPECTRUM (CAMERA RULES)

| Event   | Action   |
|---|--|
| <b>When:</b> Soft Trigger<br><b>Av:</b> 2. DWC-INTCAM02 (192.168.16.108)<br><b>Available to:</b> All Users<br><b>Name:</b> Door Open<br><b>Icon:</b> [Door Open Icon] | <b>Do:</b> Do HTTP(S) request<br><b>Interval of action:</b> Instant<br><b>HTTP(S) URL:</b> http://192.168.10.74/UnlockingByAdmin<br><b>HTTP(S) Content:</b><br><b>Content Type:</b> Auto<br><b>Login:</b> admin<br><b>Authentication Type:</b> Auto<br><b>Password:</b> *****<br><b>Request Method:</b> Auto |

### WHEN

- Trigger:** Soft Trigger at <INTCAM>.
- Availability:** Assign to all users or specific users (customizable).
- Customization:** Name the trigger and select an icon.

### ACTION

- Send an HTTP(S) request instantly or at a user-defined interval.
- Request Details:**
  - URL: http://<INTCAM IP Address>/UnLockingByAdmin
  - Content Type: Auto
  - Authentication: Use INT camera credentials (auto-detected for type and request method).

## DOORBELL LOCK RELEASE (SPECTRUM MOBILE)

### STEPS:

- Open the INTCAM live view in the Spectrum Mobile app.
- Locate the soft trigger icon in the bottom right corner.
- Press the icon to unlock the door.

### OUTCOME INDICATORS:

Success: Green check mark

Failure: Red X



Success

Fail

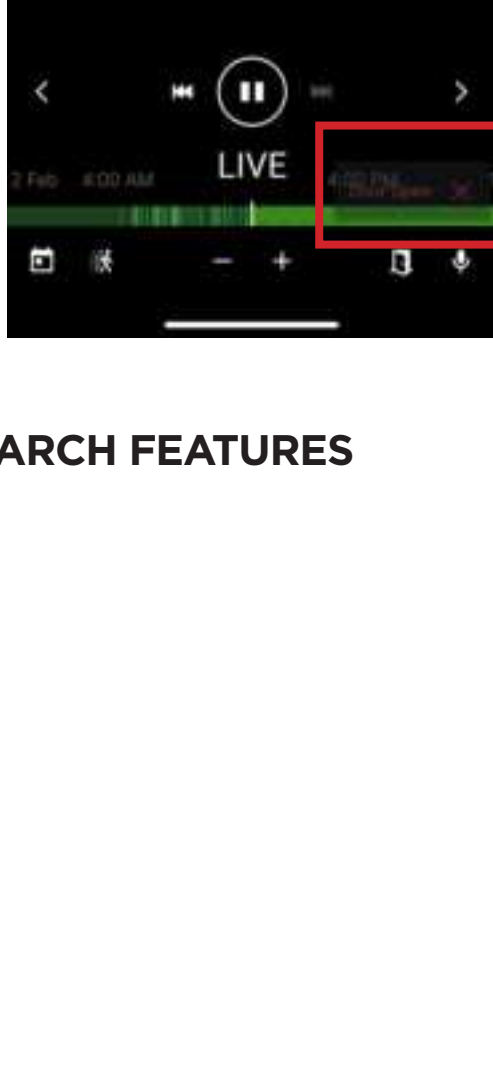
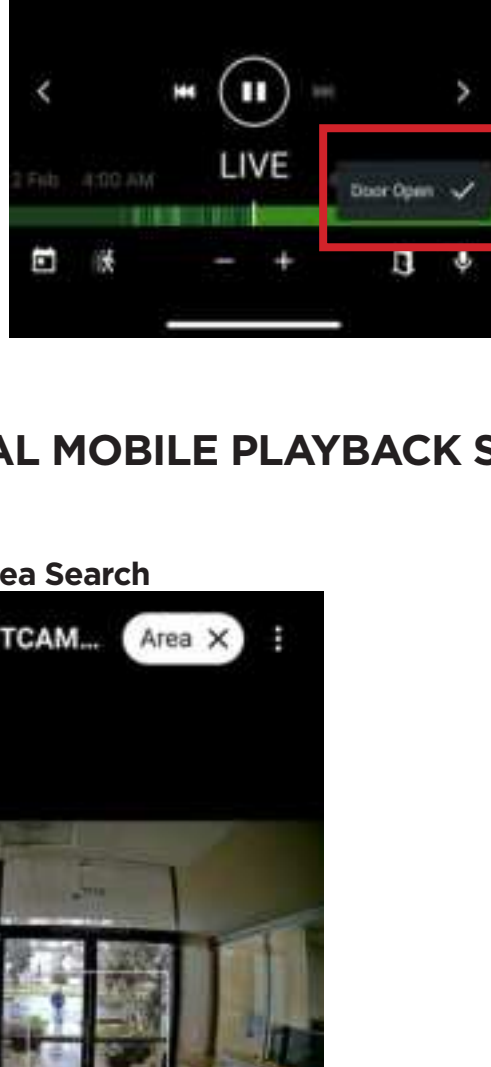

## ADDITIONAL MOBILE PLAYBACK SEARCH FEATURES



### Motion Area Search

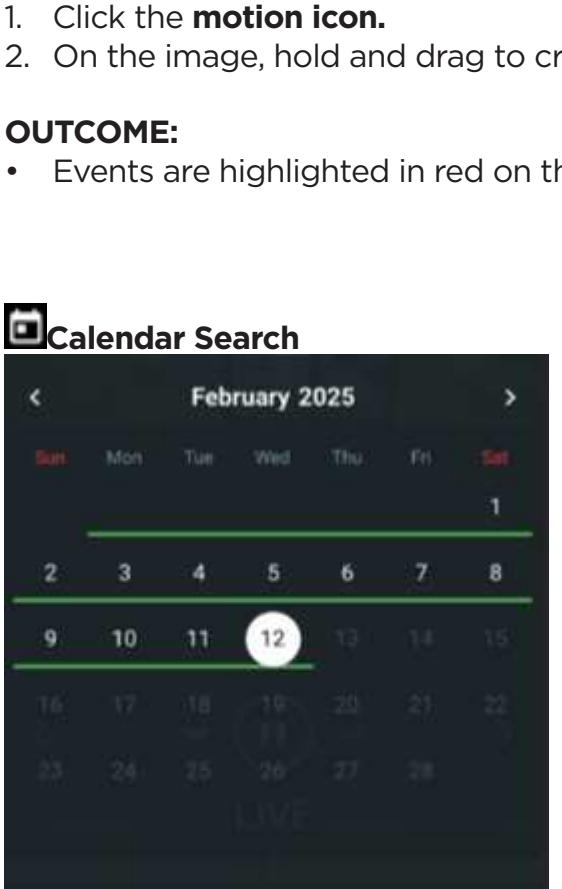

### STEPS:

- Click the **motion icon**.
- On the image, hold and drag to create a box over the **Region of Interest (ROI)**.

### OUTCOME:

- Events are highlighted in red on the timeline.



### Calendar Search

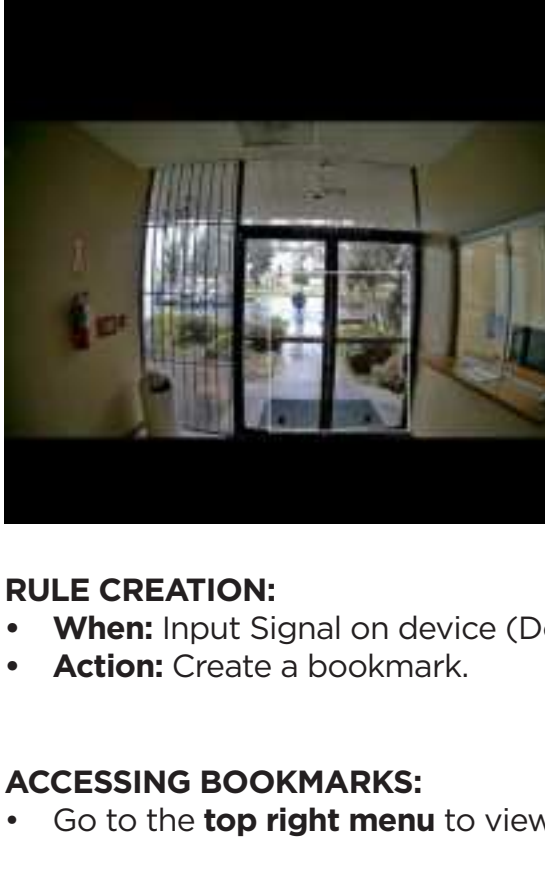

### STEPS:

- Select a date using the calendar (month, day, and year).

### INDICATOR:

- Days with archived recordings are highlighted in green.

## Bookmarks

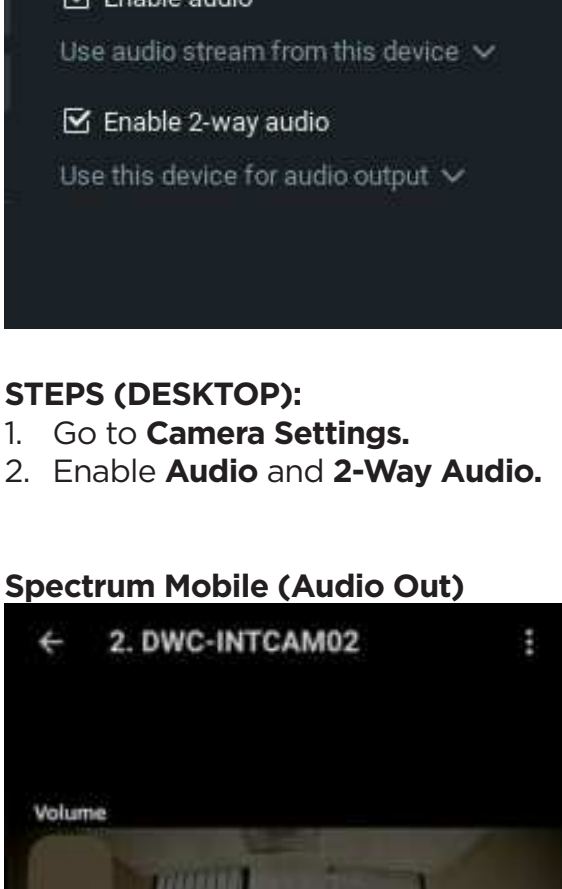

### RULE CREATION:

- When:** Input Signal on device (Doorbell) button press.
- Action:** Create a bookmark.

### ACCESSING BOOKMARKS:

- Go to the **top right menu** to view bookmarks.

## 2-WAY AUDIO

### DW Spectrum Server

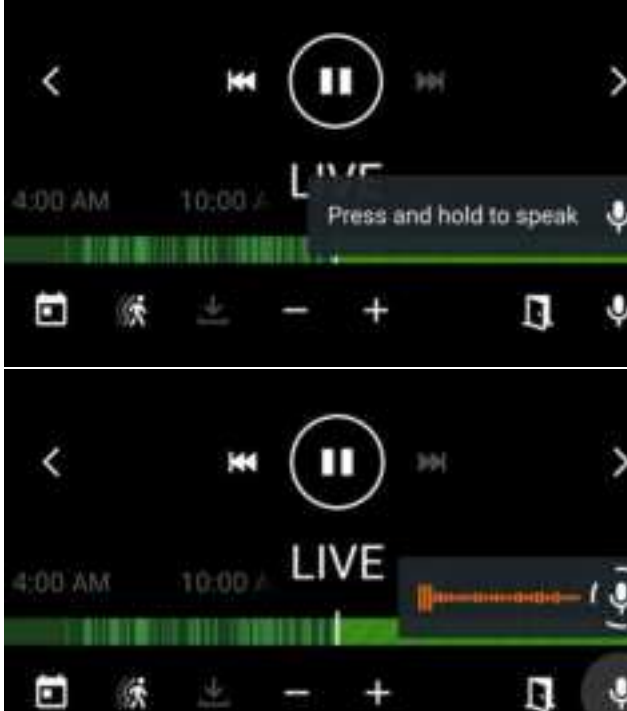

### STEPS (DESKTOP):

- Go to **Camera Settings**.
- Enable **Audio** and **2-Way Audio**.

### Spectrum Mobile (Audio Out)

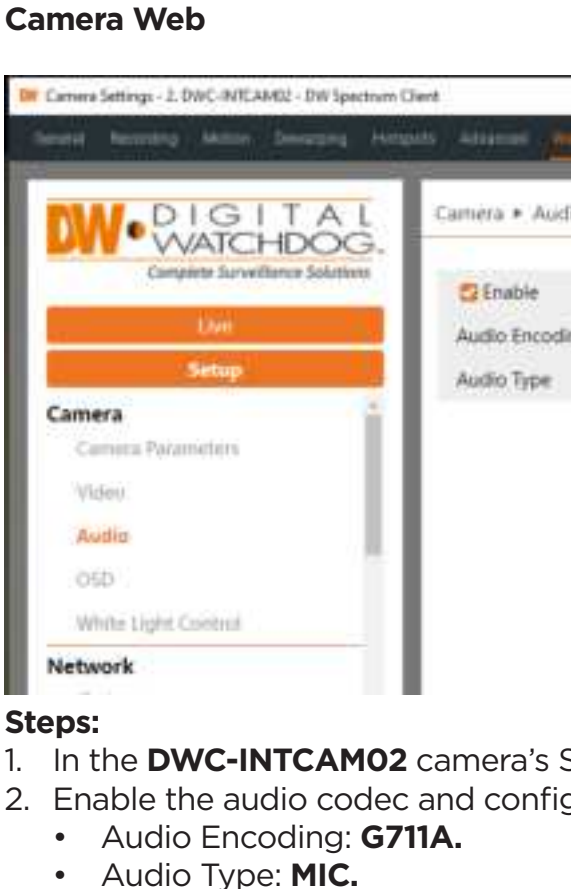

### STEPS (AFTER ENABLING AUDIO):

- Open the **INTCAM** live view.
- Adjust the volume to listen through the camera's built-in microphone.

### Spectrum Mobile (Audio In)

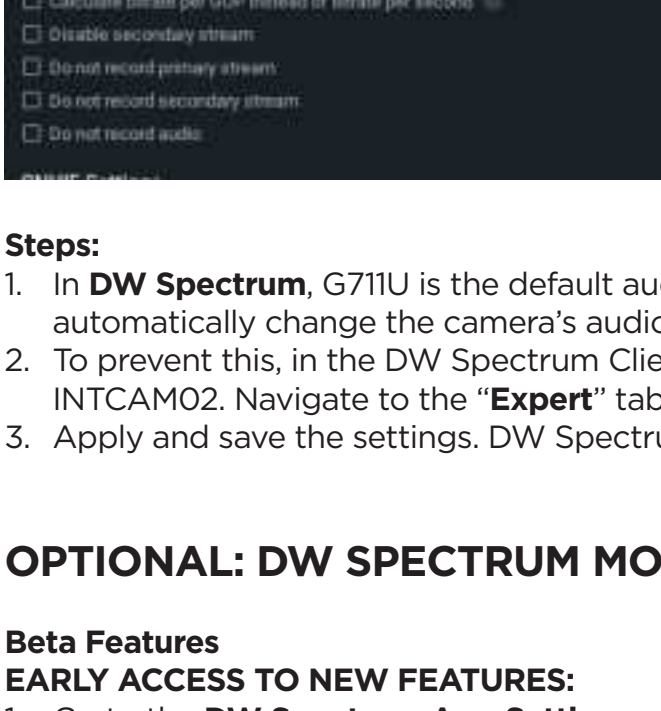

OFF

ON

### STEPS:

- In the bottom right corner, **press and hold the microphone icon**.
- The mic will activate, and audio will play through the camera's built-in speaker.

## AUDIO SETTINGS FOR 2-WAY AUDIO

### Camera Web

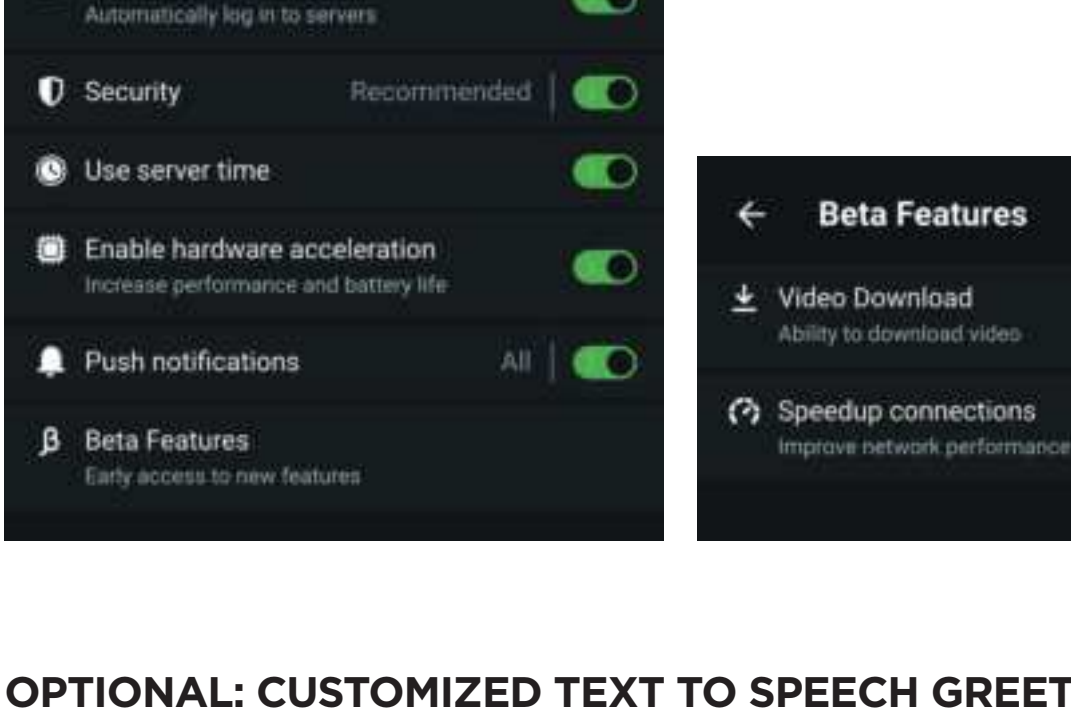

### Steps:

- In the **DWC-INTCAM02** camera's Setup Menu, select the "Audio" tab.
- Enable the audio codec and configure the following:
  - Audio Encoding: **G711A**.
  - Audio Type: **MIC**.

### DW Spectrum Server

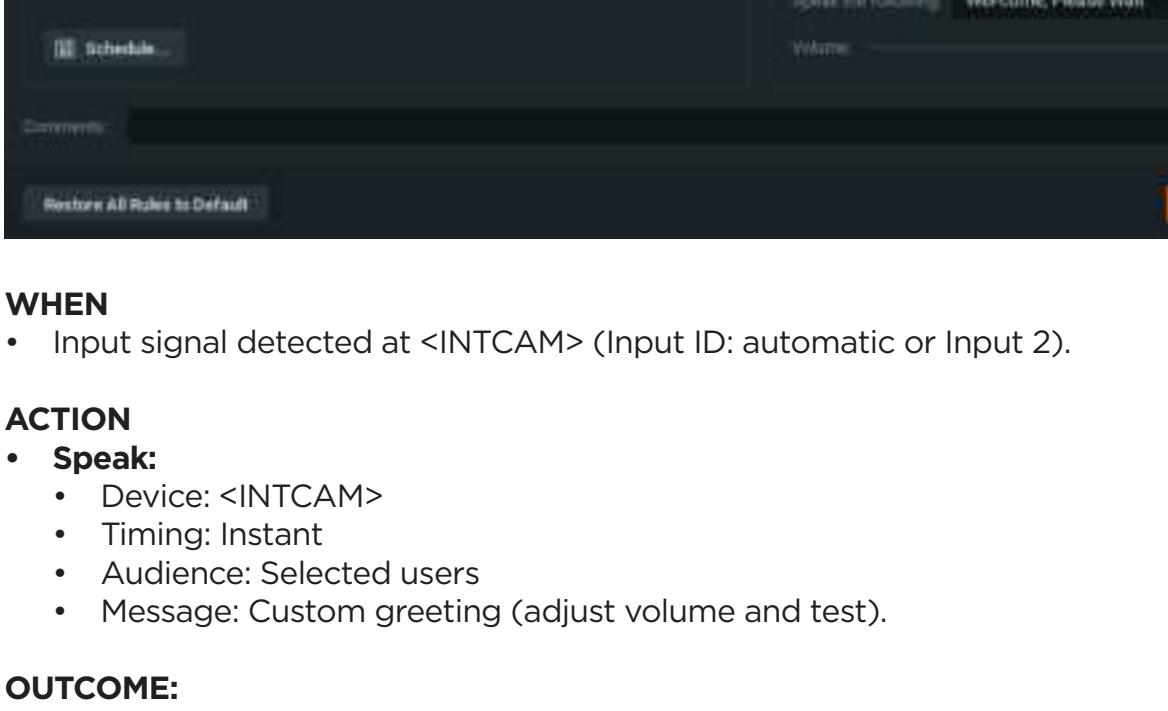

### Steps:

- In **DW Spectrum**, G711U is the default audio codec and DW Spectrum will attempt to automatically change the camera's audio/video codec to its default value.
- To prevent this, in the DW Spectrum Client, open the Camera Settings menu for the DWC-INTCAM02. Navigate to the "Expert" tab and enable "Keep camera stream and profile settings."
- Apply and save the settings. DW Spectrum will keep the camera's G711A audio codec settings.

## OPTIONAL: DW SPECTRUM MOBILE - Special feature

### Beta Features

#### EARLY ACCESS TO NEW FEATURES:

- Go to the **DW Spectrum App Settings**.
- Scroll to **BETA Features** and enable **Video Download**.
- Relaunch the app.

### OUTCOME:

- The user can now save videos directly to their phone.

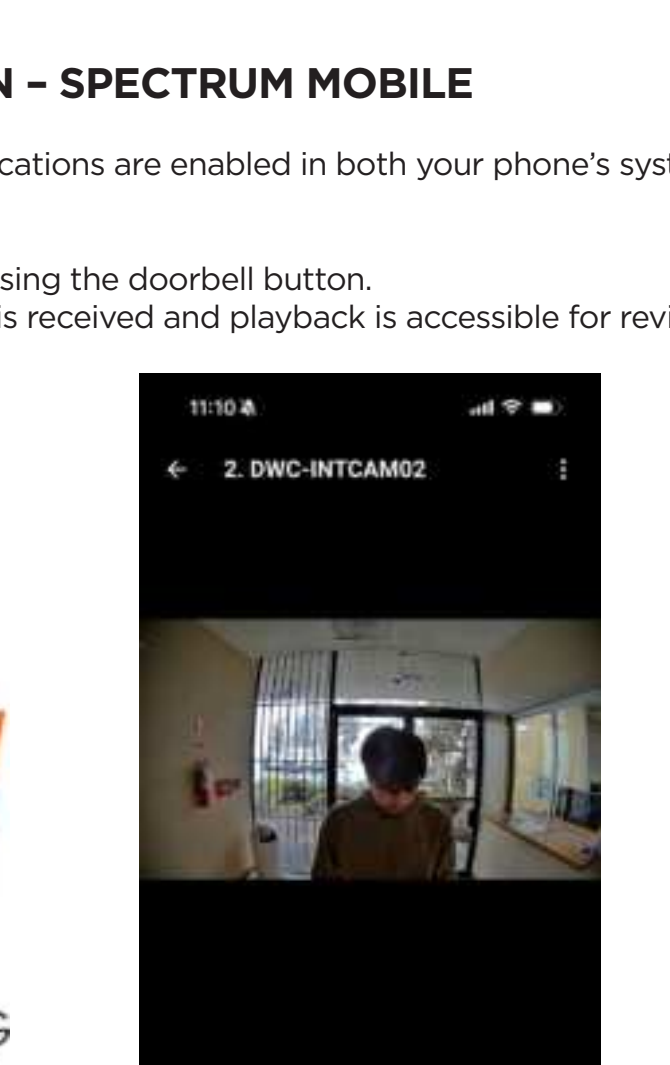
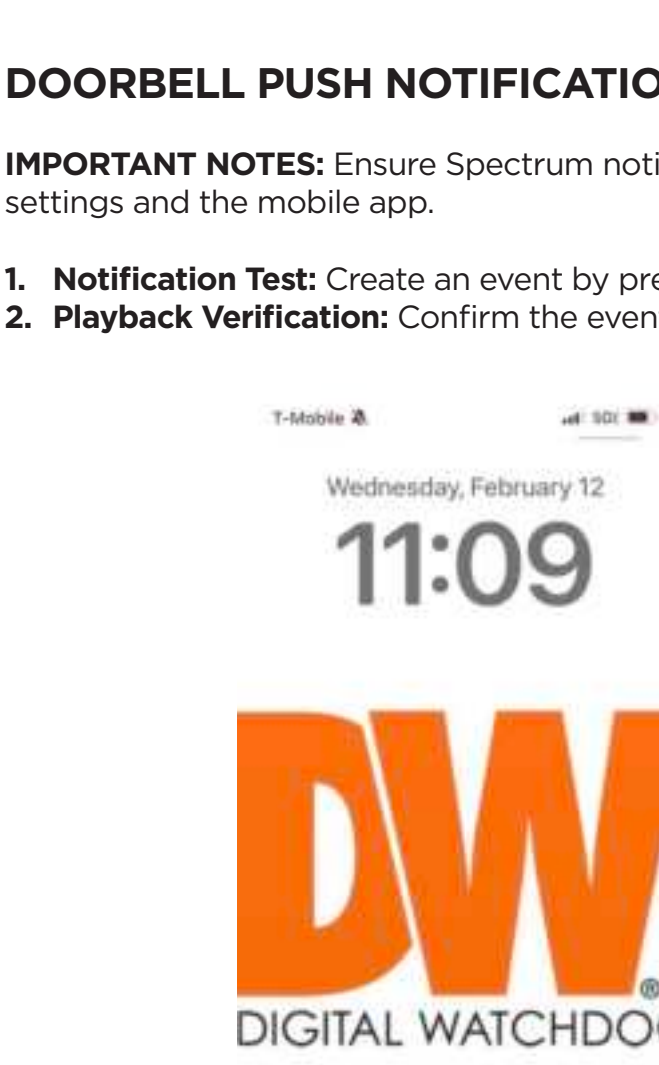

## OPTIONAL: CUSTOMIZED TEXT TO SPEECH GREETING – SPECTRUM (CAMERA RULES)

| Event   | Action   |
|---|--|
| <b>When:</b> Input Signal on Device<br><b>Av:</b> 2. DWC-INTCAM02<br><b>Input ID:</b> <automatic> | <b>Do:</b> Speak<br><input type="checkbox"/> Also play on source camera<br><b>Interval of action:</b> Instant<br><input checked="" type="checkbox"/> Speak to users: Administrators, Power Users<br><b>Speak the following:</b> Welcome, Please Wait<br><b>Volume:</b> [Volume Slider] |

### WHEN

- Input signal detected at <INTCAM> (Input ID: automatic or Input 2).

### ACTION

- Speak:**
  - Device: <INTCAM>
  - Timing: Instant
  - Audience: Selected users
  - Message: Custom greeting (adjust volume and test).

### OUTCOME:

- When the doorbell is pressed, the custom greeting will play.