

SLIMLINE FULL BODY MASSAGE CHAIR

KAMGCHRBRWA & KAMGCHRGRYA

SAFETY & WARNINGS

IMPORTANT SAFETY INSTRUCTIONS

This massage chair is intended for household only. When using an electrical appliance, basic precautions should always be followed, including the following: Read all instructions before using this massage chair. Retain this user guide for future reference.

DANGER – To reduce the risk of electric shock:

1. Always unplug this appliance from the electrical outlet immediately after using and before cleaning.
2. Never use pins or other metallic fasteners with this appliance.
3. Carefully examine the covering before each use. Discard the appliance if the covering shows any sign of deterioration, such as checking, blistering or cracking.
4. Keep Dry - Do not operate in a wet or moist condition.

WARNING – To reduce the risk of burns, fire, electric shock or injury to persons:

1. An appliance should never be left unattended when plugged in. Unplug from outlet when not in use and before putting on or taking off parts.
2. Do not operate under blanket or pillow. Excessive heating can occur and cause fire, electric shock or injury to persons.
3. This appliance is not intended for used by persons (including children) with reduced physical, sensory or mental capabilities, or lack of experience and knowledge, unless they have been given supervision or instruction concerning use of the appliances by a person responsible for their safety.
4. Keep children away from extended foot support.
5. Use this appliance only for its intended use as described in this manual. Do not use attachments not recommended by the manufacturer.
6. Never operate this appliance if it has a damaged cord or plug, if it is not working properly, if it has been dropped or damaged or dropped into water.
Return the appliance to a service centre for examination and repair.
7. Do not carry this appliance by supply cord or use cord as a handle.
8. Keep the cord away from heated surfaces.
9. Never operate the appliance with the air openings blocked. Keep the air openings free of lint, hair and the like.
10. Never drop or insert any object into any opening.
11. Do not use outdoors.
12. Do not operate where aerosol (spray) products are being used or where oxygen is being administered.

13. To disconnect, turn all controls to the off position, then remove plug from outlet.
14. Temperatures sufficiently high to cause burns may occur regardless of the control setting. Do not use on insensitive skin or on a person with poor blood circulation. Check the skin in contact with the heated area of the appliance frequently to reduce the risk of blistering.
15. Do Not Crush - Avoid sharp folds.
16. Do not use massager in close proximity to loose clothing or jewellery.
17. Keep long hair away from massager while in use.
18. Connect this appliance to a properly grounded outlet only. See Grounding Instructions.
19. The apparatus shall not be exposed to dripping or splashing and that no objects filled with liquids, such as vases, shall be placed on the apparatus.
20. An apparatus with CLASS I construction shall be connected to a MAINS socket outlet with a protective earthing connection
21. The appliance coupler is used as the disconnect device, the disconnect device shall remain readily operatable.
22. If it is not in use for a long time or after use, please turn off the power and pull out the power plug.
23. Do not damage, break, over-bend, compress, tighten, wind, rotate or knot the power cord.
24. This appliance can be used by children aged from 8 years and above and persons with reduced physical, sensory or mental capabilities or lack of experience and knowledge if they have been given supervision or instruction concerning use of the appliance in a safe way and understand the hazards involved. Children shall not play with the appliance. Cleaning and user maintenance shall not be made by children without supervision.

Keep these instructions.

This massage chair is intended for household use only.

Usage Environment:

- Do not use the massage chair in an excessively humid or dusty environment as this may result in malfunction or electric shock.
- Do not use the massage chair in a room with a temperature of 40°C (104°F) or higher.
- Do not expose the massage chair to heaters, stoves or direct sunlight.
- Place and use the massage chair on an even, non-slip floor.
- The massage chair is designed for home use and not for commercial purposes.

CAUTION:

- The massage chair is to be used indoors only.
- If you use the massage chair in a cold room, do not increase the room temperature abruptly. It is recommended that you increase the temperature gradually to a normal level.

Safety Precautions:

- To ensure safe and correct use of the massage chair, do not operate it without reading this user guide carefully.
- Do not use the massage chair when the upholstery or seat is removed. This may cause injury or malfunction.
- Do not use the massage chair in combination with other therapeutic equipment or electric blanket, etc., as this may result in ineffectiveness or injury.
- Do not use the massage chair an hour before or after eating as this may have adverse effects on the user.
- Do not allow children or pets to play around the massage chair, e.g., behind the backrest, under the seat or leg rest of the massage chair. This may result in injury.
- Do not rest or place heavy objects on the armrests, leg rest or backrest as this may result in malfunction or injury.
- Do not use the massage chair when your body is wet.
- Do not operate the massage chair with wet hands.
- It is not recommended to use the massage for more than 15 minutes.
- Do not perform continuous massage on the same spot of your body for more than 5 minutes at a time as this may result in excessive stimulation and may have adverse effects.
- Do not insert your hand or foot along the paths of the massage rollers during use as this may cause injury.
- Stop operation immediately if you experience any discomfort.
- This product is not intended for self-treatment of conditions that should be managed by a qualified health care provider.
- People on medication or with medical conditions, please consult your doctor before use.
- Please do not use the product if you are not feeling well.
- Remove all scarves, neckties, necklaces and jewellery before using the massager.

People with Medical Conditions

Consult your doctor before use if you:

- are under medical rest as ordered by a doctor
- have spinal disorders, an abnormal spinal condition or have suffered a spinal injury
- have back problems
- have diabetes, osteoporosis or sensory impairment
- have joint dysfunction
- have a pacemaker or other electronic medical devices
- may be pregnant
- have phlebitis or thrombosis
- have an increased risk for blood clots
- had recent surgery
- have surgical pins, screws or anything mechanical implanted in your body

Instances When the Massage Chair Should Not Be Used

In the following events, please switch off the main power switch immediately and disconnect the power cord from the electrical outlet:

- If water is accidentally spilled onto the massage chair. This may result in electric shock or malfunction.
- If the fabric of the backrest is torn and the internal components are exposed.
- If pain or discomfort is felt during massage, stop operation immediately and consult your doctor.
- If you detect any malfunction or any other abnormal condition during operation.
- If there is a power failure. Injury may occur when power is restored unexpectedly.
- If there is lightning.

Assembly and Repair of the Massage Chair

- Do not disassemble the backrest cover of the massage chair. Touching the internal components may result in malfunction or electric shock.
- The massage chair must only be professionally serviced or repaired. Do not attempt to disassemble or repair the massage chair yourself.

Things to Note About the Power Plug and Cord

- Check that the Alternating Current (AC) voltage corresponds with the specifications indicated for the massage chair.
- Do not connect or disconnect the power plug from the electrical outlet with wet hands. This may result in malfunction or electric shock.
- When disconnecting the power plug, pull it by holding the plug, not the cord.
- Although operation will be stopped automatically by the Auto-Timer function, always remember to switch off the main power switch after use.
- Do not place the power cord under the massage chair or any other heavy objects.
- Do not wind the power cord around the massage chair as this may damage the cord and result in a fire or electric shock.
- Do not operate the massage chair with a damaged cord or extension cord.
- Do not use the massage chair if the electrical outlet is loose.
- If the power cord is damaged, it should be replaced by a qualified technician.

Grounding Instructions

This product must be grounded. If it should malfunction or breakdown, grounding provides a path of least resistance for electric current to reduce the risk of electric shock. This product is equipped with a cord having an equipment-grounding conductor and a grounding plug. The plug must be plugged into an appropriate outlet that is properly installed and grounded in accordance with all local codes and ordinances.

DANGER – Improper connection of the equipment-grounding conductor can result in a risk of electric shock. Check with a qualified electrician or serviceman if you are in doubt as to whether the product is properly grounded. Do not modify the plug provided with the product – if it will not fit the outlet, have a proper outlet installed by a qualified electrician.

No adapter should be used with this product.

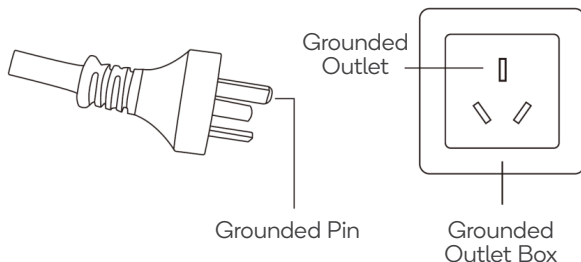

OVERVIEW

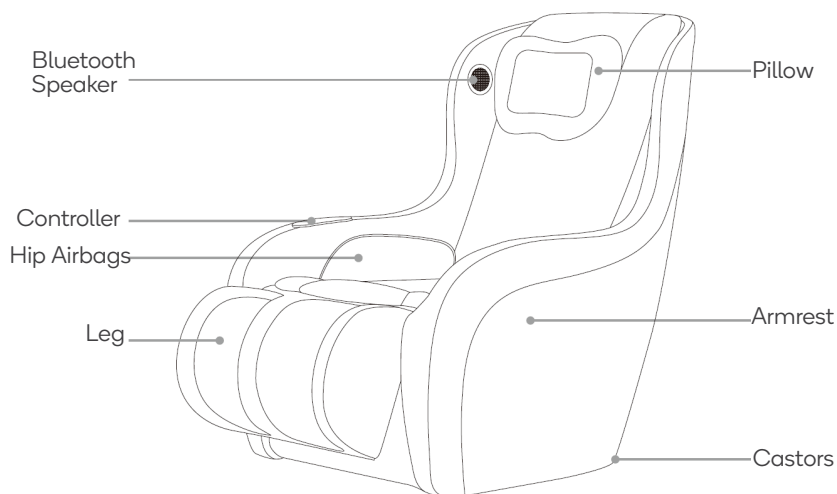

Controller

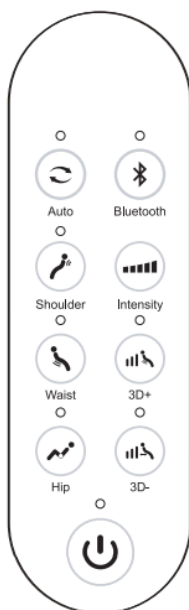

CAUTION:

- Do not sit, step or place heavy objects on the controller.
- Do not handle the controller with wet hands.
- Do not operate the controller by using sharp-edged or hard objects. It may result in damage.

CONTROLLER FUNCTIONS

Power button (⏻)

Turn on/off the massage chair. When power on, press **Power** ⏻ button, turn on massage chair, press **Power** ⏻ again to turn off.

Auto mode

Press **Auto** button enter auto modes. 3 optional auto modes:

3D mode (Red signal light)

Invigorating 3D massage to help stimulate the body & mind.

Anti-Stress mode (Blue signal light)

Helps de-stress the body & mind for better daily well-being

Senior mode (Purple signal light)

Gentle relaxation to help improve circulation and well-being

Shoulder roller button

Press **Shoulder** to start shoulder massage function, press again to finish it.

Waist roller button

Press **Waist** button to start waist massage function, press again to turn off.

Hip twist button

Press **Hip** to start hip airbags and then twist hip, press again to finish it.

Massage intensity adjustment

Press **Intensity** to adjust massage intensity. Optional 2 levels of intensity: high and low.

Increase 3D intensity

Press and hold **3D+** button to strengthen the 3D intensity until to the hardest. Or release the button when you get the expected intensity

Decrease 3D intensity

Press and hold **3D-** button to lighten the 3D intensity until to the softest. Or release the button when you get the expected intensity

INSTALLATION

Move the Chair

- Do not reposition the chair if it is switched on or plugged into an electrical outlet. Disconnect before moving.
- Tilt the chair backward as shown in the picture below and wheel it to the desired location.
- Please cover the floor with mat when move the massage chair in case of any damage of floor will be made.

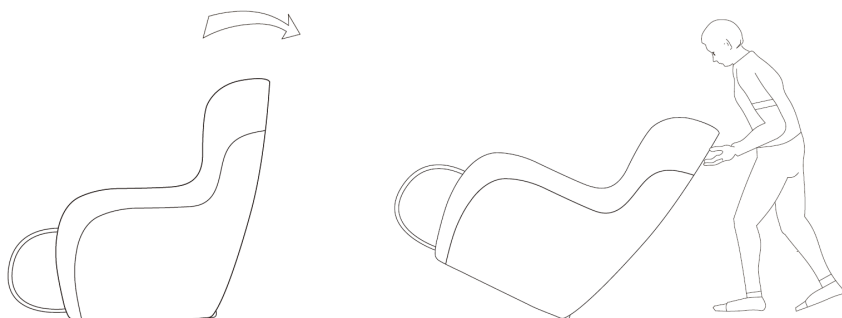

Pillow Installation

1. Connect the pillow and backrest power cord firmly.
2. Attach the pillow and backrest with Velcro.

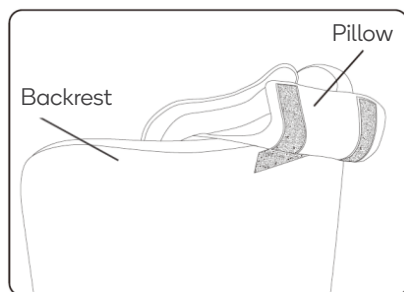
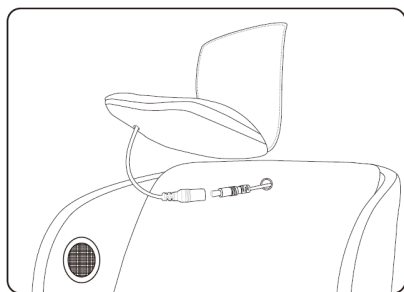

Connect power

- Plug the power cord into an electrical outlet and turn the outlet on.
- Turn on the power switch on at the back of the chair.
- To operate the chair via the controller, press the **Power**  button on the controller.

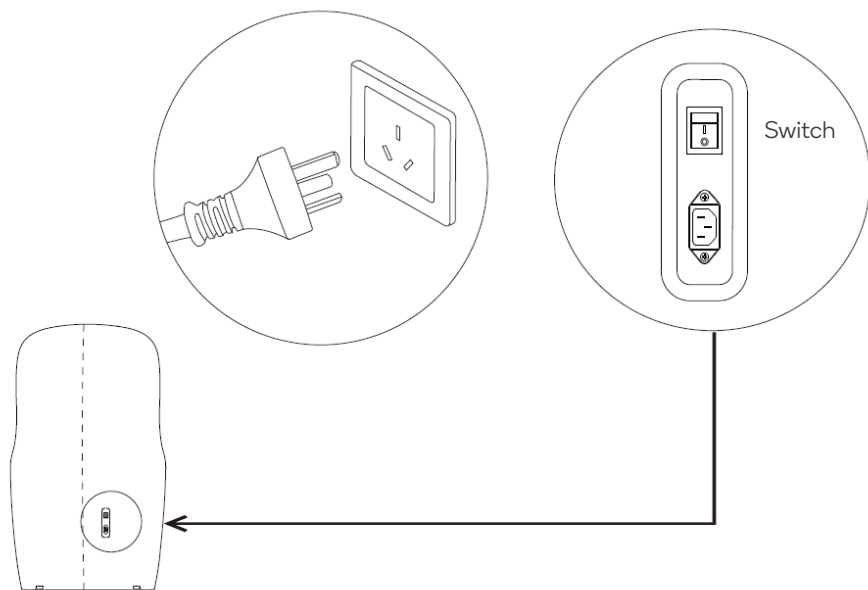

CONNECTING BLUETOOTH

Bluetooth pairing

Press the Bluetooth button on the controller to activate Bluetooth mode. When the light is on, the device is visible and able to be paired with

On your phone Bluetooth list, choose the model “R8525” to do the pairing, when a sound is heard, the connection is completed.

You will now be able to play audio from the Bluetooth speaker.

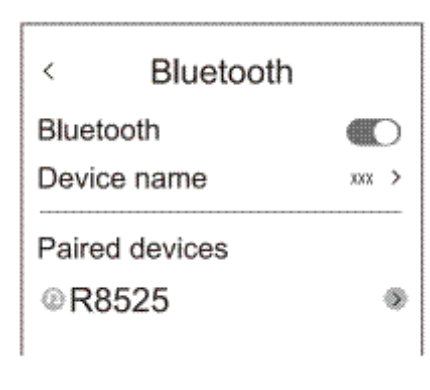

CLEANING & CARE

Maintenance methods

Please follow the below steps to clean leather and plastic parts:

- Please ensure the main switch is turn off and the power plug is unplugged from the electrical outlet.
- Dip a soft, dry cloth in water or warm water containing 3% to 5% neutral detergent and wring it thoroughly.
- Clean the leather and plastic parts.
- Then wipe with dry soft cloth.
- Let it dry naturally.

Warning

- Do not use alcohol, thinner, gasoline and other chemicals for cleaning.
- Do not dry the surface with a blower.
- Do not iron the fabric.
- During maintenance, always ensure the power plug is unplugged. Do not unplug it with wet hands.
- Please use a dust cover to avoid dust if you won't use the chair for a long time.
- As fabric colour may be dyed on the leather, be careful when using denim and colored cloth to wipe the product.
- Wipe the product with the melamine foam dipped in mild detergent, if the dirt is hard to remove.
- Do not let the leather touch plastic in case of the color fading.
- Water temperature should not exceed 40° C.



Do not use.



Water temperature
should not exceed
40° C



Do not iron

TROUBLESHOOTING

Issue	Possible Solution
The Massage Chair cannot operate, even though it has been connected to the power supply.	<ul style="list-style-type: none">• Check whether the plug is properly connected and not damaged• Check whether the switch on the Massage Chair is turned to position “I”
During operation, the controller is working but the Massage Chair is not.	<ul style="list-style-type: none">• The Massage Chair could be overheated after prolonged use. It will automatically cool down to resume its normal condition.• Please turn OFF the power and allow the chair to cool down for 30 to 50 minutes.

If there is still an abnormality after the following checks, to prevent any accident, stop using the massage chair immediately.

Unplug the power cord from the outlet and contact **help.kogan.com** for assistance.

SPECIFICATIONS

Rated Voltage	100-240V~ AC
Rated Frequency	50-60Hz
Rated Power	60W
Operating Time	Default 15 minutes
Upright position (approximate)	1090 x 670 x 990mm

Need more information?

We hope that this user guide has given you the assistance needed for a simple set-up. For the most up-to-date guide for your product, as well as any additional assistance you may require, head online to **help.kogan.com**

kogan.com