

When you set up a new account, you will be asked to fill in an identifying nickname. Next, type in your email address and tap send. You will be sent a verification code that must be entered within five minutes. Choose and enter a password, and retype it to verify. You can also set a photo but this is not required.

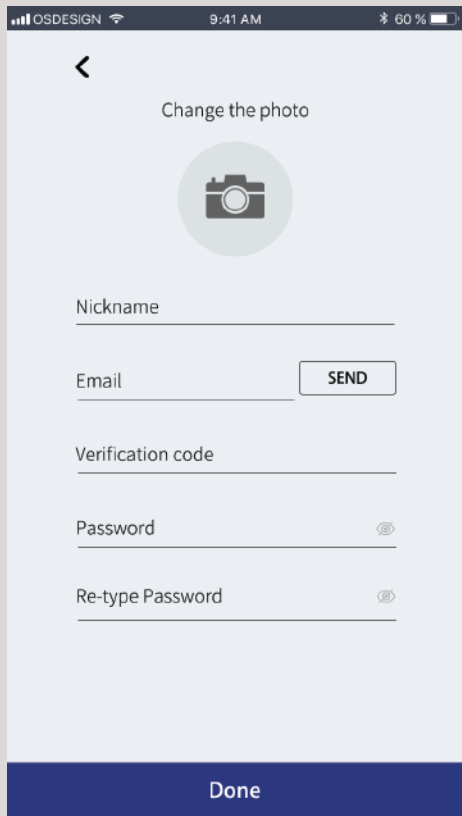

Once you've created your login, you'll need to pair your device. It will display this overlay:

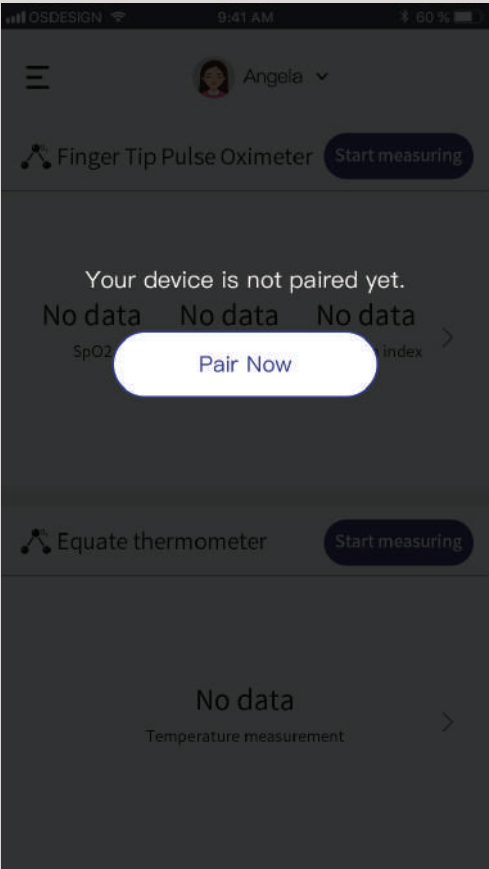

Tap "Pair Now"

The App will tell you to turn on your smartphone's Bluetooth®, press the measuring button to turn on device, When the App detects the thermometer,tap to checkmark the name and it will connect.



Tap "Next" and then verify by tapping "pairing."

Once you finished pairing,you can enter below page .press "Start measuring" button to measuring .you will now see the reading coming from your device.Check the Bluetooth icon to identify whether the Bluetooth connection is successful. If the Bluetooth display shows that it is not connected, press the power on button one more time. Sliding the test result to the left to delete a single record.



You can scroll through past measurements if needed.

Tap the Menu icon and tap on "Members." From this page you can manage your users and user info. You can add a new user by pressing "Add member ." If you tap on your nickname it will display your Personal Information, which can be adjusted if need be. The first user entered will be the Administrator by default.

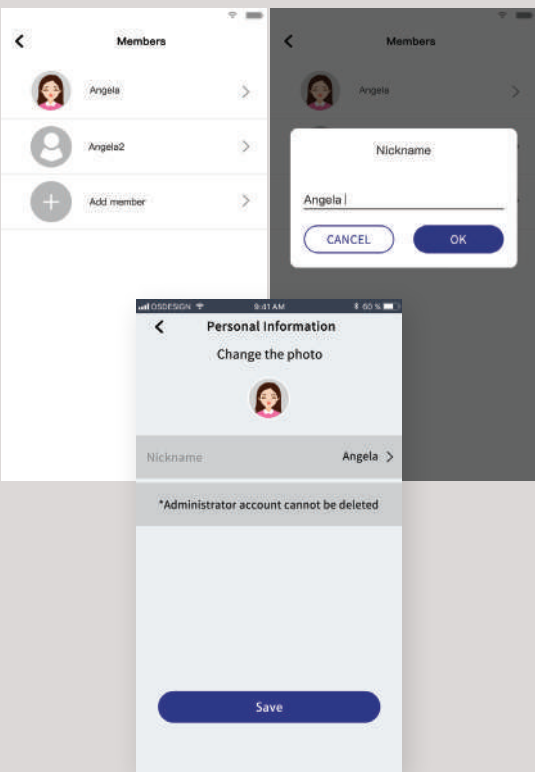

You can delete new added users, but not the first user.

From the Menu, tap "settings" so you can change the account password.You can also log out here, if you want to stop using the app.

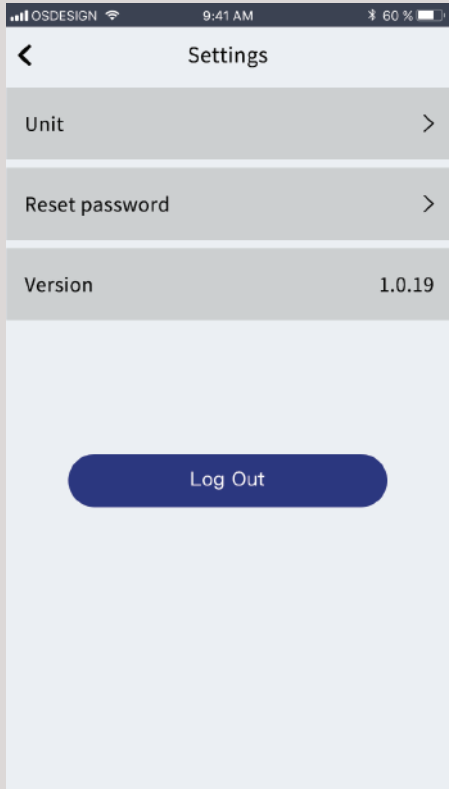

Only Administrator account show"Reset password" in this page

If you tap "Reset password," you will be shown the email password associated with the account. If this has changed, change it here. Tap "Send" next to where it says "Verification code." A six digit code will be sent to this email, and the countdown clock will start. Enter the code in the Verification code space, and you will see this:

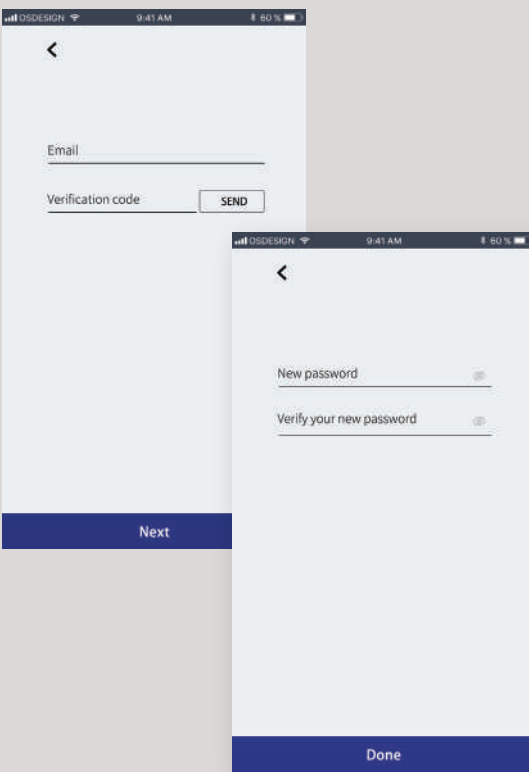

Tap "Done" when you have completed this form.

If the same user have buy two or more thermometer at the same time, and use one smartphone to connect,the user need unbind one thermometer first and then connect another one, Tap the menu,tap "Device management" and then tap "UNPAIR" to or pairing or unpair.

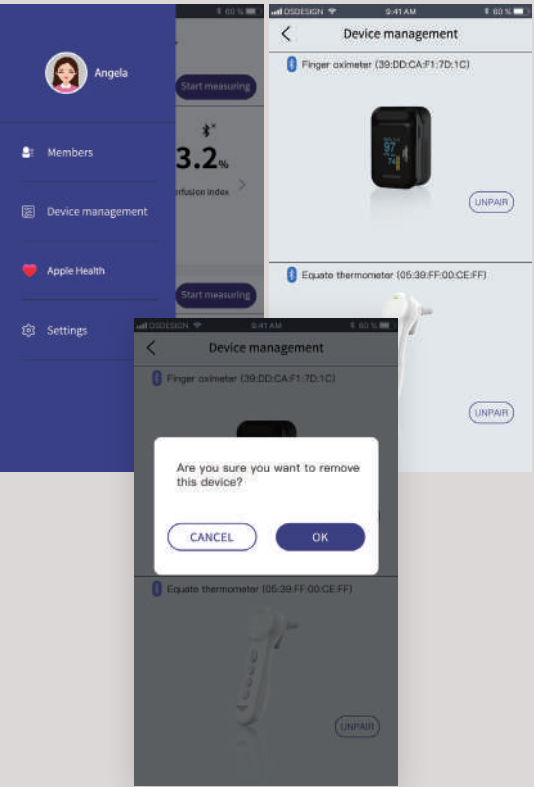

IOS Version can share data to Apple health.Press "Apple Health",and then press "OK" to share data. Android version can share data to Google fit,Press "Google fit",and then press "allow" to share data.

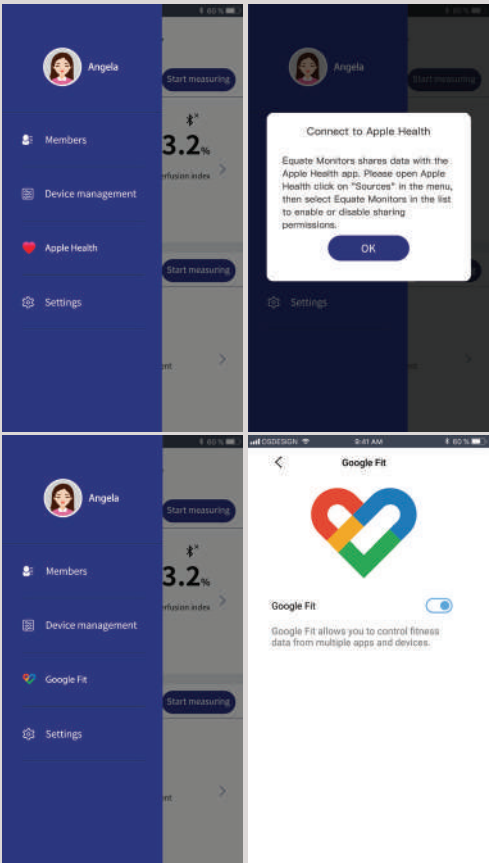

Troubleshooting:

IOS version precaution		
Problem	Possible Causes	Solution
The app cannot be used properly	1.The mobile system version is too low	Update the mobile phone to Apple iOS 12 and up.
	2.Not granting the APP permission to use wireless local area network and cellular network	Enable the APP to obtain the permission to use the wireless LAN and cellular network
Bluetooth cannot connect	1.No permission to obtain Bluetooth	Enable the APP to obtain the permission to use Bluetooth
	2. No Bluetooth enabled on phone	Turn on the mobile phone bluetooth
Measurement data cannot be shared with Apple Health	3. Mobile phones and devices are too far away	It is recommended that the distance between the mobile phone and the device be within 3 feet
	APP does not have access to Apple Health	Allow apps to access Apple Health

Android version precaution		
Problem	Possible Causes	Solution
The app cannot be used properly	1.The mobile system version is too low	1.Update the mobile phone to Android 10 and up.
	2.Access to the corresponding system permissions is not allowed, you need to obtain the corresponding system permissions.	2.Phone settings - Application management - Find the app and enable the corresponding permissions for it.
Bluetooth cannot connect	1.No permission to obtain Bluetooth	1.Phone settings - Application management - Find the app and give it permission to use Bluetooth
	2.No Bluetooth enabled on phone	2.Turn on the mobile phone bluetooth
Measurement data cannot be shared to Google fit	3.Mobile phones and devices are too far away	3.It is recommended to use the distance between the mobile phone and the device within 1m
	The function of sharing measurement data to Google fit is not enabled	Enable the function of measuring data sharing to Google fit on the APP

FCC info

These devices comply with Part 15 of the FCC Rules. Operation is subject to the following two conditions:(1)these devices may not cause harmful interference, and (2) these devices must accept any interference received, including interference that may cause undesired operation.

Note: This equipment has been tested and found to comply with the limits for a Class B digital device, pursuant to part 15 of the FCC Rules. These limits are designed to provide reasonable protection against harmful interference in a residential installation. This equipment generates, uses and can radiate radio frequency energy and, if not installed and used in accordance with the instructions, may cause harmful interference to radio or television reception, which can be Determined by turning the equipment off and on, the user is encouraged to try to correct the interference by one or more of the following measures:

- Reorient or relocate the receiving antenna.
- Increase the separation between the equipment and receiver.
- Connect the equipment into an outlet on a circuit different from that to which the receiver is connected.
- Consult the dealer or an experienced radio/TV technician for help.

Caution: Any changes or modifications not expressly approved could void the user's authority to operate the equipment.

FCC RF Radiation Exposure Statement:

1. This Transmitter must not be co-located or operating in conjunction with any other antenna or transmitter.
2. This equipment complies with RF radiation exposure limits set forth for an uncontrolled environment.
3. This equipment should be installed and operated with minimum distance 0mm between the radiator& your body.

equate™



Bluetooth®  
Dual-Function  
Infrared Thermometer

#### Accessories :

##### 1. Forehead mode Cap

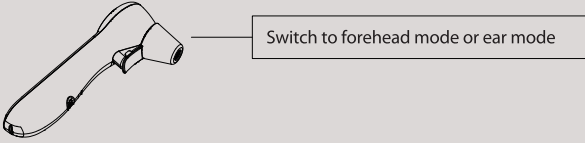

##### 2. Storage Case

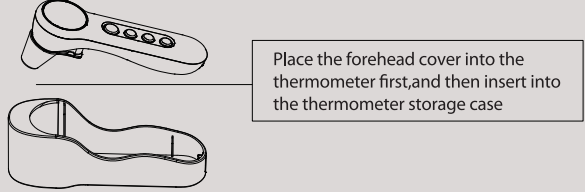

##### 3. Disposable Probe Cap

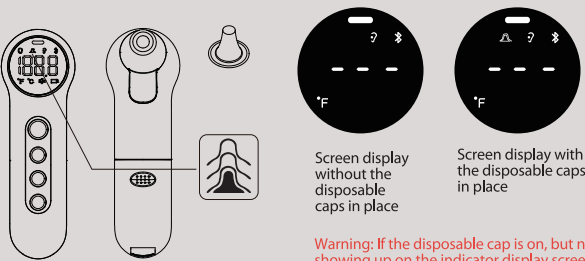

The thermometer can measure ear temperature with disposable caps or without disposable caps.  
\* To achieve accurate measurements, make sure a new and clean probe cap is in place, prior to each measurement

1

In order to use this product correctly, please read the manual carefully. The infrared thermometer can accurately and safely measure your ear temperature and forehead temperature. The infrared thermometer is safety designed without damaging the eardrum and hearing. Thank you for purchasing this product

#### Table of Contents

1. Precautions	3
2. Product Features	3
3. Body Temperature	4
4. Product Appearance	5
5. Screen Display	5
6. Measuring	6
7. Using and Cleaning the Memory	7
8. Power off	7
9. Mute Feature	7
10. High Temperature Alarm	7
11. Changing the temperature unit	8
12. Correct Measurement reading	8
13. Precautions For Use	9
14. Battery Replacement	9
15. Cleaning And Maintenance	10
16. Abnormal Information	10
17. Symbol Definitions	11
18. Using The App	12

2

#### 1. Precautions

- This product is a precision instrument, please be careful to avoid shocks and drops and cause product failure.
- Do not immerse the product in water.
- Keep this product out of reach of young children.
- If the product is not working properly, please stop using it and consult the dealer.
- Please do not disassemble this product except replace the battery. Do not discard any other parts that have been replaced by the used batteries or equipment. Dispose of them according to the relevant requirements of the local environmental protection department to avoid polluting the environment.
- Do not use an thermometer to measure fire or other heat sources.
- After strenuous exercise, there will be temperature deviations, and you must sit for 30 minutes to measure.
- All illustrations provided in this manual are for reference only and are subject to the actual product.

#### 2. Product Features

Product name	Infrared Thermometer
Bluetooth version	BLE 5.0
App Name	Equate Monitors
Measuring range	89.6°F~109.4°F(32.0°C~43.0°C)
Accuracy:	±0.4°F(±0.2°C) , 96.8°F~102.2°F (36°C~39°C) Outside this range ±0.5°F (±0.3°C)
Display resolution	0.1°C/0.2°F
Unit	°C/°F, default to °F
Measurement time	15
Memory	Automatically store 32 sets of data, and over 32 sets are covered from the first set

3

Power supply	2xAAA(1.5V), DC 3.0V
Power off	Standby for 15 seconds without any operation will automatically power off
Operation/use environment	Temperature: 50°F~104°F (10°C~40°C) Relative humidity: ≤85% RH Atmospheric pressure: 70.0kPa~106.0kPa
Storage/transport environment	Temperature: -4°F~+131°F (-20°C~+55°C) Relative humidity: ≤93% RH Atmospheric pressure: 70.0kPa~106.0kPa
Product size	140(L) x 36(W) x 57.5(H)mm
Weight	67g (not includes the batteries)

#### 3. Body Temperature

Infrared Thermometer measures the body temperature based on the infrared energy emitted from the eardrum or the forehead. Users can quickly get measurement results after positioning properly the temperature probe in the ear canal or forehead.

Normal body temperature is a range. The following table shows that this normal range also varies by site. Therefore, readings from different sites should not be directly compared. Tell your doctor what type of thermometer you used to take your temperature and on what part of the body. Also bear this in mind if you are diagnosing yourself.

Measuring part	Normal temperature range
Forehead temperature	36.1°C - 37.5°C (97°F - 99.5°F)
Ear temperature	35.8°C - 38°C (96.4°F - 100.4°F)
Oral temperature	35.5°C - 37.5°C (95.9°F - 99.5°F)
Rectal temperature	36.6°C - 38°C (97.9°F - 100.4°F)
Axillary temperature	34.7°C - 37.3°C (94.5°F - 99.1°F)

4

#### 4. Product Appearance

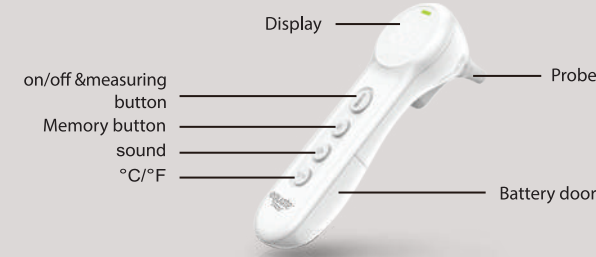

#### 5. Screen Display

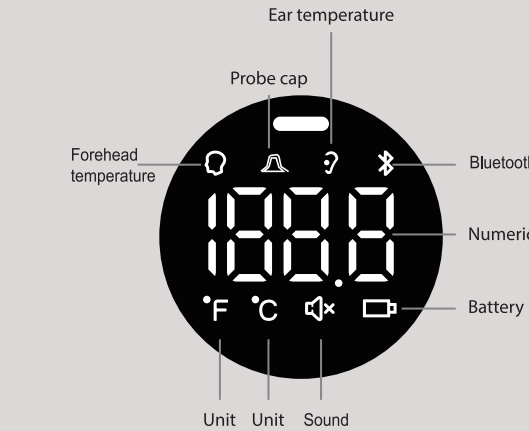

5

#### 6. Measuring

1) First step  
Install the battery, short press the measurement button, after the "BF" sound, the product is turned on, and then enter the measurement interface "----".

2) Use for forehead mode  
Please keep the probe 1-3 cm from the center of the user's forehead, then press the measurement button. A beep indicates the measurement has been finished.

3) Use for ear mode with probe caps  
Take off forehead cap to activate ear temperature mode. To start taking temperature measurement, fit the disposable probe caps on the sensor head, and then fit the probe tip into the ear canal (as deep as possible) to make the sensor aligned with the eardrum and then press button. Wait for 1 second after press the button, until you feel a beep indicates that the measurement is complete and that the results are ready.

4) Use for ear mode without probe caps  
Take off the forehead cap to activate ear temperature mode. To start taking temperature measurement, fit the probe tip into the ear canal (as deep as possible) to make the sensor aligned with the eardrum and then press button. Wait for 1 second after press the button, until you feel a beep indicates that the measurement is complete and that the results are ready.

\* If you put on a disposable probe cap, the probe cap symbol will be displayed on the screen, if the disposable probe cap is put on, the probe cap symbol will not be displayed.  
\* Environment changes can affect the accuracy of temperature readings. Before use, allow the thermometer to remain in one location without significant air temperature changes for 30 minutes. Wait at least 30 minutes after strenuous exercise before taking a temperature reading. Do not wear a hat or make sure there is no hair, sweat, or makeup on our forehead while taking temperature readings. To avoid human error, take multiple measurements and use the average temperature.

6

Bluetooth®

Dual-Function  
Infrared Thermometer

equate™



equate  
Health  
Monitors

Download the Equate Monitors app,  
the app can track history record.



#### 7. Using and Cleaning the Memory:

This thermometer automatically stores the last 32 body temperature measurements.  
1. To view previous reading, press the memory button.  
2. Press the memory button to scroll to the next stored measurement. Before displaying the measurement, a number will display between 1 and 32 to indicate which measurement you are viewing.  
3. Removing the batteries from the thermometer clears the memory.

#### 8. Power off

Automatic power off: 15 seconds automatically power off without any operation.  
Manual power off: In the standby status, press the measurement button for three seconds.

#### 9. Mute Feature:

Short press mute button to switch from mute mode or unmute mode

#### 10. High Temperature Alarm

When the measurement is higher than the alarm value, the device will emit a continuous beep sound and the button will turn to different backlight color to remind the user to pay attention.

Fever alert	Temperature range °C	Temperature range °F	Color bar	Beep mode
Normal Temperature	< 37.5 °C	< 99.5 °F	Green	One short beep
Fever	37.5~38.5 °C	99.5°F~101.3 °F	Yellow	Four short beeps . "BI-BI.....BI-BI....."
High Fever	> 38.5 °C	> 101.3 °F	Red	Nine short beeps "BIBIBI...BIBIBI...BIBIBI....."

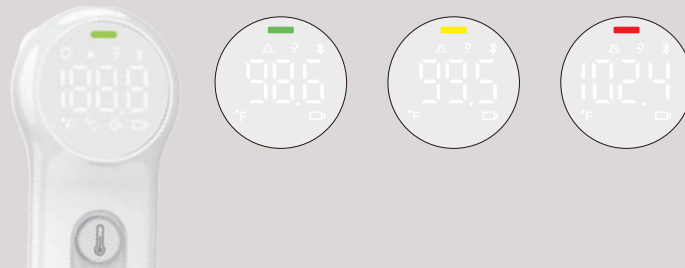

7

#### 11. Changing the temperature unit

Short Press the the "°C/°F" button to switch between °C and °F, and the default unit is °F.

#### 12. Correct Measurement reading:

You may choose to use the thermometer without a protective cap, although for hygienic purposes, it is always recommended for the disposable cap to be used and replaced before use.  
To ensure an accurate reading, please confirm that the removable cap is properly snapped into place onto the thermometer head. The Thermometer screen will indicate a cap symbol to confirm you have properly secured the cap.

1. Possible scenarios that may initiate a False, High Body Temperature measurement:

- a. After excessive exercise, there should be a 30 minute wait prior to measuring temperature
- b. The person whose temperature is being measured should be in a "room temperature" climate. If the present location is excessively high in temperature, there should be a 20 minute wait, once inside before measuring ear temperature
- c. If the Body thermometer has been stored in a low temperature environment it is recommended that it be placed at room temperature for 30 minutes before use.

2. Possible scenarios that may initiate a False, Low Body Temperature Measurements

- a. The temperature sensor head is not clear from dust or dirt
- b. The Thermometer has been removed from the ear canal too quickly
- c. The Thermometer has not been inserted deeply enough into the ear canal
- d. Measuring too quickly after entering the house in cold winter climates
- e. The temperature sensing head is not pointed in the direction of the eardrum and forehead

3. The measurement results of the right and left ear are different. This is normal. Use the higher temperature as the base.

8

#### 4. The Self-Test Function:

If this self-test function does not automatically initiate, the measuring will not be accurate.  
Once the Thermometer is turned on, it will automatically perform a self-test for a couple of seconds. Once complete, the last measured temperature will appear. At that point the thermometer is ready for a new use.

#### 13. Precautions For Use

- 1) When measuring temperature, the ear thermometer should not be placed in the ear canal for too long, so as not to affect the temperature measurement result.
- 2) It is not possible to continuously measure the temperature, and continuously insert the ear thermometer into the ear canal, which will cause the temperature of the ear canal to rise, so that the data of each measurement is different. The measurement is performed every 3 seconds after each measurement, thus ensuring the accuracy of the temperature measurement.
- 3) Always measure ear temperature while awake for maximum accuracy.
- 4) When measuring, insert the temperature sensor head as far as possible into the eardrum. When inserting, gently pull the ears outward or outside, do not force the insertion.
- 5) When measuring, keep away from devices that emit electromagnetic waves, such as mobile phones.
- 6) The ear thermometer is not used correctly, which may result in inaccurate measurement results.
- 7) Clean the earwax before measuring.
- 8) The measured value may be inaccurate when the battery is low. Please stop using and replace the battery.

#### 14. Battery Replacement

This product is powered by 2 x AAA 3V alkaline batteries. When the power is insufficient, the LED displays the empty battery symbol and flashes. At this time, the measurement cannot be started. Please replace the batteries.

9

#### 15. Cleaning And Maintenance

- If there is dirt on the machine, wipe it with a dry, soft cloth. When it becomes very dirty, wipe it with a cotton swab or a soft cloth dampened with water or 75% medical alcohol, then wipe it off with a dry cloth.
- When not using for a long time (more than 3 months), remove the battery and store it in the collection tray, note!
- Do not expose this product to strong sunlight, dust, or contaminated environments.
- Please store the product at normal room temperature, if it is placed in an outdoor environment, the temperature should be -4°F~+131°F (-20°C ~ +55°C).
- Please do not use gasoline, oil, thinner, alcohol and other chemical solvents to wipe the product. If necessary, wipe it with a damp cloth dampened with water, but avoid water entering the body to avoid damage to internal electronic components.

#### 16. Abnormal Information

What's Displayed	What it means	What to do
H	Temperature reading is too high.	The measured temperature is higher than 109.4°F (43°C) , Make sure the thermometer is properly aligned with the surface you are trying to read
L	Temperature reading is too low.	The measured temperature is lower than 89.6°F (32°C) , Make sure the thermometer is properly aligned with the surface you are trying to read
EH	Environment temperature is too high.	Check if the ambient temperature is higher than 40°C , move the product to a place that's within 10°C~40°C for 30 minutes, and then measure again

10

EL	Environment temperature is too low.	Make sure the thermometer has been in the location you will take the persons temperature measurement for at least 30 minutes. Do not place under fan, cooler or heater, for example. Do not exceed operating ambient temperature 10°C~40°C
Eerr	System error.	Move to a different environment or replace the batteries. If the problem persists, contact customer service.
Battery icon	The batteries are low	Replace the batteries and try again
NO DISPLAY	The batteries are dead	Replace the batteries

#### 17. Symbol Definitions

Person icon	Equipped with type BF applied parts
Recycling symbol	This product contains batteries and recyclable electronic waste. Please do not dispose of in household waste. Disposal can take place at appropriate collection points throughout the United States.
Manual icon	Refer to instruction manual / booklet
IP22	Extended degree of protection against harmful ingress of particulate matter and water.

Caution: Any changes or modifications not expressly approved could void the user's authority to operate the equipment.

**Warning:**  
Keep out of the reach of children.  
This thermometer does not replace the advice of a doctor.  
Keep thermometer away from water/liquid, as it is not water resistant.

Satisfaction guaranteed - Or we'll replace it or give you your money back.  
For questions or comments please call  
1-888-287-1915.

**DISTRIBUTED BY:**  
Walmart Inc.,  
Bentonville, AR 72716  
PRODUCT OF CHINA

11

#### 18. Using The App

Activate Bluetooth on your mobile device but do not connect to anything. After you've downloaded the app, you can log in if you have an account already or register a new user account and set up your profile.

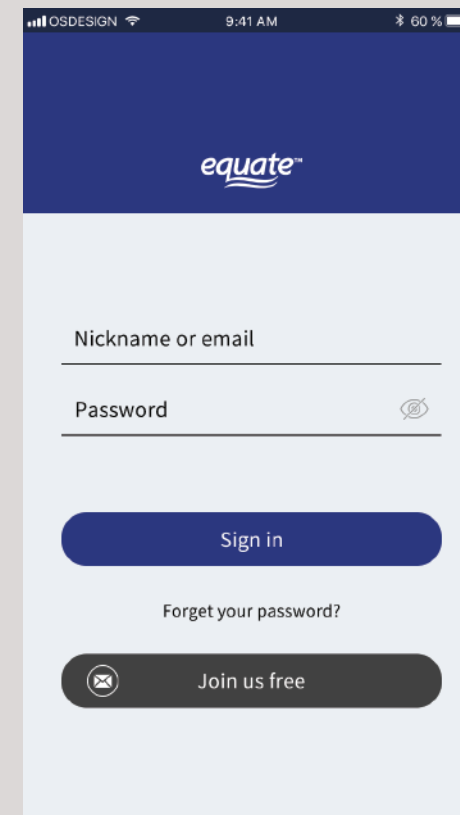

12