

MODEL PART DIAGRAM

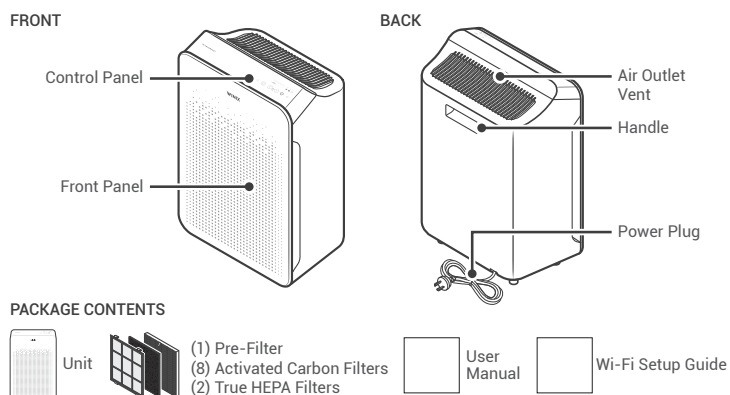

WHERE TO USE

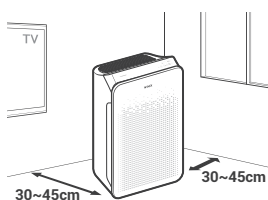

Allow 30~45cm. of space between TVs, radios, and other electronics. Electromagnetic interference from certain electronics may cause product malfunction.

Place indoors away from direct sunlight. Direct exposure may cause product malfunction or failure.

Only place on hard, flat surfaces. Flimsy or slanted surfaces may result in abnormal noise and vibrations.

Allow at least 30~45cm. from walls for maximum air flow

4-STAGE AIR PURIFICATION

Air Purification means it removes inanimate particles

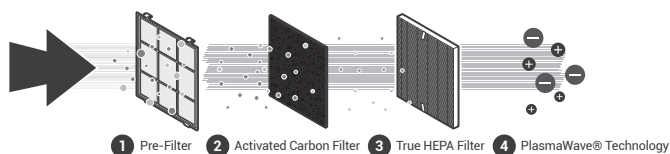

INITIAL OPERATION

1. Remove the front panel by grasping its upper edge and gently pulling forward.
2. Remove the Pre-Filter, then the bag of filters behind it.
3. Remove filters from protective plastic bag.
4. Install the filters until they fit securely in place.
 03. True HEPA Filter (back)
 02. Activated Carbon Filter (middle)
 01. Pre-Filter (front)
5. After filters are installed, close the front panel.
6. Insert the power cord into an electrical outlet.

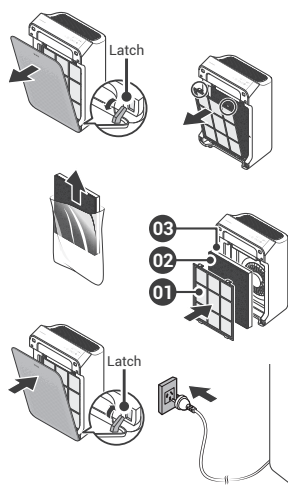

MAINTENANCE

When to Replace Filters

Filter	Indicator Light	When to Service	When to Replace
Pre-Filter	none	Clean once every 14 days	Permanent
Deodorization Filter	none		Every 3 months
True HEPA Filter	Check Filter	Can NOT be WASHED	Lasts up to 12 months

- When the Check Filter Indicator LED is on, it is time to replace the Filter.
- Intervals between filter replacement may vary depending on environment.

REPLACING FILTERS



Resetting Filter Life:

After replacing your True HEPA Filter, place the Pre-Filter back in and close the Front Panel. While the unit is on, hold the Filter Reset Button for at least 5 seconds until you hear the beep. After the beep, the Filter Replacement Indicator will disappear. The True HEPA Filter is now reset.

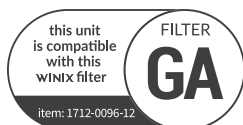

CONTROL PANEL

01. Auto Mode Indicator - The LED "Auto" light will indicate when Auto Mode is activated.

02. Air Quality Indicator - Color coded LED light indicates one of three levels of Air Quality: Red (poor), Amber (fair), and Blue (good).

03. Fan Speed Indicator - Indicates the current fan speed.

04. Sleep Mode Indicator - The LED "Sleep" light will indicate when Sleep Mode is on.

05. Filter Replacement Indicator - LED light indicates when it is time to change the filter.

06. Filter Reset Button - After replacing the True HEPA Filter, use a small object such as a paper clip, to press and hold the Filter Reset Button for at least 5 seconds until the Filter Replacement Indicator turns off.

07. Smart Sensor - Detects the amount of odorous gas in the environment. When in Auto mode, the fan speed adjusts according to the detected amount of gas.

08. Power Button - Turns the unit on or off. During the first 30 seconds of powering up, the Air Quality Indicator will cycle through Blue, Amber and Red colors.

- Smart sensor takes approximately 4 minutes to detect the air quality in the environment before normal operation begins.

09-1. Fan Speed/Auto/Sleep Buttons - Use the Fan Speed arrow buttons to set the desired fan speed. Fan Speeds cycle over in this sequence: Auto, Low, Medium, High, Turbo, Sleep, Auto.

Auto Mode: Automatically adjusts fan speeds according to your indoor air quality. The fan speed will adjust to low when air quality is good, medium when fair, and to high when poor.

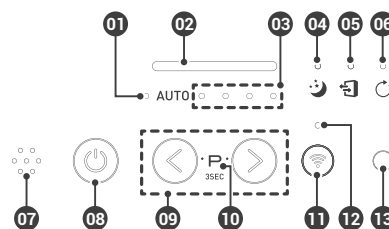

Sleep Mode: When Sleep Mode is activated, the Air Quality Indicator LED light is disabled.

- Fan speed will automatically set to minimum speed (lower than 'Low') which will be nearly silent. When Sleep Mode is active, PlasmaWave® will be disabled, but it can be turned back on.

09-2. PlasmaWave® Button - Press and hold the buttons < + > for 3 seconds

Press the Plasmawave® button when the unit is on to enable or disable this feature. By default, PlasmaWave® is enabled whenever the unit is powered on. When the unit is running, you may hear a chirping or buzzing sound. The sound is from particles passing through PlasmaWave®, it is normal and does not signify product failure.

10. PlasmaWave® Indicator - Indicates whether PlasmaWave® is enabled or disabled.

11. Wi-Fi Button - Press for 3 seconds to activate pairing mode. When Wi-Fi is paired, press the button to turn Wi-Fi off or back on.

12. Wi-Fi Indicator - Enables or disables the Wi-Fi feature. When in the pairing state, the Wi-Fi LED flashes. When paired successfully, the Wi-Fi LED will be a solid white light.

13. Light Sensor - Detects the amount of ambient light in the environment. When in Auto Mode, the light sensor detects when to put the unit into Sleep Mode.

Winix Smart Wi-Fi Setup - Refer to the Wi-Fi Guide provided inside the box.

CLEANING CARE

Cleaning the Filters:

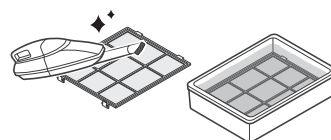

Use a vacuum cleaner or soft brush to clean the Pre-Filter.

- If it is excessively soiled, rinse in room temperature water. Do not use detergent or soap. Allow the filter to dry for 24 hours or more before using. Intervals between filter cleaning may vary depending on the air quality. Do not use hot water over 40 °C or volatile fluids such as paint thinner.

NOTICE

- When cleaning the unit, always unplug the power cord first and then wait until the unit has cooled down.
- Never disassemble, repair, or modify this unit yourself.
- Do not use flammable sprays or liquid detergents.
- Do not allow children to clean or maintain the unit.
- Before cleaning or maintaining, ensure unit is unplugged.
- Do not use benzene, alcohol, or other volatile fluids, which may cause damage or discoloration.

Cleaning the Exterior & Interior:

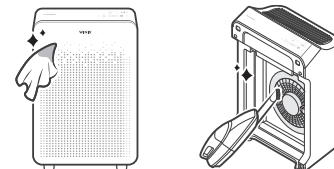

Wipe with a soft damp cloth using room temperature water.

- Afterwards, wipe it down with a dry cloth.

Open the front panel and clean the interior with a vacuum cleaner.

- For optimal performance, clean every 1 - 2 months.

SPECIFICATIONS

Model	C545(AU)
Voltage	AC 220 V - 240 V, 50 / 60 Hz
Power Rate	65 W
Dimensions	350 mm (W) x 215 mm (D) x 524 mm (H)
Weight	5 kg
Filter SKU	Filter GA : 1712-0096-12

Exterior design, and product specifications may be changed without prior notice to improve product performance.

AUSCLIMATE FILTER CLUB

For exclusive savings on replacement filters ausclimate.com.au/pages/filter-club

CDB GROUP

New Zealand
PO Box 100707
North Shore Mail Centre
Auckland 0745
www.cdbgroup.com

Australia
PO Box 574
South Morang
Victoria 3752
www.cdbgroup.com

SAFETY AND CAUTIONS

Before operating this equipment, carefully read and follow these safety cautions.

Ensure filters are inserted before running unit. Running the unit without filters can shorten the lifespan of the unit and cause electric shock or injury.

Be sure foreign objects are NOT inserted into the vents on the unit. Objects can include pins, rods, and coins.

Do not touch any part of the interior of the unit with wet hands. The high voltage may cause electric shock.

Ensure unit intake and outlet vents do not become blocked. Blockage may lead to increased internal temperatures, causing product failure and deformation.

Do not use the unit as a step stool or place heavy objects on the unit. Personal injury may occur or product failure and deformation.



WARNING

Follow these instructions to reduce the risk of serious injury or death and to reduce risk of damaging the unit.



If the supply cord is damaged, it must be replaced by the manufacturer, its service agent or similarly qualified persons in order to avoid a hazard.



This appliance is not intended for use by persons (including children) with reduced physical, sensory or mental capabilities, or lack of experience and knowledge, unless they have been given supervision or instruction concerning use of the appliance by a person responsible for their safety.



This appliance can be used by children aged from 8 years and above under supervision. This appliance can be used by persons with reduced physical, sensory or mental capabilities or lack of experience and knowledge if they have been given supervision or instruction concerning use of the appliance in a safe way and understand the hazards involved.



Children should be supervised to ensure that they do not play with the appliance.



Cleaning and user maintenance shall not be made by children without supervision.



Before cleaning or maintaining, ensure unit is unplugged.



The cord can become damaged by forcefully bending, pulling, twisting, bundling, pinching or placing heavy objects on it.



Do not install in any sort of motor or transport vehicle (trucks, boats, ships, etc.).



Do not place in an area with excessive amounts of noxious gases.



Do not place near any flammable materials (aerosols, fuel, gases, etc.).



Do not place in excessively humid areas where the unit may become wet.



Do not place unit closer than 30 cm from the wall during operation. It may cause condensation on the wall and the surrounding area.



Do not use around mist or fumes from industrial oil or around large quantities of metallic dust.



Do not place below any electrical outlet.



Do not have the unit facing into wind or drafts.



Do not pull on the power cord when unplugging the unit.



Do not tie or knot the power cord when unit is in operation.



If the unit becomes submerged in water, unplug it and contact customer service.



Do not unplug or move the unit while in operation.



Do not plug additional appliances into the same outlet or power supply.



Do not touch the plug with wet hands.



Unplug the unit when not in operation for extended periods of time.



Do not place around heating elements.

SAFETY INSTRUCTIONS

Read and save these instructions.

Thank you for purchasing a Winix air purifier. This product is for household use only.

IMPORTANT CAUTIONS FOR USING YOUR AIR PURIFIER:

WARNING:

Follow the instructions in this manual to reduce the risk of electric shock, short circuit, and/or fire.

- Do not repair or modify the unit. All repairs should be completed by a qualified technician.
- Do not use if the power cord or plug is damaged or the connection to the wall outlet is loose.
- Use AC 220 - 240 V only.
- Do not damage, break, forcefully bend, pull, twist, bundle, coat, pinch, or place heavy objects on the power cord.
- Periodically remove dust from the power plug. This will reduce the risk of shock due to humidity build up.
- Remove the power plug from the outlet before cleaning the unit. When removing the power plug, grasp by holding the plug itself, never hold by the cord.
- If the power plug is damaged, it must be replaced by the manufacturer or a qualified technician.
- Remove the power plug from the outlet when not in use.
- Do not handle the power plug with wet hands.
- Do not operate the unit when using indoor smoke-generating insecticides.
- Do not clean unit with benzene or paint thinner. Do not spray insecticides on the unit.
- Do not use the unit where it is humid or where the unit may become wet, such as the bathroom.
- Do not insert fingers or foreign objects into air intake or outlet.
- Do not use the unit near flammable gases. Do not use near cigarettes, incense, or other spark-creating items.
- Unit will not remove carbon monoxide emitted from heating appliances or other sources.
- Unplugging the product disconnects the remote functions.

IMPORTANT PRECAUTIONS FOR USING YOUR AIR PURIFIER:

- Do not block the intake or outlet vents.
- Do not use near hot objects, such as a stove.
- Do not use where the unit may come into contact with steam.
- Do not use the unit on its side.
- Keep away from products that generate oily residue, such as a deep fryer.
- Do not use detergent to clean the unit.
- Do not operate without a filter.
- Do not wash and reuse the True HEPA Filter.
- Hold the handle on the back of the unit to transport.
- Do not hold by the front panel.
- Do not stick any small objects into the air outlet vents or fan.

PRODUCT WARRANTY

Product Name	Air Purifier
Model Name	C545(AU)
Purchase Date	
Warranty period	Two (2) Years
Place of purchase	
Place of purchase Tel.	
Customer	Address
	Name
	Tel.

※ After purchase, be sure to complete all of the above information.

FREQUENTLY ASKED QUESTIONS

Problem	Check / Actions to take	Problem	Check / Actions to take
It does not turn on at all.	Is the plug securely attached to the outlet? <ul style="list-style-type: none">Make sure the outlet has power going to it, and ensure the plug is secured.	There is a strange smell.	Is it being used in a place with a lot of smoke, dust, or odours? <ul style="list-style-type: none">Clean the air intakes on either side and clean the Pre-Filter.Clean or change the filter.
	Is there a power outage? <ul style="list-style-type: none">Check to see if other lights and electrical equipment are working and try again.		
It doesn't work in Auto Mode.	Has Auto Mode been selected? <ul style="list-style-type: none">Press the Mode button until Auto Mode is selected.	The fan strength is weak. The unit is not purifying the air.	Is the Check Filter indicator light on? <ul style="list-style-type: none">Change the filters as required.
It vibrates and makes a lot of noise.	Is it running on a slanted or uneven surface? <ul style="list-style-type: none">Move the unit to a hard, flat, even area of the floor.	The display panel is dim.	Is the Light Sensor blocked by debris? <ul style="list-style-type: none">When Auto Mode is on, Sleep Mode is automatically activated when the Light Sensor detects that the room is dark.
The power plug and outlet feel hot.	Is the plug securely plugged in? <ul style="list-style-type: none">Make sure the plug is properly plugged into the outlet.		

WINIX

AIR PURIFIER

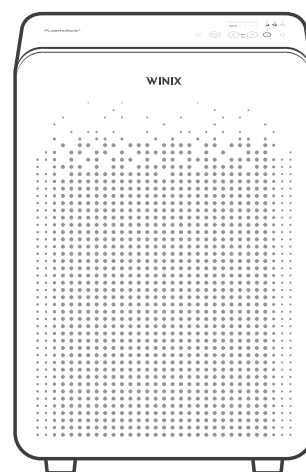

C545(AU) USER MANUAL



The product uses the "WFM60-SFP201" wireless module, and the RCM mark could not be added due to the label size problem of the "WFM60-SFP201" wireless module, so the RCM mark was added to the user manual of the finished product.

- The product warranty is printed on the back of this guide. This product is manufactured for use only in Australia. This product is suitable for 220 - 240 V only.