

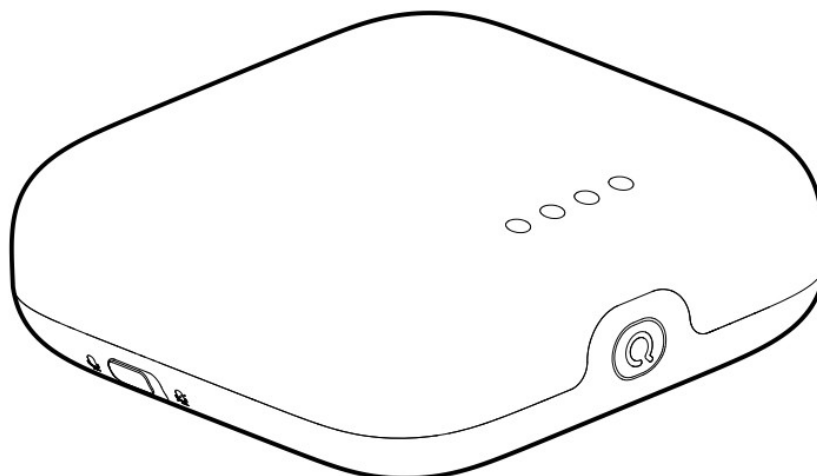

onn ORPK4VTG 4K Pro Streaming Device User Guide

[Home](#) » [Onn](#) » onn ORPK4VTG 4K Pro Streaming Device User Guide 



QUICK START GUIDE
onn. 4K Pro Streaming Device | Google TV
100135769_EN_231222

Contents

- 1 WHAT'S INCLUDED
- 2 SAFETY INFORMATION
- 3 STREAMING DEVICE
- 4 REMOTE CONTROL
- 5 HOW TO POSITION
- 6 SETUP
- 7 GOOGLE ASSISTANT
- 8 INDICATOR STATE
- 9 SOUND OUTPUT
- 10 FIND MY REMOTE
- 11 TROUBLESHOOTING
- 12 COMPLIANCE
- 13 COMPLIANCE
- 14 Documents / Resources
 - 14.1 References

WHAT'S INCLUDED

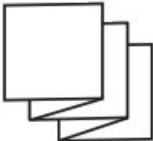
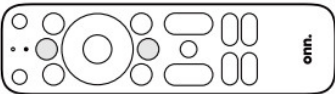
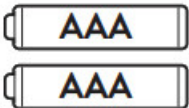
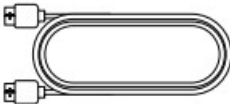
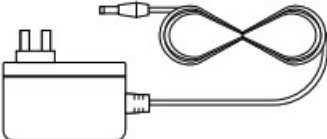
Part	Description	Picture
1	Streaming Device x1	
2	Quick Start Guide x1	
3	Remote Control x1	
4	Batteries x2	
5	HDMI Cable x1	
6	Power Adapter x1	

SAFETY INFORMATION



- No parts should be repaired by users.
- Place the device on a flat, firm and stable surface. Do not put it on a carpet or rug.
- Protect the device from high temperatures, humidity, water and dust.
- Do not mix old and new batteries and do not mix alkaline, standard (carbon-zinc) or rechargeable (ni-cd, ni-mh, etc.) batteries.
- Do not place any objects near your device that may damage it (e.g. liquid-filled objects or candles).
- Place the device in a well-ventilated location to prevent the accumulation of internal heat.
- Presence of live parts inside the device! Do not open. Risk of electric shock!



CAUTION

Battery Replacement

Risks of explosion if the battery is replaced by an incorrect type:

- replacement of a battery with an incorrect type that can defeat a safeguard (for example, in the case of some lithium battery types)
- disposal of a battery into fire or a hot oven, or mechanically crushing or cutting of a battery, that can result in an explosion
- leaving a battery in an extremely high temperature surrounding environment that can result in an explosion or the leakage of flammable liquid or gas
- a battery subjected to extremely low air pressure that may result in an explosion or the leakage of flammable liquid or gas

The Environment for Device

- Appropriate Operating Temperature: 32°F to 104°F.
- Appropriate Operating Humidity: 5% ~ 85% Non-condensing.

STREAMING DEVICE

1. Front Panel

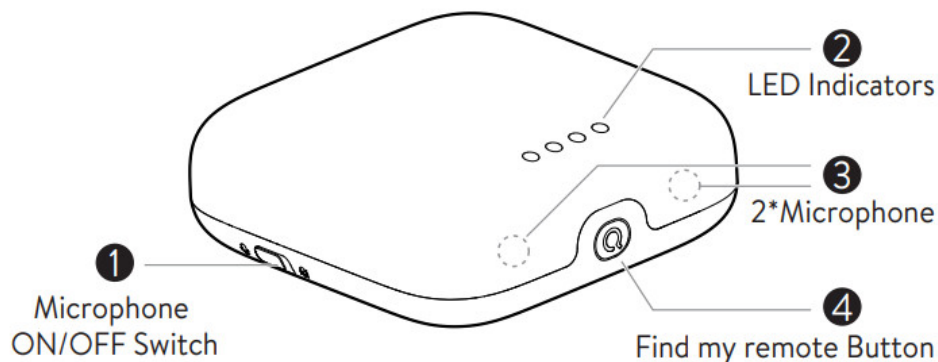

2. Back Panel

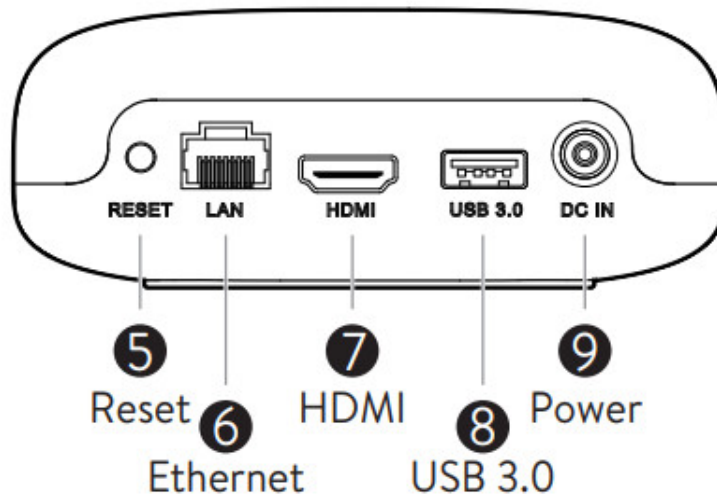

REMOTE CONTROL

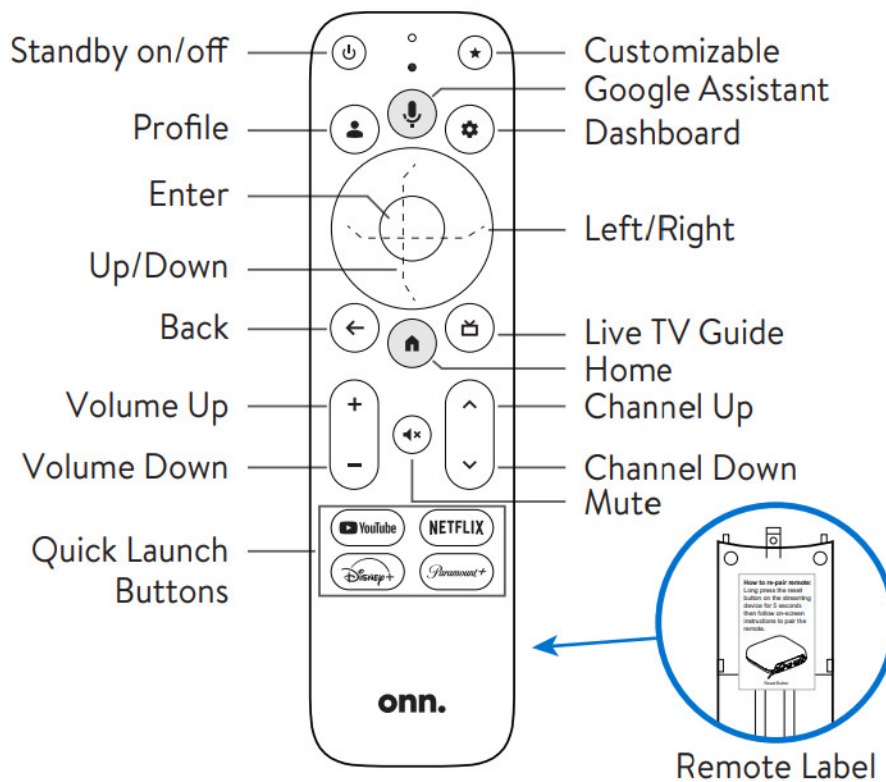

Customizable Button

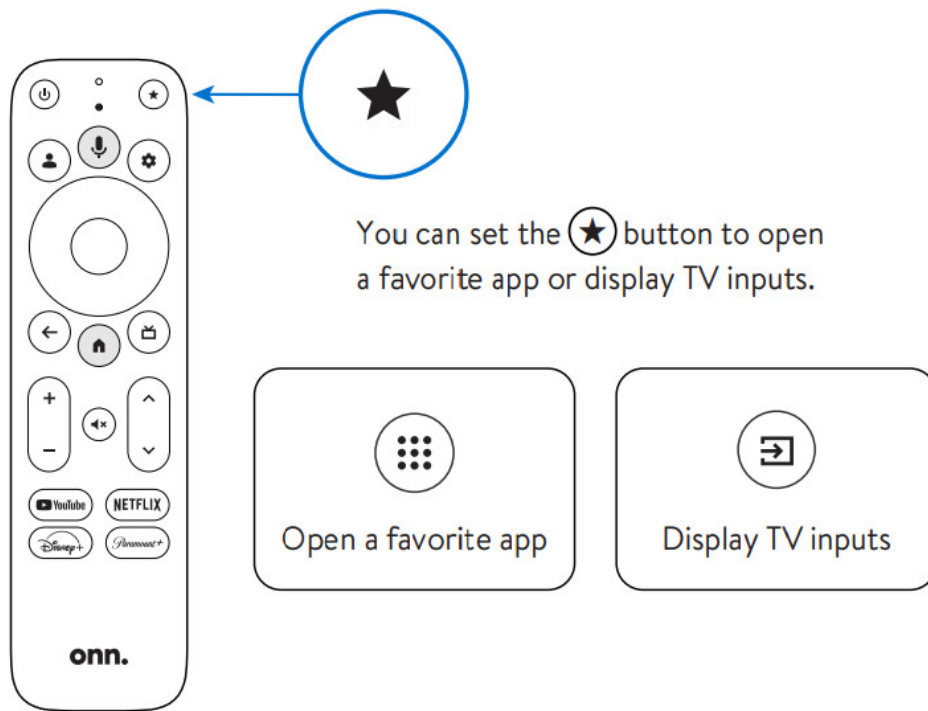

HOW TO POSITION

Position Your Streaming Device

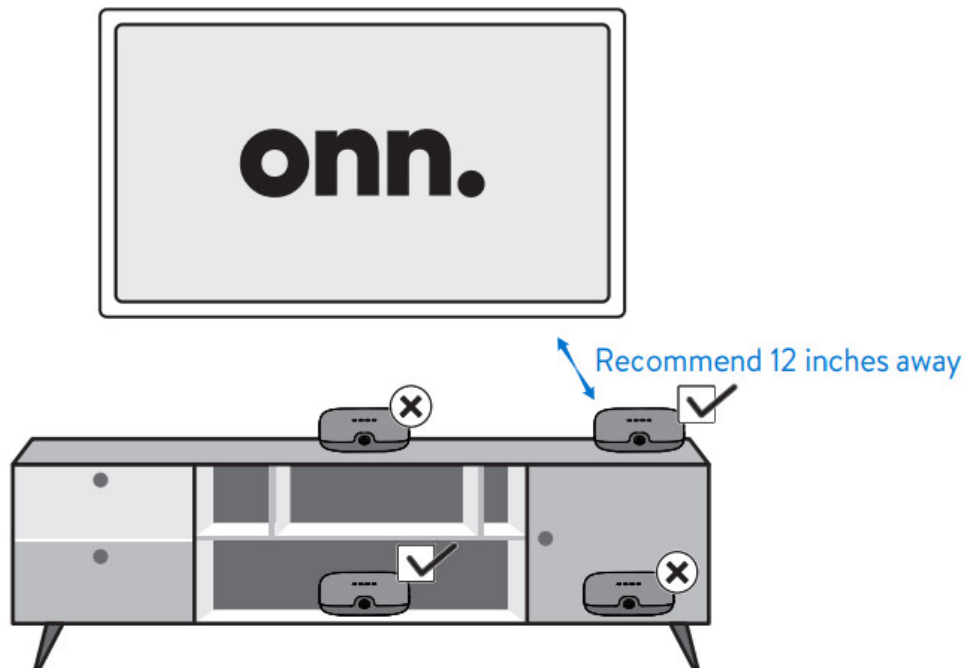

- Please position your Streaming Device 12 inches away from any other devices.
- Please do not position your Streaming Device in any closed cabinet.

SETUP

1. Start Up TV

Turn on your TV before using Streaming Device.

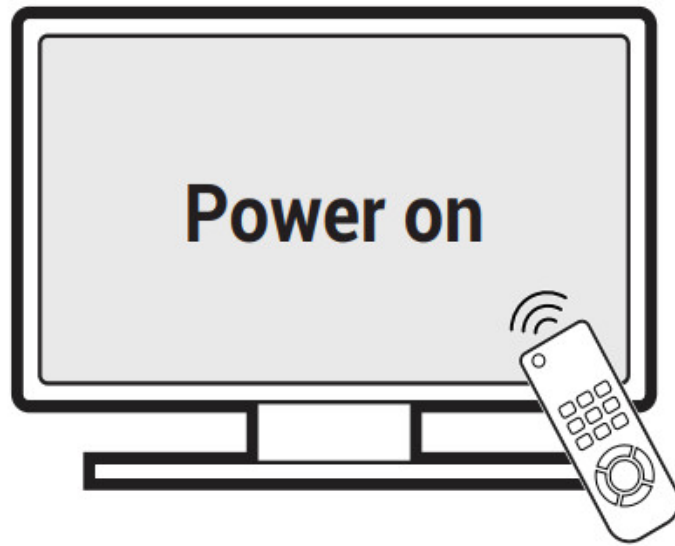

2. Set Input Source Of TV

After your TV is turned on, go to the Inputs page where you can switch the input source. Select HDMI Input, e.g. HDMI1.

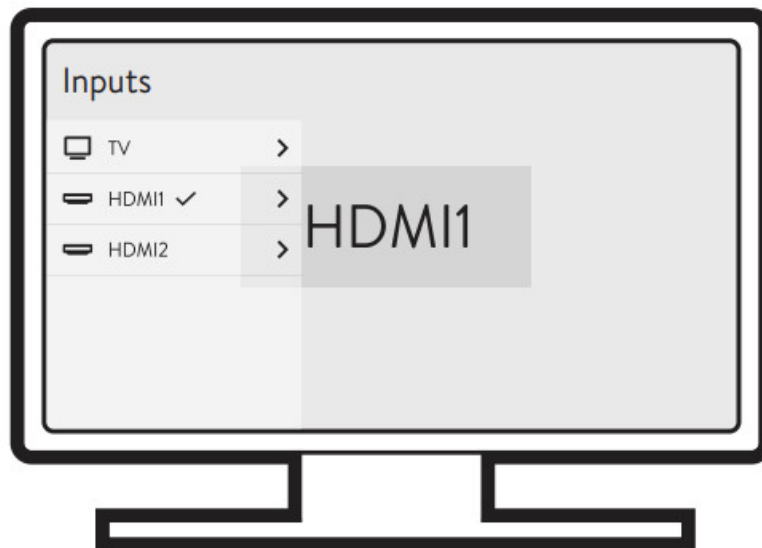

3. Connection

3.1 Connection To Your TV

Connect HDMI to HDMI port of the device and TV set.

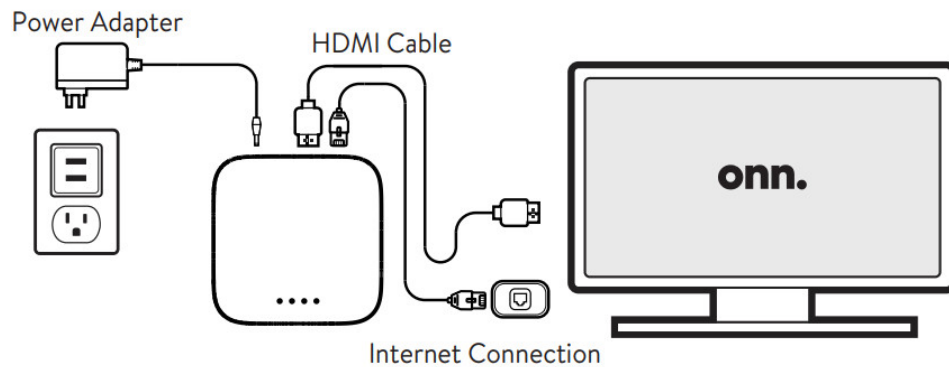

3.2 Connection With Power

Connect the included power adapter to the Streaming Device which will power on the unit.

4. Follow On-Screen Setup

Follow the on-screen instructions to set up Google TV™ on your Streaming Device.

4.1 Remote Pairing

Insert the 2 AAA batteries into the remote. Hold both BACK and HOME button on the remote until pairing is successful.

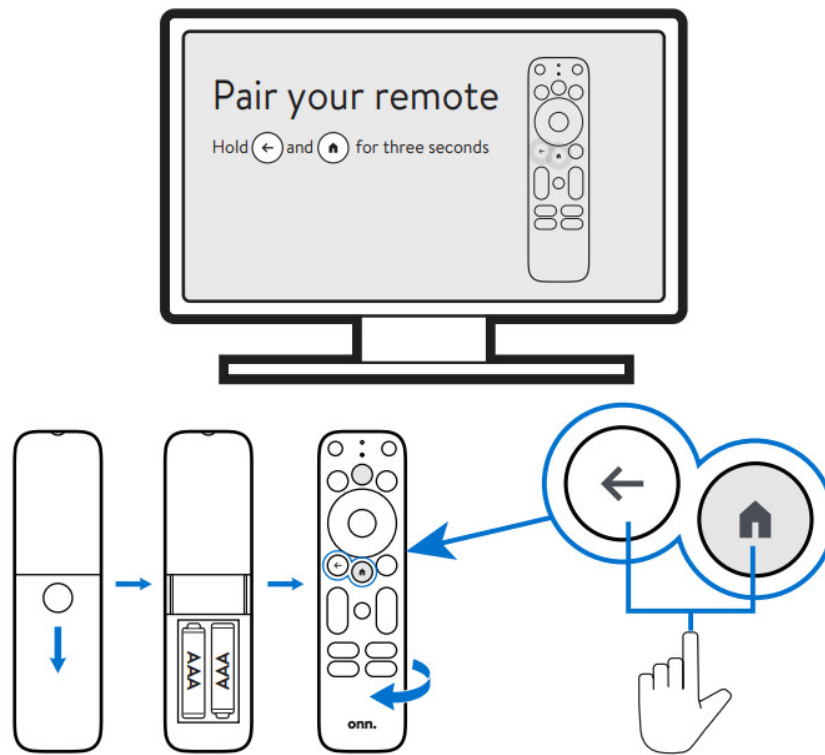

4.2 Select language

Follow the on-screen instructions to select your language and region.

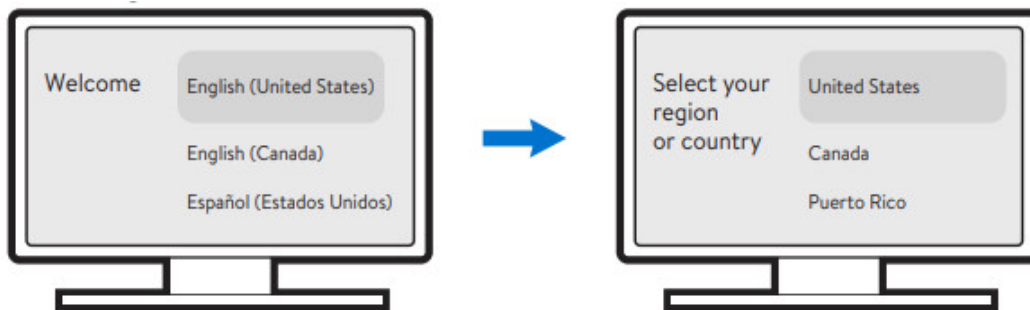

4.3 Set up with the Google Home app or on the TV

1. On the Google Home app: Install the Google Home app from your phone's app store, then open the Google Home app and scan the QR code on the right side of TV.
2. On TV: Follow the on-screen setup.

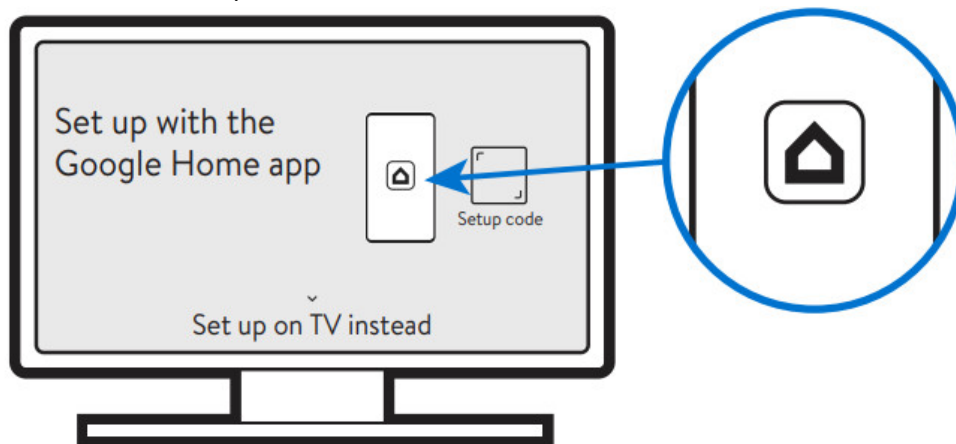

4.4 Wi-Fi Connection

Select your Wi-Fi network and enter the password.



OR

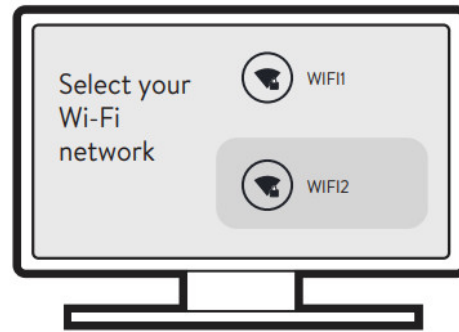

On the Google Home app

On TV

4.5 Sign in to your Google Account

Log in for a personalized Google TV experience.

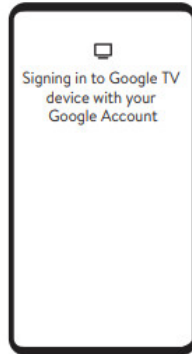

OR

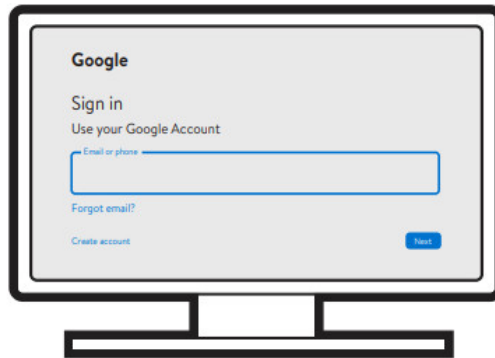

On the Google Home app

On TV

4.6 Select your services

Follow the on-screen instructions to select which streaming services you use.

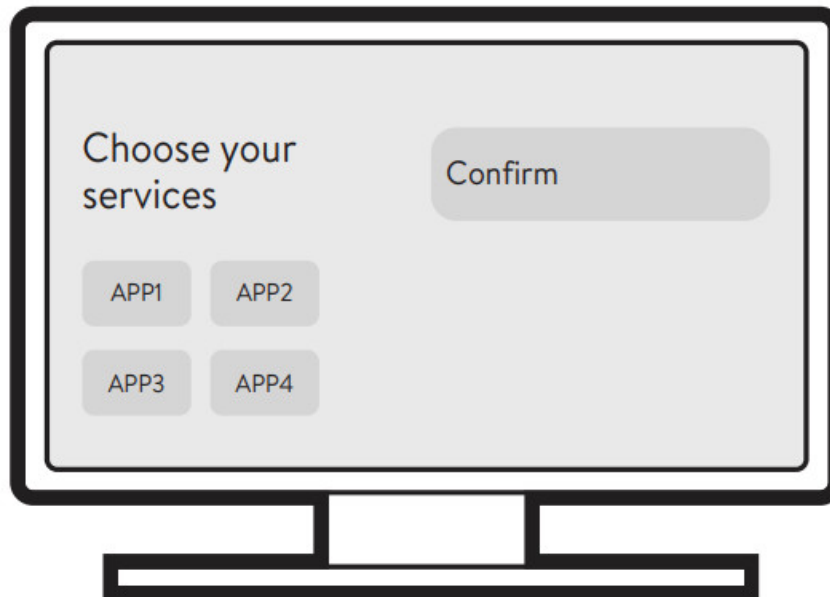

4.7 Remote Control Set Up

Follow the on-screen instructions to set up your remote.

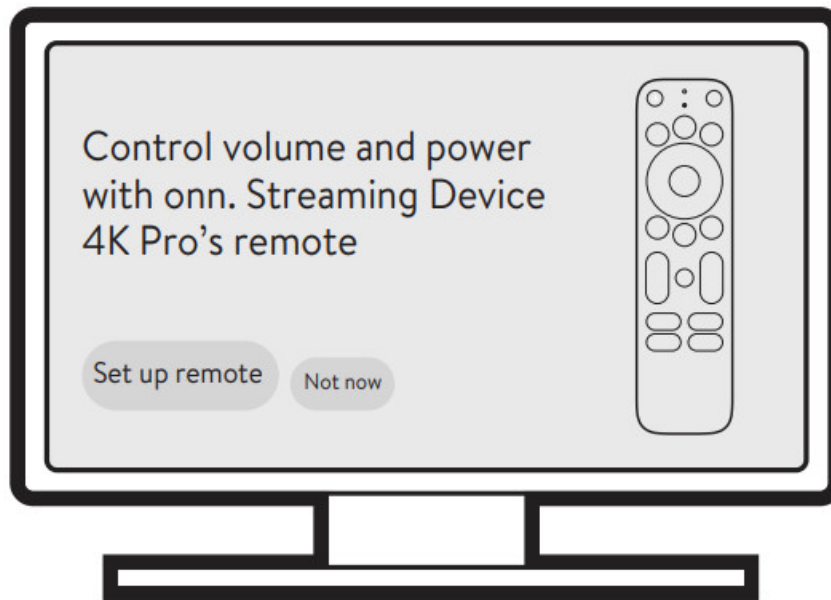

5. Start Exploring

Browse 700,000+ movies and TV episodes, plus live TV, from across your streaming services — in one place.

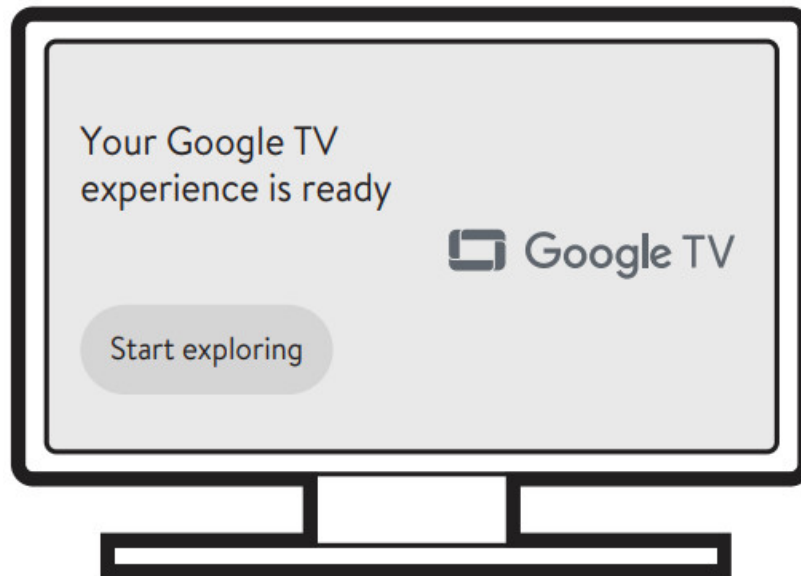

GOOGLE ASSISTANT



Hey Google Talk to Google Assistant to control your TV with just your voice

The hands-free mic can be activated in settings. (Settings > Accounts & Sign-in > Select Account > Google Assistant > Hands-free Mic)

With hands free voice control, you can set aside your remote and simply use your voice to search and access entertainment, get answers, control the TV and smart home devices, and streamline your day. Just say "Hey Google" to get started.

1. Enjoy entertainment

"Hey Google, find action movies"

"Hey Google, search for funny shows"

2. Control your smart home

"Hey Google, dim the lights"

"Hey Google, turn on the living room lights"



3. Get answers and plan your day

"Hey Google, what's the weather today?"

"Hey Google, what is on my agenda today?"

INDICATOR STATE

Mute State

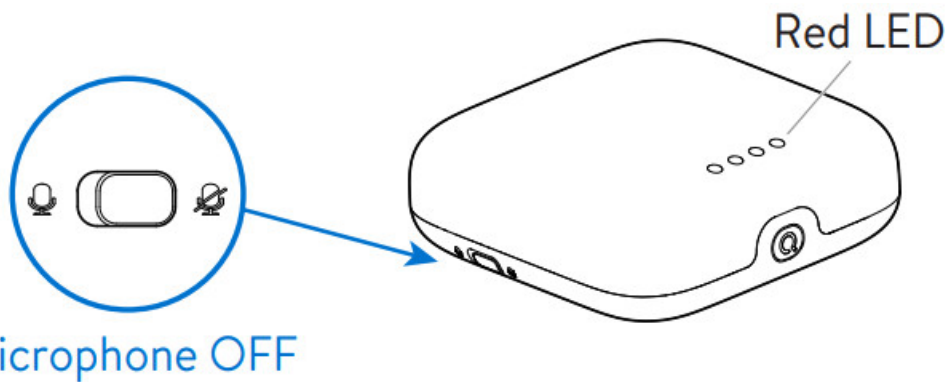

When the microphone is off, indicators will light up in red.

Unmute State

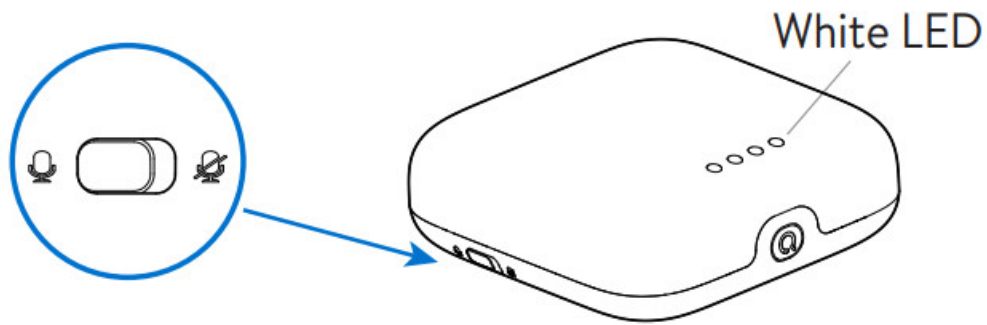

Microphone ON

When the microphone is on, indicators will light up in white after you say “Hey Google” to indicate that Google Assistant has been activated.

SOUND OUTPUT

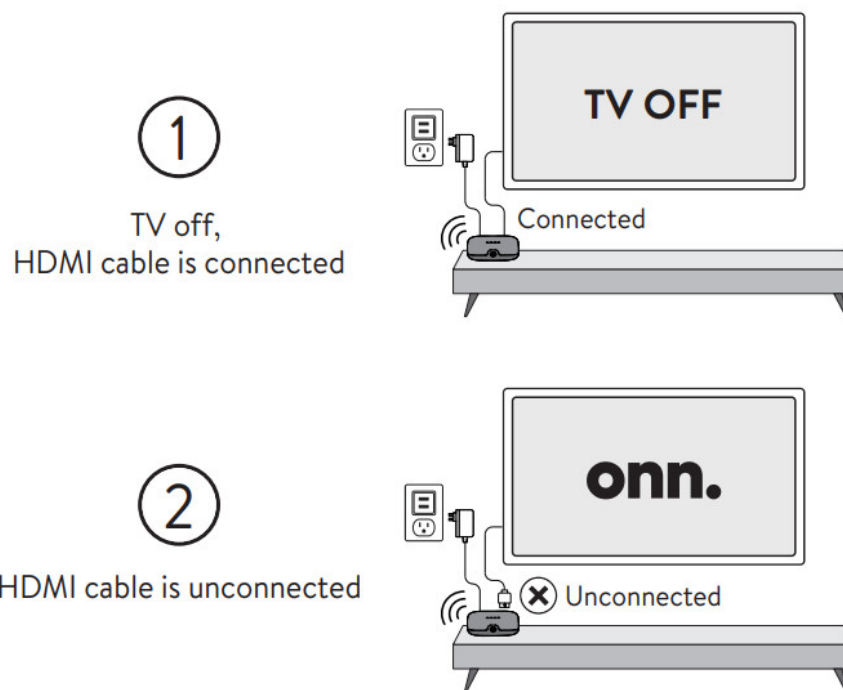

When TV is off or HDMI cable is disconnected, all the sound will be output by Streaming Device itself.
(Refer to scenario 1 and scenario 2 above)

FIND MY REMOTE

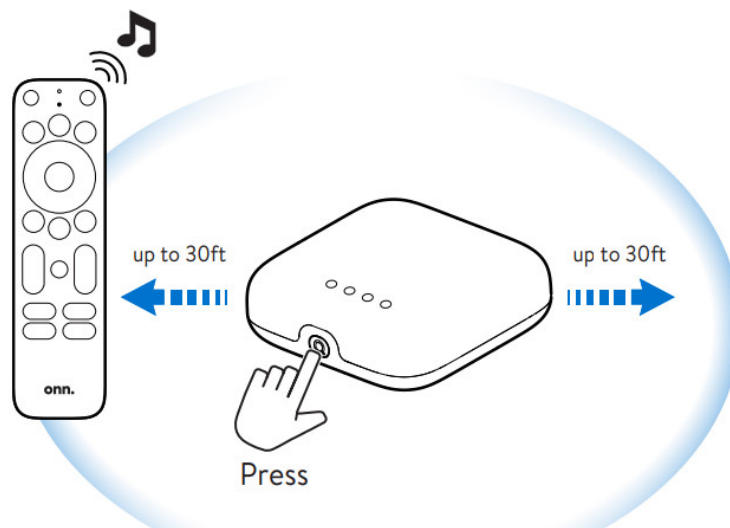

Within a range up to 30ft (360 inches), by pressing the Find my remote Button, the remote control will emit a sound for 30s.

The sound can be turned off by pressing any button on the remote control.

TROUBLESHOOTING

- **No display after power on?**
 - Confirm the HDMI cable is plugged in properly.
 - Make sure your TV has not entered sleep mode. Press the power button on the remote control to wake up your TV.
- **TV has images but no sound?**
 - Make sure your TV is not in mute or low volume.
- **Fail to connect to the network?**
 - Make sure Wi-Fi is functional and your box has a strong enough signal from your router.
- **Remote control failure?**
 - Replace the battery of the remote control with a new one, and make sure it is placed in the correct polarity.
- **If hands-free voice control is not responding**
 - Check network status.
 - Check the streaming device is on unmute state.(Microphone is switched on.)
 - Check the hands-free mode is activated in settings. (Settings > Accounts & Sign-in > Select Account > Google Assistant > Hands-free Mic)
- **Please use the original accessories to ensure safety and a better experience.**

COMPLIANCE

FCC Statement

This equipment has been tested and found to comply with the limits for a Class B digital device, pursuant to part 15 of the FCC Rules.

These limits are designed to provide reasonable protection against harmful interference in a residential installation. This equipment generates, uses and can radiate radio frequency energy and, if not installed and used in accordance with the instructions, may cause harmful interference to radio communications. However, there is no guarantee that interference will not occur in a particular installation.

If this equipment does cause harmful interference to radio or television reception, which can be determined by turning the equipment off and on, the user is encouraged to try to correct the interference by one or more of the following measures:

- Connect the equipment into an outlet on a circuit different from that to which the receiver is connected.
- Consult the dealer or an experienced radio/TV technician for help.

COMPLIANCE

FCC Radiation Exposure Statement

This device complies with FCC radiation exposure limits set forth for an uncontrolled environment. This equipment must be installed and operated in accordance with provided instructions and the antenna(s) used for this transmitter must be installed to provide a separation distance of at least 20 cm from all persons.

This device complies with Part 15 of the FCC Rules. Operation is subject to the following two conditions:

- this device must accept any interference received, including interference that may cause undesired operation.



Any changes or modifications not expressly approved by the party responsible for compliance could void the user's authority to operate the equipment.



Manufactured under license from Dolby Laboratories. Dolby, Dolby Vision, Dolby Atmos, and the double-D symbol are registered trademarks of Dolby Laboratories Licensing Corporation.



The terms HDMI, HDMI High-Definition Multimedia Interface, HDMI trade dress and the HDMI Logos are trademarks or registered trademarks of HDMI Licensing Administrator, Inc. Google TV is the name of this device's software experience and a trademark of Google LLC. Google, YouTube and Google Home are trademarks of Google LLC. Netflix is a trademark of Netflix, Inc. All brands contained herein are trademarks of their respective owners.

We'd love to hear from you. Scan with your smartphone camera and let us know what you think.



<http://www.walmart.com/reviews/write-review?productId=5193222892>



Documents / Resources



[onn ORPK4VTG 4K Pro Streaming Device](#) [pdf] User Guide

ORPK4VTG, 2AYYS-ORPK4VTG, 2AYYSORPK4VTG, ORPK4VTG 4K Pro Streaming Device, ORPK4VTG, 4K Pro Streaming Device, Streaming Device, Device

References

- [User Manual](#)

[Manuals+](#), [Privacy Policy](#)

This website is an independent publication and is neither affiliated with nor endorsed by any of the trademark owners. The "Bluetooth®" word mark and logos are registered trademarks owned by Bluetooth SIG, Inc. The "Wi-Fi®" word mark and logos are registered trademarks owned by the Wi-Fi Alliance. Any use of these marks on this website does not imply any affiliation with or endorsement.