

# ROGUE<sup>®</sup> ECHO ROWER ASSEMBLY GUIDE

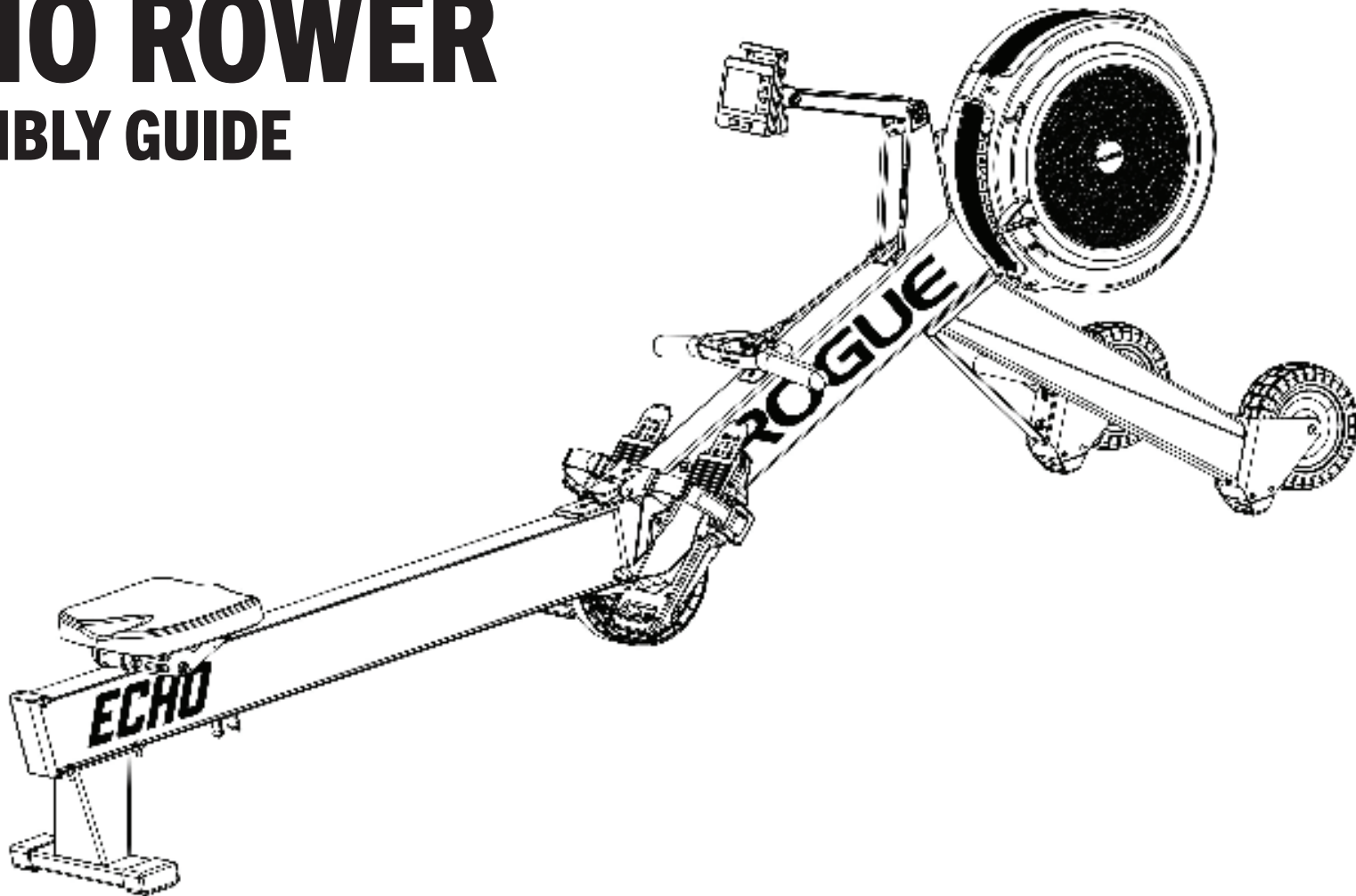











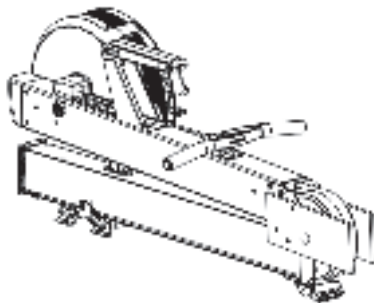

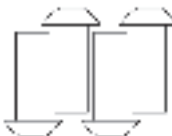
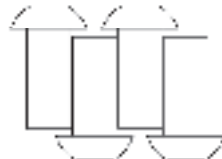

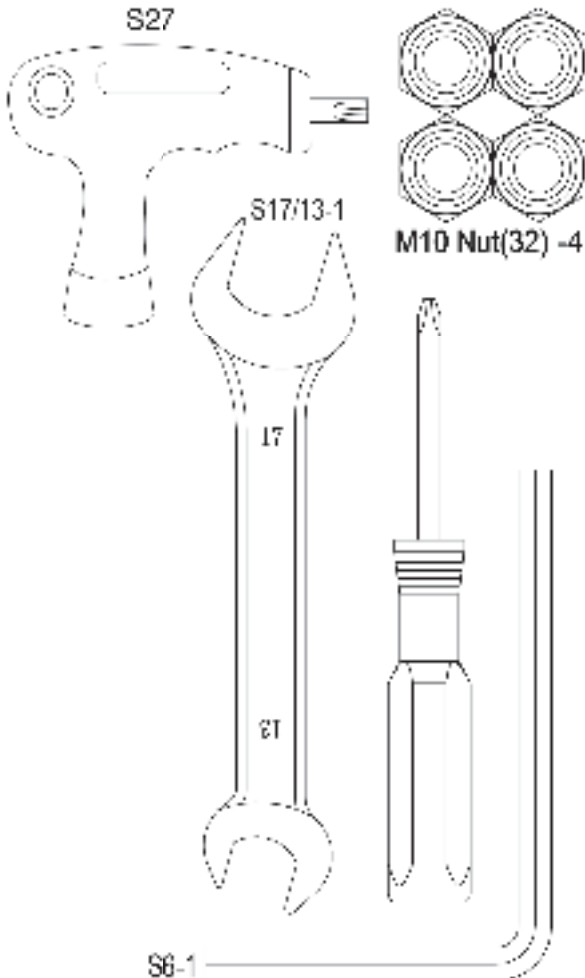
## IMPORTANT SAFETY INFORMATION

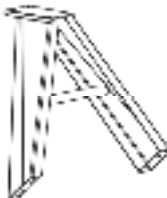
### WARNING:

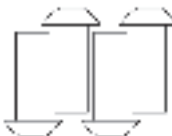
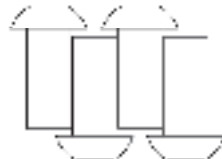
#### MISUSE OF THIS CAN RESULT IN SEVERE INJURY.

Both Rogue Fitness and buyer disclaim any express or implied warranty, including, without limitation, warranties or merchantability and/or fitness for a particular purpose with respect to the equipment. Buyer assumes all liability to use of equipment.

PARTS AND TOOLS USED

	1		1						
			1						
	1		1						
			1						
			1						
	1		1						

## STEP 1

- TAKE OUT THE FRAME (80)
- USE THE WRENCH (S27) IN THE HARDWARE KIT TO REMOVE THE 6 SCREWS ON THE PROTECTION BOARD

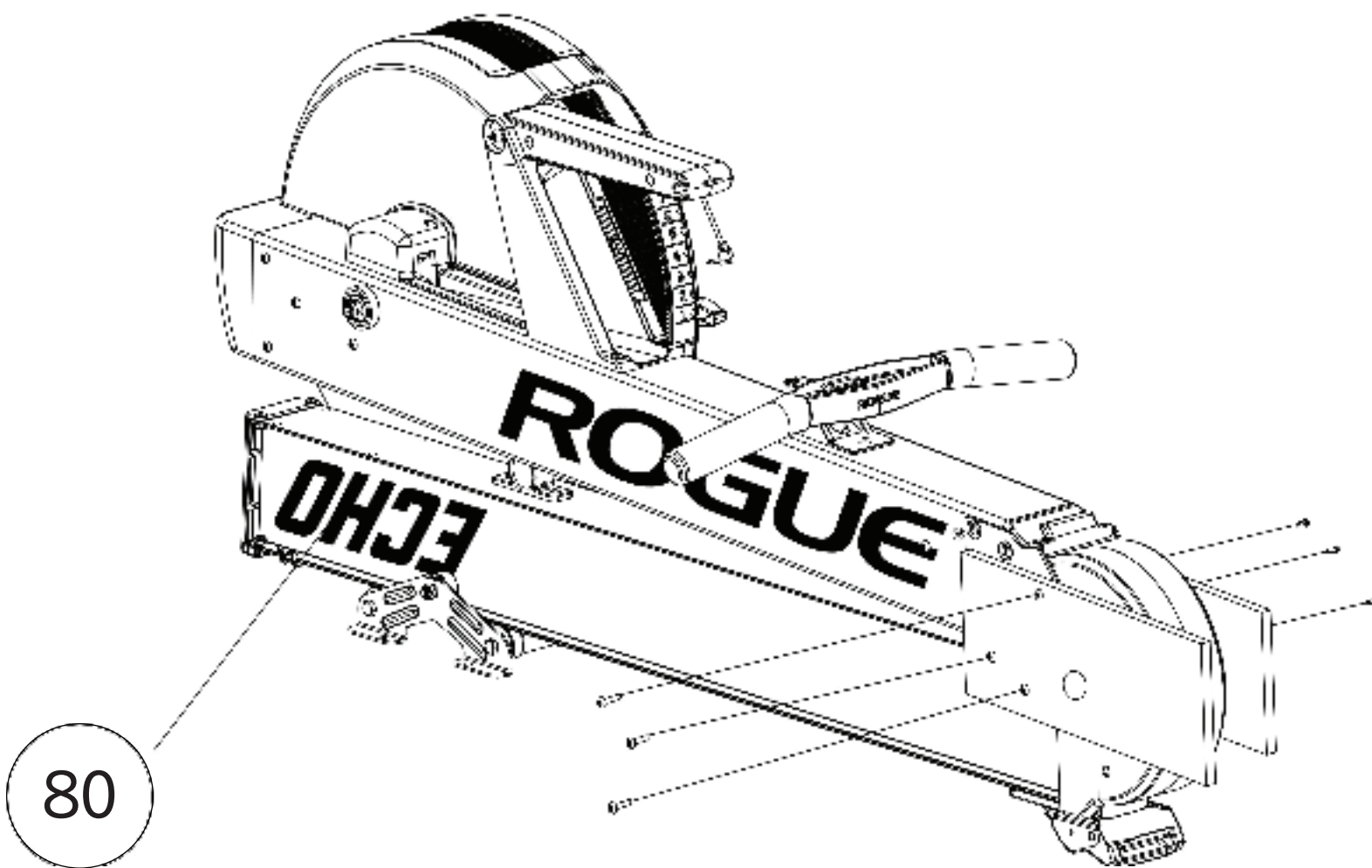

## STEP 2

- ASSEMBLE THE END CAP (33) ONTO THE FRAME (80)

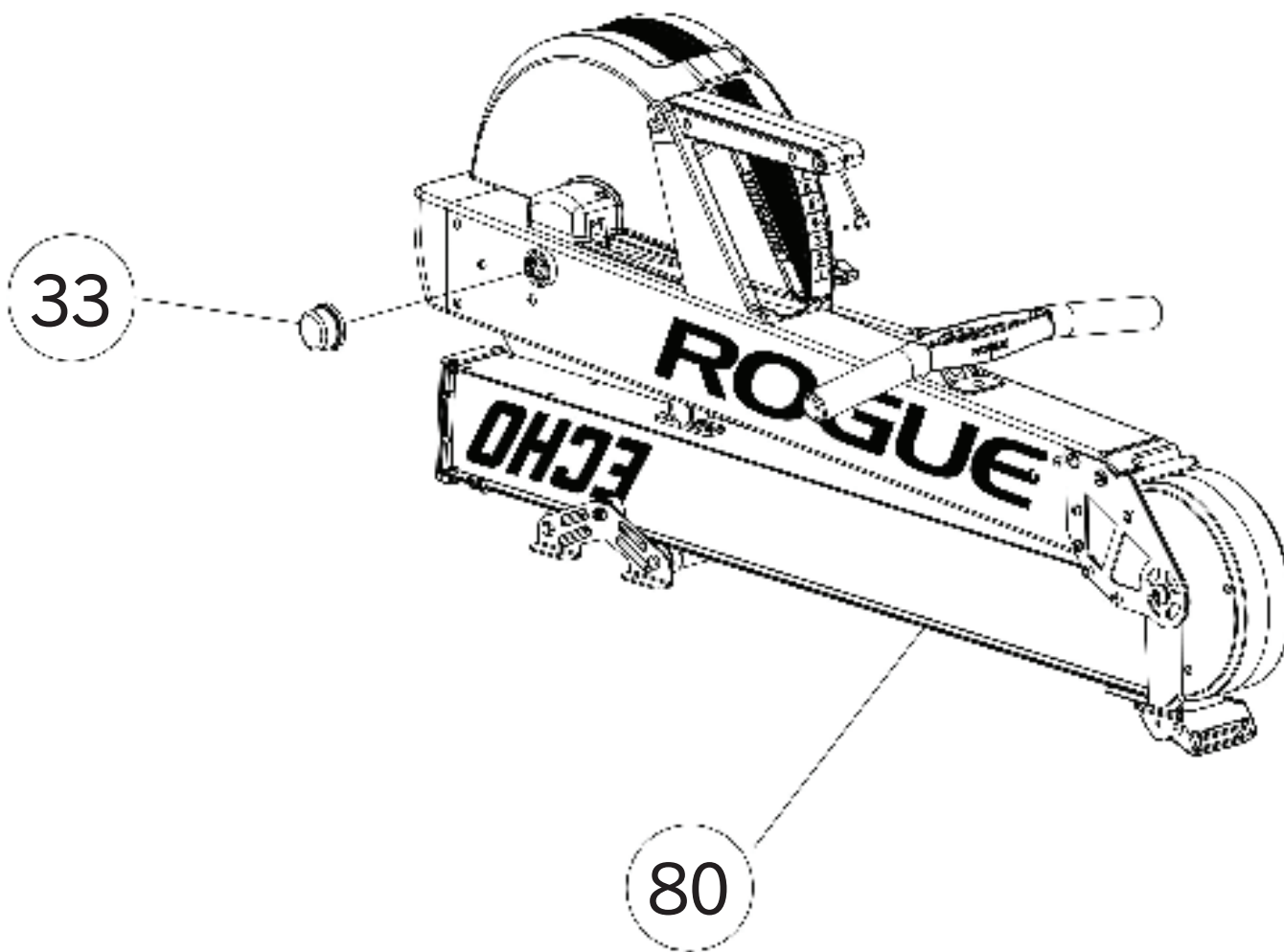

## STEP 3

- FIX THE TURF TIRE WHEELS (L) AND (R) ONTO THE FRONT FOOT TUBE ASSEMBLY (56) USING M10 HEX NUTS (32)

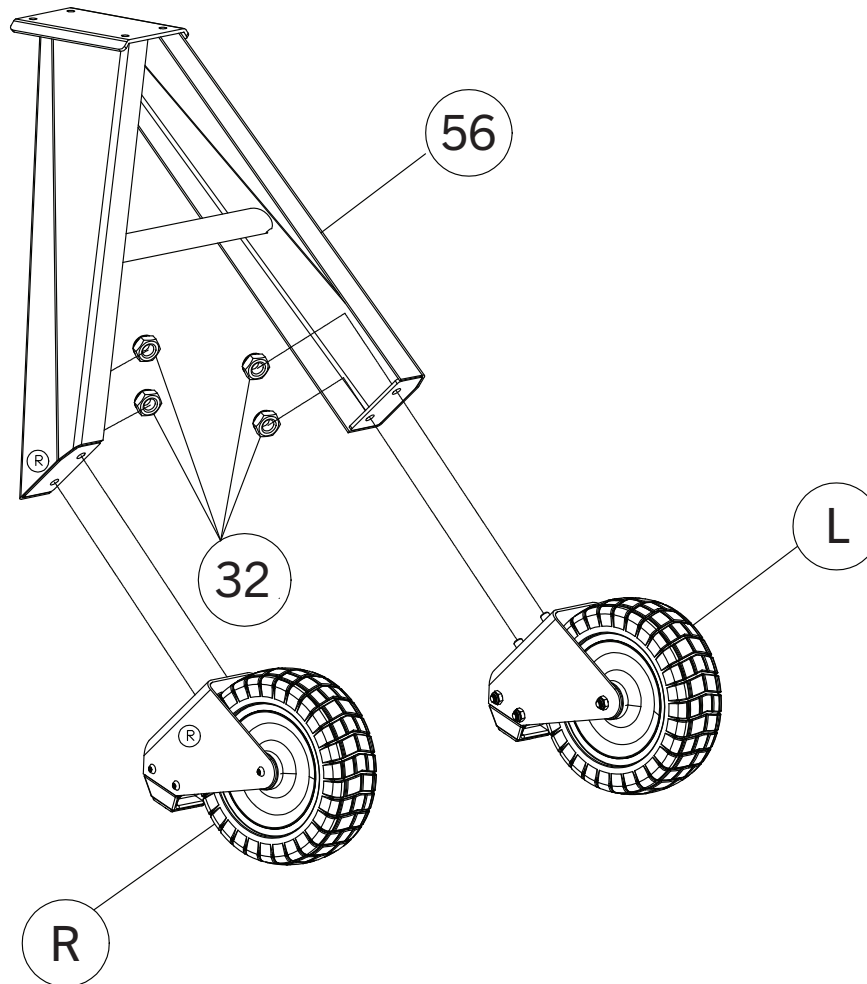

## STEP 4-1

- SPREAD ROWER APART BY 12 INCHES
- INSERT ROUND CROSS BAR OF LEG ASSEMBLY (56) INTO PLASTIC RECIEVER BASE (80)
- PUSH ROWER BACK TOGETHER ALL THE WAY UNTIL YOU SEE THE BOLT HOLES OF THE LEGS LINE UP WITH THREADED HOLES OF BASE

\* RECOMMENDED TO USE TWO PEOPLE FOR THIS STEP

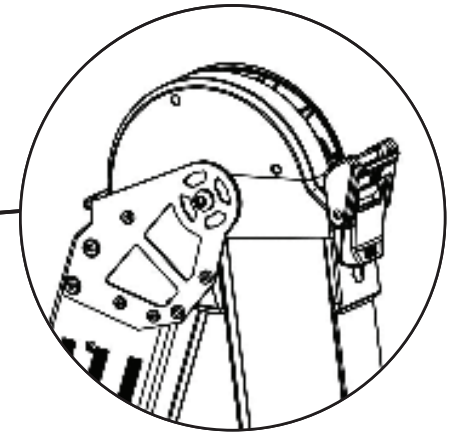
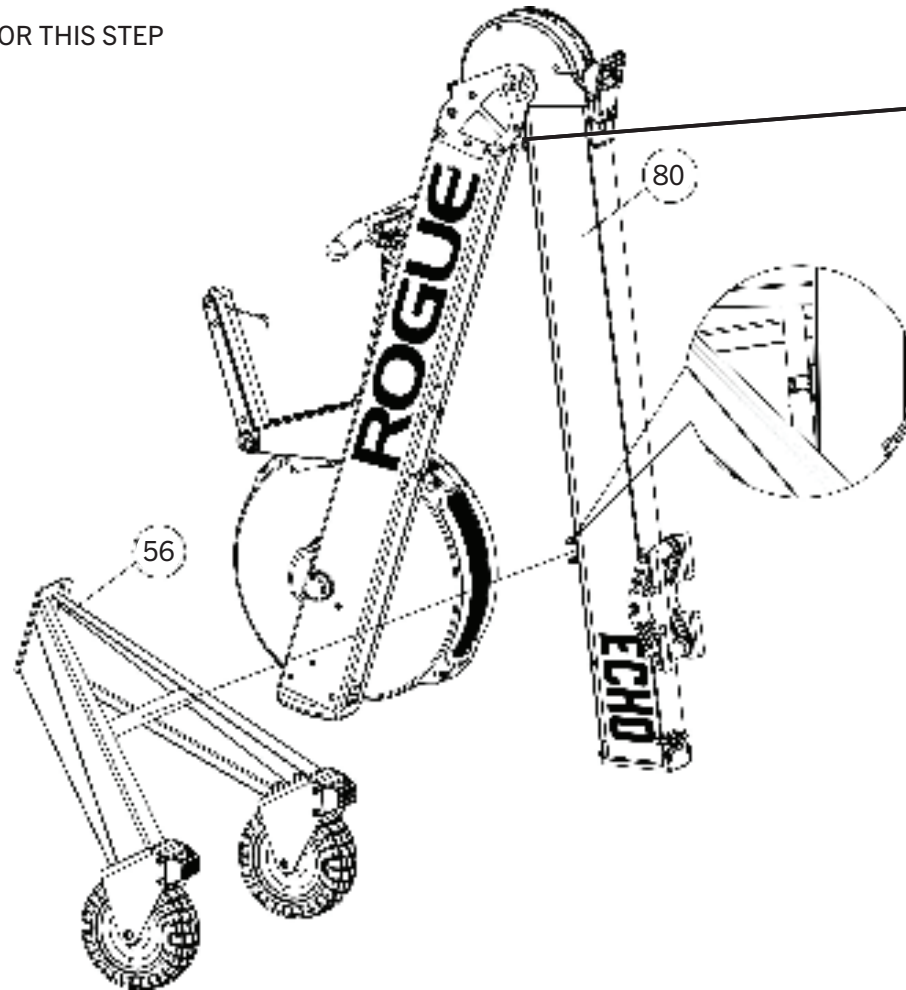

**⚠ CAUTION**  
**PINCH POINT WARNING**

## STEP 4

- STAND THE FRAME VERTICALLY
- USE THE M8 \* 20 (57) HEX HEAD BOLT TO FIX THE FRONT FOOT TUBE ASSEMBLY TO THE FRAME (80)

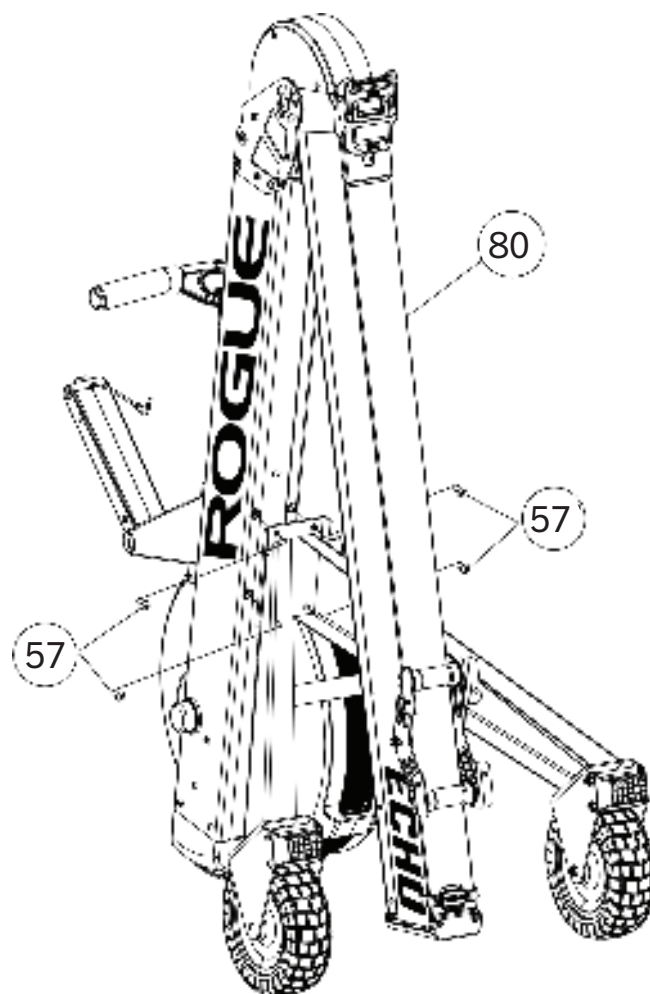

## STEP 5

- FIX THE LEFT (L) AND RIGHT (R) FOOT PEDAL ASSEMBLIES TO THE FRAME (80) USING A 1/4-20 FULL THREAD SCREW (83) (PAN HEAD SCREW)

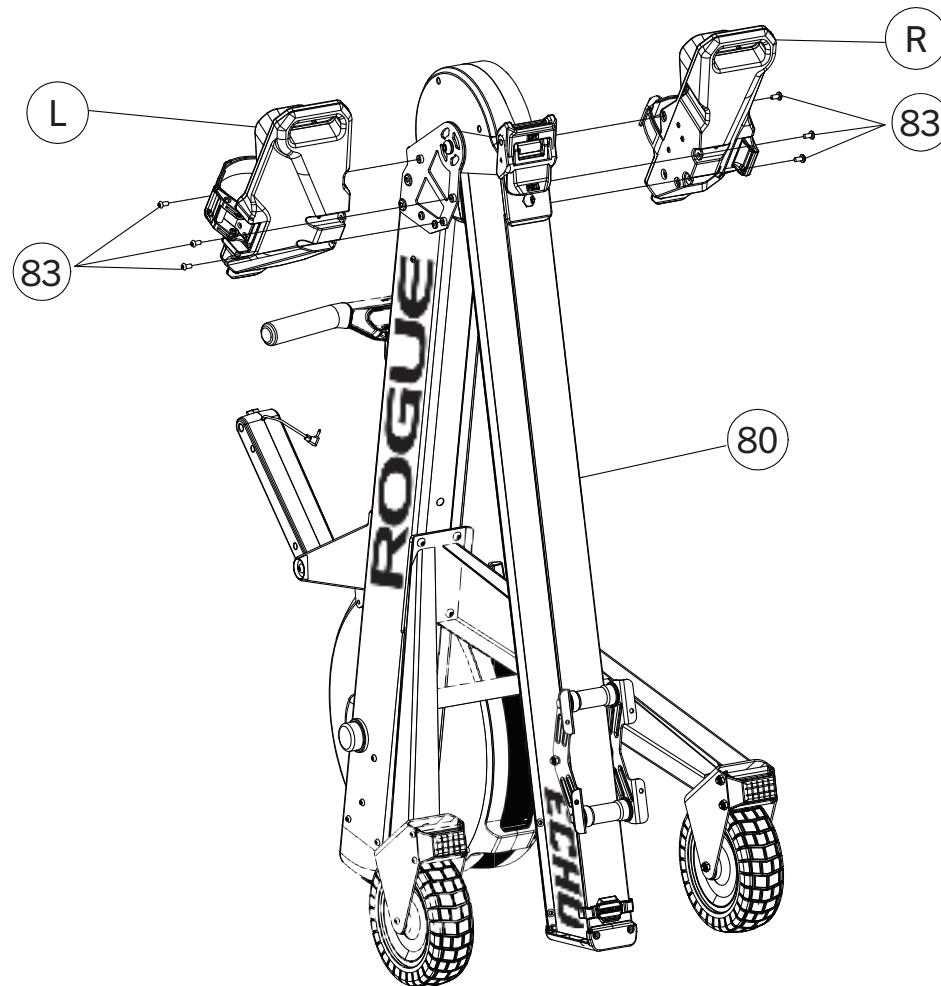



## STEP 6

- FIX THE REAR FOOT TUBE ASSEMBLY (108) TO THE FRAME (80) USING 1/4-20 X16MM SOCKET HEAD SCREWS (111)
- LOCK IT WITH WRENCH (S27)

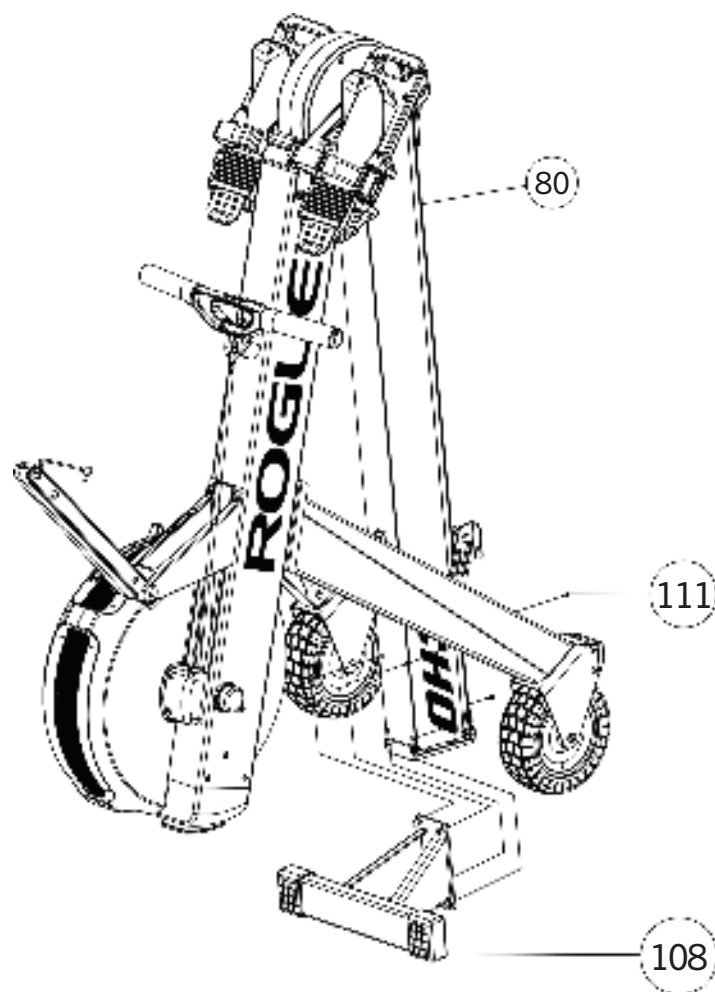

## STEP 7

- FIX THE SEAT CUSHION (123) TO THE SEAT BRACKET ASSEMBLY (122) USING A 20MM FULL THREAD (20) SOCKET PAN HEAD SCREW (3/16-24)
- SEE ORIENTATION IN IMAGE FOR CORRECT SEAT ALIGNMENT (123)

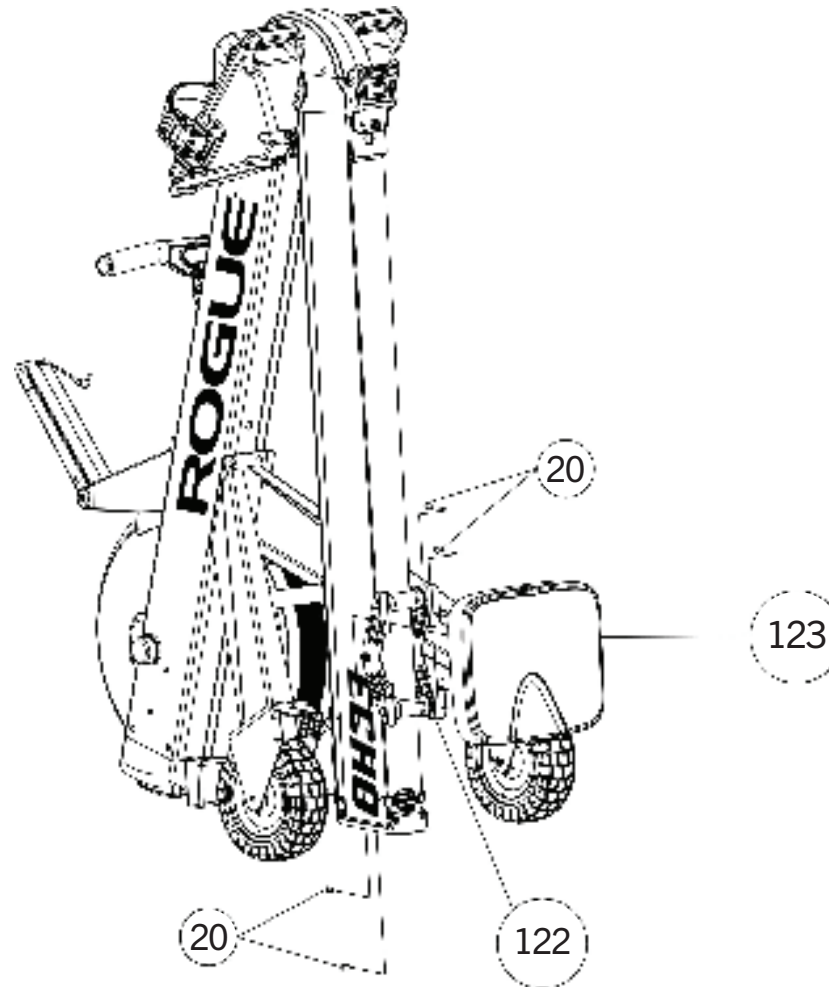

## STEP 8

11

- HOLD TIRE WITH YOUR FOOT WHEN UNFOLDING THE UNIT BY SEPARATING THE REAR MAIN FRAME ASSEMBLY FROM THE FRONT FOOT TUBE ASSEMBLY
- PLACE HORIZONTALLY

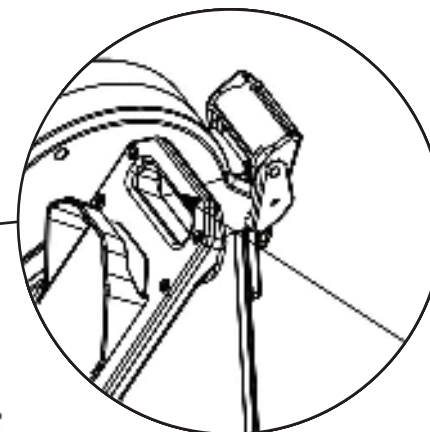
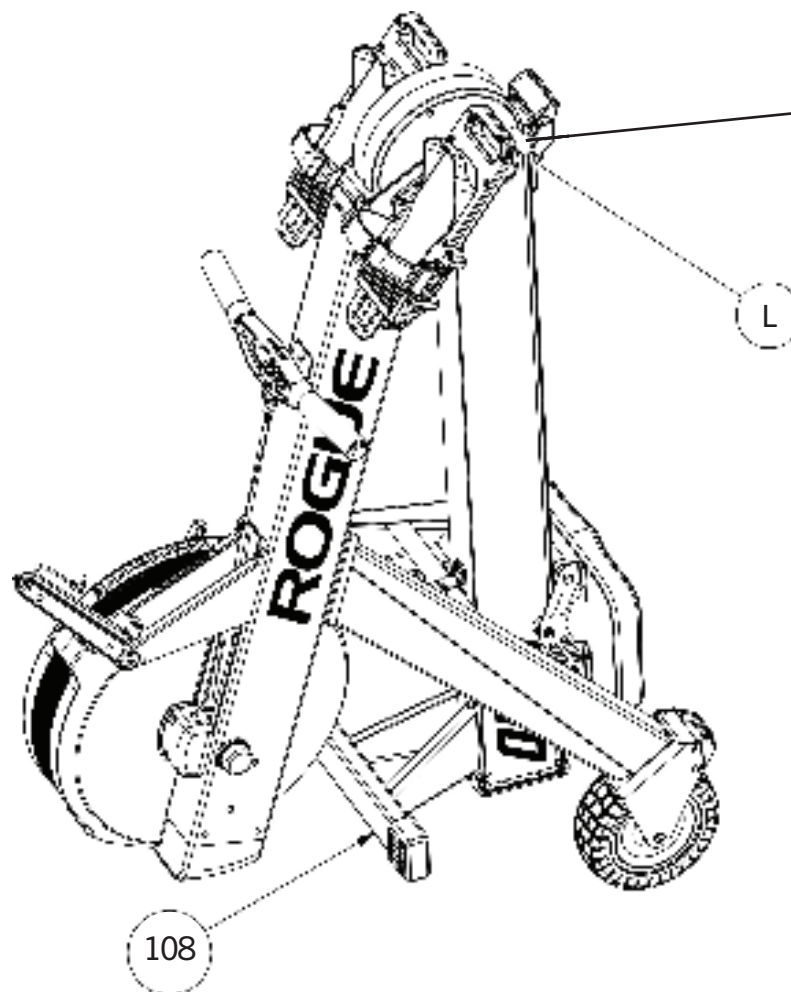

**⚠ CAUTION**  
**PINCH POINT WARNING**  
KEEP YOUR HANDS CLEAR  
OF THE HINGE- DO NOT PUT  
FINGERS ON THE LATCH WHEN  
CLOSING

## STEP 9

- FIRST, LIFT THE LATCH HANDLE (94) ALL THE WAY FORWARD UNTIL IT CATCHES ON THE HOOK (98)
- PULL THE HANDLE (94) BACK DOWN AND PUSH IT FIRMLY CLOSED.

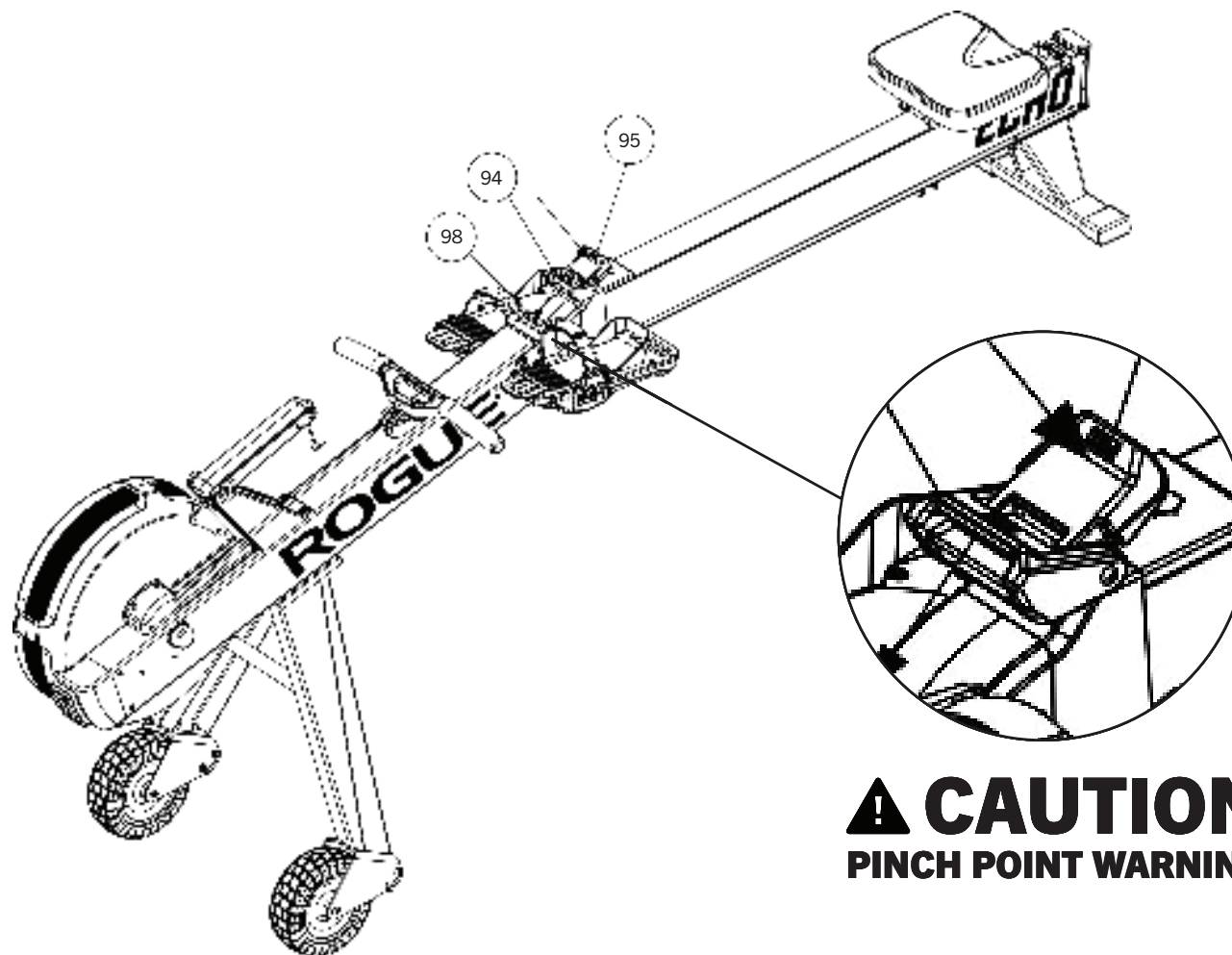

**⚠ CAUTION**  
**PINCH POINT WARNING**

## STEP 10

- LIFT THE REAR LATCH (95) UP BY HAND, AND THE ENTIRE BUCKLE WILL BE RELEASED, ALLOWING THE FRONT AND REAR FRAMES TO FOLD UP

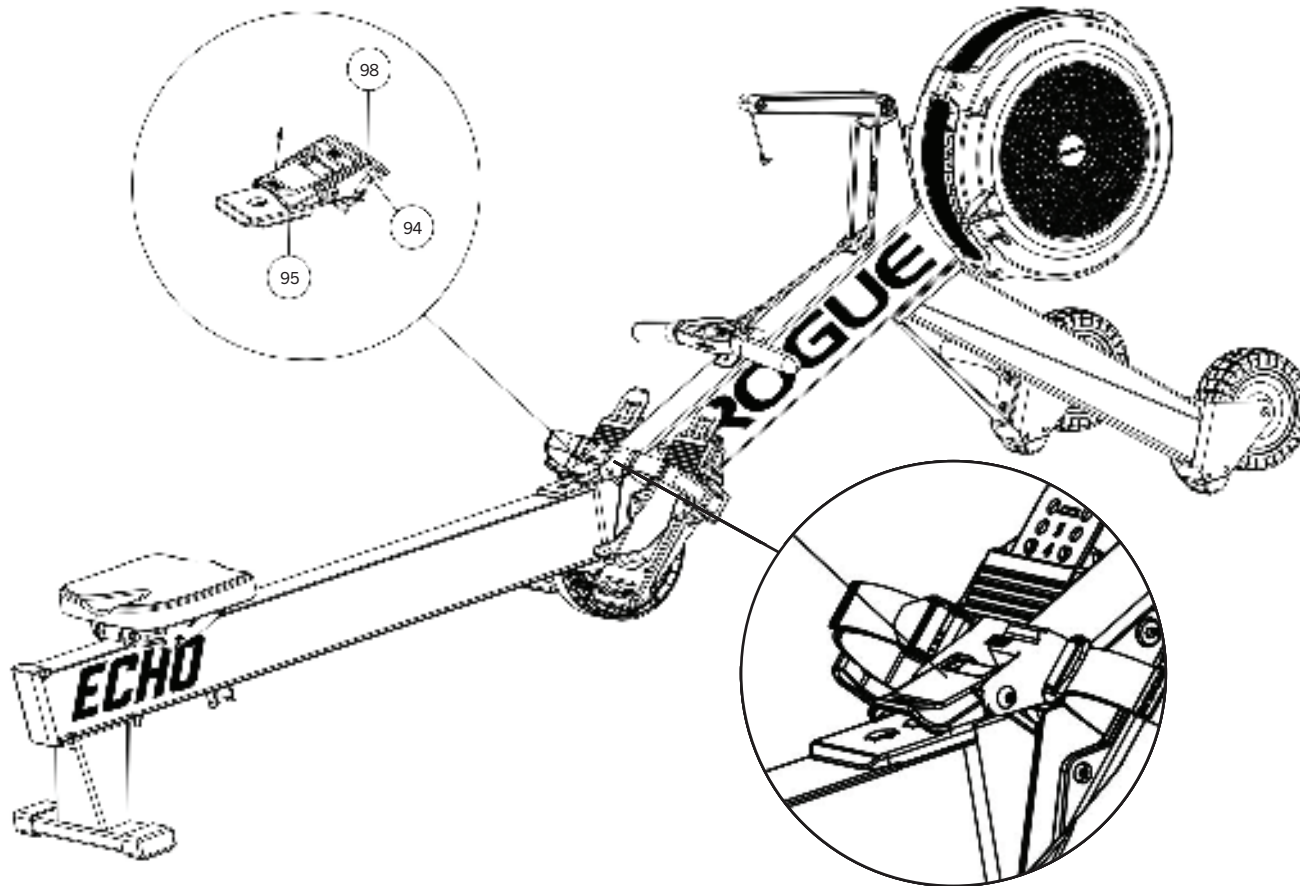

**⚠ CAUTION**  
**PINCH POINT WARNING**

## STEP 11

- INSTALL THE BATTERIES BEFORE ASSEMBLING THE CONSOLE WITH THE ROWER
- REMOVE THE SCREWS AND NUTS FROM THE CONSOLE AND INSTALL THE CONSOLE ONTO THE ROWER
- MAKE SURE THE TAB ON THE ROWER GOES INSIDE THE CURVED POCKET OF THE CONSOLE
- MAKE SURE THE WIRE CANNOT GET PINCHED

\*IF THE WIRE CAN BE PINCHED, YOU DO NOT HAVE THE ROWER TAB INSIDE THE CURVED POCKET

- TIGHTEN THE SCREWS WITH A WRENCH (S27)
- INSERT THE SIGNAL WIRE INTO THE CONSOLE.

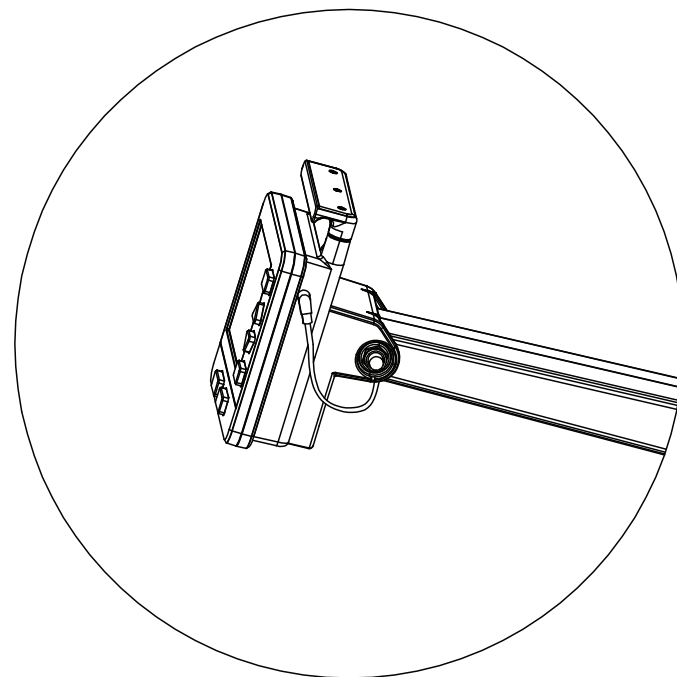
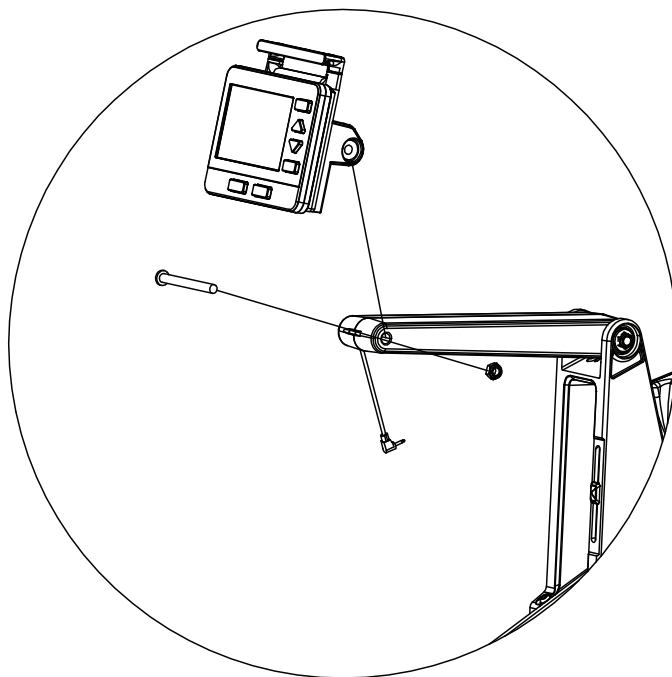
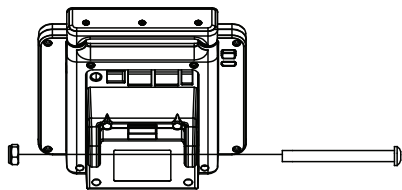

## STEP 12

- CHECK TO MAKE SURE THE ROWER IS STABLE, AND FUNCTIONS PROPERLY
- ROW EASY AT FIRST TO CONFIRM FUNCTION

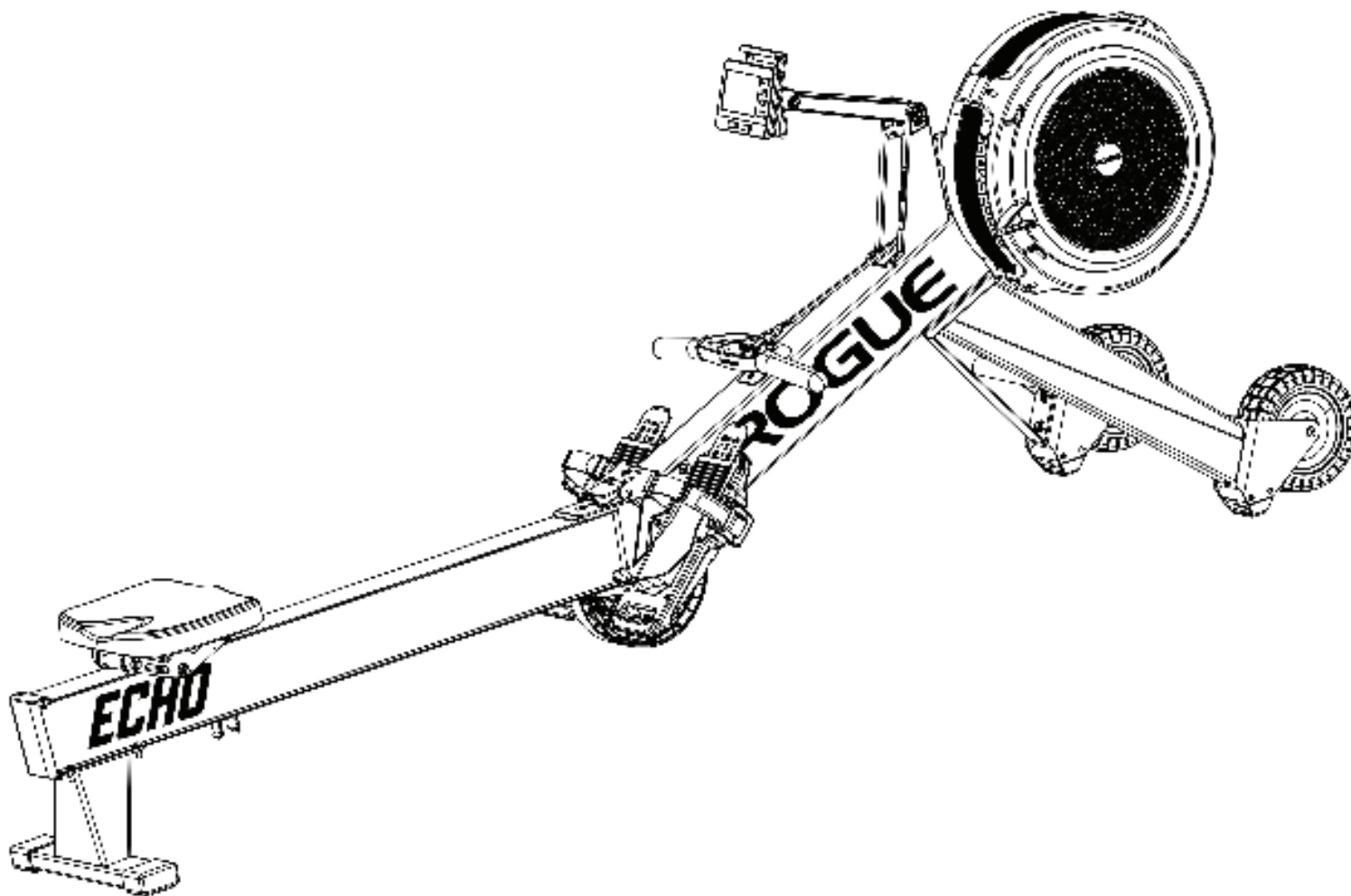

**— ROGUE —**



**SCAN FOR  
INSTRUCTIONS**

**— ROGUE —**



**IRON GAME  
PROGRAMMING**