

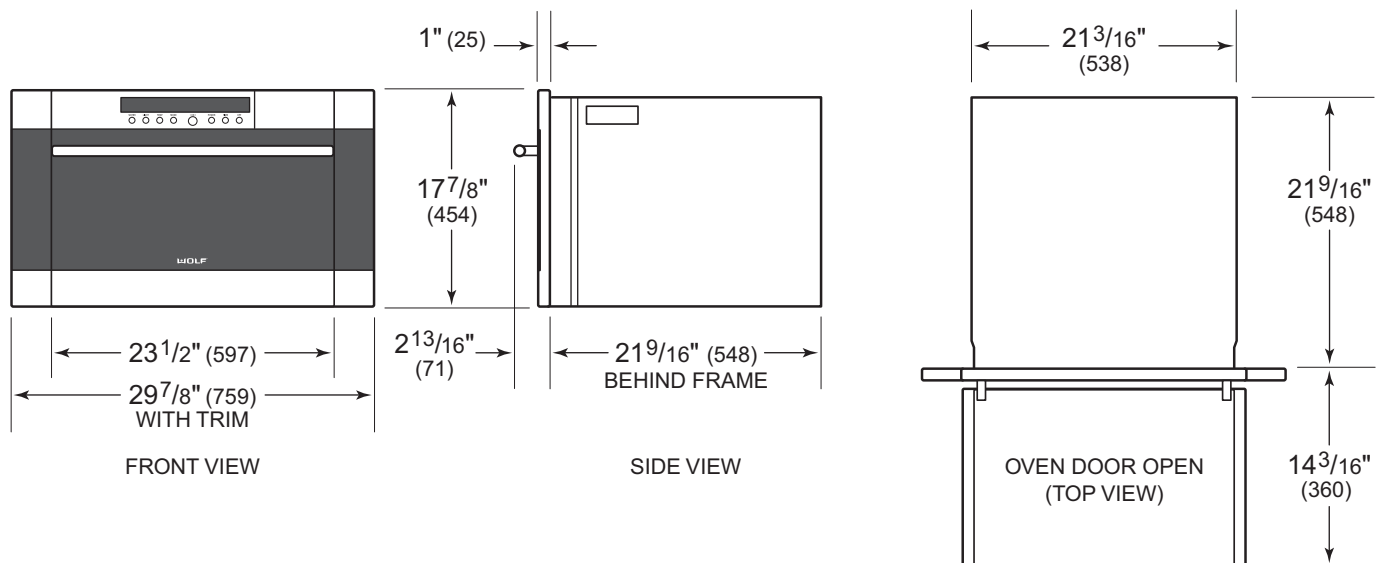

## INSTALLATION INFORMATION

This section of the manual covers some of the installation issues that a service technician may need to know when servicing a Wolf convection steam oven. If additional installation information is needed after reviewing this section of the manual please refer to the installation guide or contact the Wolf Appliance Customer Service Department.

### Overall Dimensions of CS024



### Installation Applications

The convection steam oven can be installed in a standard or flush inset application. The installation opening must have a flat, level base to support the oven. A minimum base support of 100 lbs (45 kg) is required. The electrical supply for the oven must be located in an adjacent cabinet unless the cabinet is deeper than 24" (610) for a standard installation or 25" (635) for a flush inset application.

#### Standard Installation

For standard installations, the convection steam oven is installed by inserting into cabinetry from the front. The oven has face trim on the top and both sides that will overlap stiles and rails. Refer to the chart below for trim overlaps.

Oven Trim Overlap	
Top Overlap	$\frac{3}{16}"$ (5)
Bottom Overlap	0" (0)
Side Overlap	$3\frac{13}{16}"$ (97)

#### Flush Inset Installation

For flush inset installations, the inside edges of the rough opening must be finished, as they will be exposed when the oven door is open. These edges should be stained instead of having a laminated surface, to avoid damage from high temperatures and steam.

#### Combination Installations

The Wolf convection steam oven with trim is designed and agency approved for installation with Wolf cooktops, built-in ovens, microwaves and warming drawers only. For typical combination installations, refer to the illustrations on the following pages.



### Electrical Requirements

#### NOTES:

- Unless using cabinets deeper than 24" (610) for a standard installation or 25" (635) for a flush inset installation, the electrical supply for the convection steam oven must be placed in an adjacent cabinet within reach of the 6' (1.8 m) power cord. Choose the electrical location shown in the illustrations on the following pages that best suits the installation.
- Follow all National Electrical Code regulations. In addition as well as all local codes and ordinances when installing electrical service.
- Performance may be compromised if the electrical supply is less than 240 volts. A ground fault circuit interrupter (GFCI) is not recommended and may cause interruption of operation.

Electrical Requirements	
Electrical Supply	240/208 VAC, 60 Hz
Service	20 amp dedicated circuit
Receptacle	NEMA 6-20R grounding-type
Power Cord	6' (1.8)

#### ⚠ WARNING

**ELECTRICAL SHOCK HAZARD: PLUG INTO A GROUNDED 3-PRONG OUTLET. DO NOT REMOVE THE GROUND PRONG. NO NOT USE AN ADAPTER. FAILURE TO FOLLOW THESE INSTRUCTIONS CAN RESULT IN ELECTRICAL SHOCK, FIRE OR DEATH!**

To minimize shock hazard, the power cord must be plugged into a grounding-type receptacle, grounded to conform with the National Electrical Code, ANSI/NFPA 70 latest edition, or Canadian Electrical Code (CSA) and all local codes and ordinances. Refer to the illustrations below.

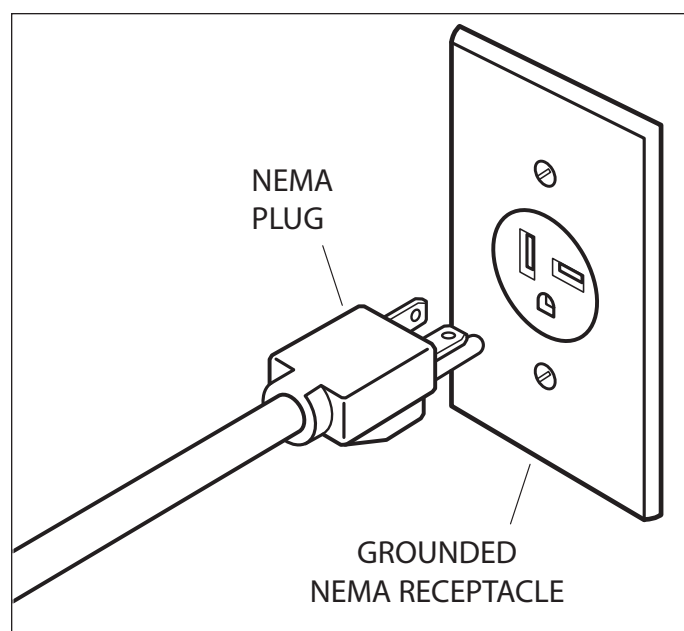

**NEMA 6-20R Receptacle**

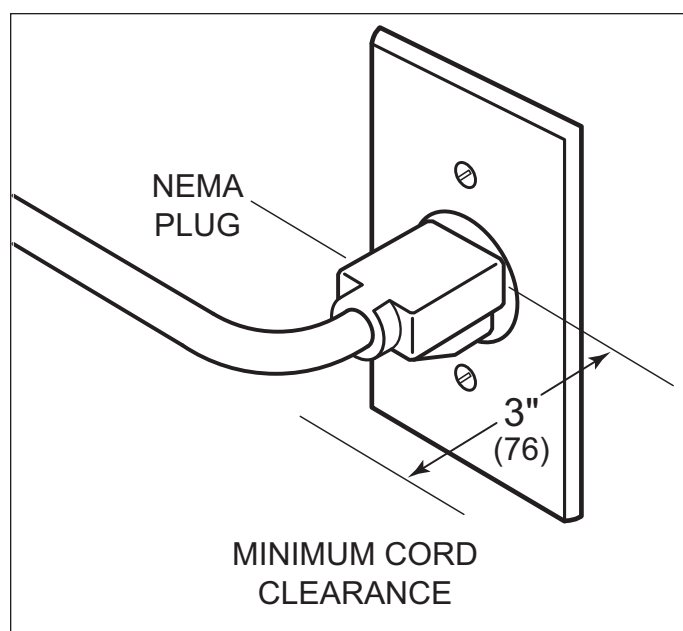

**Power Cord Clearance**

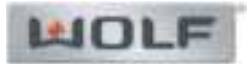

## ROUGH-IN INSTALLATION SPECIFICATIONS

## Standard Installation

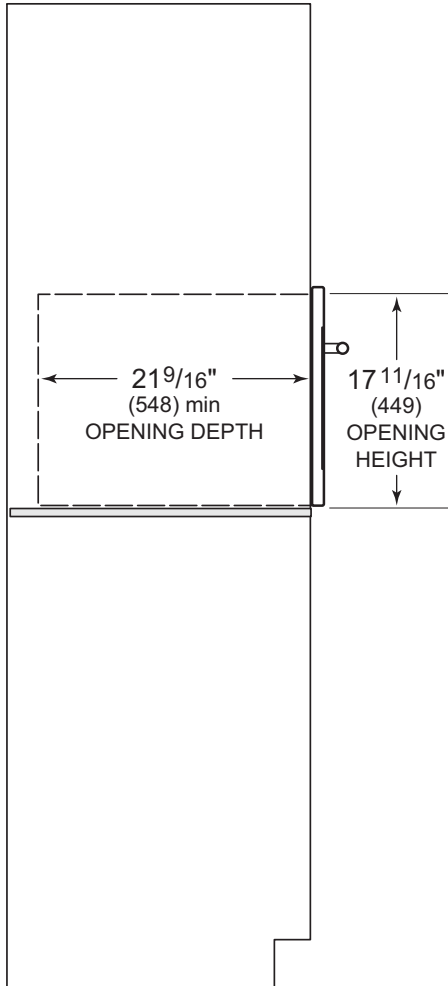

SIDE VIEW



FRONT VIEW

**NOTES:** Minimum base support 100 lbs (45 kg).  
Electrical supply must be located in adjacent cabinet within 3' (.9 m) of opening.  
Dashed line represents profile of unit.



## Flush Inset Installation

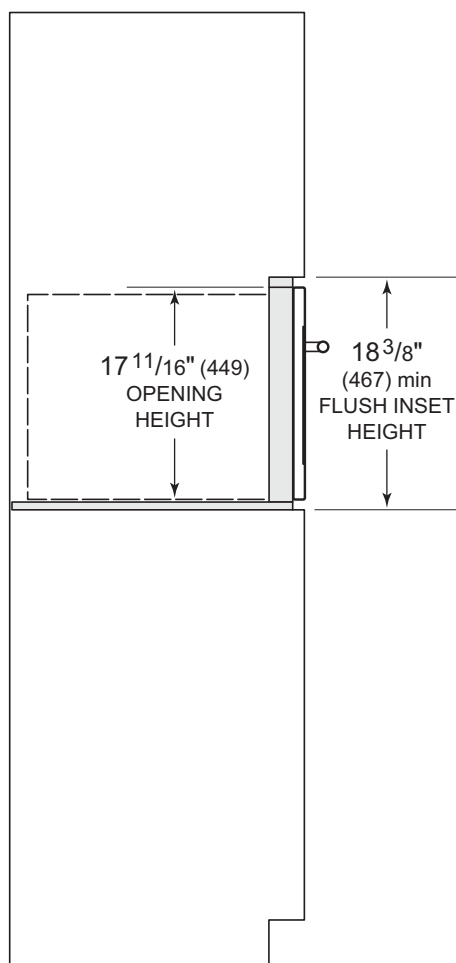
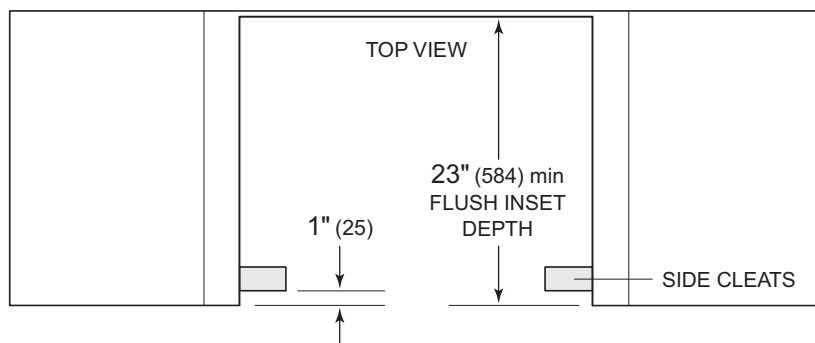

SIDE VIEW

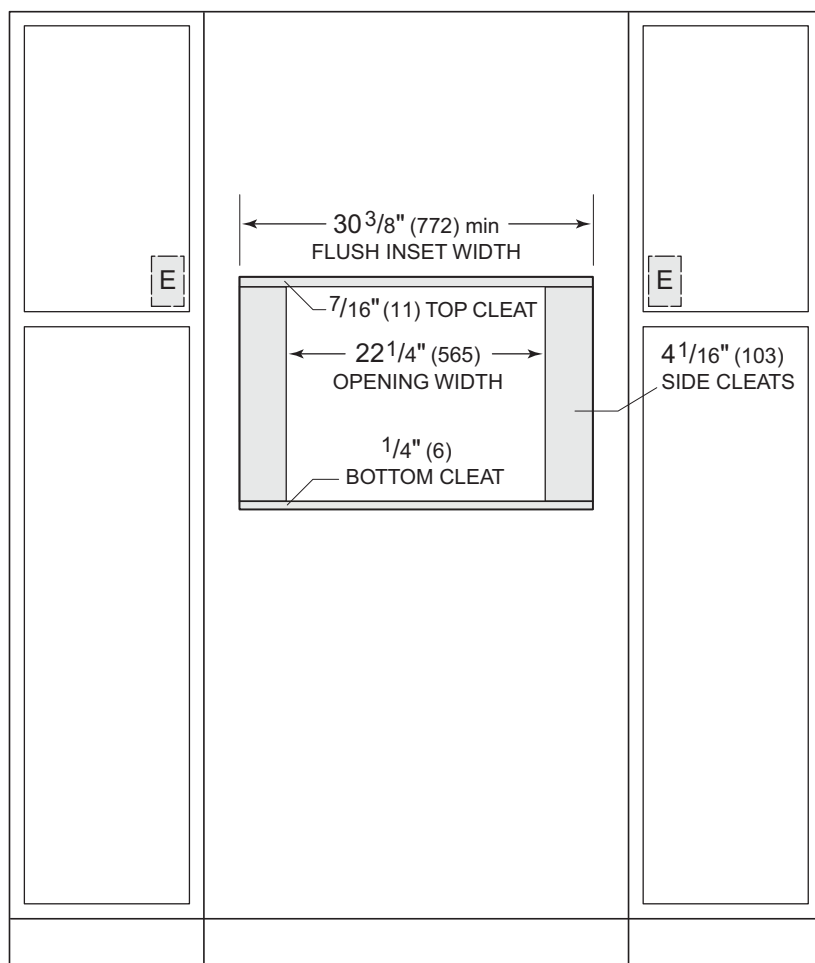

FRONT VIEW

**NOTES:** Minimum base support 100 lbs (45 kg).  
Electrical supply must be located in adjacent cabinet within 3' (.9 m) of opening.  
Cleats may be visible and should be finished to match cabinetry.  
Dashed line represents profile of unit.



Standard Installation with L-Series Wall Oven

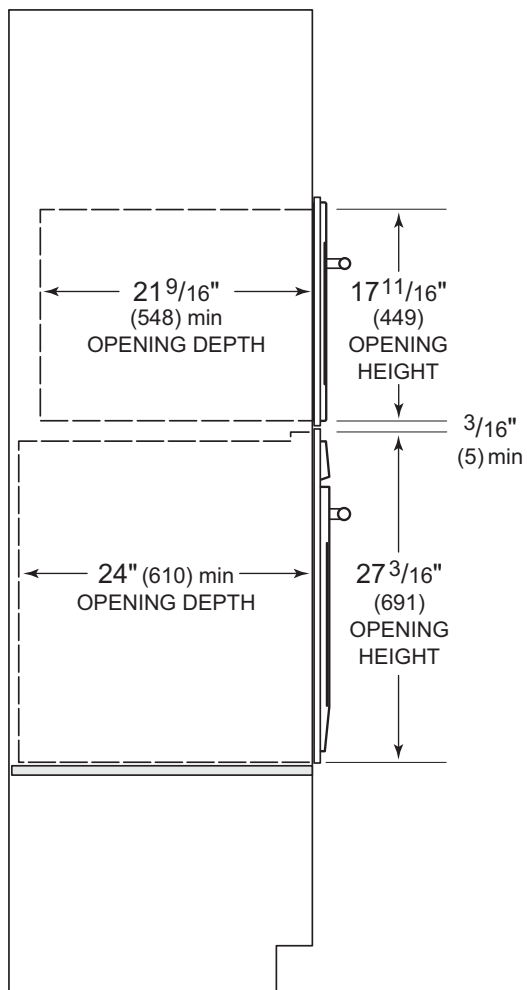

SIDE VIEW

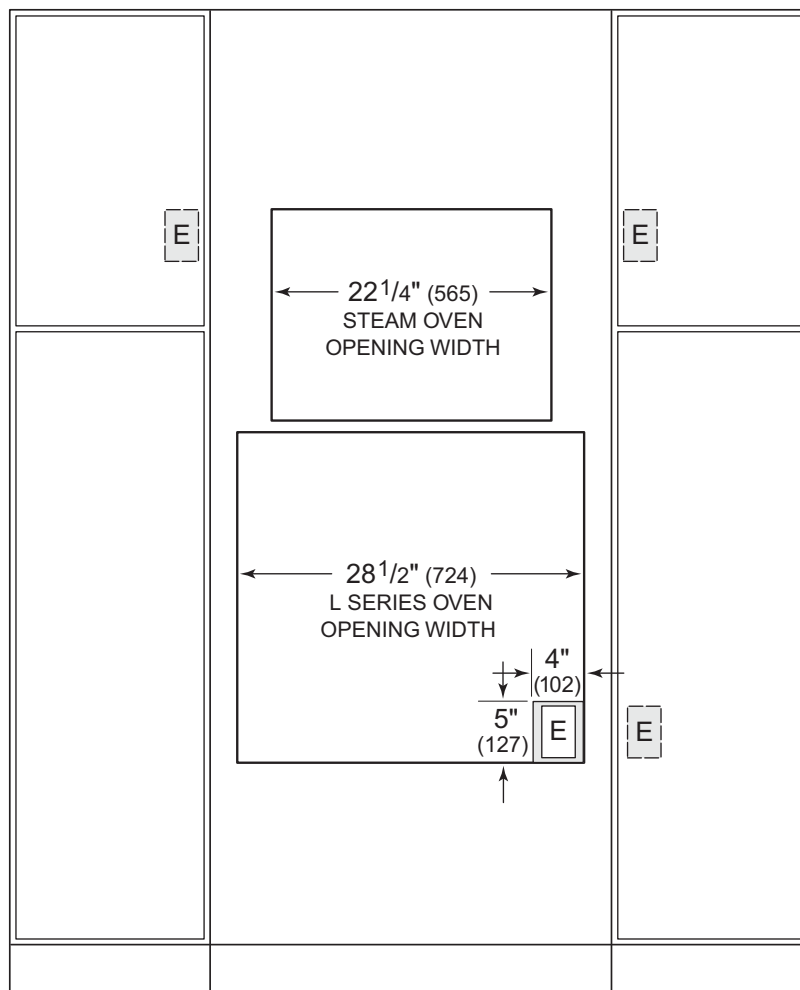

FRONT VIEW

**NOTES:** Minimum base support for steam oven 100 lbs (45 kg) and L series oven 250 lbs (113 kg).  
Electrical supply for steam oven must be located in adjacent cabinet within 3' (.9 m) of opening.  
Location of electrical supply within L series oven opening may require additional cabinet depth.  
Dashed line represents profile of unit.



## Standard Installation with E-Series Wall Oven

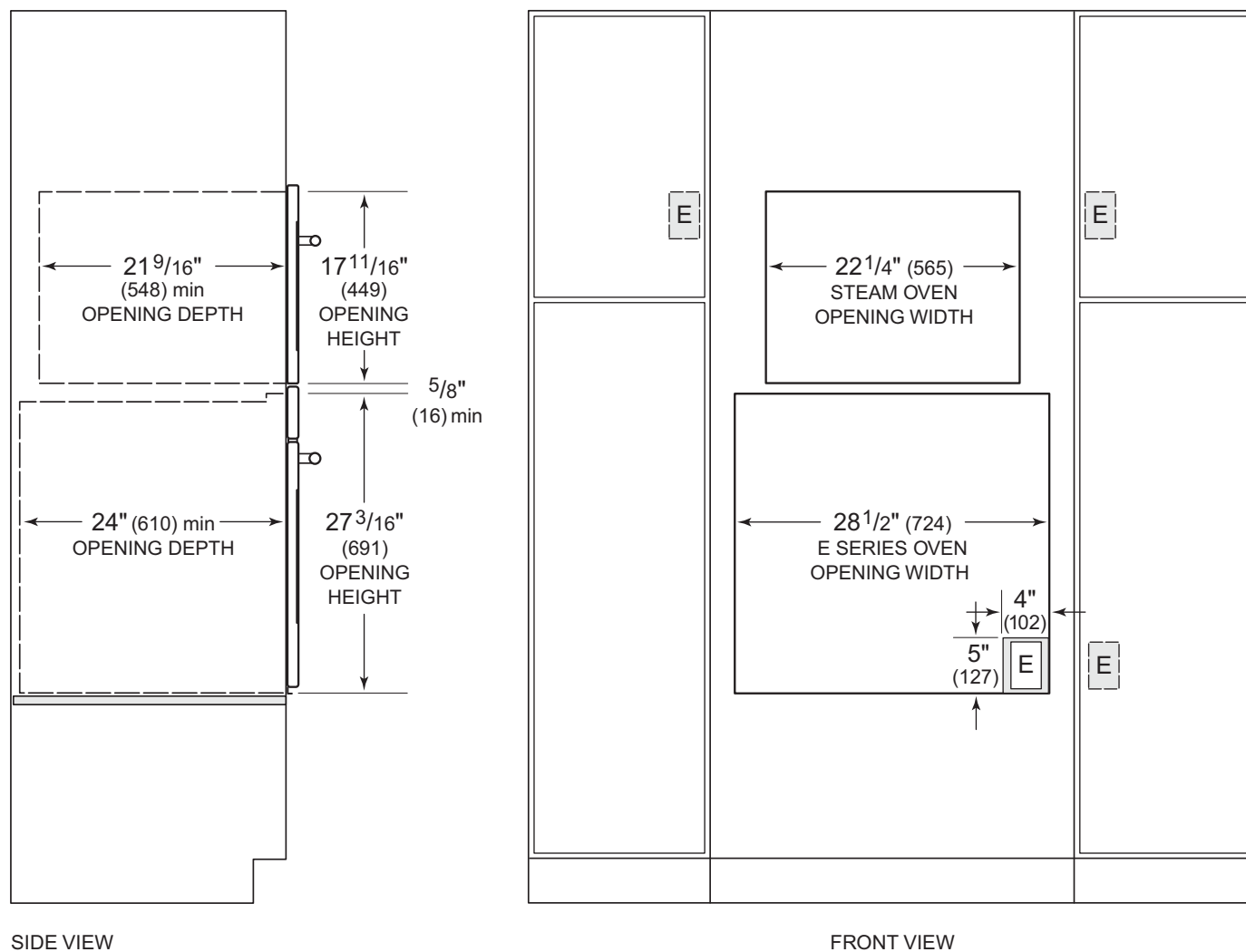

**NOTES:** Minimum base support for steam oven 100 lbs (45 kg) and E series oven 250 lbs (113 kg).  
Electrical supply for steam oven must be located in adjacent cabinet within 3' (.9 m) of opening.  
Location of electrical supply within E series oven opening may require additional cabinet depth.  
Dashed line represents profile of unit.

Flush Inset Installation with E-Series Wall Oven

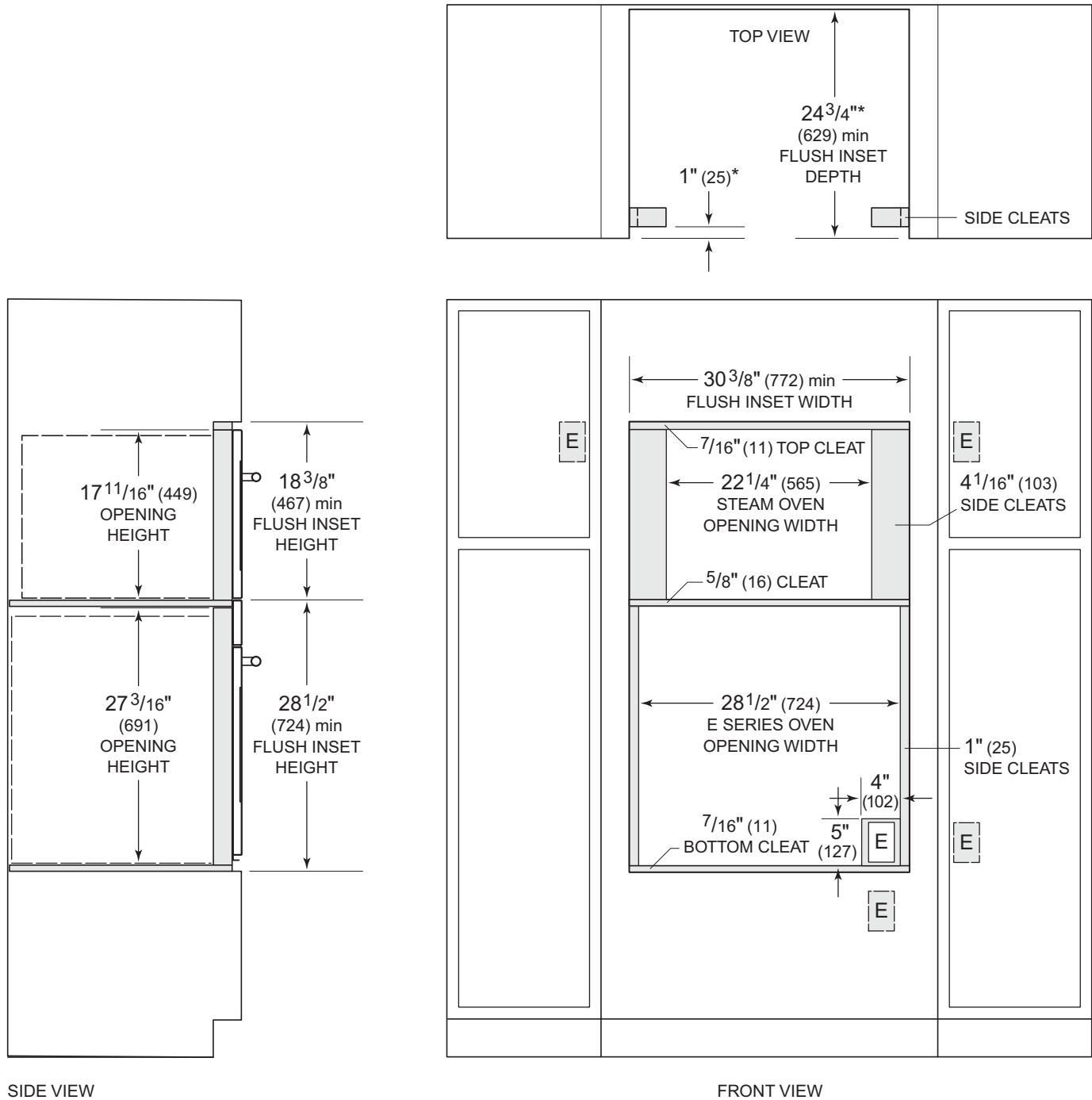

\*For black glass model, increase dimension by <sup>1</sup>/<sub>4</sub>" (6).

**NOTES:** Minimum base support for steam oven 100 lbs (45 kg) and E series oven 250 lbs (113 kg).  
 Electrical supply for steam oven must be located in adjacent cabinet within 3' (.9 m) of opening.  
 Location of electrical supply within E series oven opening may require additional cabinet depth.  
 Cleats may be visible and should be finished to match cabinetry.  
 Dashed line represents profile of unit.



## INSTALLING THE OVEN

### Installation Without Trim

**NOTE:** Before moving the oven, protect any finished flooring and cabinetry to avoid damage.

1. Move the convection steam oven into position near the installation opening. Remove and discard packing materials.
2. Carefully place the oven in the opening. Resting the oven on the cabinet base support, slide the unit into the opening until it is approximately 6" (152) from being fully installed. Guide the power cord through the opening of the adjacent cabinet or base support as the oven is slid into position. Verify the power cord is not trapped between the oven and cabinet wall.
3. Once the oven is fully positioned in the opening, open the oven door and locate the four mounting holes on the oven side trim. Refer to the illustration below. Use a 1/16" drill bit to drill pilot holes into the cabinet.
4. Using the mounting screws provided, secure the oven to the cabinet.

**NOTE:** To avoid interference, a 90 degree door stop may be required for any appliance or cabinet door installed next to the convection steam oven.

### WARNING

**FAILURE TO INSTALL THE MOUNTING SCREWS CAN ALLOW THE OVEN TO TIP FORWARD DURING USE!**

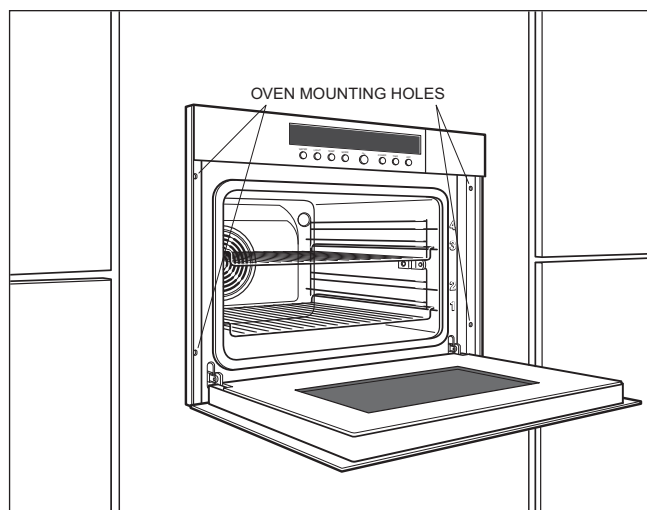

Oven Installation Without Trim



## Installation With Trim

### NOTES:

- Trim kits are an optional sales accessory and not required to install the convection steam oven.
  - Depending on the trim kit you have purchased, trim panels may look slightly different than shown in the illustrations. Not all parts provided with the trim kit will be used for installation with the convection steam oven.
  - Before moving the oven, protect any finished flooring and cabinetry to avoid damage.
1. Move the convection steam oven into position near the installation opening. Remove and discard packing materials.
  2. Position the trim panels as shown below. When properly oriented, the four mounting holes will be positioned near the bottom of the four spacers.
  3. Carefully place the oven in the opening. Resting the oven on the cabinet base support, slide the unit into the opening until it is approximately 6" (152) from being fully installed. Guide the power cord through the opening of the adjacent cabinet or base support as the oven is slid into position. Verify the power cord is not trapped between the oven and cabinet wall.
  4. Continue to slide the unit back into position until it is 1/2" (13) proud of the cabinet face frame. Open the oven door and locate the four mounting holes on the oven side trim. Refer to the illustration below. Use a 1/16" drill bit to drill pilot holes into the cabinet.
  5. Locate the four mounting screws provided with the convection steam oven. Place the left trim panel behind the oven side trim. Slide the left side of the oven back and install two of the mounting screws just far enough to hold the trim in place. Repeat with the right trim panel.
  6. To complete the installation, verify the trim panels align with oven trim and securely tighten all four mounting screws.

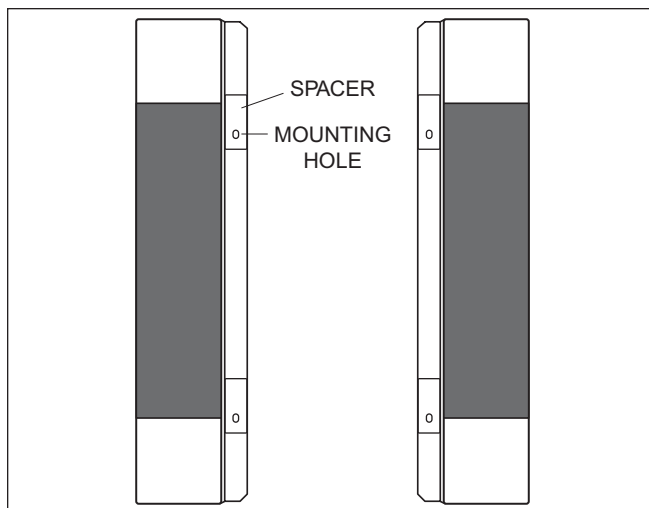

**Trim Panel Orientation**

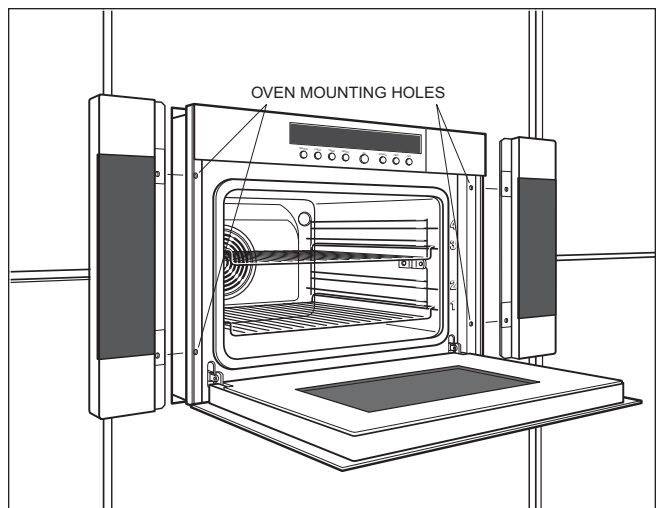

**Oven Installation With Trim**