

# Rinnai

## Operation Manual

### Portable Room Air Conditioner

Models: RPC26WA / RPC35WA / RPC41WA



#### **This appliance shall be installed in accordance with:**

- Manufacturer's Installation Instructions
  - Current AS/NZS 3000
  - Local Regulations and Municipal Building Codes including local OH&S requirements
- This appliance must be installed, maintained and removed only by an Authorised Person.  
For continued safety of this appliance it must be installed and maintained in accordance with the manufacturers instructions.





BEFORE PROCEEDING WITH THE OPERATION OF YOUR NEW RINNAI PORTABLE ROOM AIR  
CONDITIONER PLEASE READ THIS MANUAL THOROUGHLY AND GAIN A FULL UNDERSTANDING OF THE  
REQUIREMENTS, FEATURES AND OPERATION OF YOUR NEW APPLIANCE.

# TABLE OF CONTENTS

<b>Safety &amp; Important Points</b>	<b>4</b>
<b>Warranty &amp; Specifications</b>	<b>5</b>
Unpacking the Appliance .....	5
Warranty .....	5
Specifications .....	5
<b>Air Conditioner Basics</b>	<b>6</b>
Appliance Components .....	6
Control Panel .....	7
Basic Operation .....	7
Basic Operation Control Panel .....	7
COOL .....	7
DRY (Dehumidifying) .....	7
<b>Operation</b>	<b>8</b>
FAN .....	8
SLEEP Function .....	8
<b>Care &amp; Maintenance</b>	<b>9</b>
General Maintenance .....	9
Cleaning the Air Filter .....	9
Save a Service Call .....	10
When to Call for Service .....	10
<b>Installation</b>	<b>11</b>
Location .....	11
Duct Assembly .....	11
Exhaust Ducting Options .....	12
Window Installations .....	12
Semi-Permanent Wall Installation .....	13
Condensate Drainage .....	13
Internal Condensate Tank .....	13
Fixed Condensate Drainage Hose .....	13
<b>Contacts</b>	<b>16</b>

# SAFETY & IMPORTANT POINTS



## READ ALL INSTRUCTIONS BEFORE USING THE APPLIANCE.

Always comply with the following precautions to avoid dangerous situations and to ensure optimum performance.

Failure to carefully read and follow all instructions in this manual can result in equipment malfunction, property damage, personal injury and/or death.

**WARNINGS: WHEN IGNORED, CAN RESULT IN SERIOUS INJURY OR DEATH.**

**CAUTIONS: WHEN IGNORED, CAN RESULT IN MINOR INJURY OR PRODUCT DAMAGE.**



The appliance is fitted with an Australian flexible cord and 2 pin plug intended for connection to an Australian 10 Amp socket outlet. It is not suitable for connection in other countries or alternative power supplies. Ensure that the voltage and frequency of the power supply correspond to the ratings on the dataplate of the appliance.

This appliance is not intended for use by persons (including children) with reduced physical, sensory or mental capabilities, or lack of experience and knowledge, unless they have been given supervision or instruction concerning use of the appliance by a person responsible for their safety.

Young children should be supervised to ensure they do not play with the appliance.

**DO NOT** allow children or persons with reduced physical, sensory or mental capabilities to sleep directly in front of this appliance.

**DO NOT** allow children to 'post articles' into the louvres of the appliance.

**DO NOT** use power boards or double adaptors with this appliance.

**DO NOT** coil or bundle the electric cord to reduce its length as overheating of the cord may occur which could result in a fire hazard.

The flexible cord and plug must not be modified. If the cord or plug are damaged, they must be replaced by Rinnai or a Rinnai appointed service agent.

**DO NOT** cover or place articles on or against any parts of this appliance, to avoid overheating.

**DO NOT** sit on this appliance

**DO NOT** use this appliance in the immediate surroundings of a bath, a shower or a swimming pool.

**DO NOT** move this appliance whilst it is turned on.

**DO NOT** unplug the appliance by pulling on the flexible cord.

**DO NOT** handle any parts of this appliance, including the plug and flexible cord, with wet or damp hands.

**DO NOT** immerse the appliance, flexible cord and plug in water or any other liquid.

**DO NOT** place containers of any liquid or wax on top of this appliance.

Turn off the appliance and unplug from the power socket outlet when not in use.

**DO NOT** use in areas where flammable liquids are stored.

This appliance is suitable for indoor use only.

Never dismantle the appliance. Tampering with electrical connections and components is highly dangerous and may cause appliance malfunction, property damage, personal injury and/or death.

# WARRANTY & SPECIFICATIONS

## UNPACKING THE APPLIANCE

If any damage is evident **DO NOT INSTALL** or **OPERATE** and contact your supplier for advice.

## WARRANTY

The benefits to the consumer given by this warranty are in addition to all other rights and remedies of the consumer under a law in relation to the goods or services to which the warranty relates.

Our goods come with guarantees that cannot be excluded under the Australian Consumer Law. You are entitled to a replacement or refund for a major failure and for compensation for any other loss or damage. You are also entitled to have the goods repaired or replaced if the goods fail to be of acceptable quality and the failure does not amount to a major failure.

This appliance has a 2 year parts warranty from date of purchase. If the product fails within this 2 year period return it to the supplier with proof of purchase for repair or replacement.

Supplier warranty claims for Rinnai products or services must be made by contacting Rinnai Australia. Contact details are on the back of this document.

The following exclusions may cause the warranty to become void and may result in a service charge and costs of parts (if required):

1. Accidental damage and acts of God.
2. Failure due to abuse or misuse, improper maintenance, failure to maintain or improper storage.
3. Failure due to incorrect or unauthorised installations or outdoors use.
4. Failure or damage caused by alterations, service or repair work carried out by persons other than Rinnai service persons or service agents.
5. Where it is found that there is no fault with the appliance and the issue is related to the installation or is due to the failure of electricity supply.

## SPECIFICATIONS

MODEL		RPC26WA	RPC35WA	RPC41WA
Power Supply	V/Hz	220-240~ / 50		
Maximum Input Power	W	1200	1600	2000
Dimensions - Net (H x W x D)	mm	798 x 475 x 417		
Dimensions - Packing (H x W x D)		890 x 520 x 450		
Weight	kg	32		
Nominal Cooling Capacity	kW	2.60	3.55	4.10
Rated Input Current	A	4.45	5.95	7.89
Rated Input Power	kW	1.00	1.34	1.78
Refrigerant	Type	R410A		
Refrigerant Volume	g	350	520	520

# AIR CONDITIONER BASICS

## APPLIANCE COMPONENTS

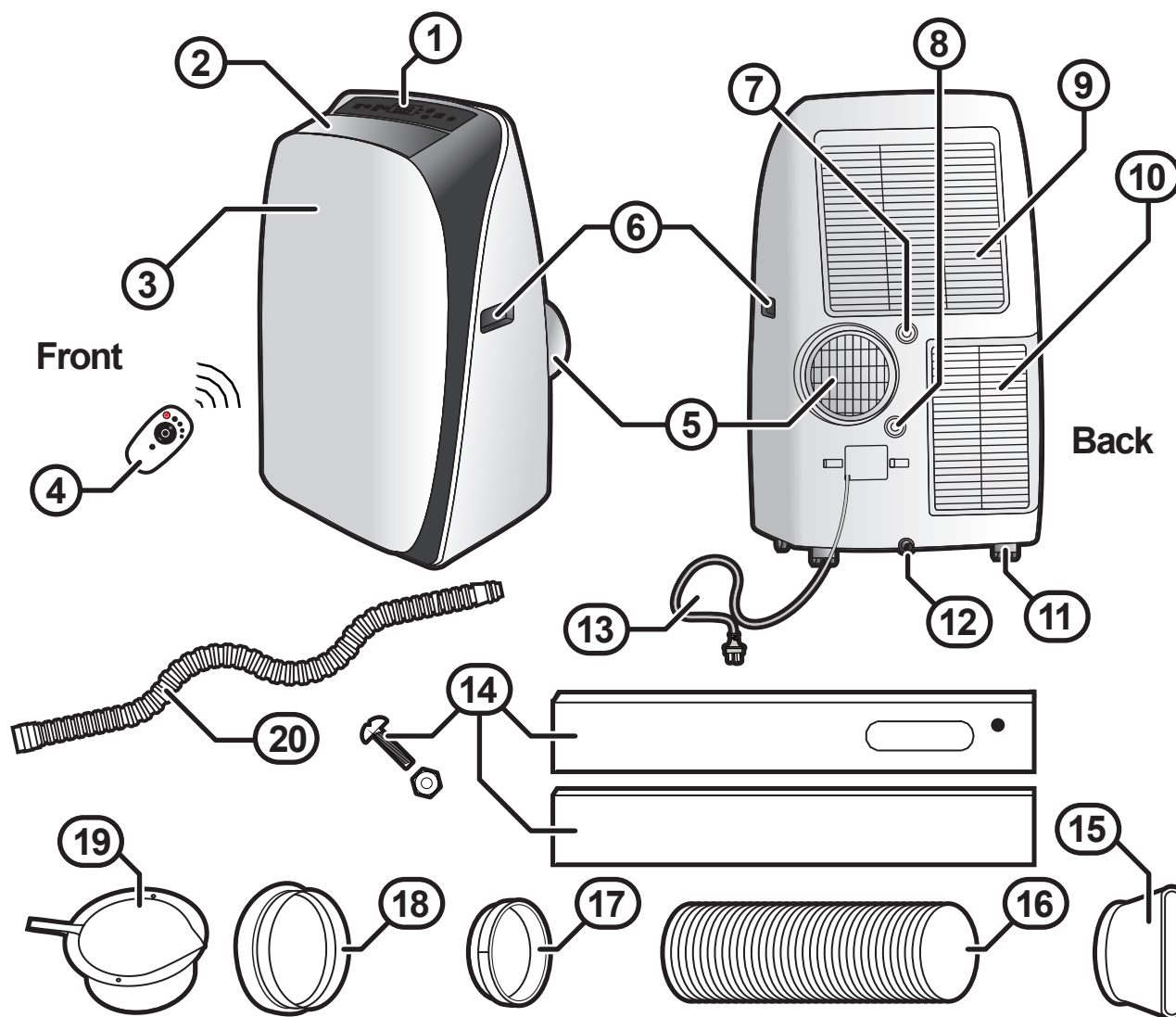

1. Control panel	2. Cool air outlet
3. Receiver window	4. Remote control (Refer separate Remote Control Manual)
5. Exhaust outlet	6. Carry handles
7. Drain outlet 1	8. Drain outlet 2 (not used on this model)
9. Room air intake (filter located behind grill)	10. Lower air intake (filter located behind grill)
11. Swivel casters (x4)	12. Drain tray outlet
13. 1.2m flexible 2 pin cord 220-240V 50Hz 10A	14. Adjustable window slide kit
15. Window exhaust duct window adaptor.	16. Exhaust duct (extends to 1.8M)
17. Duct to appliance adaptor	18. Wall exhaust adaptor
19. Wall exhaust terminal	20. Condensate drain hose

## CONTROL PANEL

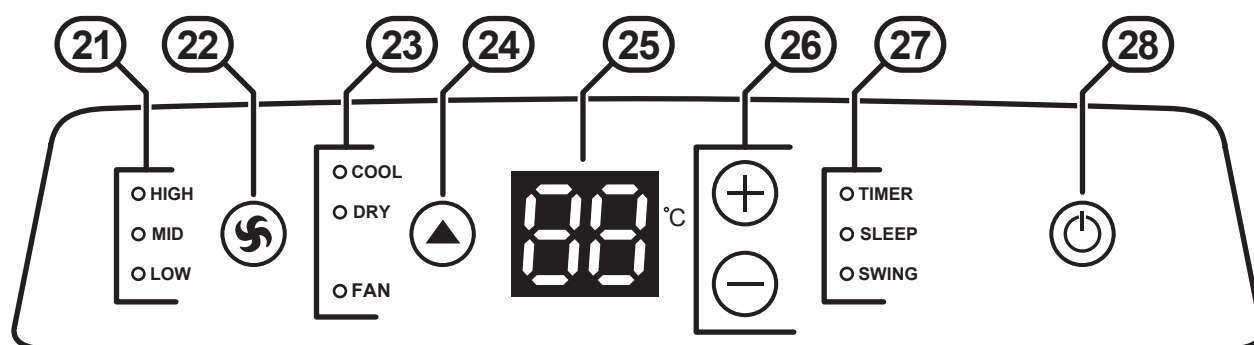

21. Fan Speed Indicators	22. Fan Speed Button
23. Mode Indicators	24. Mode selection Button
25. Temperature Display	26. Temperature Buttons
27. Function Indicators	28. ON/OFF Button



Before operating this appliance ensure that the location, installation and condensation requirements have been met, refer to installation instructions starting on page 11 for details.

For the best cooling results ensure that the filters are clean, refer page 9 for details.

When the appliance is plugged and the power point is turned on a single beep will be heard and the cool air outlet louvre will cycle open and closed once, this is normal.

## BASIC OPERATION

There are three basic operational modes available, these are COOL (chilled air operation), DRY (chilled and dehumidified operation) and FAN (fan only operation).

### BASIC OPERATION CONTROL PANEL

#### COOL

1. Press the ON/OFF button (28).
2. Press the mode button (24) until the COOL mode indicator is illuminated.
3. Use temperature buttons (26) to select the desired temperature (16°C to 32°C)
4. Use fan speed button (22) to select the desired fan speed (LOW, MED or HIGH).
5. Press the ON/OFF button (28) to stop operation.

#### DRY (DEHUMIDIFYING)

1. Press the ON/OFF button (28).
2. Press the mode button (24) until the DRY mode indicator is illuminated.
3. Use temperature buttons (26) to select the desired temperature (16°C to 32°C)
4. Press the ON/OFF button (28)

# OPERATION

## FAN

1. Press the ON/OFF button (28).
2. Press the mode button (24) until the FAN mode indicator is illuminated.
3. Use fan speed buttons (22) to select the desired fan speed (LOW, MED or HIGH).
4. Press the ON/OFF button (28)



The most recent basic operational settings are stored in the appliances memory.

If the appliance is not disconnected from the mains power supply then these setting will be available the next time the appliance is turned on via the ON/OFF button (28).

## SLEEP FUNCTION

The SLEEP function allows the set temperature to increase and decrease over a 10 hour period at pre-set time intervals to maintain your comfort while saving energy after the 10 hours has passed the appliance will resume normal operation (see graph below)..

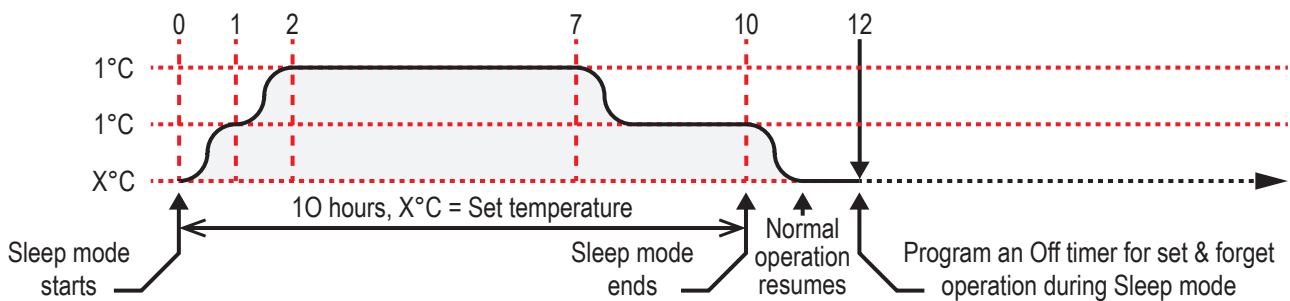



## CARE & MAINTENANCE

### GENERAL MAINTENANCE

It is recommended that after each cooling season the exterior panels and display of the appliance are cleaned with a soft damp cloth.

Air filters should be checked and cleaned every week during periods of heavy use. For intermittent use this can be extended to 2 to 3 weeks.

If storing the appliance for a prolong period remove the plugs and hoses from the drain outlets (7) , (8) and (12).



**ALWAYS turn off the power before you perform any maintenance.**

**DO NOT use solvents, alcohol or harsh cleaners on this appliance or the filters.**

**NEVER use water that is hotter than 40°C when you clean the filters. It may cause deformation or discolouration.**

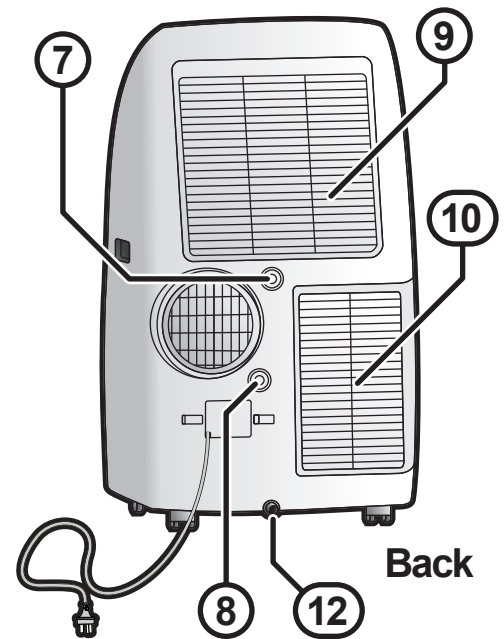

### CLEANING THE AIR FILTER

There are two air filters in this appliance, there is one filter each fitted to the inside of the Room Air Intake Grill (9), and the Lower Air Intake (10).

Before removing the grills, ensure the power cord is disconnected from the power supply.

1. Remove the grills:

To remove the Room Air Intake Grill (9) pull down on the top tab and un-clip the grill.

To remove the Lower Air Intake Grill (10) use a Philips head screw driver to remove the securing screw and un-clip the grill.

2. Un-clip the filters from each of the grills. Clean the filters with a vacuum cleaner or with warm water. If dirt is difficult to remove, wash the filter in lukewarm water with a mild detergent.

3. Ensuring that the filters are dry before replacing, then clip the filters back into the grill covers.

4. Re-attach the grills:

To re-attach the Room Air Intake Grill (9) ensure that all the tabs are properly seated and that the grill is securely clipped back into place.

To re-attach the Lower Air Intake Grill (10) ensure that all the tabs are properly seated and that the grill is securely clipped back into place and that the securing screw is replaced.

The power may now be reconnected.



**Failure to clean the filters regularly can cause excessive condensation to form and reduce the appliances efficiency.**

**If you need replacement filters, please contact Rinnai.**

**SAVE A SERVICE CALL**

SYMPTOM	POSSIBLE CAUSES	POSSIBLE SOLUTIONS
Appliance will not operate.	Not plugged into power.	Plug into power.
	Power switch OFF.	Switch power ON.
	Timer Function set.	Wait or reset timer function.
Power to Appliance but it will not start.	After switching off the appliance there may be a 3 minute delay before it may be re-started.	Wait 3 minutes.
	Room temperature is lower than the set temperature.	Adjust the set temperature to be lower than the room temperature.
	P1 appears on the display.	Drain the water from the drain outlets.
The air conditioner does not generate enough cool air.	The air intake filters are blocked	Clean air filters.
	The set temperature is too high.	Adjust the set temperature to a lower temperature.
	Drafts from open windows and doors.	Close windows and doors in the area you want to be cooled.
	Other heat sources in the room.	Remove or turn off heat sources.
	Cooling space too big.	Operate the appliance within the required cooling capacity.
Too noisy or vibrating.	Operating surface not level	Move the appliance to level a operating surface.
Splashing sound.	High level of condensate being generated.	This is normal. This appliance has a pump that evaporates some condensate through the exhaust duct.

**WHEN TO CALL FOR SERVICE**

SYMPTOM	CAUSE
<p>There is a burning smell and a strange sound coming from the unit.</p> <p>When operated if a circuit breaker (safety, ground) is thrown or a fuse is blown.</p>	Turn off the air conditioner, and contact Rinnai.

# INSTALLATION

## LOCATION

This portable air conditioner must be installed on a flat and dry surface. A minimum clearance of 500mm from walls or other appliances is required as well as easy access to a power point (GPO).

The air outlets and the ducting system must not be obstructed.



The appliance is fitted with a 1.2m flexible 2 pin cord 220-240V 50Hz 10A.

The maximum duct extension is 1.8m in total.

Both factors are to be taken into account when determining the location that the appliance will be operated in.

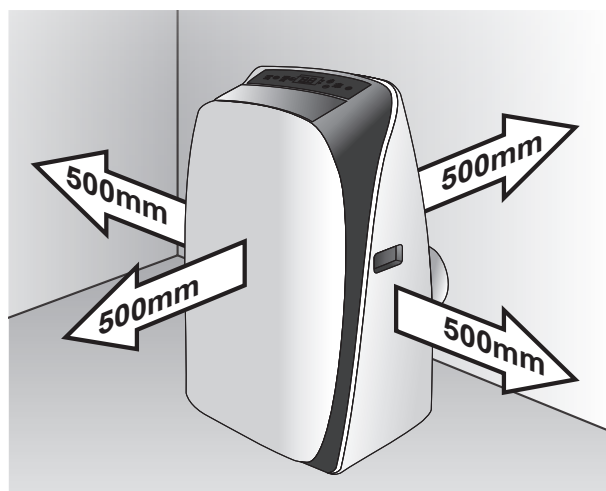

## DUCT ASSEMBLY

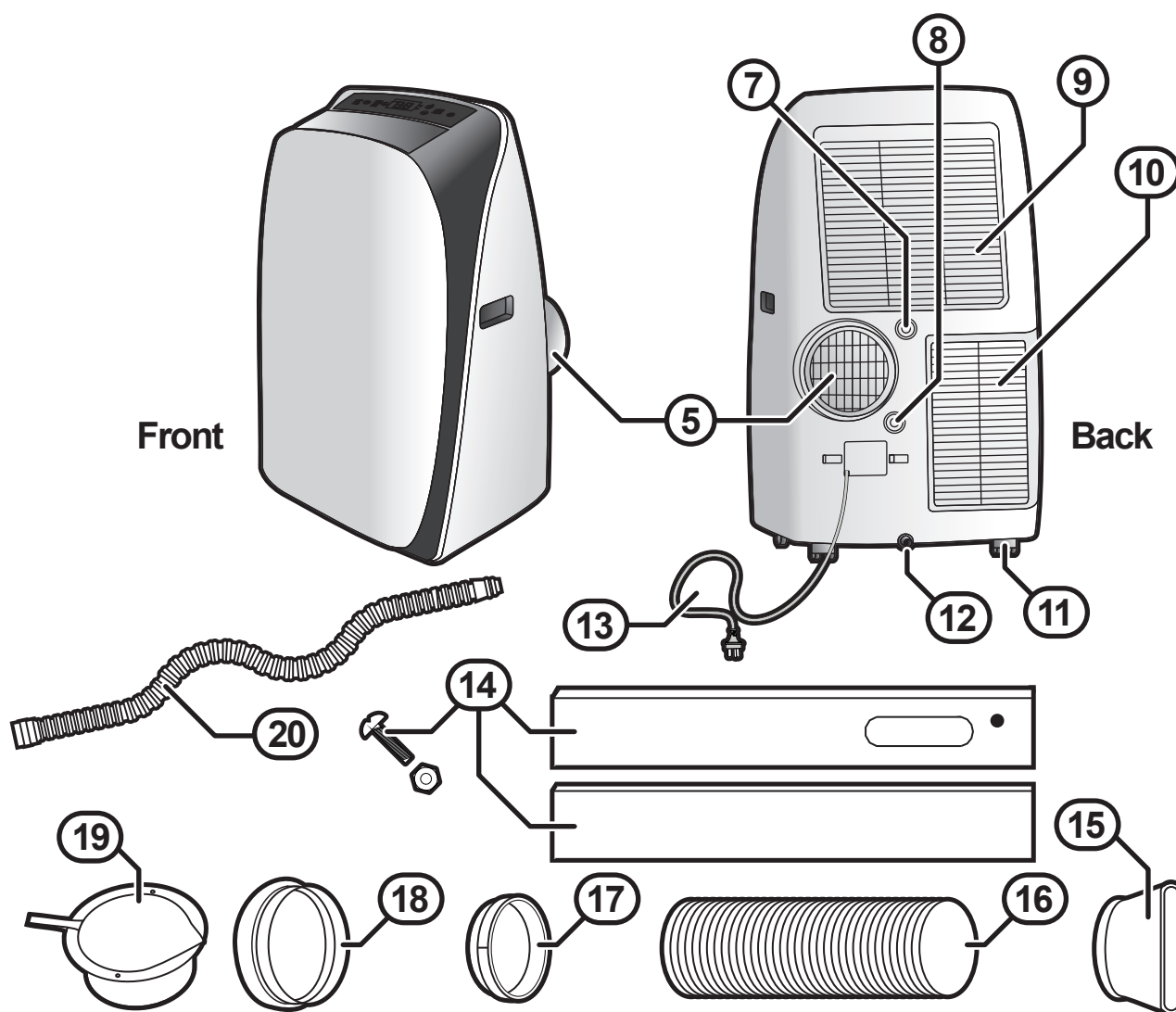

1. Place the Duct to Unit Adaptor (17) over the Exhaust Outlet (5), push it downwards to ensure it engages the Exhaust Outlet tabs.
2. Screw one end of the Exhaust Duct (16) into the Duct to Unit Adaptor (17).
3. On the other end of the Exhaust Duct (16) fix either the Window Exhaust Duct Adaptor (15) or the Wall Exhaust Adaptor (18).

## EXHAUST DUCTING OPTIONS

There are two ducting options available for this appliance, these are a Window installation or an optional Semi-permanent wall installation.



**DO NOT** over extend the exhaust duct.

Over extension of the exhaust duct can lead to kinking.

Kinked ducting causes air flow restrictions and lowers the efficiency of the appliance.

Keeping the exhaust duct as short as possible avoids this issue.

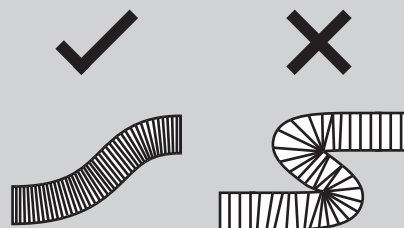

## WINDOW INSTALLATIONS

The window kit has been designed to fit most standard vertical and horizontal window applications. There may be some cases where you may need to modify some aspects of this installation procedure for certain window types.

Minimum and maximum horizontal / vertical window opening dimensions:

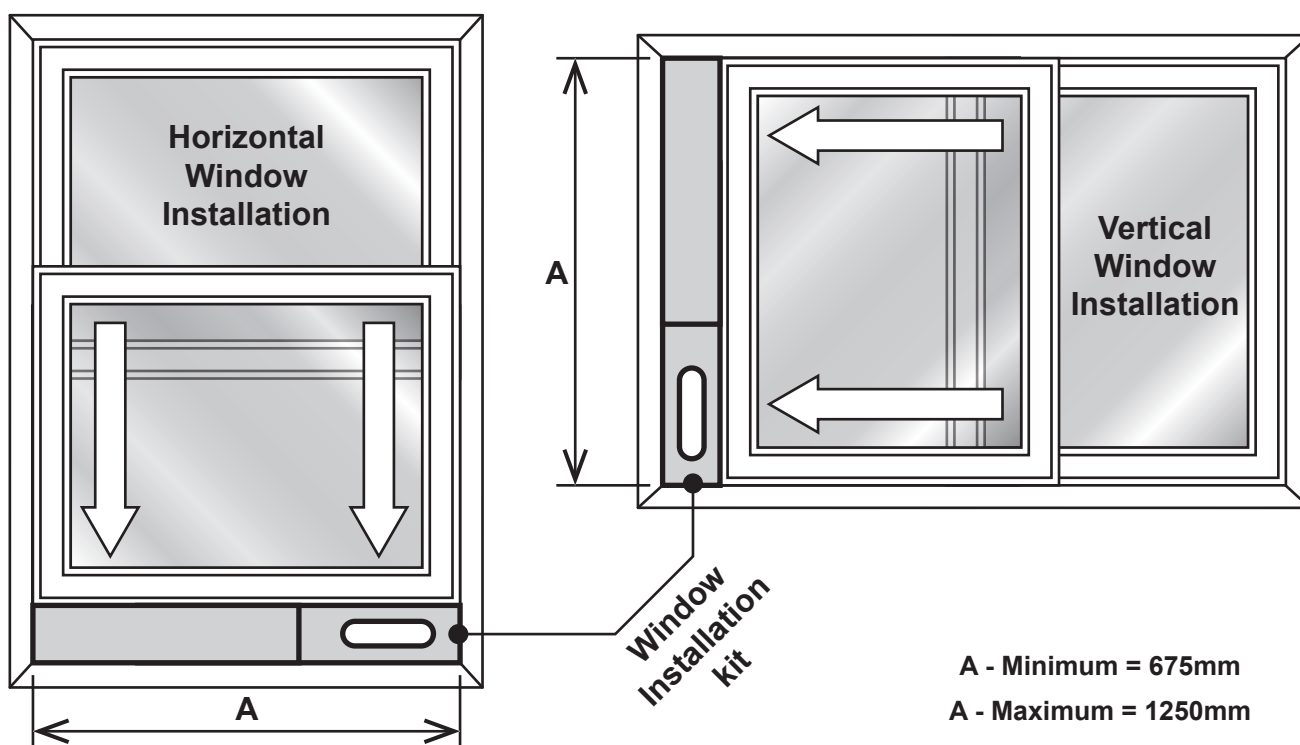

- Once a suitable window has been chosen, fit the Adjustable Slider Kit (14) into the window areas and fix the length of the kit using the supplied slide lock nut and bolt.

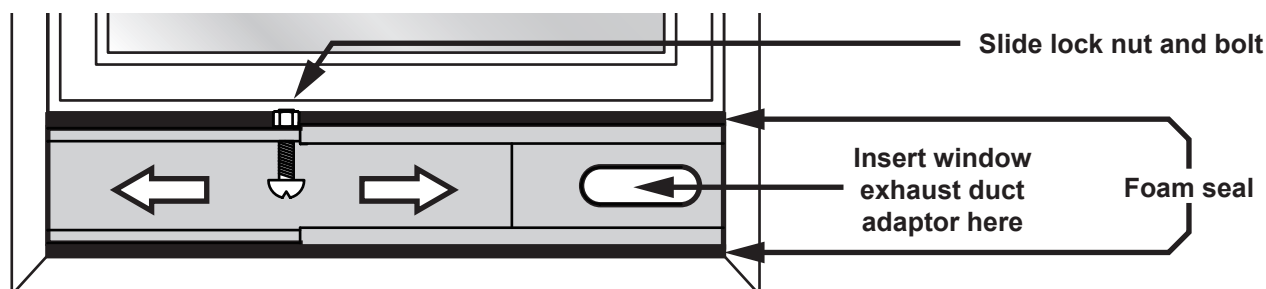

It is recommended to place a length of foam draft sealing strip along the top and bottom edges of the kit or the inside the window opening to form a seal.

- Connect the Window Exhaust Duct Adaptor (15) to the Adjustable Slider Kit (14).

## SEMI-PERMANENT WALL INSTALLATION

In some cases a window opening might not be assessable; therefore this appliance is supplied with semi-permanent wall flange kit that can be connected the Exhaust Duct.



The positioning and installation of the wall flange should be completed by an authorised person and must comply with all municipal building codes and OH&S guidelines.

## CONDENSATE DRAINAGE



Condensate produced by this appliance is NOT potable, dispose of via waste outlet or allow to evaporate.

### INTERNAL CONDENSATE TANK

During operation the appliance may produce small amounts of condensate. The appliance has an inbuilt condensate tank. If all three drain outlets (7), (8) and (12) are plugged, then this tank may reach capacity. If this happens, the appliance will stop operation and the condensate full code "P1" will be shown on the control panel display and the condensate tank will need to be drained before operation can be resumed. To do this:

1. Place shallow tray such as an oven baking tray or similar (with at least a 1 litre volume) under Drain Tray Outlet (12).
2. Remove the plug from Drain Tray Outlet (12) and drain out the condensate water, once the condensate is drained replace the plug, the appliance will now be able to then resume operation.

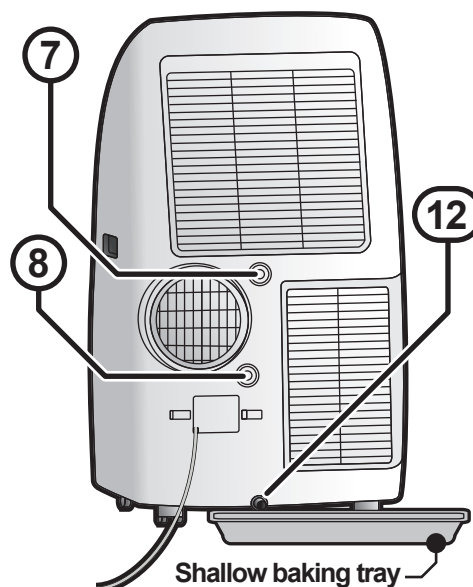

### FIXED CONDENSATE DRAINAGE HOSE

As an alternative to using the appliances internal condensate tank, a condensate drain hose (20) may be fitted.

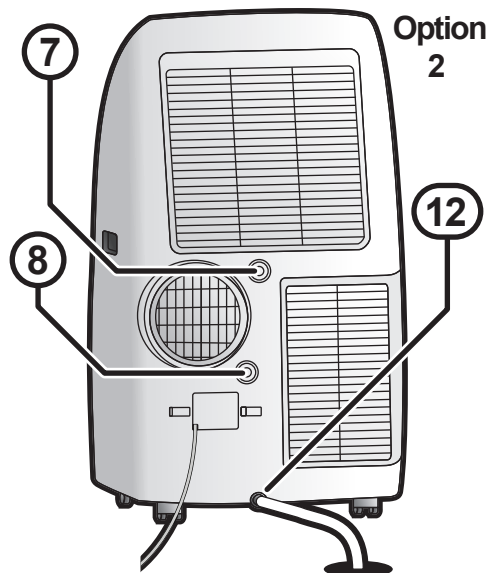
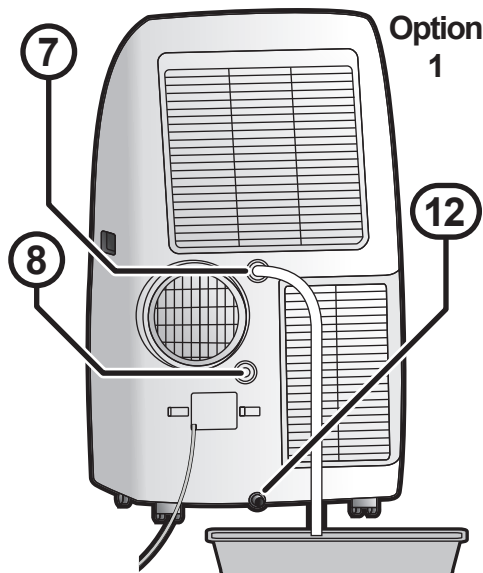

Option 1 - External Drain Tray: with drain outlets (8) and (12) plugged, fit the condensate drain hose (20) to drain outlet (7) and drain the condensate into a drain tray.

Option 2 - Existing Waste Outlet: with drain outlets (7) and (8) plugged, fit the condensate drain hose (20) to drain outlet (12) and drain the condensate into a drain tray or waste outlet.



The point to which the condensate is to be drained MUST BE lower than the drainage outlet point. When using a drain tray option, ensure that the capacity of the tray is greater than that of the condensate being produced.

## NOTES





# Rinnai

**Rinnai Australia Pty. Ltd.**

ABN 74 005 138 769

**100 Atlantic Drive  
Keysborough, Victoria 3173**

**P.O. Box 460  
Braeside, Victoria 3195**

**AU45204**

Rinnai has a Service and Spare Parts network with personnel who are fully trained and equipped to give the best service on your Rinnai appliance. If your appliance requires service, please call our National Help Line. Rinnai recommends that this appliance be serviced at least every 2 years.

With our policy of continuous improvement, we reserve the right to change, or discontinue at any time, specifications or designs without notice.

**Product Sales & Service National Help Line**

Tel: **1300 555 545\*** Fax: **1300 555 655**

\*Monday to Friday, 8.00am to 5.30pm EST

For further information visit **[www.rinnai.com.au](http://www.rinnai.com.au)**  
or email **[enquiry@rinnai.com.au](mailto:enquiry@rinnai.com.au)**