



# RAV4

2 0 1 3



QUICK REFERENCE GUIDE

# 2013 RAV4

This *Quick Reference Guide* is a summary of basic vehicle operations. It contains brief descriptions of fundamental operations so you can locate and use the vehicle's main equipment quickly and easily.

The *Quick Reference Guide* is not intended as a substitute for the *Owner's Manual* located in the vehicle's glove box. We strongly encourage you to review the *Owner's Manual* and supplementary manuals so you will have a better understanding of the vehicle's capabilities and limitations.

Your dealership and the entire staff of Toyota Motor Sales, U.S.A., Inc. wish you many years of satisfied driving in your new RAV4.

## A word about safe vehicle operations

This *Quick Reference Guide* is not a full description of RAV4 operations. Every RAV4 owner should review the *Owner's Manual* that accompanies this vehicle.

Pay special attention to the boxed information highlighted in color throughout the *Owner's Manual*. Each box contains safe operating instructions to help you avoid injury or equipment malfunction.

All information in this *Quick Reference Guide* is current at the time of printing. Toyota reserves the right to make changes at any time without notice.

# INDEX

OVERVIEW	Engine maintenance	9
	Fuel tank door release and cap	8
	Hood release	8
	Indicator symbols	4-5
	Instrument cluster	4
	Instrument panel	2-3
	<i>Keyless entry*</i>	<b>6</b>
	<i>Smart Key system*</i>	<b>7</b>
FEATURES/OPERATIONS	Active torque control AWD (AWD models)	11
	Air Conditioning/Heating	18-19
	Audio	20-21
	<i>Auto lock/unlock*</i>	<b>10</b>
	Automatic Transmission	10
	Bottle holders	25
	Blind Spot Monitor (BSM) with Rear Cross Traffic Alert	24
	Clock	19
	Cruise control	23
	Cup holders	25
	Door locks	16
	Door-Power back	14
	Light control-Instrument panel	19
	Lights & turn signals	13
	Moonroof	16
	Parking brake	11
	Power outlets-12V DC	22
	Seat adjustments-Front	12
	Seat adjustments-Rear	12
	Seat heaters	18
	Seats-Head restraints	11
	Telephone controls (Bluetooth®)	17
	Tilt and telescopic steering wheel	17
	VSC OFF button	22
	Windows-Power	15
	Windshield wipers & washers	15
SAFETY AND EMERGENCY FEATURES	Doors-Child safety locks	27
	Floor mat installation	29
	Seat belts	26
	Seat belts-Shoulder belt anchor	27
	Spare tire & tools	27
	Star Safety System™	28-29
	Tire Pressure Monitoring (warning) System	26

\* Visit your Toyota dealer for information on customizing this feature.

# OVERVIEW

## Instrument panel

### Steering wheel controls

#### Display Audio system

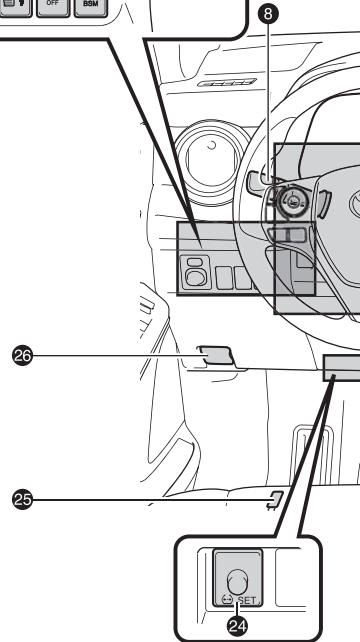
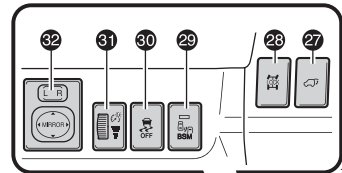
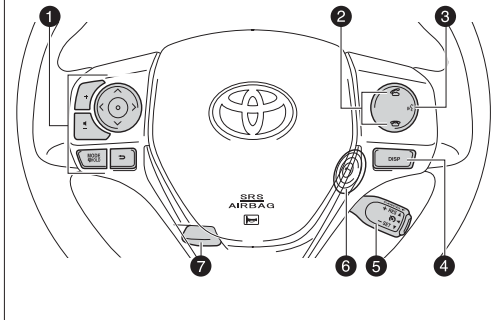

- ① Steering wheel audio controls<sup>2</sup>
- ② Telephone controls<sup>2</sup>
- ③ Voice command button<sup>1,2</sup>
- ④ Multi-Information Display switch<sup>2</sup>
- ⑤ Cruise control
- ⑥ Ignition switch (standard key)<sup>1</sup>
- ⑦ Tilt and telescopic steering release
- ⑧ Headlight, turn signal and fog light<sup>1</sup> control
- ⑨ Wiper and washer controls
- ⑩ "ENGINE START STOP" button (Smart Key)<sup>1</sup>
- ⑪ Emergency flasher switch
- ⑫ Intuitive parking assist switch<sup>1</sup>
- ⑬ Clock
- ⑭ Engine immobilizer indicator
- ⑮ Front passenger occupant classification indicator
- ⑯ Display Audio system<sup>2</sup>
- ⑰ Air Conditioning controls
- ⑱ Rear window and outside rearview mirror defogger switch

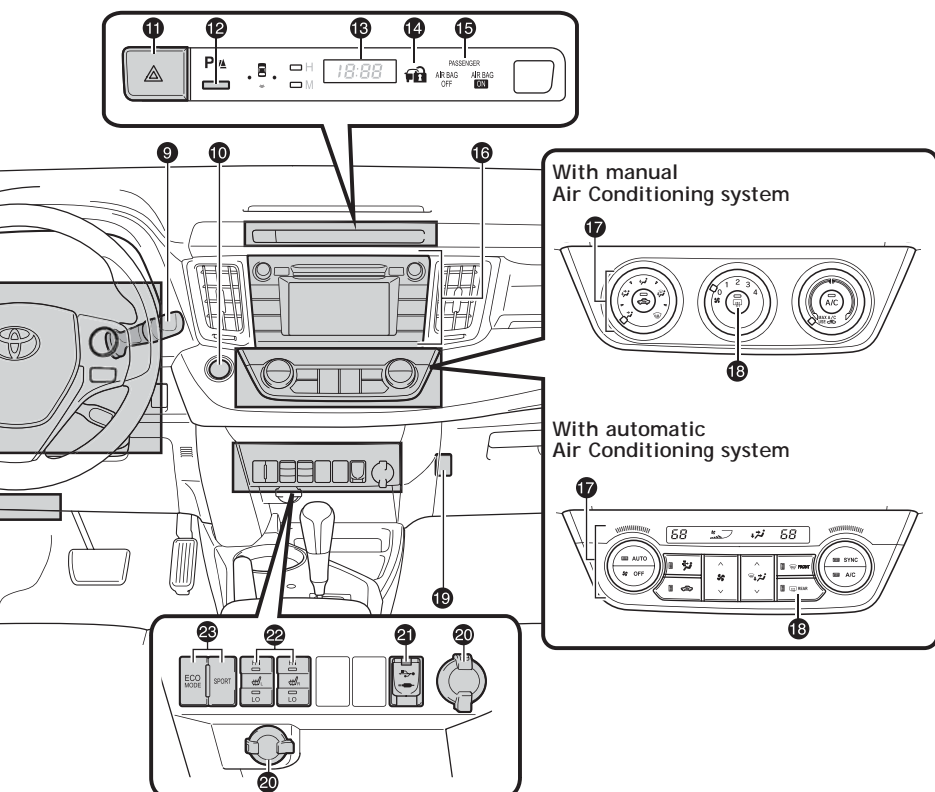

- 19 Power back door main switch<sup>1</sup>
- 20 12V DC power outlet
- 21 USB/AUX port<sup>2</sup>
- 22 Seat heater switches<sup>1</sup>
- 23 Driving mode select switches
- 24 Tire pressure warning reset switch
- 25 Fuel filler door opener
- 26 Hood lock release lever
- 27 Power back door switch<sup>1</sup>
- 28 All-Wheel Drive lock switch (AWD models)
- 29 BSM (Blind Spot Monitor with Rear Cross Traffic Alert) main switch<sup>1</sup>
- 30 VSC OFF switch
- 31 Instrument panel light control
- 32 Outside rear view mirror switches

<sup>1</sup> If equipped

<sup>2</sup> For details, refer to the "Display Audio System Owner's Manual."

Instrument cluster

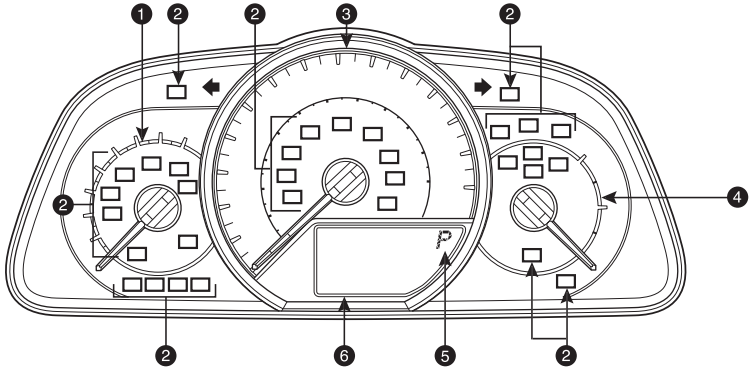

- 1 Tachometer
- 2 Service indicator and reminder
- 3 Speedometer
- 4 Fuel gauge
- 5 Automatic Transmission shift position/shift range indicator
- 6 Multi-Information Display

Indicator symbols

<b>BRAKE</b>	Brake system warning <sup>1</sup>
	Driver/Front passenger seat belt reminder (alarm will sound if speed is over 12 mph)
	Charging system warning <sup>1</sup>
	Low engine oil pressure warning <sup>1</sup>
	Malfunction/Check Engine indicator <sup>1</sup>
	Low fuel level warning
<b>MAINT REQD</b>	Engine oil replacement reminder <sup>1</sup>
	Open door warning
	Airbag warning <sup>1</sup>
<b>A/T OIL TEMP</b>	Automatic Transmission fluid temperature warning <sup>1</sup>
	Low Tire Pressure Warning <sup>1</sup>
<b>AWD</b>	Dynamic Torque Control AWD system warning light <sup>1</sup>

<sup>1</sup> If indicator does not turn off within a few seconds of starting engine, there may be a malfunction. Have vehicle inspected by your Toyota dealer.

<sup>2</sup> For details, refer to "All-wheel drive lock switch," Section 4-5, 2013 Owner's Manual.

<sup>3</sup> The indicator flashes to indicate that the system is operating.

	Electric power steering system warning <sup>1</sup>
	Low windshield washer fluid level warning <sup>1</sup>
	Front passenger occupant classification indicator
	Headlight high beam indicator
	Turn signal indicator
	Fog light indicator
	All-Wheel Drive lock indicator <sup>1,2</sup>
	Vehicle Stability Control (VSC) OFF indicator <sup>1</sup>
	Slip indicator <sup>1,3</sup>
	AUTO Limited Slip Differential indicator <sup>1</sup>
	Cruise control indicator <sup>4</sup> /Cruise control SET indicator <sup>4</sup>
	Anti-lock Brake System warning <sup>1</sup>
	Smart Key system indicator <sup>5</sup>
	Traction Control OFF indicator <sup>1</sup>
	Blind Spot Monitor warning <sup>1</sup> /Blind Spot Monitor outside rearview mirror indicators
	Theft deterrent/Engine immobilizer system indicator
	Eco Driving Indicator Light
	ECO mode indicator
	High coolant temperature warning <sup>1</sup>
	SPORT indicator
	Intuitive parking assist indicator <sup>6</sup>

<sup>4</sup> If this light flashes, refer to "Cruise control," Section 4-5, 2013 Owner's Manual.

<sup>5</sup> Light flashes in yellow to indicate a malfunction. Light flashes quickly in green to indicate that the steering lock has not been released.

<sup>6</sup> The indicator flashes to indicate a malfunction.

Keyless entry

Beep sound can be switched ON or OFF. Refer to the *Owner's Manual* for more details.

Locking



Without Smart Key system



With Smart Key system



Push



Unlocking



Without Smart Key system

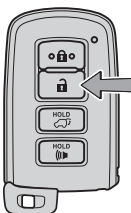

With Smart Key system



Push ONCE: Driver door  
TWICE: All doors



NOTE: If a door is not opened within 60 seconds of unlocking, all doors will relock for safety.

Power back door (if equipped)

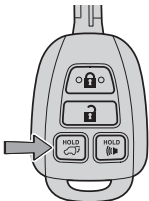

Without Smart Key system

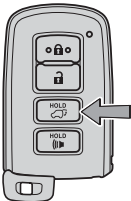

With Smart Key system





Push and hold

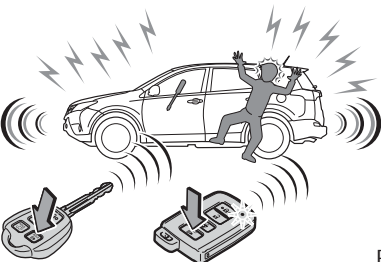

Panic button



Push and hold





## Smart Key system (if equipped)

### Start function

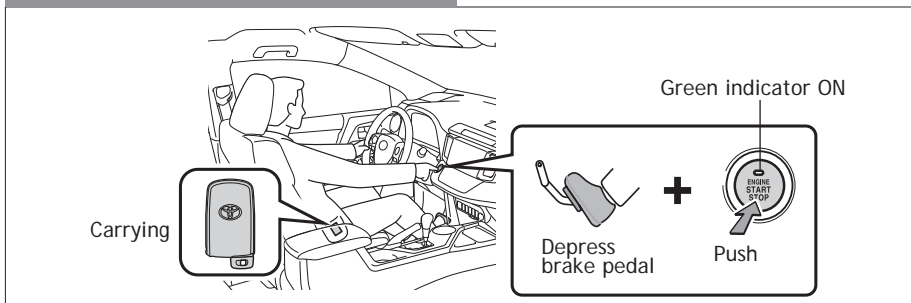

**NOTE:** Gear shift lever must be in Park and brake pedal depressed.

### Power (without starting engine)

Without depressing the brake pedal, pressing the “ENGINE START STOP” switch will change the operation mode in succession from:

#### ACCESSORY

Accessories such as the radio will operate.

#### ON

Power ON; the engine not running.

#### OFF

All systems OFF.

### Locking operation

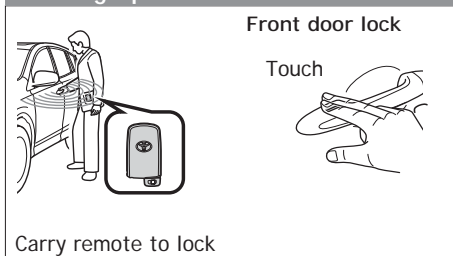

### Unlocking operation

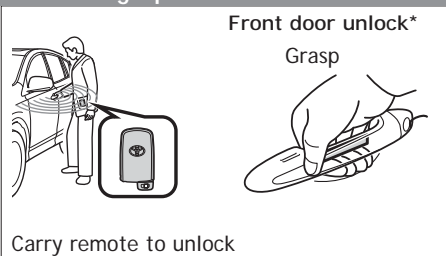

### Back door lock/unlock

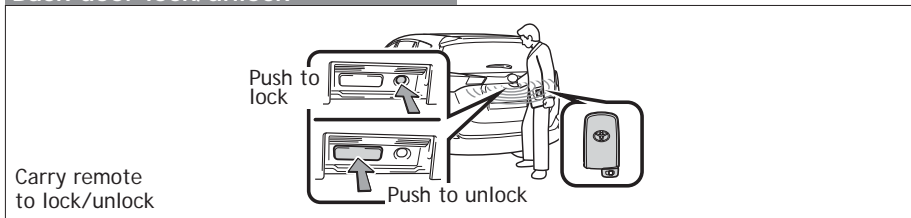

\* Driver door unlocking function can be programmed to unlock driver door only, or all doors. Grasping passenger door handle will unlock all doors.

**NOTE:** Doors may also be locked/unlocked using remote.

## Fuel tank door release and cap

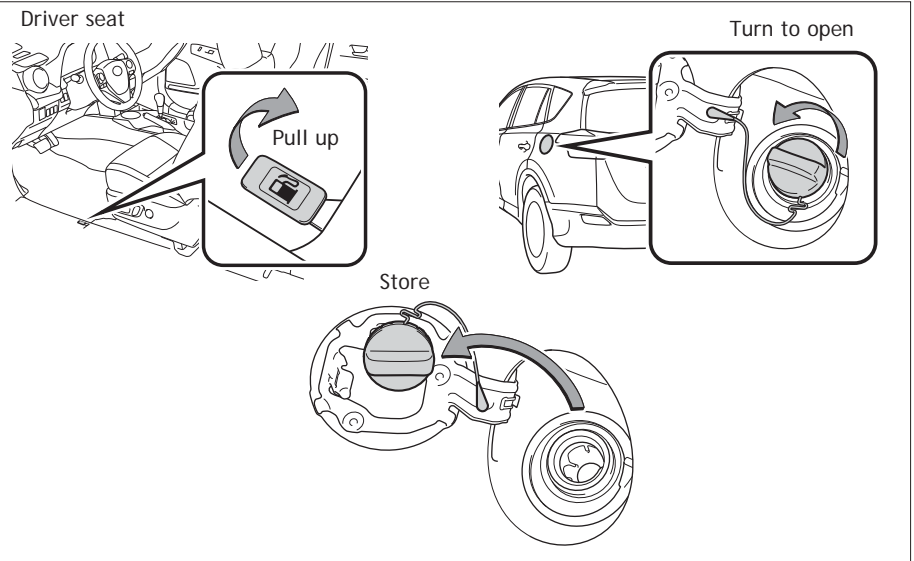

**NOTE:** Tighten until one click is heard. If the cap is not tightened enough, Check Engine "CHECK" indicator may illuminate.

## Hood release

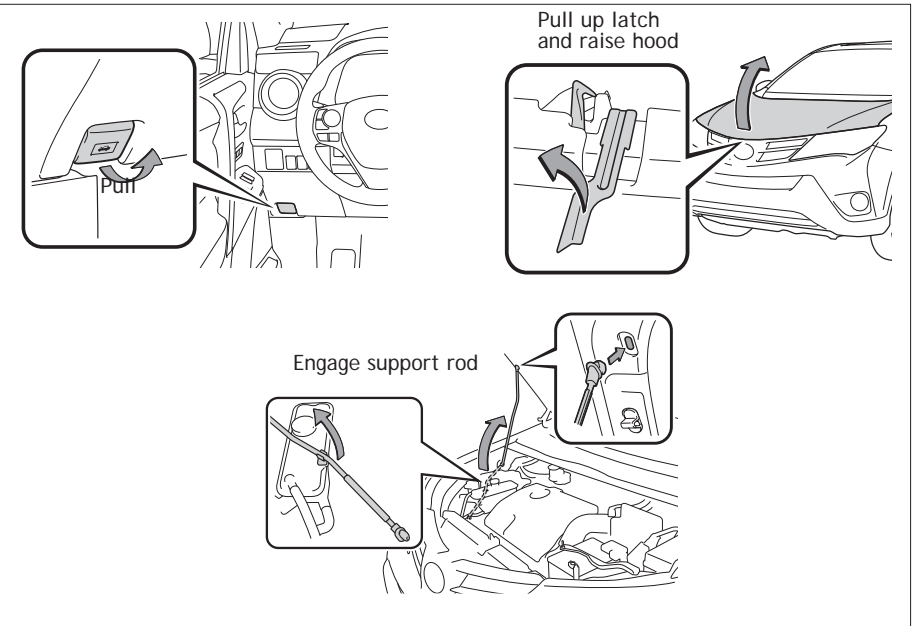

## Engine maintenance

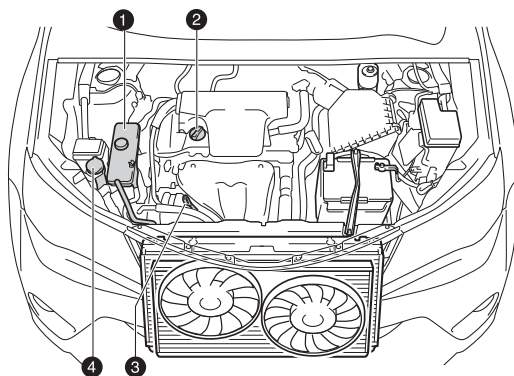

- ❶ Engine coolant reservoir
- ❷ Engine oil filler cap
- ❸ Engine oil level dipstick
- ❹ Windshield and back window washer fluid tank

**NOTE:** *Regularly scheduled maintenance, including oil changes, will help extend the life of your vehicle and maintain performance. Please refer to the "Warranty Maintenance Guide."*

# FEATURES/OPERATIONS

## Auto lock/unlock

Automatic door locks can be programmed to operate in four different modes, or turned OFF.

- Doors lock when shifting from Park.
- Doors lock when the vehicle speed goes above approximately 12 mph.
- Doors unlock when shifting into Park.

### Vehicles without Smart Key system

- Doors unlock when the ignition switch is set from "ON" to "ACC" or "LOCK" and driver's door is opened.

### Vehicles with Smart Key system

- Doors unlock when the "ENGINE START STOP" switch is set to OFF and driver's door is opened.

Refer to the *Owner's Manual* for more details.

## Automatic Transmission

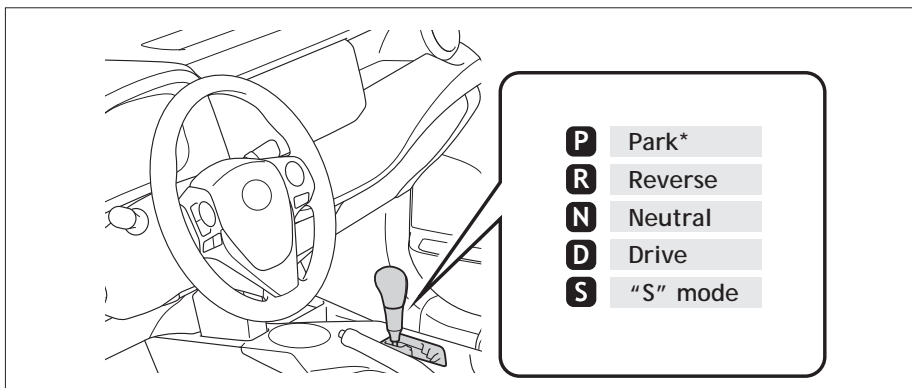

\* The ignition/"ENGINE START STOP" switch must be "ON" and the brake pedal depressed to shift from Park.

### "S" (Sequential) mode

Shift the shift lever to "S" position from "D" position.

- + : Upshift (push and release)
- : Downshift (pull and release)

Downshifting increases power going uphill, or provides engine braking downhill. For best fuel economy during normal driving conditions, always drive with the shift lever in the "D" position.

## Parking brake

Set

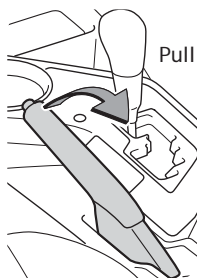

Release

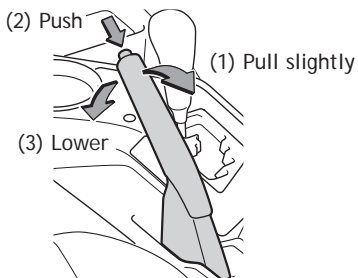

BRAKE

## Active torque control AWD (AWD models)

### All-wheel drive lock switch

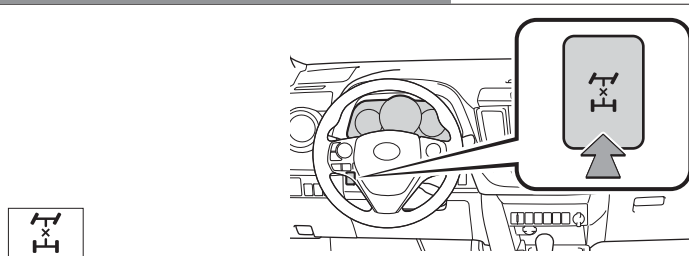

Push the switch to ensure that the engine torque is applied to the four wheels.

**NOTE:** Should **ONLY** be used when wheel spinning occurs on loose or unpaved surfaces.

Refer to the *Owner's Manual* for more details.

## Seats-Head restraints

Front seats

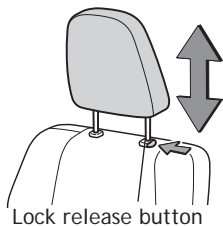

Rear seats

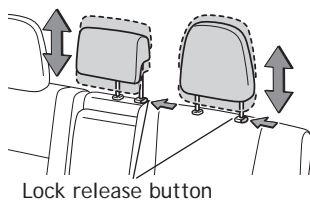

## Seat adjustments-Front

### Manual seat

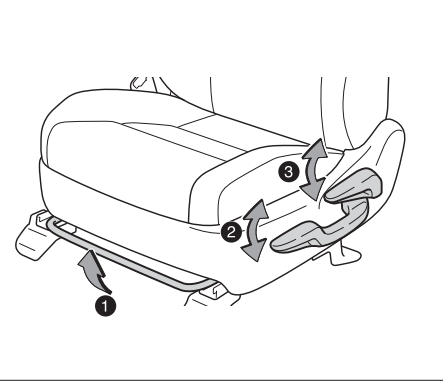

### Power seat (driver side only)

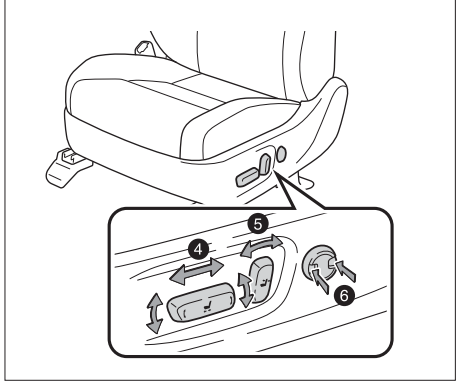

- ❶ Seat position (forward/backward)
- ❷ Height crank (driver side only)
- ❸ Seatback angle
- ❹ Seat position, cushion angle and height
- ❺ Seatback angle
- ❻ Lumbar support

## Seat adjustments-Rear

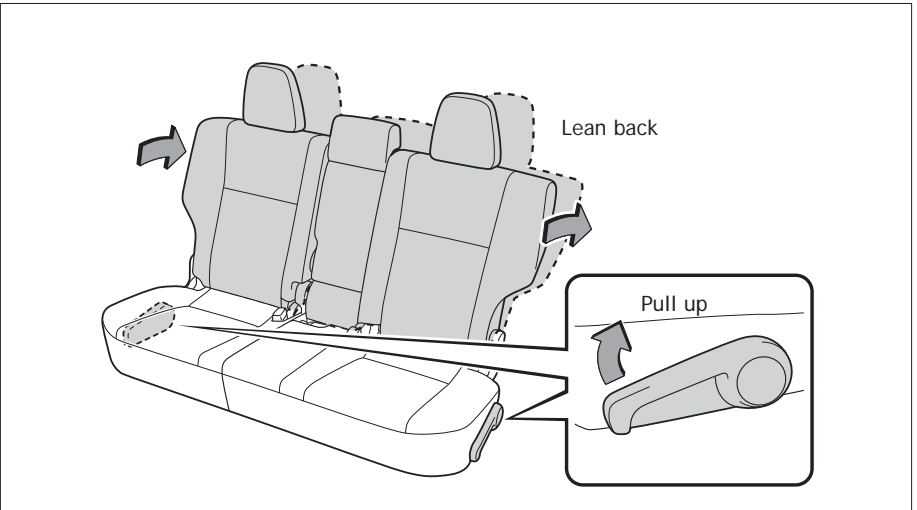

## Lights & turn signals

### Headlights

#### Type A

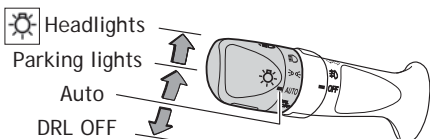

#### Type B

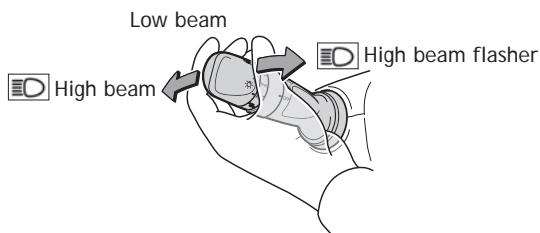
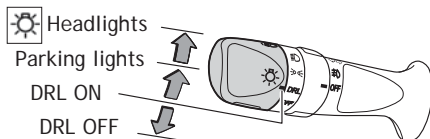

#### -Daytime Running Light system (DRL)

Automatically turns on the headlights at a reduced intensity.

#### -Automatic light cut off system

Will automatically turn lights off after a delay of 30 seconds.

### Turn signals

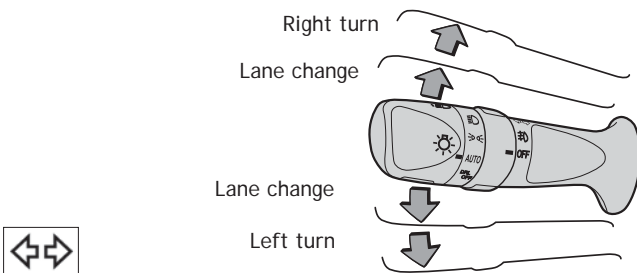

### Fog lights (if equipped)

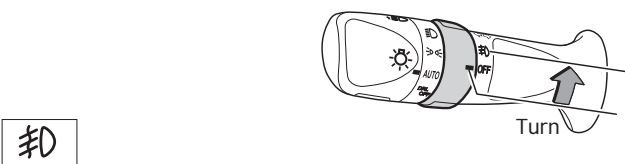

Front fog lights come on only when the headlights are on low beam.

Door-Power back (if equipped)

Instrument panel

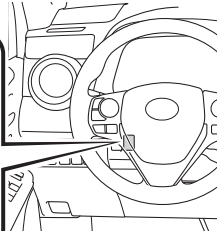
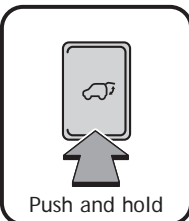

Open: Push and hold  
Close: Push and hold again

Back door (close only)

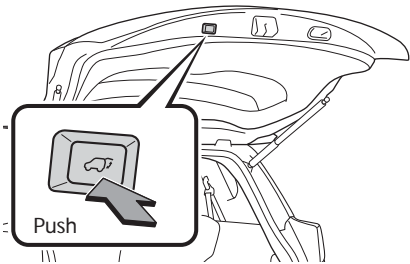

Back door (open and close)

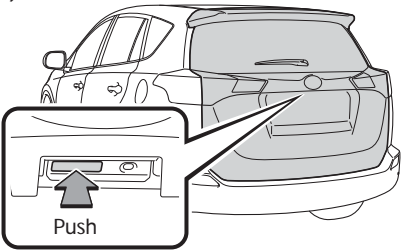

**NOTE:** If battery is disconnected, the power back door needs to be reinitialized. Refer to the *Owner's Manual* for more details.



## Windshield wipers & washers

### Front

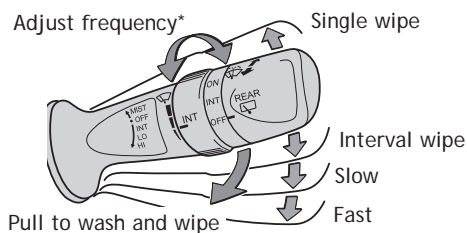

\* Intermittent windshield wiper frequency adjustment Rotate to increase/decrease wipe frequency.

### Rear

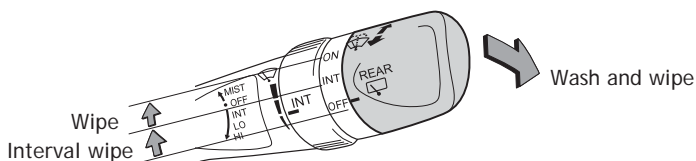

## Windows-Power

### Driver side

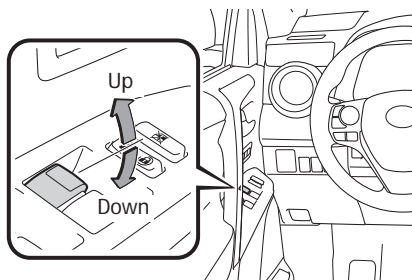

### Window lock switch

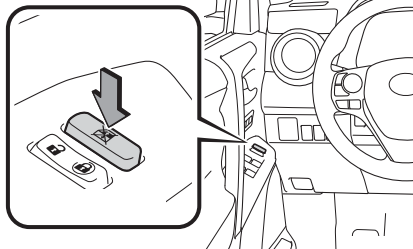

**Automatic operation (driver side only)** Push the switch completely down or pull it completely up and release to fully open or close. To stop the window partway, operate the switch in the opposite direction.

**Window lock switch** Deactivates all passenger windows. Driver's window remains operable.

Moonroof (if equipped)

Sliding operation

Push once to open partway; again to open completely.

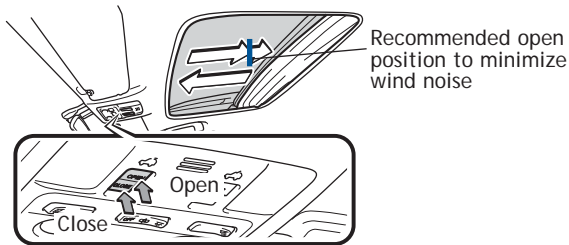

Tilting operation

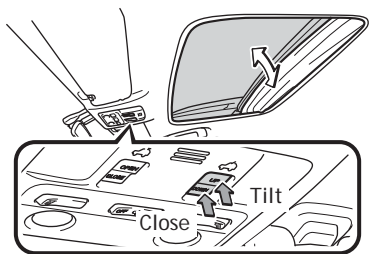

**NOTE:** If battery is disconnected, the moonroof needs to be reinitialized. Refer to the *Owner's Manual* for more details.

Door locks

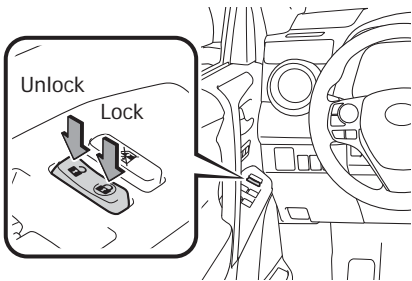

## Telephone controls (Bluetooth®)

Audio unit

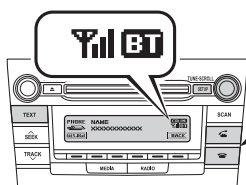

Start call

End call

Microphone

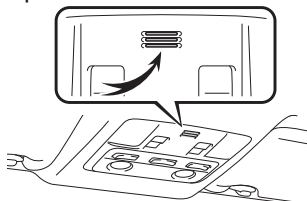

Steering wheel telephone switches

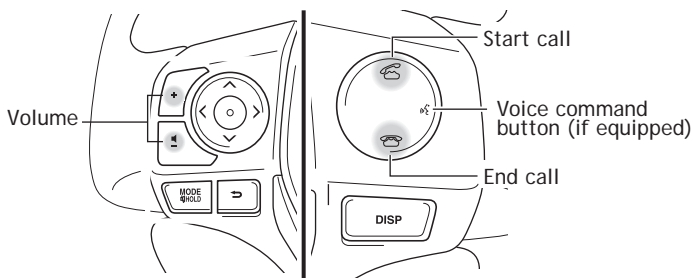

Bluetooth® technology allows dialing or receipt of calls without taking hands from the steering wheel or using a cable to connect the compatible telephone and the system.

Refer to "Bluetooth® audio/phone," Section 5-2 in the *Owner's Manual*, for more information about phone connections and compatibility.

## Tilt and telescopic steering wheel

Lock release lever

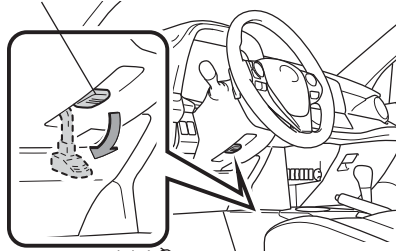

Angle

Length

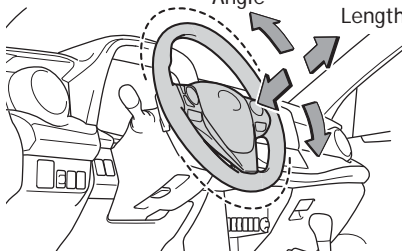

Hold wheel, push lever down, set angle and length, and return lever.

**NOTE:** Do not attempt to adjust while the vehicle is in motion.

## Seat heaters (if equipped)

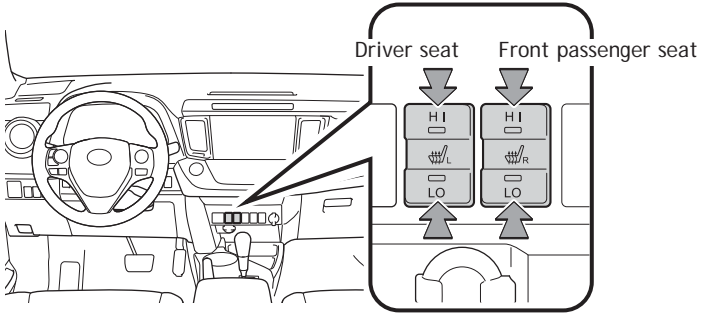

## Air Conditioning/Heating

### Automatic Air Conditioning

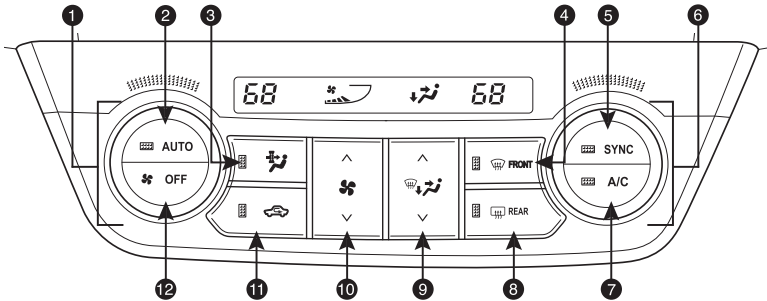

- ❶ Temperature selector (driver side)
- ❷ Automatic climate control ON  
Adjust the temperature setting, and airflow vents and fan will adjust automatically.
- ❸ Micro dust and pollen filter ON/OFF
- ❹ Windshield defogger
- ❺ Synchronizes driver, front passenger and rear temperature settings
- ❻ Temperature selector (front passenger side)
- ❼ Air Conditioning ON/OFF
- ❽ Rear defogger
- ❾ Airflow vent  
In "❹" or "❺" mode, use fresh air ("❺" indicator OFF) to reduce window fogging.
- ❿ Fan speed
- ⓫ Recirculate cabin air (fresh air when OFF)
- ⓬ Climate control OFF

## Manual Air Conditioning

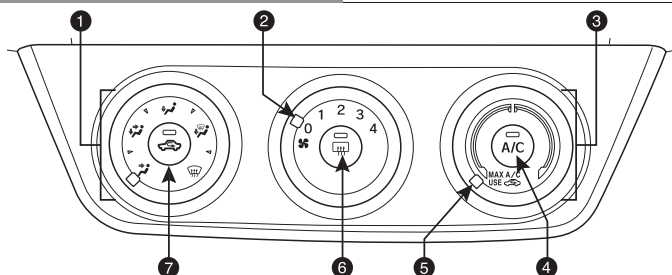

### 1 Airflow vent

In " " mode, use fresh air (" " indicator OFF) to reduce window fogging. " " mode uses fresh air only.

### 2 Fan speed

### 3 Temperature selector

### 4 Air Conditioning ON/OFF

### 5 Select for maximum cooling.

### 6 Rear defogger

### 7 Recirculate cabin air (fresh air when OFF)

## Clock

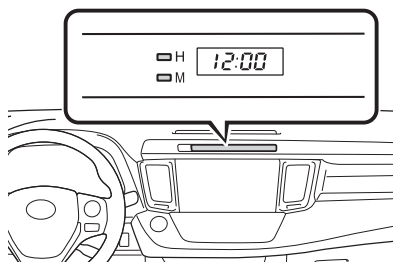

H- Hour set  
M- Minute set

## Light control-Instrument panel

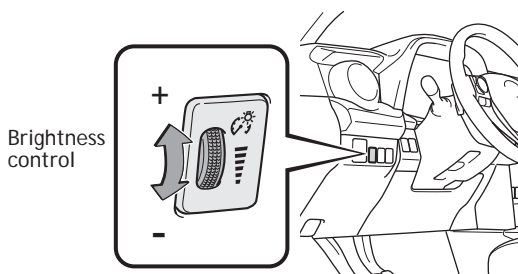

With the dial turned fully up, instrument panel lights will not dim when the headlights are turned ON.

Audio\*1

The diagram shows the car's audio system interface. At the top, there is an 'Eject CD' button and a 'Touch screen display'. Below the display, there are several buttons: 'PWR VOL' (Power/Volume), 'TUNE SCROLL' (Tune/Scroll), 'SETUP', 'AUDIO', 'SEEK', 'TRACK', 'CAR', and 'APPS'. The 'APPS' button is highlighted with a callout box showing two options: '\*2' (Display Audio system) and '\*3' (Premium Display Audio system). The 'TUNE SCROLL' button is also highlighted with a callout box showing two options: '\*2' (Display Audio system) and '\*3' (Premium Display Audio system). The 'PWR VOL' button is highlighted with a callout box showing two options: '\*2' (Display Audio system) and '\*3' (Premium Display Audio system). The 'AUDIO' button is highlighted with a callout box showing two options: '\*2' (Display Audio system) and '\*3' (Premium Display Audio system). The 'SEEK' button is highlighted with a callout box showing two options: '\*2' (Display Audio system) and '\*3' (Premium Display Audio system). The 'TRACK' button is highlighted with a callout box showing two options: '\*2' (Display Audio system) and '\*3' (Premium Display Audio system). The 'CAR' button is highlighted with a callout box showing two options: '\*2' (Display Audio system) and '\*3' (Premium Display Audio system). The 'APPS' button is highlighted with a callout box showing two options: '\*2' (Display Audio system) and '\*3' (Premium Display Audio system).

Labels and functions:

- Eject CD
- Touch screen display
- Turn to tune radio stations manually or select tracks or files
- Push to turn ON/OFF
- Push to display audio screen
- Seek station/CD track select

\*1 Refer to the "Display Audio System Owner's Manual" for instructions and more information.  
\*2 Display Audio system  
\*3 Premium Display Audio system

Steering wheel switches

The diagram shows the steering wheel controls. There is a 'Volume control' button and a 'MODE' button. The 'MODE' button is highlighted with a callout box showing two options: '\*2' (Display Audio system) and '\*3' (Premium Display Audio system). The 'MODE' button is also highlighted with a callout box showing two options: '\*2' (Display Audio system) and '\*3' (Premium Display Audio system).

Labels and functions:

- Volume control
- MODE

- ① " ^ V "  
Use to search within the selected audio medium (radio, CD, iPod®, etc.).
- ② "MODE"  
Push to turn audio ON and select an audio mode. Push and hold to turn the audio OFF.

## iPod®/USB/AUX port

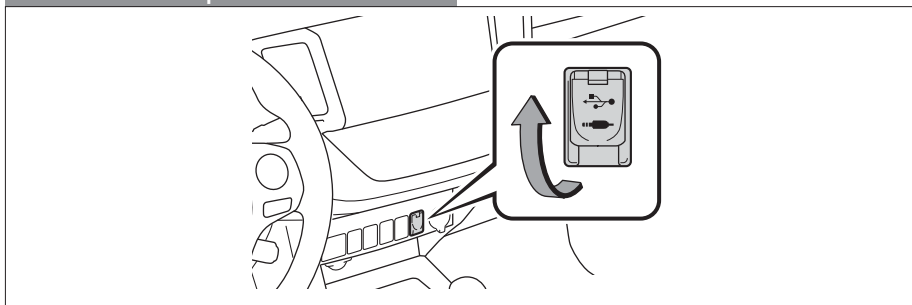

### iPod®/USB port

By connecting a USB-compatible portable audio device or USB memory to the USB port, you can listen to music from the portable audio device or USB memory through the vehicle's speaker system.

### AUX port

By inserting a mini plug into the AUX port, you can listen to music from a portable audio device through the vehicle's speaker system while in AUX mode.

Power outlets-12V DC

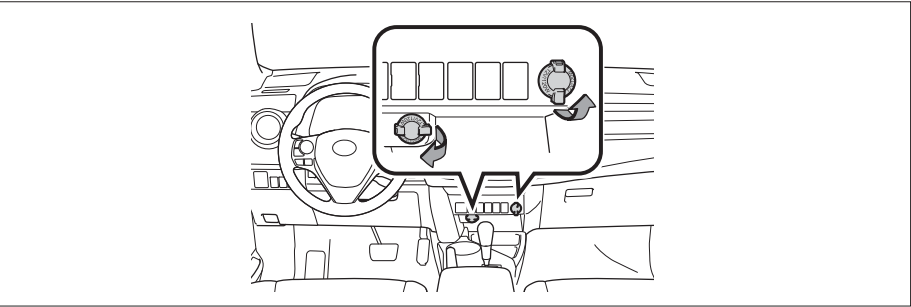

**NOTE:** Designed for car accessories. Ignition switch/“ENGINE START STOP” switch must be in the “ACC” or “ON” position to be used.

VSC OFF button

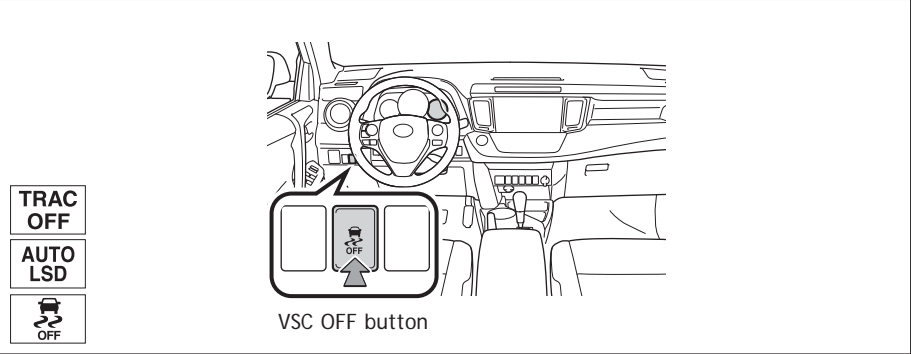

The VSC OFF button is used to switch between modes related to the TRAC, VSC and Auto LSD functions (2WD models.)

Refer to Section 4-5 of the *Owner’s Manual* for more information.



## Cruise control

### Turning system ON/OFF

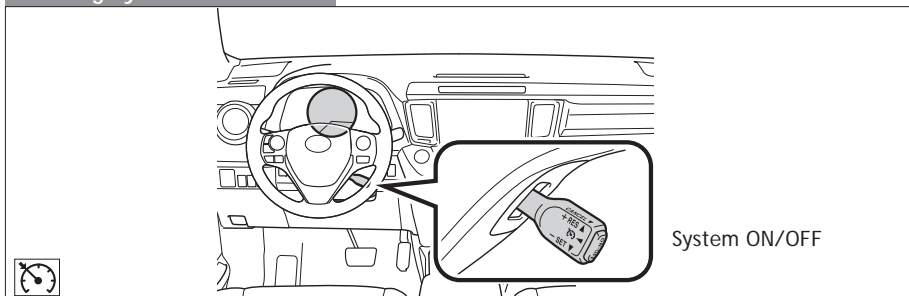

### Functions

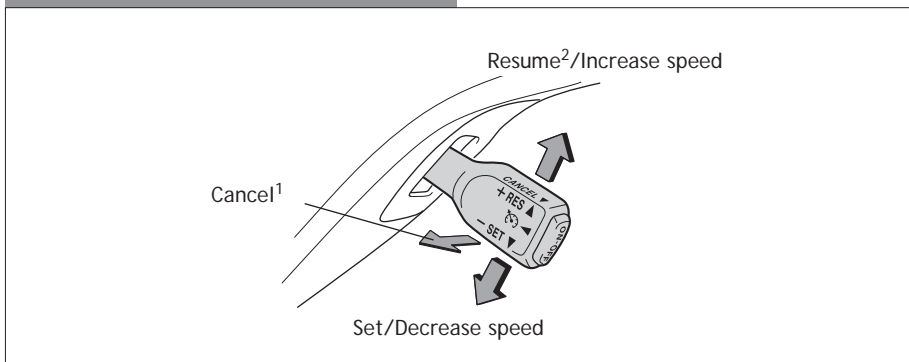

<sup>1</sup> The set speed may also be cancelled by depressing the brake pedal.

<sup>2</sup> The set speed may be resumed once vehicle speed exceeds 25 mph.

Refer to the *Owner's Manual* for more details.

### Blind Spot Monitor (BSM) with Rear Cross Traffic Alert (if equipped)

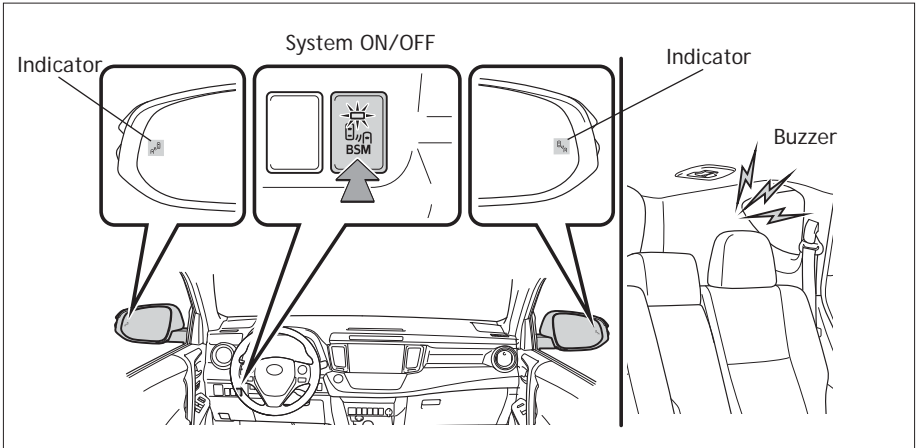

The Blind Spot Monitor is a system that has two functions:

- The Blind Spot Monitor function (assists the driver in decision making when changing lanes)
- The Rear Cross Traffic Alert function (assists the driver when backing up)

The system uses radar sensors to detect vehicles that are traveling in the area that is not reflected in the outside rearview mirror (the blind spot), and advises the driver of the vehicles' existence via the outside rearview mirror indicator.

Refer to the *Owner's Manual* for more details on this system before attempting to use it.

## Cup holders

### Front

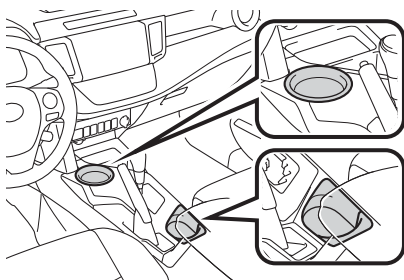

### Rear

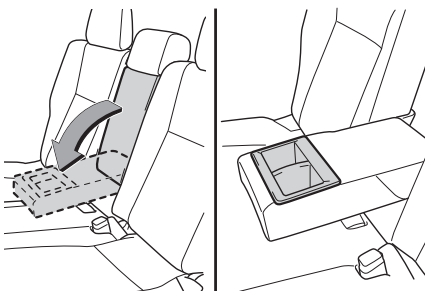

## Bottle holders

### Front door

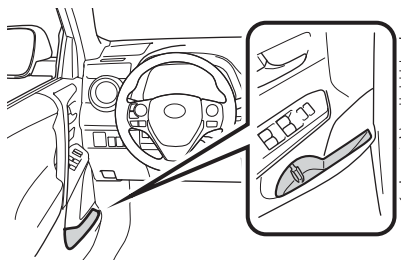

### Rear door

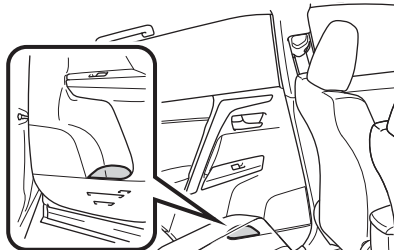

# SAFETY AND EMERGENCY FEATURES

## Seat belts

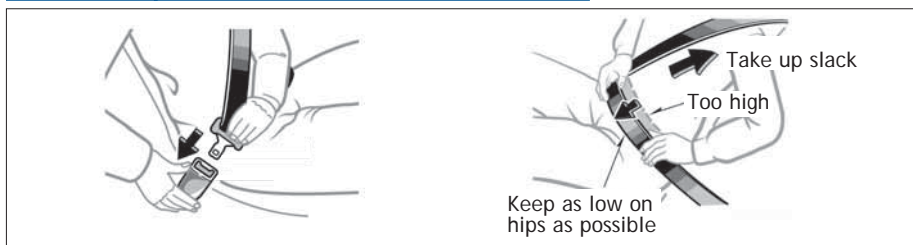

If belt is fully extended, then retracted even slightly, it cannot be re-extended beyond that point, unless fully retracted again. This feature is used to help hold child restraint systems securely.

To find more information about seat belts, and how to install a child restraint system, refer to the *Owner's Manual*.

## Tire Pressure Monitoring (warning) System

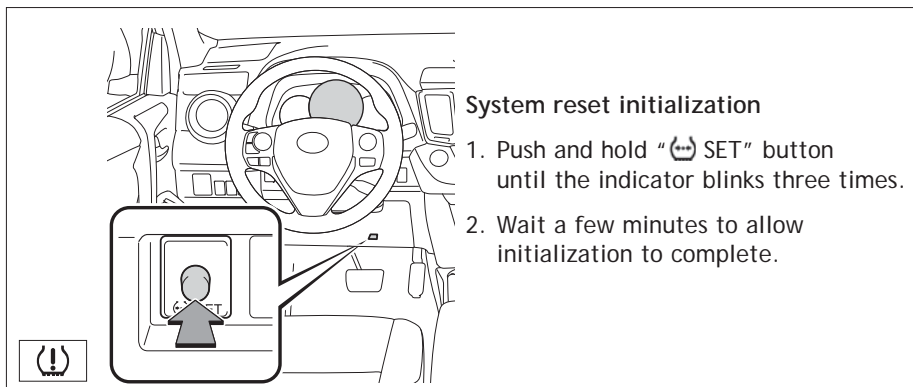

After adjusting tire pressures, or after tires have been rotated or replaced, turn the ignition switch to "ON" and press and hold the "SET" button until indicator blinks three times. Let the vehicle sit for a few minutes to allow initialization to complete.

Refer to the load label on the door jamb or the *Owner's Manual* for tire inflation specifications.

If the tire pressure indicator flashes for more than 60 seconds and then remains on, take the vehicle to your local Toyota dealer.

**NOTE:** The warning light may come on due to temperature changes or changes in tire pressure from natural air leakage. If the system has not been initialized recently, setting the tire pressures to factory specifications should turn off the light.

## Doors-Child safety locks

Rear door



Moving the lever to "LOCK" will allow the door to be opened only from the outside.

## Seat belts-Shoulder belt anchor

Push up or squeeze lock release to lower

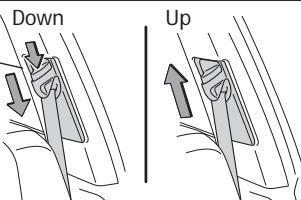

## Spare tire & tools

Tool location

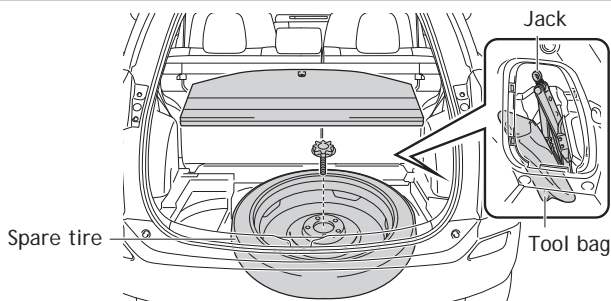

## Removing the spare tire

(1)

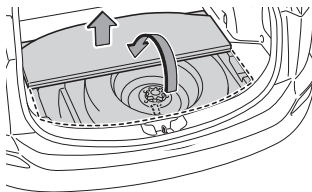

(2)

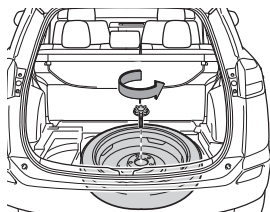

(1) Remove the tool tray.

(2) Lessen the center fastener that secures the spare tire.

Refer to the *Owner's Manual* for tire changing and jack positioning procedures.

## SAFETY AND EMERGENCY FEATURES

### Star Safety System™

All new Toyota vehicles come standard with the Star Safety System™, which combines Vehicle Stability Control (VSC), Traction Control (TRAC), Anti-lock Braking System (ABS), Electronic Brake-force Distribution (EBD), Brake Assist (BA) and Smart Stop Technology (SST).

#### Vehicle Stability Control (VSC)

VSC helps prevent loss of traction during cornering by reducing engine power and applying brake force to selected wheels.

Toyota's VSC monitors steering angle and the direction your vehicle is traveling. When it senses that the front or rear wheels begin to lose traction, VSC reduces engine power and applies braking to selected wheels. This helps restore traction and vehicle control.

#### Traction Control (TRAC)

VSC helps prevent loss of traction during cornering by reducing engine power, and Traction Control helps maintain traction on loose gravel and wet, icy, or uneven surfaces by applying brake force to the spinning wheel(s).

Toyota's TRAC sensors are activated when one of the drive wheels starts to slip. TRAC limits engine output and applies the brakes to the spinning wheel. This transfers power to the wheels that still have traction to help keep you on track.

#### Anti-Lock Brake System (ABS)

ABS helps prevent brakes from locking up by "pulsing" brake pressure to each wheel. This limits brake lockup and helps provide directional control for the current road conditions.

Toyota's ABS sensors detect which wheels are locking up and limits wheel lockup by "pulsing" each wheel's brakes independently. Pulsing releases brake pressure repeatedly for fractions of a second. This helps the tires attain the traction that current road conditions will allow, helping you to stay in directional control.

#### Electronic Brake Force Distribution (EBD)

Toyota's ABS technology has Electronic Brake-force Distribution (EBD) to help maintain control and balance when braking. Abrupt stops can cause a vehicle to tilt forward, reducing the braking power of the rear wheels. EBD responds to sudden stops by redistributing brake force to enhance the braking effectiveness of all four wheels.

#### Brake Assist (BA)

Brake Assist is designed to detect sudden or "panic" braking, and then add braking pressure to help decrease the vehicle's stopping distance. When there's only a split second to react, Brake Assist can add additional brake pressure more quickly than just the driver alone can.

## Smart Stop Technology (SST)

Smart Stop Technology automatically reduces driving torque when the accelerator and brake pedals are pressed simultaneously under certain conditions.

SST engages when the accelerator is depressed first and the brakes are applied firmly for longer than one-half second at speeds greater than five miles per hour.

SST doesn't engage if the brake pedal is depressed before the accelerator pedal, allowing vehicles to start on a steep hill and safely accelerate without rolling backward.

## Floor mat installation

There are two types of Toyota floor mats: carpeted and all-weather. Each vehicle has model-specific floor mats. Installation is easy.

To keep your floor mat properly positioned, follow these steps:

- Only use floor mats designed for your specific model.
- Use only one floor mat at a time, using the retaining hooks to keep the mat in place.
- Install floor mats right side up.

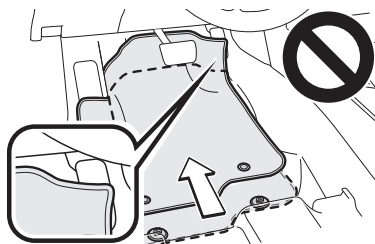
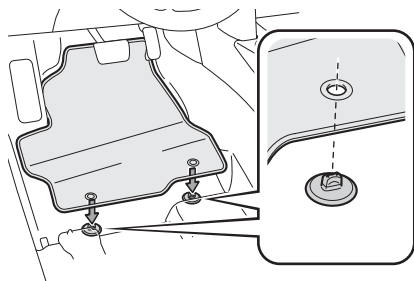



# TOYOTA Owners

[toyota.com/owners](http://toyota.com/owners)

CUSTOMER EXPERIENCE CENTER

1-800-331-4331

