

3. If you suspect a bulb is blown, check the bulb filament. If filament is coiled and unbroken, the bulb is not blown. If filament is blown, replace bulb.
4. If you suspect the main fuse is blown, check it and, if necessary, replace with a new 20 amp spade fuse.

### **SPECIFICATIONS**

Spotlight:	12 volt H3, 25 watt bulb
Batteries:	Two maintenance-free, sealed lead acid, 6 volt, 4.5 Ah
AC Adapter:	1000mA, 12 volt high frequency charger
Operating Voltage:	12 volts DC

VEC280



## **Rechargeable Inflator/Spotlight**

**High Pressure/High Volume Inflator Combo  
with 12 Volt DC Portable Power Supply**



## **USER'S MANUAL & WARRANTY INFORMATION**

### **IMPORTANT SAFETY INFORMATION, SAVE THESE INSTRUCTIONS**

TO REDUCE THE RISK OF INJURY, USER MUST READ AND UNDERSTAND THIS INSTRUCTIONAL MANUAL. THIS MANUAL CONTAINS IMPORTANT INFORMATION REGARDING THE OPERATION AND WARRANTY OF THIS PRODUCT. PLEASE RETAIN FOR FUTURE REFERENCE.

4140 S.W. 30th Ave., Ft. Lauderdale, FL 33312  
Toll Free: (866) 584-5504

**[www.vectormfg.com](http://www.vectormfg.com)**

### ONE YEAR LIMITED WARRANTY PROGRAM

This limited warranty program is the only one that applies to this product, and it sets forth all the responsibilities of Vector Manufacturing, regarding this product. There is no other warranty, other than those described herein. Any implied warranty of merchantability or fitness for a particular purpose on this product is limited in duration to the duration of this warranty.

This Vector Manufacturing product is warranted, to the original purchaser only, to be free of defects in materials and workmanship for one year from the date of purchase without additional charge. The warranty does not extend to subsequent purchasers or users. Manufacturer will not be responsible for any amount of damage in excess of the retail purchase price of the product under any circumstances. Incidental and consequential damages are specifically excluded from coverage under this warranty.

This product is not intended for commercial use. This warranty does not apply to damage to units from misuse or incorrect installation/connection. Misuse includes wiring or connecting to improper polarity power sources.

**RETURN/REPAIR POLICY:** Defective products may be returned to manufacturer. Any defective product that is returned to manufacturer within 30 days of the date of purchase will be replaced free of charge. If such a product is returned more than 30 days but less than one year from the purchase date, manufacturer will repair the unit or, at its option, replace it, free of charge.

If the unit is repaired, new or reconditioned replacement parts may be used, at manufacturer's option. A unit may be replaced with a new or reconditioned unit of the same or comparable design. The repaired or replaced unit will then be warranted under the terms of the remainder of the warranty period. The customer is responsible for the shipping charges on all returned items. During the warranty period, manufacturer will be responsible for the return shipping charges to the customer in the United States.

**LIMITATIONS:** This warranty does not cover accessories, such as charging adapters, bulbs, fuses and batteries, damage or defects resulting from normal wear and tear (including chips, scratches, abrasions, discoloration or fading due to usage or exposure to sunlight), accidents, damage during shipping to our service facility, alterations, unauthorized use or repair, neglect, misuse, abuse, failure to follow instructions for care and maintenance, fire, flood and Acts of God.

If your problem is not covered by this warranty, call our Technical Support Department at (954) 584-4446 or toll free at (866) 584-5504 for general repair information and charges if applicable. You may also contact us through our website at [www.vectormfg.com](http://www.vectormfg.com).

**STATE LAW RIGHTS:** This warranty gives you specific legal rights. Some states do not allow limitations on how long an implied warranty lasts or the exclusion or limitation of incidental or consequential damages, so the exclusions or limitations stated herein may not apply. This warranty gives the purchaser specific legal rights; other rights, which vary from state to state, may apply.

**TO REQUEST WARRANTY SERVICE FOR THIS PRODUCT:** Contact Technical Support by telephone, fax or mail (see below). We suggest that you keep the original packaging in case you need to ship the unit. When returning a product, include your name, address, phone number, dated sales receipt (or copy) and a description of the reason for return and product serial number. After repairing or replacing the unit, we will make every effort to return it to you within four weeks.

**WARRANTY ACTIVATION:** Please complete Warranty Activation Card and mail to Vector Manufacturing. Enter "VEC205SRB" as Model and "Thermo-Electric Travel Cooler & Warmer" as Product Type. All Vector products must be registered within 30 days of purchase to activate this warranty. Mail the completed registration form, along with a copy of the original sales receipt, to:

ATTN.: CUSTOMER SERVICE  
4140 SW 30th Ave., Ft. Lauderdale, FL 33312  
• TOLL FREE: (866) 584-5504 • FAX: (954) 584-5556 •

WARRANTY IS NON-TRANSFERABLE.

BD110405

© 2005 VECTOR MANUFACTURING  
MADE IN CHINA

## IMPORTANT SAFETY INSTRUCTIONS

### WARNINGS

- **Contains non-spillable sealed lead acid batteries. They must be recycled or disposed of properly.**
- **DO NOT dispose of batteries in fire, as this may result in an explosion.**
- **DO NOT open battery or short circuit, this may cause the battery to leak or get hot causing personal injury. For disposal questions, call toll-free (877) 288-7722.**

### Spotlight Safety

1. All halogen lights give off heat. Never place the light face-down on any surface when lit.
2. Never look directly into the spotlight or shine the spotlight into another person's eyes.
3. Replace bulb or batteries with type indicated in Specifications in the User's Manual.
4. Do not immerse this spotlight in water. This unit is not waterproof.
5. Lens gets very hot – do not touch lens while spotlight is operating.
6. Keep sharp objects away from lens – it is glass and can break.
7. Do not drop or throw spotlight.
8. Do not substitute power cords or charging adapters. Only charge with supplied AC and DC charging adapters.
9. Do not crush, cut, pull or expose charging adapter cords to extreme heat or sharp edges.
10. Position charging adapter cords so that they do not become entangled or become a safety hazard.
11. Always charge in a dry location.
12. Plug in the charging adapter at the spotlight first, then plug into the charging source.
13. **DO NOT OVERCHARGE:**  
AC recharge up to 10 hours maximum.  
DC recharge up to 5 hours maximum.
14. After recharge, disconnect charging adapter and wait 5 minutes before use.

### Compressor/Inflator Safety

1. Never attempt to disable or block the inflation and deflation ports while pump is operating.
2. Never cover unit at any time while operating.
3. Never leave the pump unattended while in use.
4. Never allow sand, small rocks or other debris to be sucked into the inflation or deflation ports.
5. Never look into or point the inflator port opening toward anyone's eyes.
6. Do not use the compressor continuously for longer than 15 minutes. Extended use will cause it to overheat and can damage the product. After 15 minutes of continuous use, turn the unit OFF and wait 15 minutes before resuming operation of the compressor.
7. **DO NOT** overinflate objects or exceed manufacturer's recommendations for pressure on objects to be inflated.

THIS UNIT IS NOT A TOY AND SHOULD ONLY BE OPERATED BY ADULTS. KEEP AWAY FROM CHILDREN!

**Read This User's Manual Before Using This Unit.**

## SAVE THESE INSTRUCTIONS

## TABLE OF CONTENTS

Introduction	1
Features	1
Main Fuse	2
AC and DC Charging/Recharging	2
Viewing Battery Charge Status	3
120 Volt AC Charging/Recharging	3
12 Volt DC Charging/Recharging	3
Using the Spotlight	3
Using the 2-LED Area Light	4
Using the 12 Volt DC Accessory Outlet	4
Using the Air Compressor/Inflator	4
Inflating Products With a Valve Stem Using the Compressor	4
Inflating Products Without a Valve Stem Using the Compressor	5
Using the Inflator/Deflator	5
Care and Maintenance	6
Replacement Parts	6
Bulb Replacement	6
Battery Replacement/Disposal	7
DC Plug Fuse Replacement	7
Troubleshooting	7
Operating Issues	7
Specifications	8

## INTRODUCTION

Congratulations on purchasing the **VEC280 Rechargeable Inflator/ Spotlight**. This unit features a powerful quartz halogen Spotlight, long lasting, 2-LED Area Light, High Pressure/High Volume Inflator Combo and 12 Volt DC Portable Power Supply. It uses two powerful, proven-technology, rechargeable, non-spillable, sealed, lead acid batteries for years of dependable use. It was designed to be the most versatile and practical inflator/light for travel, camping, picnicking, tailgate parties and boating. Extremely rugged construction protects the unit from most vibration and shock damage. It is water and dust resistant.

## FEATURES

- Powerful, pre-focused, replaceable quartz halogen spotlight
- Long-life, 2-LED, ultra bright area light
- 12 volt DC accessory outlet
- Built-in air compressor/inflator with pressure gauge, hoses and adapters
- Replaceable sealed lead acid battery
- Built-in 120 volt AC charger
- Fused 12 volt DC charging adapter
- Detachable storage bag
- LED battery charge level indicators
- Protective rubber safety guard (bezel) around lens
- Molded high-impact case is tough and durable

This device complies with part 15 of the FCC rules. Operation is subject to the following two conditions: (1) this device may not cause harmful interference, and (2) this device must accept any interference received, including interference that may cause undesired operation.

This equipment has been tested and found to comply with the limits for a Class B digital device, pursuant to part 15 of the FCC Rules. This limits are designed to provide reasonable protection against harmful interference in a residential installation. This equipment generates, uses and can radiate radio frequency energy and, if not installed and used in accordance with the instructions, may cause harmful interference to radio communications. However, there is no guarantee that interference will not occur in a particular installation. If equipment does cause harmful interference to radio or television reception, which can be determined by turning the equipment off and on, the user is encouraged to try to correct the interference by one or more of the following measures:

- Reorient or relocate the receiving antenna.
- Increase the separation between equipment and receiver.
- Connect the equipment into an outlet on a circuit different from that to which the receiver is connected.
- Consult the dealer or an experienced radio/TV technician for help.

## Overview

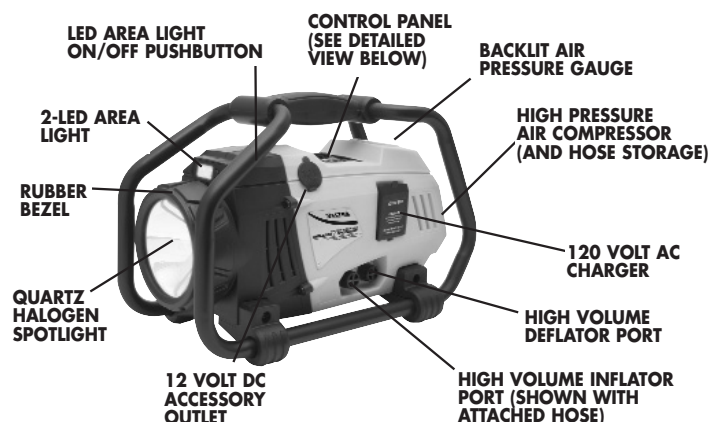

## Control Panel



## MAIN FUSE

This unit is delivered with the main fuse installed. If it needs replacement, a spare fuse is included. It should be inserted in the main fuse slot on the control panel (flip up the protective cover to access the slot).

## AC AND DC CHARGING/RECHARGING

For maximum battery life, we recommend the unit be kept fully charged at all times. If the battery is allowed to remain in a discharged state, battery life will be shortened.

- MAKE SURE ALL SWITCHES ARE TURNED OFF DURING RECHARGING.
- FULLY CHARGE THE UNIT USING THE 120 VOLT AC CHARGING METHOD BEFORE FIRST USE.
- Recharge the unit fully after each use.
- Recharge the unit every two months when it has not been used regularly.

**Notes:** Recharging the battery after each use prolongs battery life; frequent discharges between recharges reduces battery life.

*The Rechargeable Inflator/Spotlight also comes with a 12 Volt DC charging adapter for recharging the unit from a 12 volt DC accessory outlet in a vehicle.*

*If unit is fully discharged, it is recommended that the vehicle being used for recharging be left running while the unit is charged via the 12 volt DC method.*

## Viewing Battery Charge Status

Press the Battery Charge Level pushbutton to display battery status. The Battery Charge Level Indicator LEDs will light.

### LEDs (from left to right):

- Red LED indicates a low battery charge
- Two Red LEDs indicate a medium level or partially charged battery
- Two Red and one Green LEDs indicates a full or high level battery charge.

## 120 Volt AC Charging/Recharging

Connect the built-in 120 Volt AC Adapter's plug into a standard North American outlet using a common household AC extension cord (not supplied). The LED will light to indicate that the unit is charging. Time required to initially charge the unit using this method is approximately 5 to 6 hours. The LED Charging Indicator will blink when the unit is fully charged. **The Spotlight cannot be used while recharging using this method.**



## 12 Volt DC Charging/Recharging

The DC recharging method will NOT recharge the unit as effectively as the 120 volt AC method. The 12 volt DC recharging procedure is recommended only when it is necessary, since frequent use of the 12 volt DC recharging procedure may shorten the battery system's life.

1. Insert the gold-tipped end plug of the 12 Volt DC Adapter plug into the vehicle's 12 volt DC accessory outlet.
2. Insert the silver-tipped end plug into the 12 Volt DC Accessory Outlet on the back of the handle of the unit.
3. Charging time using this method is approximately 4 to 5 hours.
4. When charging is complete, remove the power cord and return it to the storage compartment.



**Note:** When using a vehicle's 12 volt DC accessory outlet as a charging/power source, be aware that some vehicles require the ignition be turned on to power the accessory outlet.

### ⚠ CAUTION

**Before charging/recharging the unit's battery, make sure all power switches are in the OFF position.**

## USING THE SPOTLIGHT

The quartz halogen Spotlight is operated by the ON/OFF switch located on the control panel.

## USING THE 2-LED AREA LIGHT

The 2-LED Area Light is operated by the LED Area Light ON/OFF Pushbutton located to the right of the Area Light on the front of the unit (directly above the Spotlight).



## USING THE 12 VOLT DC ACCESSORY OUTLET

The 12 volt DC accessory outlet powers any DC appliance that does not exceed 5 amps. Flip up the accessory outlet cover and insert the appliance's DC plug. Close the cover after use.



## USING THE AIR COMPRESSOR/INFLATOR

The built-in 12 volt DC Air Compressor is the ultimate inflator for all vehicle tires, trailer tires and sports inflatables. The attached Air Compressor Hose with standard tire valve connector (chuck) is located in the rear storage compartment and the three different sized nozzles are stored in the detachable accessory bag.

Each nozzle clips on the end of the standard tire valve connector attached to the free end of the air compressor hose.

The Inflator/Deflator is useful for quickly inflating and deflating such items as air mattresses, pool toys, etc. The detached Inflator/Deflator Hose connects to either the Inflator or Deflator port on the side of the unit. The Inflator/Deflator Hose is stored in the detachable accessory bag.

### ⚠ WARNING

**The air compressor is capable of inflating up to 150 pounds per square inch (psi). To avoid overinflating, carefully follow instructions on articles to be inflated. Never exceed recommended pressures. Always check pressure with the pressure gauge. Never leave the Air Compressor/Inflator unattended while in use. Bursting articles can cause serious injury.**

### ⚠ CAUTION

**Do not operate the Air Compressor/Inflator continuously for extended periods of time (approx. 15 minutes, depending on the ambient temperature), as it may overheat. In such event, the Air Compressor/Inflator will shut down and can be restarted after a cooling period of approximately 15 minutes.**

## Inflating Products With a Valve Stem Using the Compressor

1. Place the standard connector (chuck) of the Air Compressor Hose on the valve stem.
2. Push connector toward valve stem and close thumb latch.

**Note: Make sure connector is pushed onto valve stem as far as possible before closing thumb latch.**

3. Slide Air Compressor/OFF/Inflator Switch to COMPRESSOR.
4. Monitor the pressure gauge. When desired pressure is reached, slide the Air Compressor/OFF/Inflator Switch to OFF; open thumb latch and remove connector from valve stem.
5. Store the Air Compressor Hose in storage compartment.

## Inflating Products Without a Valve Stem Using the Compressor

Inflation of other items requires use of one of the adapters (nozzles).

1. Insert appropriate adapter (e.g. needle) into the connector (chuck) on the Air Compressor Hose and close thumb latch.
2. Insert adapter (e.g. needle) into item to inflate.
3. Slide the Air Compressor/OFF/Inflator Switch to COMPRESSOR.
4. Refer to the following table for approximate filling pressure and time. Small items such as volleyballs, footballs, etc. inflate very rapidly.
5. Monitor the pressure gauge. When desired pressure is reached, slide the Air Compressor/OFF/Inflator Switch to OFF; open thumb latch and remove connector from valve stem.
6. Remove adapter from item and store properly.

### Typical Inflation Times

	Inflation pressure (psi)	Approx. Filling time
<i>Vehicle and trailer tires</i>		
155/80R 13"	26	2.5 min.
185/70R 14"	30	4.5 min.
235/75R 16"	30	6.5 min.
235/70R 17"	42	16 min.
<i>Bicycle tires</i>		
27" X 1" (racing)	90	40 sec.
Football	13	24 sec.
Basketball	10	20 sec.
Volleyball	5	6 sec.

### ⚠ WARNING

**Always follow tire manufacturer's recommendations for pressure on item to be inflated.**

**Note: Thermo-protection device shuts down the unit when the unit overheats and restarts once the unit has reached a safe operating temperature (usually 15 minutes).**

## Using the Inflator/Deflator

### Inflating

1. Locate the inflation valve on your product and open it.
2. Fasten the Inflator/Deflator Hose (stored in the accessory bag on the side of the unit) to the **Inflator Port**.
3. Attach the appropriate nozzle to the free end of the Inflator/Deflator Hose.
4. Slide the Air Compressor/OFF/Inflator Switch to INFLATOR (bottom position).
5. When product is fully inflated, turn the Air Compressor/OFF/Inflator Switch to OFF, remove hose from valve and close the valve.

### Deflating

1. Open the valve on your product completely to release air.
2. Fasten the Inflator/Deflator Hose (stored in the accessory bag on the side of the unit) to the **Deflator Port**.
3. Attach the appropriate nozzle to the free end of the Inflator/Deflator Hose.



- Slide the Air Compressor/OFF/Inflator Switch to INFLATOR (bottom position).
- When product is fully deflated, turn the Air Compressor/OFF/Inflator Switch to OFF, remove hose from valve and close the valve.

## CARE AND MAINTENANCE

All batteries lose charge with time. AC recharge is recommended after each use or every two months when not in frequent use. Use the AC recharger and charge for the recommended time.

If the unit gets dirty, gently clean the outer surfaces of the Spotlight with a soft cloth moistened with a mild solution of water and detergent. Periodically inspect the condition of recharge adapters, connectors, and wires. Replace any components that may have become worn or broken.

### Replacement Parts

The quartz halogen bulb and sealed lead acid batteries are available through Vector Manufacturing. A comparable (12 volt H3, 25 watt) bulb may be substituted. These can also be purchased from popular automotive parts suppliers nationwide. Contact Vector Manufacturing's Technical Support Department for replacement parts (including replacement adapters and cords) and any additional information that you may need. They may be reached at (954) 584-4446 or toll free at (866) 584-5504.

### ⚠ WARNING

**To reduce the risk of shocks or burns and avoid damage to the unit, make sure all power switches are in the OFF position, all adapters are unplugged and the unit has been allowed to cool down before performing any maintenance/parts replacement.**

### Bulb Replacement

- Remove the rubber bezel on the rim of the Spotlight to reveal eight small Phillips screws in the retaining ring.
- Using a screwdriver, remove (counterclockwise) the screws and set them aside.
- Lift off the retaining ring, glass lens and rubber "O" ring and set them aside.
- Carefully remove the reflector and bulb assembly.
- Disconnect the bulb from the guarding wires and replace the burned out bulb with one of the same type listed in the Specifications section of this manual.
- Reassemble the guarding wires, put back the reflector, rubber "O" ring and the lens.
- Replace rubber bezel by sliding forward to the front of the spotlight.
- Turn one of the spotlight's ON/OFF switches to the ON position to ensure proper operation of spotlight.

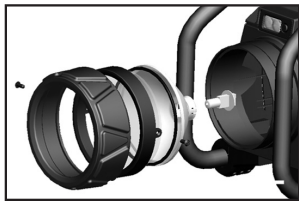

## Battery Replacement/Disposal

It is recommended that the unit be returned to Customer Service for battery replacement. Contact toll-free (866) 584-5504.

This unit contains a maintenance-free, non-spillable, sealed lead-acid battery. This battery is fully recyclable and should be accepted at any location that accepts common automotive starter batteries. Examples of places that accept these batteries are: county or municipal recycling drop-off centers, scrap metal dealers and retailers who sell automotive replacement lead acid starter batteries.



### ⚠ WARNINGS

**Do not dispose of the battery in fire, as this may result in an explosion. Before disposing of the battery, protect exposed terminals with heavy-duty electrical tape to prevent shorting (shorting can result in injury or fire).**

**Do not expose battery to fire or intense heat, as it may explode.**

### DC Plug Fuse Replacement

The fuse in the DC plug protects the charging circuit of the DC recharge adapter. If the AC recharger operates but the DC charging adapter does not, then the fuse may be opened.

To replace the fuse:

- Unscrew the end cap of the DC plug (counterclockwise).
- Remove spring center contact and fuse.
- Check fuse with a continuity checker.
- If blown, locate replacement fuse with same type and rating.
- Replace the fuse, spring, contact and end cap.
- Screw end cap clockwise until it is finger tight – DO NOT OVER-TIGHTEN.
- Check for proper operation of DC charging adapter.

## TROUBLESHOOTING

### No Charge Indicator Light

If the Charge Indicator LED does not light during 120 Volt AC charging/recharging, do the following:

- Check for bad connection to the AC Recharge Port
- Check for bad connection to the AC adapter
- Confirm there is functioning AC or DC current

**Note: None of the Charge Indicator LEDs light during 12 Volt DC charging/recharging.**

### Operating Issues

- When charging using the 120 volt AC method, the Spotlight will not operate. The Area Light will turn on when pressed while charging. Be sure all adapters are disconnected before Spotlight usage.
- If the unit does not operate, the battery may be completely discharged. Charge the unit using the AC adapter following the directions in the manual.