

## SETUP HARDWARE

### Remove Battery Holder

**A:** Slide removal tool onto Nokē ONE so the edge of tool and left edge of Nokē ONE connect

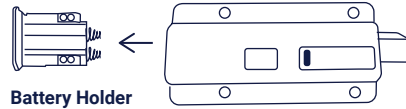
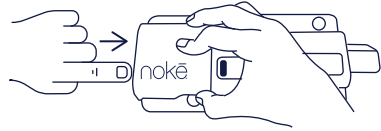
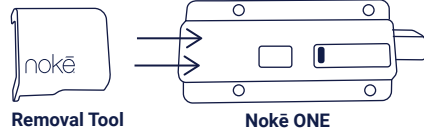

**B:** While tightly holding removal tool in place, use opposite hand to firmly push in battery holder to release it

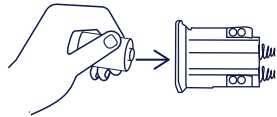

\*Use only battery supplied with Nokē One. Do not attempt to use other batteries as they will not have the necessary voltage, current, and capacity required for optimal performance

**C:** Insert battery into battery holder. Be sure positive end is on the right

**D:** With battery in holder, insert the battery holder back into the device. Press firmly on top and bottom to engage both hooks

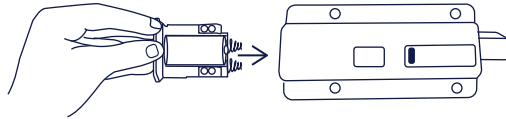

## TESTING HARDWARE \*Be sure Nokē ONE is functioning correctly before installing on door

### Unlock and Lock Nokē ONE

**A:** Before being added to the site and receiving electronic keys, you can unlock Nokē ONE by touching the plastic window on the front of the device three times. The light will turn blue when touch is accepted

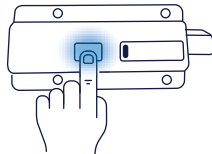

**B:** After touching three times, the light will turn green to indicate that the Nokē ONE device is now ready for unlocking

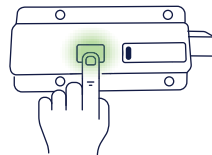

**C:** Slide the hasp left to the open position and right to lock. The light will turn red to confirm device is locked

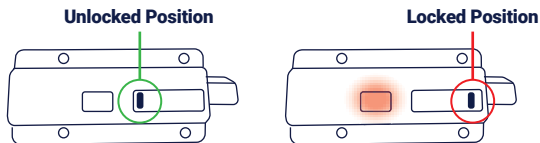

## INSTALLATION \*Remove the existing Hasp from the door before installing Nokē ONE Device

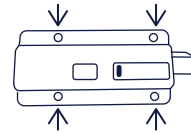

\*See back side of guide for instructions on how to use the included alignment template

**A:** Confirm the four existing holes line up with bolts on Nokē ONE. \*Drill new holes if needed

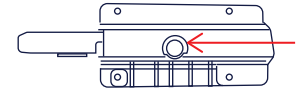

**B:** If door does not have a middle hole for cam lock, an additional hole will need to be drilled to accommodate the plastic back window for the motion sensor

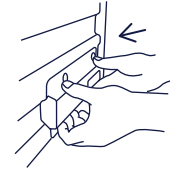

**D:** Push Nokē ONE firmly onto door

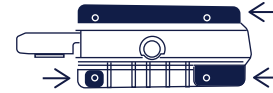

**C:** Remove backing from adhesive mounting tape on back side of Nokē ONE

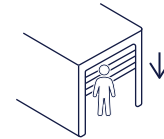

**E:** Open door and go inside unit and then pull door back down. You are now inside unit and can see the back of the device

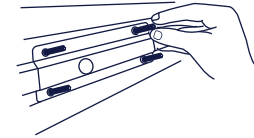

**F:** While looking at four bolts, pull firmly on each of them to extend them through door

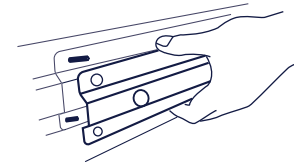

**G:** Place mounting plate over holes. Be sure to orient the plate so center hole is closer to the bottom

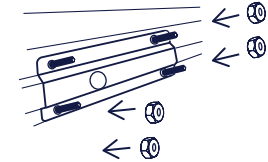

**H:** Add the four nuts to ends of bolts and tighten

## ADDING Nokē ONE TO SITE

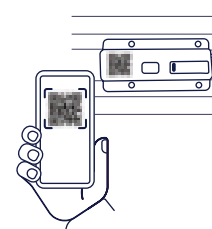

**A:** Use the Nokē Smart-Entry App to scan QR code on the device and add device to the Smart-Entry system



**B:** Using web portal, be sure electronic keys are sent to Nokē ONE via gateways



**C:** Use the app to unlock the device after it has been synced to the system. The QR sticker can now be removed

## SUPPORT

If you need support, please call 1(833) 257-0240

## USING THE ALIGNMENT TEMPLATE

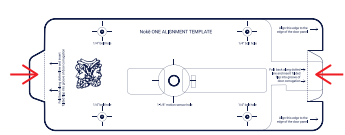

**A:** Fold both flaps back along dotted line

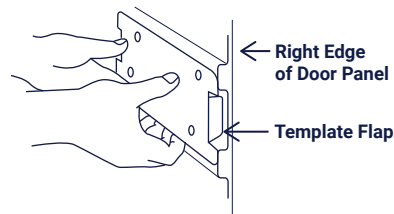
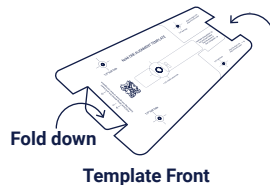

**B:** Align the right edge of template to the edge of the door panel.  
For vertical alignment, insert folded flaps into groove in the door corrugation

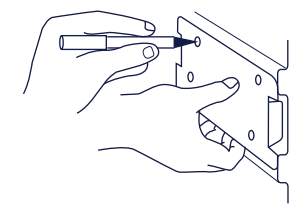

**C:** Use a marker to mark positioning for holes and then drill holes

### FCC Compliance Statement

This equipment has been tested and found to comply with the limits for a Class B digital device, pursuant to part 15 of the FCC rules. These limits are designed to provide reasonable protection against harmful interference in a residential installation.

This equipment generates, uses and can radiate radio frequency energy and, if not installed and used in accordance with the instructions, may cause harmful interference to radio communications. However, there is no guarantee that interference will not occur in a particular installation. If this equipment does cause harmful interference to radio or television reception, which can be determined by turning the equipment off and on, the user is encouraged to try to correct the interference by one or more of the following measures:

- Reorient or relocate the receiving antenna.
- Increase the separation between the equipment and receiver.
- Connect the equipment into an outlet on a circuit different from that to which the receiver is connected.
- Consult the dealer or an experienced radio/TV technician for help.

To assure continued compliance, any changes or modifications not expressly approved by the party responsible for compliance could void the user's authority to operate this equipment.

This equipment complies with Part 15 of the FCC Rules.  
Operation is subject to the following two conditions:

1. This device may not cause harmful interference, and
2. This device must accept any interference received, including interference that may cause undesired operation.

### RF Warning Statement:

This equipment should be installed and operated with a minimum distance of 20CM between the radiator and your body.

Nokē ONE  
FCC ID: 2AFRJ-1A



Nokē Inc. hereby declares that this unit complies with the fundamental requirements and relevant regulations set forth by Guideline 1999/5/EU. The declaration of conformity can be found at [noke.com/ce](http://noke.com/ce) or requested by e-mail: [support@noke.com](mailto:support@noke.com)

©2020-21 Nokē



## QUICK START GUIDE

