

# INSTRUCTIONS FOR: COOLING SYSTEM PRESSURE TEST KIT - 25PC

MODEL No: VS0011

Thank you for purchasing a Sealey product. Manufactured to a high standard this product will, if used according to these instructions and properly maintained, give you years of trouble free performance.



**IMPORTANT: PLEASE READ THESE INSTRUCTIONS CAREFULLY. NOTE THE SAFE OPERATIONAL REQUIREMENTS, WARNINGS & CAUTIONS. USE THE PRODUCT CORRECTLY AND WITH CARE FOR THE PURPOSE FOR WHICH IT IS INTENDED. FAILURE TO DO SO MAY CAUSE DAMAGE AND/OR PERSONAL INJURY AND WILL INVALIDATE THE WARRANTY. PLEASE KEEP INSTRUCTIONS SAFE FOR FUTURE USE.**

## 1. SAFETY INSTRUCTIONS

- ❑ **WARNING!** Ensure all Health & Safety, local authority and general workshop practice regulations are strictly adhered to when using this product.
- ❑ **WARNING!** Ensure the radiator is cool before opening the cap.
- ❑ **WARNING!** Take great care when working with hot, pressurised cooling systems. There is a high risk of very serious scalding. Always wear hand and eye protection.
- ✓ Maintain tester and parts in a good clean condition for the best and safest performance. **DO NOT** use tester if damaged.
- ✓ Wear suitable clothing to avoid snagging. **DO NOT** wear jewellery and tie back long hair.
- ✓ Use proper ventilation and avoid breathing in exhaust fumes.
- ✓ Keep a fire extinguisher to hand.
- ✓ Account for all tools and parts being used and **DO NOT** leave them in or near the engine.
- ✓ Keep tester parts clean and dry and store each component part in its appropriate location in the carry case.
- IMPORTANT:** Always refer to the vehicle manufacturer's service instructions, or proprietary manual, to establish the current procedure and data. These instructions are provided as a guide only.
- ✓ Ensure the gauge is reading zero (to indicate no pressure), before disconnecting.

## 2. DESCRIPTION

Traditional style cooling system pressure testing kit. Features five new adaptors, increasing the vehicle applications. Suitable for Alfa Romeo, Audi, BMW, Chrysler, Citroen, Daewoo, Fiat, Ford, Honda, Hyundai, Kia, Lancia, Mazda, Mercedes Benz, Mitsubishi, Nissan, Peugeot, Renault, Rover, Saab, Seat, Skoda, Suzuki, Toyota, Vauxhall/Opel, Volvo and VW. Also includes non-specific adaptors for other makes.

### Locates system leaks from:

- Head gasket.
- Header tank.
- Radiator and heater cores.
- Water pumps, hoses and housings.

Kit features adaptors fitted with quick-release couplings and high-powered pump with large, easy-to-read dial.

## 3. OPERATING INSTRUCTIONS

### 3.1. SET-UP.

- 3.1.1. Remove the radiator cap and clean around the radiator fitting.
- 3.1.2. Fit the appropriate vehicle adaptor as follows:
- 3.1.3. **Screw cap fastening.**  
Select the correct adaptor cap size for the type of vehicle and radiator to be tested. Screw the cap onto the radiator and check that the rubber gasket is correctly fitted.
- 3.1.4. **Expansion tank - European cars (See fig.1).**  
Select the correct adaptor (fig.1.9, 10 or 11) for the type of vehicle and tank to be tested. Screw the adaptor into the adjusting connector (fig.1.8). Fasten the two metal clips of the adjusting connector to the filler neck and wind the upper knob to ensure a tight fit.
- 3.1.5. **Expansion tank - Japanese cars (See fig.2).**  
Select adaptor (fig.2.12) for Japanese cars and attach it to the adjusting connector (fig.2.8) using the integral clips.  
Select the correct adaptor (fig.2.9, 10 or 11) for the type of vehicle and tank to be tested. Screw the adaptor into the adjusting connector. Place the assembly over the filler neck and wind the knob on the bayonet connector to ensure that the adaptor seals down on the top of the filler opening.
- 3.1.6. Connect the pump to the cap by means of the quick-release coupling at the end of the pump hose.

fig.1 EUROPEAN CARS

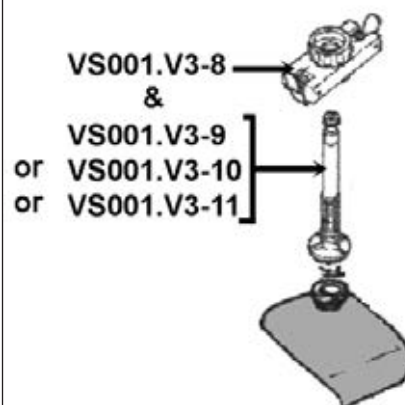

VS001.V3-9 = Ø50mm  
VS001.V3-10 = Ø35mm  
VS001.V3-11 = Ø27mm

fig.2 JAPANESE CARS

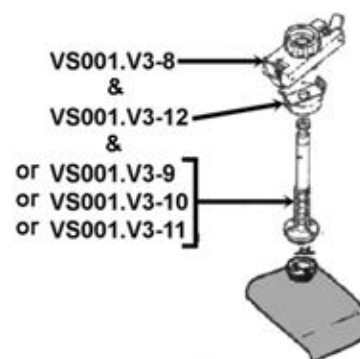

### 3.2. CHECKING THE SYSTEM.

**NOTE:** Due to the design of the internal pump seal, a vigorous pumping action is required to activate the seal and pressurise the system. A light or slow pumping action will prove ineffective. The larger the air space within the cooling system being tested, the more vigorous the initial pumping should be. By filling the cooling system and therefore reducing the air space within, less effort will be needed to pressurise it.

- 3.2.1. Pump the system until the pressure gauge (fig.3) indicates approximately 15psi.
- 3.2.2. If gauge pointer remains stationary for one minute, it will indicate that the cooling system is in good working order.
- 3.2.3. If the pointer falls it indicates that the system has a leak, resulting in loss of pressure.
- 3.2.4. Check the system for water leaks and, if located, repair accordingly.
- 3.2.5. If there is pressure loss but no external water leakage, check the condition of the head gasket.
- 3.2.6. Re-test to ensure the repaired system is in good working order.

**Note!** To release pressure from the pump, press the release valve (fig.3). Ensure the gauge is reading zero to indicate no pressure, before disconnecting.

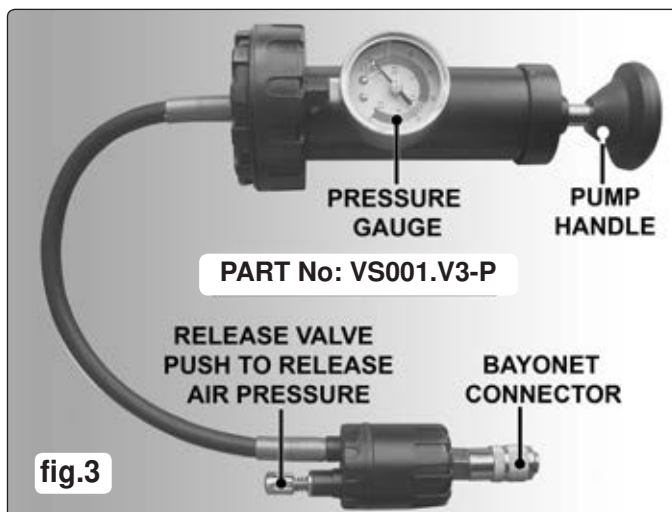

## 4. APPLICATIONS CHART

Alfa Romeo: .....VS001.V3-4  
Audi: .....VS001.V3-2, 3, 4 or 7  
BMW: .....VS001.V3-4, 5 or VS001.23  
Chrysler: .....VS001.V3-8, 7 or 10  
Citroen: .....VS001.V3-7, 8 or 10  
Daewoo: .....VS001.V3-2  
Fiat: .....VS001.V3-6 & 7  
Ford: .....VS001.V3-2, 3, 16, 17, 18, 20 or VS001.21  
Honda: .....VS001.V3-7, 15 or 16  
Hyundai: .....VS001.V3-16  
Kia: .....VS001.V3-13  
Lancia: .....VS001.V3-7  
Mazda: .....VS001.V3-16  
Mercedes Benz: .....VS001.V3-1, 8+10 or 9

Mitsubishi: .....VS001.V3-8, 10+16  
Nissan: .....VS001.V3-8+10, 8+11+16  
Peugeot: .....VS001.V3-6 or 7  
Renault: .....VS001.V3-6 or 7  
Rover: .....VS001.V3-5, 6 or 7  
Saab: .....VS001.V3-2  
Seat: .....VS001.V3-3 or 4  
Skoda: .....VS001.V3-2 or 3  
Suzuki: .....VS001.V3-8+11+12 or 8+10 or 8+11  
Toyota: .....VS001.V3-8+11 or 15 or VS001.25  
Vauxhall/Opel: .....VS001.V3-3, 6, 7, 16, VS001.22 or 24  
Volvo: .....VS001.V3-6 or 7  
VW: .....VS001.V3-2, 3, 4 or 7

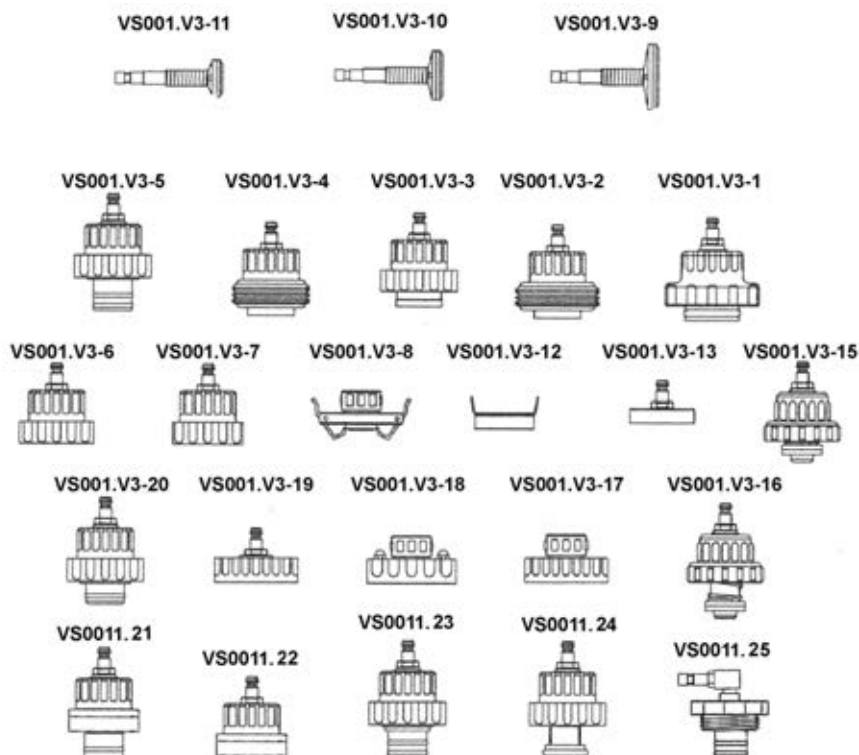

**NOTE:** It is our policy to continually improve products and as such we reserve the right to alter data, specifications and component parts without prior notice.

**IMPORTANT:** No liability is accepted for incorrect use of this product.

**WARRANTY:** Guarantee is 12 months from purchase date, proof of which will be required for any claim.

**INFORMATION:** For a copy of our latest catalogue and promotions call us on 01284 757525 and leave your full name and address, including postcode.



**Sole UK Distributor, Sealey Group,**  
Kempson Way, Suffolk Business Park,  
Bury St. Edmunds, Suffolk,  
IP32 7AR

01284 757500

01284 703534

[www.sealey.co.uk](http://www.sealey.co.uk)

[sales@sealey.co.uk](mailto:sales@sealey.co.uk)