



## 12kg Top Load Washing Machine

KAMWASHT12A & KAMWASHT12B

Safety & Warnings	3
Components	7
Overview	8
Installation	9
Operation	17
Cleaning & Care	23
Specifications	27
Troubleshooting	27
Notes	29

# Safety & Warnings

Read all the instructions in this guide carefully before using this product. Retain this guide for future reference.

## Explanation of the Symbols

- **Warning:** This combination of symbol and signal word indicates a potentially dangerous situation which may result in death or serious injuries unless it's avoided.
- **Caution:** This combination of symbol and signal word indicates a potentially dangerous situation which may result in slight or minor injuries or damage to property and the environment.
- **Note:** This combination of symbol and signal word indicates a potentially dangerous situation which may result in slight or minor injuries.

## Electrical Safety

- If using a power board or portable power unit, keep it dry and away from water splashes. Do not share the socket with other electrical appliances. Avoid using loose plugs or sockets.
- Ensure the power plug is easily accessible during use. Unplug the washing machine and turn off the water tap when not in use, cleaning, or in case of power failure. Avoid plugging or unplugging with wet hands.
- Do not bend, stretch, twist, or overload the power cord.
- If the power cord or plug is damaged, cease use immediately and contact **help.Kogan.com** for support.
- Avoid installing the washing machine in bathrooms or damp areas. Do not wash the washing machine with water or place wet clothes on the control panel.
- Keep the washing machine out of direct sunlight and away from heat sources.
- Do not place the washing machine on carpets or areas without floor drains if it has a drainage function.

## For Your Safety

- Do not insert hands into the drum while the washing machine is operating. Supervise children to prevent accidents.
- If the spin tub does not stop within 15 seconds after opening the cover, cease use immediately and contact **help.Kogan.com** for support.

- Ensure the new hose sets supplied with this product are used. Never use old hose sets.
- Do not attempt to disassemble, repair, or modify the washing machine yourself.
- Before any maintenance or cleaning, unplug the appliance from the electrical outlet.
- Always unplug the washing machine and turn off the water supply after use.
- To ensure your safety, power plug must be inserted into an earthed three-pole electrical outlet. Check carefully and make sure that your outlet is properly and reliably earthed.
- Ensure that the product is installed in accordance with the instructions in this user guide.
- This appliance can be used by children aged 8 years and above and people with reduced physical, sensory or mental capabilities or lack of experience and knowledge if they have been given supervision or instruction concerning use of the appliance in a safe way and understand the hazards involved. Children should not play with the appliance. Cleaning and user maintenance shall not be done by children without supervision.

## **Safety Precautions on Maintenance**

- Children should be supervised to ensure that they do not play with appliances.
- Animals and children may climb into the washing machine. Check the washing machine before every operation.
- Young children should be supervised that they do not play with the appliance.
- This appliance may be hot during the operation. Keep kids and pets far away from the washing machine during the operation.
- Keep the washing machine out of direct sunlight and away from heat sources.
- To avoid damage, remove all packaging before using the appliance.
- Ensure the inlet valves are correctly connected to cold-water supply.
- The power plug must be accessible after installation.

## **Risk of Explosion**

Do not wash or dry articles that have been cleaned in, washed in, soaked in or dabbed with combustible or explosive substances (such as wax, oil, paint, gasoline, degreasers, dry-cleaning solvents, kerosene, etc.). This may result in fire or explosion. Thoroughly rinse items by hand before washing.

## Installing the Product

- This washing machine is for indoor use only.
- This product is not intended to be built-in.
- The openings must not be obstructed by a carpet.
- Avoid installing the washing machine in bathrooms or damp areas. Do not wash the washing machine with water or place wet clothes on the control panel.
- Remove all packaging and transport bolts before using the appliance. Otherwise, serious damage may result.
- A washing machine with a single inlet valve only can connect to cold-water supply.
- Plug must be accessible after installation.
- Risk of Damaging Appliance
- This product is intended for home use only.
- Do not climb up and sit on the top cover of the washing machine.
- Do not lean against the washing machine door.
- During transport:
  - Transport bolts must be reinstalled into the washing machine before transport.
  - The accumulated water shall be drained out of the washing machine.
  - Handle the washing machine carefully. Never hold protruding parts on the washing machine while lifting. Washing machine doors cannot be used as the handle during transport.
  - This appliance is heavy. Always transport with care.
- Do not close the door with excessive force.
- This appliance must not be used to wash carpets.

## Operating the Appliance

- Before washing the clothes for the first time, it is highly recommended to run a full cycle without clothes inside.
- Flammable and explosive or toxic solvents are forbidden and must not be used in or on this appliance.
- Gasoline, alcohol or solvents should not be used as detergents.
- Ensure you use detergents suitable for top loading washing machines.
- Ensure that all pockets are emptied before loading. Sharp and rigid items such as coins, brooches, nails, screws or stones may cause serious damage to this washing machine.

- Ensure the water inside the drum has been drained before opening the door. Do not open the door if there is any water visible.
- Never refill the water by hand during washing.
- After the program is completed, wait for at least 2 minutes before opening the door.

## **Disposal**

- Contact your local environmental authority to find the correct method of disposal. Dispose of all packaging in a responsible manner in accordance with local regulations.
- Dispose of old appliances in accordance with local regulations. Remove the doors, cut off the main cable, break or remove spring or bolt catches if fixed to prevent children getting trapped or involve themselves in other dangers.

## **Risk to Children**

- This product can be used by children aged 8 years and over, and by persons with reduced physical, sensory or mental capabilities or lack of experience and knowledge, only if they have been given supervision or instruction on how to use the product safely and understand the associated hazards
- Children must not play with the product. Cleaning and maintenance must not be carried out by children without adult supervision
- Always check the interior before use. Children or pets may climb into the appliance
- Keep children under supervision to ensure they do not play with the product
- The appliance becomes hot during operation. Keep children and pets away while the product is in use
- Do not operate the product in extremely wet environments or in areas with explosive or corrosive gases
- Remove all packaging materials before use. Failure to do so may result in serious damage
- If the product has a single inlet valve, it must be connected to a cold-water supply only. Products with dual inlet valves must be correctly connected to both hot and cold-water supplies
- Ensure the power plug is easily accessible after installation

# Components



Upper Drain Hose  
(optional)



Cold Water Supply Hose



Hot Water Supply Hose  
(optional)



Bottom Cover



Screw



User Guide

## Note:

If the drain hose is already installed on the machine, then there is no spring clamp and drain hose in the accessories.

# Overview

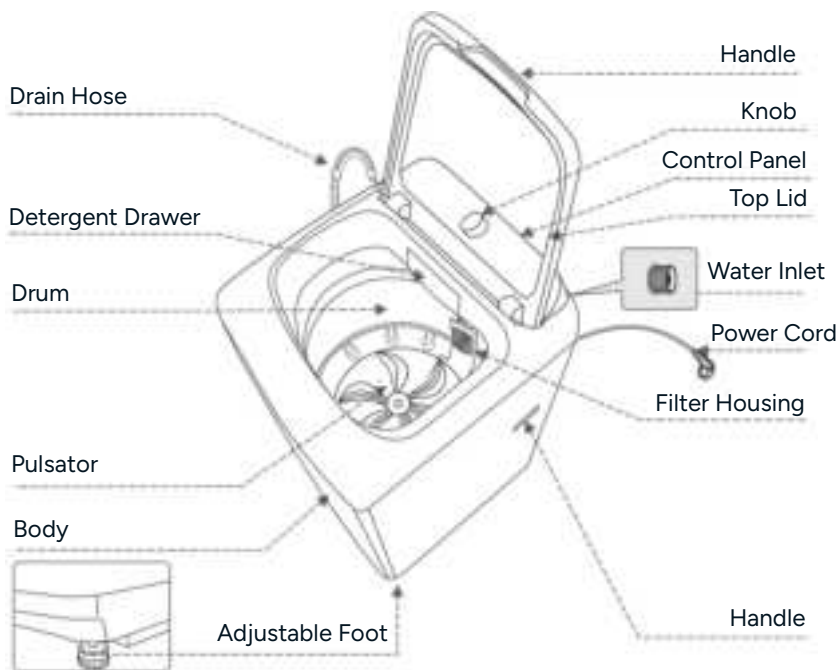

## Note:

All images shown are for illustrative purpose only. The actual product and components may differ.



# Installation

## Unpacking the Washing Machine

### Warning:

- Packaging material (e.g. films, Styrofoam) can be dangerous for children.
- There is a risk of suffocation! Keep all packaging well away from children.

1. Pull the carton straight up and over the top of the washing machine.
2. Lift the washing machine off the foam cushion.



- Operating the washing machine whilst on the foam cushion is strictly forbidden.
- Do not open the carton from the top. It is easily damaged and will make it difficult to remove.
- To avoid injury to people and damage to property, do not burn the carton in a fireplace.
- Packaging material can be dangerous for children. There is a risk of suffocation! Keep all packaging away from children.

## Location

- Place the washing machine in a dry area, away from direct sunlight above 0°C.
- Ensure there is a floor drain where the washing machine will be installed, with unobstructed water flow. The floor drain should be flush with or slightly lower than the washing machine's placement to prevent damage from potential water leakage.
- Position the washing machine on a flat, solid floor, maintaining a distance of at least 20mm from the side and 45mm from the rear.

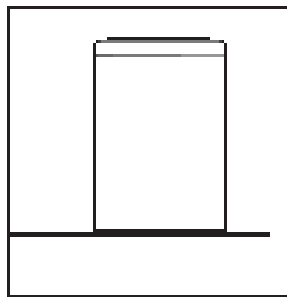
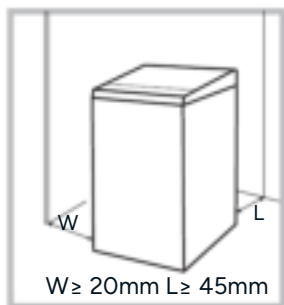

### Caution:

Do not block the ventilation openings on the bottom of washer by carpeting when the washer is installed on a carpeted floor.

## Levelling the Washing Machine

1. Check that all legs are securely attached to the cabinet. If not, rotate them back to their original positions and tighten the lock nuts
2. Use a spirit level to check whether the product is properly aligned. Adjust if necessary to ensure level placement
3. Loosen the lock nuts and turn the feet until they are in full contact with the floor
4. Once the feet are adjusted and secured, press down on all four corners to confirm the machine is stable and level
5. If needed, adjust the height of the washer's adjustable leg to maintain balance. The maximum permissible tilt of the supporting surface is 2°

### Warning:

Ensure the lock nuts on all four feet are firmly tightened against the cabinet to prevent movement during operation.

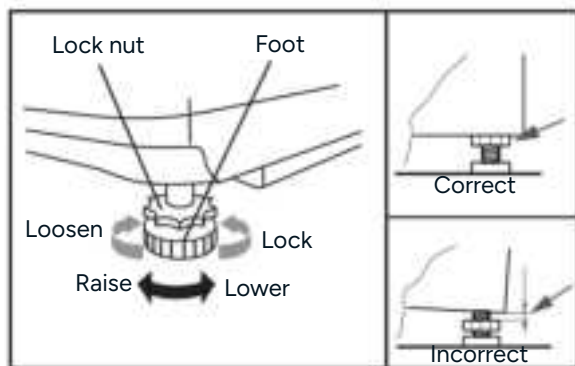

## Installing the Bottom Cover

1. Unplug the power cord of the washer.
2. Locate the bottom cover and remove it during unpacking.
3. Gently lay down the backside of the washing machine on a soft mat or cushion. (Be careful not to dent the Frame.)
4. Align the bottom cover with the hooks of base and push towards the rear until it reaches into the back hooks.
5. Use the screw provided in the accessory bag to fasten the bottom cover to the base.
6. Gently lift the washing machine back to its upright position and ensure it is stable.

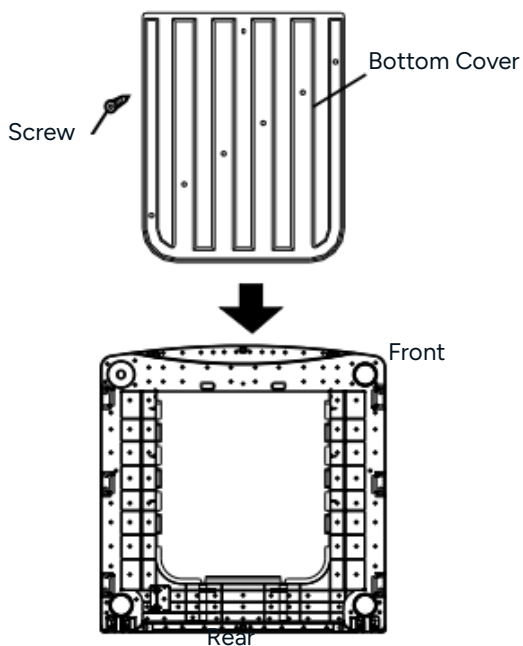

### Note:

All images shown are for illustrative purpose only. The actual product and components may differ.

## Installation the Drain Hose

### **Warning:**

- Do not bend, twist or excessively extend the drain hose
- Ensure the drain hose is positioned correctly to avoid water leakage or damage
- If the drain hose is too long, do not push it into the washing machine, as this may cause abnormal noise during operation.

### **Note:**

For models with an upper drain system, the drain hose is pre-installed at the factory and requires no further assembly. The following instructions and images apply only to models with a lower drain system.

1. Pinch both sides of the hose clamp and attach it securely to the drain outlet located on the rear panel of the washing machine
2. Refit the hose clamp towards the end of the drain hose to ensure a tight seal
3. When the washing machine is not in use, hang the drain hose in the holder on the right side of the top frame
4. During operation, place the end of the drain hose securely in a sink or standpipe

5. There are two acceptable options for positioning the end of the drain hose, depending on your setup. Ensure the hose remains securely in place and does not become dislodged during use.

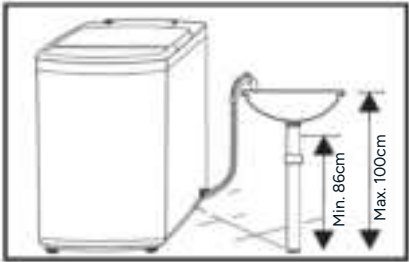
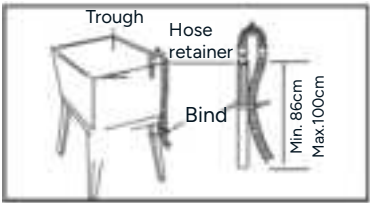
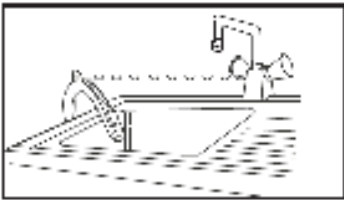

**Tap Selection and Inlet Hose Connection**

Select a compatible tap for installation. The inlet hose can be connected to an ordinary tap, a screw tap, or a special washing machine tap.



Standard Tap



Screw Tap



Washing Machine Tap

## Connecting to a Standard Tap

1. Loosen the clamp nut until approximately 5 mm of thread is exposed
2. Loosen all four bolts on the connecting base
3. Position the connecting base onto the tap and tighten the bolts evenly to secure it
4. Tighten the clamp nut to hold the base in place
5. Press the slide bushing and insert the inlet hose into the connecting base until it clicks into position
6. Ensure the connection is secure and properly aligned
7. Turn on the tap and check for any water leakage

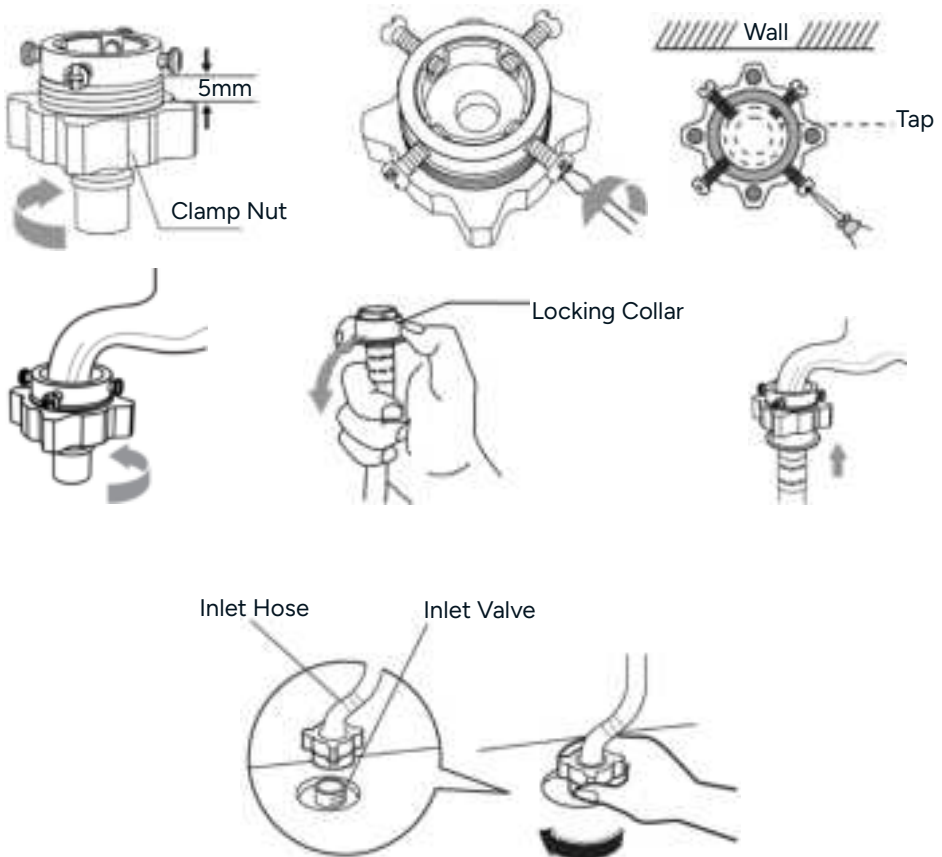

## Connecting to a Screw Tap

If using a threaded tap, simply screw the inlet hose fitting directly onto the tap until secure. Ensure the connection is tight and leak-free.

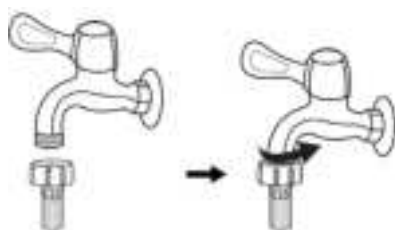

## Connecting to a Special Washing Machine Tap

If using a tap designed for washing machines, insert the inlet hose directly into the special tap connection and ensure it is fully secured. Check for leaks after turning on the tap.



### Warning:

- To prevent leakage or water damage, follow the instructions in this chapter!
- Do not kink, crush, modify or sever water inlet hose.



# Operation

## Preparation of Laundry Before Washing

- Ensure pockets are empty (pins, coin or something may possibly damage clothes or washing machine).
- Wool items, underwear, articles with embroidery, nylon etc., should be placed in a laundry bag for extra protection.
- Close all fasteners and tie loose laces.
- Press light clothing down.
- Separate white clothes from coloured clothes, coats from underwear.

## Control Panel

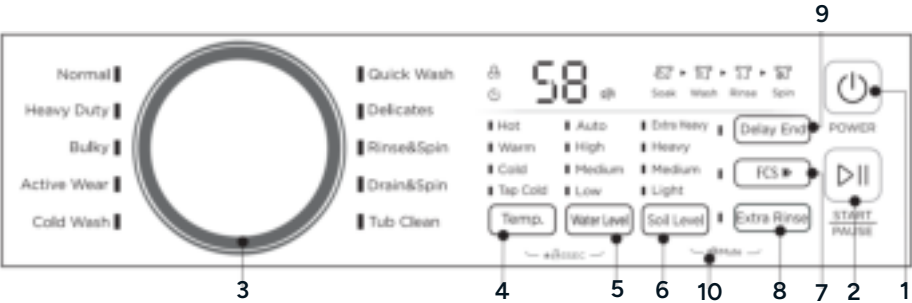

1	Power Button	Press to turn the appliance on/off.
2	Start/Pause Button	<ul style="list-style-type: none"><li>• Press to start the washing operation.</li><li>• Press again to temporarily pause the operation.</li><li>• Press once more to resume operation.</li></ul>
3	Program Knob	Press to choose the appropriate washing program based on the laundry type.
4	Temp Button	Press to select the washing water temperature. The rinse water temperature is always cold.
5	Water Level Button	<ul style="list-style-type: none"><li>• Press to adjust the water level according to the laundry load size.</li><li>• Different water levels can be selected for washing and rinsing.</li></ul>
6	Soil Level Button	Select clothes soil level. There are 4 levels to choose from, Extra Heavy, Heavy, Medium and Light.

7	FCS Button (Fast Cycle Setting)	After selecting a wash program, press the 'FCS' button to enable the fast cycle function. The indicator light will turn on, and the selected program will run in a shorter time while still maintaining effective cleaning performance. To cancel this function, press the 'FCS' button again
8	Extra Rinse Button	Select to add a rinse cycle.
9	Delay End Button	Press the button to preset delay end time.
10	Mute Button	Cancel button beeps and program sound by pressing soil level and extra rinse together at the same time.

## Operation Steps

1. Preparation
  - a. Ensure the drain hose is fitted.
  - b. Connect the water supply hoses to the faucet and turn the faucet on.
  - c. Plug the power cord into a the electrical outlet.
  - d. Place clothes inside.
  - e. Close the lid.
2. Press 'Power Button'.
3. Use the recommended amount of detergent as shown in chart.
4. Press 'Start/Pause button'.
  - Sensor tests the clothes weight automatically. (For Standard/ Custom/ Heavy/ Quick Wash).
  - Select water level, wash/spin time, water flow.

## After Washing

1. Buzzer will beep after washing finished and the power supply will be cut off automatically.
2. Unload the laundry.

### **Warning:**

- Washing a single item may cause imbalance and trigger an unbalanced load alarm. To ensure smooth drainage and operation, add one or two additional garments to the load
- Do not wash clothing that has come into contact with flammable substances such as kerosene, petrol, or alcohol.

## **Using Detergent and Additives**

- If using thick or clumped detergent or additives, dilute them with water before pouring into the detergent compartment. This prevents blockages or overflow during water intake
- Select the appropriate detergent for the wash temperature and fabric type to achieve optimal cleaning results while minimising water and energy use.

## **Selecting a Program**

1. Press the 'Program button' to select the program you need according to your load. Refer to the chart below.

Program	
Normal	Standard fabric washing program, suitable to wash ramie cotton fabric wash for once, rinsing for twice, the spin time is a little long.
Bulky	Suitable to wash bulky clothes. For example Jeans and so on.
Active Wear	Suitable to wash Active Wear clothes.
Cold Wash	Using cold water to get better protection of the clothes and keep the original colour the clothes.
Rinse & Spin	Select this program to run only the rinse and the spin functions
Drain & Spin	Select this program to run only the drain and the spin functions
Heavy Duty	Use this program when washing heavy duty clothes like Jeans and blanket.
Delicates	The water flow is infirmly. It is used for washing woollens, thin clothes or cleaner clothes.
Tub Clean	It will be adhered to wash powder's residue inside and outside the barrel because of the pollution and the problem of the water quality. It will take smelly and the drain will not be flowing. Otherwise, the

	adhering residue will take off during the wash process. And the clothing will be dirty. User should clean the tub monthly.
Quick Wash	To wash light dirty clothes with only one rinsing cycle.
Hand wash	Select this program for washing dirty clothes, so that the clothes after washing to show the effect of hand rubbing.
Whites	To wash white clothes
Casuals	To wash casual

## Options

(Only available on models with these features).

### Water Level:

Select the water level based on fabric type, load size, and how soiled the items are. This option is not available for Drain & Spin or Tub Clean programs.

### Temp:

Press the ‘Temp’ button to select from Hot, Warm, Cold, or Tap Cold water settings for the wash cycle.

### Delay End:

Use this function to delay the end of the wash cycle

1. Select a program
2. Press the ‘Delay End’ button. The Delay End light will illuminate
3. Press the ‘Delay End’ button repeatedly to choose the desired time
4. Press ‘Start/Pause’ to begin the delay countdown

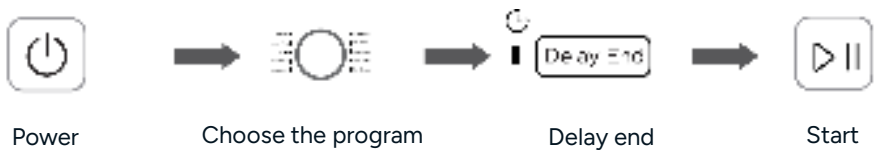

### Caution:

- If power is interrupted during use, the selected program is saved and will resume when power is restored
- The display shows the end time of the delay, not the start time.

## Child Lock

Activate this function to lock all control panel buttons and prevent unintended operation

### How to lock:

1. Press the 'Power' button to turn on the appliance
2. Press the 'Start/Pause' button to begin washing
3. Press and hold both the 'Temp' and 'Water Level' buttons for 3 seconds.

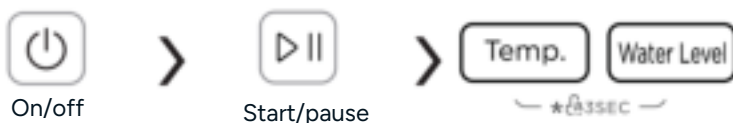

### How to Unlock:

Press and hold both the 'Temp' and 'Water Level' buttons again for 3 seconds

### Caution:

- If the lid is opened during operation, the buzzer will sound for 10 seconds and then alarm every 15 minutes
- If the lid remains open for more than 1 hour, the machine will shut down automatically.

# Soil Level

Use this option to select how heavily soiled the laundry is

- 1. Select a program
- 2. Press the 'Soil Level' button to choose from Extra Heavy, Heavy, Medium, or Light
- 3. Press 'Start/Pause' to begin the wash with the selected soil level

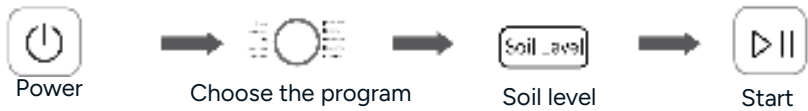

**Note:**

The Soil Level setting cannot be used with Rinse & Spin or Drain & Spin programs.

# Custom Program Settings

You can personalise your wash by selecting the desired program along with custom water level, temperature, and delay end settings to suit your washing needs.

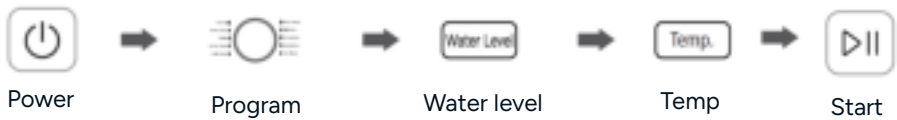

# Cleaning & Care

## Warning:

Before your maintenance starts, please unplug the machine and close the tap.

## Cleaning the Cabinet

Regular maintenance helps extend the service life of the washing machine. Clean the exterior surface with a diluted non-abrasive, neutral detergent when necessary. Wipe off any water spills immediately using a soft, damp cloth.

Do not use sharp objects or abrasive cleaners on the surface.

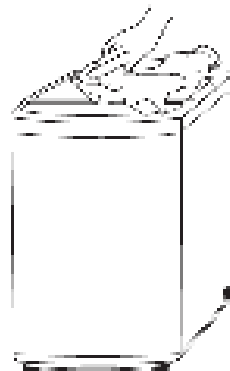

## Cleaning the Inlet Filter

1. Disconnect the inlet hose from the rear panel of the machine.
2. Use long-nose pliers to remove the inlet filter.
3. Wash the filter thoroughly using a soft brush.
4. Reinstall the cleaned filter and reconnect the inlet hose.

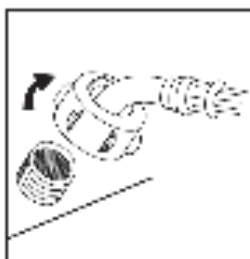

## Note:

If you notice reduced water flow into the washing machine, the inlet filter may be blocked and should be cleaned.

## Cleaning the Lint Filter

The washing machine is equipped with a built-in lint filter to collect lint during each wash cycle

1. Clean the lint filter every 10 wash cycles.
2. Remove the lint filter from the washer.
3. Rinse the filter with clean water to remove trapped lint.
4. Reinstall the lint filter securely in the machine.

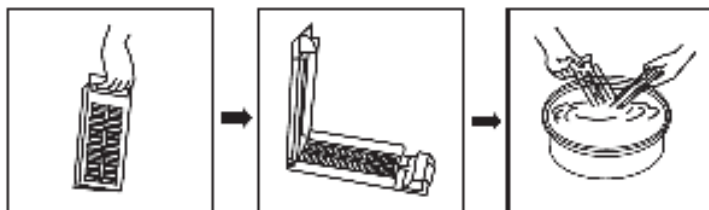

Filter 'A'



Filter 'B'



## Cleaning the Drain Pump Filter

### Warning:

- Be careful of hot water.
- Allow detergent solution to cool down.
- Unplug the appliance before cleaning to avoid electric shock.
- The drain pump filter collects lint, yarn, and small foreign objects from the wash. Clean the filter regularly to maintain normal operation.

1. Place a container under the pump area to collect any water
2. Open the pump cover by turning it counterclockwise
3. Remove any foreign objects from the filter
4. Clean the filter under running water

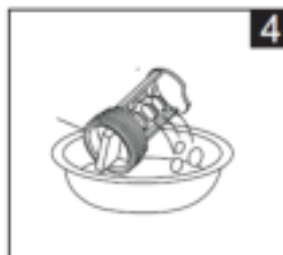
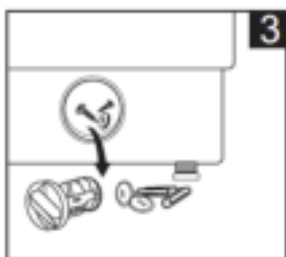
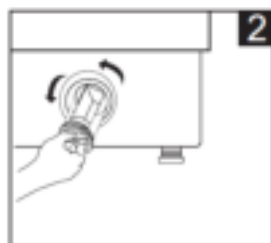
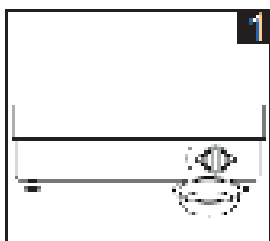

5. Reinstall the filter, aligning the tab with the pump opening
6. Tighten the pump cover by turning it clockwise.

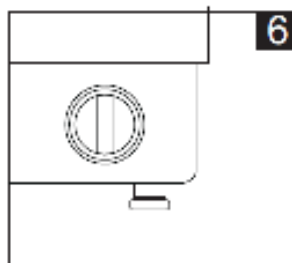
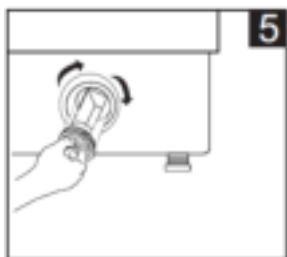

### Caution:

- Ensure the valve cap and emergency drain hose are reinstalled correctly. The cap plates must align with the holes, otherwise leakage may occur.
- Do not remove the pump cover during a wash cycle. Wait until the cycle has finished and the appliance is empty.
- Only applicable to models equipped with this function.

### Disposal



This marking indicates that this appliance should not be disposed with other household wastes. To prevent possible harm to the environment or human health from uncontrolled waste disposal, recycle it responsibly to promote the sustainable reuse of material resources.

# Specifications

Washing Capacity	12kg
Dimension (W x D x H)	601 x 611 x 1050mm
Net Weight	45kg
Rated Input Power	600W
Power Supply	120-127V~,60Hz
Standard Water Pressure	0.03MPa~0.8MPa

# Troubleshooting

## Error Codes

Description	Reason	Solution
E1	Alarm for abnormal water intaking.	Check the water tap is opened or not.
E2	Alarm for water drain has not finished.	Check the water level sensor and drain pump.
E3	Alarm for lid not closed before wash and spin.	Close the lid, Press "Start" button
E4	Alarm for washing stay at one side.	Manually balance clothes in the barrel by hands.
XX	Others	Please try again first, call up service line if there are still troubles.

### Note:

After completing the checks, restart the appliance. If the issue persists or another error code appears on the display, contact the **help.Kogan.com** for further assistance.

If the appliance does not start or stops during a cycle, first review the following checks. If the issue cannot be resolved, contact the **help.Kogan.com** for further support.

Issue	Inspection Items
No washing function	<ul style="list-style-type: none"> <li>• The power is turned on and the fuse has not blown.</li> <li>• The power supply voltage is stable and not too low.</li> <li>• The water level has reached the required amount to start operation.</li> <li>• The 'Delay End' function is not active. The appliance will only begin the cycle once the set delay time has.</li> </ul>
No water entering the machine.	<ul style="list-style-type: none"> <li>• The power is turned on and the fuse has not blown.</li> <li>• The water supply is active, and water pressure is sufficient.</li> <li>• The inlet hose is correctly connected, and the water tap is open.</li> <li>• The inlet valve filter screen is not clogged with debris.</li> <li>• The inlet valve coil is functioning properly (a faint electromagnetic sound when switching on is normal).</li> <li>• The 'Start/Pause' button was pressed after turning on the appliance.</li> </ul>
Water does not drain properly.	<ul style="list-style-type: none"> <li>• The drain hose is not positioned too high above ground.</li> <li>• The end of the drain hose is not submerged or sealed in water.</li> <li>• The internal rubber ring of the drain valve is not blocked by debris.</li> </ul>
Abnormal spin operation.	<ul style="list-style-type: none"> <li>• The lid is closed securely.</li> <li>• The laundry is evenly distributed inside the drum and not overloaded.</li> <li>• The appliance is placed on a stable, level surface.</li> <li>• The motor belt is not loose.</li> </ul>

[illegible]

[illegible]

[illegible]

### **Need more information?**

We hope that this user guide has given you the assistance needed for a simple set-up.

For the most up-to-date guide for your product, as well as any additional assistance you may require, head online to **help.Kogan.com**.

