

Recessor user guide.

Modified on: Thu, 7 Jan, 2021 at 6:44 PM

Aeotec Recessor.

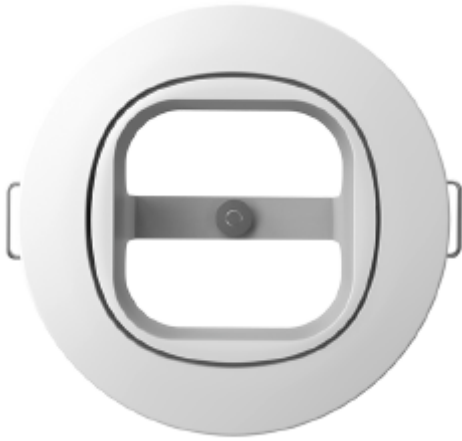

Aeotec Recessor has been crafted as a an add-on product to mount Aeotec Multisensor 6 or TriSensor to your ceiling or wall to allow these sensors to be small enough to be subtle.

Important safety information.

Please read this and other device guides carefully. Failure to follow the recommendations set forth by Aeotec Limited may be dangerous or cause a violation of the law. The manufacturer, importer, distributor, and / or reseller will not be held responsible for any loss or damage resulting from not following any instructions in this guide or in other materials.

Contains small parts; keep away from children.

Pre-Installation Requirements.

You'll need a few tools on hand in order to install Recessor:

- Power Drill
- 75mm / 3" hole saw bit.

Install Recessor.

In order to install your recessor and mount your Multisensor 6 or TriSensor, please follow these simple steps. This will require you to make a round shaped hole in your wall or ceiling.

1. Make a ~75mm / 3" circular hole for your recessor using a circular hole saw.

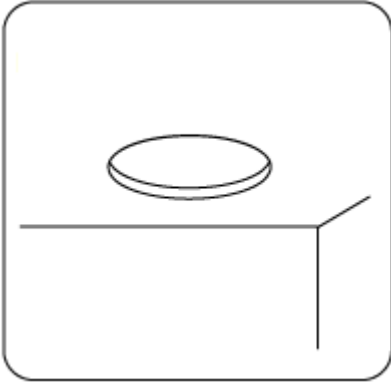

2. Lock Multisensor 6 or TriSensor into your Recessor and screw it in.

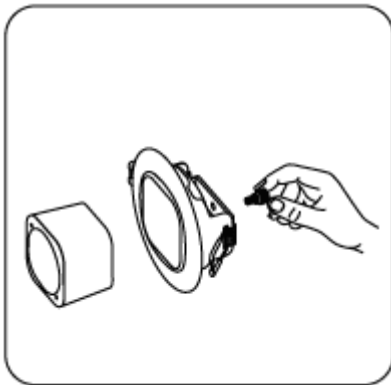

3. Bend in Recessor holder and fit Recessor into the ~75mm / 3" hole then release.

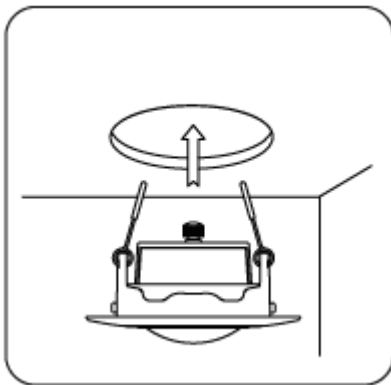

4. You are now done!

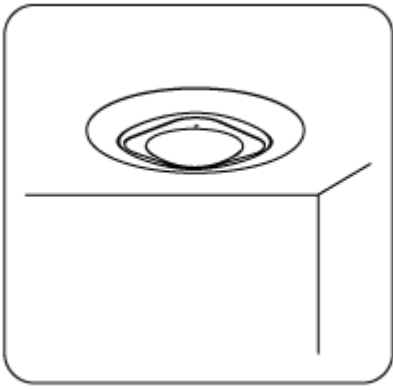

Technical Specifications.

Model Number: DSE010

Product Dimensions: 96 x 86 x 40 mm

Package Dimensions: 100 x 139 x 40 mm

Product Weight: 32 g

Total Package Weight: 78 g

UPC: 810667023355

EAN: 1220000013469