

Kobra S1- Firmware update guide

1. Bind the printer

After the printer is turned on, please bind the printer according to the following documents.

[Kobra S1-Printer Binding Guide | Anycubic Wiki](#)

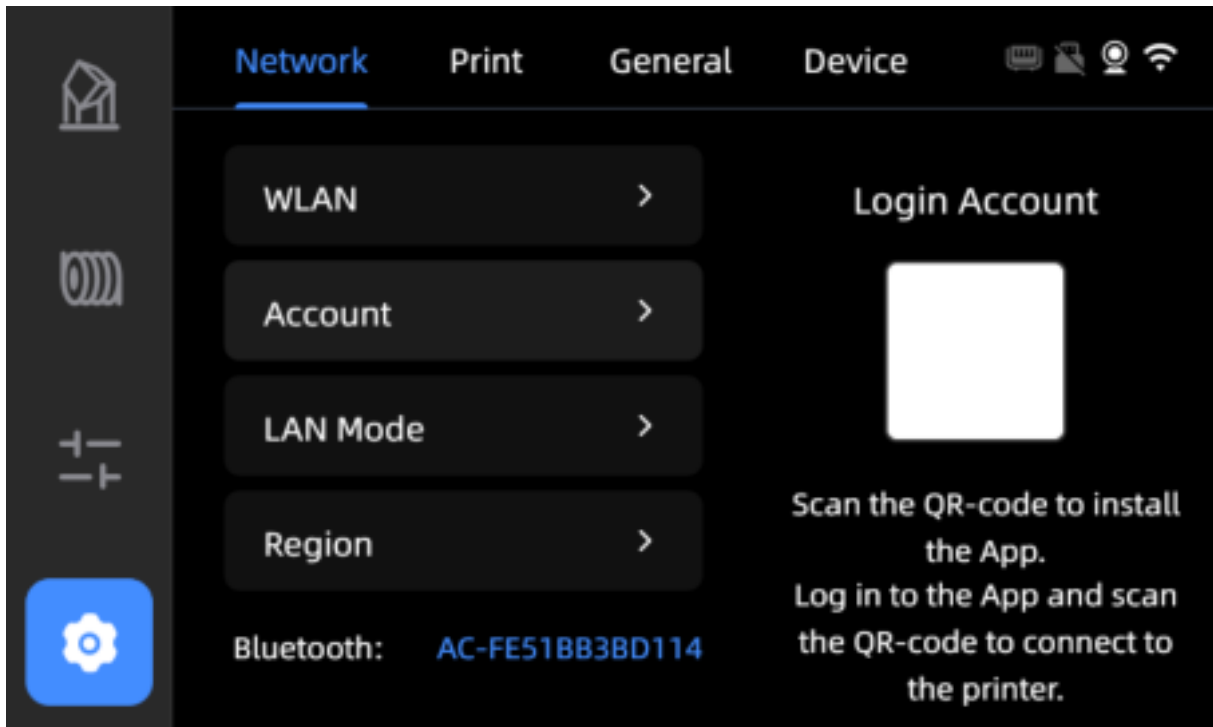

2. Update the firmware

Step 1: Update the printer firmware

(1) First click the "Settings" icon - "Device" - "Printer information" from the display screen to check whether the firmware version is the latest version. If the arrow below appears after the firmware version, then the printer's firmware is not the latest version, please click the arrow to upgrade.

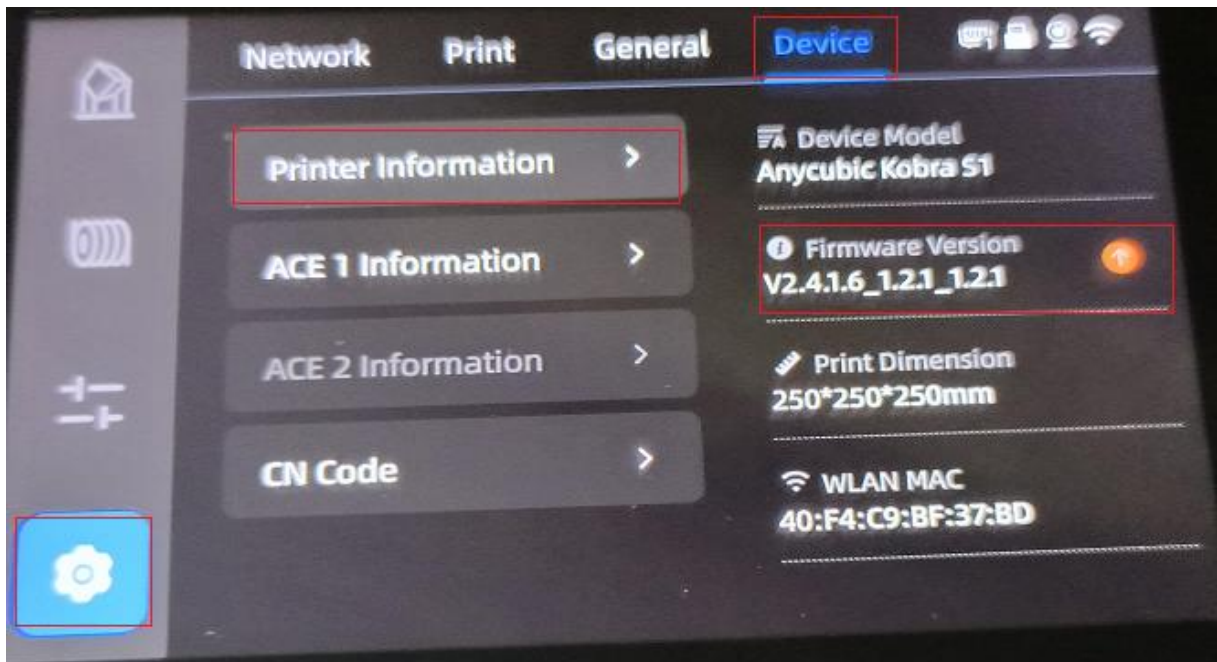

(2) The display screen will pop up to find new firmware version, please click "OK" to update the firmware.

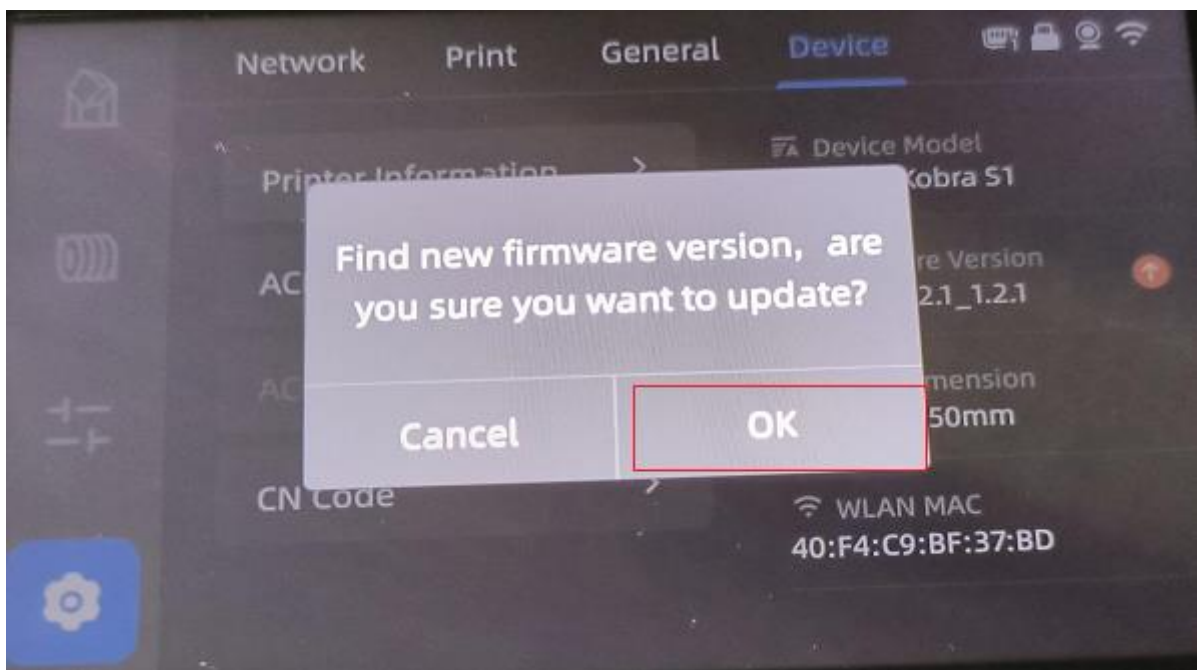

(3) After the firmware update is complete, please restart the printer to check whether the firmware is updated.

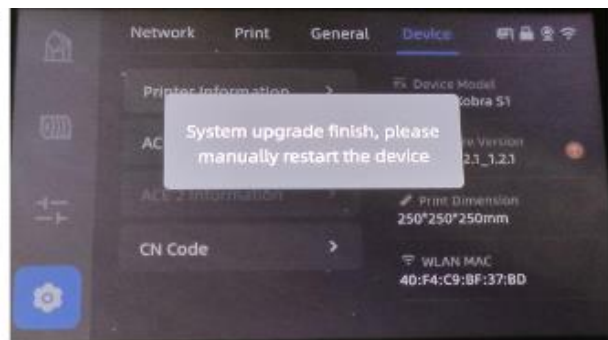
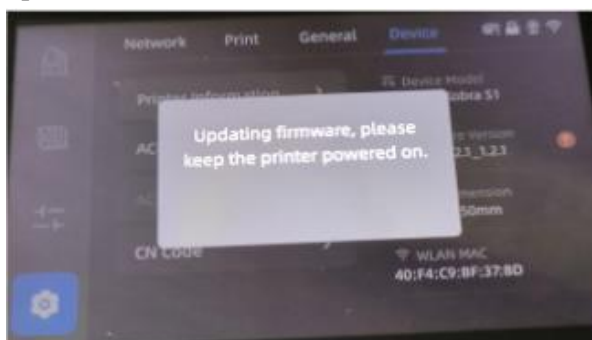

Step 2: Update the ACE Pro firmware

(1) Click the "Settings" icon - "Device" - "ACE 1 Information" from the display screen to check whether the firmware version is the latest version. If the arrow below appears after the firmware version, then the firmware is not the latest version, please click the arrow to upgrade the firmware.

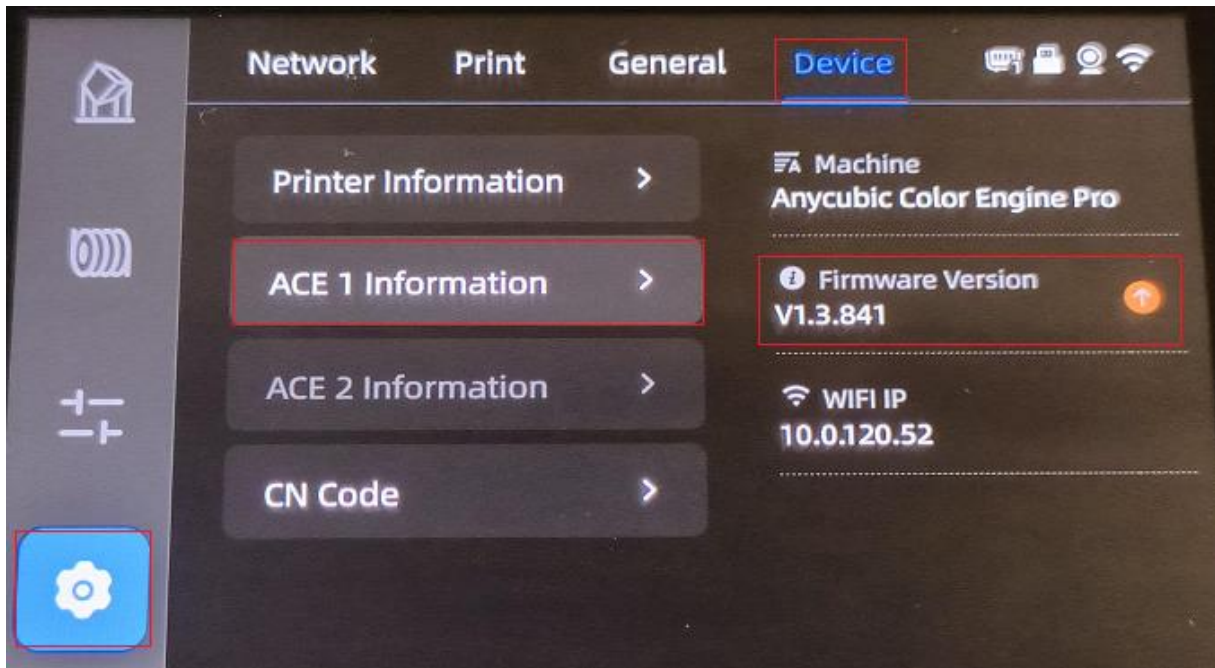

(2) The display screen will pop up to find new mcu ACE firmware version, please click "OK" to update the firmware.

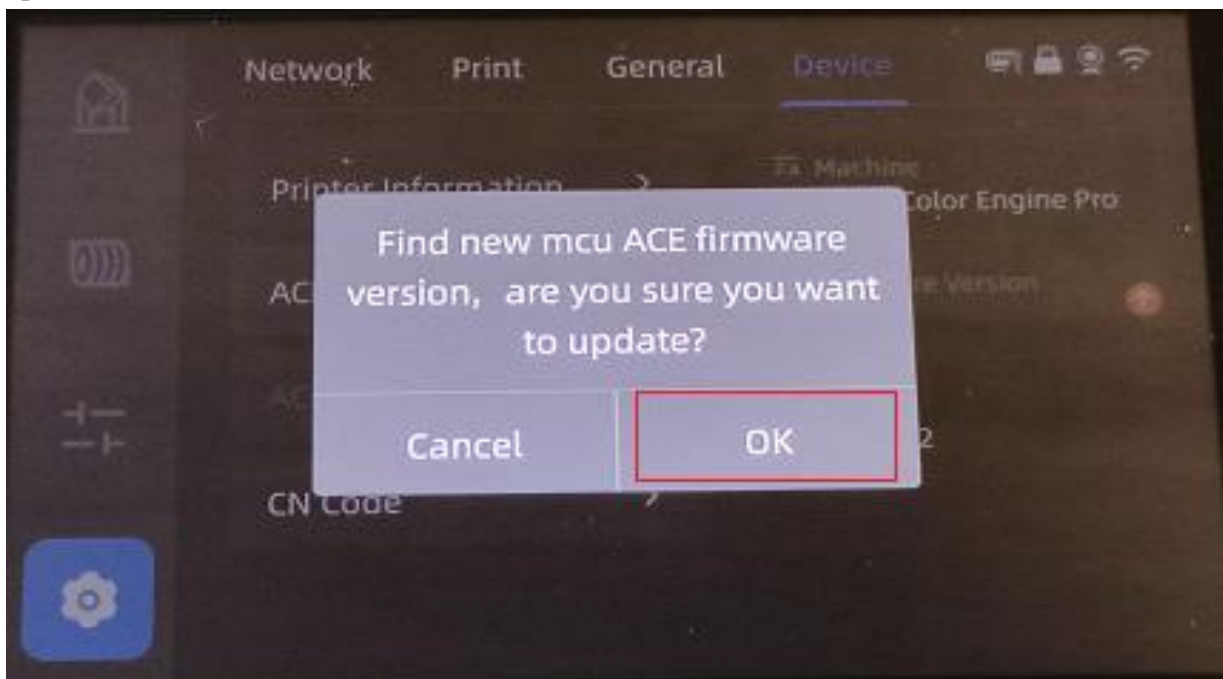

(3) Click "Confirm" to complete the firmware update of ACE Pro.

