

DREO | Tower Fan

Nomad TF414

USER MANUAL

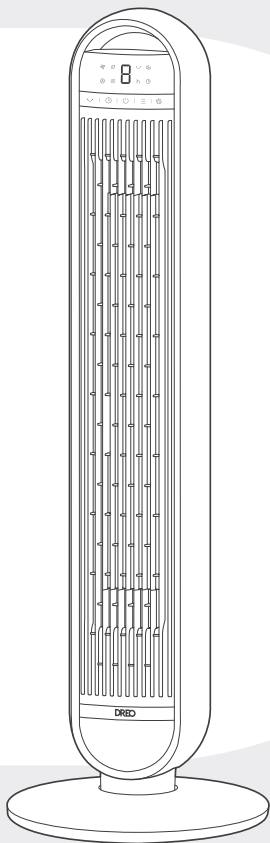

”

Thanks for Choosing **DREO!**

Your support means the world to us.
We hope you enjoy our product as much as
we did creating it.

CONTENTS

01

IMPORTANT SAFETY INSTRUCTIONS

1-2

02

ASSEMBLING YOUR TOWER FAN

3-5

03

KNOWING YOUR TOWER FAN

6-7

04

USING YOUR TOWER FAN

8-11

05

CLEANING AND MAINTENANCE

12-13

06

TROUBLESHOOTING

14

07

DREO CUSTOMER CARE

15-16

IMPORTANT SAFETY INSTRUCTIONS

01



READ ALL CAUTIONARY MARKINGS ON THE APPLIANCE AND SAFETY INSTRUCTIONS IN THE USER MANUAL BEFORE USE



Do not cover the air inlet and outlet while in operation.



Do not use the fan near flammables and combustibles.

General Safety

1. Children shall not play with the appliance. Cleaning and maintenance shall not be performed by children without supervision.
2. Use the appliance as described in the user manual only. Any other use not recommended in the user manual may cause fire, electrical shock, or personal injury.
3. This appliance can be used by children aged above 8 years and persons with reduced physical, sensory or mental capabilities or lack of experience and knowledge if they have been given supervision or instruction concerning use of this appliance in a safe way and understand the hazards involved.

Operation Safety

1. Place the appliance on a flat, dry surface before use.
2. Do not immerse in water and any other liquids.
3. Do not use the appliance until the base is installed.
4. Do not insert your fingers, pencil, and any other objects into the grilles while in operation.
5. Do not dismantle, repair, or modify. All servicing should be performed by qualified personnel.

Electricity Safety

1. Make sure that the voltage of your electricity supply is the same as that indicated on the appliance.
2. Always unplug before cleaning or leaving the appliance unused for a long period of time. Keep your hands dry when plugging/unplugging.

3. Do not operate any fan with a damaged cord or plug. Discard fan or return to an authorized service facility for examination and/or repair.
4. Do not run cord under carpeting. Do not cover cord with throw rugs, runners, or similar coverings. Do not route cord under furniture or appliances. Arrange cord away from traffic area and where it will not be tripped over.
5. **WARNING:** To reduce the risk of fire or electric shock, do not use this Fan with any solid-state speed control device.
6. **WARNING:** To reduce the risk of fire, electric shock or injury to persons, do not use replacement parts that have not been recommended by the manufacturer (e.g. parts made at home using a 3D printer).
7. **WARNING:** If the supply cord is damaged, it must be replaced by the manufacturer, its services agent or similarly qualified persons in order to avoid a hazard.

FOR HOUSEHOLD USE ONLY READ AND SAVE THESE INSTRUCTIONS

Gentle Reminder:



Check the appliance regularly and refer to TROUBLESHOOTING or contact our customer support if it shows any of the following signs:

- Power cord or plug is damaged.
- Loud noise, unusual smell or excessive heat.

Specifications

| | |
|--------------|---------------|
| Model No. | DR-HTF014 |
| Input | 220-240v 50Hz |
| Rated Power | 30W |
| Battery Type | AAA |



Correct Disposal of this product

This marking indicates that this product should not be disposed of with other household waste throughout the EU. To prevent possible harm to the environment or human health from uncontrolled waste disposal, recycle it responsibly to promote the sustainable reuse of material resources. To return your used device, please use the return and collection system or contact the retailer where the product was purchased. They can take this product for environmentally safe recycling.

ASSEMBLING YOUR TOWER FAN

02

Assembly Instructions

When using the appliance for the first time, remove the wraps and attach the parts by following the steps below.

1

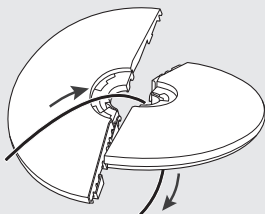

Run the cord through the center hole of the two base halves.

2

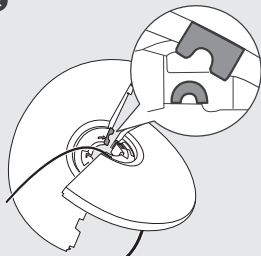

Intersect the two base halves diagonally. Match the arched cutout with the arched support on the base. Then, hook them together.

3

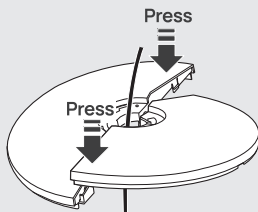

Press down on the edge until you hear a **click** to securely snap the two base halves together.

4

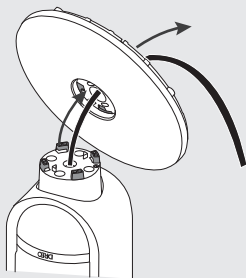

Thread the cord through the center hole and attach the base to the fan bottom.

5

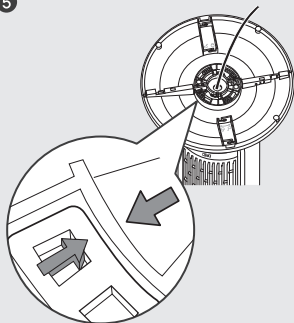

Make sure the arrows on both the base and fan bottom are aligned.

6

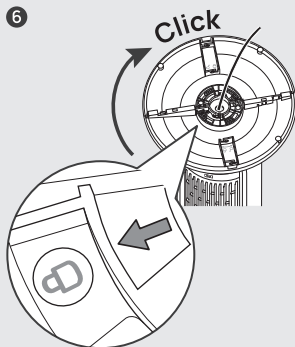

Turn the base clockwise until it **clicks** into place.

7

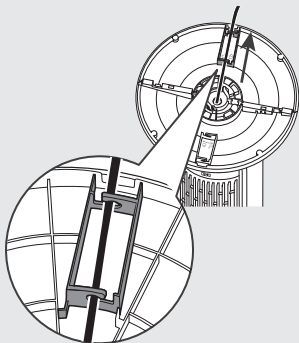

Thread the cord through all REAR cord keepers, then set the fan upright.

! CAUTION

- Do not operate the tower fan if the base has not been installed.
- Make sure to thread the cord through all rear cord keepers.

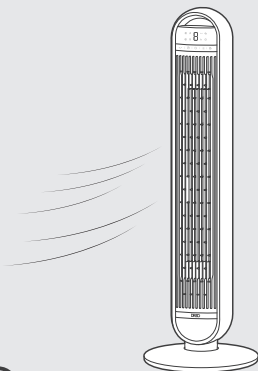

Package Contents

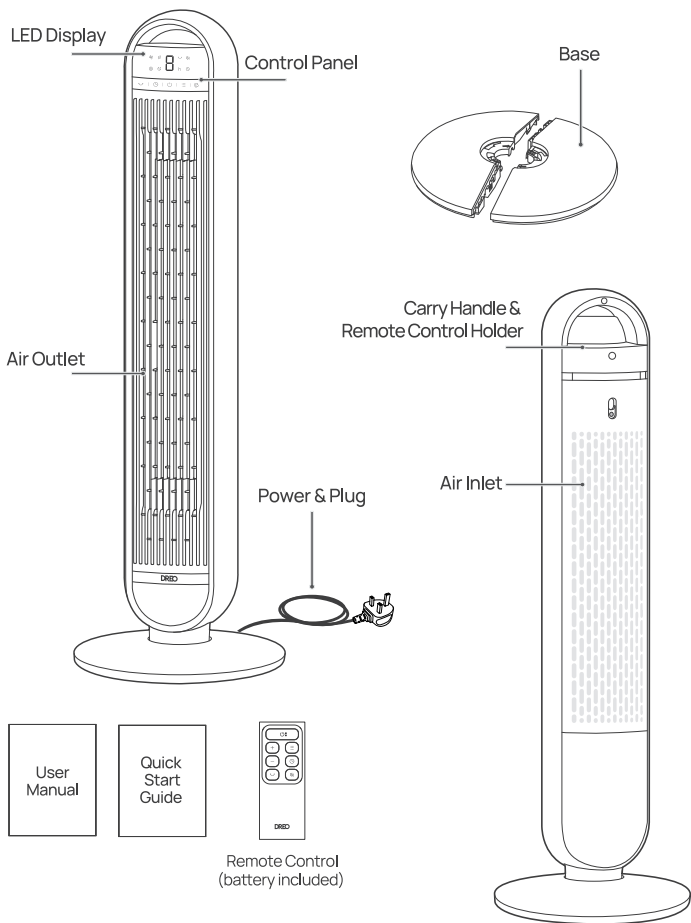

KNOWING YOUR TOWER FAN

03

Control Panel



Power Button

- Turn power on/off



Mode Button

- Switch between Normal/Natural/Sleep Mode
- Long press for 3 seconds to mute/unmute



Timer Button

Select to set a timer (0-8h)



Oscillation Button

- Adjust airflow direction



Fan Speed Button

- Adjust airflow volume (1-8 levels)

LED Display

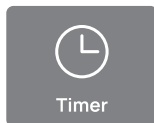
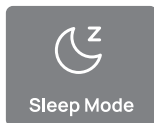
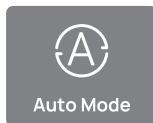
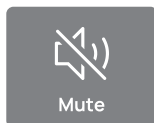
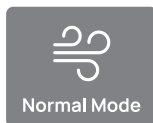
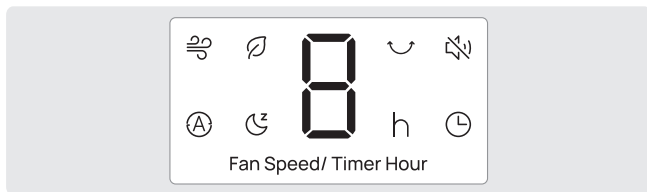

USING YOUR TOWER FAN

04

Working Modes



Normal Mode

Fan runs at the constant speed.



Natural Mode

Fan speed goes up and down intermittently to replicate the natural breeze.



Auto Mode

Fan automatically increases speed when room temp is higher and decreases speed when temp is lower.



Sleep Mode

(Mute On)

Balance comfort and noise by automatically decreasing fan speed as you fall sleep.



If the fan speed is 3 or higher, it will decrease two times, one speed every 30 minutes, then it will remain constant.

If the fan speed is 3 or below it will remain constant.

Additional Features



Mute

Long press the  or press  on the remote control to turn on/off the button sounds.



Timer

When the fan is ON/OFF, touch the timer button repeatedly to set a timer (1-8 h). When the timer ends, the fan will stop/start running automatically. To cancel, set the time to 0 hour.

Note: Display will return to fan speed after 3 seconds.



Memory

If the fan is turned OFF and connected to power, it will operate under the previous settings (except the timer setting) when it is turned ON again.



Display Auto Off

- Display turns off after 1 minute (after 5 seconds in sleep mode).
- Wake up the display with any button.

Getting the Most out of Your Tower Fan

1. Remove any tall obstacles that might block the airflow from the fan.
2. Combine with your AC unit to get cooler air throughout the room.
3. Position the tower fan closer to you to get more direct airflow.
4. Place a bucket of ice in front of the fan for an extra cooling boost.

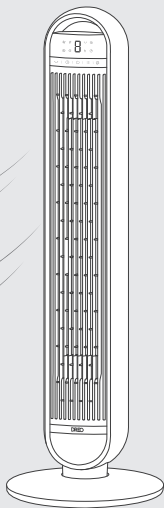

Remote Control

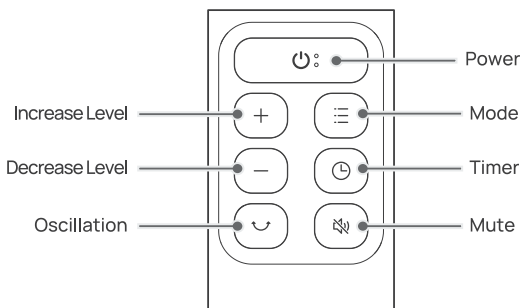

Battery Replacement

1. Remove the battery cover in the direction indicated by the arrow.
2. Replace with two new AAA 1.5V batteries. Make sure that the positive(+) and negative(-) terminals are positioned correctly.
3. Push the battery cover back into place.

WARNING

- Replace with new batteries of the same type when replacement is required.
- Remove the batteries when the remote control is unused for long period of time.
- Do not attempt to dismantle the batteries.
- Do not dispose the batteries in fire, batteries may explode or leak.
- Chemical burn hazard. Keep batteries away from children.
- Do not mix old and new batteries and Do not mix alkaline, standard (carbon-zinc) or rechargeable (ni-cad, ni-mh, etc.) batteries.

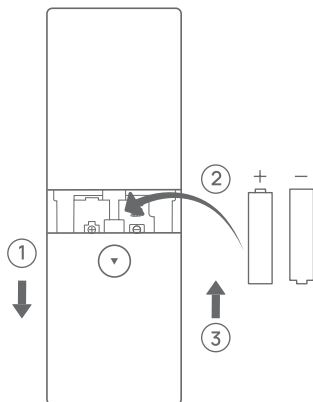

BATTERY WARNING

KEEP OUT OF REACH OF CHILDREN

Swallowing can lead to chemical burns, perforation of soft tissue, and death. Severe burns can occur within 2 hours of ingestion. Seek medical attention immediately.



No obvious symptoms from battery ingestion. Unfortunately, it is not obvious when a button or coin battery is stuck in a child's oesophagus (food pipe). There are no specific symptoms associated with this. The child might:

- cough, gag or drool a lot; appear to have a stomach upset or a virus;
- be sick;
- point to their throat or stomach;
- have a pain in their abdomen, chest or throat;
- be tired or lethargic; be quieter or more clingy than usual or otherwise "not themselves";
- lose their appetite or have a reduced appetite; and
- not want to eat solid food / be unable to eat solid food.

These sorts of symptoms vary or fluctuate, with the pain increasing and then subsiding. A specific symptom to button and coin battery ingestion is vomiting fresh (bright red) blood. If the child does this seek immediate medical help. The lack of clear symptoms is why it is important to be vigilant with "flat" or spare button or coin batteries in the home and the products that contain them.

CLEANING AND MAINTENANCE

05

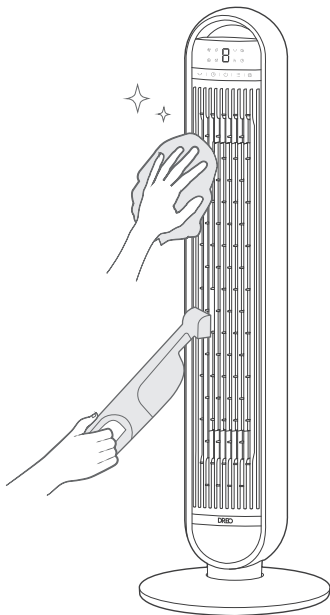

Outer Surface

Gently wipe off the dust with a soft, dry cloth.

Grilles & Blades

Remove the dust using a vacuum or air duster.

Base

The base can be disassembled in the reverse order of assembly.

CAUTION



1. Always unplug the fan before any cleaning or maintenance.
2. Do not immerse in water or get water inside the motor housing.
3. Do not use any chemical agents when cleaning the fan.
4. Store in a cool, dry place and cover it to protect from dust.

Rear Grille



WARNING

Turn off the appliance and unplug before any cleaning and maintenance.

1

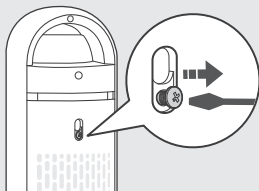

Remove the screw on the top of the rear grille with a Philips screwdriver.

2

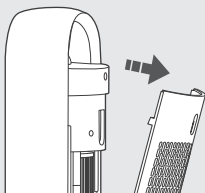

Lift up the grille and pull it out.

3

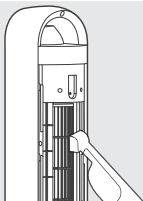

Clean the dust on blades using a vacuum cleaner or air duster. Rinse the rear grille under running water or with a clean, damp cloth.

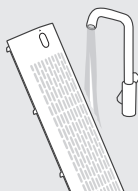

4

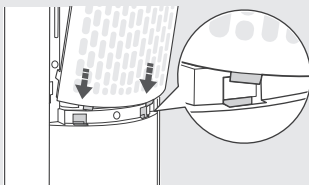

Dry up, then install the grille and the screw back in place, making sure the bottom pegs are fully inserted into the slots.

My fan won't turn on!

Make sure that the cord is connected to a powered outlet and the mains voltage corresponds with the voltage indicated on the fan.

My fan is shaky and wobbling!

1. Place the fan on a flat, level surface.
2. Incorrect installation might also cause shakiness. Please refer to the assembly instructions in **page 3-4**. Note that the power cord must be run through all rear keepers.

My fan is making vibration and noise!

1. Place the fan on a flat, level surface.
2. Be sure not to insert anything into the air inlet and outlet.

If your problem is not listed or still persists, please contact our Customer Support (see page 16).

DREO CUSTOMER CARE

07

Default 24-Month Warranty

This appliance is covered by DREO warranty for 24 months from the date of its original purchase.

Extend Your Warranty

Extend your warranty by registering your new appliance on our website <https://dreowarranty.com>.

The warranty will not apply in cases of:

1. Accident, misuse, or repairs performed by unauthorized personnel.
2. Any unit that has been tampered with or used for commercial purposes.
3. Normal wear and tear of wearable parts.
4. Use of force, damage caused by external influences.
5. Damage caused by non-observance of the User Manual, e.g. connection to an unsuitable mains supply or noncompliance with the instructions.
6. Partially or completely dismantled appliances.
7. Defects caused by or resulting from damages from shipping or from repairs, service, or alteration to the product or any of its parts that have been performed by a repair person not authorized by DREO.

We can only provide after-sales service for products that are sold by DREO or DREO authorized retailers and distributors. If you have purchased the appliance from a different place, please contact your seller for return and warranty issues.

| Specification details | Symbol | Value | Unit |
|--|-----------------|-------|-------------------------|
| Maximum Fan Flow Rate | F | 32.7 | m ³ /min |
| Fan Power Input | P | 24.4 | W |
| Service Value | SV | 1.3 | (m ³ /min)/W |
| Standby power consumption | P _{SB} | 0.5 | W |
| Fan Sound Power Level | L _{WA} | 60 | dB(A) |
| Maximum Air Velocity | c | 4.4 | meters/sec |
| Seasonal electricity consumption | Q | 9 | kWh/a |
| Measurement Standard for Service Value | IEC 60879: 2019 | | |

Model No.: DR-HTF014
Rev_1.0_UK

We're Here to Help!



uk-support@dreoo.com



www.dreoo.com



Dreo Limited



61 Bridge Street, Kington, HR5 3DJ, United Kingdom
uerp@hesung.com



MADE IN CHINA



www.dreo.com

Looking for help?

Contact us to get expert support.



uk-support@dreo.com



www.dreo.com