

LIMITED 1 (ONE) YEAR WARRANTY

If your Wahl product fails to operate satisfactorily within one (1) year from the date of original purchase or receipt as a gift, Wahl will at our option repair or replace it and return it to you FREE OF CHARGE. Our warranty does not cover blades which are wear out parts. Please mail your product prepaid to Wahl Clipper Corporation, 3100 N. Locust Street, Sterling, Illinois 61081, Attention: Repair Department, with a note describing the defect and the date of original purchase or receipt as a gift (if in warranty). Products out of warranty will be repaired at our standard repair charges.

This warranty is void and no repair or replacement will be made under this warranty or otherwise if:

1. The product is modified in any manner.
2. The product is repaired by anyone other than Wahl Clipper Corporation
3. The product has been subject to unreasonable use.

This warranty gives you specific legal rights and you may also have other rights which may vary from state to state. No other written express warranty is given. Any implied warranty including any warranty of merchantability, which may arise from purchase or use is limited to the one-year period provided in this express warranty. Some states may not allow such limitation, so it may not apply to you. No responsibility is assumed for incidental or consequential damages of any type, or for the use of unauthorized attachments. Some states may not allow the exclusion or limitation of incidental or consequential damages, so the limitation or exclusion may not apply to you. Warranty valid only in the United States.

D 499,211
105 372

GARANTIA LIMITADA POR UN (1) AÑO

Si su producto no llegará a opera satisfactoriamente en el período de un (1) año, desde la fecha de la compra original o de haberlo recibido como regalo, Wahl lo reparará o reemplazará a su criterio y se lo enviará GRATUITAMENTE. Nuestra garantía no cubre las hojas, las cuales son partes desmontables. Por favor envíe su producto con franqueo pagado a Wahl Clipper Corporation, 3100 N. Locust Street, Sterling, Illinois 61081, Atención: Departamento de reparaciones, con una nota describiendo el defecto y con el recibo de compra original o el recibo como regalo (si aún está bajo garantía). Los productos fuera de garantía serán reparados a nuestros precios originales de reparación.

Esta garantía no es válida y no se hará ninguna reparación o reemplazo si el producto:

1. Ha sido modificado en cualquier manera.
2. Ha sido reparado por otro que no sea Wahl Clipper Corporation.
3. Ha sido sometido a una utilización inadecuada.

Esta garantía le brinda derechos legales específicos y usted puede adquirir otros derechos, los cuales varían de un estado a otro. No se brinda ninguna otra garantía expresa. Cualquier garantía implícita incluyendo cualquier garantía mercantil la al podría surgir por la compra o la utilización, está limitada al período de un año proporcionado en esta garantía expresa. Algunos estados no permitirán tal limitación; por lo tanto tal vez no se aplique a usted. No se asumirá ninguna responsabilidad por daños accidentales o consiguientes de cualquier tipo o por la utilización de dispositivos no autorizados. Algunos estados no permitirán tal exclusión o limitación; por lo tanto tal vez no se aplique a usted. Garantía válida solamente en Estados Unidos de Norteamérica.

D 499,211
105 372

GARANTIE LIMITÉE D'UN AN

Si le produit Wahl cesse de fonctionner de façon satisfaisante en deçà d'un an, à compter de la date d'achat initiale ou de réception en cadeau, Wahl s'engage, à son gré, à le réparer ou à le remplacer, et à le retourner SANS FRAIS à l'expéditeur. La garantie ne couvre pas les lames, les brosses ou d'autres pièces d'usure. Le produit défectueux doit être envoyé, port payé, à Wahl Clipper Corporation, 3100 N. Locust Street, Sterling, Illinois 61081, Attention: Repair Department, accompagné d'une note décrivant le défaut et indiquant la date d'achat initiale ou de réception en cadeau (s'il est couvert par la garantie). Le produit non couvert par la garantie est réparé moyennant des frais de réparation standard.

La présente garantie est nulle et non avenue, et aucune réparation ni aucun remplacement ne sont effectués, au titre de la présente garantie, ou autrement si :

- 1) le produit a été modifié de quelque manière que ce soit;
- 2) le produit a été réparé par toute entité autre que Wahl Clipper Corporation;
- 3) le produit a été soumis à un usage abusif.

La garantie confère à l'acheteur des droits juridiques précis, qui peut également se prévaloir d'autres droits propres à son État de résidence. Aucune autre garantie expresse écrite n'est donnée. Toute garantie implicite, y compris toute garantie de qualité marchande, découlant de l'achat ou de l'utilisation se limite à une période d'un an, qui est prévue dans la présente garantie expresse. Certains États peuvent ne pas reconnaître la présente garantie limitée, qui alors peut ne pas s'appliquer à l'acheteur. La société décline toute responsabilité à l'égard de dommages accessoires ou consécutifs, quels qu'ils soient, ou de l'utilisation d'accessoires non approuvés. Certains États peuvent ne pas permettre l'exclusion ou la limitation à l'égard de dommages accessoires ou consécutifs, et la limitation ou l'exclusion peut alors ne pas s'appliquer à l'acheteur. Garantie valide aux États-Unis seulement.

D 499,211
105 372

OPERATING INSTRUCTIONS RECHARGEABLE CLIPPER

STERLING BIG MAG LITHIUM ION Model No. 8843

MANUAL DE OPERACION DE LA MAQUINILLA

MANUEL D'UTILISATION DE LA TONDEUSE



WAHL®

WAHL CLIPPER CORPORATION

2900 Locust St. • Sterling, IL 61081 • (815) 625-6525 • Fax: (815) 625-0091

Form No.94693

www.wahlpro.com

Printed in U.S.A.

IMPORTANT SAFEGUARDS

When using your clipper, basic precautions should always be followed:

READ ALL INSTRUCTIONS BEFORE USING

DANGER

To reduce the risk of death or injury by electric shock:

1. Do not place or store appliance where it can fall or be pulled into a tub or sink. Do not place in or drop into water or other liquid.
2. Except when charging, always unplug this appliance from the electrical outlet when not in use.
3. Unplug the cord before cleaning recharge stand.
4. Do not reach for an appliance that has fallen into water. Unplug immediately.
5. Do not use while bathing or in a shower.

WARNING

To reduce the risk of burns, fire, electric shock or injury to persons:

1. Do Not Crush, Disassemble, Heat above 100°C (212°F), or Incinerate the appliance, due to Risk of Fire, Explosion, or Burns.
2. This appliance is not suitable for use by people (including children) with physical, sensory or mental disabilities or who do not have the relevant experience or knowledge of using such appliance unless under the supervision of or after having received instruction in the use of the appliance by an individual who is responsible for their safety. Children should be supervised to ensure they do not play with the appliance.
3. Use this appliance only for its intended use as described in this

manual. Do not use attachments not recommended by the manufacturer.

4. Do not use this appliance with a damaged or broken blades or broken attachments, as facial injury may occur.
5. Never operate this appliance if it has a damaged cord or battery charger transformer, if it is not working properly, if it has been dropped or damaged, dropped into water. Return the appliance to Wahl Clipper Corporation for examination and repair.
6. Always attach plug to appliance first, then to outlet. To disconnect, turn all controls to off position (e.g. "0") then remove plug from outlet.
7. During use, do not place or leave the appliance where it is expected to be subject to damage by an animal, or exposed to weather.
8. Do not carry this appliance by supply cord or use cord as a handle.
9. Keep the cord away from heated surfaces.
10. Never drop or insert any object into any opening.
11. Do not use outdoors.
12. Do not operate where aerosol (spray) products are being used or where oxygen is being administered. Do not use clipper germicide cleaners containing phynyl phenol.
13. Use only the charger supplied by the manufacturer to recharge.

SAVE THESE INSTRUCTIONS

This unit is designed for commercial use

PROPER USE AND MAINTENANCE INFORMATION

1. Be sure the clipper is switched to "Off" (downward position) before placing it in the recharge stand.
2. Make sure cord is not twisted or kinked while unit is charging or being stored.

3. This unit is designed for commercial use.
4. It is normal for the unit to become somewhat warm during normal use.
5. Put a small drop of Wahl Clipper Oil between the blades after each use. Oil should be applied while the clipper is running. After cutting wet hair, clean the blades and apply a small drop of Wahl Clipper Oil before placing the unit back in the charging stand. Use Wahl Clipper Oil ONLY.
6. To clean the unit, use either a clean, dry or dampened cloth. DO NOT USE benzine or thinner to clean unit.
7. Do not store the clipper in a wet or moist environment.
8. To prolong blade life, do not use clipper on hair that is coated with a permanent wave solution or hair spray.
9. Do not touch any of the internal mechanisms. If the unit should need repair, do not attempt to repair it yourself. Return it to Wahl Clipper Corporation.

TROUBLESHOOTING

If your rechargeable clipper does not seem to be operating or charging properly, please check the following:

Check the outlet's current by plugging another appliance (one you know is in proper working condition) into the outlet.

Make sure the unit is not connected to a power source that turns itself off when lights are turned off.

Make sure the clipper and recharging stand contacts are clean and free of hair or other contaminants.

Verify the clipper is properly seated in the charger with the switch on the clipper turned to the "OFF-O)" position.

Verify that the blade assembly moves freely and is mounted properly.

If you still encounter problems with your unit, ship both your clipper and its recharging stand, prepaid, to our factory with a note explaining the problem:

Attn: Repair Department
Wahl Annex
3001 North Locust
P.O. Box 578
Sterling, IL 61081

REMOVING AND CLEANING BLADES

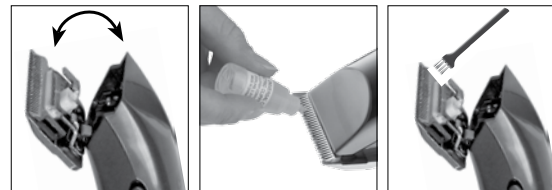

To remove the blades, hold the clipper firmly in one hand. Using the thumb of your hand, simply push the blades away from the front of the clipper. The blades and the mounting plate behind them will all come off in one piece.

To clean hair that may have become clogged between the blades, brush between the blades with the cleaning brush provided. Always be sure to oil between the blades before each use.

ADJUSTING BLADE



To adjust blade, use 5-level cutting adjustment lever to adjust length of blade from 0,7mm to 3mm.

CORD CARE

The cord should never be used to pull the clipper. Freedom of movement needs to be maintained. Care should be used to keep the cord untwisted, and undamaged.

When stored, the cord should be coiled and placed neatly in a dry place.

CHARGING THE BATTERY

Before the equipment is used for the first time, it should be charged 3-5 hours. Connect power cord plug into receptacle in back of stand and place clipper in stand so nameplate faces forward. (Not all units have recharge stands. To recharge these units, plug power cord directly into unit.) Be sure clipper is switched OFF when charging. During charging, the charge indicator is illuminated. The charge indicator will begin to blink when almost fully charged and may shut off when fully charged. Recommendation: the batteries should only be recharged when the performance of the equipment has deteriorated noticeably. Note: If the unit is fully charged and is placed in the stand to charge, the LED may not turn on. This does not indicate the unit can no longer charge. It means the unit does not need to draw electricity because it is already fully charged.

BATTERY OPERATION

Switch on the equipment using the on/off switch and, after use, switch it off again. When the battery is fully charged, the equipment can be used for up to 90 minutes.

LITHIUM-ION BATTERY REPLACEMENT, CLIPPER DISPOSAL AND RECYCLING:

For battery replacement send the entire, intact clipper unit to: Wahl Annex 3001 North Locust, P.O. Box 578, Sterling, IL 61081 Do not attempt to remove the battery. Lithium-ion batteries can explode, catch fire, and/or cause burns if disassembled, damaged, or exposed to water or high temperatures.

If you choose not to send the appliance in for battery replacement, the entire, intact clipper unit must be disposed. Do not attempt to remove the battery for disposal. Lithium-Ion batteries may be subject to local disposal regulations. Many locations prohibit disposal in standard waste receptacles. Check your local laws and regulations. For recycling contact a government recycling agency, waste disposal service, retailer, or visit online recycling sources.

