

**PHILIPS**

Steam Generator  
3000 Series  
2000 Series



English 6  
Azərbaycanca 22  
Bahasa Indonesia 38  
Bahasa Melayu 54  
Čeština 71  
Dansk 88  
Deutsch 104  
Eesti 121  
Español 137  
Français 153  
Hrvatski 170  
Italiano 187  
Latviešu 204  
Lietuviškai 221  
Magyar 238  
Nederlands 255  
Norsk 271  
O'zbek 288  
Polski 305  
Português 322  
Română 339  
Shqip 356  
Slovenščina 372  
Slovensky 388  
Srpski 405  
Suomi 422  
Svenska 438  
Tiếng Việt 454  
Türkçe 470  
Türkmençe 487  
Ελληνικά 504  
Български 521  
Кыргызча 538  
Македонски 555  
Русский 572  
Тоҷикӣ 589

Українська 606  
Қазақша 623  
Հայերեն 640  
ភាសាខ្មែរ 657  
ქართული ენა 675  
简体中文 692  
繁體中文 709  
한국어 725  
العربية 741  
فارسی 757  
עברית 773

# Introduction

Congratulations on your purchase and welcome to Philips! To fully benefit from the support that Philips offers, register your product at [www.philips.com/welcome](http://www.philips.com/welcome). Read this user manual, the important information leaflet, and the quick start guide carefully before you use the appliance. Save them for future reference.

## PSG3000 series



## PSG2000 series



- 1 CALC-CLEAN button with light
- 2 Power button
- 3 'Iron' ready light
- 4 Water tank release lever (PSG3000 series)/Water tank filling door (PSG2000 series)
- 5 Detachable water tank (PSG3000 series)/Non-detachable water tank (PSG2000 series)
- 6 Water supply hose storage compartment
- 7 Smart Clan-Clean container
- 8 Mains cord with plug
- 9 Water supply hose
- 10 Steam trigger/Steam boost
- 11 Temperature dial
- 12 Heel
- 13 Carry lock release button (PSG3010)

## Preparing for use

### Type of water to use

The appliance is suitable to be used with tap water. However, if you live in an area with hard water, we recommend that you mix an equal amount of tap

water with distilled or demineralized water. This will prevent fast scale build up and prolong the lifetime of the appliance.

**Do not add perfume, water from the tumble dryer, vinegar, starch, descaling agents, ironing aids, chemically descaled water or other chemicals, as they may cause water spitting, brown staining or damage to your appliance**

## Filling the water tank

Fill the water tank before every use. You can refill the water tank at any time during use.

### PSG3000 series

- 1 Press the lever in the water tank handle and remove the water tank from the base.

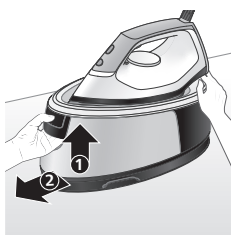

- 2 Fill the water tank up to the MAX indication.

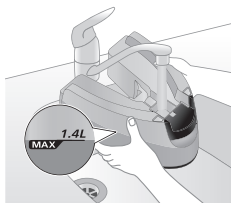

- 3 Push the water tank back into the appliance until it locks in place ('click').



**PSG2000 series**

- 1 Open the water tank filling door.



- 2 Fill the water tank up to the MAX indication then close the water tank filling door ('click').

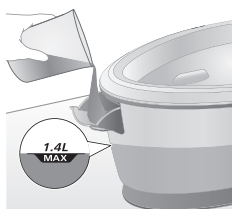

## Using your appliance

### Temperature setting

Temperature setting	Automatic steam setting	Fabric type
●		Synthetics (e.g. acetate, acrylic, nylon, viscose, polyamide, polyester)
● ●		Silk
● ● ● to MAX		Cotton, linen
ECO	ECO	All except for synthetic fabrics

### Ironing

- 1 Put the mains plug in an earthed wall socket.

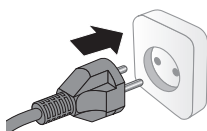

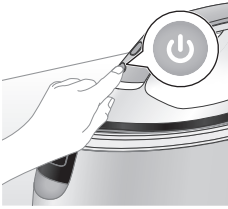

- 2 Press the power button to switch on the appliance then turn the temperature dial to set the appropriate temperature according to the table above.

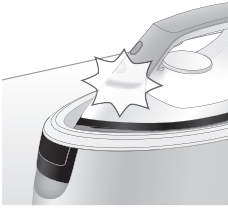

- 3 'Iron ready' light starts to flash to indicate that the appliance is heating up.

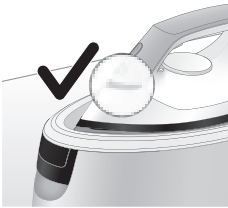

- 4 Wait until the 'iron ready' light lights up continuously.

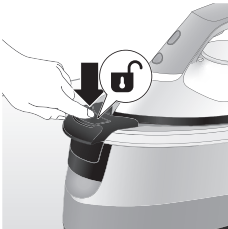

- 5 For PSG3010, press the carry lock release button to unlock the iron from the iron platform.



- 6 Remove the water supply hose from the storage compartment.

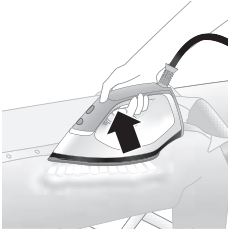

**7** Press and hold the steam trigger to start ironing.

Note: There might be water spitting from the iron at the start of each session. Press steam trigger for 10 seconds before ironing to prevent water stains on garment.

Note: When you start your ironing session and especially during the first usage of steam trigger, it may take more than 30 seconds for steam to come out of the appliance.

Note: The pump is activated each time you press the steam trigger. It produces subtle rattling sound. When there is no water in the water tank, the pump sound is louder.

**Warning: Never direct steam at people.**

## Vertical ironing

You can use the steam iron in vertical position to remove wrinkles from hanging fabrics.

**1** Hold the iron in vertical position, press the steam trigger and touch the garment lightly with the soleplate and move the iron up and down.

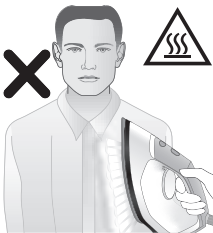
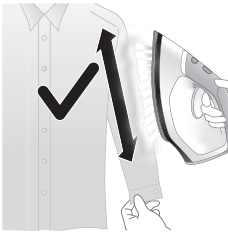

**Warning: Hot steam is emitted from the iron. Never attempt to remove wrinkles from a garment while someone is wearing it. Do not apply steam near your or someone else's hand.**





## Steam boost

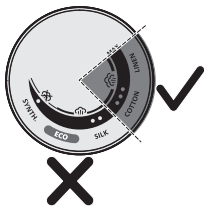

- 1 Steam boost function is only available from 3 dots to MAX temperature.

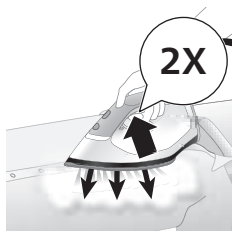

- 2 Press steam trigger twice quickly to release a powerful boost of steam for 3 seconds.

## Auto shut-off

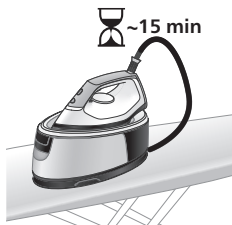

- 1 When the appliance is not in use for more than 15 minutes, the 'iron ready' light starts to flash and it starts to cool down.

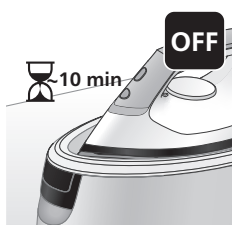
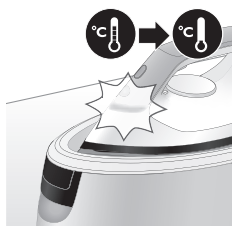

- 2 Upon leaving the appliance untouched for the next 10 minutes, it will switch off automatically.

**Warning: Never leave the appliance unattended when it is connected to the mains. Always unplug the appliance after use.**

# Cleaning and maintenance

## Smart Calc-Clean System

Your appliance has been designed with a Smart Calc-Clean system to ensure that descaling and cleaning is done regularly. This helps to maintain a strong steam performance and prevents dirt and stains coming out of the soleplate over time. To ensure that the cleaning process is performed, the appliance gives regular reminders.

## Performing the Calc-Clean process with the Calc-Clean container

**Warning:** Do not leave the appliance unattended during the Calc-Clean process.

**Caution:** Always perform the Calc-Clean process with the Calc-Clean container. Do not interrupt the process by lifting the iron up from the Calc-Clean container, as hot water and steam will come out of the soleplate.

**Note:** Make sure that the appliance is plugged in and switched ON during the Calc-Clean process.

### PSG3000 series

- 1 After 1 to 3 months of use, the Calc-Clean light starts flashing and the appliance starts beeping to indicate that you have to perform the Calc-Clean process.

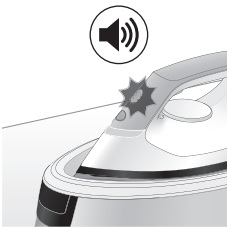

- 2 Besides that, a second defense step to protect the appliance from scale is integrated: the steam function gets disabled if descaling is not done. After descaling is done, the steam function will be restored. This takes place regardless of the type of water used.

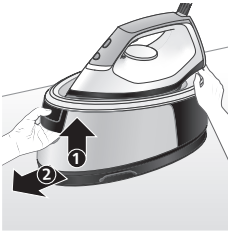

- 3** Press the lever in the water tank handle and remove the water tank from the base.

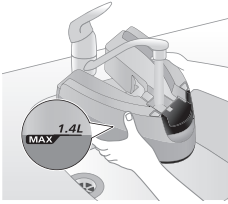

- 4** Fill up the water tank halfway.

Note: Make sure that the appliance is plugged in and switched ON during the Calc-Clean process.



- 5** Push the water tank back into the appliance until it locks in place ('click').

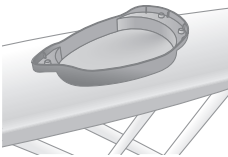

- 6** Place the Calc-Clean container on the ironing board or any other even, stable surface.

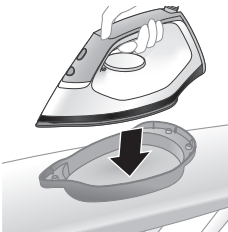

- 7** Place the iron stably on the Calc-Clean container.

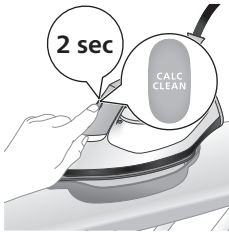

- 8** Press and hold the CALC-CLEAN button for 2 seconds until you hear short beeps.

Note: The Calc-Clean container has been designed to collect scale particles and hot water during the Calc-Clean process. It is perfectly safe to rest the iron on this container during the entire process.

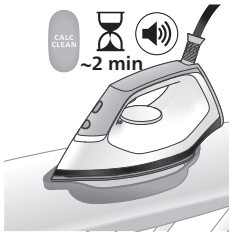

- 9** During the Calc-Clean process, you hear short beeps and a pumping sound. Wait approximately 2 minutes for the appliance to complete the process.



- 10** When the Calc-Clean process is completed, the iron stops beeping and the CALC-CLEAN light stops flashing.

Caution: The iron is hot.

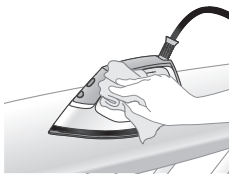

- 11** Wipe the iron with a piece of cloth and put it back on the base station.

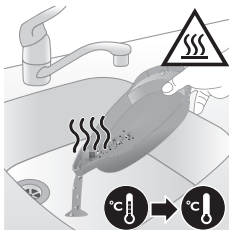

- 12** As the Calc-Clean container becomes hot during the Calc-Clean process, wait about 5 minutes before you touch it. Then carry the Calc-Clean container to the sink, empty it and store it for future use.

Note: During the Calc-Clean process, clean water may come out of the soleplate if no scale has accumulated inside the iron. This is normal.

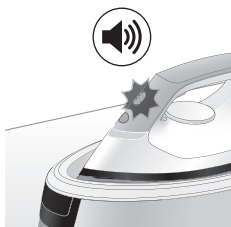

### PSG2000 series

- 1 After 1 to 3 months of use, the Calc-Clean light starts flashing and the appliance starts beeping to indicate that you have to perform the Calc-Clean process.



- 2 Besides that, a second defense step to protect the appliance from scale is integrated: the steam function gets disabled if descaling is not done. After descaling is done, the steam function will be restored. This takes place regardless of the type of water used.



- 3 Open the water tank filling door.

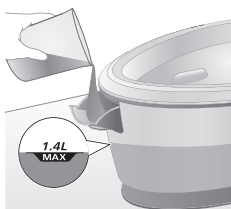

- 4 Fill up the water tank halfway.

Note: Make sure that the appliance is plugged in and switched ON during the Calc-Clean process.

- 5 Place the Calc-Clean container on the ironing board or any other even, stable surface.

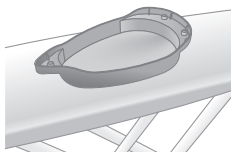

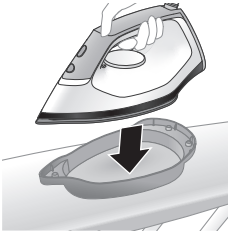

- 6** Place the iron stably on the Calc-Clean container.

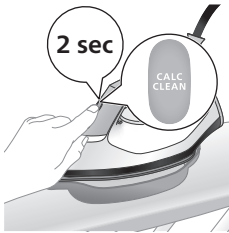

- 7** Press and hold the CALC-CLEAN button for 2 seconds until you hear short beeps.

**Note:** The Calc-Clean container has been designed to collect scale particles and hot water during the Calc-Clean process. It is perfectly safe to rest the iron on this container during the entire process.

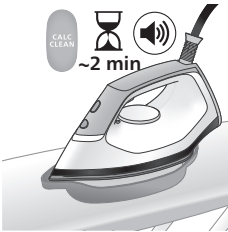

- 8** During the Calc-Clean process, you hear short beeps and a pumping sound. Wait approximately 2 minutes for the appliance to complete the process.



- 9** When the Calc-Clean process is completed, the iron stops beeping and the CALC-CLEAN light stops flashing.

**Caution:** The iron is hot.

- 10** Wipe the iron with a piece of cloth and put it back on the base station.

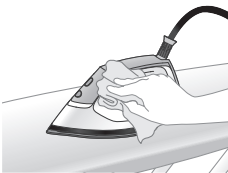

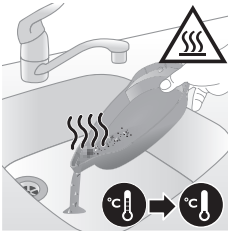

- 11** As the Calc-Clean container becomes hot during the Calc-Clean process, wait about 5 minutes before you touch it. Then carry the Calc-Clean container to the sink, empty it and store it for future use.

Note: During the Calc-Clean process, clean water may come out of the soleplate if no scale has accumulated inside the iron. This is normal.

## Cleaning the soleplate

To properly maintain your appliance, clean it regularly.

- 1** Clean the appliance with a moist cloth. To easily and effectively remove stains, let the soleplate heat up and move the iron over a moist cloth.

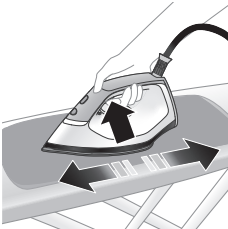

Note: Do not use soap or scrub the soleplate during cleaning.

## Storage

### PSG3000 series

- 1** Switch off the appliance and unplug it.

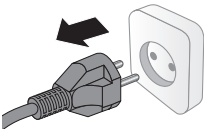

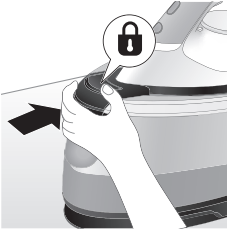

- 2** For PSG3010, place the iron on the iron platform and lock it by pushing the carry lock release button

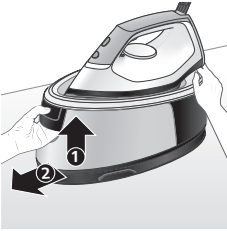

- 3** Press the lever in the water tank handle and remove the water tank from the base.

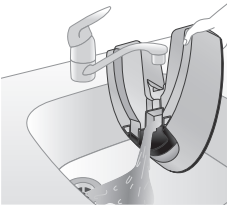

- 4** Pour the water out of the water tank into the sink.



- 5** Push the water tank back into the appliance until it locks in place ('click').



- 6** Fold the supply hose and wind the supply hose inside the supply hose storage compartment.





- 7** Fold the mains cord and fasten it with the Velcro strip. Then carry the base of the appliance with two hands.



- 8** For PSG3010, You can carry the appliance with one hand by the handle of the iron when the iron is locked on the iron platform.

### **PSG2000 series**

- 1** Switch off the appliance and unplug it.

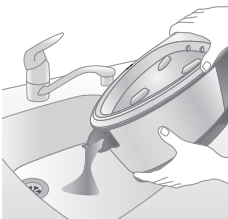
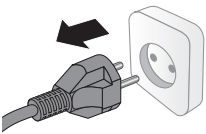

- 2** Pour the water out of the water tank into the sink.



- 3** Fold the supply hose and wind the supply hose inside the supply hose storage compartment.



- 4** Fold the mains cord and fasten it with the Velcro strip. Then carry the base of the appliance with two hands.