

# 44" PORTABLE BASKETBALL HOOP

## INSTRUCTION MANUAL

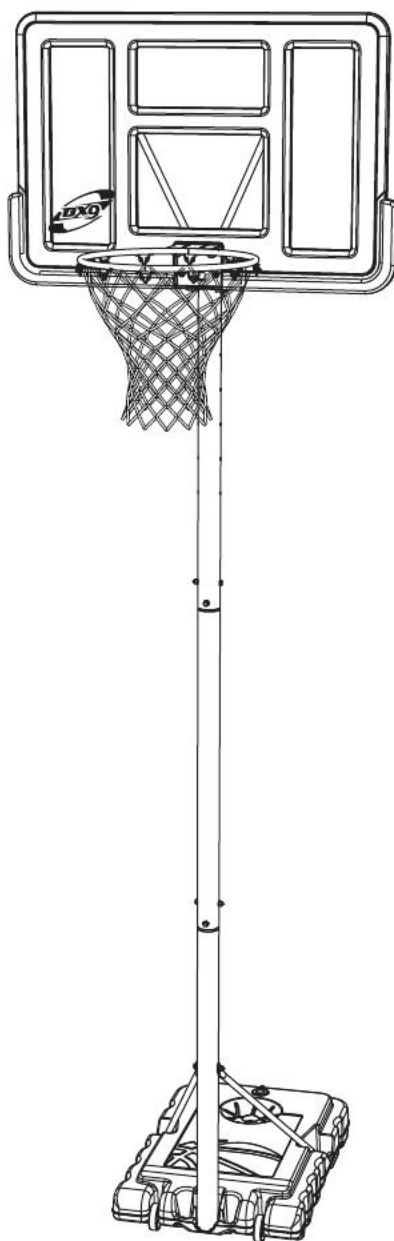

Installation Video



**MODEL NUMBER/STYLE**  
**Portable Basketball System**  
**Item No.: 44GXT2**

### SAVE THIS INSTRUCTION MANUAL FOR FUTURE REFERENCE

Customer Service Mailbox: [SERVICE@GX9SPORTS.COM](mailto:SERVICE@GX9SPORTS.COM)

Toll-Free Customer Service Number for U.S. **626-313-8956**



### **WARNING!**

READ AND UNDERSTAND  
OPERATOR'S MANUAL BEFORE  
USING THIS UNIT.

FAILURE TO FOLLOW OPERATING  
INSTRUCTIONS COULD RESULT IN  
INJURY OR DAMAGE TO PROPERTY.

# POLE CARE AND SYSTEM MAINTENANCE

The life of your basketball hoop depends on many variables. The climate, exposure to corrosives such as salt, pesticides or herbicides, and excessive use, or misuse can all contribute to product damage, which may cause personal injury. Check your basketball hoop frequently for loose hardware, excessive wear, and signs of corrosion. For safety reasons, and to extend the life of your basketball hoop, you must take the following preventative measures:

1. Check all nuts and bolts. If any are loose, tighten them.
2. Check all parts for excessive wear and tear. If necessary, replace any parts that have been worn or damaged through usage.
3. Check all parts for visible rust, chips, or cracked paint. If any are present, do the following:
  - a) Use an emery cloth to completely remove any rust or chipped paint.
  - b) Clean the area with a damp cloth and allow it to dry.
  - c) Spray two coats of rust preventative, high gloss enamel paint on the area.

IF RUST HAS PENETRATED THROUGH THE POLE ANYWHERE, REPLACE THE POLE IMMEDIATELY!

## **WARNING!!!**

NEVER PLAY WITH THE PORTABLE BASKETBALL SYSTEM WITHOUT FILLING UP THE BASE WITH WATER AND/OR SAND FULLY, AS THE HOOP MAY TIP OVER CAUSING INJURIES.

## **SAFETY INSTRUCTIONS**

- DO NOT HANG on the rim or any part of the hoop, including backboard, support braces, or net.
- During play, keep the player's face away from the backboard, rim, and net. Serious injury could occur if teeth/face come in contact with a backboard, rim, or net.
- Only adults should adjust or move the basketball hoop. When adjusting the height or moving the hoop, keep hands and fingers away from moving parts.
- Always check the unit to ensure that the base is full of water and/or sand, all nuts, bolts and hardware are tight before each use.
- The surface beneath the base must be smooth and free of gravel or other sharp objects. Punctures cause leakage and could cause the device to tip over.
- Do not allow water to freeze in the base if it is full of water.
- Two adults are required to complete the installation.
- Use extreme caution if placing the hoop on a sloped surface. The hoop may tip over more easily.
- Keep this manual for future reference.



# SAFETY INSTRUCTIONS



FAILURE TO FOLLOW THESE SAFETY INSTRUCTIONS MAY RESULT IN SERIOUS INJURY AND/OR PROPERTY DAMAGE.

Owner must ensure that all players know and follow these rules for safe operation of the Basketball Hoop.

To ensure safety, do not attempt to assemble this Basketball Hoop without following the instructions carefully. Check entire box and inside all packing material for parts and/or additional instruction material. Before beginning assembly, read the instructions and identify parts using the hardware identifier and parts list in this document. Proper and complete assembly, use, and supervision are essential for proper operation and to reduce the risk of accident or injury. A high probability of serious injury exists if this Basketball Hoop is not installed, maintained and operated properly.

- If using a ladder during assembly, use extreme caution.
- 2 capable adults are recommended for this operation.
- Check base daily for leakage. Leaks could cause system to fall.
- Assemble the pole sections properly. Failure to do so could cause the pole sections to separate during play or transport.
- Operational height is 4.8 ft (1.46m) to 10ft (3.05m) from the ground to the rim.

*Most injuries are caused by misuse and/or not following instructions. Use caution when using this unit.*

## WARNING TO INSTALLERS

Two capable adults are required for installation. The base **MUST** be filled with sand and water at all times. The entire basketball hoop must be installed according to instructions. Failure to follow instructions could result in **SERIOUS INJURY**. It is **NOT** recommended to create a temporary support for the device.



# WARNING



**FAILURE TO FOLLOW THESE WARNINGS MAY RESULT IN SERIOUS INJURY AND/OR PROPERTY DAMAGE.**

**Owner must ensure that all players know and follow these rules for operation of the system.**

- Only hang from the rim briefly to regain balance or avoid injuring others. Release the rim as safely as possible.
- During play, especially when performing dunk-type activities, keep player's face away from the backboard, rim and net. Serious injuries could occur if teeth/face come in contact with backboard, rim, or net.
- Do not slide, climb, or play on base or pole.
- Completely fill base according to manufacturer's instructions or the system will tip quickly causing serious personal injury.
- When adjusting height or moving system, keep hands and fingers away from moving parts.
- Do not allow children to move or adjust system.
- During play, do not wear jewelry (rings, watches, necklaces, etc.). Objects may entangle in net.
- Surface beneath the base must be smooth and free of gravel or other objects.
- Punctures can cause leakage and could cause system to tip over.
- Keep water and organic materials away from pole. Pole can rust and fall.
- Once a month, check pole and all metal parts for rust. Completely remove rust and repaint with exterior enamel. If rust has penetrated any steel part, replace that part immediately.
- Check system before each use for proper ballast, loose hardware, instability, and signs of corrosion and repair before each use. Never play on damaged equipment.
- Do not use system during windy or severe weather. System may tip over. Place system in an area protected from the wind or in an area away from property that may be damaged if the system falls.
- Do not leave unit in vertical position if the base is not properly filled with water and/or sand.
- This product is NOT designed to support a player hanging from any component of this basketball system.
- Rim height adjustments should be made by ADULTS ONLY.
- Wear a mouth guard when playing to avoid dental injuries.

**Toll-Free Customer Service Number for U.S 626-313-8956**



## WARNING:

Failure to observe this warning may cause property damage and/or serious injury.

This product is NOT designed to support a player hanging from any component of this basketball system.

Rim height adjustments should be made by ADULTS ONLY.

Wear a mouth guard when playing to avoid dental injuries.

During play, do not wear jewelry (rings, watches, necklaces, etc.).

Objects may entangle in net.



## WARNING:

**SWINGING ON THIS RIM  
MAY CAUSE SERIOUS  
INJURY OR DEATH.**



## WARNING:

**DO NOT LEAVE UNIT IN VERTICAL  
POSITION IF THE BASE IS NOT  
PROPERLY FILLED WITH WATER  
AND SAND.**

# Parts List

**A** Base  
1 pc

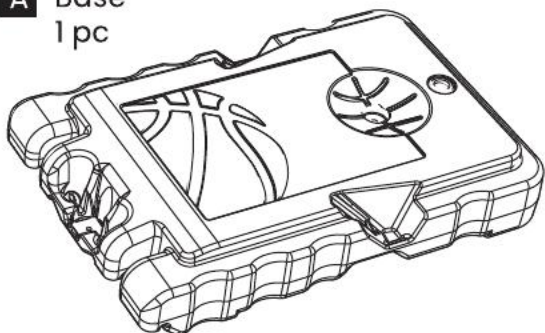

**B** Axle  
1 pc

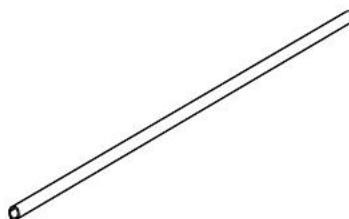

**E** Bottom Pole Brace  
2 pcs

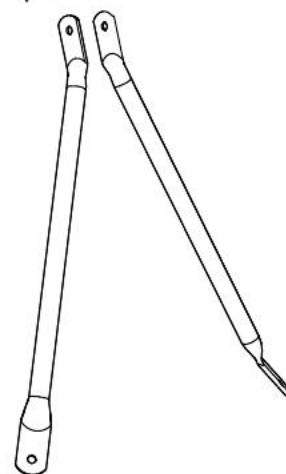

**C** Wheel  
2 pcs

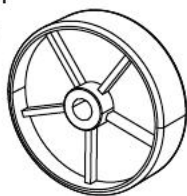

**D** Bottom Pole  
1 pc

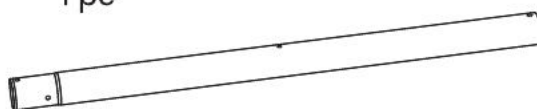

**F** Middle Pole  
1 pc

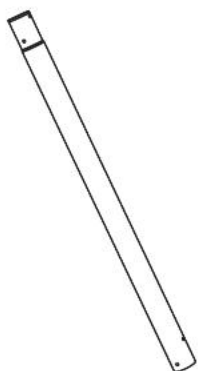

**G** Top Pole  
1 pc

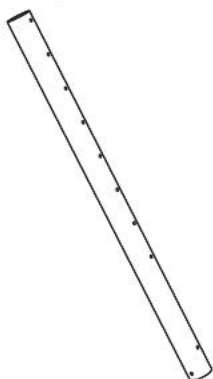

**H** Mounting  
Plate  
1 pc

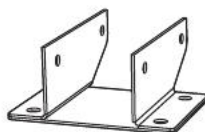

**I** Top Pole Brace  
2 pcs

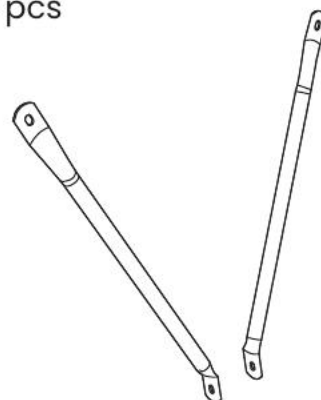

**J** Backboard  
1 pc

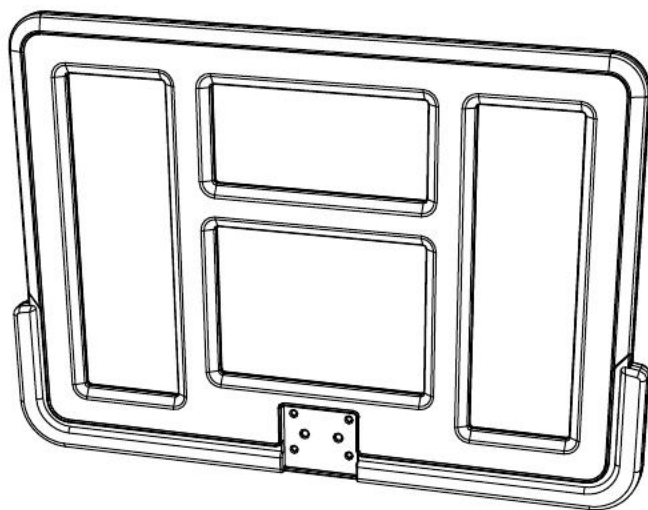

**K** Rim  
1 pc

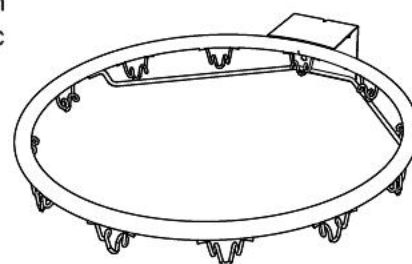

**L** Net  
1 pc

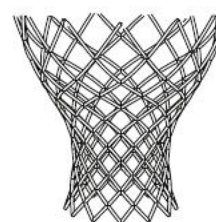

# Small Parts in Blister Pack (Bolts & Screws)

## BAG-1

Socket Wrench X1

Wrench x2

1

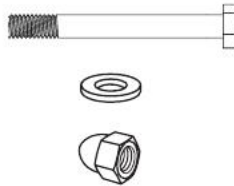
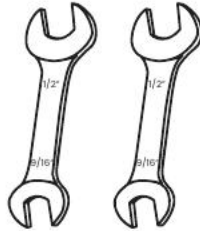
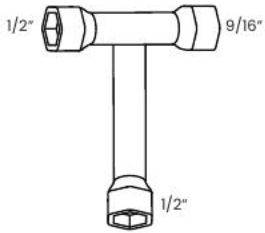

1 pcs Bolt, 5/16 x 3.19 Long

2 pcs Washer, 5/16

1 pcs Nut, 5/16

2



2 pcs Bolt, 5/16 x 0.74 Long



4 pcs Washer, 5/16



2 pcs Lock nut, 5/16

## BAG-2

3



4 pcs Bolt, 5/16 x 3.07 Long



8 pcs Washer, 5/16



4 pcs Nut, 5/16

## BAG-3

4



2 pcs Bolt, 5/16 x 1.77 Long



4 pcs Washer, 5/16



2 pcs Lock Nut, 5/16

5



2 pcs Bolt, 5/16 x 4.48 Long



4 pcs Washer, 5/16



2 pcs Lock Nut, 5/16



2 pcs Concave Washer



2 pcs Springs

## BAG-4

6

14 pcs Top Pole Cap



2 pcs Bolt, 3/8 x 0.63 Long



2 pcs Washer, 3/8



## BAG-5

7



1 pcs Bolt, 5/16 x 3.54 Long



2 pcs Washer, 5/16



1 pcs Lock nut, 5/16

8



1 pcs Bolt, 5/16 x 3.19 Long



2 pcs Washer, 5/16



1 pcs Nut, 5/16

## Required Tools And Materials

The following required tools are **NOT INCLUDED**.



• 2 Capable Adults



• Sawhorse or Support Table



• Sand funnel



• Safety Glasses



• Garden Hose or Sand



1/2" 9/16"

**AND/OR**



1/2"

9/16"

• (2 each) Wrenches and/or Socket Wrenches and Sockets (Deepwell Sockets are Recommended)

# STEP 1

Put the Base (A), Pole (D) and Wheel (C) in place. Insert the Axle (B) as shown below.

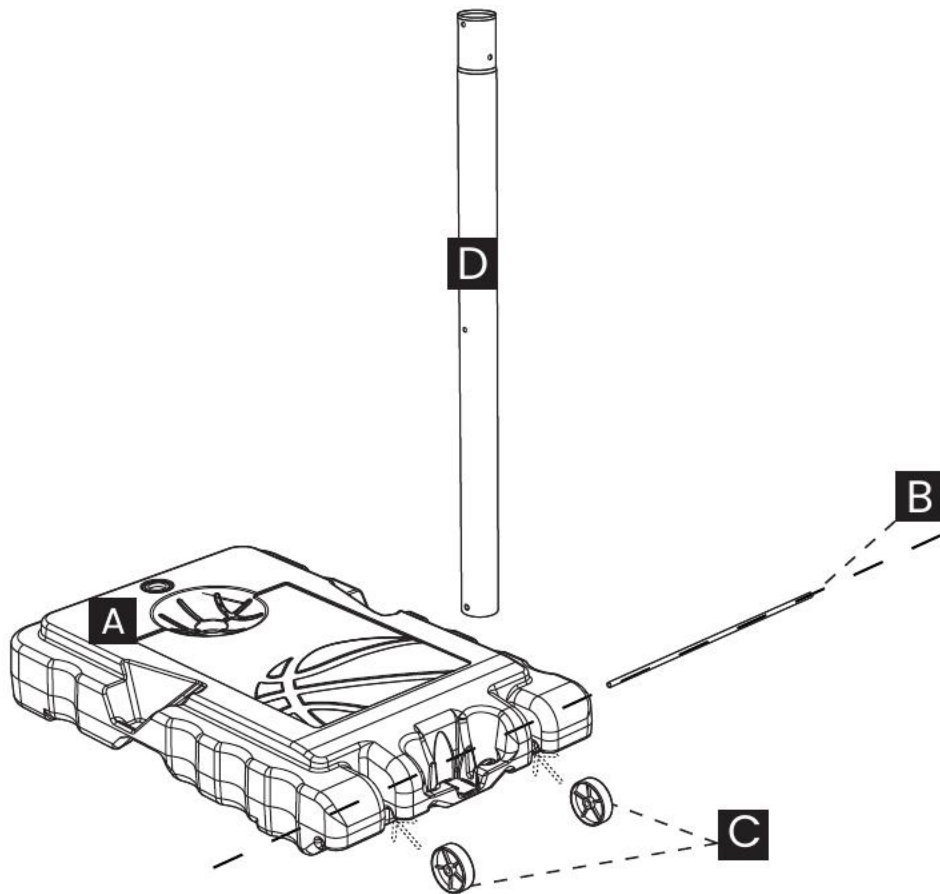

For better stability, ensure the Axle (B) is tight to the Base (A).

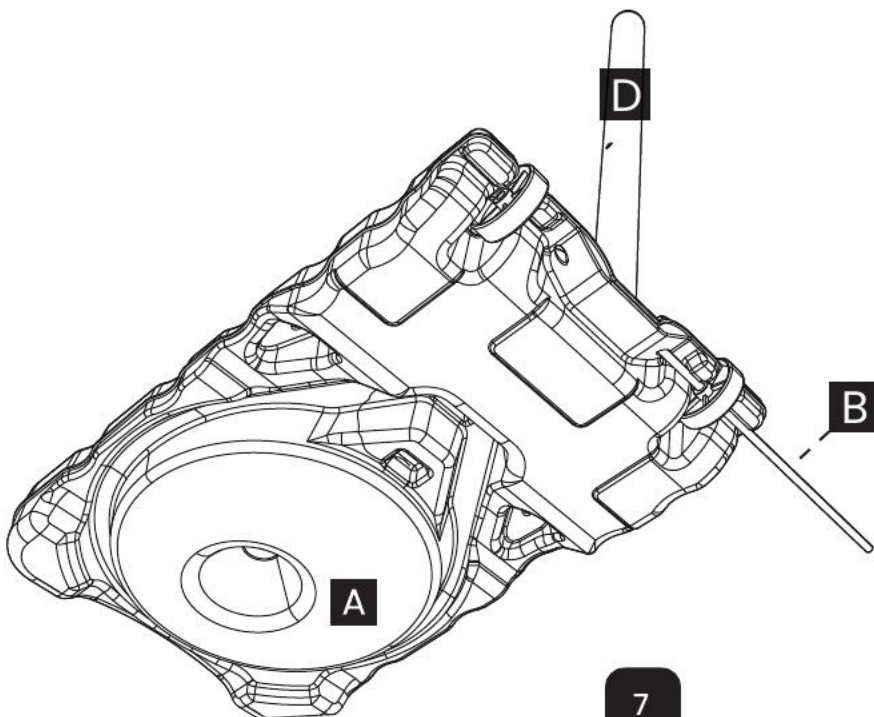

## STEP 2

Connect the Brace (E) to Pole (D) with Bolt set (#1).

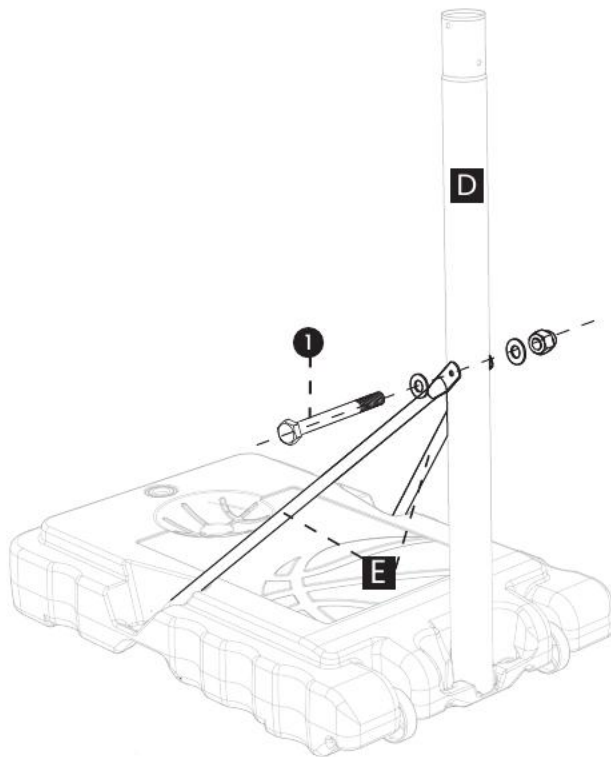

Connect the other end of Brace (E) to Base (A) with Bolt set (#2).

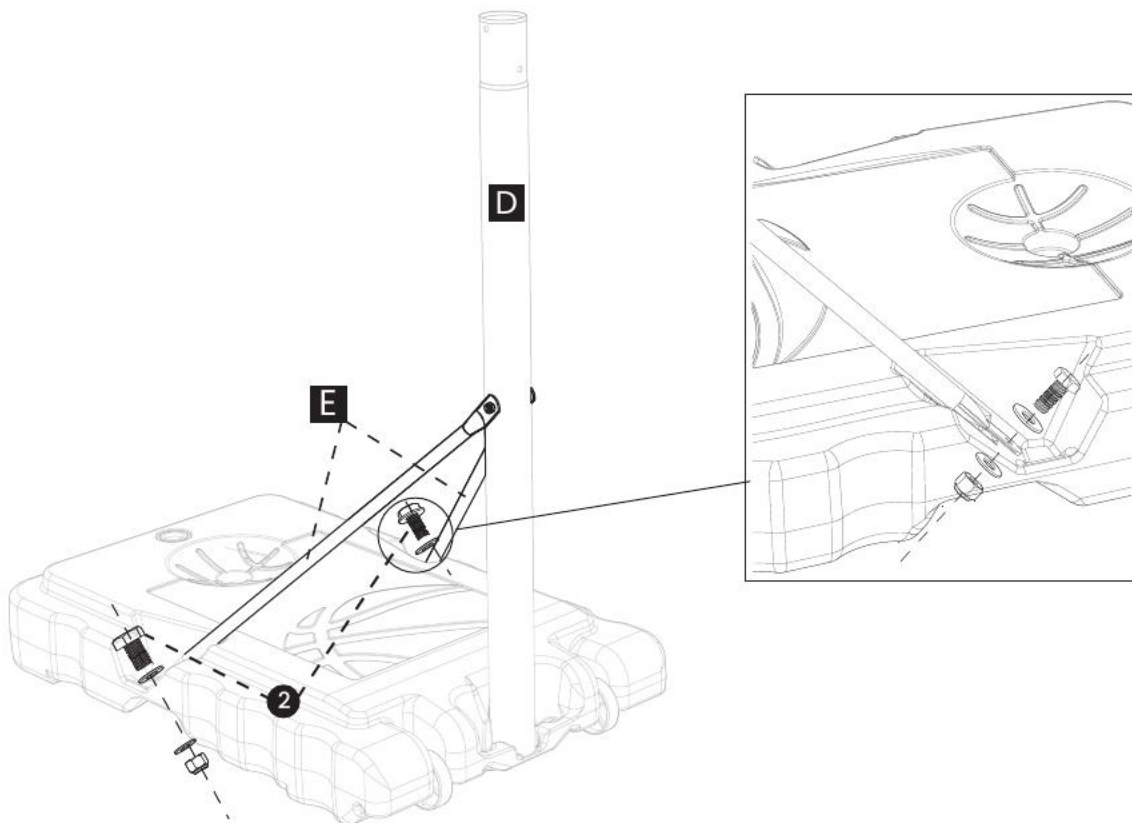

## STEP 3

Connect Pole (F) to Pole (D) with Bolt Set (#3).

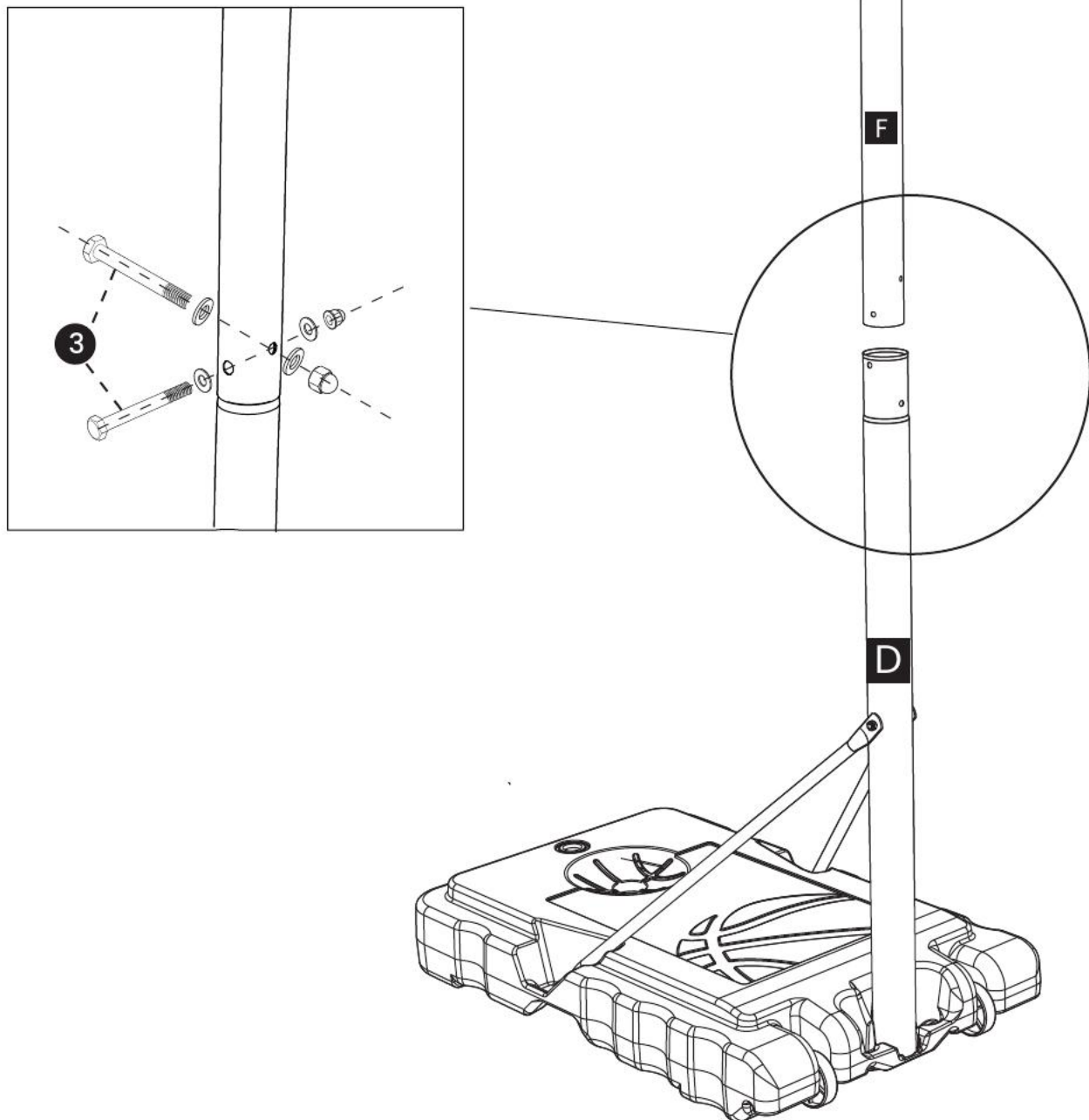

## STEP 4

Connect the Rim (K), Backboard (J) and Mounting Plate (H) together with Screw set (#4) and (#5).

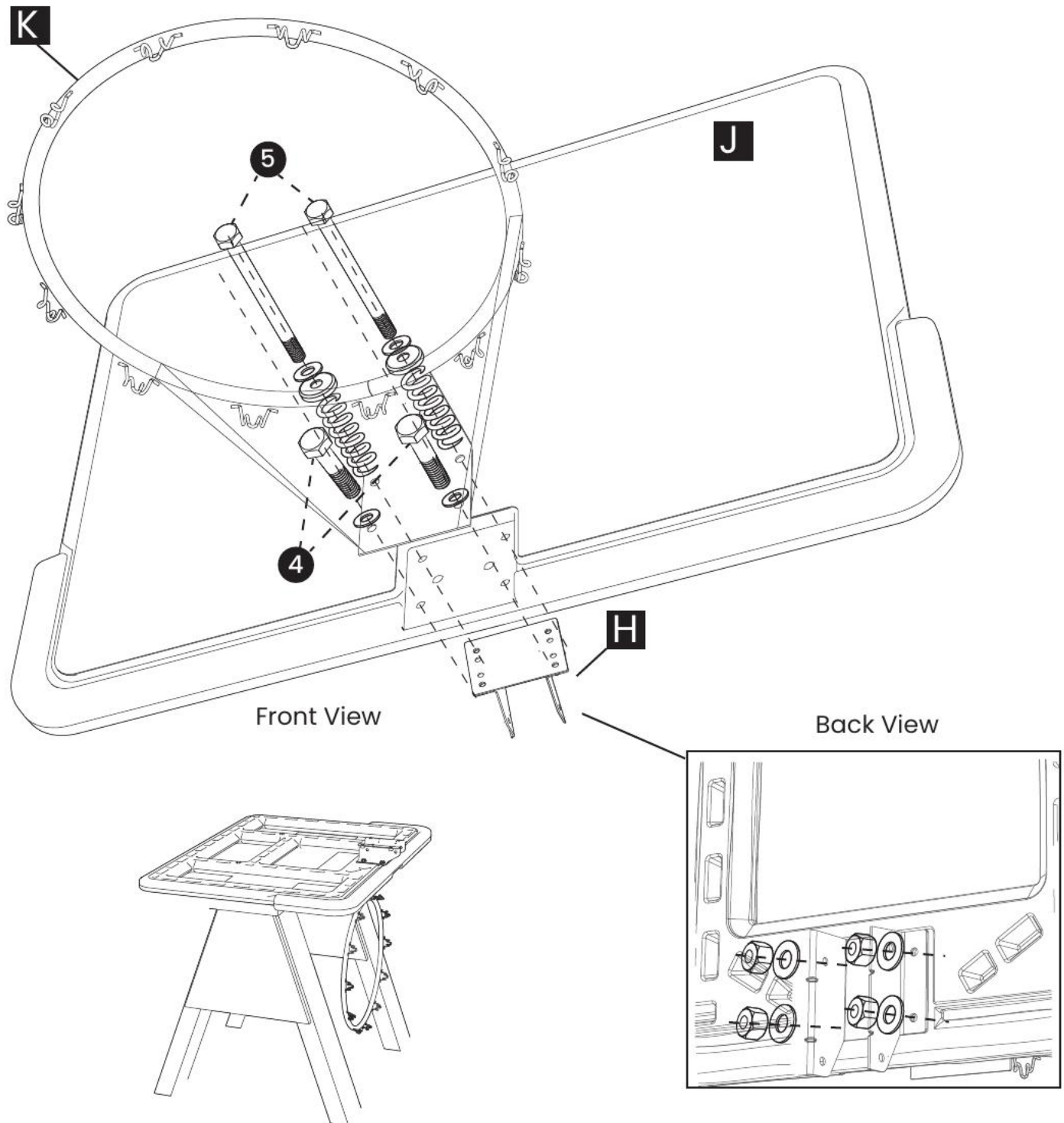

## STEP 5

Connect Lifting tube (I), Mounting Plate (H), Top Pole (G) together with Screw set (#7).

Connect Top Pole (G) to Mounting Plate (H), with Screw set (#8).

Install Lifting Tube (I) to the Backboard (J) with Screw set (#6).

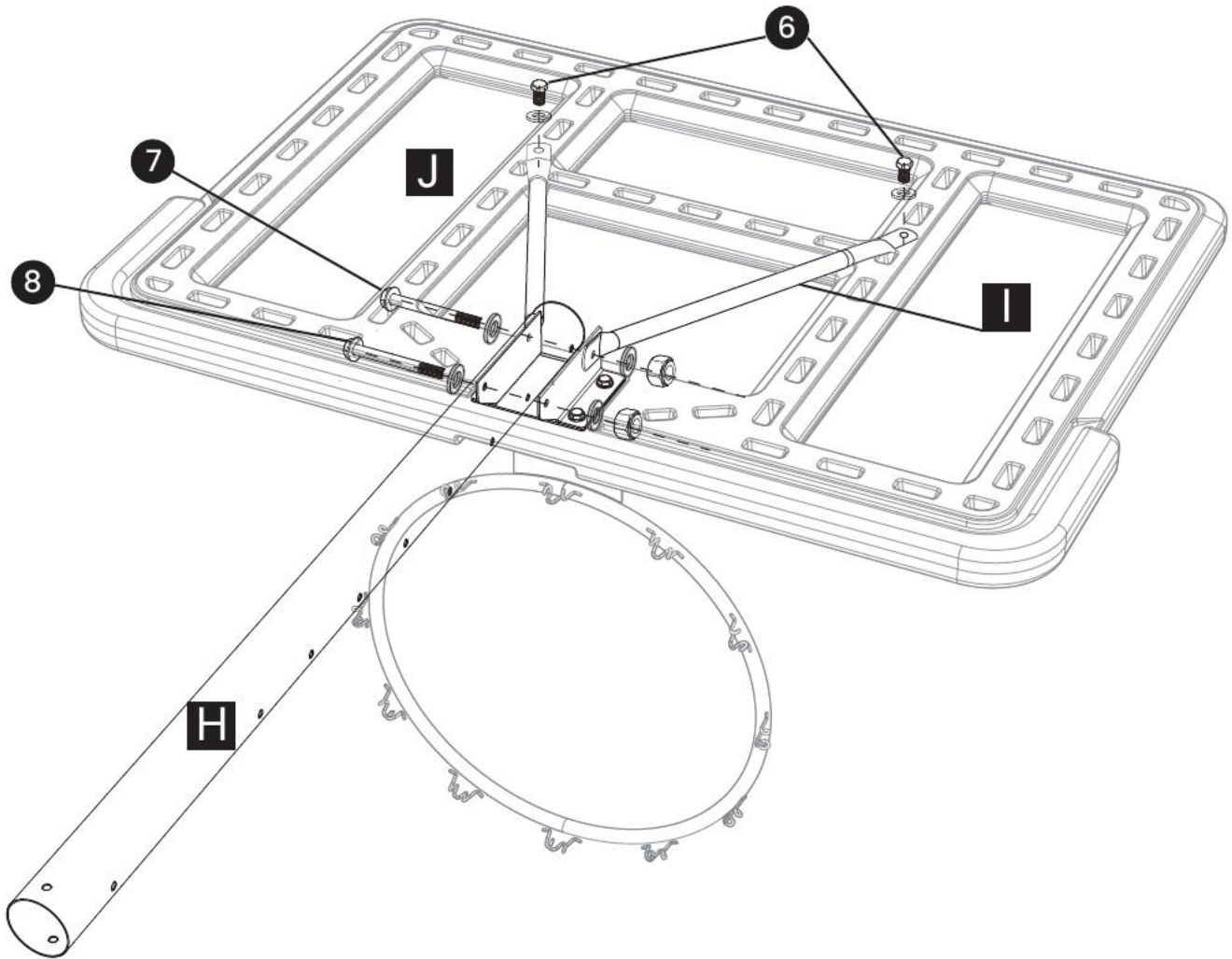

## STEP 6

Install the Net (L) to the Rim (K) as shown below.

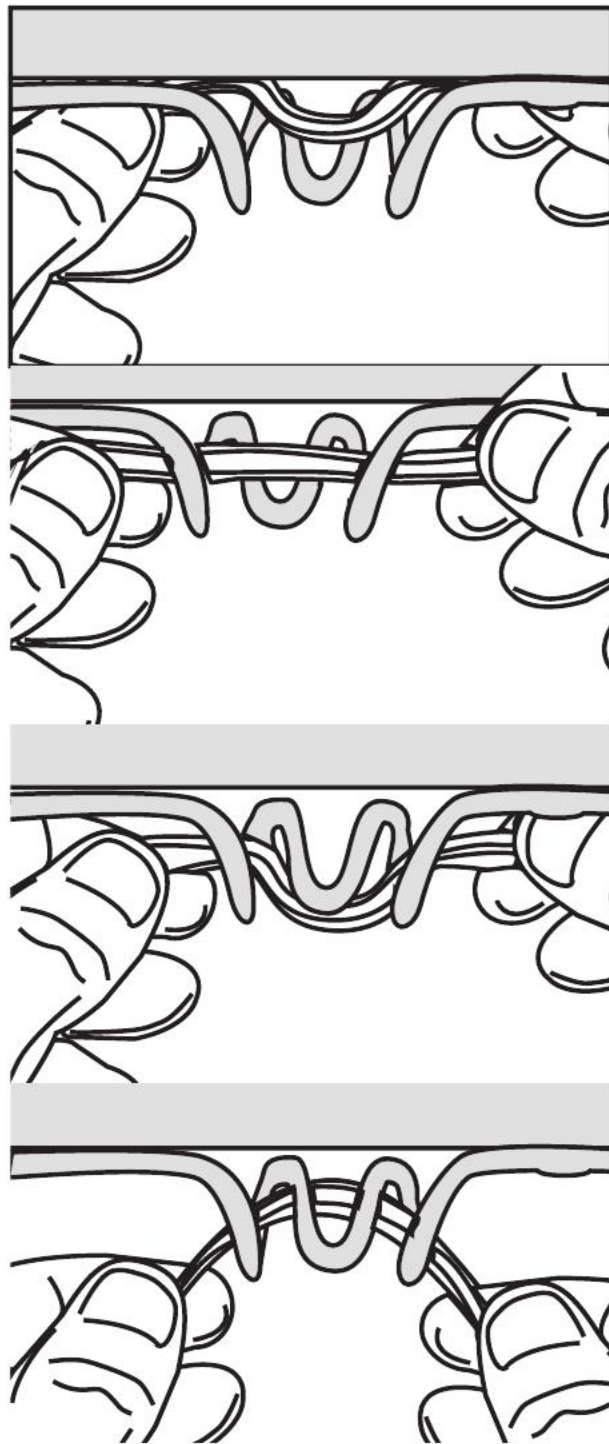
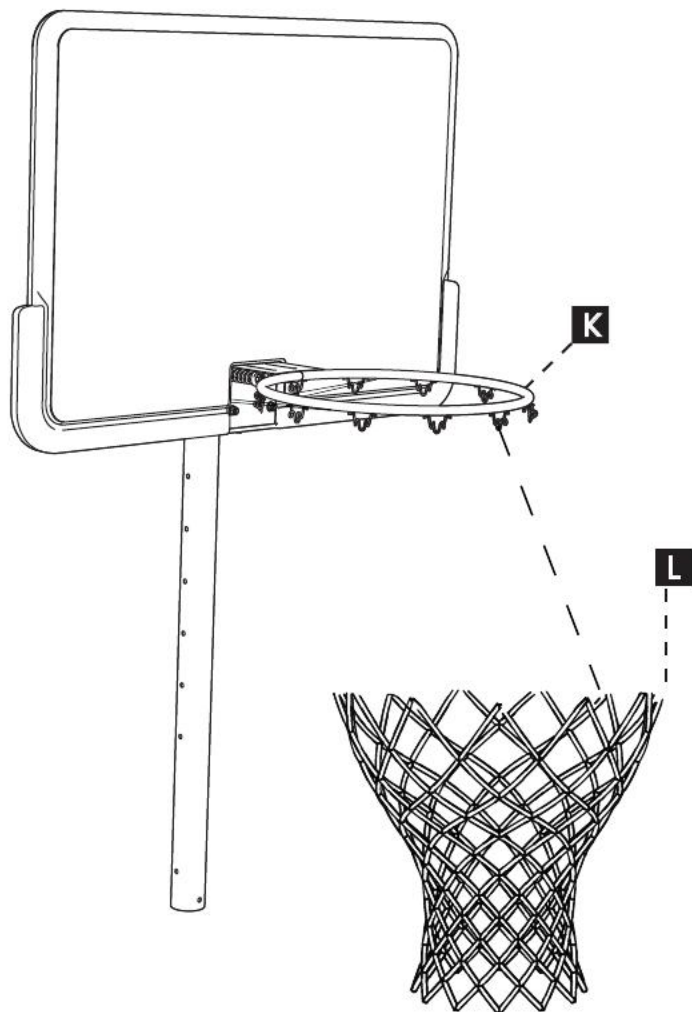

# STEP 7



Warning! Two adults are required for assembly.

Connect Pole (G) to Pole (F) with Bolt set (#3). Install the Pole caps to Pole (G)

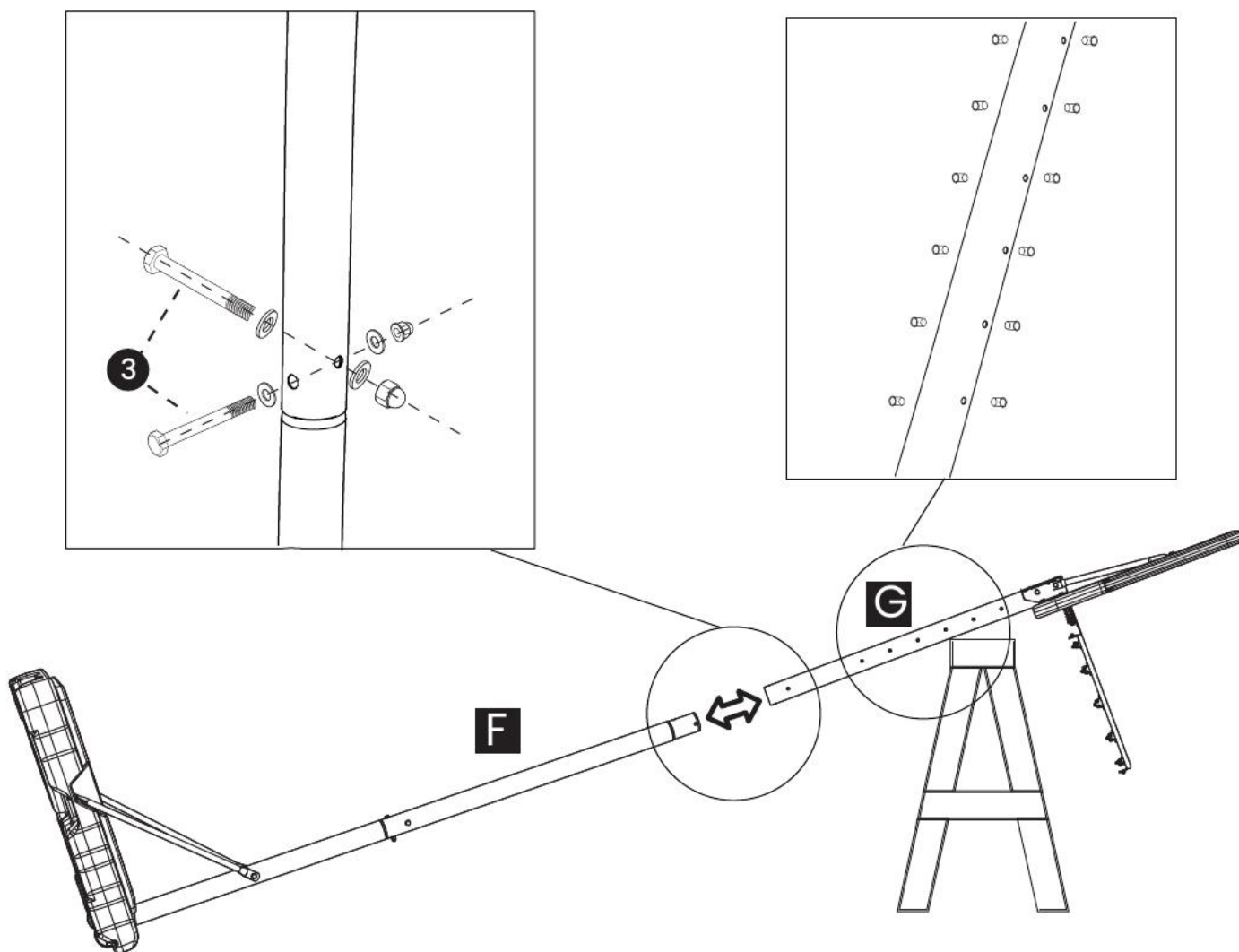

# STEP 8



Warning! Two adults are required for assembly.

Height adjustable range:  
4.8ft (1.46m) to 10ft (3.05m).

Height Adjustment System:

To reach the lowest height 4.8ft (1.46m) for children, take off the middle Pole (F) and connect Top Pole (G) to Bottom Pole (D). Then adjust the Backboard to the lowest position.

FT	M
10FT	3.05M
9.68FT	2.95M
9.36FT	2.85M
9.02FT	2.75M
8.69FT	2.65M
8.37FT	2.55M
8.04FT	2.45M

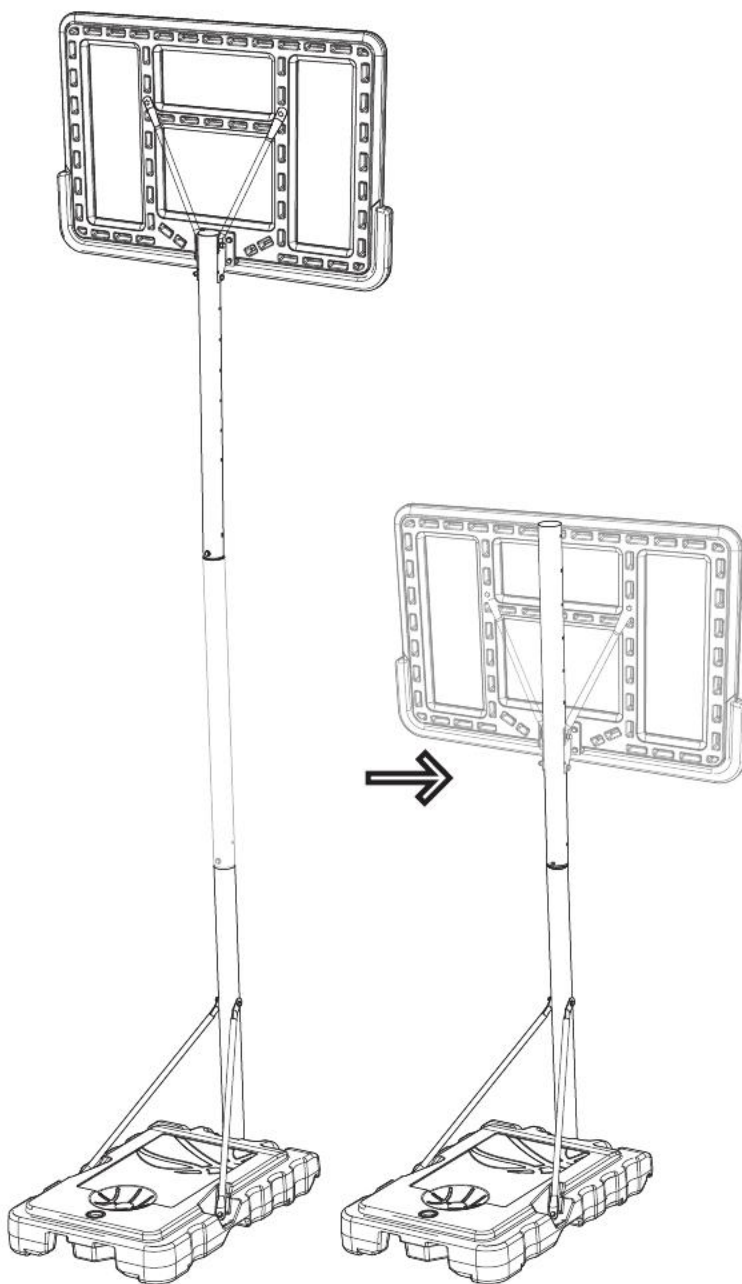

FT	M
6.76FT	2.06M
6.43FT	1.96M
6.10FT	1.86M
5.77FT	1.76M
5.45FT	1.66M
5.12FT	1.56M
4.8FT	1.46M

## STEP 9



Warning! Two adults are required for assembly.

Unscrew the two Bolt set (#7) and (#8) and take them out. Adjust Backboard height as needed. Connect and secure Backboard to Pole (G) again with Bolt set (#7) and (#8).

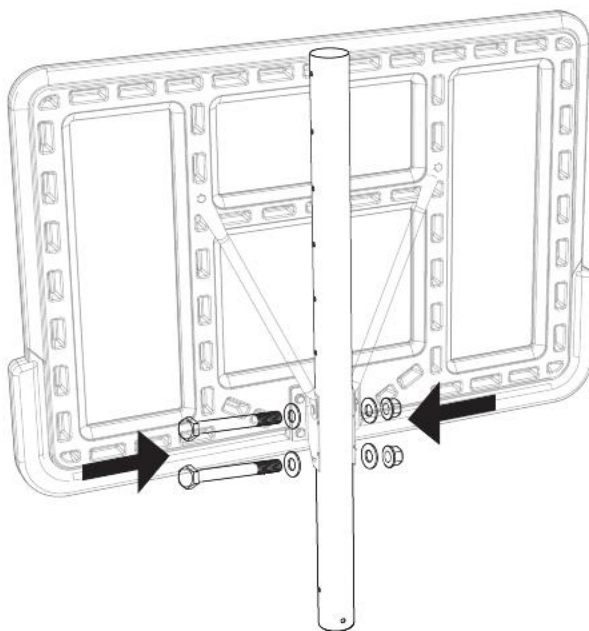
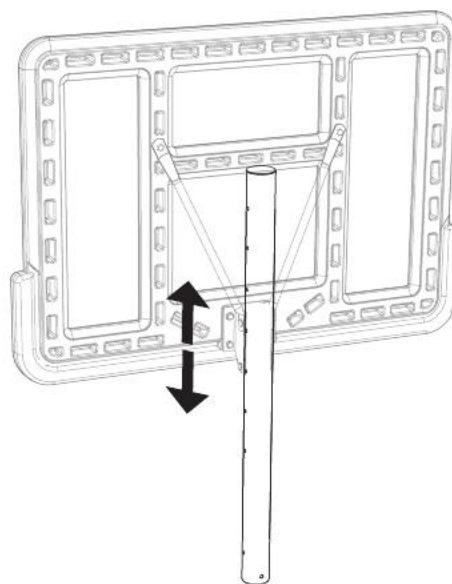
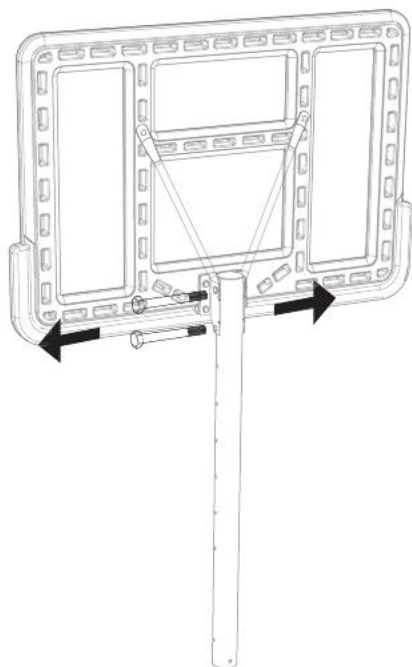

# STEP 10



Warning! Two adults are required for assembly.

## Fill the base with sand **Highly Recommended**

Figure 1

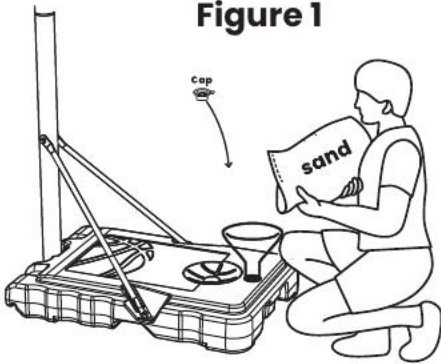
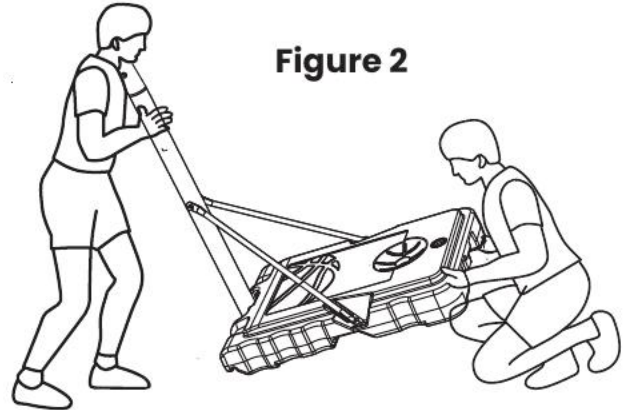

Figure 2



Two adults are required in this step.

1. Adjust the backboard to the lowest position.
2. Fill the base with sand. At least 143.3 lb. (65 kg) sand is required. Load the sand according to Figure 1. Lift the rear of the base according to Figure 2 until the sand slides into the front end of the base. Repeat the step as shown in Figure 1 and Figure 2 until the filling reaches the required weight.
3. Upright the device carefully.
4. Twist on the cap securely.

Reminder: Better to move the basketball hoop to the intended location before filling the base.

## Fill the base with water



1. Fill the base with water, at least 13.2 gallons water is required.
2. Twist the cap back on the base securely.

Reminder: Better to move the basketball hoop to the intended location before filling the base.