

Electric Standing Desk Instruction Manual

Rev00(A)

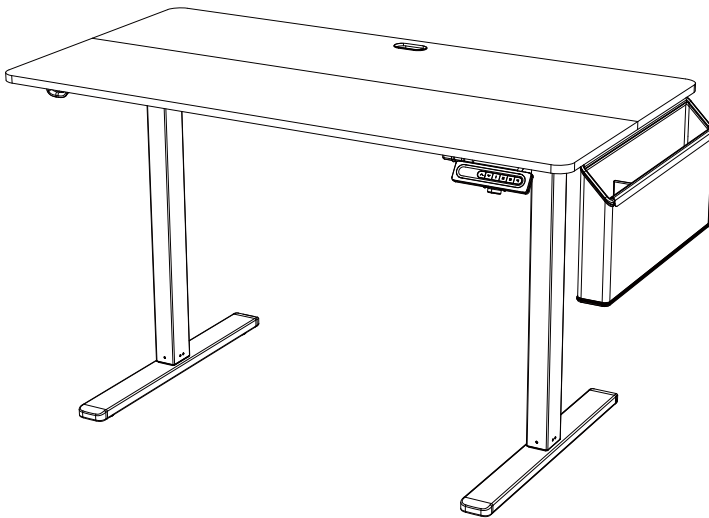

Model:

EGESD21B / EGESD21V / EGESD21N
EGESD22B / EGESD22V / EGESD22N
EGESD23B / EGESD23V / EGESD23N
EGESD24B / EGESD24V / EGESD24N

Thank you for choosing this product! We strive to provide you with the best quality products and services in the industry. Should you have any issues, please don't hesitate to contact us at service.wowowo@gmail.com.

Specifications

Height Adjustment Range:
27.5" – 46.7" (70cm–118cm)



Power Input
100V–240V



Max. Speed
25mm/s



Operating Noise
< 50dB



Load Capacity
176 lbs / 80kg

Tools Needed (not included)

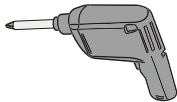

Drill

OR

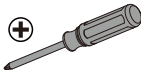

Phillips Screwdriver

Supplied Parts and Hardware for Step 1

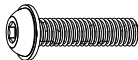

Bolt
M6 x 30mm

A x 12



Bolt
M6 x 10mm

B x 4



Set Screw

C x 2



Allen Wrench
5/32" (4mm)

D x 1



Crossbar

01 x 1

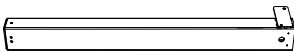

Left Desk Leg

02 x 1

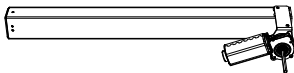

Right Desk Leg

03 x 1

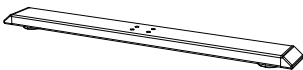

Leg Base

04 x 2

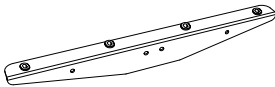

Side Plate

05 x 2



Transmission Rod

06 x 1



Rod Coupler

08 x 1



Wrench

09 x 1

Supplied Parts and Hardware for Step 2



Screw
ST5 x 14mm

E x 6

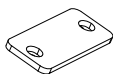

Desktop Panel
Connector

F x 3

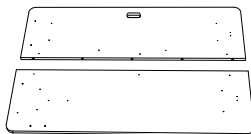

Desktop

10 x 1

Note: An extra wood dowel pin is provided for the longer 55" / 63" desk.



Wood Dowel Pin
x 5 (for 40" / 48")
x 6 (for 55" / 63")

G

Supplied Parts and Hardware for Step 3



Screw
ST5 x 14mm

E x 18

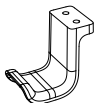

Storage Hook

07 x 2



AC Adapter Holder

11 x 1



AC Adapter

12 x 1



Controller

13 x 1

Supplied Parts and Hardware for Step 4



Screw
ST5 x 14mm

E x 4

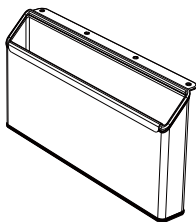

Storage Pocket

14a x 1

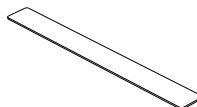

Pocket Bottom

14b x 1

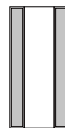

Pocket Divider

14c x 1

Supplied Parts and Hardware for Step 5



Cable Clip

15 x 4



Power Cable

16 x 1

Supplied Parts and Hardware for Step 6

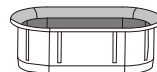

Cable Hole Cover

17 x 1

Step 1: Assembling the Frame

Align holes in the crossbar with holes in the desk legs, and insert four bolts. Partially and then fully tighten each pair of bolts.

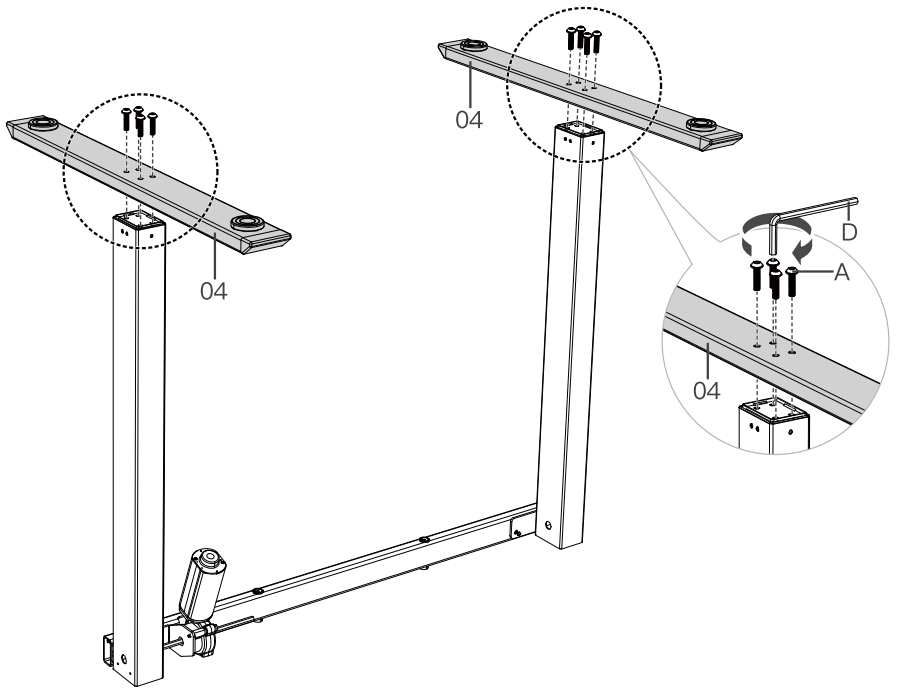
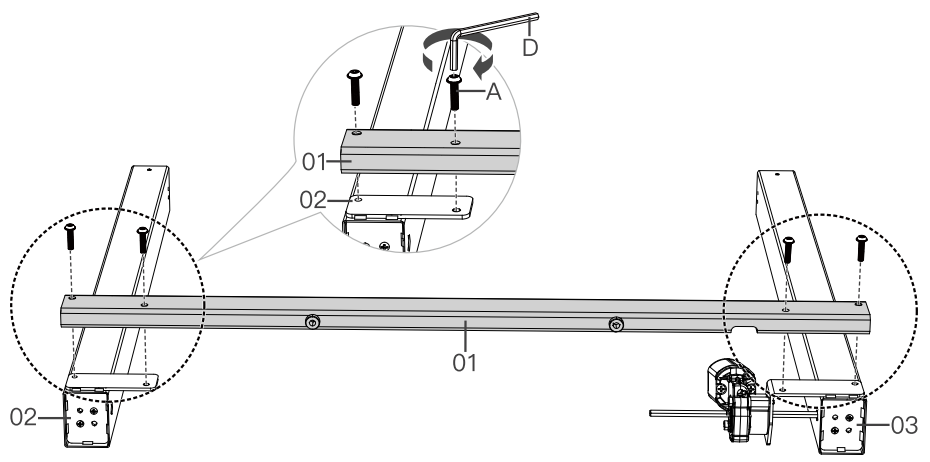

Attach the side plates.

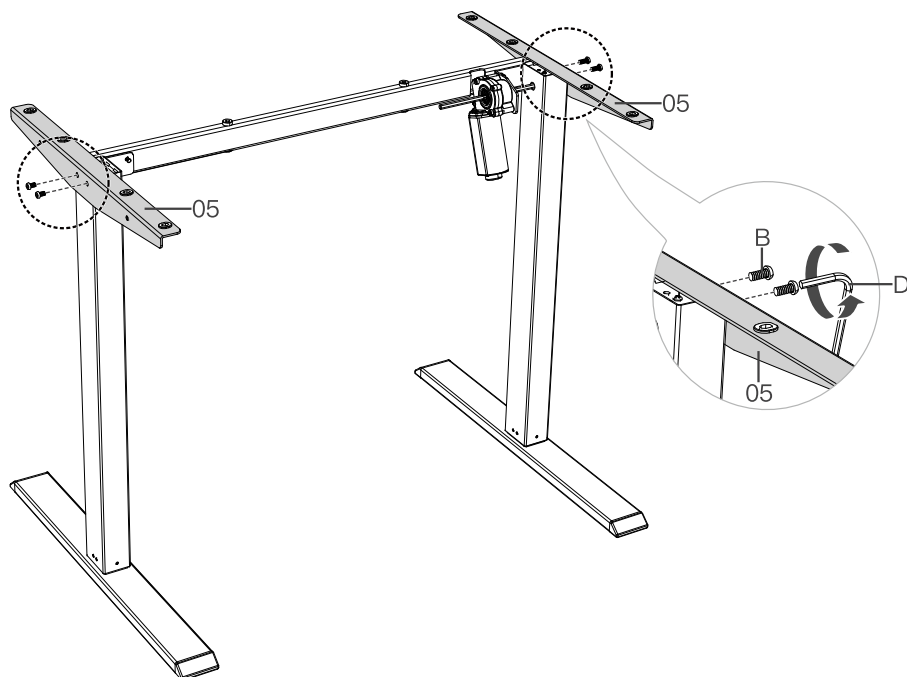

Slide the rod coupler onto the end of the motor drive shaft on the right leg.

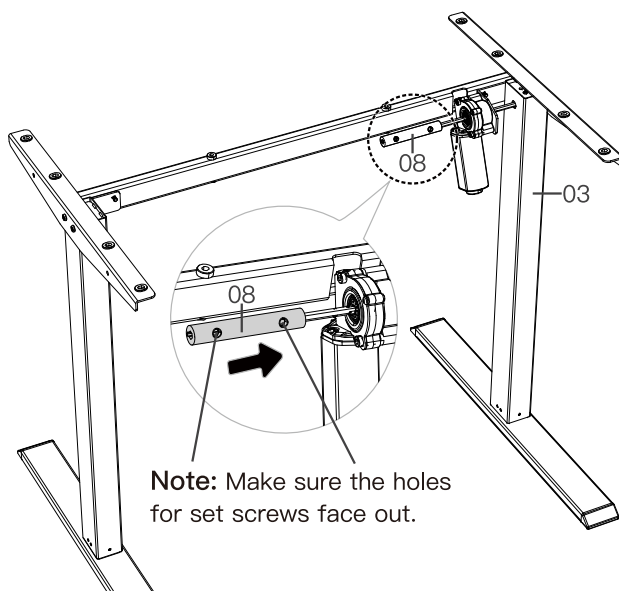

Adjust uneven desk legs:

Before attaching the transmission rod, measure the heights of the two desk legs to see if they are set at the same level. If not, insert the transmission rod into the hole in the left leg. Turn the rod, using the wrench, to adjust the left leg so it's level with the right leg. Turn the rod clockwise to raise the left leg or anti-clockwise to lower it.

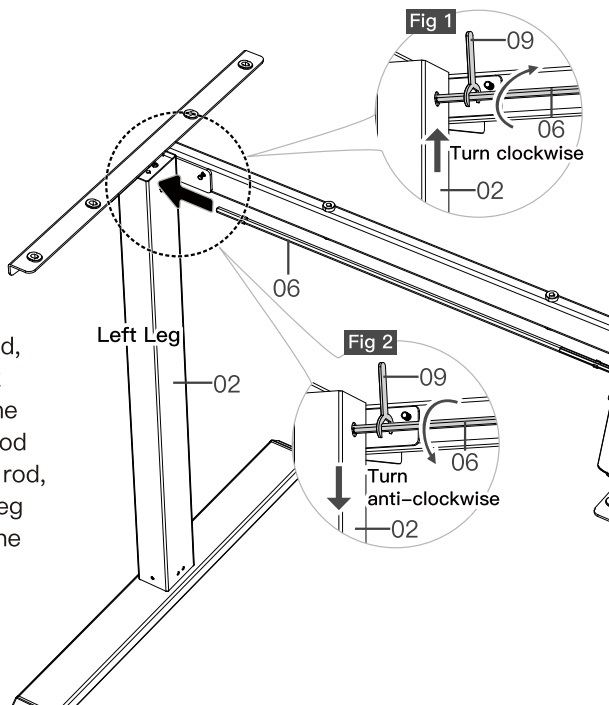

Ensure the transmission rod is properly inserted into the hole in the left leg. Slide the rod coupler to the left to connect with the other end of the transmission rod.

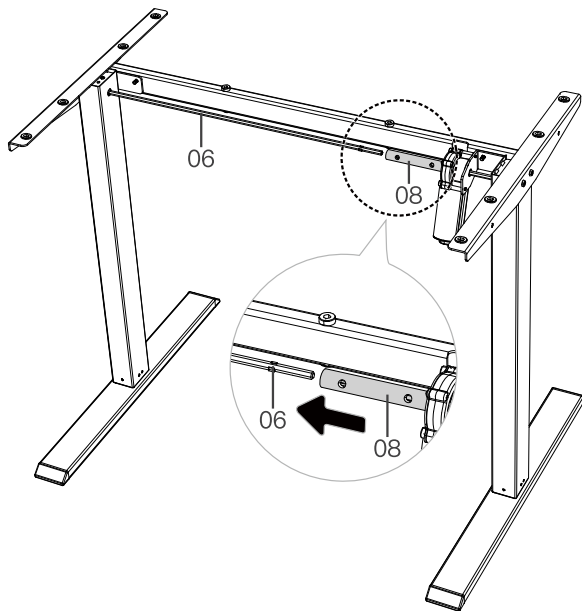

Note: If the transmission rod doesn't fit smoothly into the hole of rod coupler, fine-tune fit with the wrench.

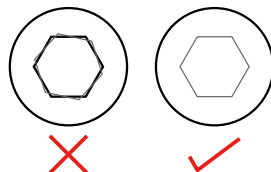
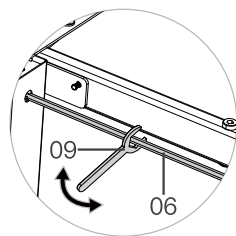

Use the set screws to secure the rod coupler.

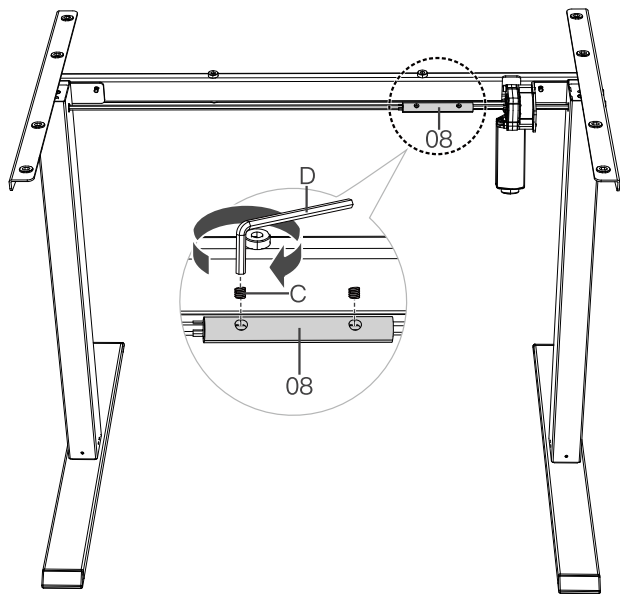

Ensure the rubber pads are attached to the frame. If any have fallen off, reattach them or use the spare rubber pads.

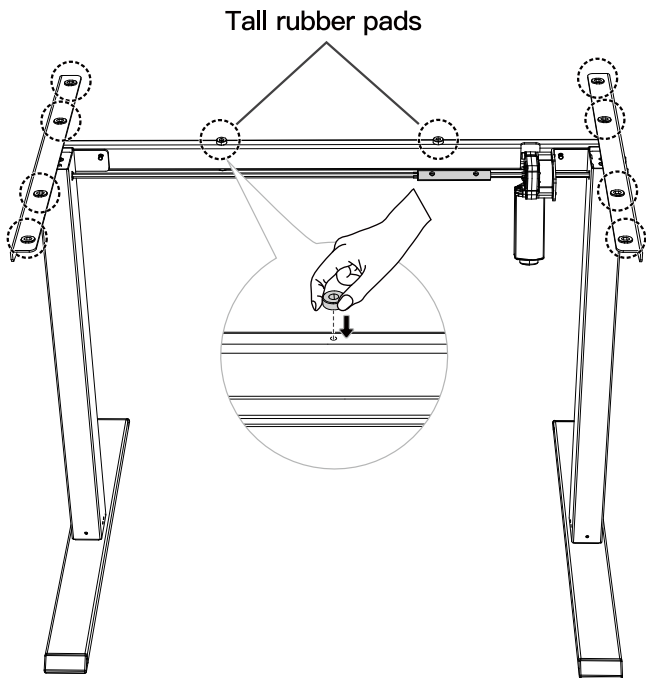

Step 2: Assembling the Desktop

For the 40" / 48" long desk, use the five wood dowel pins to join the two desktop panels together.

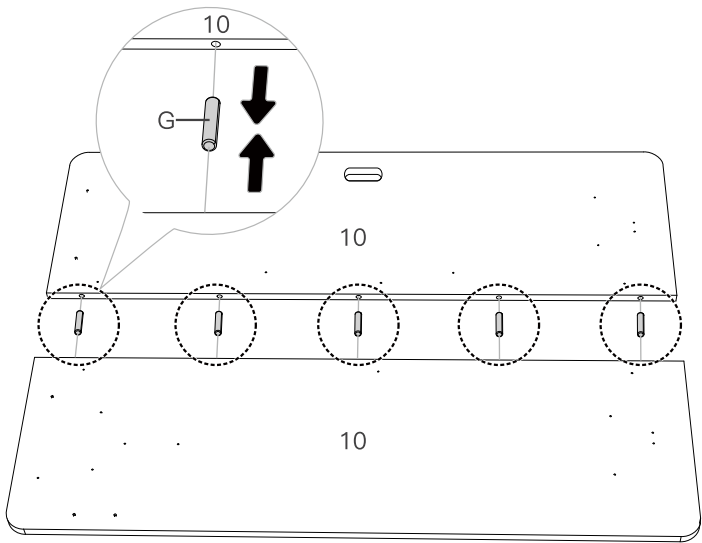

For the 55" / 63" long desk, use the six wood dowel pins to join the two desktop panels together.

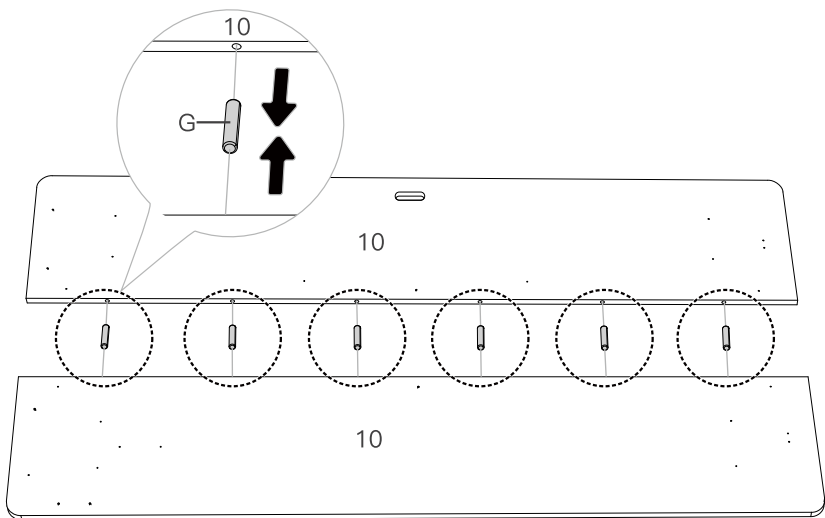

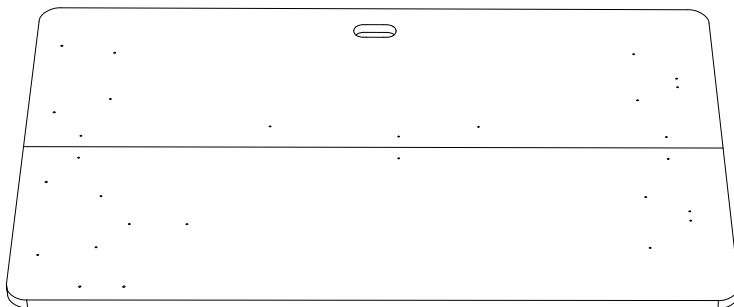

Secure the desktop panels with the connectors.

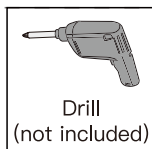

OR



You can use a drill (with suitable torque and speed) or a Phillips screwdriver.

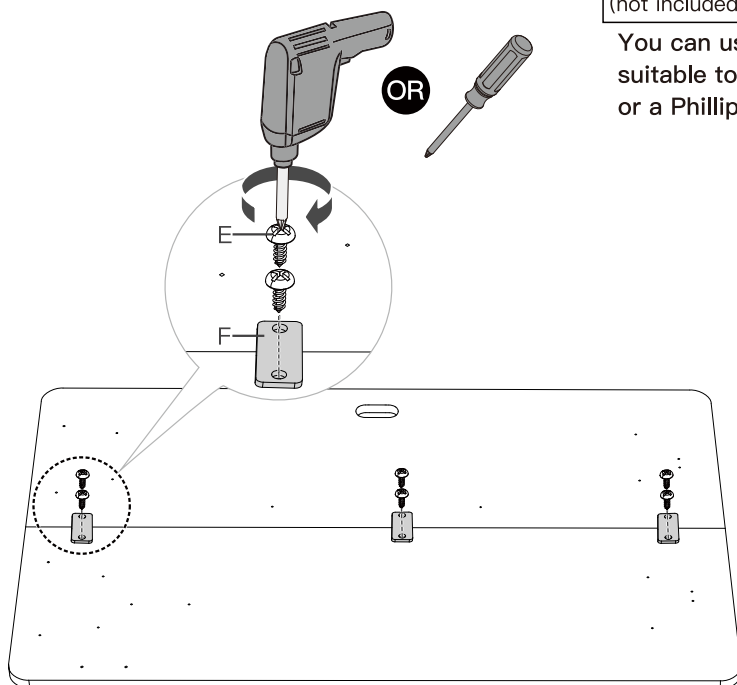

Step 3: Attaching the Desktop

Attach the frame to the desktop.

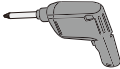

Drill
(not included)

OR



Phillips
Screwdriver
(not included)

You can use a drill (with suitable torque and speed) or a Phillips screwdriver.

Note: An off-center screw hole is not a problem. The pre-drilled holes are only guides for easier screw-in. If you have any questions or issues, please contact us at service.wowowo@gmail.com.

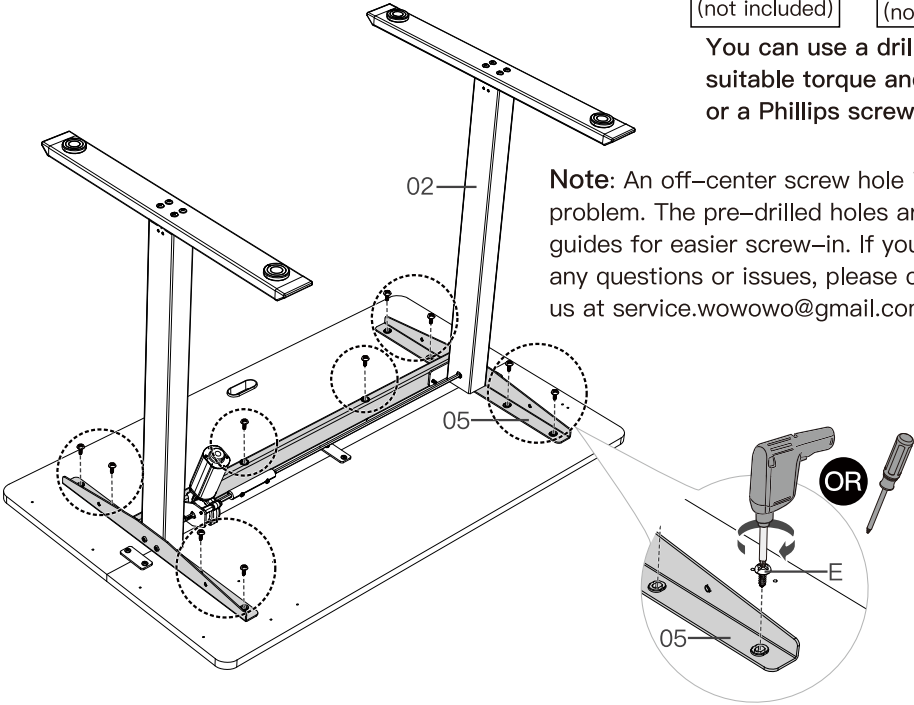

Put the AC adapter into the holder.

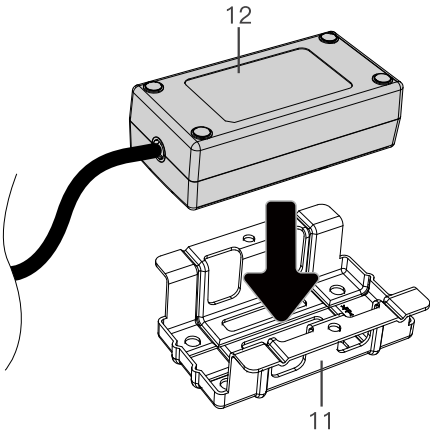

Attach the storage hooks, controller, and AC adapter with holder to the desktop.

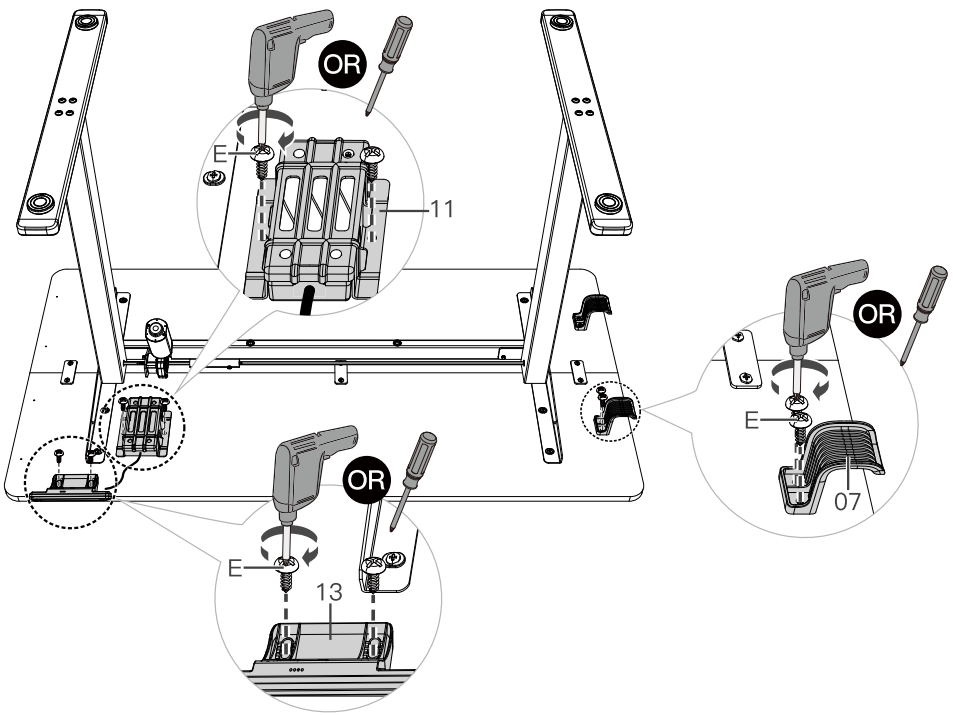

Step 4: Attaching the Storage Pocket

1

A line drawing showing a rectangular storage pocket labeled '14a' with a hand placing a horizontal divider labeled '14b' into its top edge. A large black arrow points downwards, indicating the direction of insertion.

2

Attach the divider to both sides of the storage pocket with the hook & loop fasteners.

Hook & Loop Fasteners

A line drawing showing the divider '14b' being attached to the sides of the pocket '14a' using hook and loop fasteners. A sub-part of the divider is labeled '14c'. A grey arrow points to the right, leading to a final diagram of the completed assembly where the divider is fully attached to the pocket.

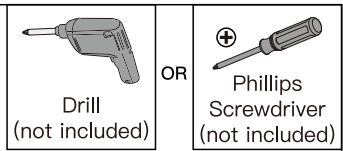

You can use a drill (with suitable torque and speed) or a Phillips screwdriver.

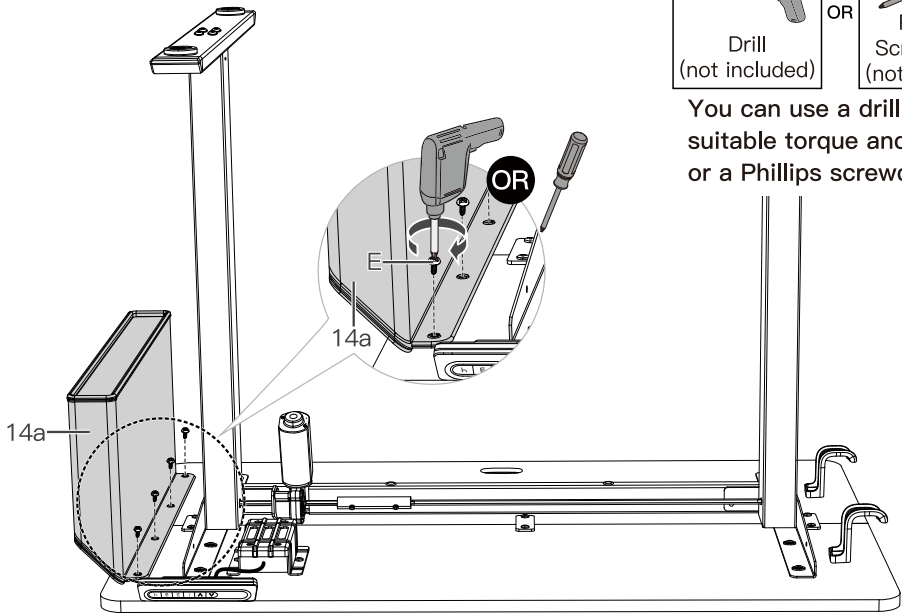

Step 5: Connecting the Cables

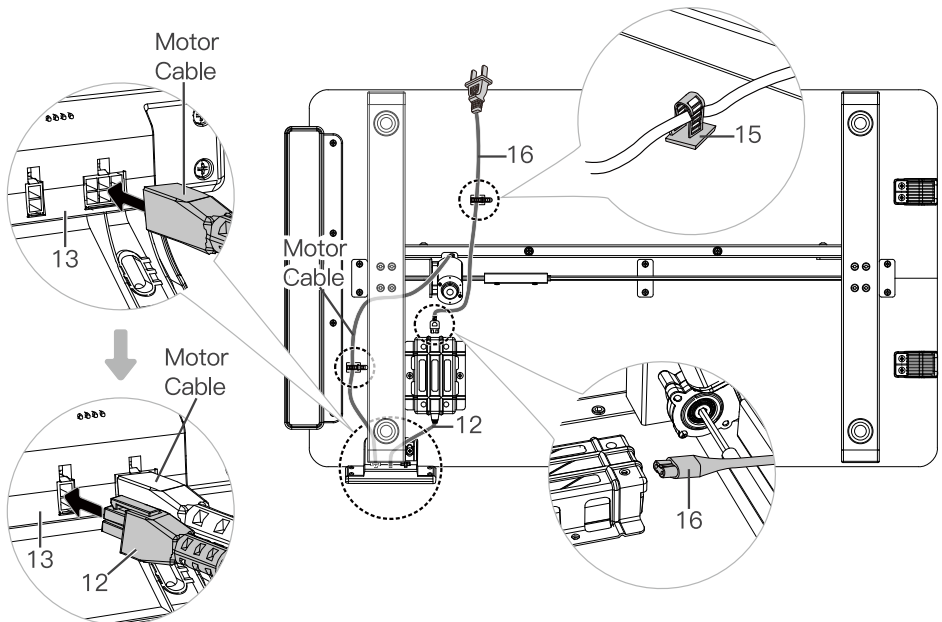

Step 6: Installing the Cable Hole Cover

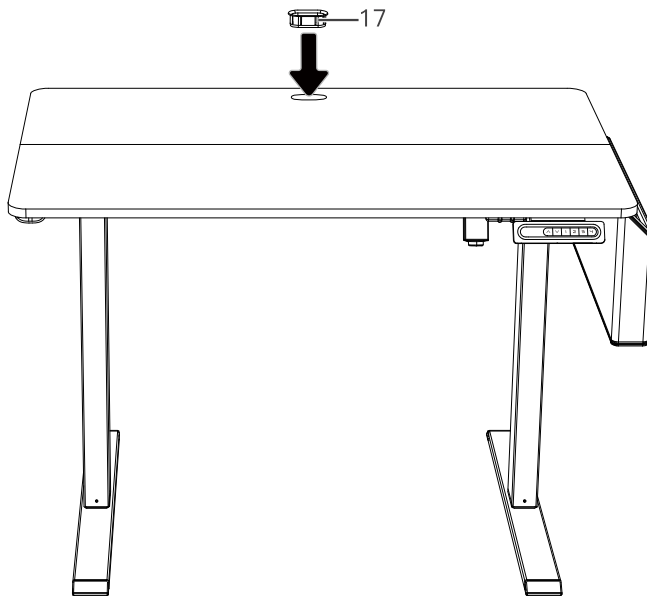

Using the Controller

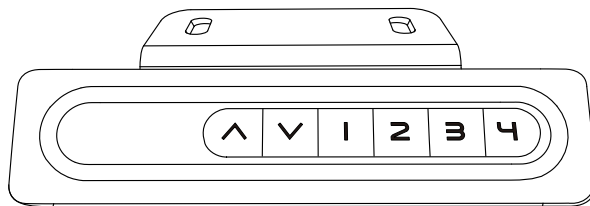

Note: Ensure that there are no obstacles when using the desk, that the desktop is not right next to the wall, and that all cables are long enough for the desk to move up and down freely. When the controller screen is off (power-saving mode), press any button to wake it before operating the desk.

Suggestion: Set the most comfortable height when you sit down to **1** and the most comfortable height when you stand up to **2**. The other two presets can be set for another user or to other heights you want to use.



Raise the Desk

Press the  button to raise the desk continuously until it reaches the highest position of 46.7" (118cm) or the button is released.

Lower the Desk

Press the  button to lower the desk continuously until it reaches the lowest position of 27.5" (70cm) or the button is released.

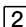
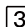
Save Height Settings

Four heights can be stored. Press and hold the  /  /  /  button for 3 seconds. The digital number will flash three times and the current height will be stored to that button.

Select Height Setting 1

Press the  button, and the desk will move to the height that was previously set for that button. Press any button to stop the desk.

Select Height Setting 2

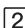
Press the  button, and the desk will move to the height that was previously set for that button. Press any button to stop the desk.

Select Height Setting 3

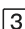

Press the  button, and the desk will move to the height that was previously set for that button. Press any button to stop the desk.

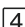
Select Height Setting 4

Press the  button, and the desk will move to the height that was previously set for that button. Press any button to stop the desk.

Settings

Reset

- 1. Press and hold the  button until the desk goes down to its lowest level, and then release the button.
- 2. Press and hold the  button for 5 seconds until the screen displays 'RST,' and then release the button with 'RST' flashing.
- 3. Press and hold it again until the desk goes down to its lowest level and comes back up slightly. The screen will display current height again, and reset is complete.

Lock/Unlock

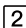
Press and hold  and  buttons together for 3 seconds to turn the lock on. The screen will display 'LOC' and the buttons will be disabled. Repeat to turn the lock off again.

Change Display Height Units	Press and hold 1 and 3 buttons together for 3 seconds to switch the display height unit. The default unit is imperial.
Change Collision Detection Sensitivity	<p>1. Press and hold 1 and 4 buttons together for 3 seconds, and 'S02' will flash on the screen. The last digit displayed is the current sensitivity level, and the value range is 0—3 (0: off; 1—3: highest to lowest).</p> <p>2. Select other levels by pressing ▲ or ▼ button, and then press and hold 1 and 4 buttons together for 3 seconds. The digits will stop flashing, and the screen will display current height again.</p>
Set/Clear Lowest Limit	<p>1. To set the lowest height limit, press and hold ▼ and 1 buttons together for 3 seconds, and the screen will display '—dO'. Whenever the desk reaches the lowest limit, the screen will display '—LO.'</p> <p>2. To clear the lowest height limit, move the desk down to the lowest height (screen displays '—LO') and press ▼ and 1 buttons together for 3 seconds. '—dO' will flash on the screen, and the limit will be cleared.</p>
Set/Clear Highest Limit	<p>1. To set the highest height limit, press and hold ▲ and 1 buttons together for 3 seconds, and the screen will display '—UP'. Whenever the desk reaches the highest limit, the screen will display '—HI.'</p> <p>2. To clear the highest height limit, move the desk up to the highest height (screen displays '—HI') and press ▲ and 1 buttons together for 3 seconds. '—UP' will flash on the screen and the limit will be cleared.</p>

Troubleshooting

1. Please try resetting the desk if you have any issues like the following:

- Abnormal operation.
- The controller screen displays 'RST' (reset).
- The controller screen displays error message E07 or E08, but the motor cable is connected correctly.

2. If the controller screen displays 'HOT,' please wait 20 minutes for the motor to cool down before making any further height adjustment.

**Thank you again for
choosing this product!**

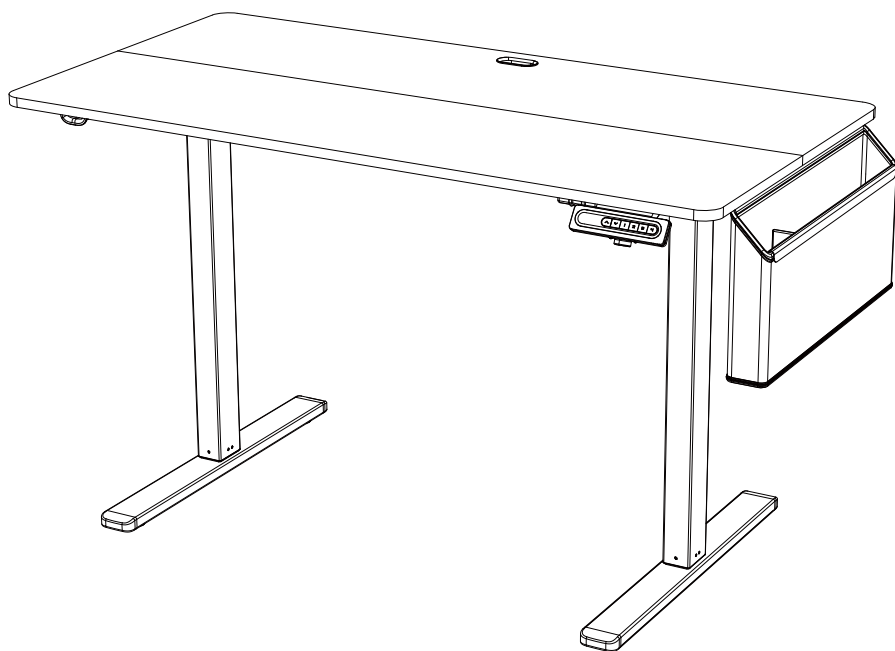

All of us do appreciate your product purchase. We hope that you are as happy with your product as we are designing and manufacturing it for you. We strive to provide you with the best quality products and services in the industry. Should you have any issues, please don't hesitate to contact us at **service.wowowo@gmail.com**.