

# Solar Shade

## Installation Instructions

Content			
Shade (A) Qty: 1	Bracket (B) Qty: 2	Bracket (C) Qty: 2	
Bracket Screw (D) Qty: 2	Bracket Washer (E) Qty: 2	Wall Bracket Screw (F) Qty: 4	Wall Anchor (G) Qty: 4

### Step 1 – Checklist

You will need the following tools:

- Drill
- Small Level
- Pencil
- Light Weight Hammer
- Step Ladder
- Screwdriver
- Tape Measure

### Step 2 – Mounting Brackets

The Roller Shade (A) can be mounted 2 ways Inside Mount or Outside Mount. You will need to leave 1-2 inches of space from the ends of headrail to properly mount the Brackets (B). Always use the Wall Anchors (G) if you are mounting the brackets onto dry wall. Using a 13/64 drill bit, drill a hole for the bracket screw. With a light weight hammer, insert the anchors until flush with the surface.



Mounting Outside  
the Window Frame (Wall)



Mounting Inside  
the Window Frame

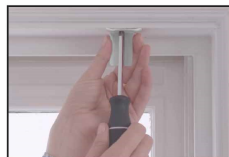

Using Bracket Screw (D) and Bracket Washer (E), secure Bracket (C) to the top of Bracket (B).

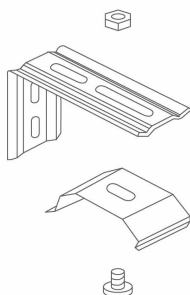

Completed Bracket Assembly

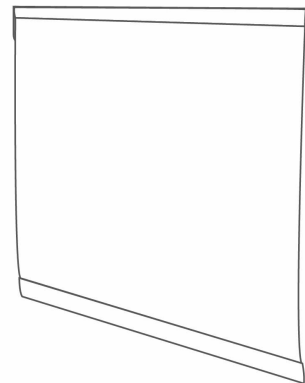

### Step 3 – Installing the Shade & Securing the Headrail

Place the headrail onto the Brackets (C) by inserting the back side of the headrail first and then pushing the front side upward until it snaps into place. There should be an audible click, when the headrail is secured.

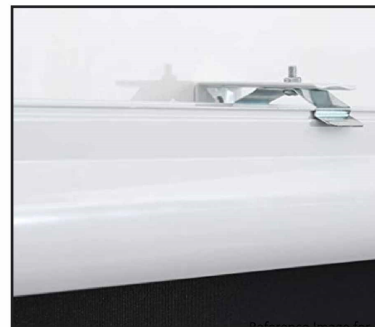

### Step 4 – Operation of Your Shade

To lower the shade:

Pull the shade by the handle to lower the shade to your desired height. Pull the handle again to hold the shade in place.



To raise the shade:

Pull the shade by the handle to release the shade. Lift to the desired height then pull the handle again to hold the shade in place.



### Step 5 – Maintaining Your Shade

Spot clean only or dust your shade with a clean cloth or feather duster.