

Hard Disk Installation Operation Guide

Install only M.2 SSD steps

- 1) Remove the SSD enclosure cover



- 2) Insert the M.2 SSD into the card slot at a certain angle.



- 3) Fix the M.2SSD with the knob

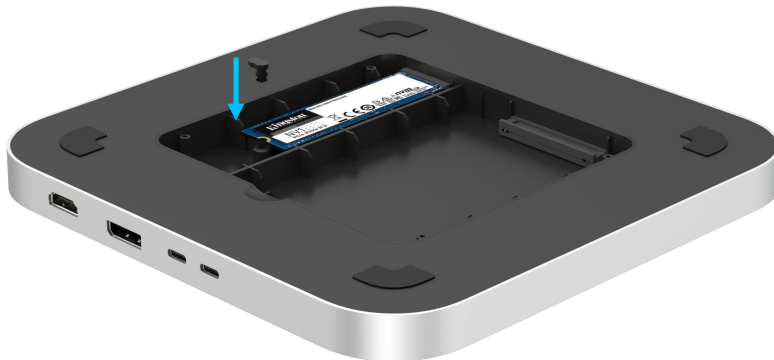

- 4) Put the Enclosure cover on and fix it in the holes with screws



Only install 2.5 inch SATA SSD steps

- 1) Remove the SSD Enclosure cover.



- 2) Insert the 2.5-inch SATA SSD into the card slot at a certain angle.



- 3) Use a self-adhesive sponge to paste on the Enclosure cover corresponding to the 2.5inch SATA SSD (fix the 2.5-inch SSD)

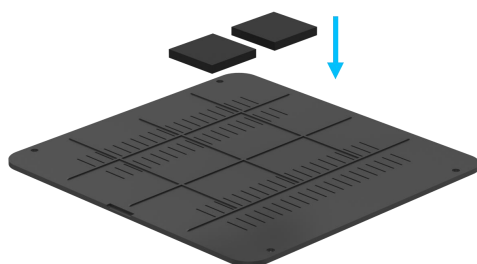

- 4) Put the Enclosure cover on and fix it in the holes with screws.



Steps to install M.2 SSD and 2.5-inch SATA SSD

- ① Remove the SSD Enclosure cover.



- ② Insert the M.2 SSD into the card slot at a certain angle.



- ③ Fix the M.2SSD with the knob

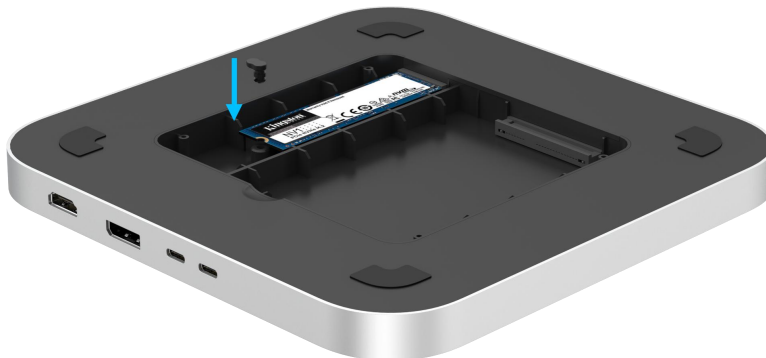

- ④ Insert the 2.5-inch SATA SSD into the card slot at a certain angle.



- ⑤ Use a self-adhesive sponge to paste on the Enclosure cover corresponding to the 2.5inch SATA SSD (fix the 2.5-inch SSD)

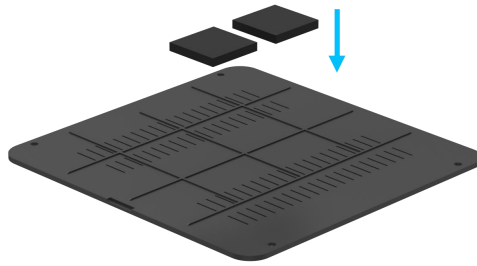

- ⑥ Put the Enclosure cover on and fix it in the holes with screws.



Formatting Steps for Brand New SSD

Disk Utility > Select SSD from List > Click Erase > Name the drive > Select APFS or Mac OS Extended as the format and then Erase the drive

Video output operation method

Windows and Mac OS can only output expanded mode (ABB) and mirrored mode (AAA)

Windows:

Method 1:



Make sure your cables are connected properly to the new monitors, then press Windows logo

key  + **P** to select a display option.

Method 2:

1. Select **Start > Settings > System > Display**. Your PC should automatically detect your monitors and show your desktop. If you don't see the monitors, select **Detect**.
2. In the **Multiple displays** section, select an option from the list to determine how your desktop will display across your screens.
3. Once you've selected what you see on your displays, select **Keep changes**.

Mac OS:

1. Choose Apple menu  > System Settings, then click Displays  in the sidebar. (You may need to scroll down.)
2. Click the + pop-up menu on the right (below the name of your Mac), then choose your display.