



# WARM SERIES

USER MANUAL

## Table of contents

Getting started .....	4
Package contents.....	4
Safety and handling .....	4
Battery .....	4
Exposure to moisture, heat, dust and other elements .....	4
Impact resistance .....	5
Repairs.....	5
Correct care and storage .....	5
Not a medical device .....	5
Danger .....	5
Switching on your Digitsole connected insoles .....	6
Charging the insoles .....	6
Adjusting the soles .....	6
Download the dedicated Warm Series application.....	7
Using the Warm Series app .....	7
Create your account .....	7
Privacy Policy .....	8
Connect your insoles to the app .....	9
Adjust the temperature of your insoles .....	10
.....	11
Timer (v7 only).....	11
Live and history .....	11
Start a new walking activity.....	11
Session history .....	12
Application settings .....	13
My profile .....	13
.....	14
My insoles.....	14
Units .....	15
Languages .....	15
Version.....	16
Terms of Use and Privacy Policy.....	16
Contact us.....	16
.....	17

Log out.....	17
Specifications of the insole battery .....	17
Radio module .....	18
Product maintenance .....	18
Recycling of insoles.....	18
Declaration of conformity .....	18
CE.....	19

## Getting started

The first connected insoles that allow the user to warm his or her feet while analysing physical activity.

## Package contents

In the box, you will find:

- A pair of Warm Series insoles
- A user manual
- A cable (1 Micro USB 2.0 USB – XGW08-047-02)

## Safety and handling

Important safety and handling information for your Warm Series insoles.

### Battery

**STANDBY MODE:** The insoles are programmed to go into "standby mode" if they are not connected to a phone, when no movement is detected for five minutes. This mode is designed to save battery power when the insoles are not in use. When the insoles are in standby mode, the red LED does not flash. A simple shake of the insoles will wake them up, and the light will start flashing again.

Do not attempt to remove or replace the batteries built into the insoles, as this may damage them.

Please refer to page 31 for instructions on battery and insole recycling.

### Exposure to moisture, heat, dust and other elements

The connected insoles have a protection class of IPX6 and are water resistant. The battery can be damaged by temperatures above 100 °C.

	Charge	Discharge
Operating temperature	0 ~ 25 °C	-20 ~ 60°C



	-10°C	0°C	23°C	60°C
Capacity	50%	80%	100%	95%

## Impact resistance

The insoles have been tested and can withstand impacts of up to 600 kg.

Do not bend, hit or perforate the Sport Profiler insoles.



## Repairs

Do not use the connected insoles if they are damaged; do not attempt to repair or modify them in any way, as this may damage the electronic components inside.



## Correct care and storage

If your insoles need to be cleaned, we recommend using chemical-free wet wipes for the outside of the insoles. Avoid letting moisture get into the USB ports. Never put the Sport Profiler insoles in the washing machine.



Information about correct storage:

- Do not expose to sunlight, excessive heat or fire
- Avoid storing them in the basement, bathroom or other damp areas
- Store the soles with a charge of approximately 30–50%
- We recommend charging the insoles about once every six months to prevent them from running out of charge completely
- Storage temperature:
  - Less than one year: -20 ~ 45 °C
  - Less than 3 months: -20 ~ 40 °C

## Not a medical device

This device is not a medical device within the meaning of the MDD 93/42/EC. It is not intended to be used for the diagnosis, treatment or prevention of disease.

## Danger

Sport Profiler insoles may present a choking hazard to young children. Keep the modules out of the reach of young children.

The use of these insoles during air transport is not recommended.



## Switching on your Digitsole connected insoles

### Charging the insoles

To charge your insoles:

1. Connect the charging cable to a USB power supply (preferred) or to your computer's USB port. Use only the cable model supplied with the device.
2. Next, connect your insoles to the Micro USB 2.0



A full charge takes about two and a half hours. Once charged, the insoles can last up to 8 hours. The battery discharge time varies according to usage: heating set point, type of shoes worn, etc.

PLEASE NOTE: The insoles are programmed to go into "standby mode" if they are not connected to a phone, when no movement is detected for five minutes. This mode is designed to save battery power when the insoles are not in use.

#### Charging and connecting your insoles

The insoles must be fully charged before first use.

- To charge them, open the protective cap on each insole.
- Insert the two micro USB connectors from the cable supplied into the insoles.
- Connect the only remaining USB part to a computer or wall socket.
- When charging, the LED on the module is red; it goes out automatically when the battery is 100% charged.

## Adjusting the soles

To adjust the size of the insoles to your shoes, you can cut them along the lines.

Be careful not to cut beyond the dotted lines on the underside of the insoles, as this could damage the electrical components and the insoles may no longer heat up. In addition, the guarantee would no longer take effect.

## Download the dedicated Warm Series application

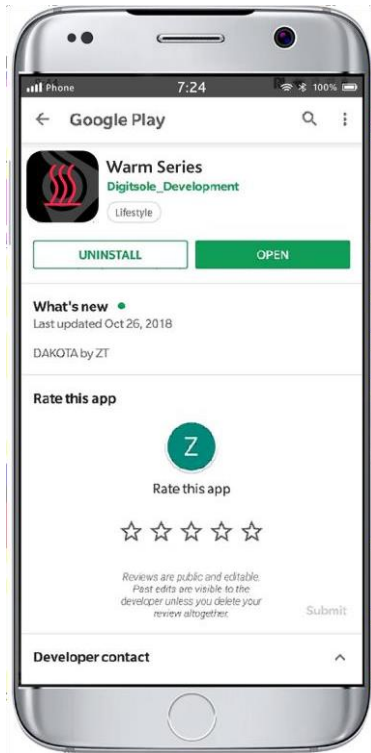

The Warm Series app is free and compatible with phones that support iOS (minimum: iOS 9.0) and Android (minimum: Android 5.0). To see if your phone is compatible with the application, check your phone version in the settings.

You can find the Warm Series application by typing 'Warm Series' in the search bar:

- On App Store<sup>®</sup> for iOS
- On Play Store<sup>®</sup> for Android

1. Install the app.
2. Activate Bluetooth and location tracking on your smartphone.
3. Launch the app.
4. Create your account on the app.

## Using the Warm Series app

### Create your account

To create your account:

1. Click on "Register".
2. Enter your personal information, such as your first name, surname, gender, date of birth and measurements.
3. Enter your email address and the password you wish to use

Your account is now active and you can use the app.

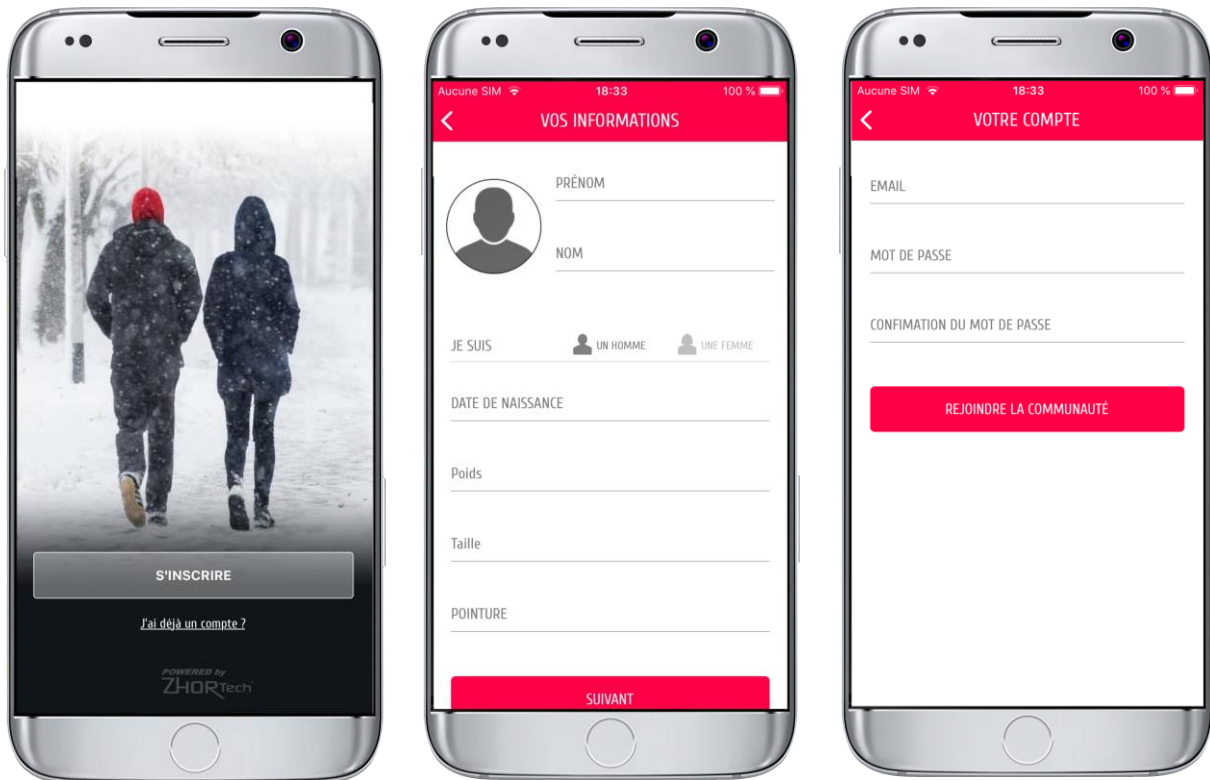

## Privacy Policy



You must read and accept our Privacy Policy before continuing.



## Connect your insoles to the app

To connect your heating insoles, make sure they are fully charged: when the red light is off, the insoles are fully charged, with an average battery life of eight hours.

Carefully follow the instructions provided by the app:

- Choose your insole type, V4/V5 or V6/V7
- Turn on your Bluetooth
- Activate location tracking
- Connect your insoles
  - If you have selected V6/V7 insoles, you can simply scan the QR code.
  - If you have selected V4/V5 insoles, you will need to plug in your insoles, click on next, unplug them and then click on connect.

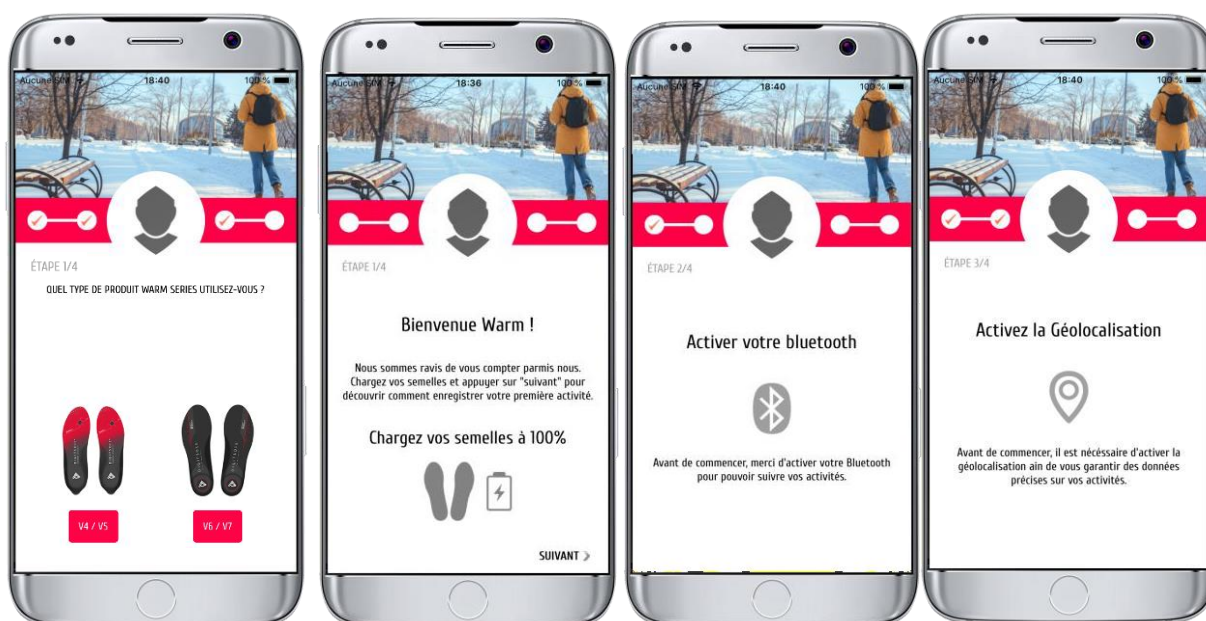

## Adjust the temperature of your insoles



To adjust the temperature of your insoles, click on "ON".

The remaining battery life for each of your insoles is displayed at the bottom of the screen.



You can then set the temperature, within the range of 25 °C to 45 °C, by clicking on the slider.

You can stop the heating by clicking on "STOP".



### **Timer (v7 only)**

If you have V7s, you can activate and deactivate the timer by clicking on the "ON/OFF" button.

Once activated, the insoles will heat up until the timer runs out.

## **Live and history**

### **Start a new walking activity**

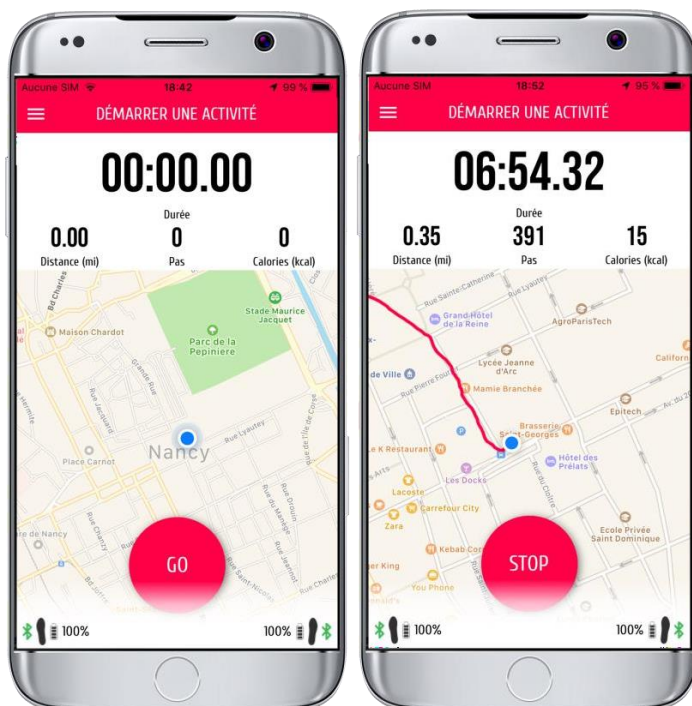

To start a new activity, your insoles must be linked to the app.

Click on "GO" to start a new session.

Click on "STOP" to end your session and check your session statistics.

If, during your activity, the insoles become disconnected from the phone, the activity will still continue to be analysed.

The insoles will automatically reconnect when you press "STOP" to stop the activity.

## Session history

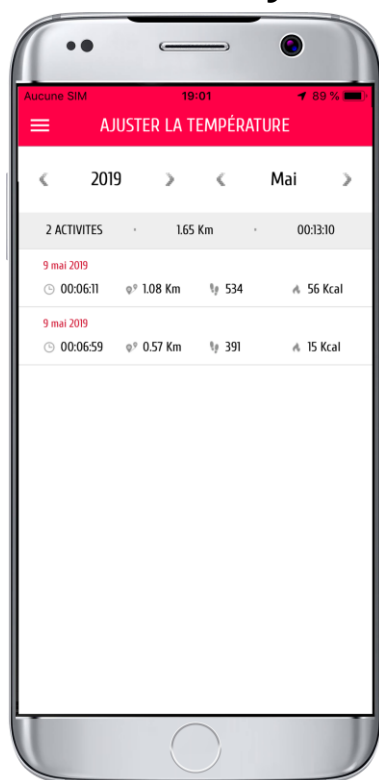

Automatically access all your activity history in the History tab.

Then select the activity you wish to view at the bottom of the screen. This tab allows you to compare all your activities by month.

## Application settings

The "Settings" tab allows you to see more information about the app and the insoles.

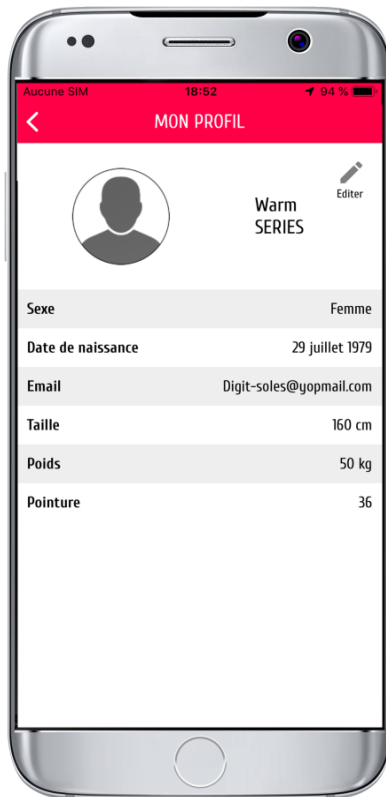

### My profile

On the "My profile" icon, you can:

- Add a profile photo,
- Adjust your height,
- Adjust your weight,
- Adjust your shoe size.



## My insoles

By clicking on "My Insoles", you can delete your insoles if you want to replace them with another pair.

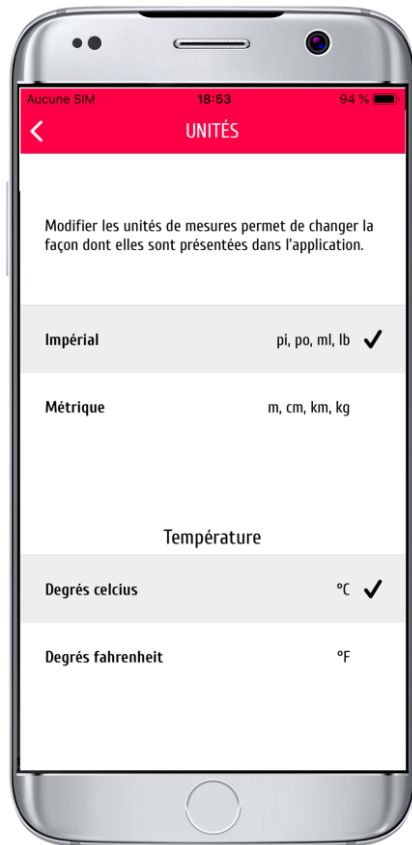

## Units

By clicking on the "Units" icon, you can set the units of measurement by clicking on "Imperial" or "Metric" and the temperature unit by clicking on "Celsius" or "Fahrenheit".

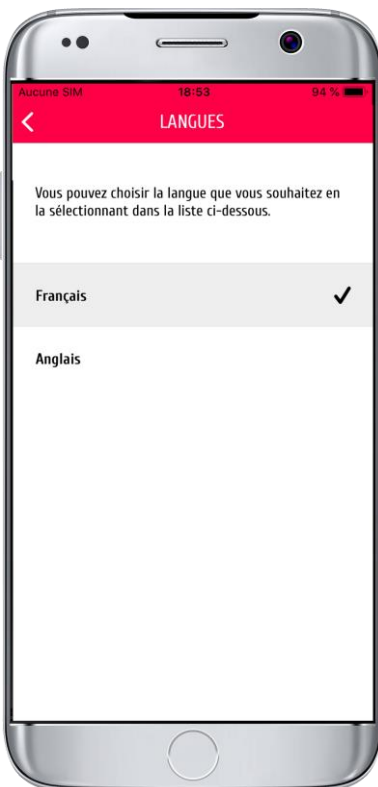

## Languages

By clicking on "Language" you can change the language of the app.



## Version

By clicking on "Version" you can access information about your insoles and your phone.

## Terms of Use and Privacy Policy

When you click on the "Terms of Use" or "Privacy Policy" tab, you will be automatically redirected to the dedicated web pages.



## Contact us

By clicking on "Contact us", you can directly access the information necessary in order to contact the customer services team.





## Log out

When you click on "Log out", you will log out of the app.

## Specifications of the insole battery

	Warm V4	Warm V5	Warm V6	Warm V7
Battery type	Rechargeable Lithium-ion Polymer		Rechargeable Lithium Ceramic Battery	
Type of connector	USB			
Capacity	EU size 34 to 41: 1500 mAh EU size 42 to 47: 2150 mAh	1300 mAh	1450 mAh	
Operating voltage	3.8 V		3.75 V	
Energy	EU size 34 to 41: 5.7 Wh EU size 42 to 47: 8.2 Wh	4.9 Wh	5.4 Wh	
Battery power	Lithium-ion Polymer		Lithium Ceramic	
Charging time	Approximately 2.5 hours			
Heating power	2.2 W			2.4 W

**You must not:**

- Dismantle the insoles
- Bring them into contact with fire
- Submerge them in a liquid
- Use them if the batteries are damaged
- Replace the battery

## Radio module

Frequency band: 2400–2483.5 MHz

Max power: 10 mW

	Warm V4	Warm V5	Warm V6	Warm V7
Frequency band	2400–2483.5 MHz			
Maximum power	10 mW			

## Product maintenance

### Recycling of insoles

Lithium-ion batteries are subject to recycling regulations that vary by country and region. In the interest of responsible environmental practices, please check the regulations in your area before disposing of these insoles. Use the collection and recycling system for waste electrical and electronic equipment where you live (e.g. drop it off at your local special waste collection centre, in the container for electronic waste).

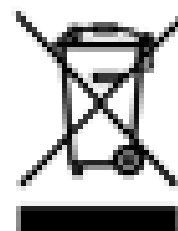

## Declaration of conformity

You can find the declaration of conformity for the United States (FCC), Canada (IC) and the European Union (EU) by following this link: <https://www.digitsole.com/safety-instructions>

## CE

- CE Directive 2014/53/EU of the European Parliament and of the Council of 16 April 2014 on the harmonisation of the laws of Member States relating to the making available on the market of radio equipment (RED).
- Directive 2011/65/EU of the European Parliament and of the Council of 8 June 2011 on the restriction of the use of certain hazardous substances (ROHS) in electrical and electronic equipment.
- Directive 2012/19/EU of the European Parliament and of the Council of 4 July 2012 on waste electrical and electronic equipment (WEEE)
- EMC Directive 2014/30/EU