

Boom! Audio HD-N01 10R Quick Start Guide

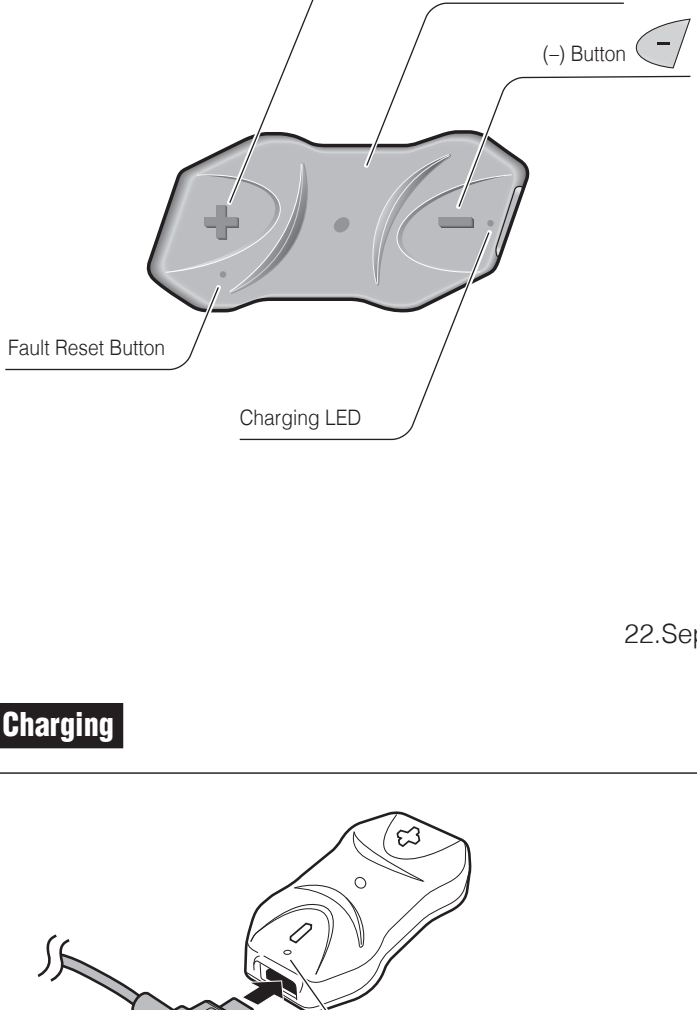

1

22.Sep

Charging

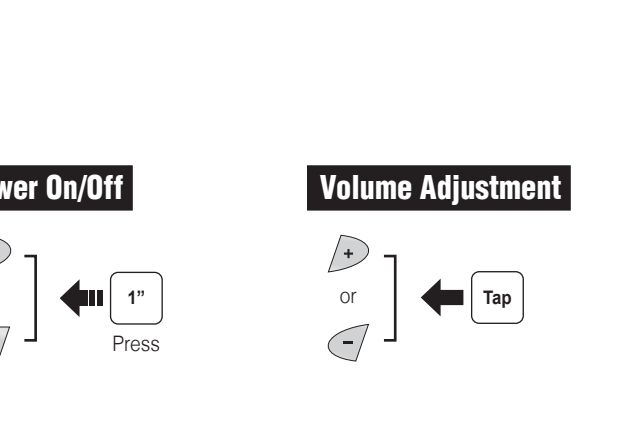

Button Operation

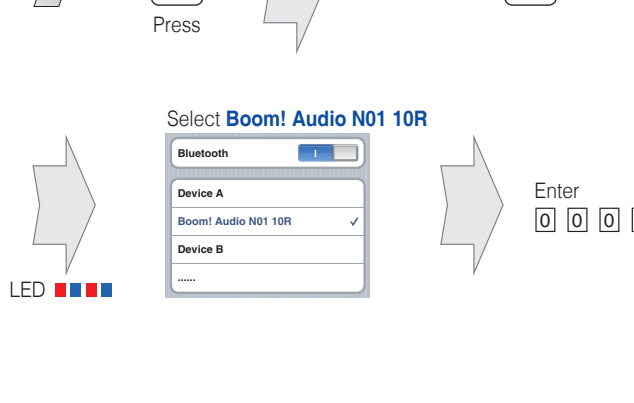

2

Power On/Off

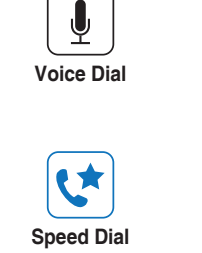

Volume Adjustment

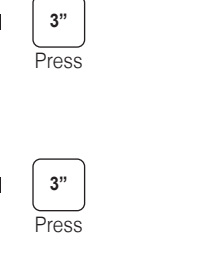

Bluetooth Pairing Phone, MP3 and GPS

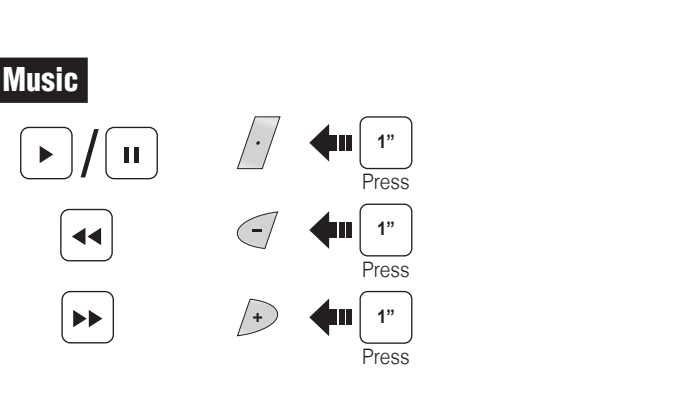

3

Mobile Phone

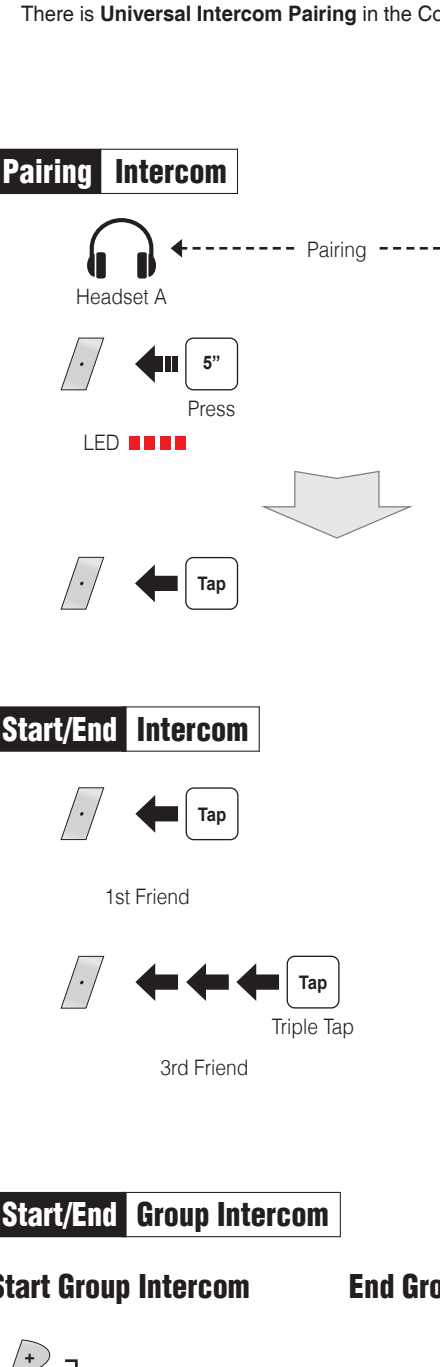

4

Music

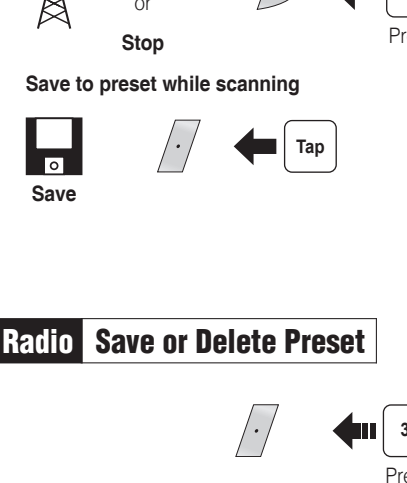

Battery Check

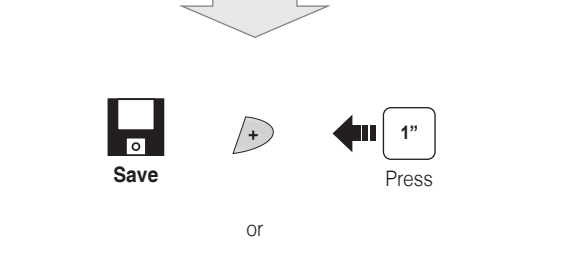

Configuration Menu

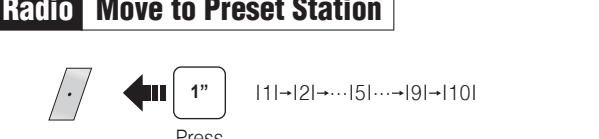

There is Universal Intercom Pairing in the Configuration Menu.

5

Pairing Intercom

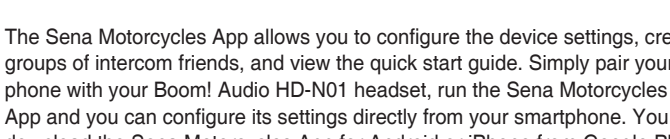

Start/End Intercom

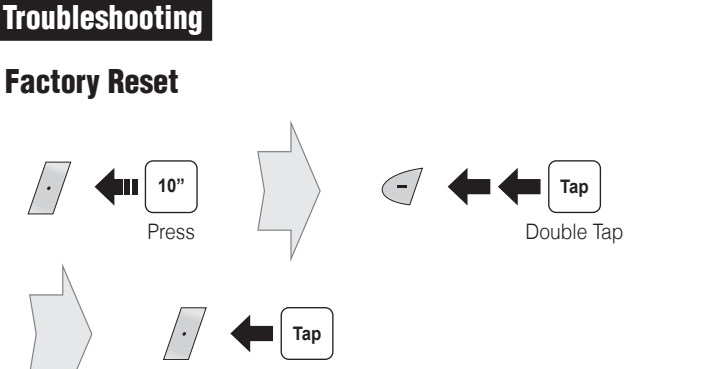

6

Start/End Group Intercom

Start Group Intercom

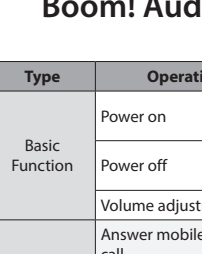

End Group Intercom

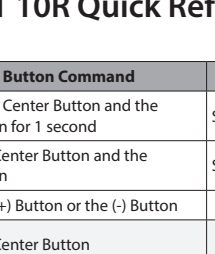

Radio On/Off

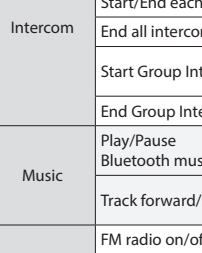

Radio Seek Stations

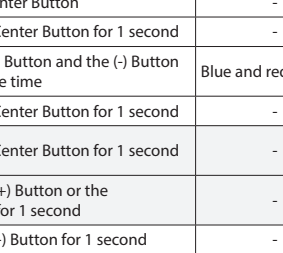

Radio Scan Up FM Band



Radio Save or Delete Preset

8

Radio Move to Preset Station

Setting

Using the Boom Audio Bluetooth Device Manager

The Device Manager allows you to upgrade the firmware and configure the device settings directly from your PC. Using this software, you can assign speed dial presets, FM radio frequency presets and more. It is available to download for both Windows and Mac. For more information on downloading the Device Manager, please visit www.H-D.com/infotainment-support.

Using the Sena Motorcycles App

The Sena Motorcycles App allows you to configure the device settings, create groups of intercom friends, and view the quick start guide. Simply pair your phone with your Boom! Audio HD-N01 headset, run the Sena Motorcycles App and you can configure its settings directly from your smartphone. You can download the Sena Motorcycles App for Android or iPhone from Google Play Store or App Store.

9

Troubleshooting

Factory Reset

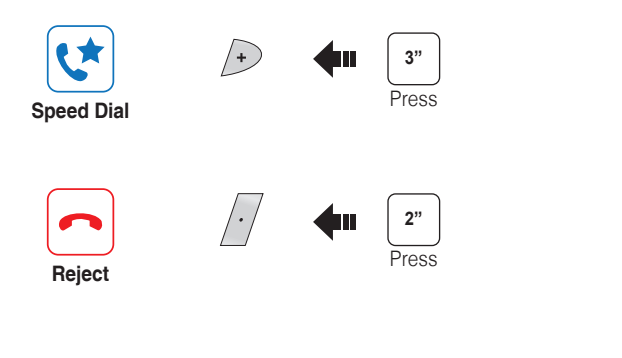

Fault Reset

If the Boom! Audio HD-N01 headset is not working properly for any reason, reset by gently pushing the pin-hole reset button located below the (+) button.

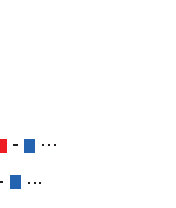

Customer Support:
www.H-D.com/infotainment-support

Boom! Audio HD-N01 10R Quick Reference

Type	Operation	Button Command	LED
Basic Function	Power on	Press the Center Button and the (+) Button for 1 second	Solid blue
	Power off	Tap the Center Button and the (-) Button	Solid red
	Volume adjustment	Tap the (+) Button or the (-) Button	-
Mobile Phone	Answer mobile phone call	Tap the Center Button	-
	End mobile phone call	Press the Center Button for 2 seconds	-
	Voice dial	Press the Center Button for 3 seconds	-
	Speed dial	Press the (+) Button for 3 seconds	-
Intercom	Reject incoming call	Press the Center Button for 2 seconds	-
	Intercom pairing	Press the Center Button for 5 seconds	Blue flashing
	Start/End each intercom	Tap the Center Button of any one of the two headsets	-
	End all intercoms	Press the Center Button for 1 second	-
Music	Start Group Intercom	Tap the (+) Button and the (-) Button at the same time	Blue and red flashing
	End Group Intercom	Press the Center Button for 1 second	-
FM Radio	Play/Pause Bluetooth music	Press the Center Button for 1 second	-
	Track forward/back	Press the (+) Button or the (-) Button for 1 second	-
	FM radio on/off	Press the (-) Button for 1 second	-
	Select preset	Press the Center Button for 1 second	-
	Seek stations	Double tap the (+) Button or the (-) Button	-
	Scan up FM band	Press the (+) Button for 1 second	-
	Stop scanning	Press the (+) Button for 1 second	-
	Save preset while scanning	Tap the Center Button	-



www.H-D.com/infotainment-support

22.Sep