



# MODERN EMBER

## Aerus Slim

Linear Electric Fireplace



36" / 42" / 50" / 60" / 72" Wall Mounted / Built-in Electric Fireplace

Model: ☐ ME-AER36-SLIM    ☐ ME-AER42-SLIM    ☐ ME-AER50-SLIM  
☐ ME-AER60-SLIM    ☐ ME-AER72-SLIM

## OWNER'S MANUAL

**AC 120V 60Hz 1465W (5000 BTUs)**

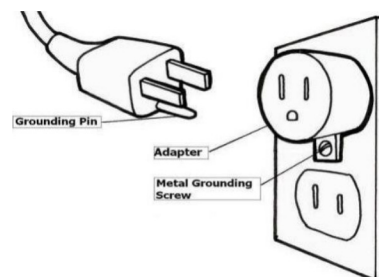
# Important Safety Instructions

**Read and understand** this entire owner's manual, including **all safety information**, before **plugging in** or **using** this product. Failure to do so could result in **fire, electric shock, or serious personal injury**.

## ⚠ WARNING

**Use this heater only as described in this manual. Any other use not recommended by the manufacturer may cause fire, electric shock, or injury to persons.**

- **This electric fireplace has a remote that requires a button battery that is hazardous to young children.**
- **DO NOT** let bare skin touch hot surfaces. This heater is hot when in use. To avoid burns, if provided, use handles when moving this heater. **KEEP** combustible materials, such as furniture, pillows, bedding, papers, clothes, and curtains at least 3 feet (0.9m) from the front of the heater, and keep them away from the sides and rear.
- **EXTREME CAUTION** is necessary when any heater is used by or near children or invalids and whenever the heater is left operating and unattended.
- **DO NOT** operate any heater with a damaged cord or plug, after it has malfunctioned, or if it has been dropped or damaged in any manner. Discard the heater or return it to an authorized service facility for examination and/or repair.
- **DO NOT** run power cord under carpeting. **DO NOT** cover power cord with throw rugs, runners, or similar coverings. **DO NOT** route power cord under furniture or appliances. Arrange power cord away from traffic area, and where it will not be tripped over.
- **CONNECT** to properly grounded outlets **ONLY**.
- **DO NOT** insert or allow foreign objects to enter any ventilation or exhaust opening, as this may cause electric shock or fire, or damage the heater.
- To prevent a possible fire, **DO NOT** block air intakes or exhaust in any manner. Doing so could cause a fire.
- **DO NOT** use on soft surfaces, like a bed, where openings may become blocked.
- **DO NOT** use it in areas where gasoline, paint, or flammable liquids are used or stored as heater has hot and arcing or sparking parts inside.
- **ALWAYS** plug heaters directly into a wall outlet/receptacle. **NEVER** use with an extension cord or relocatable power tap (outlet/power strip).
- **DO NOT** place the heater near a bed because objects such as pillows or blankets can fall off the bed and be ignited by the heater.
- **NEVER** use this heater in bathrooms, laundry rooms, or any other location where the heater could fall into a bathtub or pool, become damp, or come in contact with water.
- **AVOID FIRE!** Regularly inspect all air vents to make sure they are free from dust, lint, or other blockage. Unplug the unit and clean with a vacuum **ONLY**. **DO NOT** rinse or get wet.
- **ALWAYS** mount to wall bracket before use. **DO NOT** set on the floor, or other surface, to use.
- **NEVER** use a wall mount bracket from another manufacturer.
- This product is not intended to be a primary heat source. It is for supplemental heat only.
- **INDOOR** use only! **NEVER** use this heater outdoors! Doing so may result in electric shock!
- Risk of electric shock! **DO NOT OPEN!** No user-serviceable parts inside!
- **ALWAYS** turn this heater off before unplugging it from the outlet.
- **ALWAYS** disconnect this unit from the power supply before performing any assembly or cleaning, or before relocating the electric fireplace.
- **NEVER** leave this heater unattended. **ALWAYS** unplug this heater when not in use.
- **ALWAYS** store this heater in a dry location. **NEVER** use the fireplace if it has become wet.
- **NEVER** plug this heater into an outlet that is old, cracked, or has any loose wires or connections. Plugging this heater into a faulty outlet could result in electric arcing within the outlet that could cause the outlet to overheat or catch fire.
- **ALWAYS** check your heater cord and plug connections with each use!
  - i. **MAKE SURE** the plug fits tight in the outlet. Faulty wall outlet connections or loose plugs can cause the outlet to overheat.
  - ii. Heaters draw more current than small appliances. Overheating may occur even if it has not occurred with the use of other appliances.
  - iii. During use, check frequently to see if the plug outlet or face plate is **HOT**.
  - iv. If the outlet or face plate is **HOT**, discontinue use immediately and have a qualified electrician inspect and/or replace the faulty outlets.
- The power cord supplied with the heater has three prongs: two flat blades (live and neutral) and one round pin (ground). If a 3-slot receptacle is not available, an adapter **MUST** be used. The adapter **MUST** be properly grounded to the outlet box (see figure below). [NOTE: Adapter NOT INCLUDED.]



**SAVE THESE INSTRUCTIONS FOR FUTURE USE.**

# Preparation

## ⚠ CAUTION

This product includes a **GLASS** panel! **ALWAYS USE EXTREME CAUTION** when handling glass. **FAILURE** to do so could result in personal injury or property damage.

- Remove all parts and hardware from the carton and place them on a clean, soft, dry surface.
- Parts and assembly steps are grouped for wall-hanging or recessing use.
- Check the parts list to make sure nothing is missing.
- Dispose of packaging materials properly. Please recycle whenever possible.

# Tools

## YOU WILL NEED THE FOLLOWING TOOLS

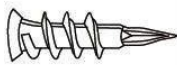
(NOT INCLUDED):

- **Phillips Screwdriver**
- **Electric Drill**
- **Stud Finder**
- **1/4" Wood Drill Bit**
- **Level**
- **Hammer**
- **Tape Measure**

# Parts & Hardware



**A - Fireplace**



**C - Drywall Anchors**



**E - Decorative Crystals**



**G - Screw Covers**



**I - Strain Relief**



**B - Wood Screws**



**D - Wall Bracket**

*Fixed on back of fireplace*



**F - Remote Control**

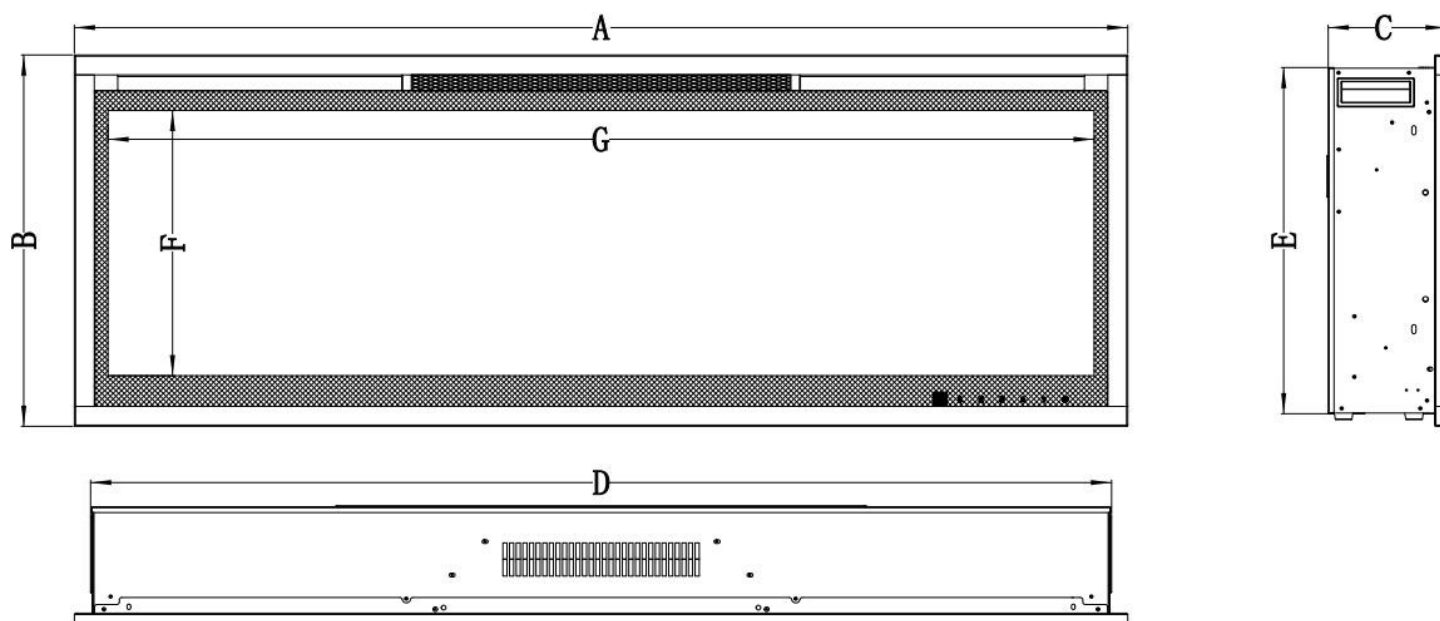


**H - Driftwood Logs**



**J - Cover Plate**

# Specifications & Dimensions



**NOTE:** Measurements are taken from the glass front

		MODEL NUMBER				
PRODUCT DIMENSION		AER36-SLIM	AER42-SLIM	AER50-SLIM	AER60-SLIM	AER72-SLIM
	A	36" [915mm]	42" [1067mm]	50" [1271mm]	60" [1525mm]	72" [1830mm]
	B	17-5/8" [448mm]				
	C	4- 1/4" [108mm]				
	D	34-1/2" [876mm]	40-1/2" [1028mm]	48- 1/2" [1232mm]	58- 1/2" [1486mm]	70- 1/2" [1791mm]
	E	16- 1/2" [418mm]				
	F	12-5/8" [320mm]				
	G	32-7/8" [834mm]	38-7/8" [986mm]	46-7/8" [1190mm]	56-7/8" [1444mm]	68-7/8" [1749mm]

# Installation & Assembly

Your appliance is a wall-mounted, recessed and/or mantel installed appliance. Select a suitable location that is not susceptible to moisture and is away from drapes, furniture and high traffic areas.

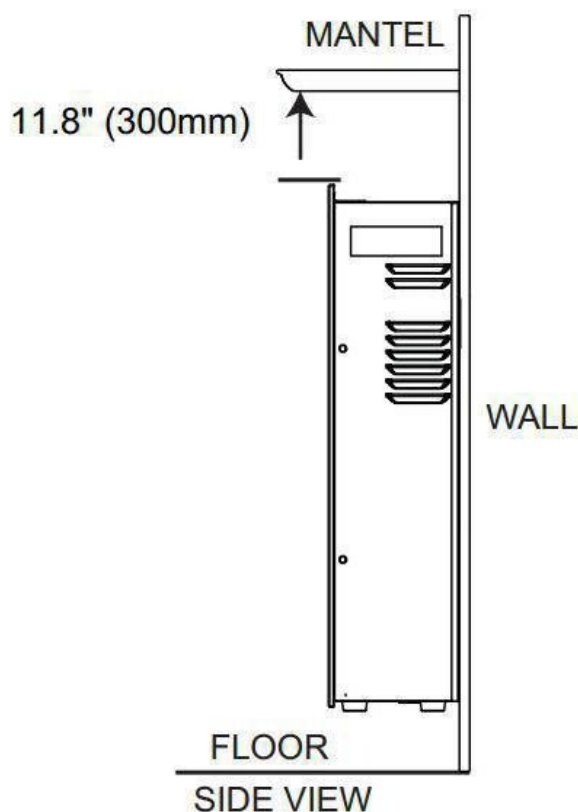
**NOTE:** Follow all National and local electrical codes.

## MINIMUM CLEARANCE TO COMBUSTIBLES

**NOTE:** Measurements are taken from the glass front.

<b>Bottom</b>	0" (0mm)
<b>Sides</b>	0" (0mm)
<b>Back</b>	0" (0mm)
<b>Top</b>	11.8" (300mm) to mantel/ceiling

## MINIMUM MANTEL CLEARANCES



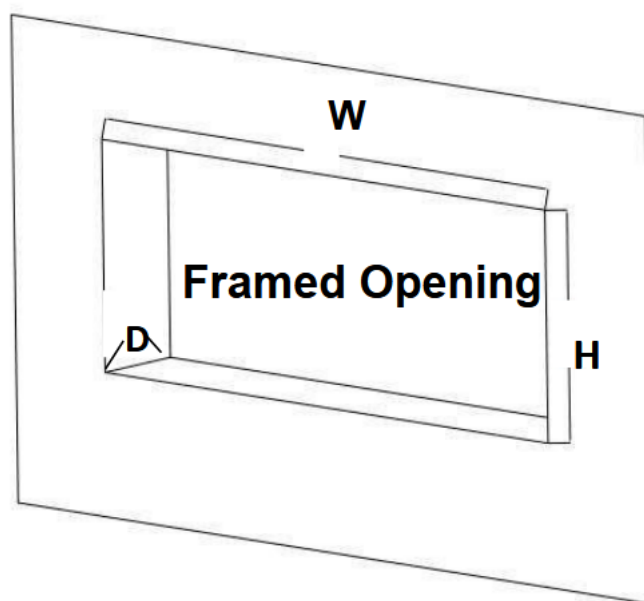
### ⚠ WARNING

When using paint or lacquer to finish the mantel, the paint or lacquer must be heat resistant to prevent discoloration.

## RECESSED INSTALLATION

### STEP 1:

Prepare a wall with framed opening dimensions (Figure A) listed in the chart below.



**Figure A**

FRAMED OPENING SIZE			
Model	W	H	D
<b>ME-AER36-SLIM</b>	34- 3/4" [884mm]	16- 3/4" [426mm]	4" [102mm]
<b>ME-AER42-SLIM</b>	40- 3/4" [1036mm]		
<b>ME-AER50-SLIM</b>	48- 3/4" [1238mm]		
<b>ME-AER60-SLIM</b>	58- 3/4" [1492mm]		
<b>ME-AER72-SLIM</b>	70- 3/4" [1778mm]		

# Installation & Assembly

## RECESSED INSTALLATION

### STEP 2:

Install the wall anchors in each side of the framed opening according to the dimensions in **Figure B**.

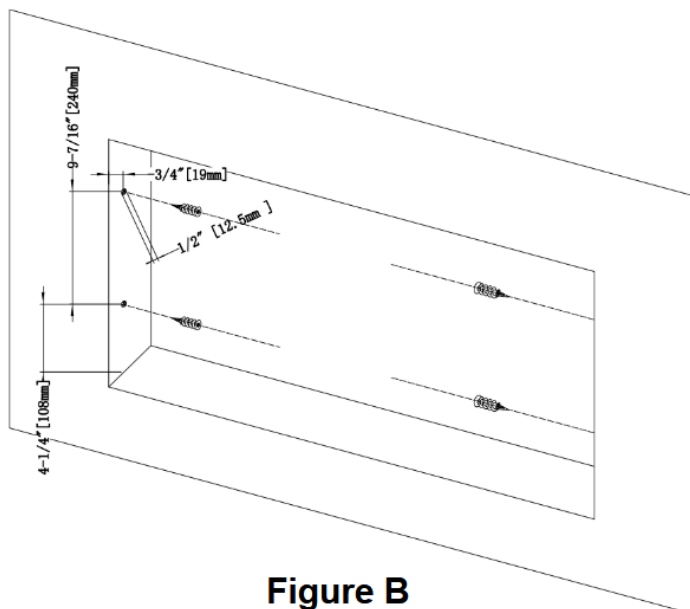


Figure B

### STEP 3:

Remove the screws from each side of the glass panel as shown in **Figure C**.

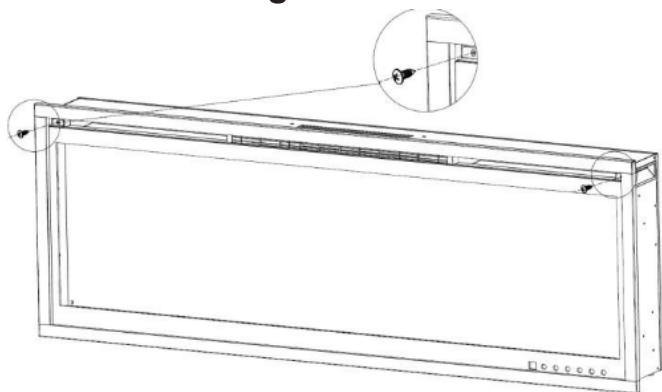


Figure C

### STEP 4:

**WARNING!** It is highly recommended that two people complete this step.

Remove the glass panel from the front of the fireplace (**Figure D**).

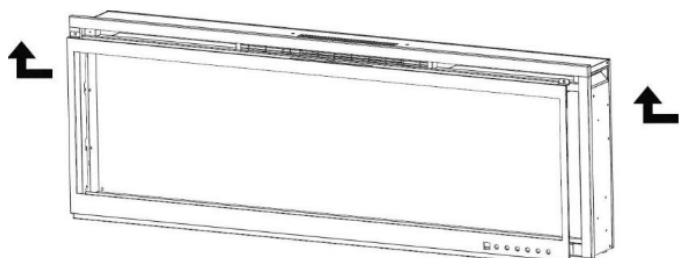


Figure D

### STEP 5:

Remove the two screws from each side (**Figure E**). Then, remove the two metal brackets from each side (**Figure F**).

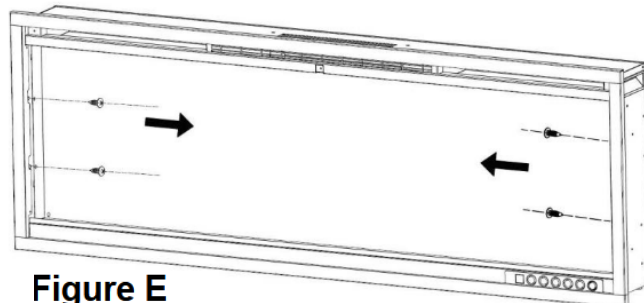


Figure E

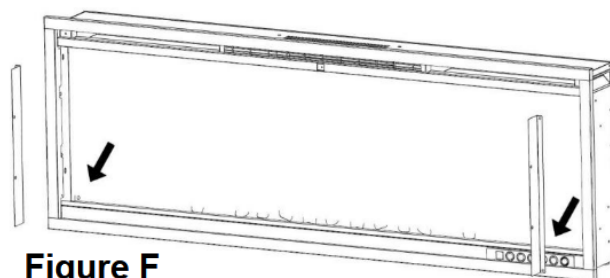


Figure F

### STEP 6:

**WARNING!** It is highly recommended that two people complete this step.

Lift the fireplace and insert into the framed opening. Use your bubble level to level the fireplace within the framing and adjust as needed. Drive four screws through the mounting holes located on each side as shown in **Figure G**. Install the media and re-install the glass panel (**Figure H**).

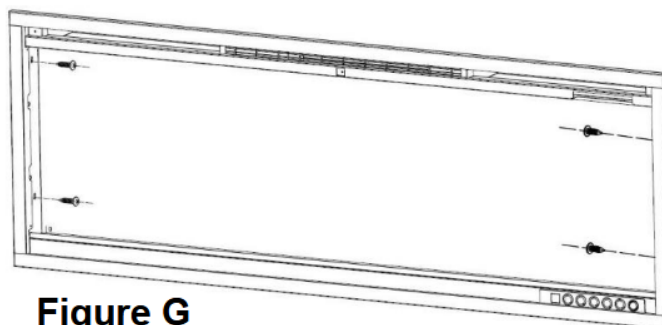


Figure G

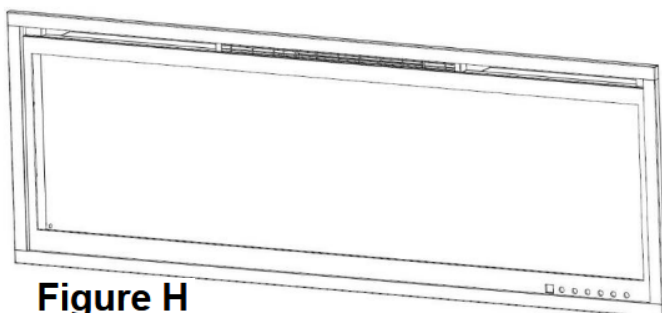


Figure H



# Installation & Assembly

## WALL MOUNTED INSTALLATION

Due to the many different materials used on different walls, it is highly recommended that you consult your local builder before you install this appliance on the wall.

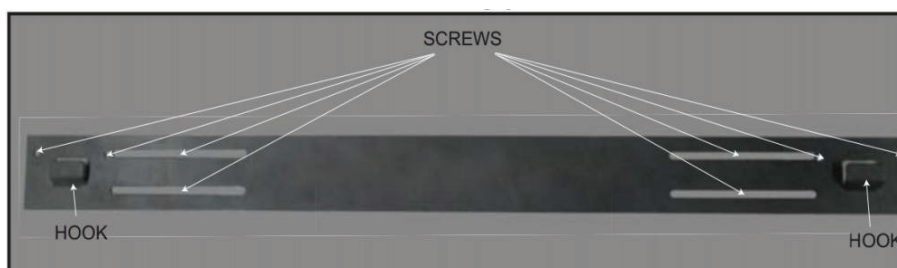
**Step 1:** Select a location that is not prone to moisture and is located at least 36" (914mm) away from combustible materials, such as curtains, drapes, furniture, bedding, paper, etc.

**Step 2:** Have two people position the appliance against the wall where it will be mounted. Use a bubble level to ensure the fireplace is level on the wall. Mark the location.

**Step 3:** Place the unit face down on a soft, non-abrasive surface. Remove the bracket from the back of the unit by removing the screws as shown in **Figure I**.

**Step 4: CAUTION!** It is highly recommended that the mounting bracket be screwed into wall studs whenever possible. If wall studs cannot be used, ensure that the supplied plastic anchors are used to affix the bracket to the wall and that the bracket is adequately secured.

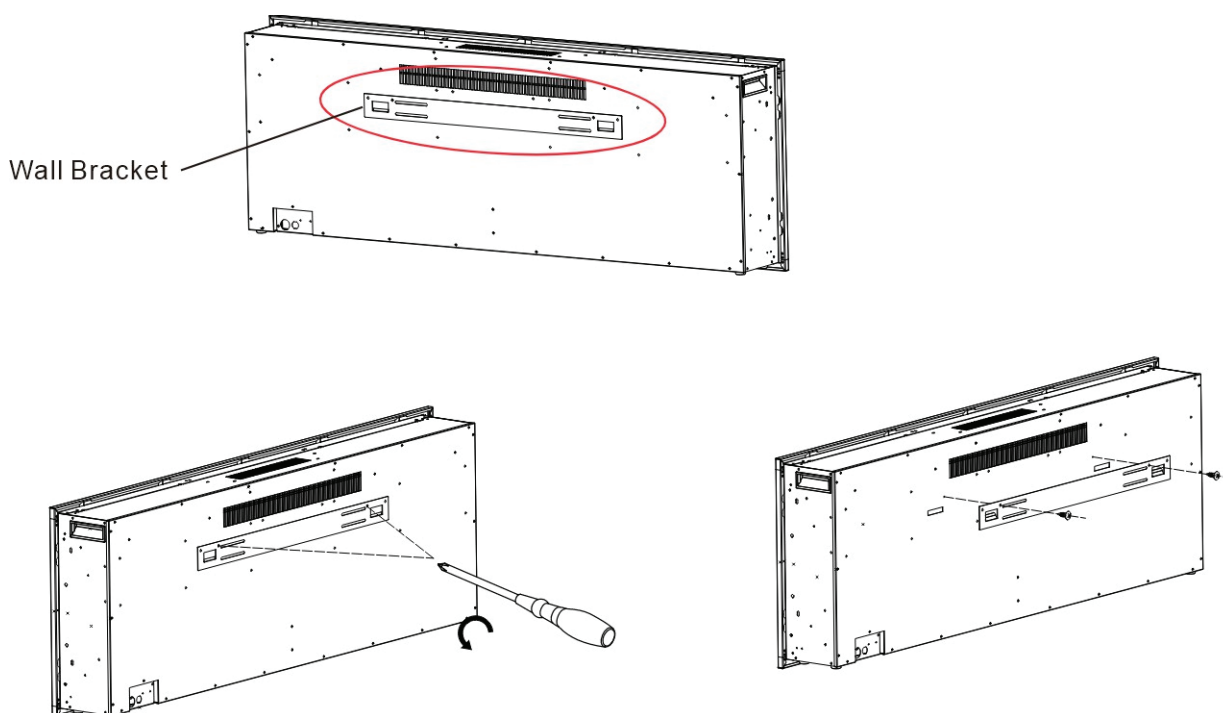
Mark the location of the screw locations on the wall. Then mount the bracket on the wall using the supplied screws. The bracket **must** have the hooks facing upward and be level.



**Figure I**

**Step 5:** With the wall mounting bracket installed, have two people lift the appliance and insert the two hooks on the bracket into the two slots on the back of the fireplace.

**Step 6:** Check the fireplace for stability, ensuring that the bracket will not pull free from the wall.



Wall Bracket Illustrated

# Installation & Assembly

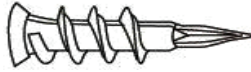
## “L” SHAPE BRACKET INSTALLATION

### Only Used For Wall Mounted Installation



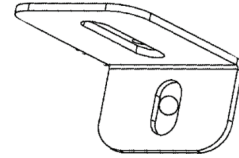
x1

Screw



x1

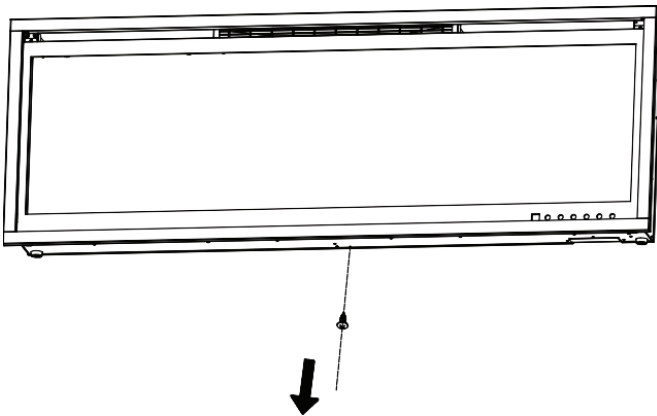
Drywall Anchor



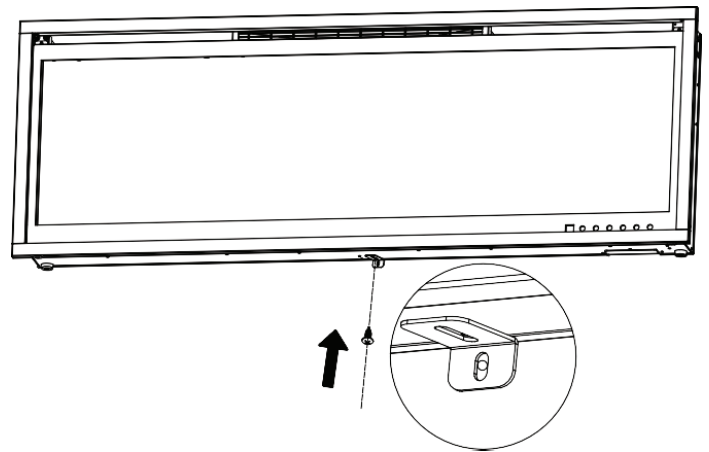
x1

= Shape Bracket

**Step 1.** Remove the silver screw at the bottom of the appliance. Set the screw aside. **Fig 1-1**

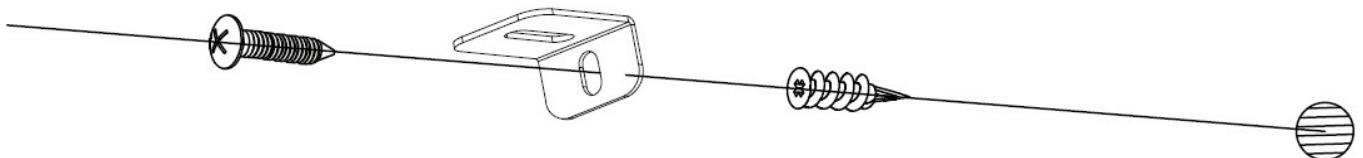


**Fig 1-1**



**Fig 1-2**

**Step 2.** Using the screw previously removed, attach the L-bracket (supplied) to the bottom of the fireplace box. **Fig 1-2**



**Fig 1-3**

**Step 3.** Install the plastic anchor (B) into the drywall, then install the screw A (supplied) into the hole of the L-bracket into the wall anchor to secure the fireplace from coming off the bracket. **Fig 1-3**



# Installation & Assembly

## HARD-WIRING INSTALLATION

### **! WARNING**

Turn off the appliance completely and let it cool down before servicing. Only a qualified service person should service and repair this electric appliance.

#### **Hard-Wiring Connection**

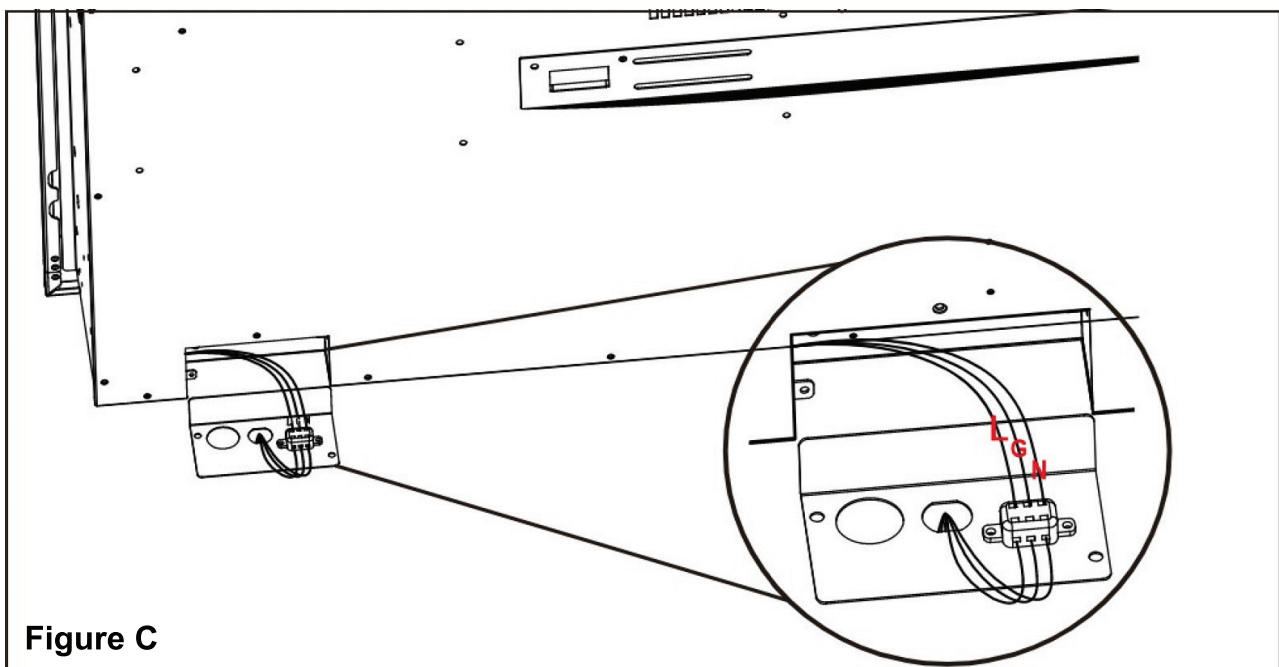
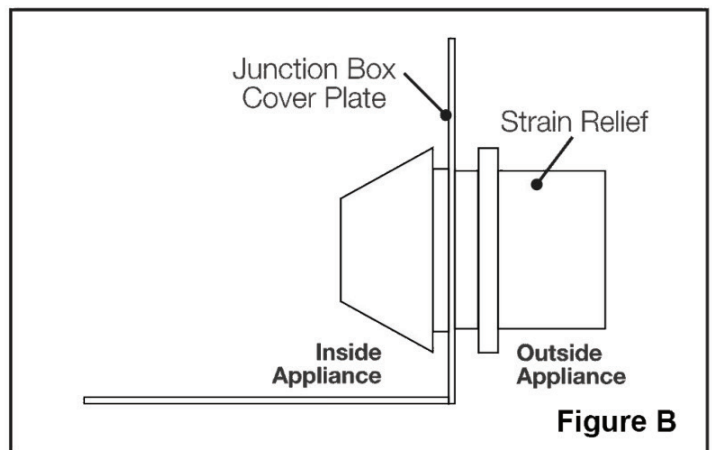
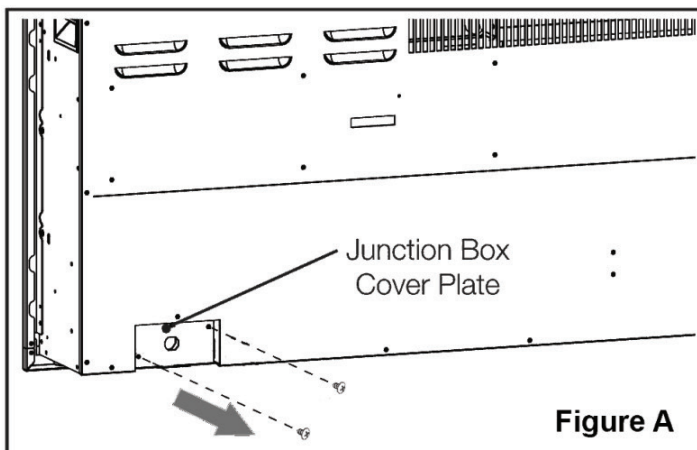
If it is necessary to hard-wire this appliance, a qualified electrician must remove the cord connection and wire the appliance directly to the household wiring. The dedicated circuit and power supply breaker must be rated for 120V, minimum 15 amps.

The appliance must be electrically connected and grounded in accordance with local codes. In the absence of local codes, use the current CSA C22.1 Canadian Electrical Code in Canada or the current ANSI/NFPA 70 National Electrical Code in the United States.

### **NOTICE**

There are 3 wires from the appliance junction: white (neutral), black (power L1), and red (ground) that connect to 120V power supply (break panel). See below.

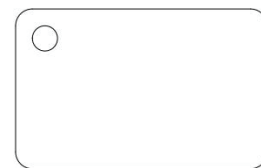
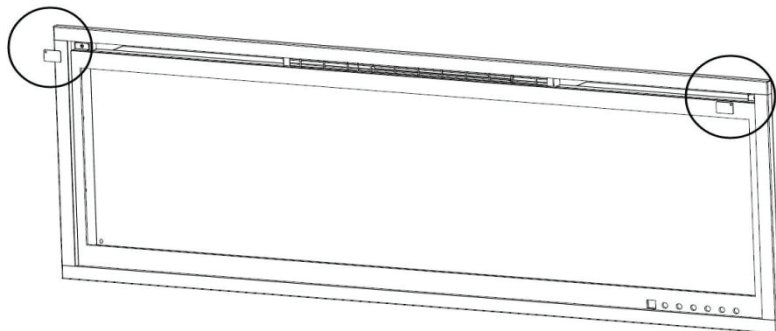
1. Remove the 2 securing screws from the junction box cover plate, located on the bottom left hand side of the appliance (**Figure A**).
2. Install the strain relief to the junction box cover plate (located in hardware bag) (**Figure B**).
3. Remove all the wires, and take out the existing cable plug. The power cord may be discarded.
4. Take new cover plate supplied in the hardware bag and punch out the 7/8" (22.2mm) hole. Feed wires through box connector. Connect the three wires (from outside) appropriately to the terminal connectors (Red (G) is ground, White (N) is neutral, and Black (L) is the hot/line connection (**Figure C**).
5. Resecure the junction box cover plate using the 2 screws previously removed in step 1.



# Installation & Assembly

## METAL SCREW COVER INSTALLATION

Place the two metal covers over the screws. Pre-installed magnets in the fireplace will keep the covers secure.



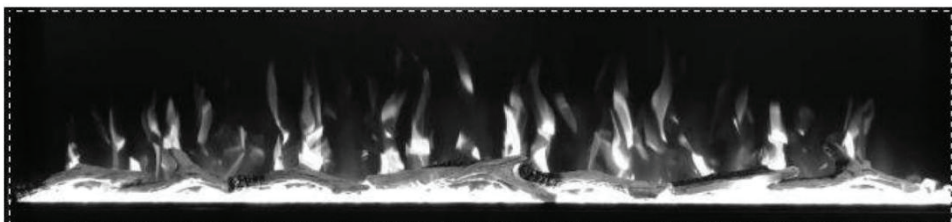
Screw Cover

## CRYSTAL / DRIFTWOOD LOGS INSTALLATION

- Glass front must be removed and the appliance must be mounted in its final location before the crystal embers are installed.
- Carefully place small crystal embers into the strip as shown in **Figure J**. Apply an even layer from side to side.
- Randomly place the driftwood logs on top of the crystals as shown in **Figure K**.



**Figure J** (Crystals)



**Figure K** (Driftwood Logs)

## Operation



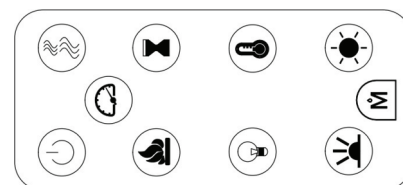
**Read and understand** this entire owner's manual, including **all safety information**, before plugging in or **using** this product. Failure to do so could result in **electric shock**, **fire**, **serious injury**, or **death**.

## POWER

Plug the power cord into an AC 120 Volt outlet (see **IMPORTANT SAFETY INFORMATION** on Page 2). Make sure the outlet is in good condition and that the plug is not loose. **NEVER** exceed the maximum amperage for the circuit. **DO NOT** plug other appliances into the same circuit.






# Methods of Operation

This electric fireplace can be operated by the CONTROL PANEL, or by the battery-powered REMOTE CONTROL. Before operating, please review the **IMPORTANT SAFETY INFORMATION** on Page 2, and heed all warnings.







Remote Control

## REMOTE CONTROL / CONTROL PANEL OPERATIONS

BUTTON	FUNCTION	ACTION & INDICATION
 <b>POWER</b>	<b>ON:</b> Enables control panel functions and remote control. Turns on flame effect. <b>OFF:</b> Disables control panel functions and remote control. Turns off flame effect.	1. <b>Press once.</b> Indicator light turns on. Power turns on. All functions enabled. 2. <b>Press again.</b> Flame effect turns off. Unit goes to standby. All functions turn off.
 <b>TIMER</b>	<b>TIMER button:</b> Controls timer settings to turn off fireplace at selected time. Settings range from 0.5 hours to 8 hours.	1. <b>Press once.</b> Indicator light turns on. Timer is set to 0.5 hours. 2. <b>Press again until desired setting is reached.</b> Indicator lights show setting.
 <b>FLAME</b>	<b>FLAME button:</b> Makes flame effect dimmer and brighter. <b>NOTE:</b> Flame effect stays on until power button is turned off. Flame effect must be on for fireplace to turn on.	1. <b>Press once.</b> Flame brightness effect starts changing. 2. <b>Press again</b> until desired setting is reached.
 <b>COLOR</b>	<b>COLOR button:</b> Makes the flame effect change colors. <b>NOTE:</b> Color effect stays on until power button is turned off. Color flame effect must be on for fireplace to turn on.	1. <b>Press once.</b> Flame color effect starts changing. 2. <b>Press again</b> until desired setting is reached. There is a total of 6 flame colors.
 <b>HEATER</b>	<b>HEATER button:</b> Turns heater on and off. <b>NOTE:</b> The heater only works when the flame effect is on. If the flame effect is off, the heater will not turn on. <b>Heater button can be locked or unlocked by holding the Heater button for 5 seconds.</b> <b>NOTE:</b> To prevent overheating, the heater blows cool air for 10 seconds.	

# Methods of Operation

## REMOTE CONTROL / CONTROL PANEL OPERATIONS (CONT.)

<div></div> <div>TEMP</div>	<p><b>Temperature button:</b> Changes the temperature settings.</p> <p>1. <b>Press once.</b> Touch panel indicator becomes active.</p> <p>2. <b>Press again</b> until desired setting is reached. Digital display shows setting as below.</p> <table><tr><td>Display Value</td><td>NO</td><td>0</td><td>1</td><td>2</td><td>3</td><td>4</td><td>5</td><td>6</td><td>7</td><td>8</td><td>9</td><td>10</td><td>11</td><td>12</td><td>NO</td></tr><tr><td rowspan="2">Temperature</td><td>C°</td><td>18</td><td>19</td><td>20</td><td>21</td><td>22</td><td>23</td><td>24</td><td>25</td><td>26</td><td>27</td><td>28</td><td>29</td><td>30</td><td>C°</td></tr><tr><td>F°</td><td>64</td><td>66</td><td>68</td><td>70</td><td>72</td><td>74</td><td>76</td><td>78</td><td>80</td><td>82</td><td>84</td><td>86</td><td>88</td><td>F°</td></tr></table> <p><b>NOTE:</b> Press the button for 5 seconds to switch between °C and °F.</p>		Display Value	NO	0	1	2	3	4	5	6	7	8	9	10	11	12	NO	Temperature	C°	18	19	20	21	22	23	24	25	26	27	28	29	30	C°	F°	64	66	68	70	72	74	76	78	80	82	84	86	88	F°
Display Value	NO	0	1	2	3	4	5	6	7	8	9	10	11	12	NO																																		
Temperature	C°	18	19	20	21	22	23	24	25	26	27	28	29	30	C°																																		
	F°	64	66	68	70	72	74	76	78	80	82	84	86	88	F°																																		
<div></div> <div>EMBER LIGHT</div>	<p><b>LED ember light button:</b> Makes the ember bed light change colors.</p> <p><b>NOTE:</b> Ember bed color effect stays on until power button is turned off.</p>	<p>1. <b>Press once.</b> Ember bed color effect starts changing.</p> <p>2. <b>Press again</b> until desired setting is reached. There is a total of 10 ember bed colors.</p>																																															
<div></div> <div>EMBER BED BRIGHTNESS</div>	<p><b>LED ember bed brightness button:</b> Makes the ember bed brighter or dimmer.</p>	<p>1. <b>Press once.</b> Ember bed color brightness starts changing.</p> <p>2. <b>Press again</b> until desired setting is reached.</p>																																															
<div></div> <div>SPEED</div>	<p><b>Flame speed button:</b> Controls the speed of the flame. There are 3 flame speed settings: 01 (slow), 02 (medium), and 03 (fast).</p>	<p>1. <b>Press once.</b> Flame speed starts changing.</p> <p>2. <b>Press again</b> until desired setting is reached. Display shows the setting.</p> <p>The default setting is 02 (medium speed).</p>																																															

### NOTICE

When the heater is first turned on, a slight odor may be present. This is normal and should not occur again unless the heater is not used for a long period of time.

### NOTICE

To improve operation, **aim** the remote control at the front of the fireplace. **DO NOT press the buttons too quickly.** Give the unit time to respond to each command.

# Methods of Operation

## TEMPERATURE LIMITING CONTROL

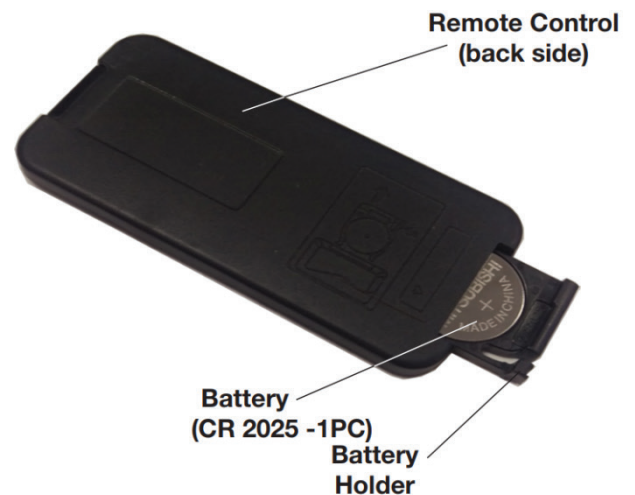
This heater is equipped with a Temperature Limiting Control. Should the heater reach an unsafe temperature, the heater will automatically turn OFF. To reset:

1. Turn the ON/OFF switch on the CONTROL PANEL to OFF.
2. Unplug the power cord from the outlet. Wait 5 minutes.
3. Inspect the fireplace to make sure no vents are blocked, or clogged with dust or lint. If they are, use a vacuum to clean the vent areas.
4. With the POWER switch in the OFF position, plug the power cord back into the outlet.
5. If the problem continues, have your outlet and wiring inspected by a professional.

## REMOTE CONTROL BATTERY INFORMATION

Remote control uses **one CR2025** battery (INCLUDED)

- Remove and immediately recycle or dispose of used batteries according to local regulations and keep away from children.
- Do NOT dispose of batteries in household trash or incinerate.
- Even used batteries may cause severe injury or death.
- Call a local poison control center for treatment information.
- Non-rechargeable batteries are not to be recharged.
- Do not force discharge, recharge, disassemble, heat above (manufacturer's specified temperature rating) or incinerate. Doing so may result in injury due to venting, leakage or explosion resulting in chemical burns.
- Ensure the batteries are installed correctly according to polarity (+ and -).
- Do not mix old and new batteries, different brands or types of batteries, such as alkaline, carbon-zinc, or rechargeable batteries.
- Always completely secure the battery compartment. If the battery compartment does not close securely, stop using the product, remove the batteries, and keep them away from children.



The remote control has a removable plastic tab to prolong the battery life while shipping. Remove the tab for the remote control.

- A.** To replace the existing battery, remove the battery holder.  
**B.** To remove the battery holder, turn remote onto front side and press the left side lever towards the center while pulling the battery holder out using the slot provided.  
**C.** Replace existing battery, type CR 2025, with a new battery and reinstall the battery holder into the remote by sliding it into position.  
**D.** Battery holder is secure into the remote control when a clicking noise is heard.

### **⚠ WARNING**

**NEVER** dispose of batteries in **fire**. Failure to observe this precaution **may result in an explosion**. Dispose of batteries at your local hazardous material processing center.



# Care & Maintenance

## CLEANING



**ALWAYS** turn the heater **OFF** and **unplug the power cord from the outlet** before cleaning, performing maintenance, or moving this fireplace. Failure to do so could result in **electric shock, fire, or personal injury**.



**NEVER** immerse in water or **spray with water**. Doing so could result in **electric shock, fire, or personal injury**.

### Metal:

- Buff using a soft cloth, slightly dampened with a citrus oil-based product.
- **DO NOT** use brass polish or household cleaners as these products will damage the metal trim.

### Glass:

- Use a good quality glass cleaner sprayed onto a cloth or towel. Dry thoroughly with a paper towel or lint-free cloth.
- **NEVER** use abrasive cleansers, liquid sprays, or any cleaner that could scratch the surface.

### Vents:

- Use a vacuum or duster to remove dust and dirt from the heater and vent areas.

### Plastic:

- Wipe gently with a slightly damp cloth and a mild solution of dish soap and warm water.
- **NEVER** use abrasive cleansers, liquid sprays, or any cleaner that could scratch the surface.

## MAINTENANCE



**Risk of electric shock! DO NOT OPEN any panels! No user-serviceable parts inside!**



**ALWAYS** turn the heater **OFF** and **unplug the power cord from the outlet** before cleaning, performing maintenance, or moving this fireplace. Failure to do so could result in **electric shock, fire, or personal injury**.

### Electrical and Moving Parts:

- The fan motors are lubricated at the factory and will not require lubrication.
- Electrical components are integrated in the fireplace and are not serviceable by the consumer.

### Storage:

- Store heater in a clean, dry place when not in use.

## WARNING

**NO SERVICING** of the internal or electrical parts should be performed by the consumer. **DO NOT service the unit yourself.**



# Replacement Parts

Ref.	SPARE PARTS	ME-AER36-SLIM	ME-AER42-SLIM	ME-AER50-SLIM	ME-AER60-SLIM	ME-AER72-SLIM
1	Front Glass	4060011348	4060011083	4060010992	4060011005	4060011006
2	Acrylic Plastic Panel	4010021063	4010021061	4010021048	4010021065	4010021067
3	Heater & Blower	4040010100+4040040115				
4	Flame Step Motor	4040010064				
5	Power Board	4040090040				
6	Main Circuit Board (PCB)	4040100269				
7	Remote Control	4040150153				
8	Control Panel	4040110080				
9	LED Flame Light Strip	4040080126				
10	LED Ember Bed Light Strip	4040080003	404008002			
11	Crystals	3190027				
12	Logs	3030588				
13	Ember-Bed Strip	4010021062	4010021060	4010021044	4010021064	4010021066

# App Connection Instructions

## 1. App download

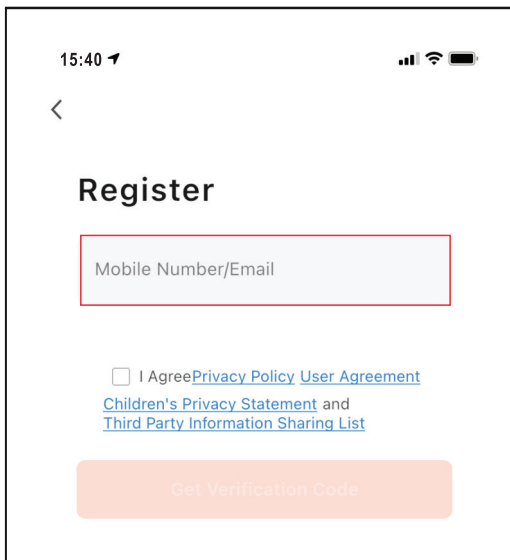
- Download "Tuya Smart" from the app store.
- Scan the QR code.
- Turn on the "GPS" from your mobile device.



Note: make sure your mobile phone is well connected to the nearest WIFI signal.

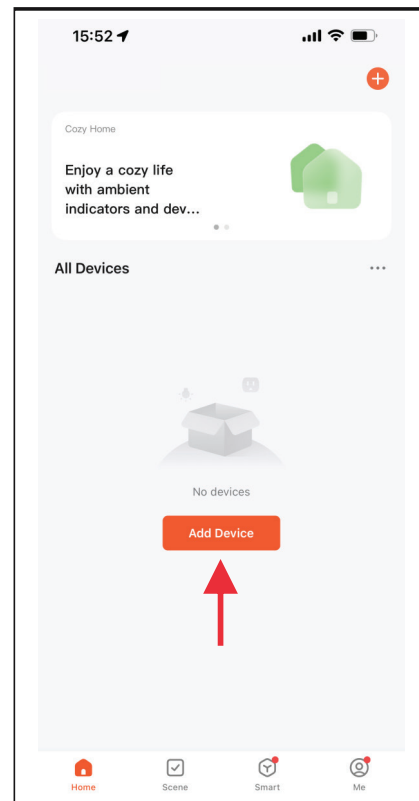
## 2. Login

- Register with your email ID or Mobile phone number as the user name.
- Setup your account password.



## 3. Add device

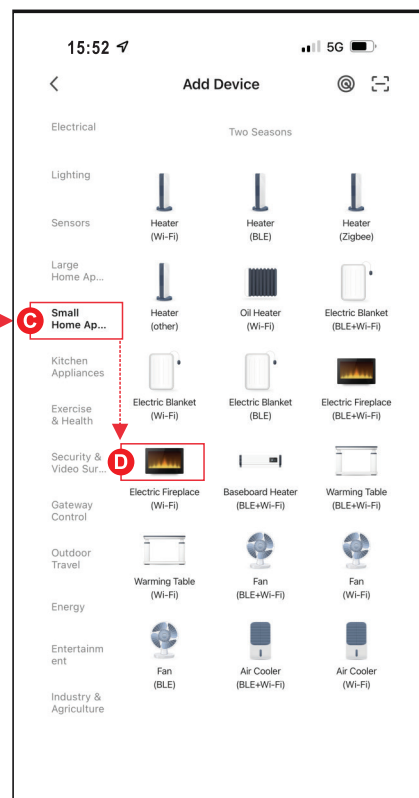
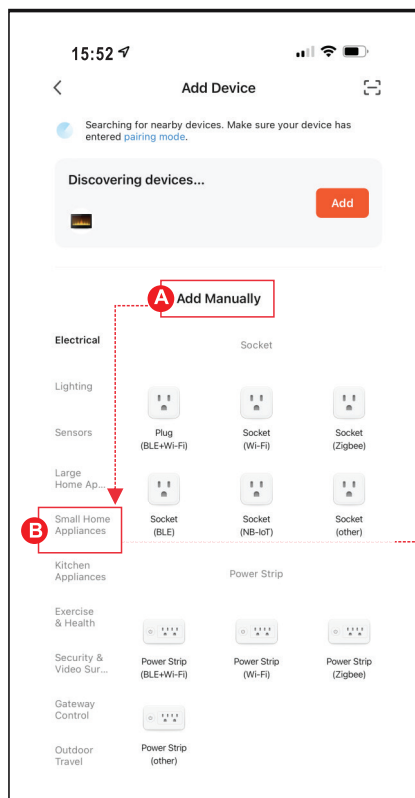
After account is created, log into account and select the "Add Device" button.



## 3. Add device - Continued


There are three methods to add your Aerus Fireplace.

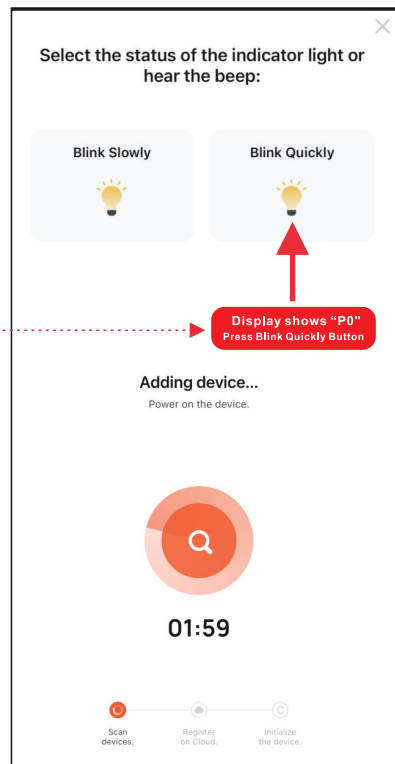
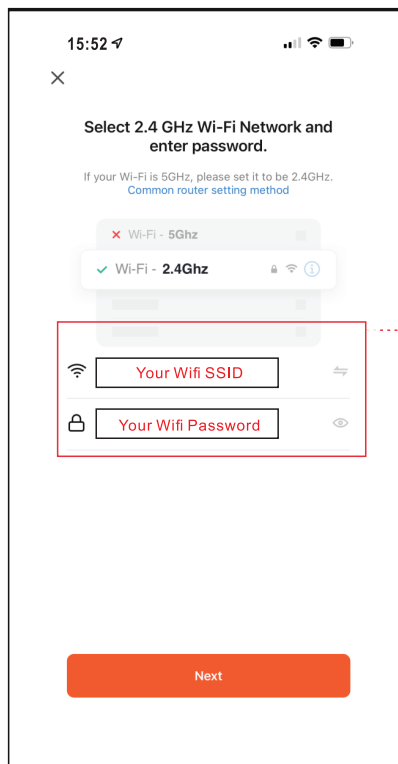
- Method 1: Add Manually on "P0" mode. Please follow below steps A,B,C,D.
- Method 2: Add Manually on "P1" mode. Please follow below steps A,B,C,D.
- Method 3: Add by Bluetooth. Open Bluetooth on your mobile phone before adding.




# App Connection Instructions

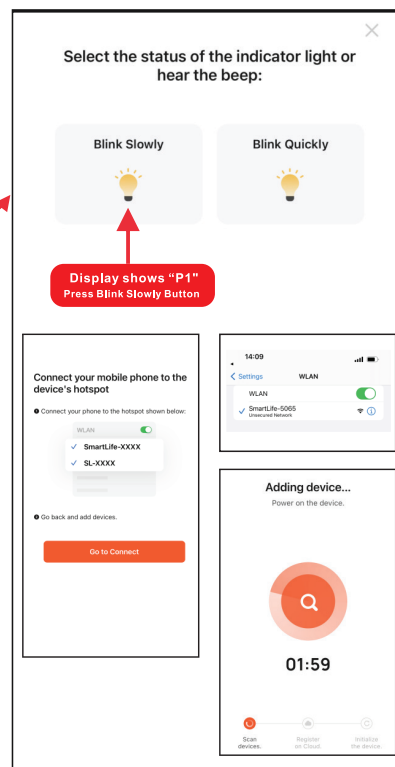
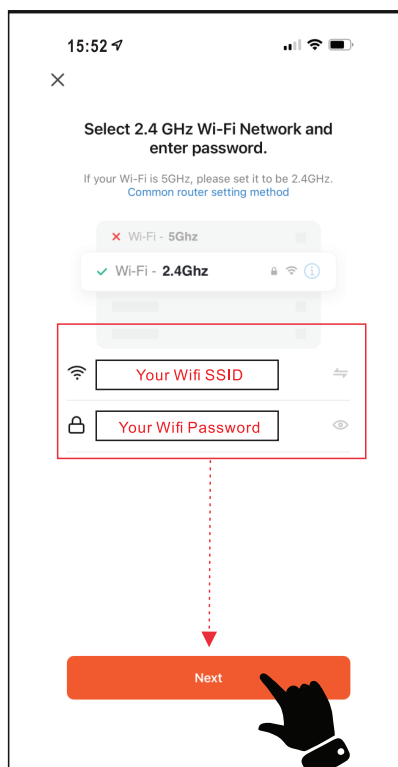
## 4. Connecting method 1 - (P0)

- Press & hold  from remote control or control panel until display on control panel shows "P0."
- Enter the WIFI name and password, then press "Next" button for pairing.
- Press the **Blink Quickly** button for "P0," device being added.
- When complete, display on control panel shows "P4" and LED Ember-light shows **GREEN** color and flashes 6 times.




## 4. Connecting method 2 - (P1)

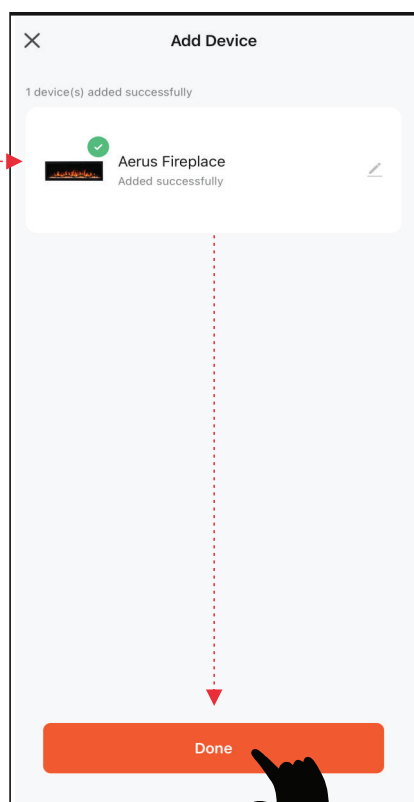
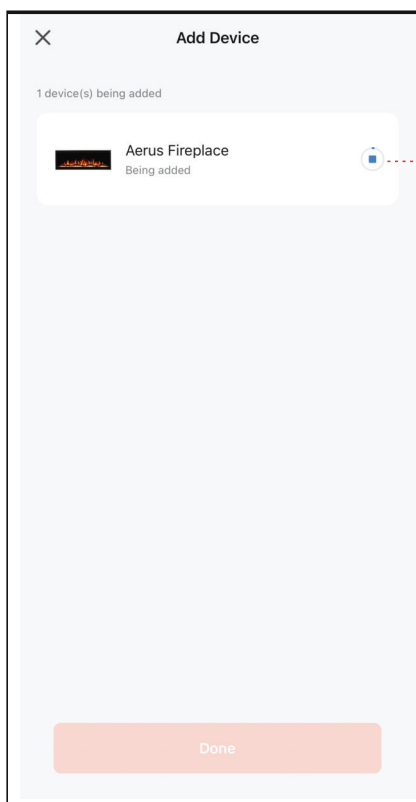
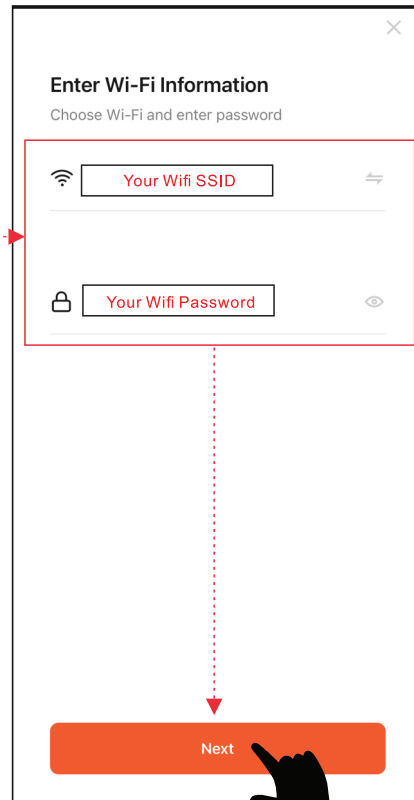
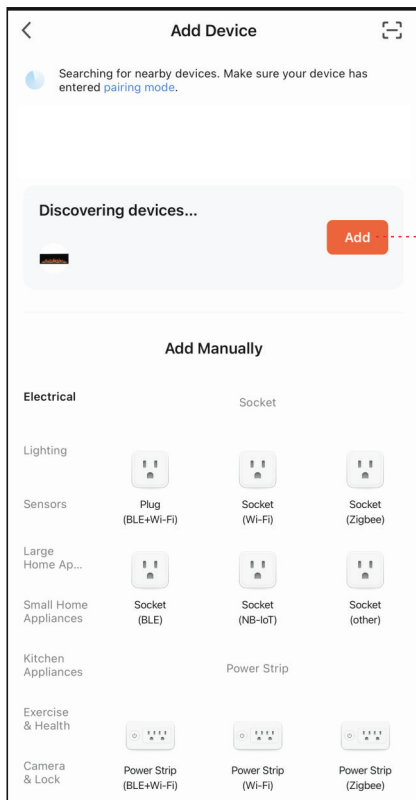
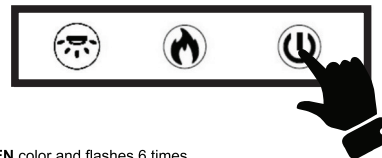
- Press & hold  from remote control or control panel until display on control panel shows "P1."
- Enter the WIFI name and password, then press "Next" button for pairing.
- Press the **Blink Slowly** button for "P1." Then go to connect your mobile phone to the device's hotspot.
- Select device's hotspot (**SmartLife-xxxx**), then back to device. Device being added.
- When complete, display on control panel shows "P4" and LED Ember-light shows **GREEN** color and flashes 6 times.



# App Connection Instructions

## 4. Connecting method 3 - (Bluetooth)

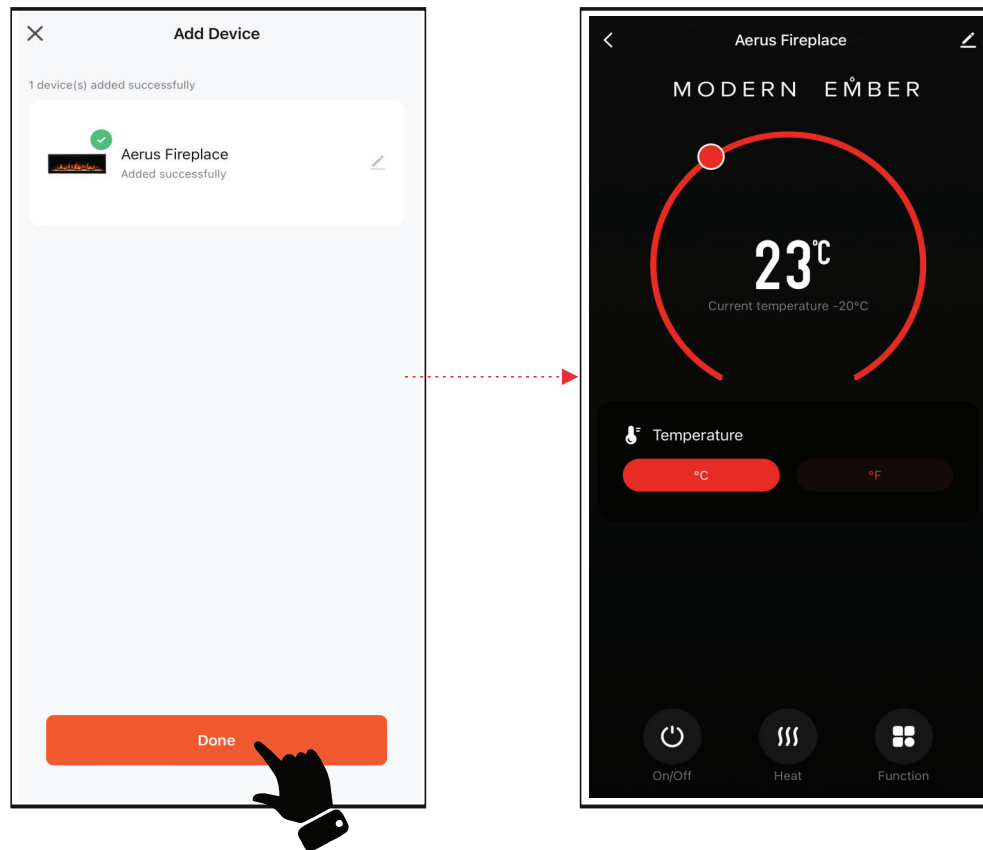
- Press & hold  from remote control or control panel until display on control panel shows "P0."
- Press the **Add** button when you see the device named "Aerus Fireplace."
- Enter the WIFI name and password, then press "Next" button for pairing.
- When complete, display on control panel shows "P4" and LED Ember-light shows **GREEN** color and flashes 6 times.



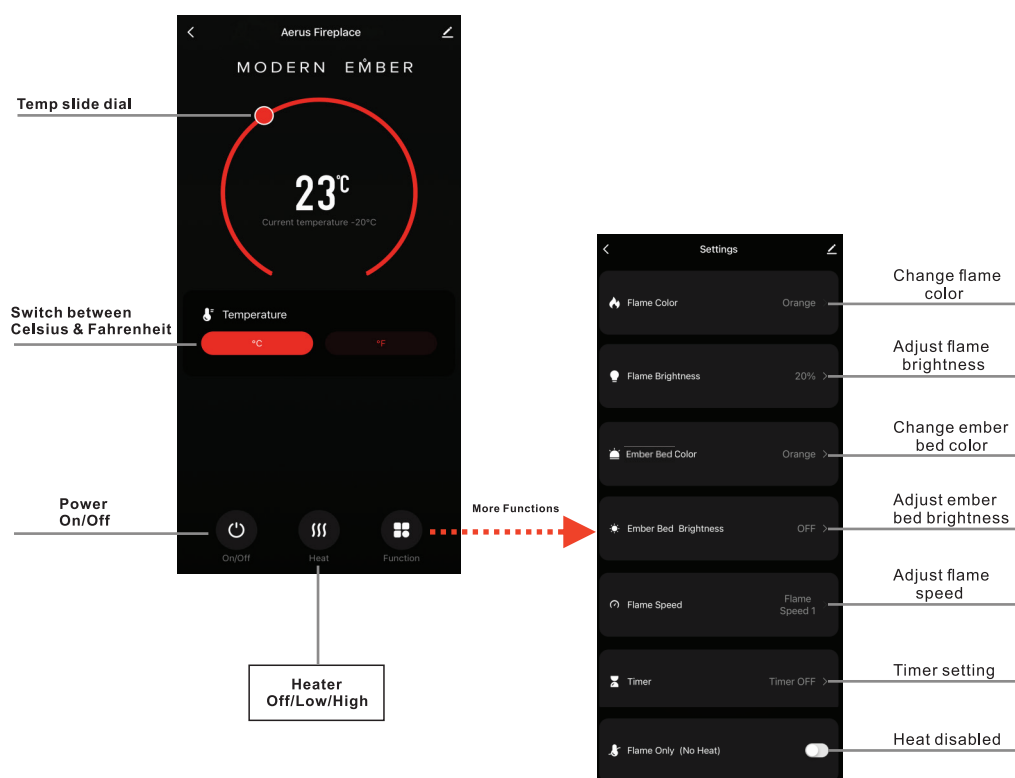
# App Connection Instructions

## 5.Complete

- Press **Done** to complete.



## APP Operating Instruction





MODERN EMBER

Questions, problems, missing parts?

Before returning to store, call

Customer Service:

8am-5pm CST, Monday - Friday

**Phone: 877-430-0703**

**Email: [resolutions@electricfireplacesdirect.com](mailto:resolutions@electricfireplacesdirect.com)**

Retain this manual for future use.