

Operation Manual

Foldable Painting Stand

65656

wiltec



Illustration similar, may vary depending on model

Read and follow the operating instructions and safety information before using for the first time.

Technical changes reserved!

Due to further developments, illustrations, functioning steps, and technical data can differ insignificantly.

Updating the documentation

If you have suggestions for improvement or have found any irregularities, please contact us.



The information contained in this document may alter at any time without previous notice. It is prohibited to copy or spread any parts of this document in any way without prior written allowance. All rights reserved.

The WilTec Wildanger Technik GmbH cannot be held accountable for any possible mistakes in this operating manual, nor in the diagrams and figures shown.

Even though, the WilTec Wildanger Technik GmbH has undergone biggest possible efforts to ensure that the operating manual is complete, faultless, and up to date, mistakes cannot be entirely avoided.

If you should find a mistake or wish to make a suggestion for improvement, we look forward to hearing from you.

Send an e-mail to:

service@wiltec.info

or use our contact form:

<https://www.wiltec.de/contacts/>

The most recent version of this manual in various languages can be found in our online shop via:

<https://www.wiltec.de/docsearch>

Our postal address is:

WilTec Wildanger Technik GmbH
Königsbenden 28
52249 Eschweiler
Germany

To return orders for exchange, repair, or other purposes, please use the following address. Attention! To allow for a smooth execution of your complaint or return, it is important to contact our customer service team before returning the goods.

Returns Department
WilTec Wildanger Technik GmbH
Königsbenden 28
52249 Eschweiler

E-mail: **service@wiltec.info**

Tel: +49 2403 55592-0

Fax: +49 2403 55592-15



Introduction

Thank you for purchasing this quality product. **To minimise the risk of injury we urge that our clients take some basic safety precautions when using this device. Please read the operation instructions carefully and make sure you have understood its content.**

Keep these operation instructions safe.

Safety Instructions

- Ensure that the work stand is placed on a stable, level, and load-bearing surface to prevent tipping or slipping.
- The maximum load capacity is 220 kg. Do not exceed this limit to avoid material failure or injury.
- Make sure that the safety chains are properly and securely hooked in place before placing any load on the stand. Loose chains may cause the frame to collapse.
- The stand is intended for doors, hoods, bumpers, body parts, and other paintable workpieces. Do not place people or vehicles on it.
- Before each use, check that all hinges, welds, and joints are intact. Do not use the product if any damage is found.
- Always wear suitable gloves and safety footwear when using the stand to prevent injuries when handling heavy or bulky items.
- When transporting or storing the stand, keep fingers and hands clear – **risk of crushing!** Ensure the stand being completely cooled down, cleaned, and unloaded.
- Not intended for permanent outdoor use – protect the product from rain and moisture to prevent corrosion.
- This product is not a toy. Keep children away from the work area.
- Only use the work stand when it is fully assembled and in good working order. Unauthorised modifications or repairs are not permitted.

Assembly Instructions

1. Slide the foam padding **(8)** onto the bent tube **(9)**.
2. Insert a leg tube **(6)** into the bent tube **(9)**.
3. Align the holes in the bent tube and leg tube and secure them using the eyebolt with chain **(4)**.
4. Assemble the second bent tube in the same way, but use the hook bolt **(2)** to secure the leg tube and bent tube.
5. Complete the assembly by placing one of the assembled tubes on top of the other.
6. Align the holes and secure with the M8×80 pivot bolts **(3)**.
7. Make sure that a flat washer **(5)** is placed on the outside, between, and inside the tube connections.
8. Use M8 nuts **(1)** to tighten the pivot bolts **(3)**.
9. Finally, press the tube end pieces **(7)** onto the open ends of the tubes.

Parts overview

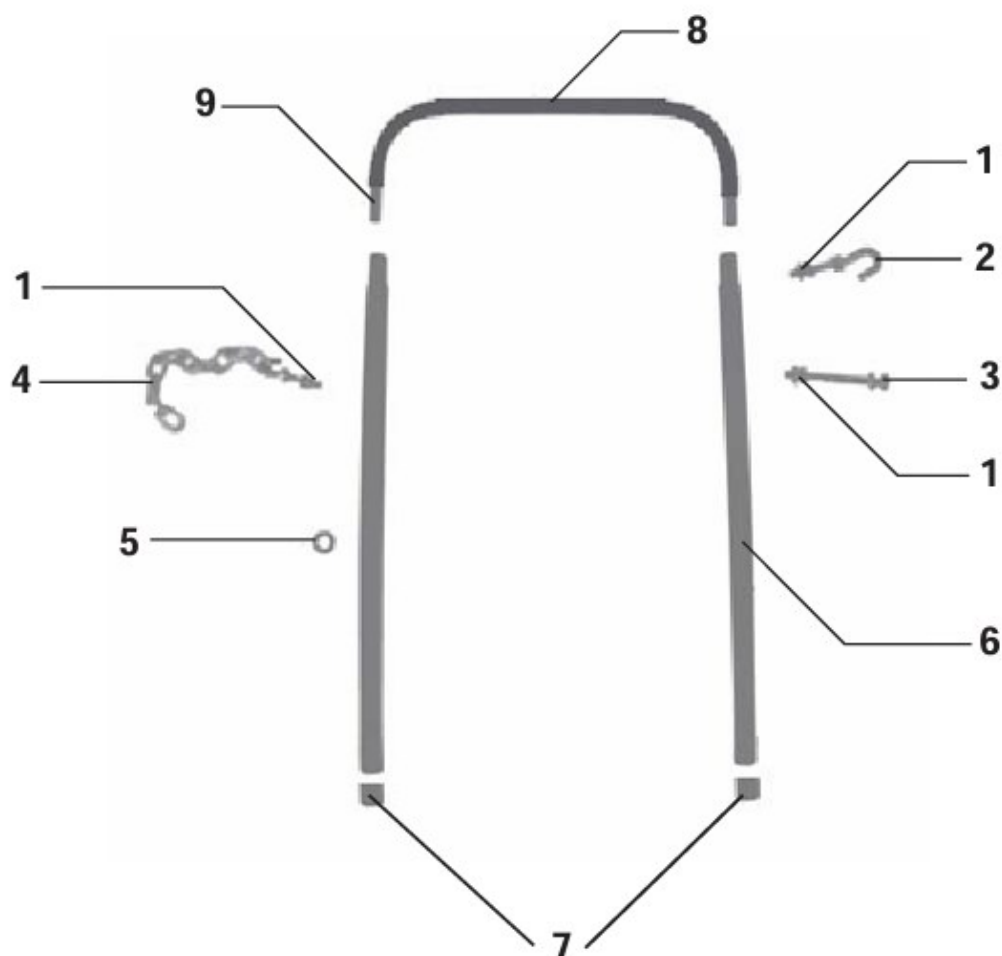

Nº	Name
1, 2, 3, 4, 5	Assembly kit (small parts)
6	Support leg (tube)
7	Tube end piece
8	Foam pad
9	Curved tube

Important notice:

The reprint or reproduction, even of excerpts, and any commercial use, even in part, of this instruction manual require the written permission of WilTec Wildanger Technik GmbH.