

DIRECTORY

Safety Precautions	2
Packing	3
Brief Introduction	4
Motherboard Diagram	5
Rear I/O panel	6
Installation and Settings	7
Drivers Installation	11
BIOS Settings	13

SAFETY PRECAUTIONS

- Products could probably be damaged due to electrostatic discharge(ESD). Please follow these steps below for a successful computer assembly:
- Make sure all parts are firmly connected; otherwise, it might lead to the failure of recognizing components or starting the computer.
- In order to prevent products from being damaged by ESD, please make sure to discharge your body static by touching other metal objects before taking the motherboard out of box.
- Hold the border of motherboard when taking it out. Do not touch the sensitive parts of motherboard.
- Please put the motherboard in an anti-static container or on anti-static pad if not needed.
- Before turning on the computer, make sure all parts inside the case are firmly connected without any loose screws or metal components.
- Do not start the computer before installation finished, otherwise it might result in permanent damage to the computer parts or even injury to the user.
- If you need any assistance in the process of installation, please contact our after-sales customer service or reach us on HUANANZHI official E-mail:business@huananzhi.com for professional technical support.
- Prior to installation or disassembly, please switch off the power and pull the power cable from the socket.

- Keep the motherboard away from moisture.
- Keep the user manual for future reference.
- Before plugging the power supply, please make sure the socket provides the corresponding voltage.
- In any of the following situations, please keep the motherboard and power cable in a safe place. Do not put anything onto the power cable.
- In the event of any of the following conditions, have the board checked by a service technician:
 - Liquid penetrated into the computer.
 - Motherboard is exposed to moisture.
 - Motherboard does not work even if you follow the instructions on user manual.
 - Motherboard fell off to the ground and got damaged.
 - Motherboard has clear signs of damage.

PACKING

- **Please confirm that the motherboard is properly packaged upon purchase of the product. If there is any damage to packaging or lack of accessories, contact us as soon as possible.**
 - 1.HUANANZHI X10X99-16D motherboard
 - 2.SATA data cable
 - 3.I/O shield back plat
 - 4.Warranty Card

BRIEF INTRODUCTION

Features

CPU: Intel® LGA2011-3 Processor Intel® Xeon™
 RAM: 16*DIMM supports up to 1024GB DDR4
 2400/2133/1866MHZ Non-ECC.ECC memory
 Quad-Channel Memory Architecture
 Actual memory data rate depends on CPU type and DRAM module

I/O effects: 6 x SATA3.0 (maximum transfer speed up to 6GB/s)
 4 x SSATA3.0 (maximum transfer speed up to 6GB/s)
 2 x USB2.0 interface
 2 x USB3.0 ports
 1 x VGA Display Interface
 1 x PS/2 Mouse and Keyboard port
 2 x RJ45 Network card interface

Audio: Realtek Audio Transcoder
 Realtek 5.1 Channel High Fidelity Audio
 Audio output: Front Out/Front Speaker Out
 Audio input: Microphone input, Audio input

Ethernet: 2 x Intel I225-V Gigabit Port

Expansion slot: 3 x PCIe 3.0 x16
 2 x PCIe 3.0x8
 1 x M.2 NVME PCIe 3.0X4 (key M)2280
 1 x M.2 NVME PCIe 3.0X4 (key M)22110
 2 x SFF-8643 x4 2.0

Motherboard Overview

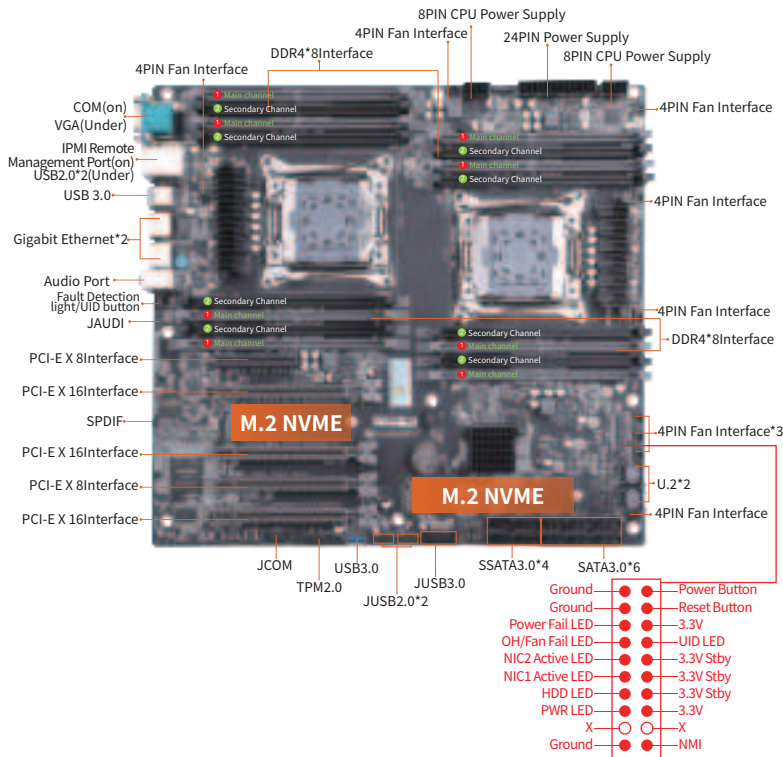

1-1 X10X99-16D motherboard overview

Rear I/O Panel

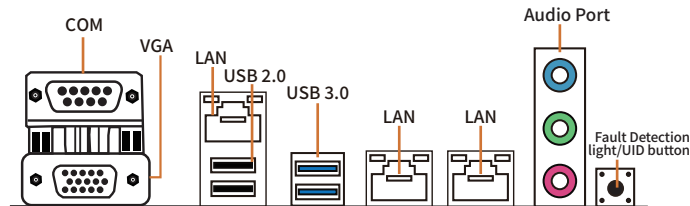

1-2 Overall Rear I/O Panel Display

The diagram illustrates the internal wiring of the RJ45 port. It shows two tables representing the LED status indicators and their corresponding pin connections.

Activity/Link LED	
Status	Description
Off	No link
Yellow	Linked
Blinking	Data activity

The Activity/Link LED is connected to the top two pins (1 and 2) of the RJ45 port.

Speed LED	
Status	Description
Off	10 Mbps connection
Green	100 Mbps connection
Orange	1 Gbps connection

The Speed LED is connected to the bottom two pins (3 and 6) of the RJ45 port.

1-3 LAN port LED indications

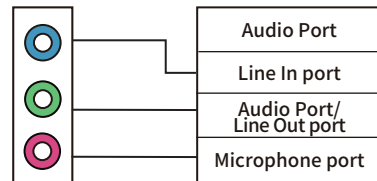

1-4 Audio Port Configuration

Installation And Settings

NOTICE

please check the motherboard where all pins marked with number "1" or white bold line are PIN "1".

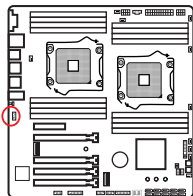

		9	1
		10	2
1	MIC+	2	Ground
3	Vbias	4	AuD_Vcc(AVCC)
5	L_R_Out	6	R_Out Back
7	N.C	8	Key
9	L_L_Out	10	L_Out Back

2-1 Front Audio Output Ports

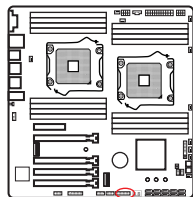

		2																20
		1																19
1	Power	2	USB3_RX_DN															
3	USB3_RX_DP	4	Ground															
5	USB3_TX_C_DN	6	USB3_TX_C_DP															
7	Ground	8	USB2.0-															
9	USB2.0+	10	GND															
11	USB2.0+	12	USB2.0-															
13	Ground	14	USB3_TX_C_DP															
15	USB3_TX_C_DN	16	Ground															
17	USB3_RX_DP	18	USB3_RX_DN															
19	Power	20	N.C															

2.2 USB3.0 Interface

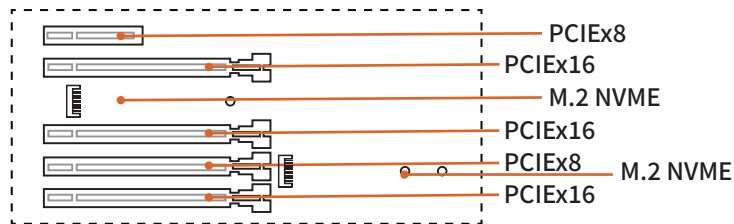

2-3 PCI Expansion Slot

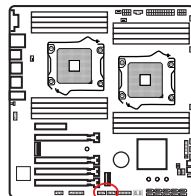

		10							2
		9							1
1	VCC	2	VCC						
3	D-	4	D-						
5	D+	6	D+						
7	GND	8	GND						
9	KEY	10	N.C						

2-4 USB Extension Interface

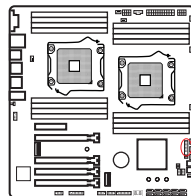

		19								1
		20								2
1	Ground	2	Power Button							
3	Ground	4	Reset Button							
5	Power Fail LED	6	3.3V							
7	OH/Fan Fail LED	8	UID LED							
9	NIC2 Active LED	10	3.3V Stby							
1	NIC1 Active LED	2	3.3V Stby							
3	HDD LED	4	3.3V Stby							
5	PWR LED	6	3.3V							
7	X	8	X							
9	Ground	10	NMI							

2-5 F_PANEL1 Boot Interface

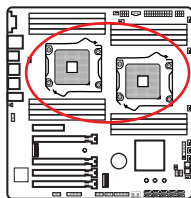

- In order to properly place the CPU in the motherboard, the surface of the LGA2011-3 CPU has two pairs of starting points and a golden triangle. Golden triangle indicates Pin1

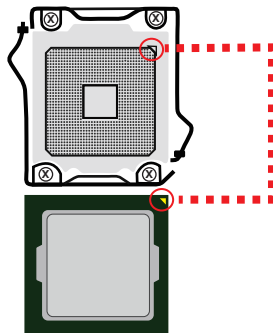

2-6 CPU Installation

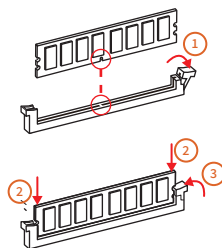

- 1.Pull the clips on both ends of the memory slot outward, and the memory strip corresponds to the protruding position of the slot to determine the direction of installation.
- 2.Align the memory module into the slot and press
- 3.Let the snaps on both ends of the slot automatically bounce

2-7 Memory Installation

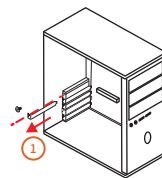

- 1.Use a screwdriver to remove the bezel and screws on the main unit

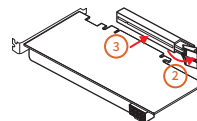

- 2.Need to pick up the card slot of the card slot when installing the graphics card
- 3.Insert the graphics card into the card slot of the graphics card

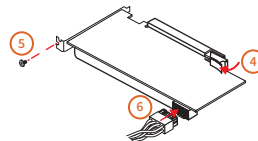

- 4.After the installation is in place, the chuck will automatically return to its position.
- 5.Remove the graphics card to the chassis with screws
- 6.Install the power cord

2-8 Graphics Card Installation

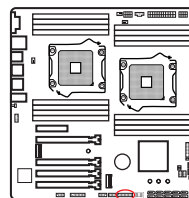

SSATA 3.0*4

SATA 3.0*6

2-9 SATA Interface

Drivers installation

1.Drivers listing:

Driver Directory	Driver Description	Operating System
X10X99-16D Chipset Driver	Intel chip information installation	win7/win10
X10X99-16D Suond Card Driver	Realtek series sound card driver installation	win7/win10
X10X99-16D LAN Driver	Realtek network card driver installation	win7/win10

2.Intel Chip Information Installation

Run “Control Panel - System - Hardware - Device Manager”
Click the right mouse button to change the driver's hardware device and proceed with the installation below:
Option: Propertyt - Update driverl - Not connect to Internet - Manually installation
Find the corresponding directory
Select "Next step"

3.Audio driver installation

Before this installation, please check the model of the audio chip on the motherboard first(you may refer to this manual), Select the proper driver accordingly for installation.

3.1Audio driver installation (take HD Audio series for example)

Run "driver installer": X10X99-16D Audio DRIVER/ALC662-32bit_Win7_Win8_Win81_Win10_R279.exe/ALC662-64bit_Win7_Win8_Win81_Win10_R279.exe
Click on "next"to continue,and then"finished"
The system will automatically restart itself to finish the installation

3.2 Uninstallation of audio driver(take HD Audio series for example)

Getting into Windows desktop, choose "setting"/ "control",and then "add/remove programs". Later, choose "Realtek High Definition Audio Driver" in the menu and click on "add/remove"so thatthe driver will be automatically removed.

4.Driver installation of external video card

Run "driver installer", take Setup.exe,
Click on "next" - "yes"
-"next"
-"next"and"finished"
The system will automatically search for devices to complete the installation

5.Driver installation of network

Run "driver installer":X10X99-16D LAN DRIVER /setup.exe
click on "next"-

"installation"- "finished"and restart the computer,
and restart the computer, The system will automatically
search for devices to complete the installation.

BIOS Settings

In order to enable the computer to work well or execute specific functions, CMOS SETUP normally stores all kinds of data in CMOS SRAM of the motherboard. When the computer is shut down, motherboard’ s battery will supply power to CMOS SRAM. When the computer is turned on and starts POST(Power On Self Test), press “Delete/Del” key to enter into AMI BIOS CMOS SETUP main page. Motherboard warm boot key is “F7”.

Menu: please pay attention to every option in the settings menu. When there is a triangle shaped symbol on the left side of menu, it means that you choose this sub-menu,so a pop-up sub-menu will be available.

1.Main Menu Function

Main	Advanced	Chipset	Boot	Security	Save	Exit
------	----------	---------	------	----------	------	------

- ☆ Main
- ☆ System Overview
Date/Time settings, HDD specs/Monitor type settings.
- ☆ Advanced
Advanced Settings
BIOS special function settings, such as virus alert, booting disk priority etc.
- ☆ Chipset
Advanced Chipest Settings
- ☆ Boot
Boot Settings
- ☆ Security
Security Settings
- ☆ Save
Save Setting
- ☆ Exit
Exit Options
Exit settings include loading of optimized defaults value/
loading of fail-safe defaults / discarding changes/ exiting
without saving.Exit settings include loading of optimized
defaults value/ loading of fail-safe defaults / discarding chang-
es/ exiting without saving.