

80V STRING TRIMMER

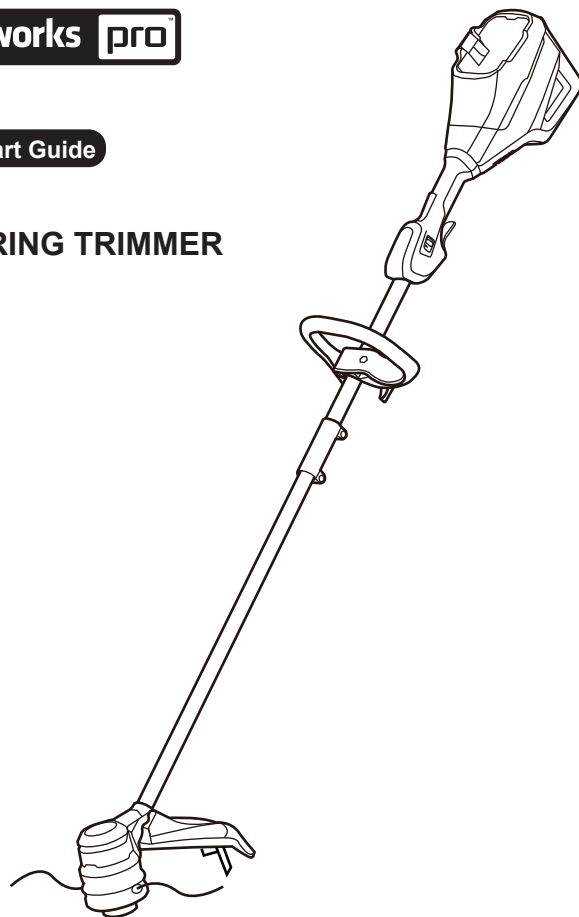

Depending on the model purchased, packaging will contain different accessories and parts. Refer to the package for more details.

KNOW YOUR MACHINE

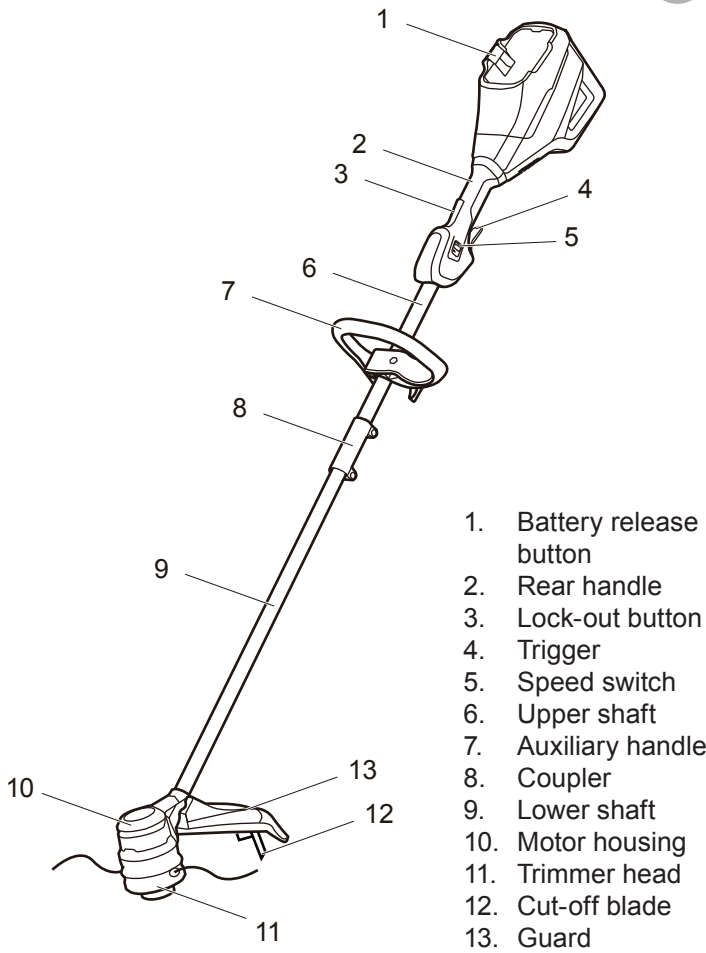

1. Battery release button
2. Rear handle
3. Lock-out button
4. Trigger
5. Speed switch
6. Upper shaft
7. Auxiliary handle
8. Coupler
9. Lower shaft
10. Motor housing
11. Trimmer head
12. Cut-off blade
13. Guard

INSTALLATION

Attach the guard

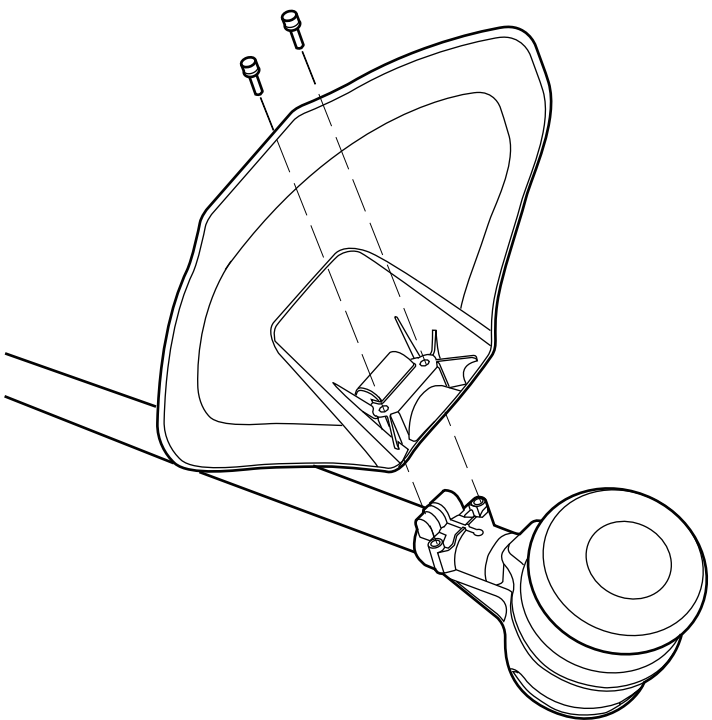

Attach the edge guide

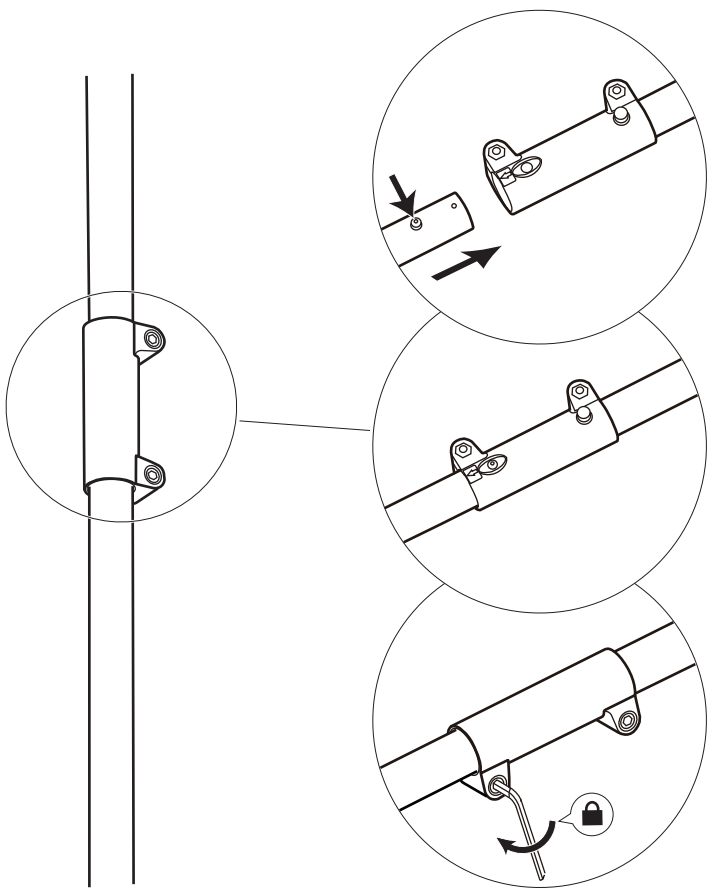

4

Attach the auxiliary handle

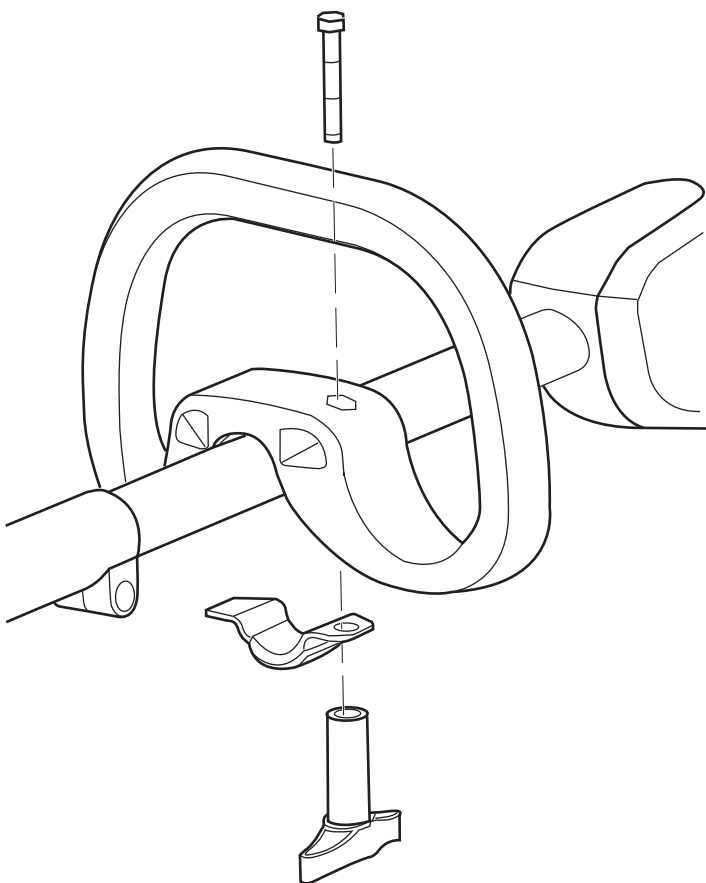

Install the battery

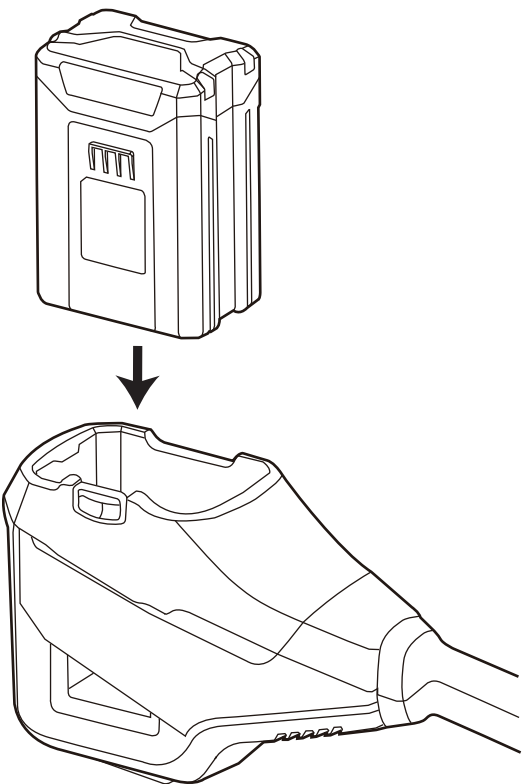

5

OPERATION

Start the machine

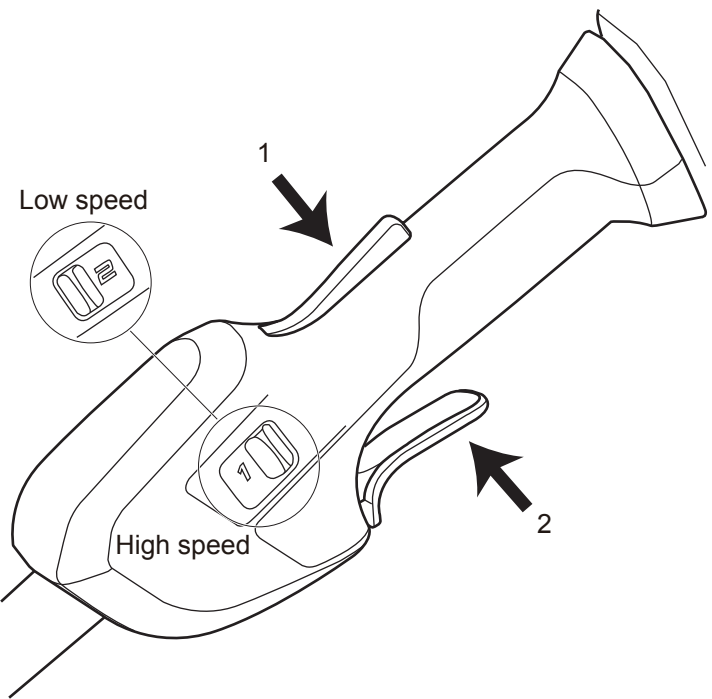

Operation tips



Adjust the length of the cutting line

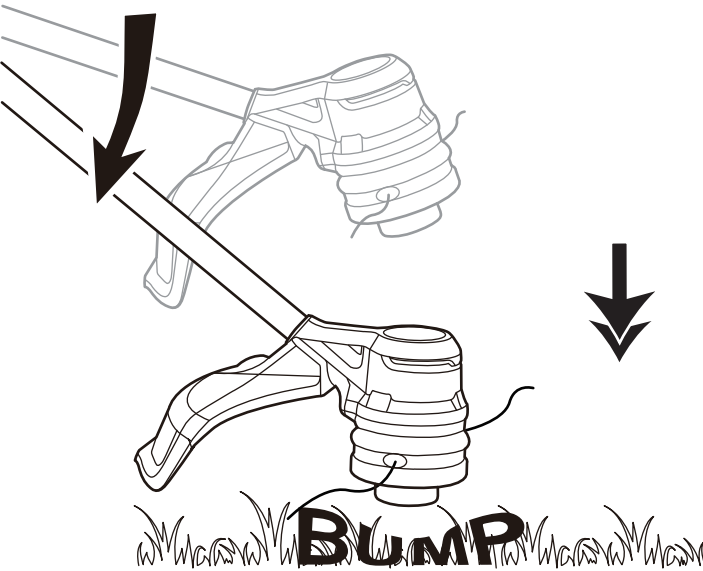

Adjust the cutting diameter (14"-16")

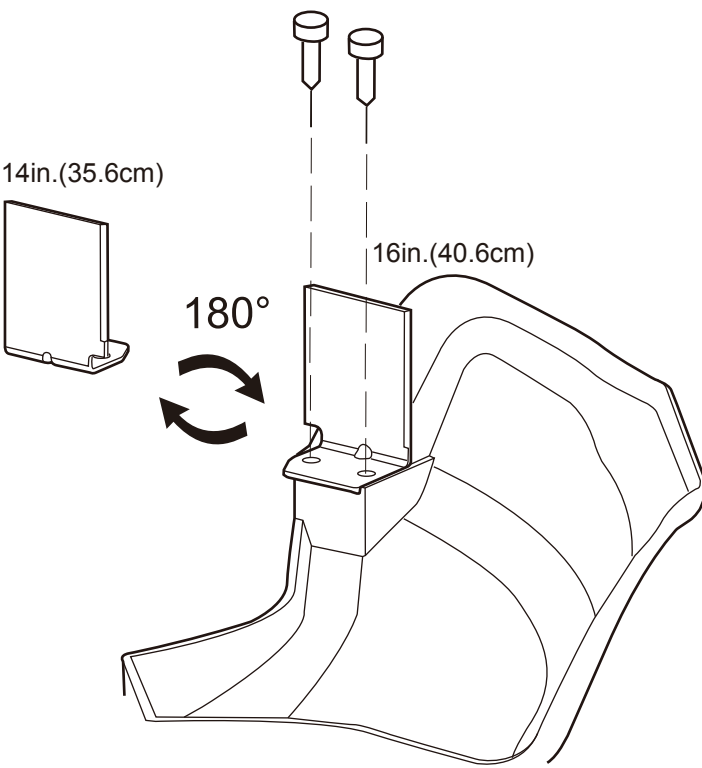

MAINTENANCE

Replace the spool and bump head

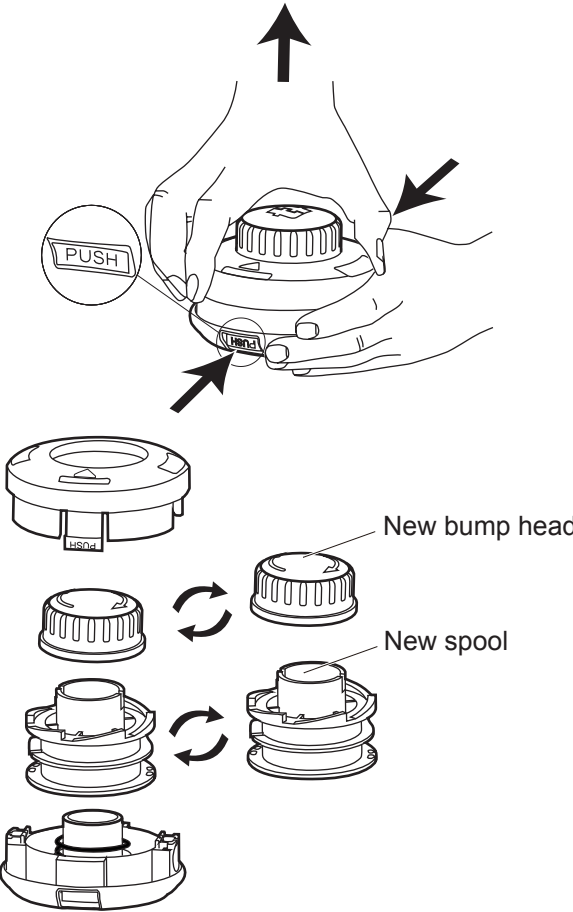

MAINTENANCE

Install the cutting line

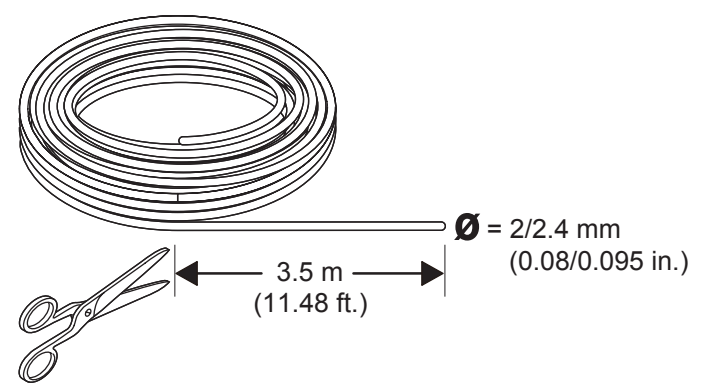

Push and rotate the bump head to align the slots as below.

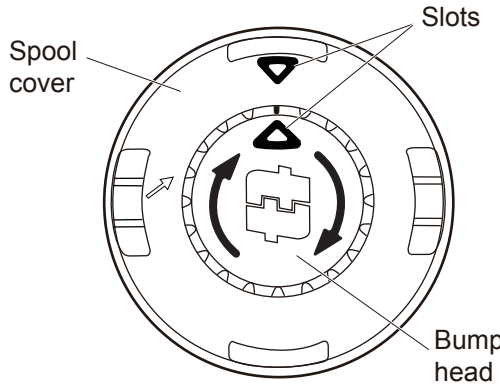

13

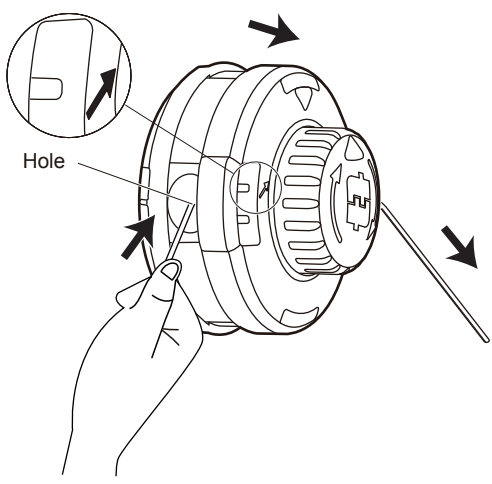

14

