

User manual NEWELL electronic timer remote



CAUTION:

1. Please read the following safety guidelines to avoid damage to the equipment or personal injury.

2. Do not disassemble or modify the device.

3. Do not allow water to penetrate

4. Do not use near flammable gases.
5. Keep out of the reach of children.

6. Switch off / unplug immediately in the event of a fault.

7. Do not expose to high temperatures.

8. Use the batteries in accordance with their instructions for use. Insert the batteries with the correct polarity. Remove the batteries if you do not plan to use the device for a long time.

9. Do not short circuit.

Device description

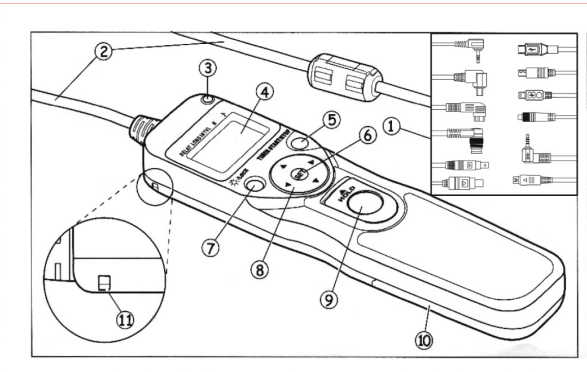

- Display:

1. Cursor

2. Time

3. Lock indicator

4. Low indicator battery levels
5. Timer indicator

6. Sound

7. Set

8. Open shutter

9. Number of photos

1. Connector

2. Cable

3. Diode

4. Display

5. Start / stop timer
6. Set

7. Backlight / Lockout

8. Directional arrows

9. Shutter release

10. Battery compartment cover

11. Lanyard clip

The device is not equipped with a switch. In To save battery power, make sure the **TIMER ACTIVE**, **SET**, and **RELEASE** indicators are turned off.

To switch on the illumination - briefly press the illumination / lock button.

To lock the buttons - press and hold the light /lock button until the "L" icon appears on the display.

Use

In order to connect the cable to the camera:

1. Turn off the camera.

2. Make sure that the **TIMER ACTIVE**, **SET**, and **RELEASE** indicators are off.

3. Connect the cable connector to the socket on the device.

Electronic remote release cable can be used as:

Timer-the ability to program a delayed trigger, exposure, intervals, number of photos. **Manual shutter release** for manual triggering of remote shutter release

1. **Settings on the camera: Exposure mode-M** (manual)
Time - Bulb
Intervalometer - off
Auto focus mode - AF - AFC or Manual
Burst mode - off
Programming the timer

2. Press **SET**- the icon starts blinking on the display.



DELAY - shutter release delay
LONG - exposure time
INTVL - interval

N-number of photos
 🛎 (frames)
 - sound on / off

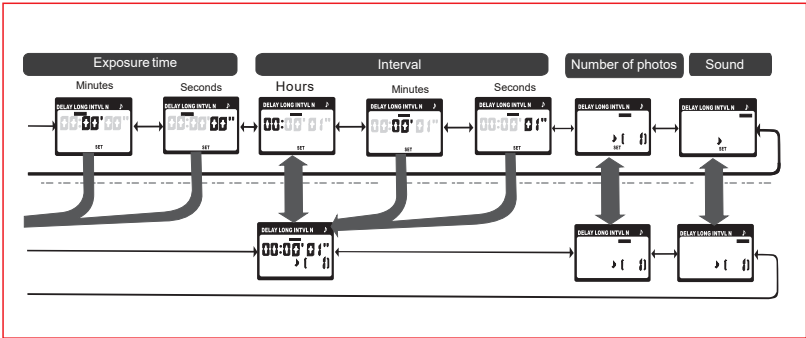

Use the directional arrows to program the timer. Right / Left for selection, up / down to change. The cursor shows the current position. Press SET to confirm.

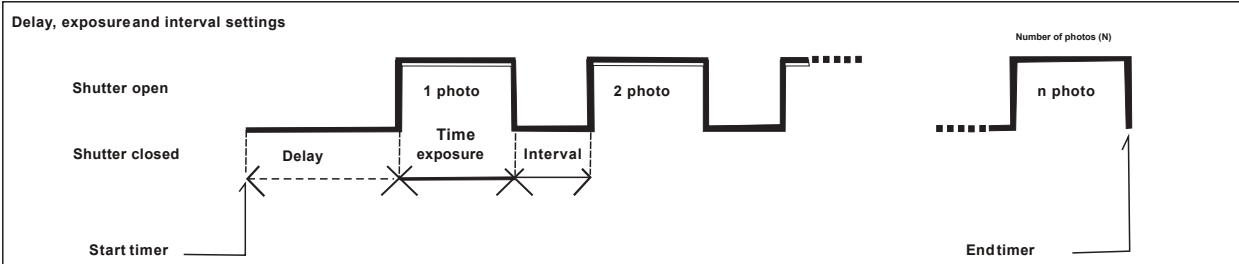

- * To ensure correct operation, the interval should be at least 1 second longer than the exposure time.
- * When using autofocus, the delay should be at least 2 seconds and the interval at least 2 seconds longer than the exposure time.

The electronic cable release can also be used in manual mode (without batteries inserted). The display and the acoustic signal will not be active.

- * When using the noise reduction function with long exposures, the interval should be set to at least twice the exposure time.
3. Starting the program
 Press **TIMER START/ STOP**. The timer will start and the icon on the display will start flashing.

- Connect the cable to the camera.
- Turn on the camera.
 - Set the exposure mode, time, autofocus mode and more to ensure correct exposure.
 - Press the shutter release button halfway. If the focus and exposure are correct, press the button the rest of the way down to take the picture.



- * The display shows the time remaining until the next photo.
- * While the camera shutter is open, the display shows the time remaining until the shutter is closed and the **RELEASE** icon blinks.
- * The program will end automatically when the preset number of shots is reached. To stop at any time, press **TIMER START/ STOP**.

- * to open the shutter in Bulb mode - press and slide to the **HOLD** position. Slide in the opposite direction to finish.

Specification

Supported cameras	- according to the connector fitment
Delay	- 0 s to 99 h 59 min 59 s at second intervals
Exposure time	- 0 s to 99 h 59 min 59 s at second intervals
Interval	- 1 s to 99 h 59 min 59 s at second intervals
Number of photos	- 1 to 399, unlimited
Power	- 2 x AAA 1.5 V LR03 alkaline
Ambient operating temperature	- -20 C - +50 C
Dimensions	- 15.5 cm x 4 cm x 1.8 cm
Weight	- 84 g
Cable length	- 94 cm