



www.awolvision.com
support@awolvision.com



AWOL Vision Matte white Fixed Frame Screen INSTRUCTION MANUAL



Thank you for choosing the AWOL Vision Matte White Projection Screen. Please read this manual carefully before installation and use.

PACKING LIST

For better recognizing Inner & Outer frames, you can make every component marked by the corresponding number as below after you unpack the protective film in case of messing up.



① Inner frame A × 2



① Inner frame B × 2



① Inner frame C × 2



② Outer frame A × 2



② Outer frame B × 2



② Outer frame C × 2



③ Support rod × 1



④ Glass fiber strip × 2



④ Glass fiber strip × 4



⑤ Screen × 1

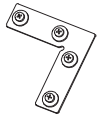

⑥ Corner connectors × 4



⑦ Corner connectors × 4



⑧ Tension spring × N



⑨ Pull hook × 1

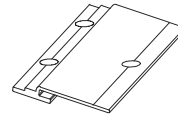

⑩ Outer frame connector × 2

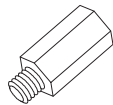

⑪ M5 single head hexagon stud × 4



⑫ M5*6 Phillips screw × 6

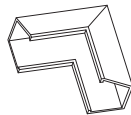

⑬ Corner protection × 4

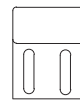

⑭ Wall bracket × 2

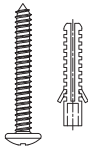

⑮ Wall bracket screw × 4 set

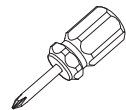

Phillips screwdriver × 1



Spirit level × 1



Gloves × 1



Manual × 1

7.0 Specification

AWOL Vision Matte White Screen Specification		
Model	MW-100	MW-120
Size	100 inch	120 inch
Material	Matte white	Matte white
Gain	1.3 dB	1.3 dB
Resolution	up to 8K	up to 8K
Viewing Angle	170°	170°
Projection Ratio	16:9	16:9
Matched Projector	Long Throw Projector	Long Throw Projector
	Short Throw Projector	Short Throw Projector
	Ultra Short Throw Projector	Ultra Short Throw Projector
Screen Weight	17.2 lbs / 7.8 kg	21.4 lbs / 9.7 kg
Package Weight	25.41 lbs / 11.5 kg	28.7 lbs / 13 kg
Package Size	1405*230*130MM 55.3*9.1*5.2 inch	1650*230*130MM 65.0*9.1*5.1 inch

6.2 Drill holes on the marks on the wall with a percussion drill, insert the rubber plug, screw on the screws, and fix the wall bracket (Figure 13)

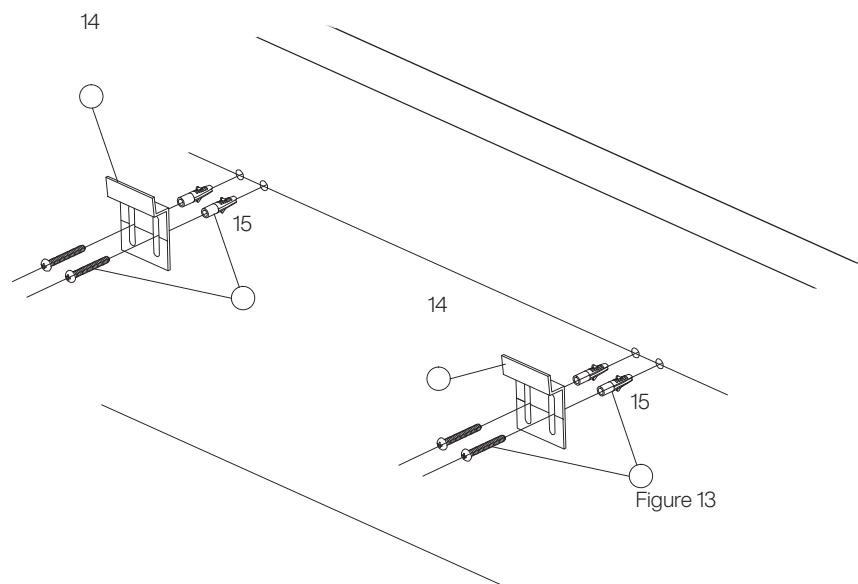

6.3 Hang the assembled screen on the wall (operated by two persons) (Figure 14)

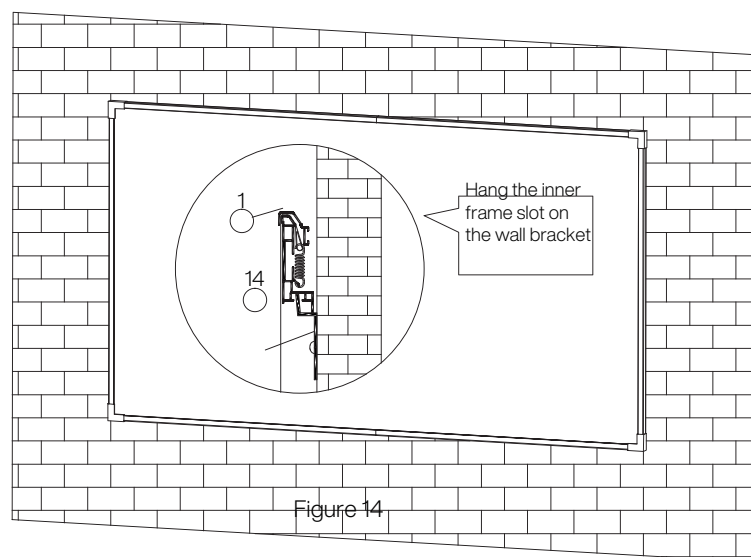

Figure 14

1.0 Precautions

Please follow the operating regulations below when assembling projection screen for the best performance as the result.

1.1 When assembling, find a suitable size floor or table. The surface must be clean and free of any obstacles. The floor or table must be covered with clean materials such as cloth, film, blankets, etc.

1.2 Handle with care during installation to prevent personal injury or property damage.

1.3 Do not touch the surface of the projection screen with ungloved hands.

1.4 Do not touch the projection surface with sharp or hard objects to prevent damage to the screen material.

1.5 Keep children away from the screen to prevent accidents.

1.6 It's highly recommended to clean screen surface by soft cloth every two weeks to keep it clear for projection.

1.7 Please use a soft cotton cloth to wipe (dip some water) gently, and it is not advisable to use any chemical cleaners or alcohol.

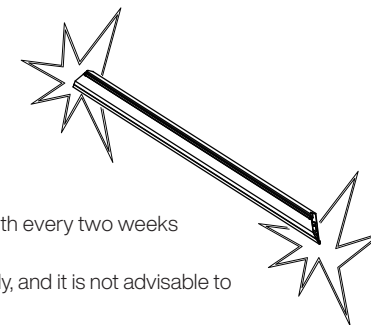

2.0 Assemble the frame

Before assembling inner frames, please wear gloves in case of wound by the edge.

2.1 Open the package and check whether the accessories in the box are complete.

2.2 Connect inner frame A and inner frame B first (Figure 1)

2.3 Insert the 4 corner connectors into the inner frame C (Figure 2)

2.4 Assemble the four inner frames and struts as shown in the figure below, and lock them with screws after the inner frame is assembled (Figure 2, Figure 3);

2.5 It's highly recommended that you should firstly assemble Inner frame A & B.

2.6 Tips for installing support rod: Please firstly put female head between support rod and screw hole, and then tighten up screws with enough space for further check and adjustment upon the whole inner frame.

Tips:

- Please check and prepare all the necessary components according to Packing List ahead of time.

- Please don't thoroughly tighten the screws because you might need further check and adjustment before it's total completed.

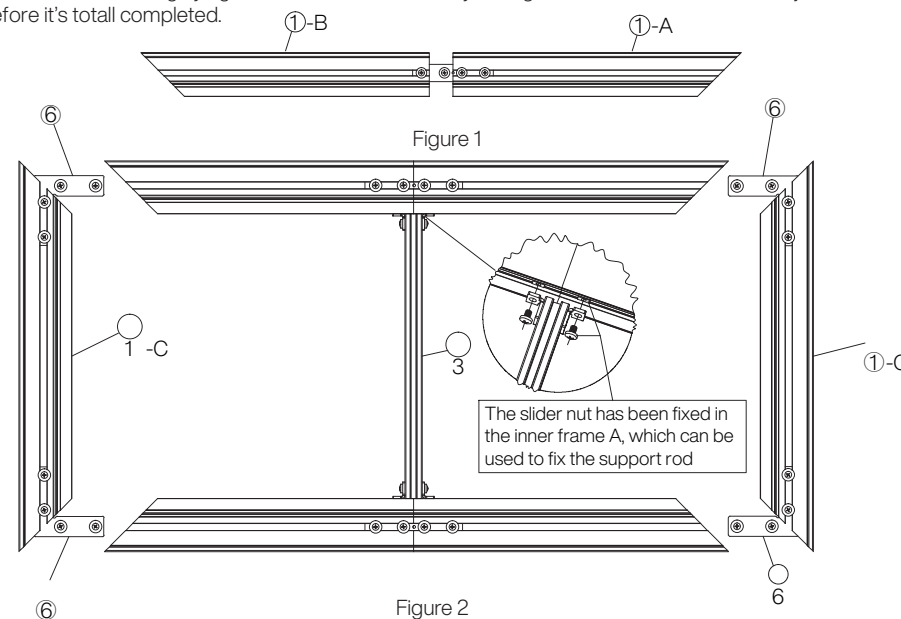

Figure 2

Please make sure every two vertical inner frames are well-fit.

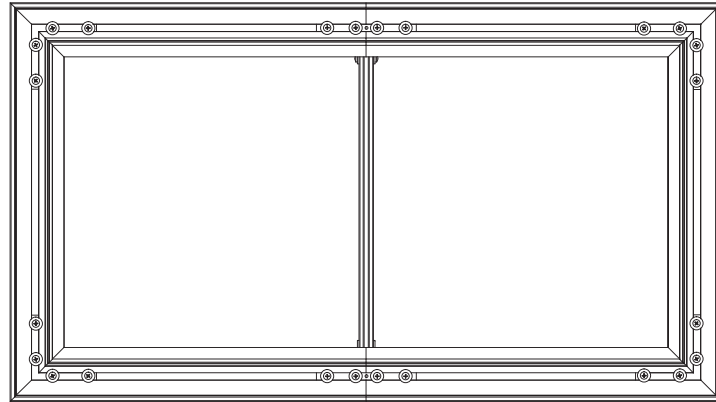

Figure 3

3.0 Assemble the screen

3.1 Wear gloves (to avoid the screen being stained with fingerprints that can not be erased).

Lay a clean cloth on a flat, clean surface (or ground) to protect the screen.

3.2 Take out the screen from the package, turn the screen face down, unfold the screen, and then according to the length of the glass fiber strips, take the glass fiber strips insert to around of screen as shown below.

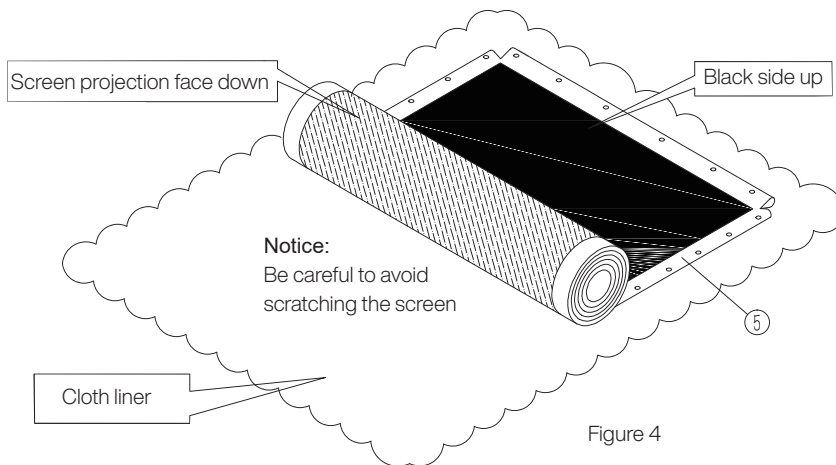

Figure 4

6.0 Mount on the wall

6.1 Install wall hangers on the wall according to screen size. Required tools: level, hammer drill, pencil, ladder, etc. As shown below. Please estimate the installation position of the screen before installing the wall pendants. The height of the lower edge of the screen from the ground is generally about 50~80cm.

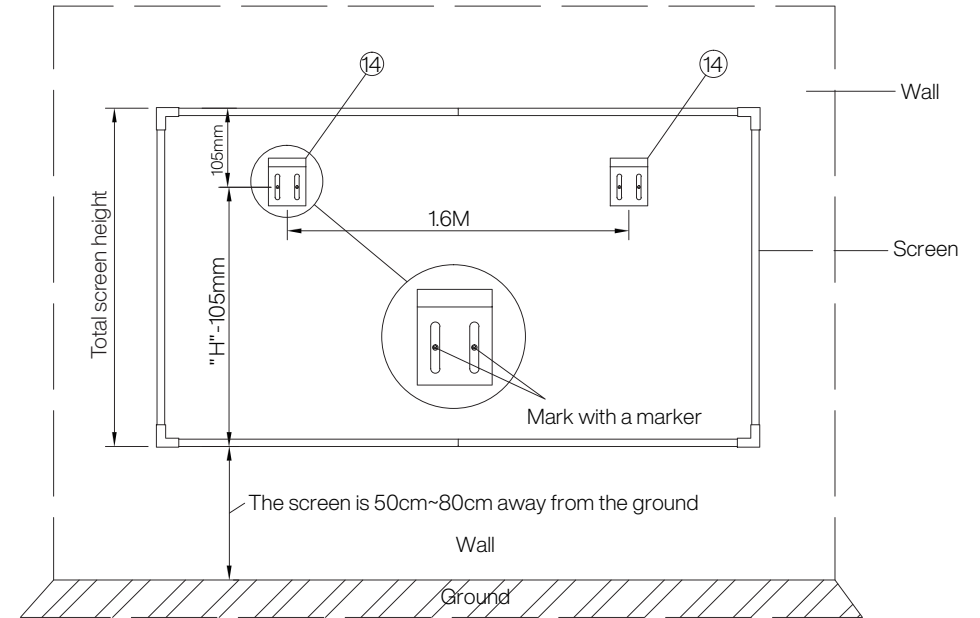

Figure 12

5.2 Put the outer frame against the frame screen, align the four corners, connect the surroundings with corner connector and lock all the screws (Figure 10)

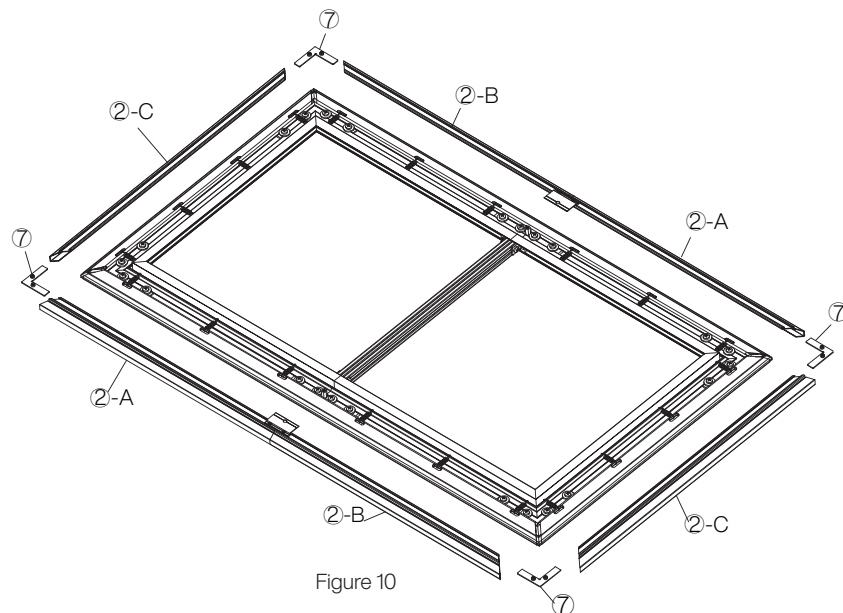

Figure 10

5.3 Use screws to lock the joints of the outer frame on the hexagonal studs, and clip the corner protectors into the slots of the outer frame (Figure 11)

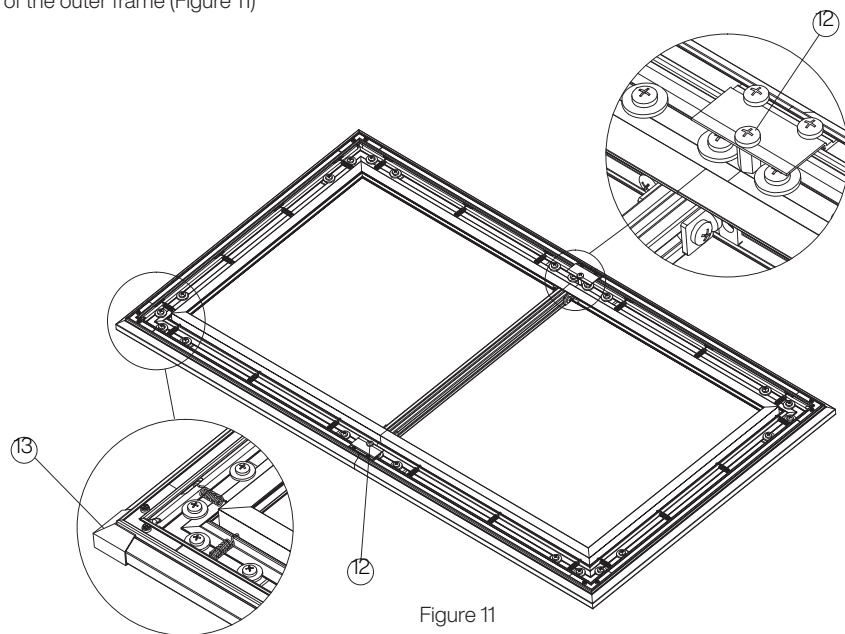

Figure 11

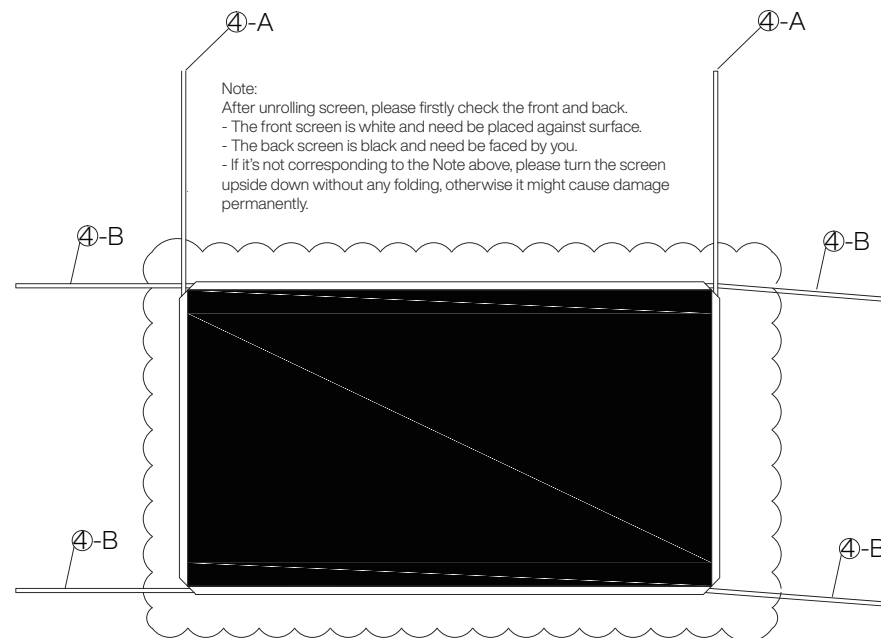

Figure 5



Important note: Please cooperate with two people when assembling, and do not make any actions that may cause the screen to fold or rub against hard objects.

4.0 Assemble screen and inner frame

4.1 Put the assembled frame on the screen. Align the frame with the line marks on the four corners of the screen (Figure 6)

Note: Please make sure the metal frame is put right on the center of the screen.

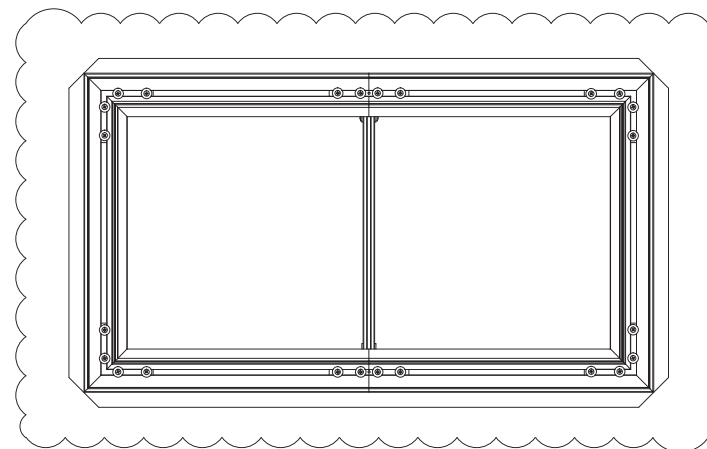
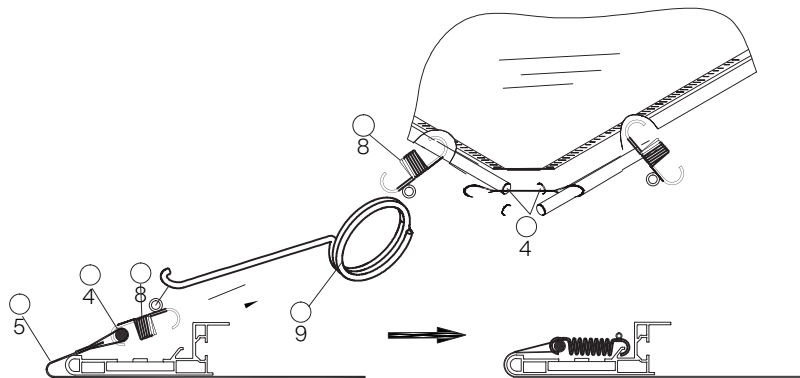

Figure 6

4.2 Adjust the position of the screen and the frame so that the frame is in the middle of the screen, and check the overall flatness of the screen before installing the tension spring.



4.3 Hang the screen on the frame with the tension spring. Please follow the following sequence for hooking tension springs: Firstly install the four corner springs in the order of 1-8; then hang the middle springs 9-12, and finally spring from the middle, and install the other springs symmetrically in turn (Figure 7)

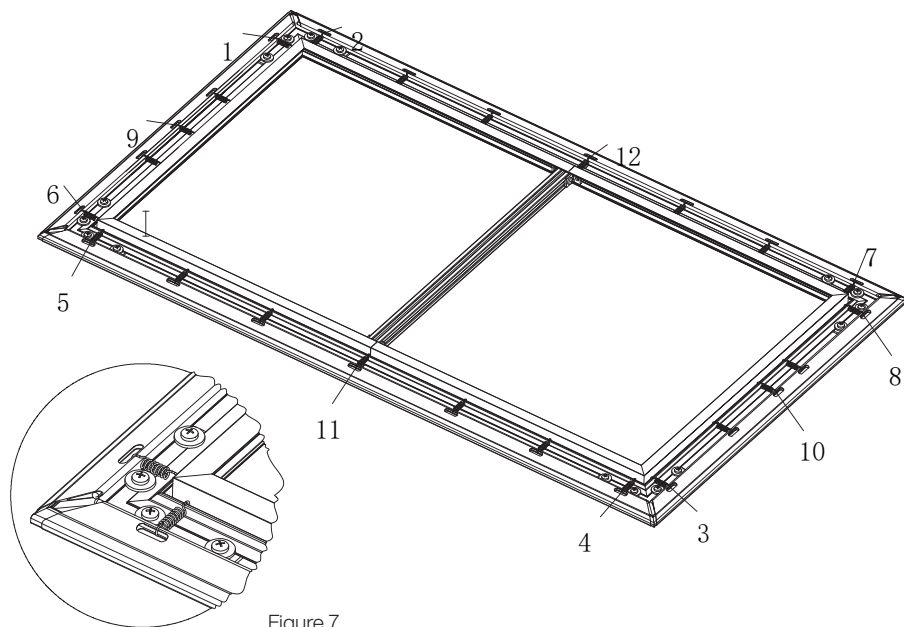

Figure 7

Tips:
Please firstly insert tension spring into the hole of screen, and fix it with Glass Fiber Strip inside.
Then use the hook offered in bag to drag the tension spring to connect with metal edge of inner frame.

Note:
After hooking all tension springs, please check if any one of them loses tension.
If so, please replace them with new ones.

5.0 Outer frame installation

5.1 Splice the outer frame A and outer frame B into a complete frame (Figure 8), and drive the hexagonal studs into the long frame splicing strip (Figure 9)

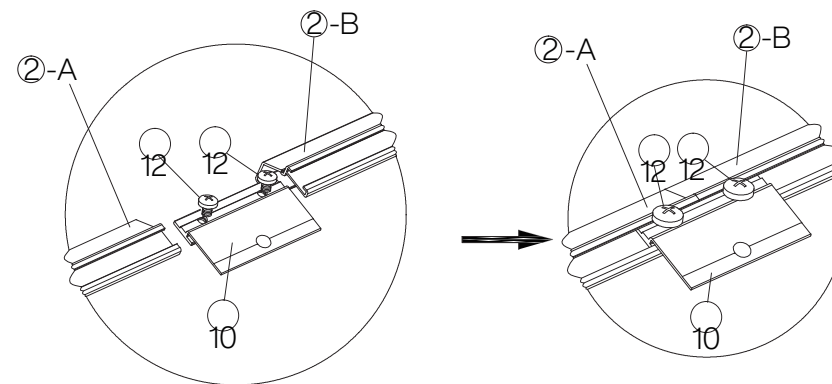

Figure 8

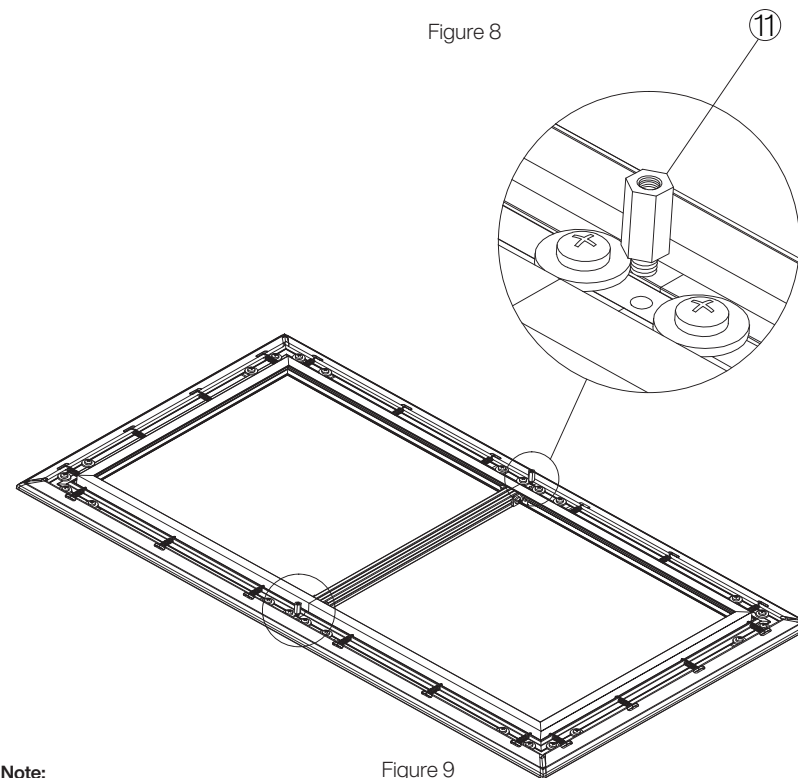

Figure 9

Note:

If you find white screen surface partly wrinkled, please do as follows:
- It might take some hours for slight wrinkles to become totally smooth.
Or, you can smooth slightly-wrinkled part by gloved hand and it will probably recover immediately.
- The stubborn wrinkles can automatically recover by the high elasticity of screen, so it's highly recommended for users to observe for 10 days.
Or, if it still remains wrinkled, please contact the after-sale service team of AWOL VISION for assistance by QR code on the front page at any time.