



Lynx Tip 5 Flow Quizzes User Guide

[Home](#) » [LYNX](#) » Lynx Tip 5 Flow Quizzes User Guide 

Lynx Tip 5 Flow Quizzes User Guide



Creating flow pathways between slides is one of the greatest joys of using Lynx – firstly because of how easy it is to do and, secondly, because the transition effect looks so cool. Here, Gareth explains how to utilise this awesome feature to set up an interactive quiz.

1. The trick with setting up a flow quiz is to write the question on one slide and the possible answers on separate slides. The multiple-choice option will be created thanks to the flow windows later. Check out the four slides I have prepared as an example:



So, the first slide is just an image plus the question text box. The others also have an image (found using the Media search, of course) with text boxes showing the possible answers and another saying whether that option is right or wrong. Notice that I have also added an arrow from the in the Content area.

2. Now it is time to drop a flow link from the answer slides onto the question slide. I need to open the slide viewer by clicking on the icon indicated from the tool bar at the bottom of Lynx Whiteboard:

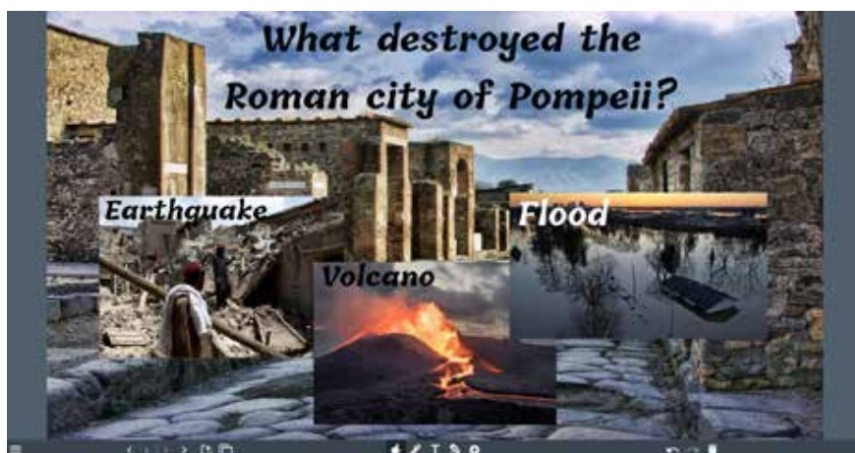
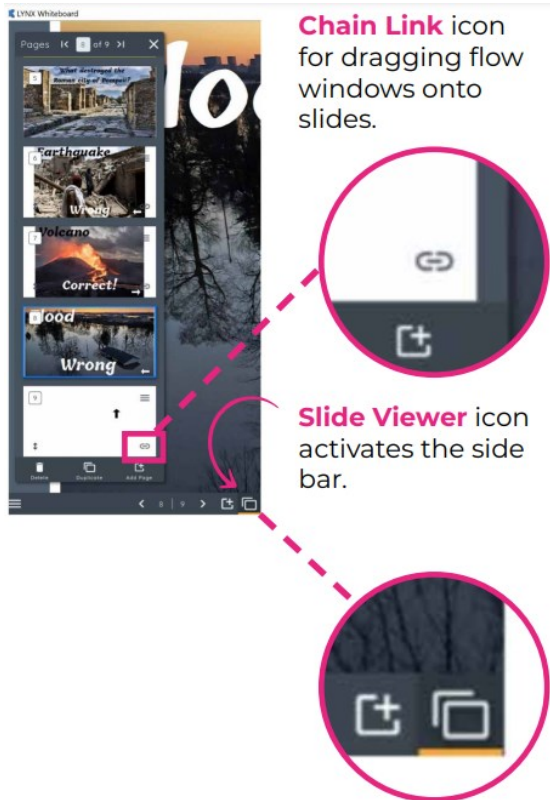

3. By clicking and holding the Chain Link icon on each answer slide, I can drag the tile onto the question tile and drop it there. Eventually, I end up with three flow windows on my question slide, as shown above.
4. While resizing and positioning each flow window, it's clear that I have two issues to sort out. Firstly, the white background to the side of each slide is a little annoying. Secondly, the words Correct and Wrong are visible in the flow windows, making the quiz a lot easier than it should be. Luckily, solving both issues is easy in Lynx Whiteboard.



To solve the visible backgrounds, I click on each flow window to reveal the floating tool bar. Selecting the “Reference Options” icon, I can toggle off “Show Border” and “Show Background Colour”.

5. Next, I head to each of the answer slides. I want to hide the words “Wrong” and “Correct”, as well as the arrows I added. To do this, I repeat the following process on each answer slide. I select the item I want to hide and choose the “Visibility” Eye icon. Then I simply toggle on the “Hide in Preview” button.

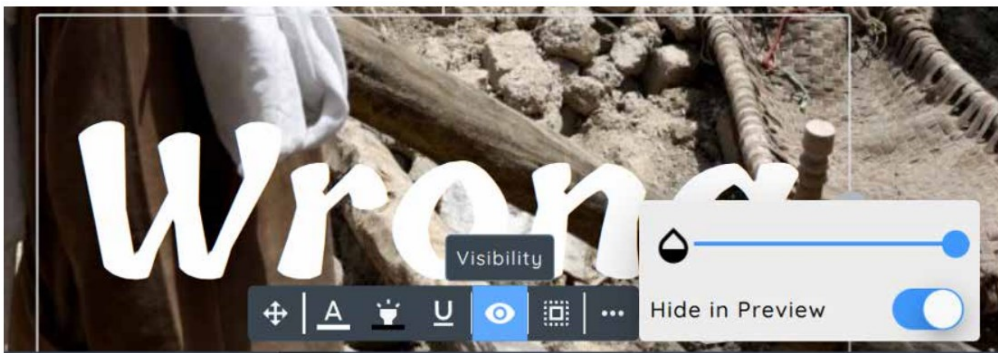

Returning to the question slide, we can now only see the images and the answer options. (See the final image.) But what about those arrows? They are for links to either take us back to the question slide if the wrong answer was chosen, or to advance us to the next question. Creating these links is also easy.

6. From the floating tool bar of each arrow, I open the Three Dots menu and select Link. This opens the hyperlink window, from where I can select the slides I would like each arrow to direct the user to. • Replicator Editable Link e presenting →

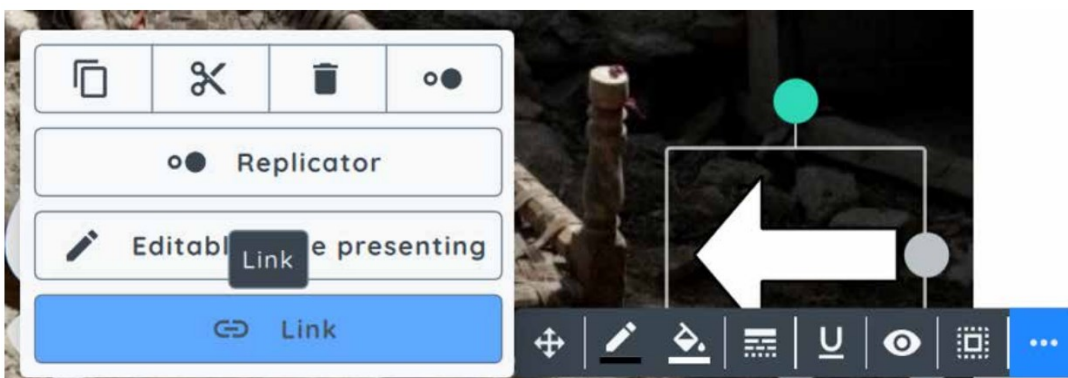

7. Click OK twice to set the link and I’m all set. Naturally, I need to repeat this process for other questions; but before long I’ll have an engaging quiz that children can flow through in Presentation Mode. Link Select file Clear Select slide Select action

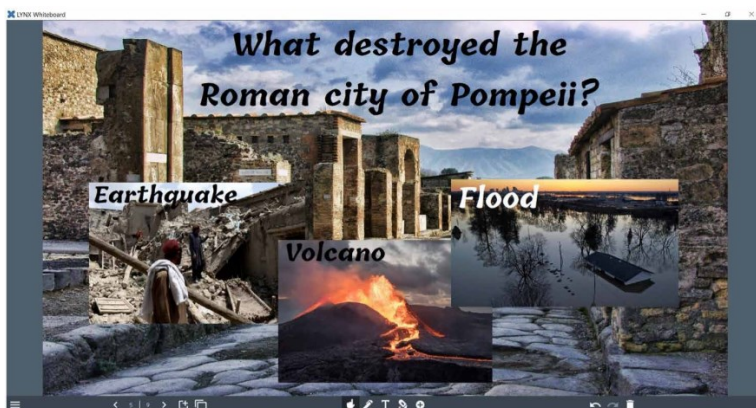
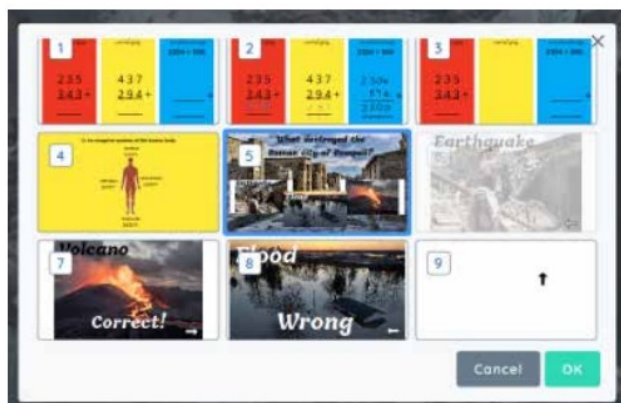

Documents / Resources

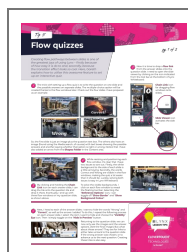

[Lynx Tip 5 Flow Quizzes](#) [pdf] User Guide
Tip 5 Flow Quizzes, Tip 5, Flow Quizzes, Quizzes