



Ixnav LX G-meter Standalone Digital Meter With Built In Flight Recorder User Manual

[Home](#) » [Ixnav](#) » Ixnav LX G-meter Standalone Digital Meter With Built In Flight Recorder User Manual 

Contents

- 1 Ixnav LX G-meter Standalone Digital Meter With Built-In Flight Recorder
- 2 Specifications
- 3 Limited Warranty
- 4 Installation
- 5 LXNAV G-meter Basics
- 6 System Description
- 7 System Description
- 8 Operating Modes
- 9 Setup Mode
- 10 Limits
- 11 About
- 12 Wiring and static ports
- 13 Firmware Update
- 14 Wiring and Static Ports
- 15 FAQs
- 16 Documents / Resources
 - 16.1 References
- 17 Related Posts



Ixnav LX G-meter Standalone Digital Meter With Built-In Flight Recorder



Specifications

- Product Name: LX G-meter
- Type: Standalone digital G-meter with built-in flight recorder
- Manufacturer: LXNAV
- Dimensions: Standard 57mm cut-out
- Power Supply: Compatible with any FLARM device with RJ12 connector, recommended fuse 1A

Important Notices

The LXNAV G-METER system is designed for VFR use only. All information is presented for reference only. It is ultimately the pilot's responsibility to ensure that the aircraft is being flown by the manufacturer's aircraft flight manual. The g-meter must be installed by applicable airworthiness standards according to the country of registration of the aircraft.

Information in this document is subject to change without notice. LXNAV reserves the right to change or improve their products and to make changes in the content of this material without the obligation to notify any person or organization of such changes or improvements.



A Yellow triangle is shown for parts of the manual which should be read carefully and are important for operating the LXNAV G-METER system.



Notes with a red triangle describe procedures that are critical and may result in loss of data or any other critical situation.



A bulb icon is shown when a useful hint is provided to the reader.

Limited Warranty

This LXNAV g-meter product is warranted to be free from defects in materials or workmanship for two years from the date of purchase. Within this period, LXNAV will, at its sole option, repair or replace any components that fail in normal use. Such repairs or replacement will be made at no charge to the customer for parts and labour, the customer shall be responsible for any transportation cost. This warranty does not cover failures due to abuse, misuse, accident, or unauthorized alterations or repairs.

THE WARRANTIES AND REMEDIES CONTAINED HEREIN ARE EXCLUSIVE AND INSTEAD OF ALL OTHER WARRANTIES EXPRESSED OR IMPLIED OR STATUTORY, INCLUDING ANY LIABILITY ARISING UNDER ANY WARRANTY OF MERCHANTABILITY OR FITNESS FOR A PARTICULAR PURPOSE, STATUTORY OR OTHERWISE. THIS WARRANTY GIVES YOU SPECIFIC LEGAL RIGHTS, WHICH MAY VARY FROM STATE TO STATE.

IN NO EVENT SHALL LXNAV BE LIABLE FOR ANY INCIDENTAL, SPECIAL, INDIRECT, OR CONSEQUENTIAL DAMAGES, WHETHER RESULTING FROM THE USE, MISUSE, OR INABILITY TO USE THIS PRODUCT OR FROM DEFECTS IN THE PRODUCT. Some states do not allow the exclusion of incidental or consequential damages, so the above limitations may not apply to you. LXNAV retains the exclusive right to repair or replace the unit or software or to offer a full refund of the purchase price at its sole discretion. SUCH REMEDY SHALL BE

YOUR SOLE AND EXCLUSIVE REMEDY FOR ANY BREACH OF WARRANTY.

To obtain warranty service, contact your local LXNAV dealer or contact LXNAV directly.

Packing Lists

- LXNAV g-Meter
- Power supply cable
- Calibration chart by MIL-A-5885 paragraph 4.6.3 (Optional)

Installation

The LXNAV G-meter requires a standard 57mm cut-out. Ensure the power supply scheme is compatible with any FLARM device with an RJ12 connector. The recommended fuse is 1A. The back of the unit has two pressure ports with dedicated labels indicating their functions.

More about pinout and pressure port connections is available in Chapter 7: Wiring and static ports.



Pressure ports are available only in the "FR" version

Cut-Outs

Cut-Out for LXNAV G-meter 57

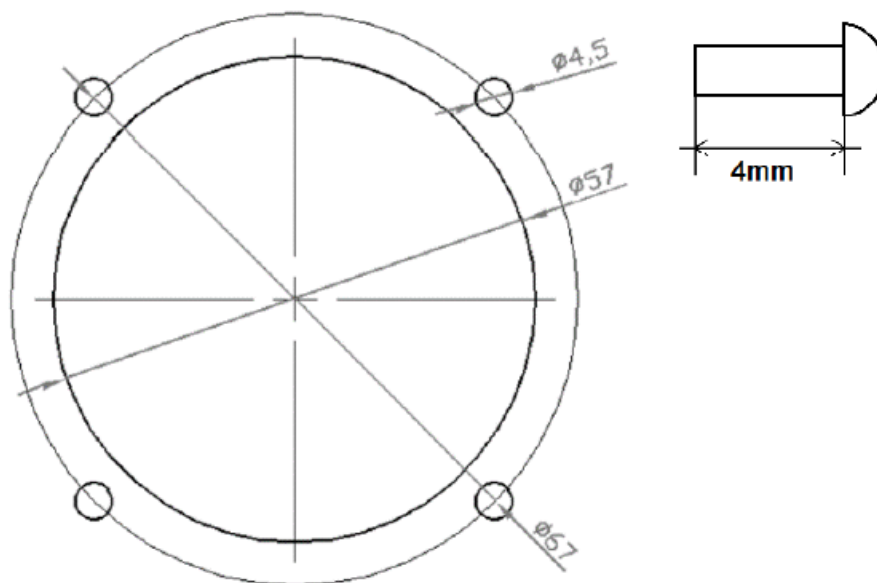

The length of the screw is limited to maximum 4mm!

Cut-Out for LXNAV G-meter 80

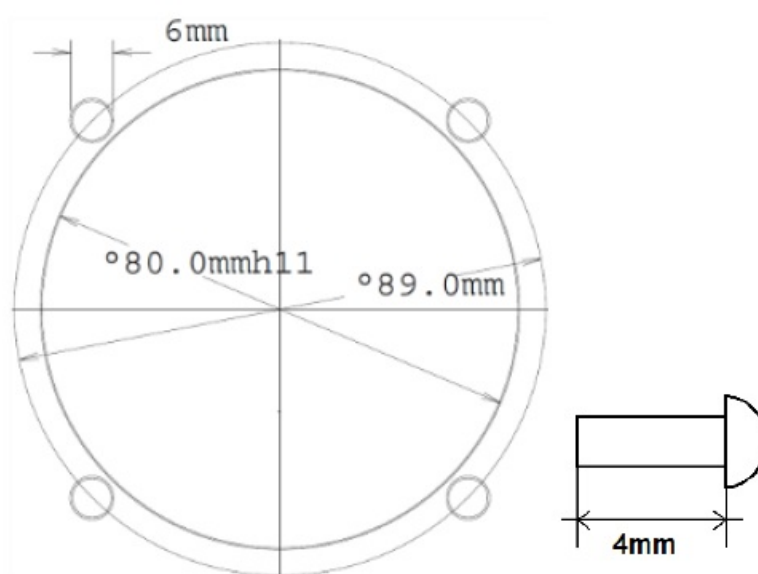

The drawing is not to scale



Length of screw is limited to max 4mm!

LXNAV G-meter Basics

The LXNAV G-meter at a Glance

The LXNAV g-meter is standalone unit designed to measure, indicate and log g-forces. The unit has standard dimensions that will fit into the instrument panel with an opening of 57 mm diameter.

The unit has an integrated high precision digital pressure sensor and inertial system. The sensors are sampled

more than 100 times per second. Real Time Data is displayed on a QVGA 320×240 pixel 2.5-inch high brightness colour display. To adjust values and settings the LXNAV g-meter has three push buttons.

LXNAV G-meter Features

- An extremely bright 2.5" QVGA colour display readable in all sunlight conditions with the ability to adjust the backlight
- 320×240 pixels colour screen for additional information such as minimum and maximum g-force
- Three push buttons are used for input
- G-force up to +-16G
- Built-in RTC (real-time clock)
- Logbook
- 100 Hz sampling rate for very fast response.
- 57mm (2.25") or 80mm(3.15") version

Interfaces

- Serial RS232 input/output
- Micro SD card

Technical data

Parameter	Symbol	Min	Typ	Max	Units
Power Supply	Power	8.0	12.0	32.0	V
Consumption at 12V	Current	90	120	140	mA
Max range	G	-16		+16	G (m/s ²)
G-force Accuracy	G	-0.1		+0.1	G (m/s ²)
FR memory (Ext. Micro SD card)			16Gb		
Airspeed measurement				325	km/h
Airspeed measurement				175	kts
Airspeed accuracy	-2			+2	km/h
Airspeed accuracy	-1			+1	Kts
RTC accuracy	Time	-100		+100	ppm



The airspeed sensor is not calibrated as it is used only for detecting the start and end of the flight. The measurement of the airspeed may be inaccurate.

G-meter57

- Power input 8-32V DC
- Consumption 90-140mA@12V

- Weight 195g
- Dimensions: 57 mm (2.25") cut-out
- 62x62x48mm Power input 8-32V DC
Consumption 90-140mA@12V
Weight 315g
Dimensions: 80 mm (3,15") cut-out
80x81x45mm

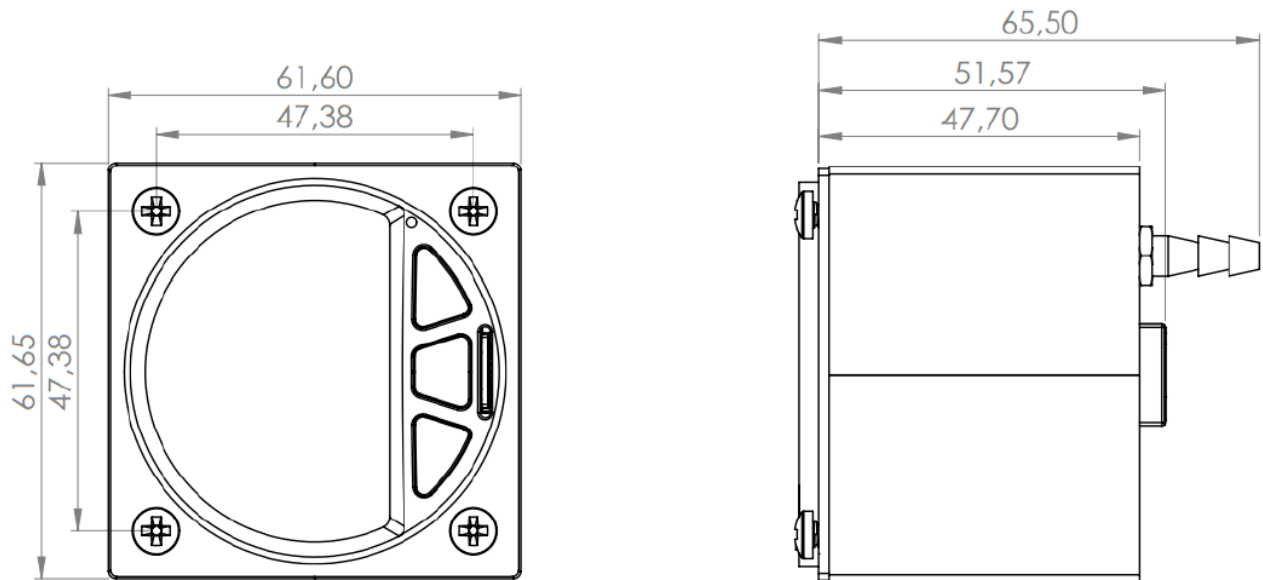

G-meter80

- Power input 8-32V DC
- Consumption 90-140mA@12V
- Weight 315g
- Dimensions: 80 mm (3,15") cut-out
- 80x81x45mm

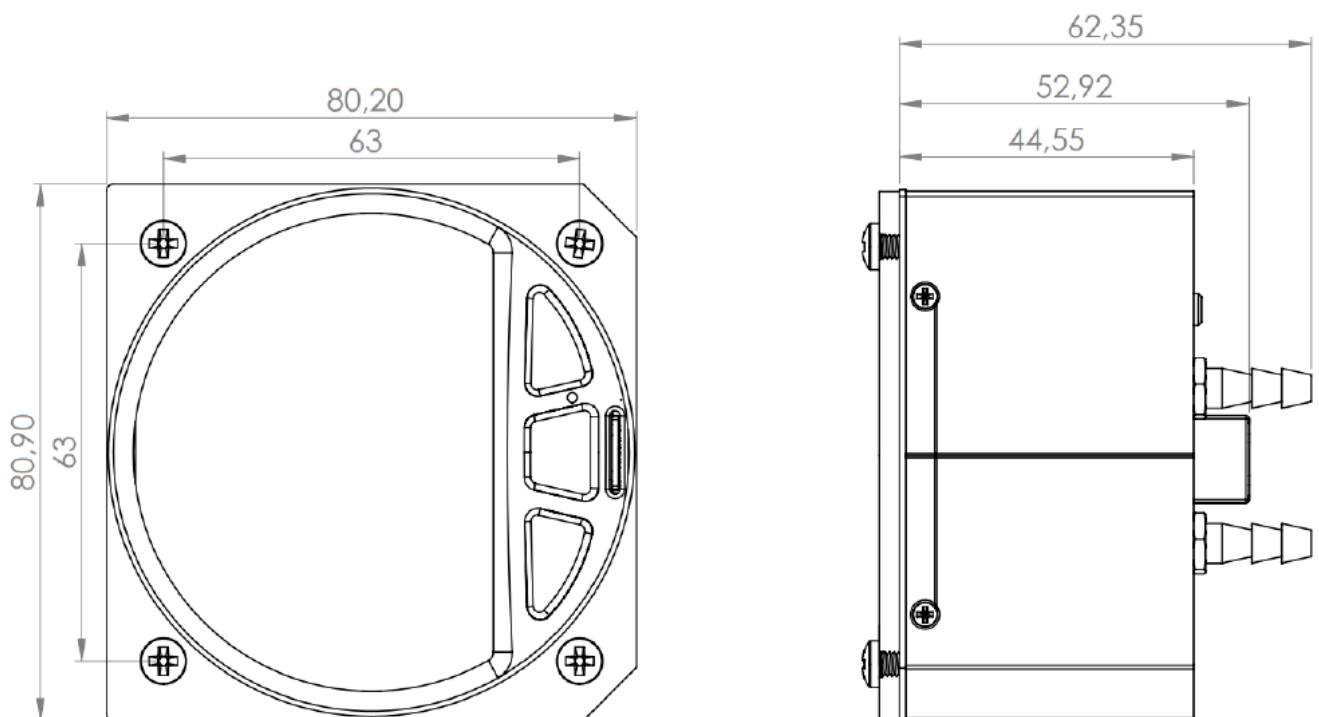

System Description

Push Button

LXNAV G-meter has three push buttons. It detects short or long presses of the push button. A short press means just a click; a long press means pushing the button for more than one second.

The three buttons between have fixed functions. The top button is ESC (CANCEL), the middle button is to switch between modes, and the lower button is the ENTER (OK) button. The upper and lower buttons are also used to rotate between subpages in the WPT and TSK modes.

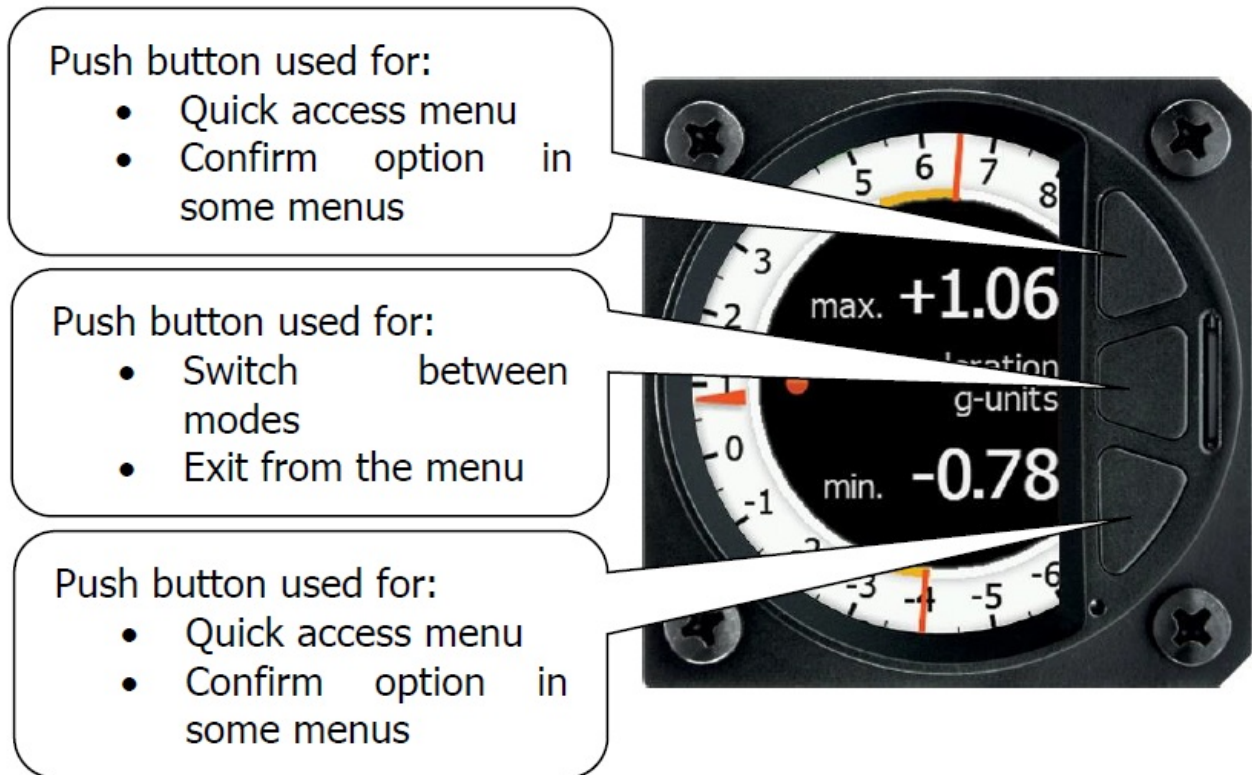

Flight recorder (FR) version

G-meter FR can also record flights. If FR is enabled, Logbook mode is available, as well as the option to transfer flight data recordings (.igc) files via an SD card. Please note that although the G-meter has a flight recorder and files are in .igc format, the device is not IGC certified (it can't be used for soaring competitions or records claims). Only G-force data and IASares were recorded. IGC logs are stored internally in the unit. Recorder IAS is not calibrated and may not indicate the real values.

SD card

SD card is used for updates and transfer logs. To update device simply copy update file to SD card and restart the device. You will be prompt for an update. For normal operation, it is not necessary to have SD card inserted.



A micro SD card is not included with the new G-meter.

Switching on the Unit

The unit will power on and will be ready for immediate use.

User Input

The LXNAV G-meter user interface consists of dialogues which have various input controls. They are designed to make the input of names, parameters, etc., as easy as possible.

Input controls can be summarized as

- Text editor
- Spin controls (Selection control)

- Checkboxes
- Slider control

Text Edit Control

The Text Editor is used to input an alphanumeric string; the picture below shows typical options when editing text/numbers. Use the upper and lower button to change the value at the current cursor position.

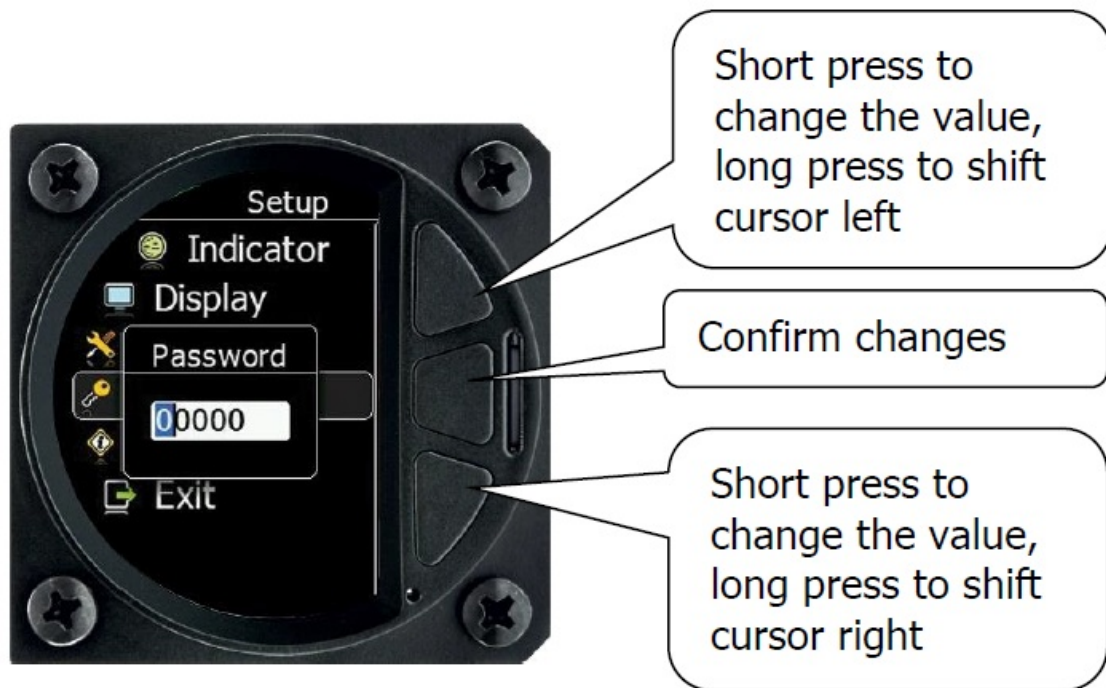

Once the required value is selected, long-press the lower push button to move to the next character selection. To move back to the previous character, long-press the upper push button. When you have finished editing, press the middle push button. A long press of the middle push button exits from the edited field ("control") without any changes.



Selection Control

Selection boxes, also known as combo boxes, are used to select a value from a list of predefined values. Use the top or bottom button to scroll through the list. With middle button confirms the selection. Long press to the middle button to cancel changes.



Checkbox and Checkbox List

A checkbox enables or disables a parameter. Press the middle button to toggle the value. If an option is enabled, a check mark will be displayed, otherwise, an empty rectangle will be displayed.

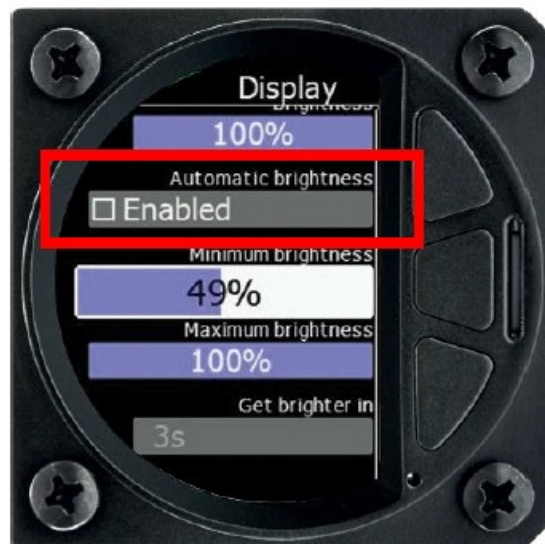

Slider Selector

Some values, such as volume and brightness, are displayed as a slider icon.

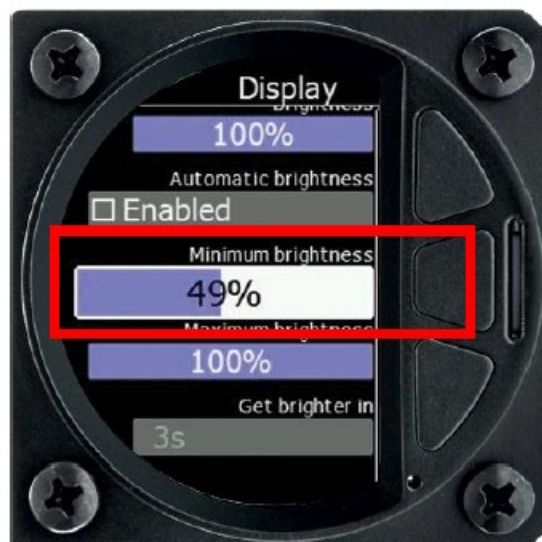

With a push of the middle button, you can activate the slide control and then by pushing top and bottom button you can select the preferred value and confirm it via the middle button.

Switching Off

The unit will switch off when no external power supply is present.

System Description

The unit features a push button, flight recorder (FR) version, SD card slot, and user input controls including text edit control, selection control, checkbox options, slider selector, etc. To switch on the unit, follow the specified procedure. User input controls allow for various settings adjustments.

Operating Modes

The LXNAV G-meter operates in main mode for regular usage. Access the quick access menu for immediate settings changes. Enter the setup mode to customize logbook entries, indicators, display settings like brightness and night mode darkness, hardware configurations, passwords, and system information.

The LXNAV G-meter has two operating modes: Main mode and Setup mode.

Main Mode



Setup Mode



- Main mode: Shows g-force scale, with maximums and minimums.
- Setup mode: For all aspects of the setup of the LXNAV g-meter.

With the up or down menu, we will enter the quick access menu.



Main mode



Quick Access Menu

In the quick access menu, we can reset the maximum displayed positive and negative g-load or switch to night mode. The user must confirm switching to night mode. If it is not confirmed in 5 seconds, it will switch back to normal mode.



Setup Mode

Logbook

The logbook menu displays the list of flights. If the RTC time is set properly the take-off and landing time shown will be correct. Each flight item consists of the maximum positive g-load, the maximum negative g-load from the flight and the maximum IAS.

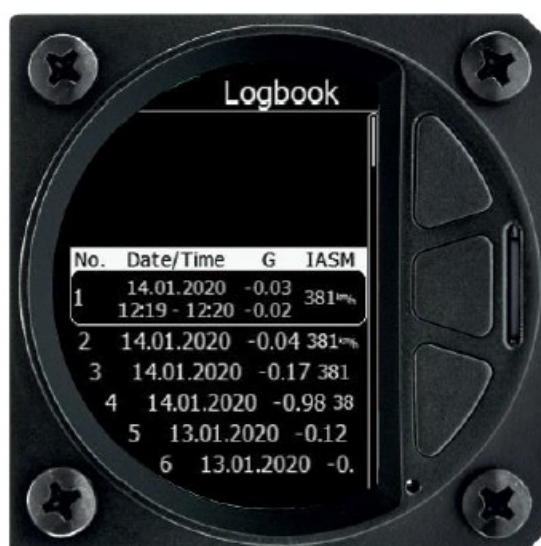

This function is available only with the "FR" version.

Indicator

The needle range can be set between 8g, 12g and 16g. The theme and needle type can be also adjusted in this menu.



Display



Automatic Brightness

If the Automatic Brightness box is checked the brightness will be automatically adjusted between the minimum and maximum parameters set. If the Automatic Brightness is unchecked the brightness is controlled by the brightness setting.

Minimum Brightness

Use this slider to adjust the minimum brightness for the Automatic Brightness option.

Maximum Brightness

Use this slider to adjust the maximum brightness for the Automatic Brightness option.

Get Brighter In

The user can specify in which period the brightness can reach the required brightness.

Get Darker In

The user can specify in which period the brightness can reach the required brightness.

Brightness

With the Automatic Brightness unchecked, you can set the brightness manually with this slider.

Night Mode Darkness

Set the percentage of the brightness to be used after pressing the NIGHT mode button.

Hardware

The hardware menu consists of three items:

- Limits
- System time
- Airspeed offset



Limits

In this menu user can set the limits of indicator

- The minimum red zone limit is a red marker for maximum negative g-load
- Max red zone limit is red marker for maximum positive g-load
- The warning zone minimum is a yellow area of caution for negative g-load
- The warning zone max is a yellow area of caution for positive g-load



force sensor works up to $\pm 16g$.

System Time

In this menu the user can set the local time and date. Available is also an offset from UTC. UTC is used within the flight recorder. All flights are logged in UTC.

Airspeed Offset

In case of any drift of the airspeed pressure sensor, the user can adjust the offset, or align it to zero.



Do not do autozero when airborne!

Password



- 01043 – Auto zero of the pressure sensor
- 32233 – Format device (all data will be lost)
- 00666 – Reset all settings to factory default
- 16250 – Show debug info
- 99999 – Delete complete logbook

Logbook deletion is PIN-protected. Each owner of the unit has their own unique PIN code. Only with this pin code is it possible to delete the logbook.

About

The About screen displays the serial number of the unit and the firmware version.



Wiring and static ports

Pinout

The power connector is pin-compatible with S3 power or any other FLARM cable with an RJ12 connector.

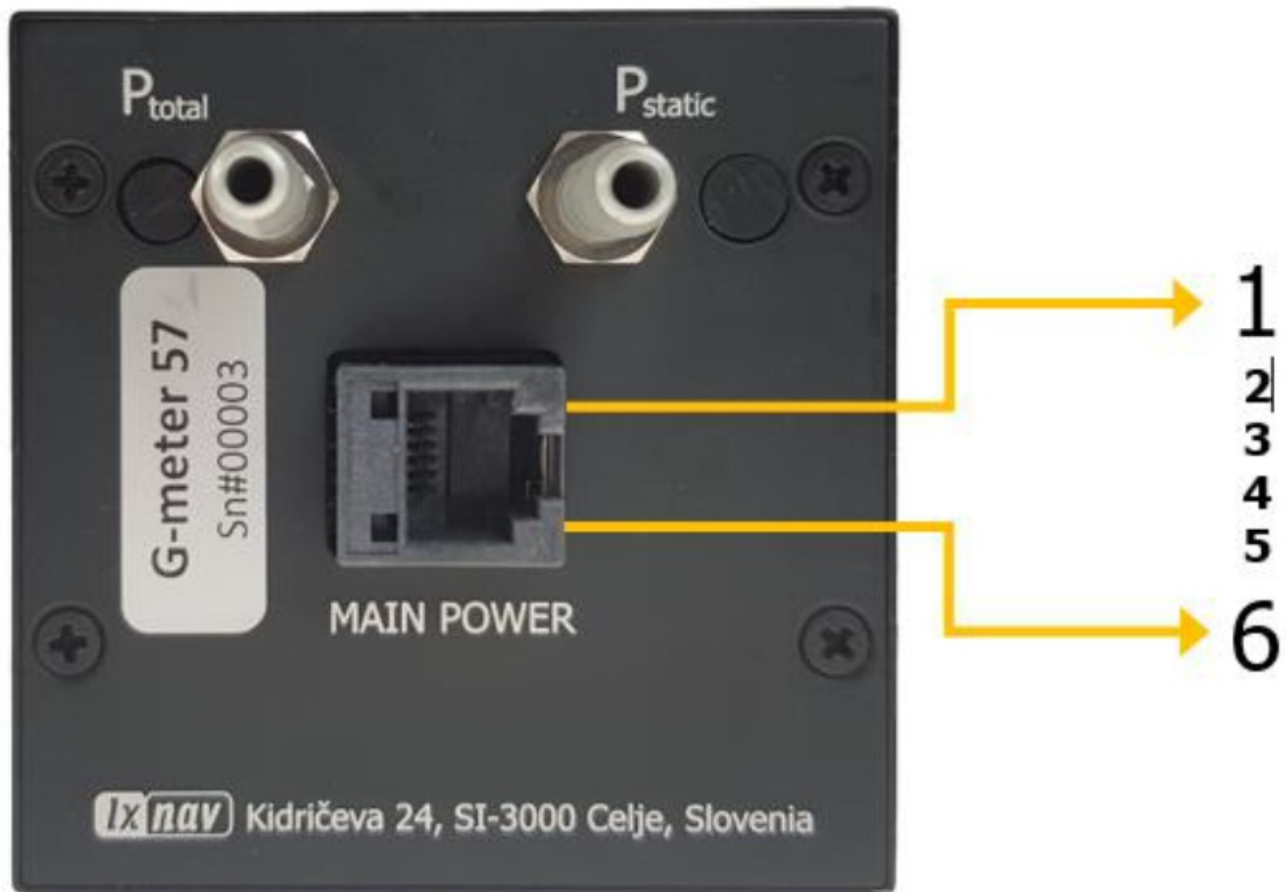

Pin Number	Description
1	Power supply input
2	No connection
3	Ground
4	RS232 RX (data in)
5	RS232 TX (data out)
6	Ground

Static ports connection

Two ports are on the back of the G-meter unit:

- P_{static} static pressure port
- P_{total} pitot or total pressure port

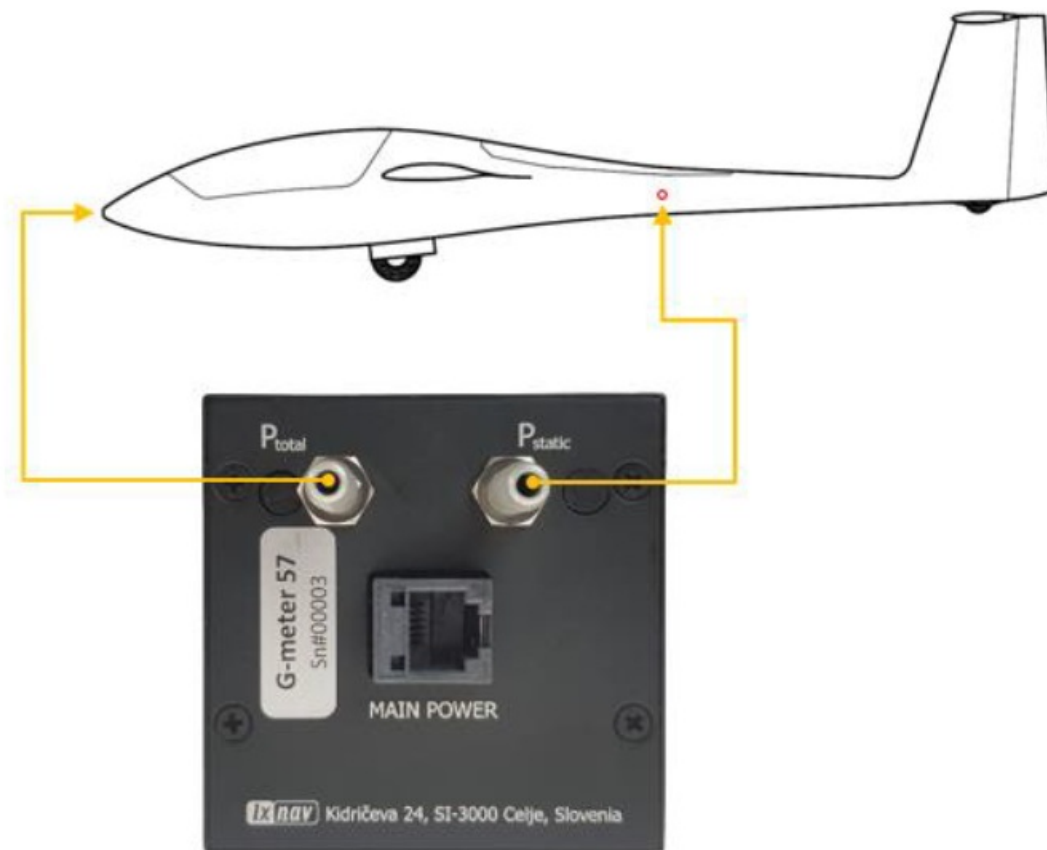

Static ports are used for the purposes of flight logger. Without static ports connected device will still have all other functionalities.

Firmware Update

Firmware updates of the LXNAV G-meter can be easily carried out using the SD card. Please visit our [webpage www.lxnav.com](http://www.lxnav.com) and check for the updates.

You can also subscribe to a newsletter to receive news about the LXNAV G-meter updates automatically. Information about the new version, including changes to ICD protocol, can be found in the release notes at <https://gliding.lxnav.com/lxdownloads/firmware/>.

Updating LXNAV G-meter

- Download the latest firmware from our website, section downloads/firmware <http://www.lxnav.com/download/firmware.html>.
- Copy the ZFW file to G-meter's SD card.
- G-meter will ask you to confirm the update.
- After confirmation, the firmware update will take a few seconds, and then G-meter will restart.

Incomplete Update Message

If you get an incomplete update message, you need to unzip the ZFW firmware file and copy the content to the SD card. Insert it into the unit and power on.



If you can't unzip the ZFW file, please rename it to ZIP first.

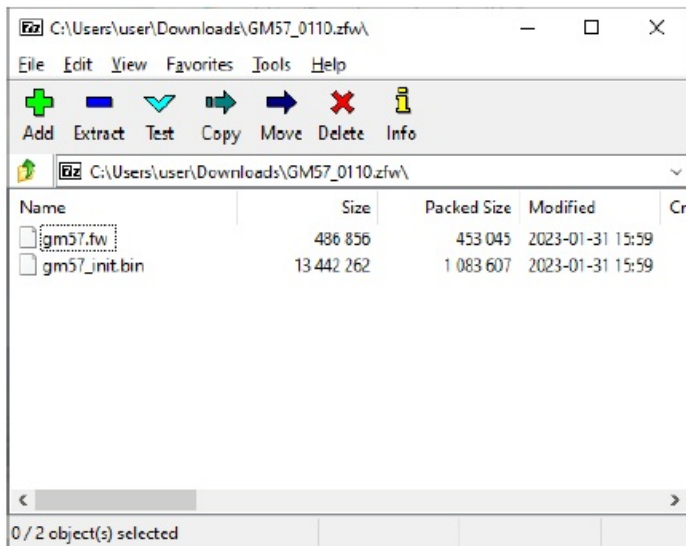

The ZFW file contains 3 files:

- GMxx.fw
- GMxx_init.bin

If GMxx_init.bin is missing, the following message will appear: "Incomplete update ..."

Revision history

Rev	Date	Comments
1	April 2020	Initial release
2	April 2020	Review of English language content
3	May 2020	Updated chapter 7
4	May 2020	Updated chapter 6.3.4.1
5	September 2020	Updated chapter 6
6	September 2020	Updated chapter 3
7	September 2020	Style update
8	September 2020	Corrected chapter 5.5, updated chapter 2
9	November 2020	Added chapter 5.2
10	January 2021	Style update
11	January 2021	Added chapter 3.1.2
12	February 2021	Updated chapter 4.1.3
13	April 2021	Added chapter 5.2, updated chapter 5.5.4, 7.2
14	August 2021	Updated ch. 4.1.3
15	January 2023	Updated Ch. 5.2
16	January 2023	Updated ch. 4.1.3, 5.2
17	January 2024	Updated ch. 4.1.3, 4.1.1
18	February 2024	Updated ch. 6.3.2
19	May 2024	Updated ch. 4.1.3
20	August 2024	Added ch. 8

Wiring and Static Ports

Refer to the provided pinout for wiring connections. Ensure proper connection of static ports for accurate readings.

LXNAV

- Kidriceva 24, SI-3000 Celje, Slovenia
- T: +386 592 334 00 |
- F: +386 599 335 22 |
- info@lxnav.com
- www.lxnav.com

FAQs

Q: Can the LX G-meter be used for IFR flights?

A: No, the LX G-meter is designed for VFR use only.

Q: How can I obtain warranty service?

A: Contact your local LXNAV dealer or LXNAV directly for warranty service.

Documents / Resources

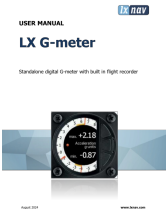
	<p>lxnav LX G-meter Standalone Digital Meter With Built In Flight Recorder [pdf] User Manual LX G-meter Standalone Digital Meter With Built In Flight Recorder, LX G-meter, Standalone Digital Meter With Built In Flight Recorder, Meter With Built In Flight Recorder, In Flight Recorder, Flight Recorder</p>
-----------------------------------------------------------------------------------	----------------------------------------------------------------------------------------------------------------------------------------------------------------------------------------------------------------------------------------------------------------------------------------------------------------------------------

References

- [lx LXNAV Gliding](#)
- [lx Firmware • LXNAV Gliding](#)
- [lx Firmware • LXNAV Gliding](#)
- [User Manual](#)

[Manuals+](#), [Privacy Policy](#)

This website is an independent publication and is neither affiliated with nor endorsed by any of the trademark owners. The "Bluetooth®" word mark and logos are registered trademarks owned by Bluetooth SIG, Inc. The "Wi-Fi®" word mark and logos are registered trademarks owned by the Wi-Fi Alliance. Any use of these marks on this website does not imply any affiliation with or endorsement.