

LUXSWAY

DY103IR-12C LED RGB
STRIP LIGHT



LUXSWAY DY103IR-12C LED RGB Strip Light Instruction Manual

[Home](#) » [LUXSWAY](#) » LUXSWAY DY103IR-12C LED RGB Strip Light Instruction Manual 

Contents

- 1 LUXSWAY DY103IR-12C LED RGB Strip Light
- 2 INTRODUCTION
- 3 SPECIFICATIONS
- 4 WHAT'S IN THE BOX
- 5 PRODUCT REMOTE
- 6 FEATURES
- 7 SETUP GUIDE
- 8 CARE & MAINTENANCE
- 9 TROUBLESHOOTING
- 10 PROS & CONS
- 11 WARRANTY
- 12 FREQUENTLY ASKED QUESTIONS
- 13 References

LUXSWAY

LUXSWAY DY103IR-12C LED RGB Strip Light



INTRODUCTION

Any indoor space can be improved with the adaptable and fashionable LUXSWAY DY103IR-12C LED RGB Strip Light. This LED strip, which has 12 RGB colors and white light, is ideal for practical illumination, mood lighting, and decoration. It is extremely energy-efficient, using only 6 watts of power to produce a 700-lumen output with 20 super-bright white LEDs and 20 RGB LEDs.

With the use of an infrared (IR) remote control, users can easily change the lighting modes, brightness, and color of the device, which runs on a 110V AC power source. Screws or a magnetic base can be used to mount the strip, giving you flexibility for different installation requirements. The LUXSWAY LED RGB Strip Light, which retails for \$25.99, was initially made available on February 5, 2021. It is produced by LUXSWAY, a reputable brand in cutting-edge lighting solutions.

SPECIFICATIONS

Brand	LUXSWAY
Price	\$25.99
Power Source	AC
Connectivity Technology	IR
Bulb Shape Size	T6 1/2
Mounting Type	Screw-in or Magnetic
Lighting Method	12 RGB Colors + White
Voltage	110 Volts (AC)
Brightness	700 Lumen
Wattage	6 Watts
Bulb Features	20 LEDs Super White + 20 RGB LEDs
Color Temperature	4000 Kelvin
Average Life	30,000 Hours
Product Dimensions	1.1 x 17.7 x 1.1 inches
Weight	10.23 ounces
Item Model Number	DY103IR-12C
Date First Available	February 5, 2021
Manufacturer	LUXSWAY



WHAT’S IN THE BOX

- LED RGB Strip Light
- Manual

PRODUCT REMOTE

Increases brightness & speed up
Flash/Strobe/Fade/Smooth Mode
(Level 1-5)

Decreases brightness & slow down
Flash/Strobe/Fade/Smooth Mode
(Level 1-5)



FEATURES

- **Super Bright LED Lighting:** With 20 RGB LEDs and 20 white SMD LEDs, this lighting system has a 700-lumen total brightness.
- **Adjustable Brightness:** Users can alter the lighting intensity by adjusting the brightness between 1% and 100%.
- **Twelve Color Choices:** It has a 4000K white light option and 12 different RGB color options.
- **Operation by Remote Control:** A 24-key remote control is included for simple color and brightness adjustments.
- **Four Dynamic Lighting Modes:** For a personalized atmosphere, there are four dynamic lighting modes: FLASH, STROBE, FADE, and SMOOTH.
- **Integrated Timer Function:** Configure the light to switch off on its own in one, two, three, or four hours.
- **Memory Function:** When the light is turned on again, it remembers the last setting it was on.
- **AC Adapter Powered:** Stable and reliable lighting is provided by an AC adapter that operates between 100 and 240V.
- **Long Power Cable:** A 65-inch power cable is included for convenience and adaptability.
- **Magnetic Mounting Option:** For tool-free installation, it comes with two magnets and four metal mounting plates.
- **Screw Mounting Option:** Four screws and four mounting clips are included for long-term installation.
- **Ultra-Thin Profile:** Its 1.1-inch thickness makes it perfect for desk, shelf, or under-cabinet installations.
- **Broad Remote Range:** It may be easily controlled from a distance of up to 20 feet.
- **Energy-Efficient LED Technology:** This lighting system is economical because it only requires 6 watts of power.
- **Long LED Lifespan:** LED lights have a 30,000-hour lifespan, which guarantees their dependability and durability.

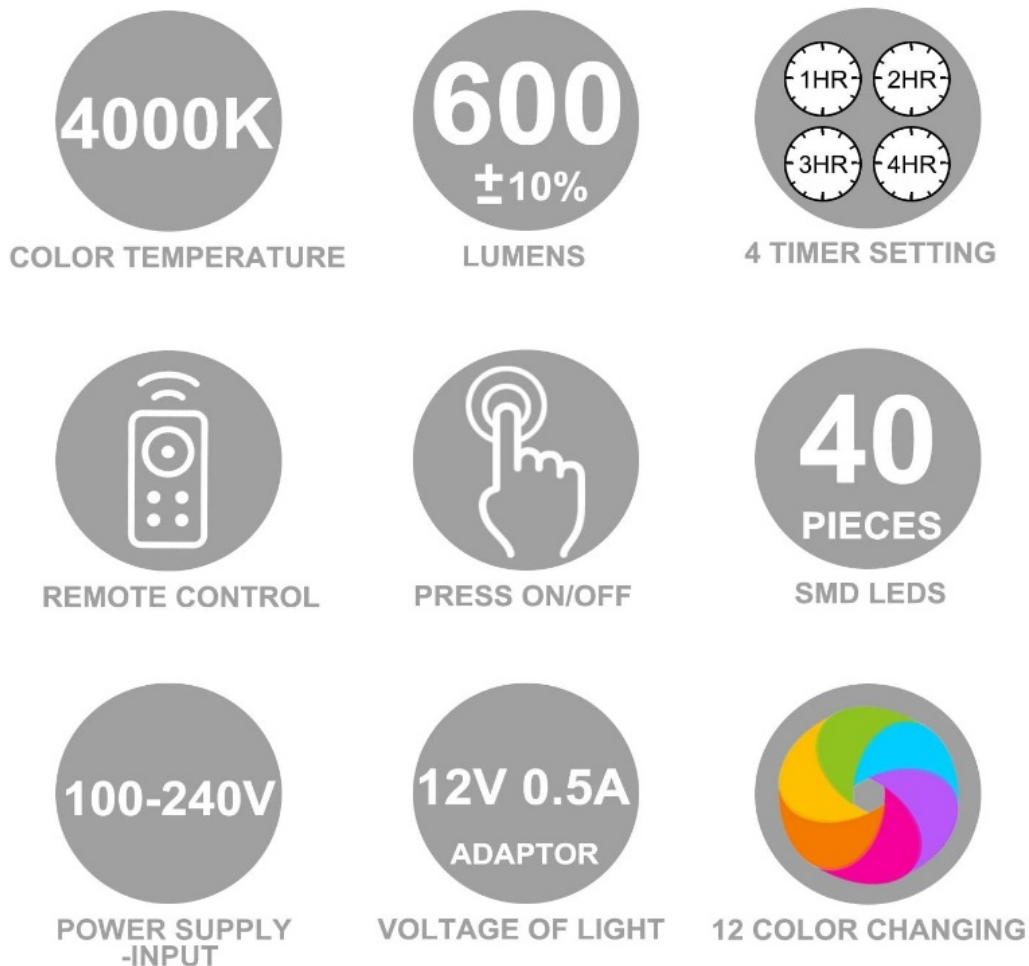

SETUP GUIDE

- **Unpack the Light Strip:** Take out the mounting accessories, power adapter, remote control, and light bar from the box.
- **Select the Installation Location:** Under cabinets, desks, shelves, or counters are the best options.
- **Select a Mounting Method:** Depending on the surface, choose either screw or magnetic mounting.
- **Clean the Surface:** To improve adhesion, wipe off the installation area to get rid of any dust or oil.
- **Magnetic Mounting (Option 1):** Mount the light bar to a metal surface using the included metal mounting plates.
- **Adhesive Tape Installation (Option 2):** Apply the 3M double-sided tape that comes with the metal mounting plates to a non-metal surface.
- **Screw Mounting (Option 3):** For a secure installation, use the screws and mounting clips included with the product.

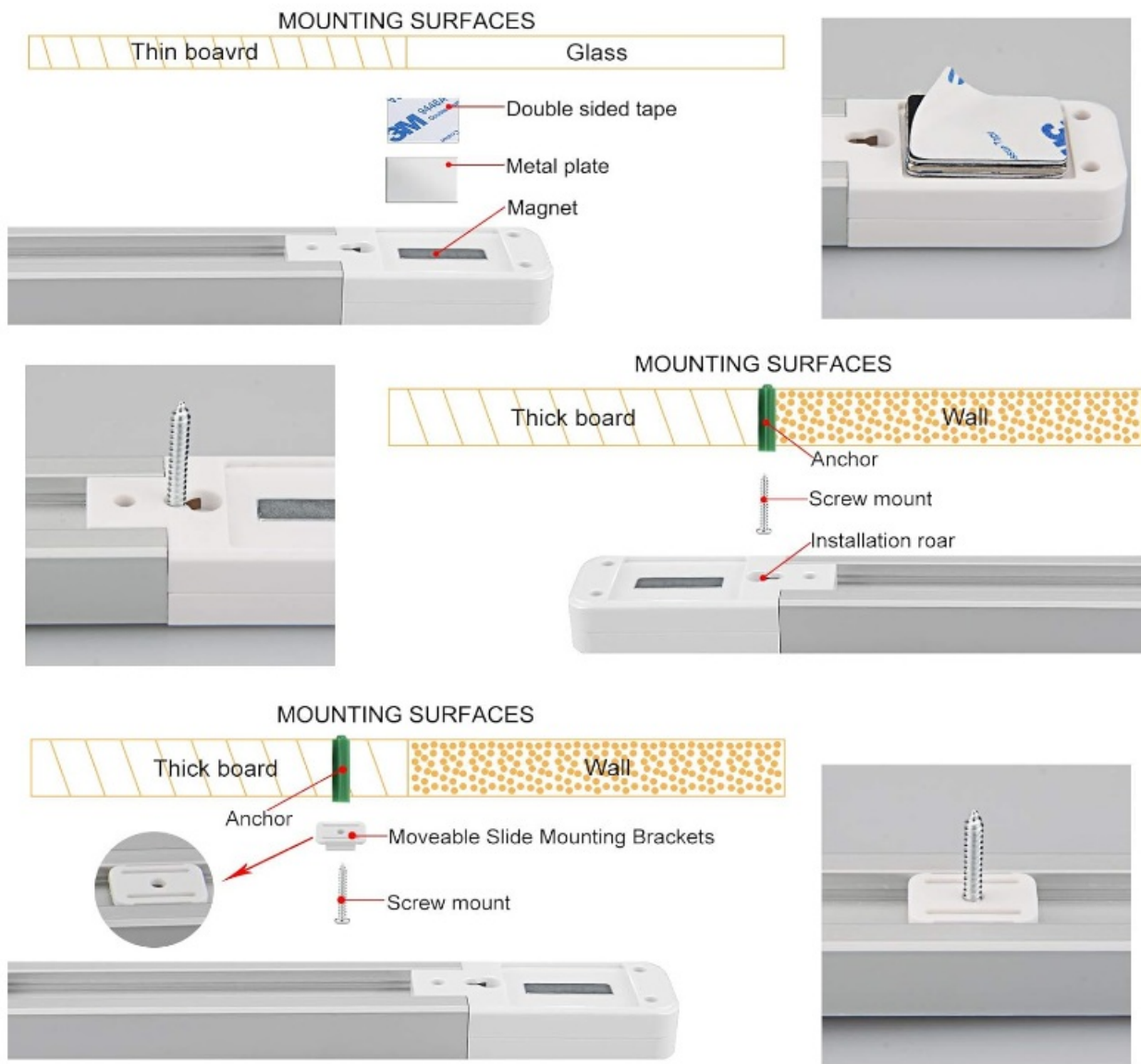

- **Attach the Power Adapter:** Plug in the 65-inch power wire to connect the light bar to a power outlet.
- **Turn on the Light:** Press the ON button on the light bar or remote control.

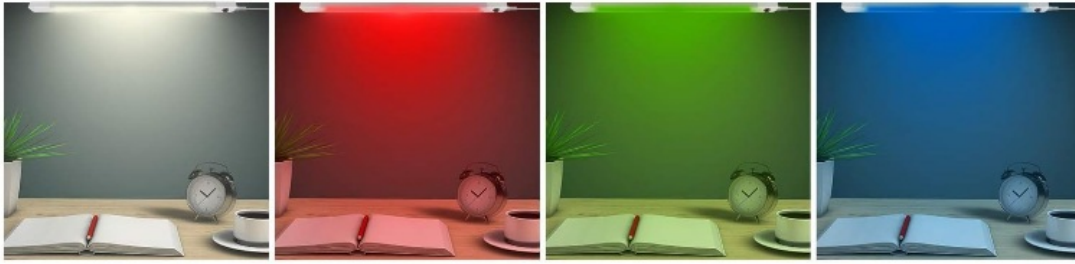

Press button to ON warm white/
red/green/blue & OFF

Remote control included
On/Off/dimmer/12 color
changing/timer/flash/strobe/
fade/smooth features



- **Choose a Color Mode:** Utilize the remote control to select from 12 RGB colors or 4000K white light.
- **Adjust Brightness Levels:** To change the intensity from 1% to 100%, press the brightness controls.
- **Change the Lighting Modes:** For dynamic effects, select FLASH, STROBE, FADE, or SMOOTH.
- **Set the Timer Function:** Press 1HR, 2HR, 3HR, or 4HR to have the light go off automatically at the designated time.
- **Cancel Timer:** To end any running timer settings, press the ON button on the remote.
- **Test and Adjust:** Ensure the light is positioned correctly and make any necessary adjustments.

CARE & MAINTENANCE

- **Keep the Remote Control Safe:** To avoid losing the remote, store it in a specific location.
- **Clean the Light Strip Regularly:** Wipe it down with a gentle, dry cloth.
- **Avoid Water Exposure:** Keep the lamp away from moisture as it is not waterproof.
- **Check Adhesive Mounts:** Occasionally press the adhesive tape firmly to ensure solid adhesion.
- **Verify Screw Tightness:** If using screws for mounting, periodically check for looseness.
- **Avoid Overbending the Light Bar:** Keep it flat to prevent damage.
- **Unplug When Not in Use:** To save energy, unplug lights that won't be used for extended periods.
- **Keep the Power Cord Away from Heat:** Prevent damage by keeping the cord away from hot surfaces.
- **Inspect the Power Adapter:** Regularly check for frayed or exposed wires on the cable and adapter.
- **Avoid Overloading Power Outlets:** Do not plug the light bar into an overloaded extension cord.
- **Check Timer Functionality:** Ensure the timer turns off the light at the designated time.

- **Avoid Using Harsh Chemicals:** Use a soft cloth instead of abrasive cleaning solutions.
- **Replace Remote Battery When Needed:** If the remote stops working, change the battery.
- **Store in a Cool, Dry Place:** Keep the light in a dry location if moving or storing it.
- **Handle Carefully:** Avoid dropping or removing the light bar with force to prevent LED damage.

TROUBLESHOOTING

Issue	Possible Cause	Solution
Light does not turn on	Loose power connection	Ensure the AC plug is securely connected
Remote control not working	Weak or dead battery	Replace the remote battery
Colors appear dim or incorrect	Voltage fluctuations	Use a stable 110V power source
Some LEDs are not lighting up	Internal wiring issue	Contact customer support for a replacement
Flickering lights	Loose or damaged wiring	Secure all connections properly
No response to IR remote	IR sensor blocked	Ensure there are no obstructions
White mode not bright enough	Power supply issue	Check if the power adapter is functioning properly
Light strip overheating	Poor ventilation	Avoid placing near heat-sensitive objects
Mounting issues	Surface not clean	Clean and dry the mounting area before installation
Color changing randomly	Interference with IR signals	Move the remote closer and avoid obstacles

PROS & CONS

Pros	Cons
12 RGB colors + white for versatile lighting	No smart app control
Easy installation with magnetic or screw-in mounting	Limited to IR remote control
700-lumen brightness for effective illumination	Not waterproof
Energy-efficient with 6W power consumption	Fixed strip length, no extensions available
30,000-hour lifespan for long-term use	No dimmable feature in white mode

WARRANTY

The LUXSWAY DY103IR-12C LED RGB Strip Light comes with a **1-year limited warranty** covering manufacturing defects, faulty components, and performance issues. The warranty does not cover damages caused by misuse, unauthorized modifications, or environmental factors. Customers can claim their warranty by contacting LUXSWAY customer support with proof of purchase.

FREQUENTLY ASKED QUESTIONS

Why is my LUXSWAY DY103IR-12C LED RGB Strip Light not turning on?

Ensure the AC power connection is secure and that the power outlet is functioning. If using the remote, check the remote batteries.

Why is the remote control not working with my LUXSWAY DY103IR-12C LED RGB Strip Light?

Make sure the IR remote sensor is not obstructed and that the remote is pointed directly at the light strip. Also, replace the remote batteries if necessary.

What should I do if my LUXSWAY DY103IR-12C LED RGB Strip Light is flickering?

Flickering may be caused by loose connections or power fluctuations. Check all wiring and ensure a stable power source.

Why does my LUXSWAY DY103IR-12C LED RGB Strip Light only display one color?

This could be due to a malfunctioning IR receiver or incorrect remote settings. Try resetting the light by unplugging it for a few minutes before reconnecting.

How do I reset my LUXSWAY DY103IR-12C LED RGB Strip Light?

To reset, unplug the light for about 5 minutes, then plug it back in and try using the remote to change settings.

How many LEDs are in the LUXSWAY DY103IR-12C LED RGB Strip Light?

The LUXSWAY DY103IR-12C includes 20 super white LEDs and 20 RGB LEDs, allowing for a mix of vibrant colors and bright white lighting.

What are the mounting options for the LUXSWAY DY103IR-12C LED RGB Strip Light?

The LUXSWAY DY103IR-12C can be screw-mounted or attached magnetically, providing flexibility in installation.

What is the lifespan of the LUXSWAY DY103IR-12C LED RGB Strip Light?

The LUXSWAY DY103IR-12C has an average lifespan of 30,000 hours, ensuring long-lasting performance.

References

- [User Manual](#)

Manuals, Privacy Policy

This website is an independent publication and is neither affiliated with nor endorsed by any of the trademark owners. The "Bluetooth®" word mark and logos are registered trademarks owned by Bluetooth SIG, Inc. The "Wi-Fi®" word mark and logos are registered trademarks owned by the Wi-Fi Alliance. Any use of these marks on this website does not imply any affiliation with or endorsement.