



LUTRON Single-Pole/3-Way Quiet Fan-Speed Controls User Guide

[Home](#) » [Lutron](#) » LUTRON Single-Pole/3-Way Quiet Fan-Speed Controls User Guide 



Single-Pole / 3-Way Quiet Fan-Speed Controls

Please read before installing.



P/N 0301990 REV A

Models

120 V~ 60 Hz 1.5 A		120 V~ 60 Hz 2 A
AYFSQ-F	DVFSQ-F-HO	DVFSQ-F-HO
CTFSQ-F	DVSCFSQ-F-HO	
DVFSQ-F	TGFSQ-F	DVSCFSQ-F-HO
DVSCFSQ-F		

Use our mobile-friendly self-paced installation tool: www.lutron.com/wiringwizard

Find more product information: www.lutron.com/support

–Videos

– Frequently Asked Questions

– Online Chat (8 am – 5 pm EST)

Call us:

U.S.A. | Canada | Caribbean

1.844.LUTRON1 (588.7661) (24/7)

Mexico +1.888.235.2910

Others +1.610.282.3800Help

IMPORTANT

1. Do not use control with exhaust fans
2. CAUTION: To avoid overheating and possible damage to other equipment, do not use to control receptacles, lighting, fluorescent lighting fixtures, or transformer supplied appliances.
3. Do not use control with a fan and light that operate with the same switch.
4. When no "grounding means" exists within the wall box for an existing switch or dimmer, the National Electrical Code® (NEC®) allows a switch/dimmer to be installed as a replacement as long as 1) a nonmetallic, noncombustible faceplate is used with nonmetallic attachment screws or 2) the circuit is protected by a ground fault circuit interrupter. Lutron wallplates meet this requirement.
5. The use of ceiling fan controls on circuits protected by a ground fault circuit interrupter (GFCI) may result in nuisance tripping and is not recommended.
6. Use control with a ceiling paddle fan only. Use only one ceiling paddle fan per control.
7. For new installations, wire a test switch before installing the control.
8. Set multi-speed fans to their highest setting before installing controls.
9. Use only one control in a 3-way circuit.
10. Install in accordance with all national and local electrical codes.
11. Clean control with a soft damp cloth only. Do not use any chemical cleaners.
12. Not for use with DC motor fans.

Contents

- [1 Set the fan to the highest speed](#)
- [2 Turn power OFF at circuit breaker](#)
- [3 Remove side sections \(if ganging devices\)](#)
- [4 Determine wiring type \(ONLY ONE FAN CAN BE USED PER CONTROL\)](#)
- [5 Troubleshooting](#)
- [6 Limited Warranty:](#)
- [7 Documents / Resources](#)
 - [7.1 References](#)
- [8 Related Posts](#)

Set the fan to the highest speed

NOTE: For ceiling-mounted, paddle fans only

Turn power OFF at circuit breaker

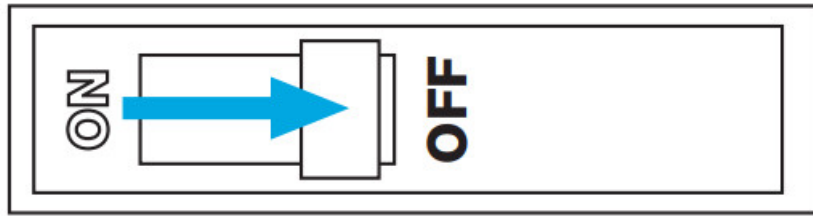

WARNING: SHOCK HAZARD. May result in serious injury or death. Turn off power at the circuit breaker or fuse before installing.

Remove side sections (if ganging devices)

When combining controls in one wall box, remove all inner side sections before wiring (see below). Use pliers to bend each side section back and forth until it breaks off. No derating is required.

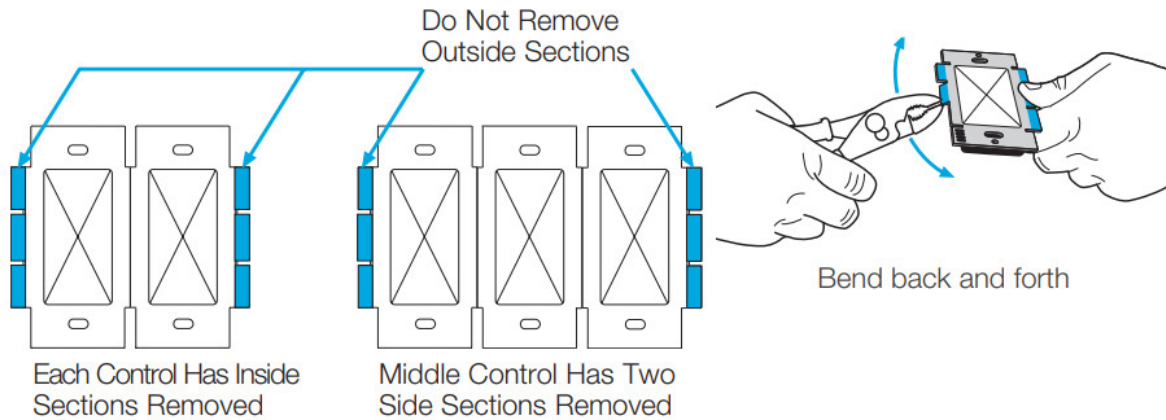

Determine wiring type (ONLY ONE FAN CAN BE USED PER CONTROL)

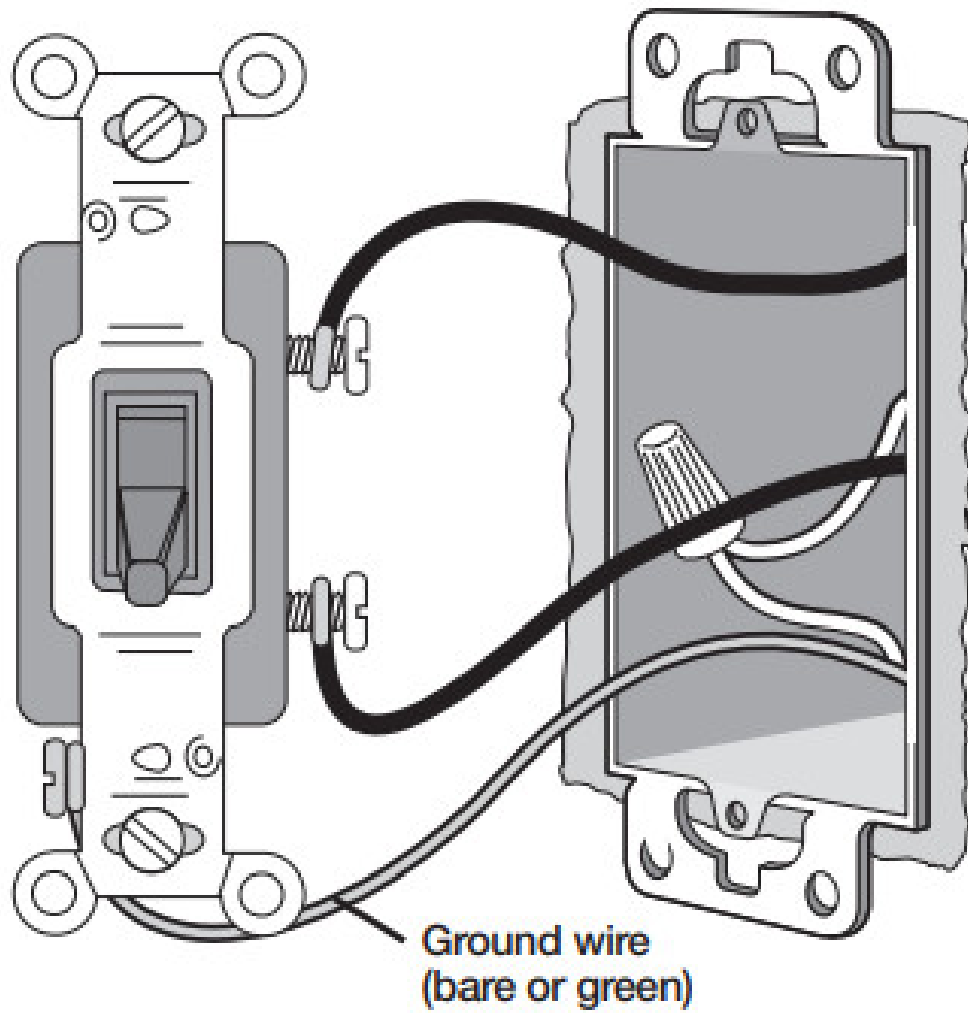
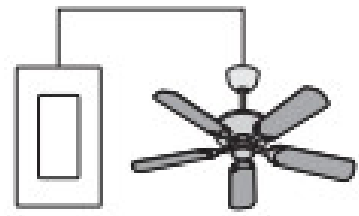

For fans switched from **two** locations:

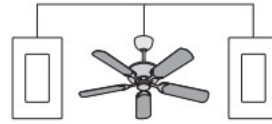

NOTE: Only one control can be used per circuit.

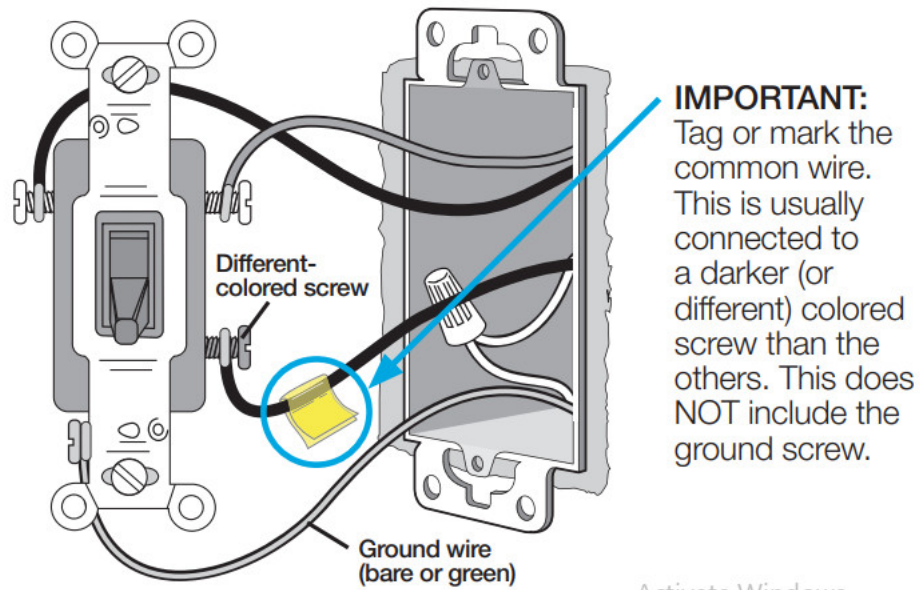

Activate Windows

Remove existing switch and connect the new fan control (appropriately choose ONE of the diagrams below)

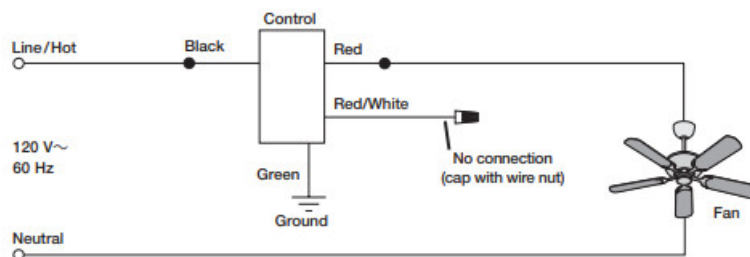
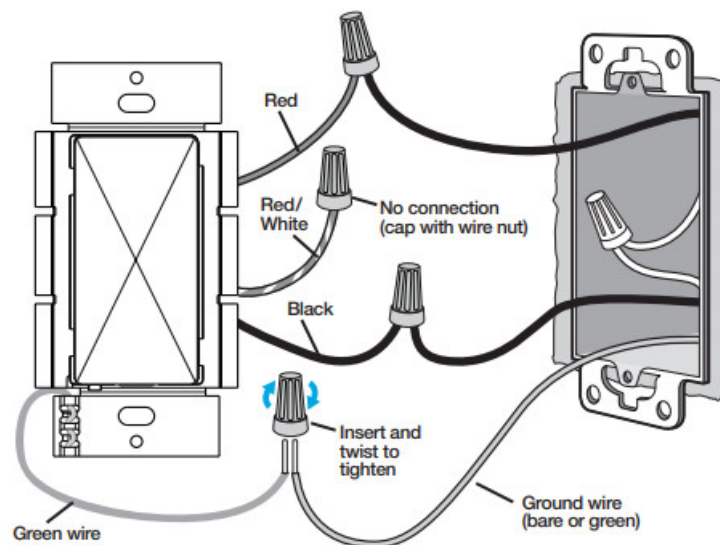

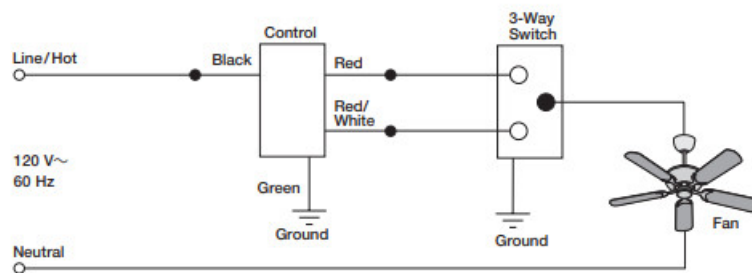
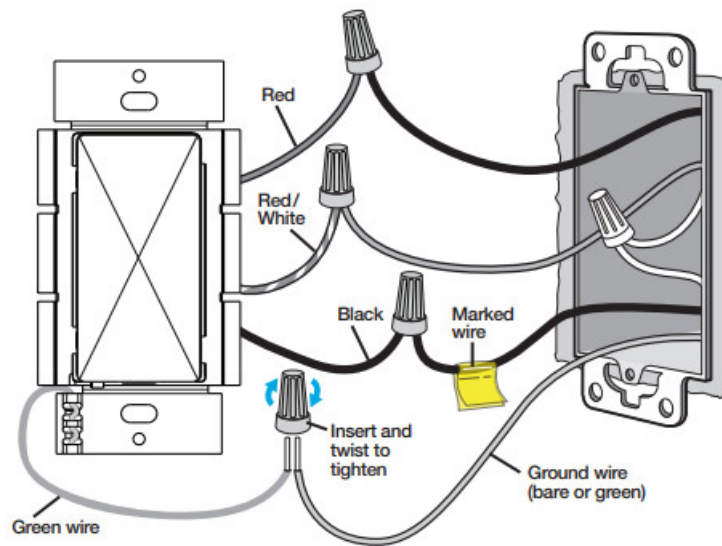

Mount the control using the provided screws

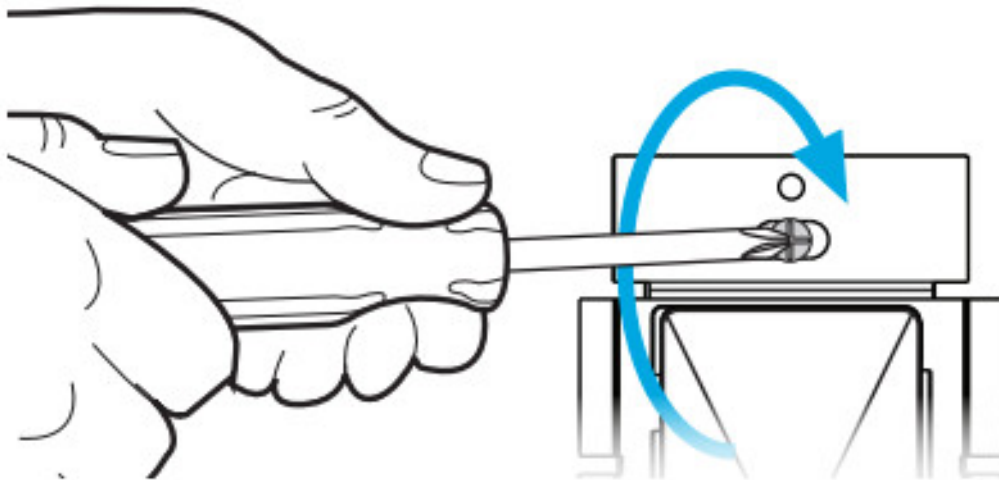

Install the faceplate (not included)

Turn power ON at circuit breaker

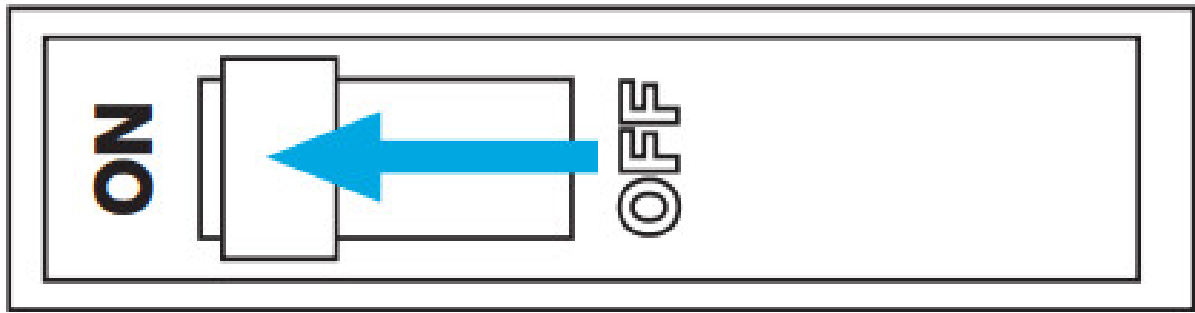

Installation is complete!

Troubleshooting

Symptom	Solution
Toggle works in reverse (for a single pole).	<ul style="list-style-type: none"> • Verify Step 5A.
The fan doesn't run at full speed.	<ul style="list-style-type: none"> • Verify that fan is set to the highest speed. See Step 1.

For additional Troubleshooting, please visit www.lutron.com/support

Limited Warranty:

[369-119_Wallbox_Warranty](#) [PDF]

Lutron is a trademark or registered trademark of Lutron Electronics Co., Inc. in the US and/or other countries. All other product names, logos, and brands are the property of their respective owners.

©2017-2021 Lutron Electronics Co., Inc.

www.lutron.com/support

Documents / Resources

	<p>LUTRON Single-Pole/3-Way Quiet Fan-Speed Controls [pdf] User Guide Single-Pole, 3-Way Quiet Fan-Speed Controls</p>
--	--

References

-  [Lutron Support Center | Lutron](#)
-  [How to Install a Dimmer Switch | Dimmer Switch Wiring | Lutron Web Tools](#)