



Lutron DVCL-153P-IV Dimmer Dimmable LED User Manual

[Home](#) » [Lutron](#) » Lutron DVCL-153P-IV Dimmer Dimmable LED User Manual 

Contents

- [1 Lutron DVCL-153P-IV Dimmer Dimmable LED User Manual](#)
- [2 Troubleshooting](#)
- [3 Related Posts](#)



Lutron DVCL-153P-IV Dimmer Dimmable LED User Manual



Please read before installing. If using LED or CFL bulbs, they must be Lutron compatible for optimal performance! For the compatible bulb list, please visit www.lutron.com/dimcflled

Help

Use our mobile-friendly self-paced installation tool: www.lutron.com/wiringwizard

Find more product information: www.lutron.com/support

- Videos
- Frequently Asked Questions
- Online Chat (8 am – 5 pm EST)

Call us: U.S.A. | Canada | Caribbean
 1.844.LUTRON1 (588.7661) (24/7)
 Mexico +1.888.235.2910
 Others +1.610.282.3800

IMPORTANT

1. **CAUTION:** Use only with permanently installed fixtures with dimmable screw-in compact fluorescent, dimmable screw-in LED, halogen, or incandescent lamps. To avoid overheating and possible damage to other equipment, do not use to control receptacles, motor-driven appliances, or transformer-supplied appliances.
2. Install in accordance with all national and local electrical codes.
3. When no “grounding means” exists within the wall box for an existing switch or dimmer, the National Electrical Code® (NEC®) allows a switch/dimmer to be installed as a replacement as long as 1) a nonmetallic, noncombustible faceplate is used with nonmetallic attachment screws or 2) the circuit is protected by a ground fault circuit interrupter. Lutron wallplates meet this requirement. When installing a control according to these methods, cap or remove the green wire before screwing the control into the wall box.
4. Only one dimmer can be used in a 3-way circuit.
5. Protect the dimmer from dust and dirt when painting or spackling the wall.
6. It is normal for the dimmer to feel warm to the touch during operation.
7. Clean the dimmer with a soft damp cloth only. Do not use any chemical cleaners.
8. For indoor use only.

Turn the power OFF at the circuit breaker

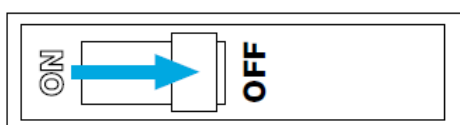

WARNING: SHOCK HAZARD.

May result in serious injury or death. Turn off the power at the circuit breaker or fuse before installing.

Remove side sections (if ganging devices)

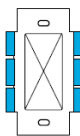
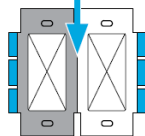
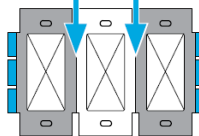
Maximum Allowable Incandescent/Halogen Wattage		
No sides removed	1 side removed	2 sides removed
		
600 W	500 W	400 W

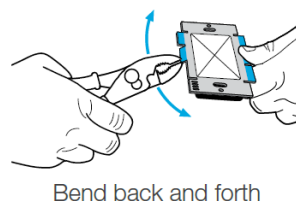

Remove side sections if mounting two or more devices side by side. Removing side sections reduces the

dimmer's maximum wattage rating (see chart below).

NOTE: Maximum wattage ratings are not affected when using only LEDs or CFLs.

For maximum wattage information when mixing light bulb types see www.lutron.com/multigang

Determine wiring type



For lights switched from one location:

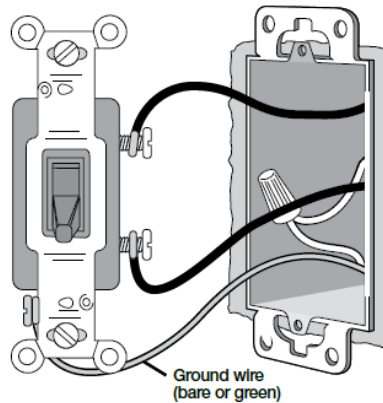

For lights switched from two locations:

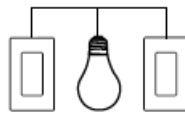

NOTE: Only one dimmer can be used per circuit.

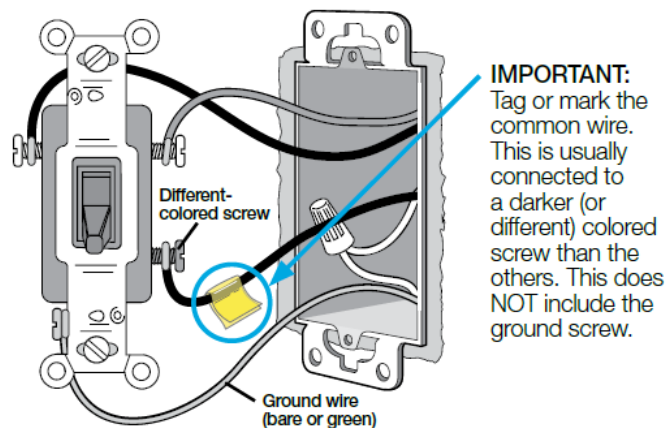

Remove the existing device and connect the new dimmer (appropriately choose ONE of the diagrams below)

For lights switched from one location:

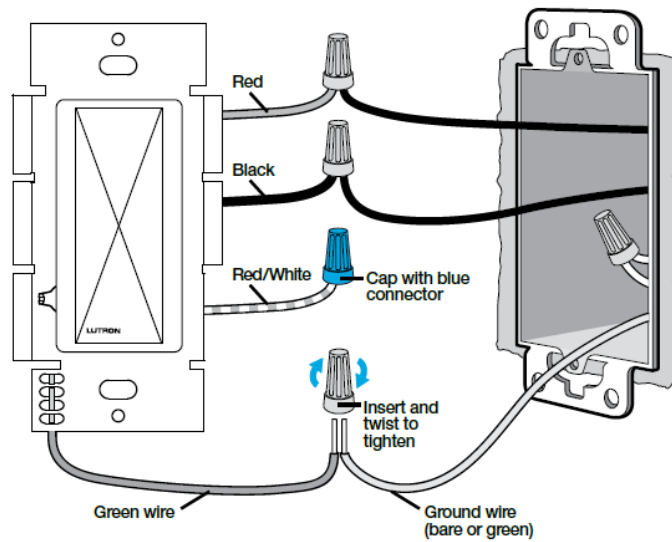

For lights switched from two locations:

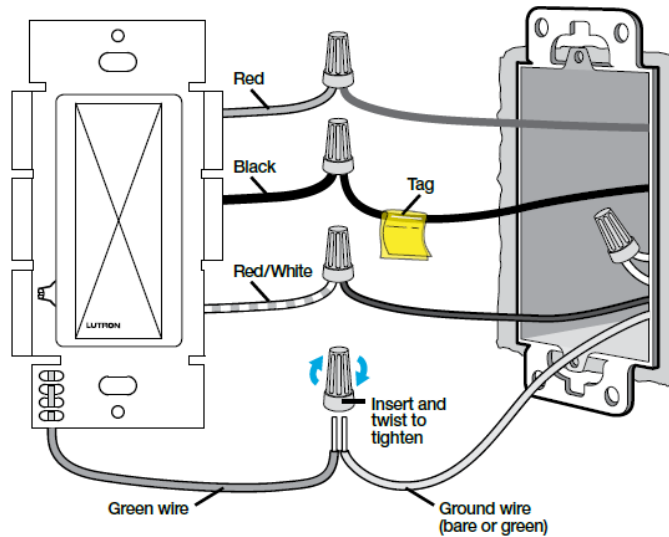

NOTE: Diva dimmer shown for illustration purposes. Other products may vary.

Mount the dimmer using the provided screws

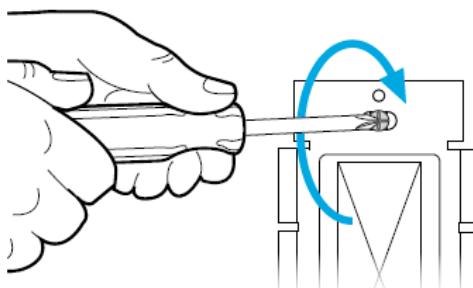

Turn the power ON at the circuit breaker

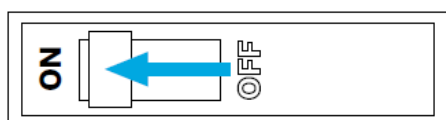

Adjust the dimming range for LEDs and CFLs

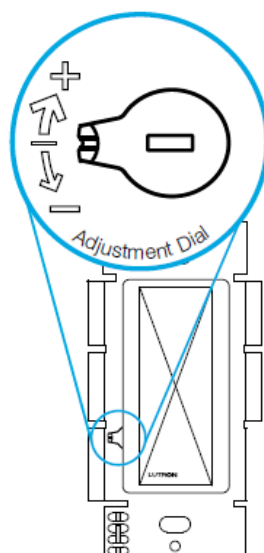

- Turn lights ON using the dimmer's ON/OFF switch.
- Move the dimming slider to the minimum level (bottom of travel).
- Turn the adjustment dial until the lights are stable.

NOTE: The Adjustment Dial on your dimmer may be in a different location than shown.

- Ensure proper operation using the toggle (readjust the dial if necessary).

Install the faceplate (not included)

Installation is complete!

Troubleshooting

Symptom	Solution
CFLs or LEDs do not dim, have a poor dimming range, or they flicker /flash.	Verify Step 7. Ensure bulbs are Lutron compatible.
Audible buzzing (common with LEDs).	If bothersome, use a different bulb.
One location will not turn on if the other location is turned off.	Common (tagged) and traveler wires are swapped. Verify Step 4B.

For additional Troubleshooting, please visit www.lutron.com/support

Download PDF: [Lutron DVCL-153P-IV Dimmer Dimmable LED User Manual](#)