



LURACO L0903A iFill 5 Intelligent Spa Control System User Manual

[Home](#) » [LURACO](#) » LURACO L0903A iFill 5 Intelligent Spa Control System User Manual 

Contents

- [1 LURACO L0903A iFill 5 Intelligent Spa Control System](#)
- [2 INTRODUCTION](#)
- [3 FEATURES and OPERATIONS](#)
- [4 Installation Guide](#)
- [5 System Installation](#)
- [6 How to operate the iFill 5 \(Be sure that the faucet is open\)](#)
- [7 WARRANTY INFORMATION](#)
- [8 Important Instructions](#)
- [9 Documents / Resources](#)
 - [9.1 References](#)
- [10 Related Posts](#)



LURACO L0903A iFill 5 Intelligent Spa Control System



INTRODUCTION

When using electrical equipment, basic safety precautions should always be followed to reduce the risk of fire, electric shock and injury. Safety precautions are as follows:

1. Read and follow all instructions before using the equipment.
2. Keep the cord out of heavy traffic area. To avoid fire hazard NEVER put the cord under rugs or near heat generating devices.
3. Always turn off the equipment before servicing.
4. Do not drop or insert any object into any openings.
5. Do not operate any equipment with damaged parts.
6. This system is for indoor use only.
7. Do not attempt to repair or adjust any electrical or mechanical functions on this unit. Doing so will void the warranty.
8. As a condition of acceptability UL requires that this product be installed over a non-combustible surface; if this product is installed over a combustible surface, a non-combustible layer must be installed between the device and the surface.
9. Any other use not recommended by the manufacturer may result in electrical shock or injury.

After reading this owner's guide, if you have any questions or comments, please call 817-633-1080 or contact our technical support department at support@luraco.com or visit our website at www.luraco.com for more information

PLEASE READ AND SAVE THESE IMPORTANT SAFETY INSTRUCTIONS

FEATURES and OPERATIONS

iFill 5 Features

- Complete spa controller with intelligent automatic fill features.
- Digital water temperature and session elapsed time display.
- Volume setting from 1 to 10 gallons.
- Can be used with or without disposable liners.
- 3 switched and 1 continuous outlet.
- Drain pump-controlled outlet with timer.
- Heavy duty industrial graded brass water valve and flow sensor package.
- Can be operated in both automatic or manual modes.
- Built-in 1-hour timer.
- Reliable, simple and easy to use.
- 120VAC, 60Hz (2 Amps max per outlet).
- UL Recognized

Installation Guide

I) Overall System Integration

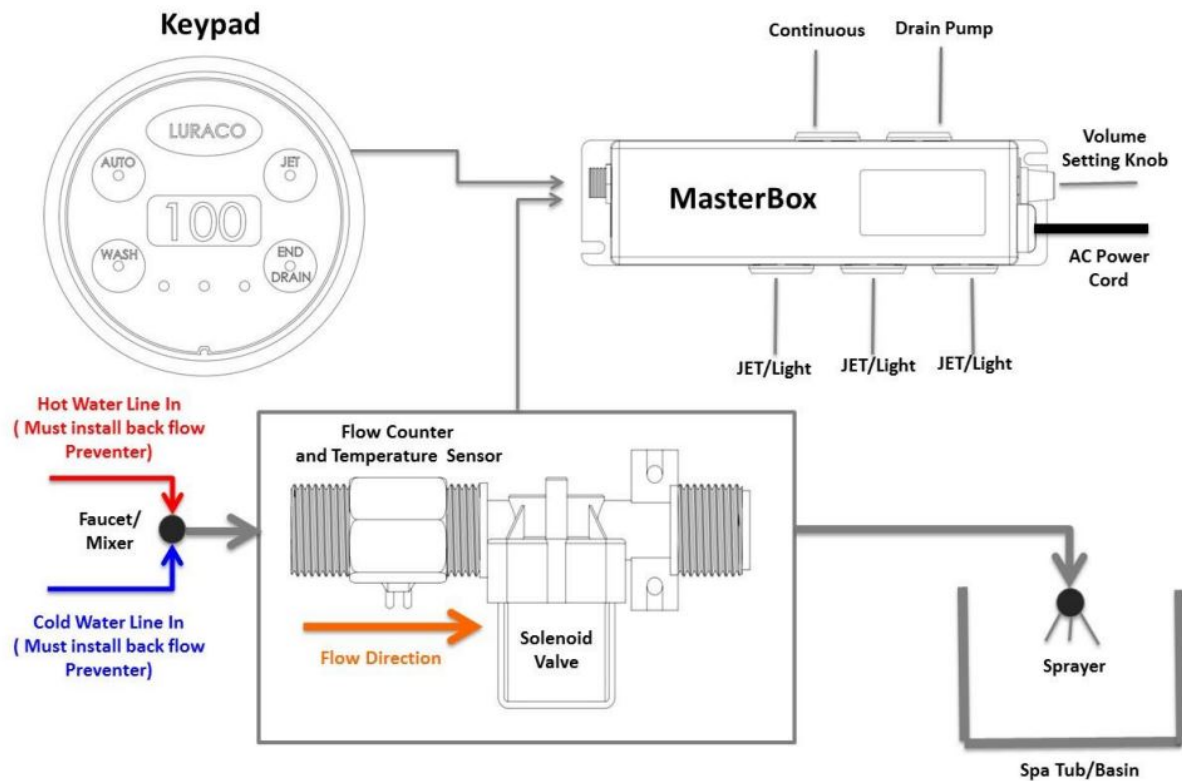

Fig.1: Connection Diagram

ATTENTION: BACKFLOW “PREVENTERS ARE” REQUIRED FOR EVERY SPA CHAIR. THEY MUST BE INSTALLED ON BOTH HOT AND COLD-WATER LINES TO AVOID LOSING HOT WATER FROM ONE CHAIR TO ANOTHER.

System Installation

Follow the steps below for iFill 5 installation

1. Connect the Flow Sensor/Water Valve Package to the output of water mixer/faucet. Be sure the water flow direction is correct.
2. Connect the Control Keypad and Flow Sensor/Water Valve Package to MasterBox

Automatic Fill Volume Setting:

The volume of each Auto iFill can be set by the knob located next to the power cord on Masterbox. Depending on the knob position, water valve shuts off when water volume reached the set value.

How To Change the Temperature Unit (Fahrenheit or Celsius):

Be sure all buttons on keypad are off, press and hold the END/DRAIN button for 5 seconds until F or C is displayed on the keypad.

How to operate the iFill 5 (Be sure that the faucet is open)

ATTENTION: BEFORE PRESSING AUTO iFILL BUTTON. BE SURE THE PREVIOUS SESSION IS COMPLETE AND DRAIN OUT WATER IN THE BASIN. TO UNLOCK THE AUTO BUTTON, PRESS THE END BUTTON

- Press the Auto/iFill button to turn On or Off the Automatic fill.
- Press the JET button to turn On or Off the JET and color light manually (1-hour timer)
- Press the Wash button to turn On or Off the water manually (5-minute safety timer)
- Press End/Drain button to end the session and unlock the Auto fill button. This button will also turn on the drain pump.

Understanding The Display Screen

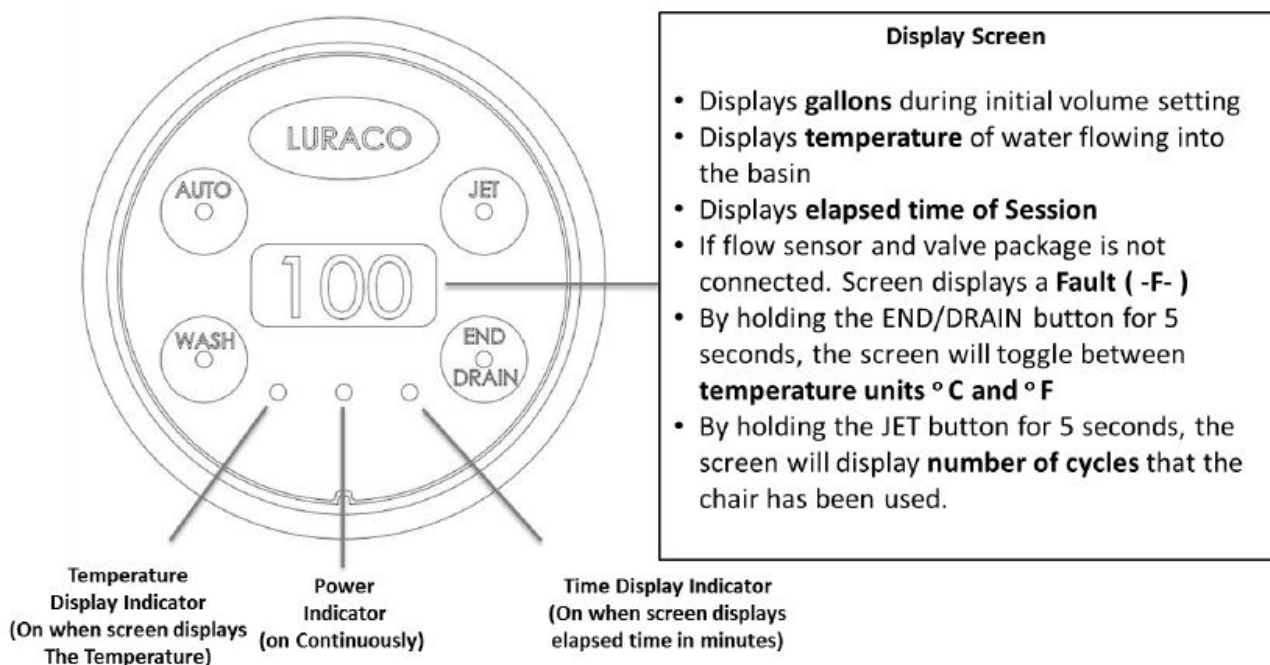

Fig.2: Display Screen

How to reboot the iFill 5

Please follow the steps below

- Completely drain all water from the tub.
- Unplug the Masterbox power cord from the power outlet.
- Wait about 5 seconds and then plug power cord back into the power outlet.

WARRANTY INFORMATION

One (1) YEAR LIMITED WARRANTY

1. This Warranty applies only to the original purchaser of this product.
2. This Warranty applies ONLY to repair or replacement of any supplied or manufactured parts of this product.
The warranty does not cover normal wear, coating, dropped or abused units or any related shipping costs.
3. Unless otherwise proscribed by law, Luraco shall not be liable for any personal injury, property or any incidental or consequential damages of any kind resulting from malfunctions, defects, misuse, improper installation or alteration of this product.

Attention: Any modification to the product will void the warranty

Important Instructions

If you need to send a unit to Luraco for repair, please follow the steps below.

1. Call 800-483-9930 or 817-633-1080 to get a case number.
2. Carefully pack the item in its original carton or another suitable container to avoid damages during shipping.
3. Before packing your unit, be sure to enclose:
 - Your name with full shipping address and telephone number.
 - A dated receipt for PROOF OF PURCHASE.
 - The case number that will be given to you in Step 1.
 - Include a detailed description of the problem you are having.
 - All shipping costs must be prepaid by the sender.

THANK YOU FOR BUYING LURACO PRODUCTS



LURACO HEALTH & BEAUTY, LLC

1140 107TH STREET, ARLINGTON, TX 76011 TEL: +1-817-633-1080, FAX: +1-817-633-1085

Documents / Resources

	<p>LURACO L0903A iFill 5 Intelligent Spa Control System [pdf] User Manual L0903A, iFill 5 Intelligent Spa Control System, Intelligent Spa Control System, Spa Control System, L0903A, Intelligent Spa</p>
---	---

References

-  [Luraco – LURACO Technologies](#)
-  [Luraco – LURACO Technologies](#)

Manuals+.