



lupilu Baby Mobile with Rotating Function and Music Box Instructions

[Home](#) » [lupilu](#) » lupilu Baby Mobile with Rotating Function and Music Box Instructions 

Contents

- [1 lupilu Baby Mobile with Rotating Function and Music Box](#)
- [2 INTRODUCTION](#)
- [3 Safety instructions](#)
- [4 Assembly](#)
- [5 Disassembly](#)
- [6 Use](#)
- [7 Documents / Resources](#)
 - [7.1 References](#)
- [8 Related Posts](#)

lupilu®

lupilu Baby Mobile with Rotating Function and Music Box



INTRODUCTION

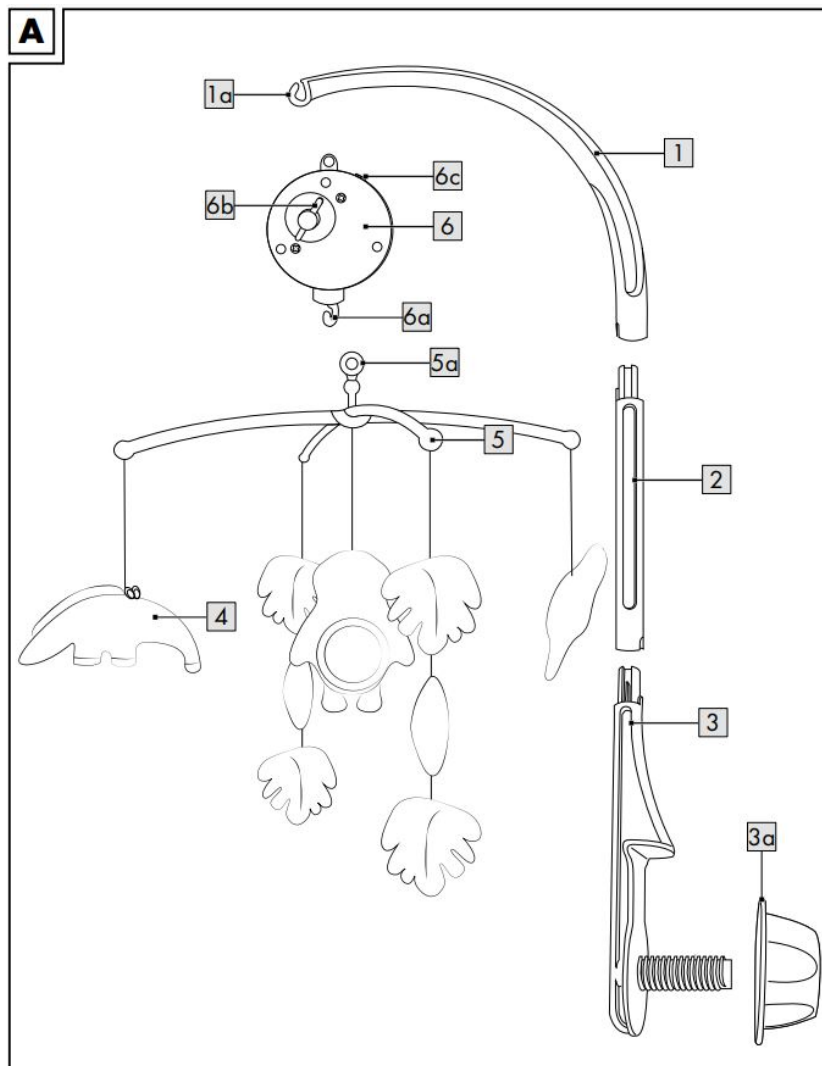

This quick reference guide is a fixed part of the instructions for use. Keep both this and the instructions for use in a safe place. When passing this product on to third parties, please be sure to include all documentation. Read the instructions for use before use, and pay particular attention to the safety instructions included in the operating instructions.

You can download the instructions for use at the following internet link: <https://www.lidl-service.com>

Scope of delivery

- 1 x main arm (1)
- 1 x connecting piece (2)
- 1 x bracket (3)
- 5 x plush pendant (4)
- 2 x cross arm, interconnected (5)
- 1 x music box (6)
- 1 x quick start guide

Technical data

Dimensions: approx. 32.5 x 45 x 67cm (d x w x h)

Date of manufacture (month/year): 05/2021

Delta-Sport Handelskontor GmbH

hereby declares that this product

conforms to the following basic requirements and other applicable regulations:

Directive 2009/48/EC of the European Parliament on the safety of toys.

This toy must be attached out of the reach of children.

Intended use

This product is a toy for children of any age and for private use.

Safety instructions

- **Warning.** None of the packaging and fastening materials are considered part of the toy and must always be removed for safety reasons before the product can be given to children to play with.
- **Warning.** This toy must be attached out of the reach of the child. Remove this toy when the child begins trying to crawl on all fours to prevent possible injuries from entanglement.
- Check the product for damage or wear before each use. The product may be used only when in good working order and condition!

Assembly

The product should be only assembled by adults. Attach the product out of the reach of the baby.

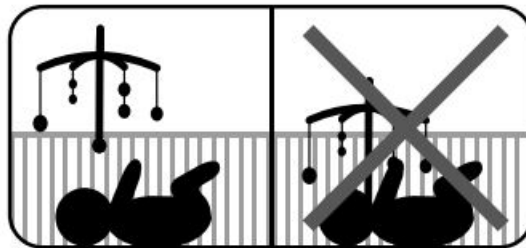

Assemble the product only when the cot is empty with no baby in it!

1. Remove the packaging completely.
2. Turn the knob (3a) on the thread of the bracket (3).
3. Place the bracket with the thread inwards on the upper frame of the cot.
Note: The end of the thread should be facing outwards through two of the railings.
4. Put the bracket knob (3a) from the outside onto the end of the thread and tighten it.
Note: The bracket should be seated firmly on the frame of the cot. Do not tighten too much since this might cause scratching.
5. Put the connecting piece (2) on the bracket and the main arm (1) as shown in fig. A.
6. Hang the music box (6) on the hook (1a) of the arm.
7. Pull out the two cross arms (5) so that they form a cross and the plush pendants (4) hang freely.
8. Hook the eyelet (5a) of the cross arms (5) to the hook (6a) on the music box.

Disassembly

Disassemble the product from the cot only when the cot is empty with no baby in it!

1. Hold the product tightly with one hand and loosen the knob (3a) on the bracket with the other.
2. Remove the knob (3a) from the thread of the bracket (3).

Use

Important! Remove the protective foil from the mirror before first use.

Hold the music box (6) with one hand and turn the switch (6b) to the right. The music plays until the switch has turned back to its starting position. While the music is playing, the cross arms (5) with the plush pendants (4) turn.

Note: Slide the switch (6c) down to stop the music box (6).

Storage, cleaning

When not in use, always store the product clean and dry at room temperature.

Wipe clean with a damp cloth only. **IMPORTANT!** Never clean the product with harsh cleaning agents.



Note: The plush pendants (4) can be machine-washed at 30°C, delicate cycle.



1. To wash the plush pendants (4) undo the knots that attach them to the cross arms (5) and pull the cords out of the pendants.
2. After washing the pendants, thread them back onto the cross arms (5) and attach them with any kind of knot of your choosing.

Note: Check the strength of the knot since a pendant could otherwise come loose and fall on the baby.

Documents / Resources

| | |
|---|--|
|  | <p>Iupilu Baby Mobile with Rotating Function and Music Box [pdf] Instructions Baby Mobile with Rotating Function and Music Box</p> |
|---|--|

References

- [eBay.de/](#)