



[Home](#) » [LUNOS](#) » **LUNOS 5-UNI-FT Universal Control with Switch Instruction Manual** 

Contents [[hide](#)]

- [1 LUNOS 5-UNI-FT Universal Control with Switch](#)
- [2 Product Information](#)
- [3 Product Usage Instructions](#)
- [4 Installation Instruction](#)
- [5 FOR MORE INFO](#)
- [6 FAQ](#)
- [7 Documents / Resources](#)
 - [7.1 References](#)



LUNOS 5-UNI-FT Universal Control with Switch

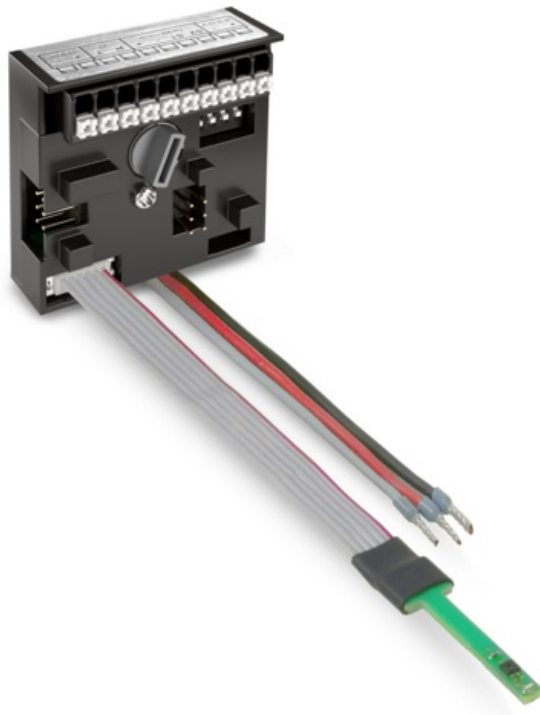

Product Information

The Universal Control with Switch 5/W2U is a versatile device that allows for the integration of a humidity sensor and LED into your control system. It is designed for seamless installation and reliable performance.

Specifications:

- **Model:** 5/W2U
- **Compatibility:** 5/UNI-FT & RF
- **Color:** Arctic White
- **Manufacturer:** Brand Kopp

Product Usage Instructions

- **Step 1: Assign Terminals Correctly**

1. Locate the internal push button on the backside of Switch 5/W2U.
2. Ensure proper connection by referring to the color-coded terminals: violet for the connection cable switch, grey for the LED, and orange for the humidity/temperature sensor.

- **Step 2: Pierce the Sticker on the Back**

Pierce the sticker on the back of the device to access the installation area.

- **Step 3: Insert Humidity Sensor/LED**

1. Carefully insert the humidity/temperature sensor and LED by piercing through the center as indicated.
2. Ensure the sensor board is fully inserted for proper functionality.

- **Step 4: Install Control Unit and Switch**

Install the control unit and switch in a flush-mounted box for a clean and finished look.

Note: Ensure the connection cable is not shortened or extended during installation.

Installation Instruction

- **Step 1: Assign terminals correctly**

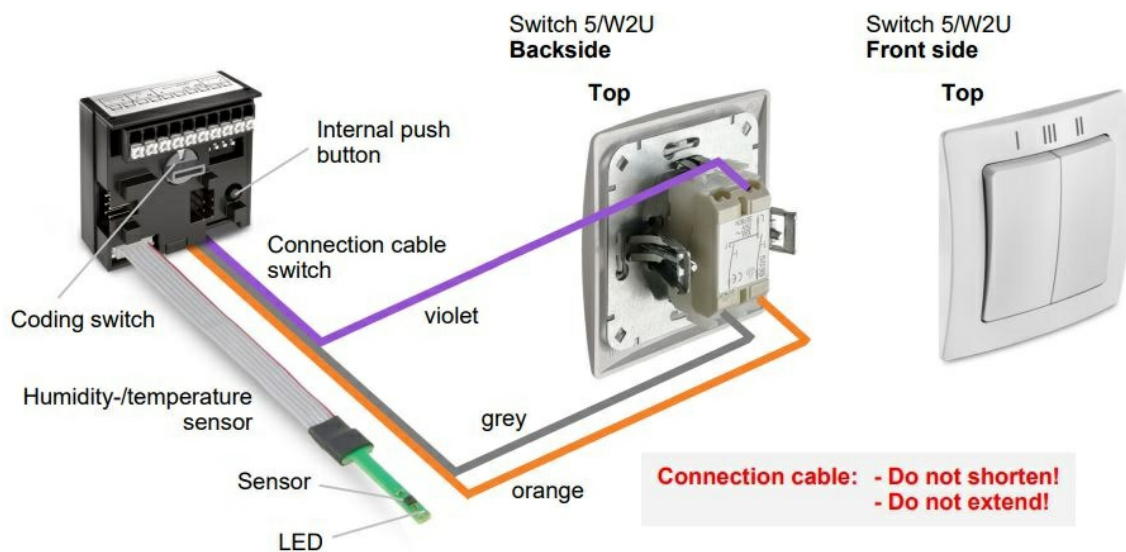

- **Step 2: Pierce the sticker on the back**

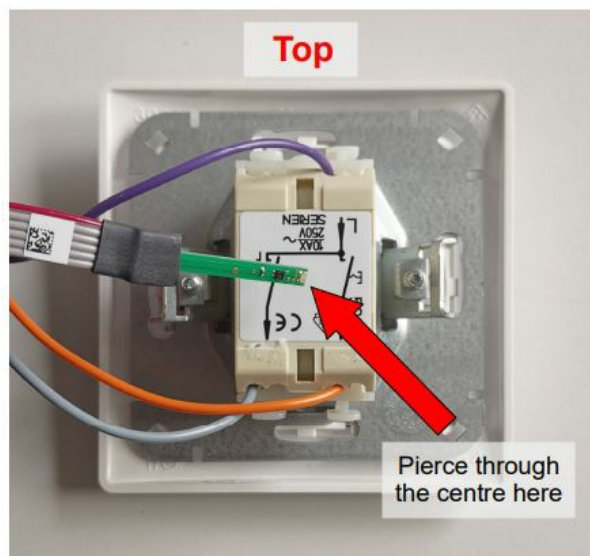

- **Step 3: Insert the humidity sensor/LED**

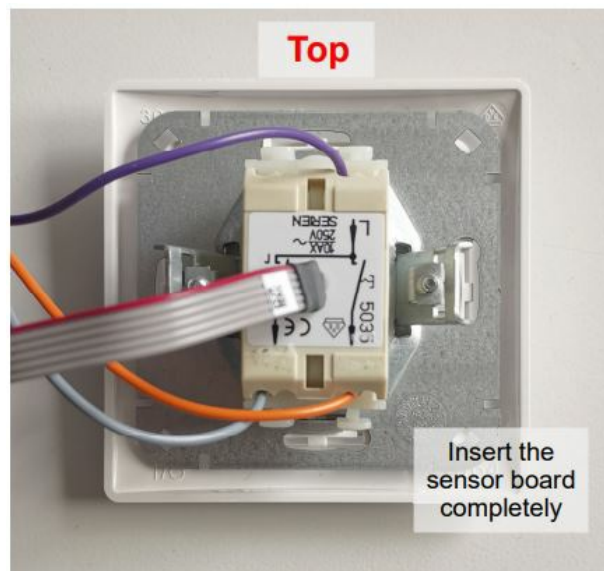

- **Step 4:** Install the control unit and switch in a flush-mounted box – done

Note: 5/W2U = Brand Kopp, series Paris (arctic white)

FOR MORE INFO

- info@lunos.de
- www.lunos.de

FAQ

What should I do if the LED does not light up after installation?

Check the connections and ensure proper insertion of the sensor board. If the issue persists, contact customer support for assistance.

Can I use this product with other switch brands?

The 5 W2U is specifically designed for Brand Kopp, series Paris, in arctic white color. It is recommended to use it with compatible components for optimal performance.

Documents / Resources

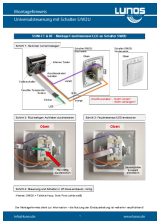

[LUNOS 5-UNI-FT Universal Control with Switch \[pdf\]](#) Instruction Manual 5-UNI-FT, 5-W2U, E512, 5-UNI-FT Universal Control with Switch, 5-UNI-F T, Universal Control with Switch, Control with Switch, with Switch

References

- [User Manual](#)

LUNOS

 5-UNI-FT, 5-UNI-FT Universal Control with Switch, 5-W2U, Control with Switch, E512, LUNOS, Universal Control with Switch, with Switch

Leave a comment

Your email address will not be published. Required fields are marked *

Comment *

Name

Email

Website

☐ Save my name, email, and website in this browser for the next time I comment.

Post Comment

Search:

e.g. whirlpool wrf535swhz

Search

[Manuals+](#) | [Upload](#) | [Deep Search](#) | [Privacy Policy](#) | [@manuals.plus](#) | [YouTube](#)

This website is an independent publication and is neither affiliated with nor endorsed by any of the trademark owners. The "Bluetooth®" word mark and logos are registered trademarks owned by Bluetooth SIG, Inc. The "Wi-Fi®" word mark and logos are registered trademarks owned by the Wi-Fi Alliance. Any use of these marks on this website does not imply any affiliation with or endorsement.