



LUNAR ARTEFACTS Lapi Adjustment-Tool Instructions

[Home](#) » [LUNAR ARTEFACTS](#) » LUNAR ARTEFACTS Lapi Adjustment-Tool Instructions 

Contents

- [1 LUNAR ARTEFACTS Lapi Adjustment-Tool](#)
- [2 Instruction](#)
- [3 Top removal](#)
- [4 Sensitivity adjustment](#)
- [5 Documents / Resources](#)
- [6 Related Posts](#)



LUNAR ARTEFACTS
LONDON

LUNAR ARTEFACTS Lapi Adjustment-Tool

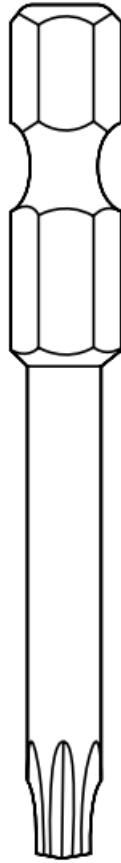

Instruction

Every effort has been made to perfectly pre-adjust the leather top, however, leather is a natural material easily affected by humid and dry air. Hence there is always a slight chance of leather shrinkage or expansion during the transportation stage. We have included a screw tool, which will assist in adjusting the leather top and the buttons in case of misalignment. Follow the simple steps on the next page to complete the necessary refinements.

Top removal

Remove the top to adjust the screws on the inner side of the leather cover.

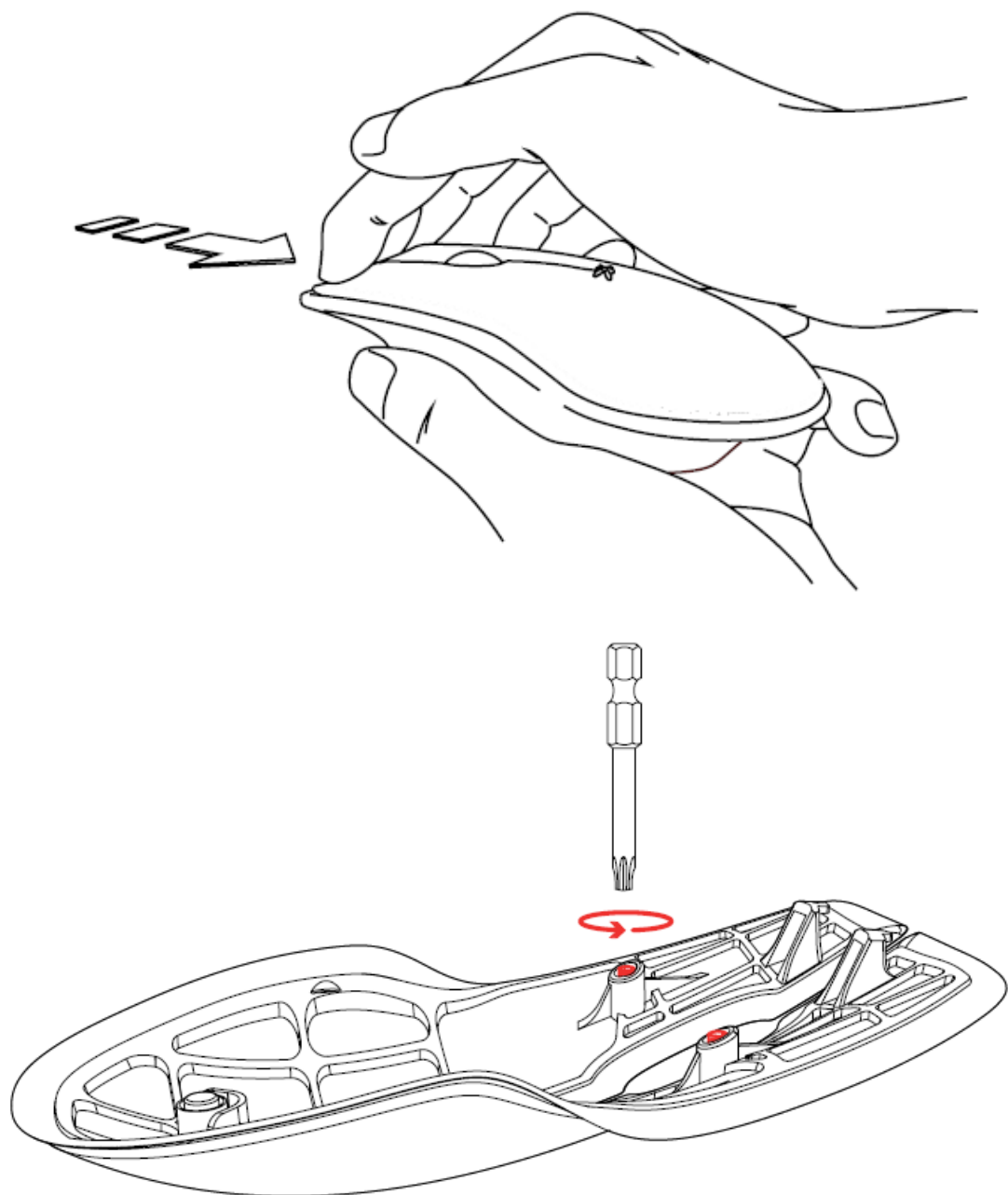

Sensitivity adjustment

- Move the screw tool counterclockwise for additional sensitivity.
- Move the screw tool clockwise for additional stiffness.
- Test the buttons by clicking. If required, repeat the steps to adjust the buttons per your preference.

