



LUMISCOPE 5710 LUMINEB II Compressor Nebulizer User Manual

[Home](#) » [Lumiscop](#)e » LUMISCOPE 5710 LUMINEB II Compressor Nebulizer User Manual 



**Model 5710LUMINEB II
Compressor Nebulizer
Operation Instructions**



Contents

1 INTRODUCTION
2 PARTS IDENTIFICATION
3 OPTIONAL ACCESSORIES AVAILABLE
4 CLEANING YOUR LUMINEB II
5 DISINFECTING YOUR LUMINEB II
6 CHANGING THE FILTER
7 REPLACEMENT PARTS
8 OPTIONAL ACCESSORIES
9 SPECIFICATIONS
10 OBTAINING WARRANTY SERVICE
11 Documents / Resources
12 Related Posts

INTRODUCTION

Congratulations on purchasing your new LUMINEB II Compressor Nebulizer . It is a compact medical device designed to efficiently deliver physician prescribed medication to the bronchial lung passages . With proper care and use, it will provide you with many years of reliable treatment .

This product has been developed for the treatment of asthma, allergies and other respiratory disorders . It creates a stream of air that travels through clear tubing to the nebulizer . When air enters the nebulizer, it converts the prescribed medication into aerosol mist for easy inhalation .

Your LUMINEB II should be used under the supervision of a licensed physician and/ or respiratory therapist . We encourage you to thoroughly read these instructions to learn about the features and proper use of this product . Any use of this product other than its intended use will void all warranties and should be avoided.

CAUTION: USA FEDERAL LAW RESTRICTS THIS DEVICE TO SALE BY OR ON THE ORDER OF A PHYSICIAN.



WARNINGS:

- The 5710 contains high-precision assemblies. Therefore, avoid extreme temperatures, humidity, direct sunlight and strong static electricity or electromagnetic waves
- To avoid electrical shock, keep the unit away from water, do not immerse the power cord or unit in liquid, do not use while bathing, do not reach for a unit that has fallen into water – immediately unplug it.
- Not for use by children without adult supervision.
- Not for use for other than medical nebulization treatment.
- Do not attempt to fix or repair the machine under any circumstances. Contact the Lumiscope Technical Support Department at 770-447-1609 for assistance.
- Disconnect the unit from the electrical source before cleaning, filling the nebulizer and after each use.
- Ensure the power cord is fully inserted into the socket to prevent electrical malfunction .
- Clean the unit and accessories carefully with a slightly damp, soft cloth . Do not apply excess pressure . Do not use solvents or cleaners on either the unit or accessories.
- Only use the included Lumiscope AC adapter for AC powering. Do not leave the unit plugged in while unattended.
- Never block the air openings of the unit or operate it where the air openings may be obstructed.
- **WARNING:** Notice for California Customers- California Proposition 65
WARNING: This product contains a chemical known to the State of California to cause cancer and reproductive or developmental harm .

PARTS IDENTIFICATION

1. Nebulizer Compressor	4. Tube Connector	7. Power Cord	10. Power Cord Plug
2. Air Tube	5. Standard Mouthpiece	8. Air Vents	11. Filters
3. Filter Compartment	6. Nebulizer	9. On/Off Switch	

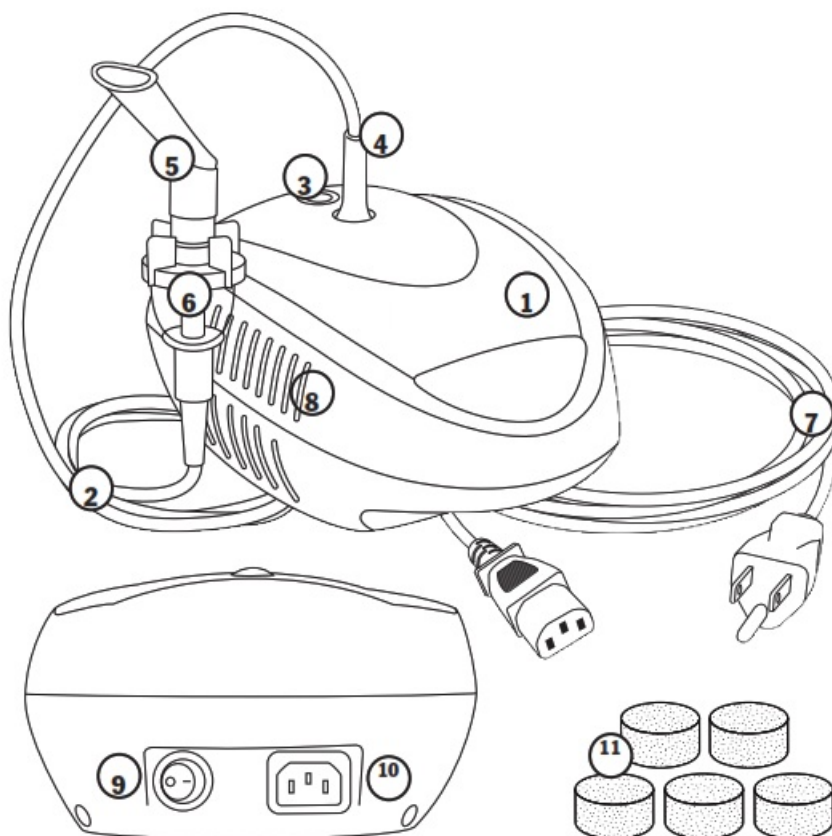

OPTIONAL ACCESSORIES AVAILABLE

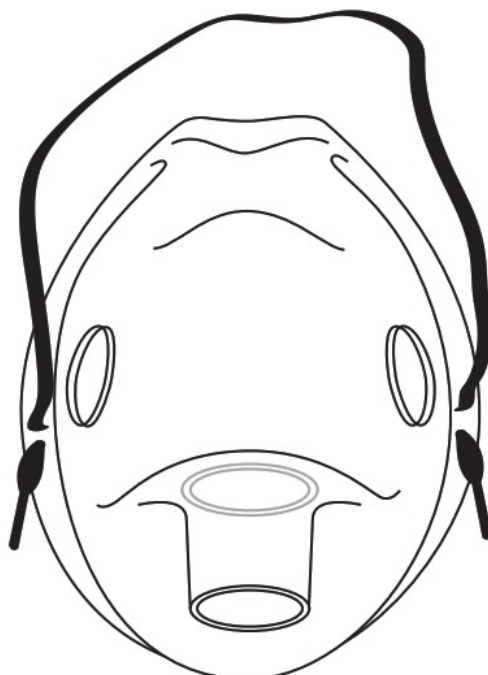

USING YOUR LUMINEB II COMPRESSOR NEBULIZER:

Note: Prior to initial operation, the nebulizer should be thoroughly cleaned.

1. Place your LUMINEB II on a flat and stable surface. Be sure that you can easily reach the controls while you are seated.
2. Gently twist the top part of the nebulizer assembly counter-clockwise to disassemble the nebulizer. (fig.1)

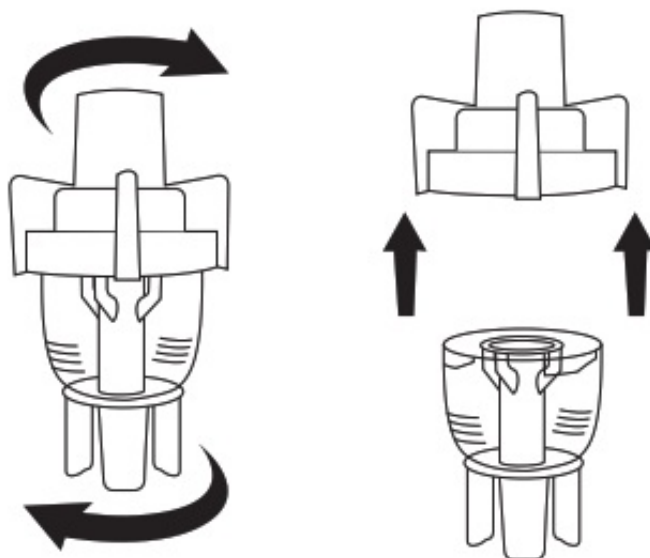

Figure 1

3. Fill the bottom section of the nebulizer with the medication prescribed by your physician. Be sure that the nebulizer cone is put inside the bottom section. (fig. 2)

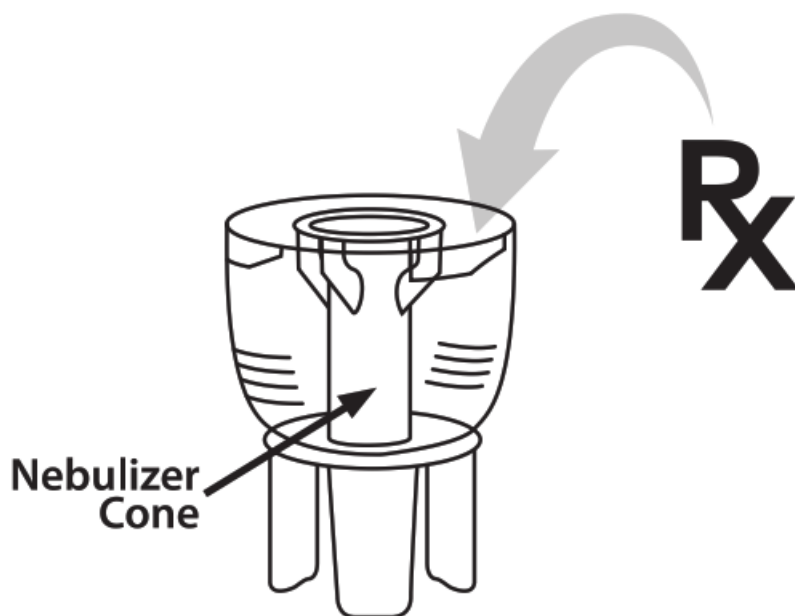

Figure 2

4. Replace the top part of the nebulizer and gently twist clockwise to reassemble the nebulizer . Make sure both sections are connected properly. (fig. 3)

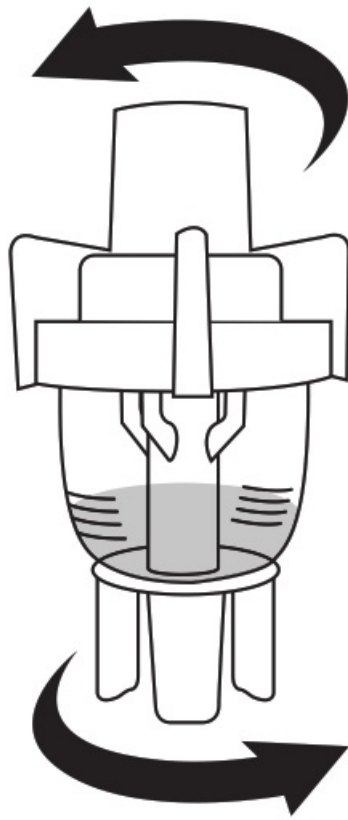

Figure 3

5. Attach one end of the air tube to the base of the nebulizer. (fig. 4)
6. Attach the other end of the air tube to the air outlet on the top of the LUMINEB II. (fig .4)

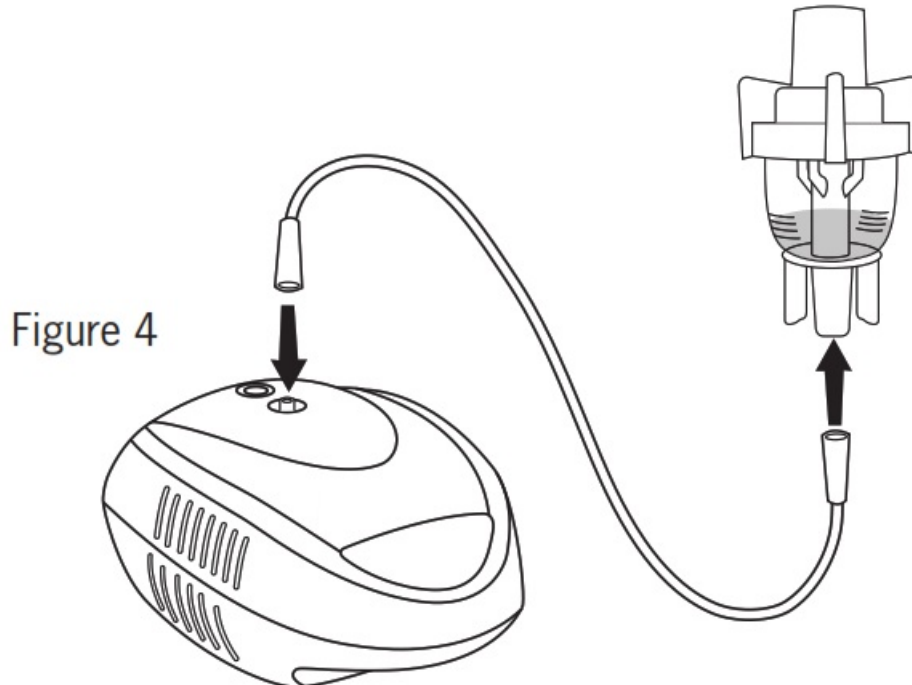

Figure 4

7. Attach the standard mouthpiece to the top of nebulizer assembly. (fig. 5) If using an optional mask, attach the mask to the top of nebulizer assembly. (fig . 6)
8. Make sure the On/Off switch is in the Off position, then plug the power cord into an electrical outlet.
9. Flip On/Off switch to On position to begin your prescribed treatment .
10. When your treatment is finished, shut off the LUMINEB II and unplug it from the electrical outlet.

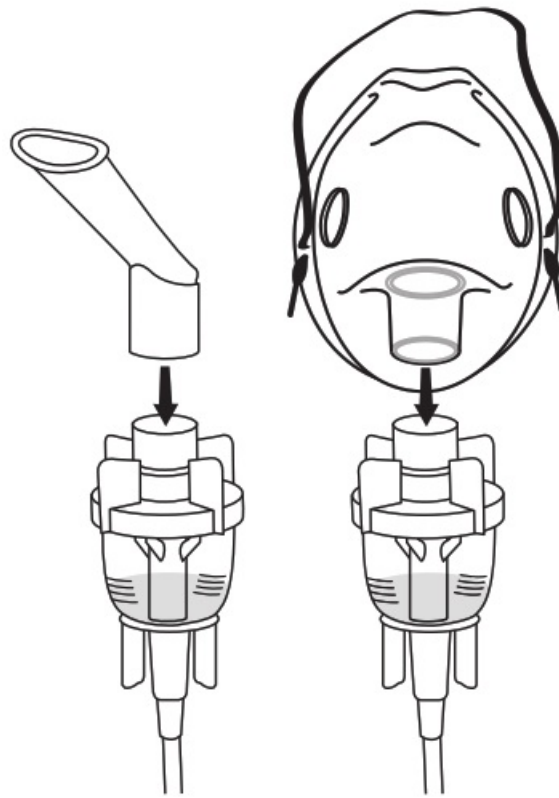

Figure 5

Figure 6

IMPORTANT:

The compressor motor has a thermal protector which will shut off the unit before it overheats. When the thermal protector shuts the unit off:

1. Switch off the LUMINEB II.
2. Unplug the unit from the electrical outlet.
3. Wait 30 minutes for the motor to cool down before another treatment.
4. Make sure the air openings are not obstructed.

CLEANING YOUR LUMINEB II

It is recommended that the nebulizer, mouthpiece and mask are thoroughly cleaned with hot water after each use and cleaned with mild detergent after the last treatment of the day . If your physician or respiratory therapist specifies a different cleaning procedure, follow their instructions.

Before cleaning, make sure the power cord is disconnected from the electrical outlet and the unit.

To clean your LUMINEB II:

1. Disconnect the air tube, nebulizer and mouthpiece.
2. Gently twist the nebulizer to open it.
3. Rinse the nebulizer and mouthpiece or mask with water.
4. Dry with a clean soft towel or allow to air dry.
5. Reassemble the nebulizer when completely dry.
6. Wipe the compressor with a damp cloth and allow to air dry.
7. Never use powdered cleaners or soap pads on the compressor, as it may damage the finish of the unit.

DISINFECTING YOUR LUMINEB II

It is suggested that your LUMINEB II be disinfected after the last treatment of each day. Unless indicated otherwise by your physician, disinfect your LUMINEB II:

1. Use one part white vinegar to three parts distilled water . Make sure the mixed solution is enough to submerge the nebulizer and mouthpiece.
2. Wash the nebulizer, mouthpiece and/or mask in warm water with a mild detergent, then rinse the detergent solution out with hot tap water.
3. Submerge the cleaned components in the water and vinegar solution for thirty minutes.

CHANGING THE FILTER

1. Use only Lumiscope nebulizer filters.
2. Do not substitute cotton or any other materials . Do not wash, clean or re-use a filter.
3. Never operate your LUMINEB II without a filter.
4. Change the filter every 30 days or when it turns gray.

To change the filter:

1. Remove the filter cover on the top of the compressor unit. (see page 5)
2. Replace the old filter with a new one.
3. Replace the filter cover.

REPLACEMENT PARTS

Replacement parts are available – please contact our Customer Service Department at 770-368-4700 .

OPTIONAL ACCESSORIES

Adult Mask (item 5704)

SPECIFICATIONS

Method of Nebulization	Piston Driven
Power	AC 120V, 60Hz
Power Consumption	70
Medication Capacity	5 ml
Particle Size	4 µm
Sound Level	~ 60dba
Maximum Medication Capacity	13ml (cc)
Average Nebulization Rate	0 .2ml/min
Compressor Pressure Range	30 – 36 Psi (210 – 250 KPa / 2 .1 – 2 .5 bar)
Operating Pressure Range	8 – 16 Psi (50 – 100 KPa / 0 .5 – 1 .0 bar)
Liter Flow Range	6 ~ 8 lpm
Operating Temperature Range Operating Humidity Range	50°F – 104°F (10°C – 40°C)
Storage Temperature Range	10 – 95% RH
Storage Humidity Range	-4°F – 158°F (-20°C – 70°C)
Dimensions (LxWxH)	10 – 95% RH
Weight	8.5” x 7.75” x 6” (210mm x 195mm x 150mm)
Standard Accessories	3 .3 lb (1 .5kg)
Optional Accessories	Power Cord, Nebulizer, Air Tube, Mouthpiece and Filters (x5)

Protection against electric shock

- Class II Equipment
- Type BF applied parts: Mouthpiece and mask

Protection Against Harmful Ingress of Water

- IPX0 (Ordinary)
- Degree of safety in the presence of flammable anesthetics or oxygen
- No AP/APG (Not suitable for use in the presence of flammable anesthetics or oxygen)
- Mode of Operation: Continuous

FIVE-YEAR LIMITED WARRANTY:

SCOPE OF WARRANTY

GF Health Products, Inc. (“GF”) warrants to the original purchaser (“Customer”) only, that it will replace or repair components, at GF’s sole discretion, that are defective in material or workmanship under normal use for a period of five years after the purchase date unless there is an expiration date on the component in which case the warranty shall expire on the earlier of the warranty period or the expiration date . The warranty does not extend to non-durable parts and does not include labor or costs of shipping. This limited warranty is not transferable. All warranties are conditioned upon the proper use of the product strictly in accordance with good commercial

practice and applicable GF instructions and manuals, including proper use and maintenance. The warranty is void if the defect is caused by any other reason not related to defects in materials or workmanship.

OBTAINING WARRANTY SERVICE

GF's customer service team must be notified of any warranty claim within the applicable warranty period.

There is a \$15 fee for return shipping and handling . Please make checks payable to GF Health Products, Inc . Failure to follow the specific directions provided by the GF customer service team will result in denial of the warranty claim.

ENTIRE WARRANTY, EXCLUSIVE REMEDY AND CONSEQUENTIAL DAMAGES DISCLAIMER

THIS WARRANTY IS GF'S ONLY WARRANTY AND IS IN LIEU OF ALL OTHER WARRANTIES, EXPRESS OR IMPLIED. GF MAKES NO IMPLIED WARRANTIES OF ANY KIND INCLUDING ANY IMPLIED WARRANTIES OF MERCHANTABILITY OR FITNESS FOR A PARTICULAR PURPOSE . IF ANY MODEL OR SAMPLE WAS SHOWN TO THE CUSTOMER, SUCH MODEL OR SAMPLE WAS USED MERELY TO ILLUSTRATE THE GENERAL TYPE AND QUALITY OF THE PRODUCT AND NOT TO REPRESENT THAT THE PRODUCT WOULD NECESSARILY CONFORM TO THE MODEL OR SAMPLE IN ALL RESPECTS.

GF'S TOTAL LIABILITY FOR ANY PRODUCT OR SERVICE PROVIDED IS LIMITED TO THE COST OF THE PRODUCT GIVING RISE TO THE CLAIM. IN NO EVENT WHETHER IN CONTRACT, INDEMNITY, WARRANTY, NEGLIGENCE, STRICT LIABILITY OR OTHERWISE WILL GF BE LIABLE FOR ANY DIRECT, SPECIAL, INDIRECT, INCIDENTAL, EXEMPLARY OR CONSEQUENTIAL DAMAGES, INCLUDING, BUT NOT LIMITED TO: DAMAGES FOR LOSS OF PROFITS OR INCOME, LOSS OF USE, DOWNTIME, COVER, OR EMPLOYEE OR INDEPENDENT CONTRACTOR WAGES, PAYMENTS AND BENEFITS.

This warranty gives you specific legal rights . You may have additional rights which vary from state to state .



GRAHAM-FIELD

Manufactured for: GF Health Products, Inc.

Atlanta, GA 30360

Made in China

Documents / Resources

	<p>LUMISCOPE 5710 LUMINEB II Compressor Nebulizer [pdf] User Manual 5710 LUMINEB II Compressor Nebulizer, 5710, LUMINEB II Compressor Nebulizer, Compressor Nebulizer</p>
-------------------------------------------------------------------------------------	--------------------------------------------------------------------------------------------------------------------------------------------------------------------------------------