



Luminox XS.0337 Unisex Analog Quartz Watch with Polyester Strap Instructions

[Home](#) » [LUMINOX](#) » Luminox XS.0337 Unisex Analog Quartz Watch with Polyester Strap Instructions 

Contents

- [1 Luminox XS.0337 Unisex Analog Quartz Watch with Polyester Strap](#)
- [2 Product Information](#)
- [3 Product Usage Instructions](#)
- [4 Frequently Asked Questions](#)
- [5 INSTRUCTIONAL SHEET](#)
- [6 Documents / Resources](#)
 - [6.1 References](#)
- [7 Related Posts](#)



Luminox XS.0337 Unisex Analog Quartz Watch with Polyester Strap



Product Information

Specifications

- Product: Rubber Strap
- Material: Rubber
- Compatibility: Suitable for watches with spring bar attachments

Description

The rubber strap is a durable and flexible accessory designed to provide a comfortable fit for your watch. It is made from high-quality rubber material, ensuring longevity and resistance to wear and tear. The strap features spring bar attachments that allow for easy installation and removal, making it convenient to switch between different watch straps.

Product Usage Instructions

How to Install a Rubber Strap using a Spring Bar

1. Begin by installing the spring bars into each end of the strap. Ensure that they are fully inserted and centered inside the strap.
2. Take the short end of the strap (the end with the buckle) and position it on the top of the watch, specifically at the 12 o'clock end.
3. From the back side of your watch, insert one end of the spring bar into the hole on the watch lug.
4. Using a changing tool, compress the other end of the spring bar, allowing it to slide inside the watch lug. Ensure that both ends of the spring bar securely snap into their respective holes to prevent the strap from falling off.
5. Repeat the process on the other side of the watch. The long end of the strap should be installed at the bottom of the watch, specifically at the 6 o'clock end.

How to Remove a Rubber Strap with a Spring Bar

1. From the back side of your watch, insert the forked end of your changing tool between the strap and the watch lug. The tool should grip the ridge of the spring bar, allowing it to be compressed.
2. Apply gentle pressure inwards towards the strap (away from the watch) to compress the spring bar. Simultaneously, apply some downward pressure to pop the bar out. Be cautious with the force applied to avoid slipping and potentially scratching your watch.
3. Repeat the process on the other side. Remove the spring bars from the old strap and reuse them to mount your new strap.

Frequently Asked Questions

Q: Can I use this rubber strap on any watch?

A: The rubber strap is suitable for watches with spring bar attachments. Ensure that your watch has the necessary holes on the lugs to accommodate the spring bars.

Q: How do I know if the spring bars are securely attached?

A: After inserting the spring bars, ensure that both ends are securely snapped into their holes. Give the strap a gentle tug to verify its stability.

Q: Can I reuse the spring bars when changing straps?

A: Yes, you can remove the spring bars from the old strap and reuse them to mount your new rubber strap. Ensure that they are in good condition and properly inserted into the holes on the watch lugs.

INSTRUCTIONAL SHEET

How to install a rubber strap using a spring bar

1. Install the spring bars into each end of the strap. Be sure to push them all the way in so they are centered inside the strap.
2. Install the short end of the strap (the end with the buckle). It goes on the top of the watch (the 12 o'clock end).
From the back side of your watch, insert one end of the spring bar into the hole on the watch lug.
3. Use your changing tool to compress the other end of the spring bar, so it slides inside the watch lug. Make sure both ends of the spring bar securely snap into their holes, or the strap will fall off the watch.
4. Repeat the process on the other side of the watch. Remember, the long end of the strap goes on the bottom of the watch (the 6 o'clock end).



How to remove a rubber strap with a spring bar

1. From the back side of your watch, insert the forked end of your changing tool in between the strap and the watch lug. The spring bar has a ridge that the tool will grab, allowing it to be compressed.
2. Gently apply pressure inwards towards the strap (away from the watch) to compress the spring bar. At the same time, apply some downward pressure so the bar will pop out. Be measured with your force, as you don't want to slip and potentially scratch your watch.
3. Repeat on the other side. Remove the spring bars from the old strap, and reuse them to mount your new strap.

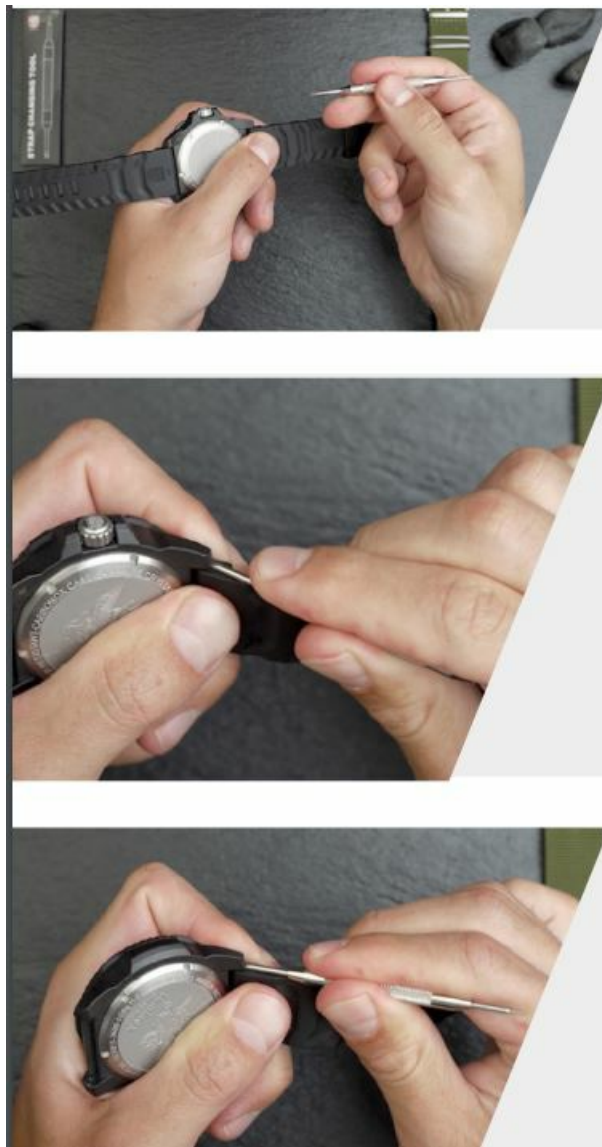

Documents / Resources

	<p>Luminox XS.0337 Unisex Analog Quartz Watch with Polyester Strap [pdf] Instructions XS.0337 Unisex Analog Quartz Watch with Polyester Strap, XS.0337, Unisex Analog Quartz Watch with Polyester Strap, Watch with Polyester Strap, Polyester Strap</p>
---	---

References

- [User Manual](#)