

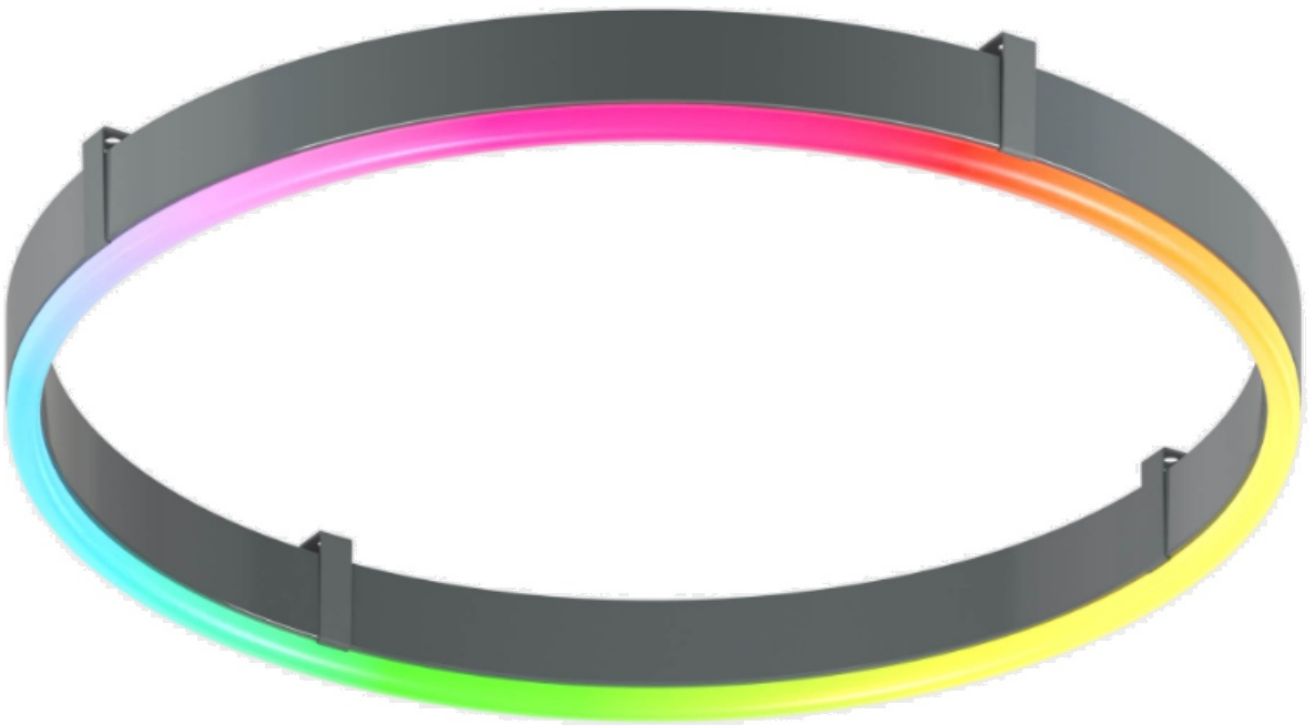

## **luminii Surface Dynamic Color Ring Surface Mount Instruction Manual**

[Home](#) » [luminii](#) » luminii Surface Dynamic Color Ring Surface Mount Instruction Manual 

### **luminii Surface Dynamic Color Ring Surface Mount**



## Contents

- [1 Installation Instructions – Plexineon Surface Dynamic Color](#)
- [2 Straight run with mounting clips](#)
- [3 Curved run/rings with mounting clips](#)
- [4 Install Fixtures into Mounting Clips](#)
- [5 RGB&RGBW WIRING DIAGRAM](#)
- [6 WIRING DIAGRAM](#)
- [7 OPERATING GUIDE](#)
- [8 Documents / Resources](#)
  - [8.1 References](#)
- [9 Related Posts](#)

## Installation Instructions – Plexineon Surface Dynamic Color

**Models:** Plexineon Fixture Surface Mount Dynamic Color and Plexineon Rings Surface Mount Dynamic Color

**Please read all instructions prior to installation and keep for future reference!**

1. . PRODUCT TO BE INSTALLED BY A QUALIFIED ELECTRICIAN.
2. USE ONLY WITH CLASS 2 POWER UNIT
3. 24 VOLTS DC
4. SUITABLE FOR WET LOCATIONS
5. . SURFACE MOUNT ONLY



Plexineon Straight Run Fixture

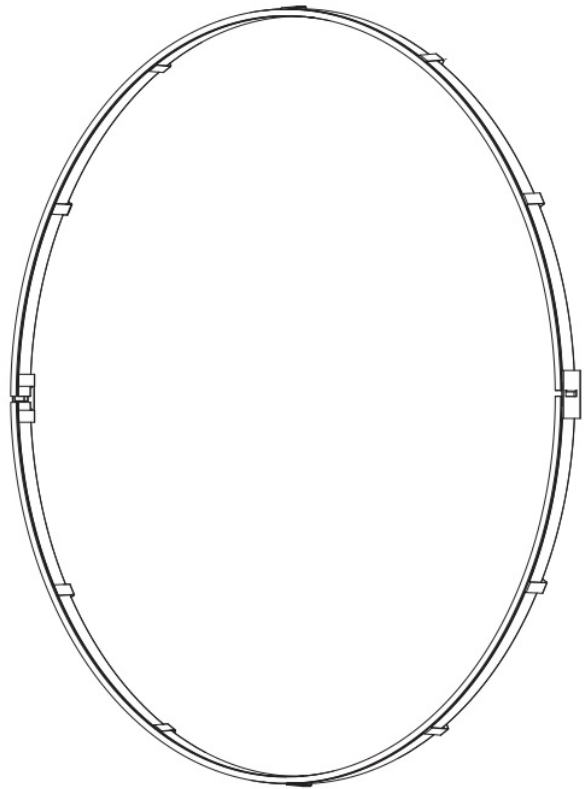

Plexineon Ring Surface Mount

## Straight run with mounting clips

**NOTE:** Prior to installation all 24VDC wires must be present within 72" of the installation. Refer to the power supply installation instruction for additional information.

**NOTE:** More than one person is recommended for this installation.

**1.1** Once the location or pattern is determined for Plexineon to be installed, start off by marking the area. Amount of mounting clips may vary dependent upon pattern. Reference diagrams below.

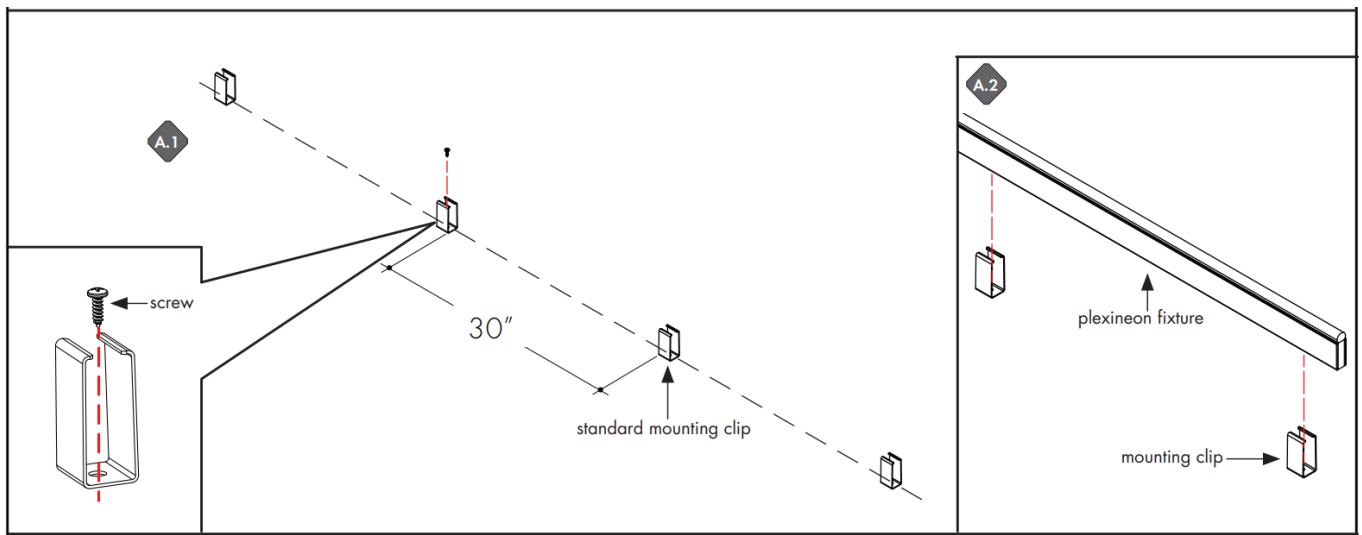

**A.1** Line up and screw on the mounting clips to the mounting holes with no greater than 30" apart. Make sure it is straight by using a level.

**A.2** Fix the plexineon fixture into installed mounting clips. See page 3 for clipping instructions.

### Curved run/rings with mounting clips

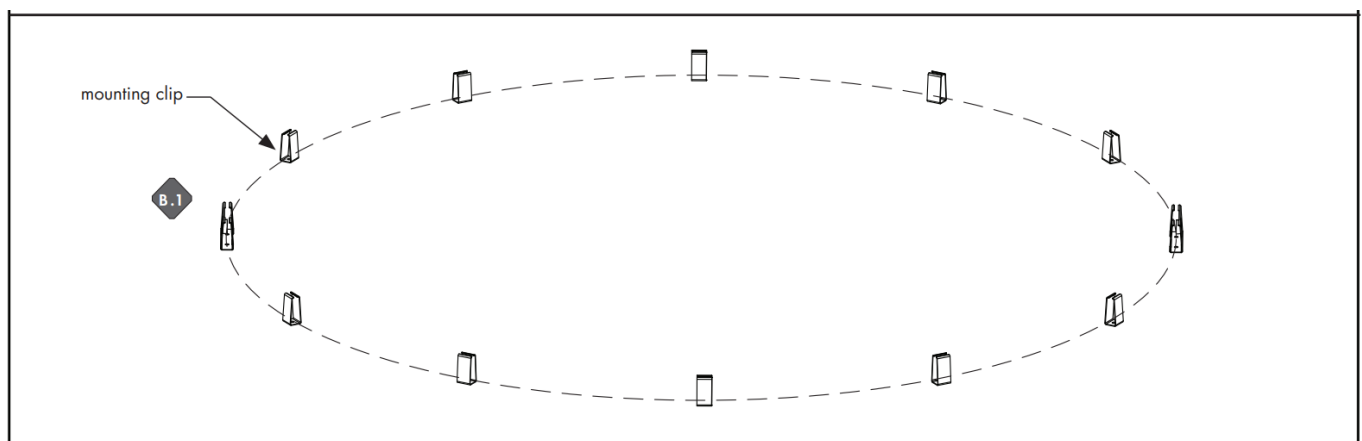

**B.1** Determine the shape of the plexineon layout, then mark the pattern onto the surface. Place the mounting clips with no greater than 30" apart. Screw onto surface.

**B.2** Fix the plexineon bend/ring fixture into installed mounting clips. See page 3 for clipping instructions.

**NOTE:** Standard Clips and Decorative Clips have different required spacing.

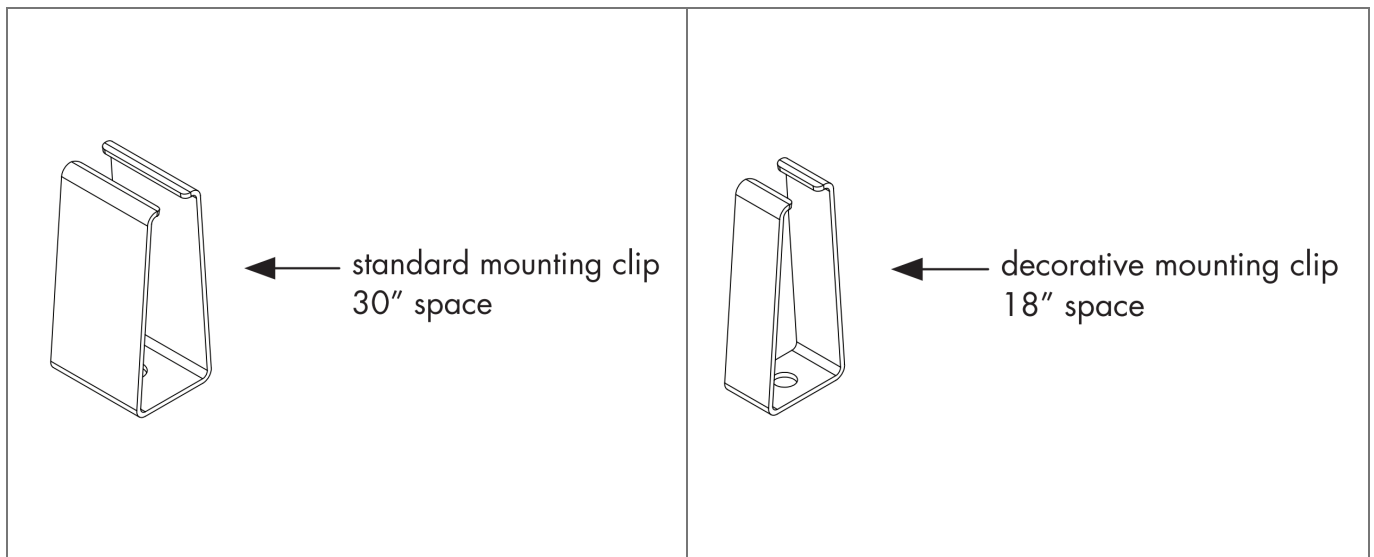

## Install Fixtures into Mounting Clips

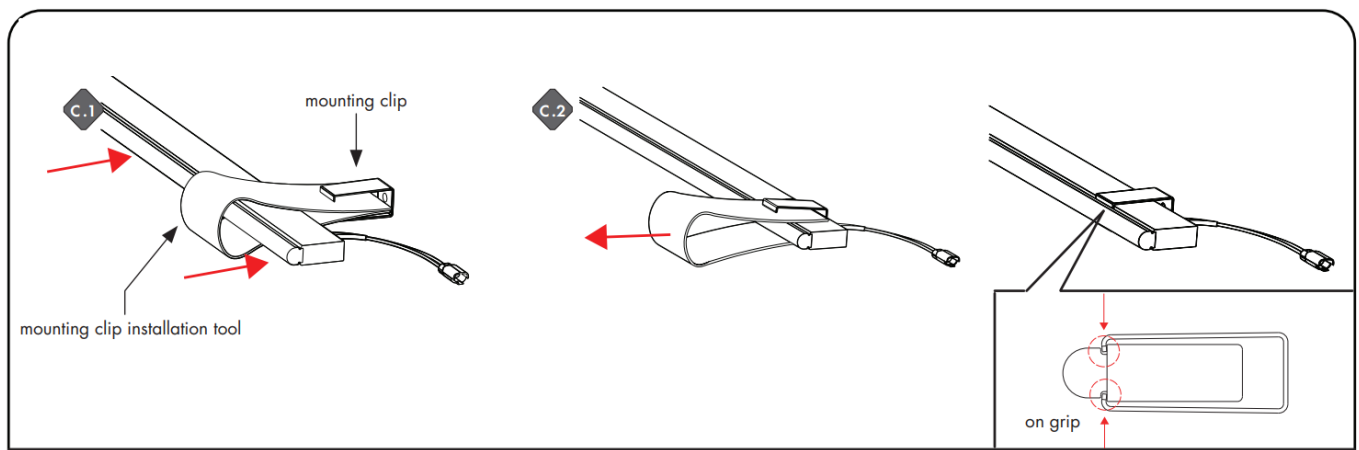

**C.1** Make an U shape with mounting clip installation tool, insert two edges into mounting clip. Place plexineon fixture inside the shape. Then push the fixture into clip.

**C.2** Remove the tool. Make sure mounting clip is clipped right on the grip.

## RGB&RGBW WIRING DIAGRAM

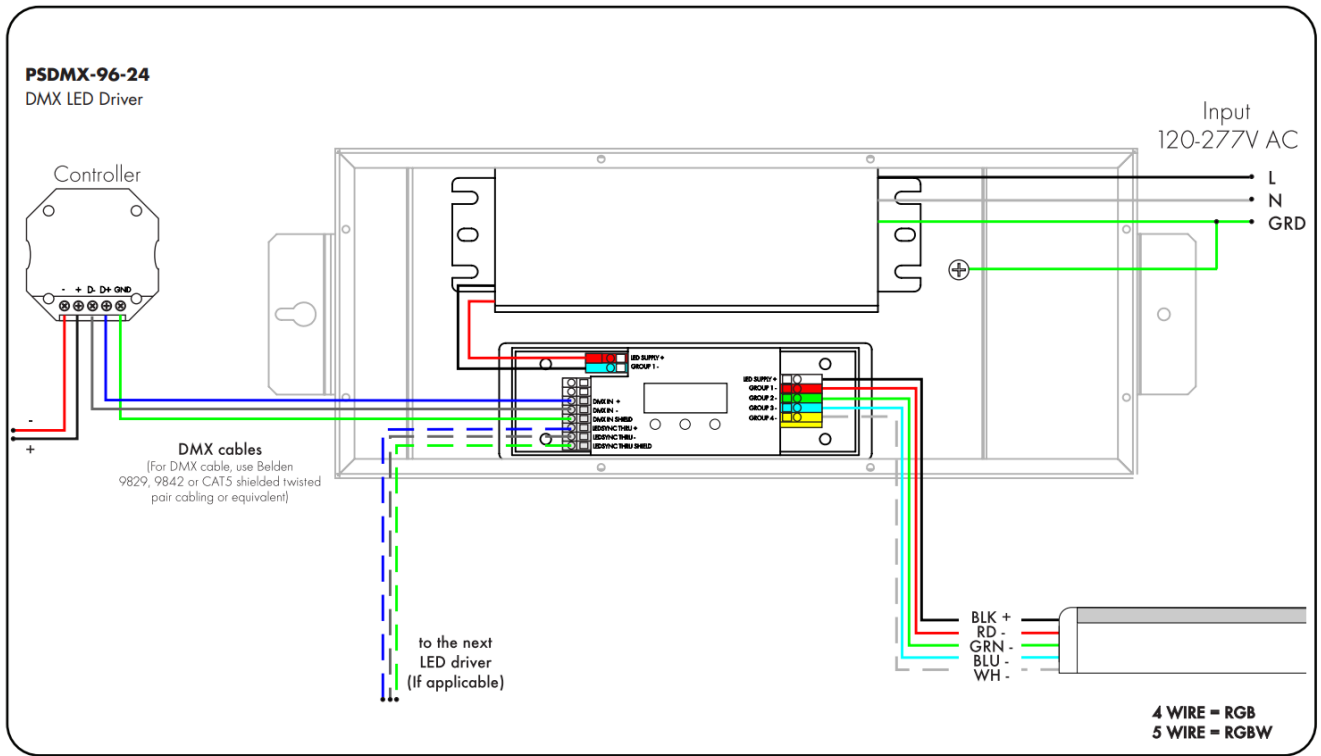

## WIRING DIAGRAM

### SR-DMX-SPI

Smart Pixel LineLED Decoder

**NOTE:** Please make sure that power is turned off before wiring. Also, ensure that the correct power supply (volt age and wattage) is used to power the LED strips connected to the decoder. Follow illustrated wiring diagram. Use screwdriver to open and close connection slots.

**NOTE:** When connecting two or more LED strip lights or light fixtures, always make sure the signal direction arrows are pointing to same direction

The signal direction arrow should appear on label of each section of LED fixture.

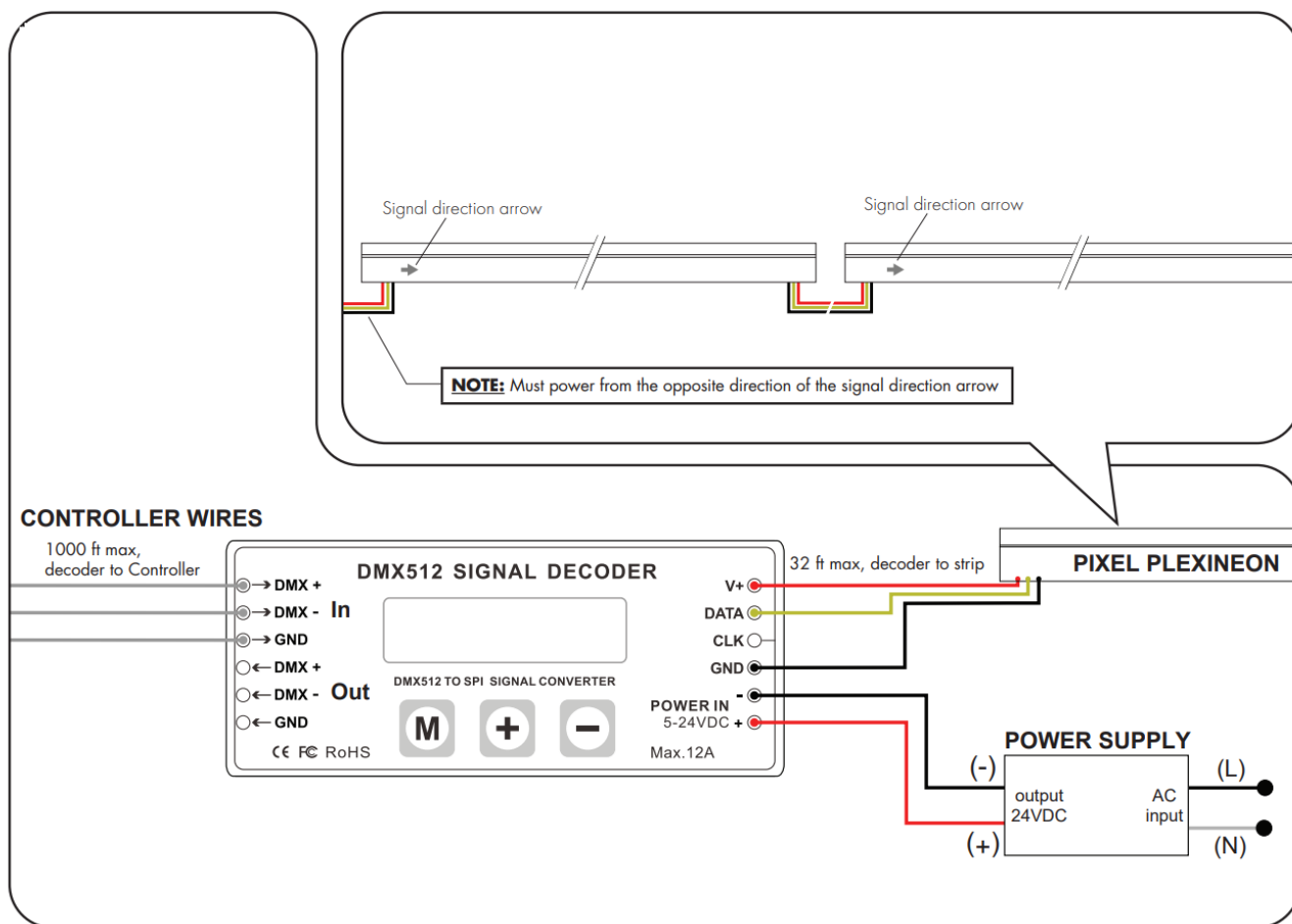

## OPERATING GUIDE

### SR-DMX-SPI

Smart Pixel LineLED Decoder

There are three buttons on the decoder.

	Parameter Setting		Increase Value		Decrease Value
--	-------------------	--	----------------	--	----------------

After operation, if no action was taken within 30s, the button lock, and backlight of the screen will turn off.

1. Long press M button for 5s to unlock the buttons, and the backlight will turn on.
2. Long press M button for 5s to switch between test mode and decode mode after unlocked.

During test mode, the first line of LCD will show: TEST MODE. Use test mode to verify RGBW Pixel functionality. During decoder mode, the first line of LCD shows: DECODER MODE. Use decoder mode when connecting to a Controller and for final installation and customization.

The second line of the LCD Display shows the current setting and value. Note: 1 Pixel = 1 Cut Increment

**NOTE:**

When connected to a controller, DMX512 Signal Decoder will stay in “Decoder Mode”.

**MODE TABLE**

SETTING	LCD DISPLAY	VALUE RANGE	DESCRIPTION
Built-in Programs	TEST MODE MODE NO.:	1-26	See Program Table below
Program Speed	TEST MODE RUN SPEED:	0-7	0: fast, 7: slow
DMX Address	DECODER MODE DMX ADDRESS:	1-512	Address of the starting point/Pixel of a program
DMX Signal RGB	DECODER MODE DMX RGB SEQ:	RGB, BGR, etc.	N/A
Pixel Quantity	DECODER MODE PIXEL QTY:	1-170(RGB), 1-128(RGBW)	Number of Pixels to follow a program



IC TYPE	DECODER MODE I C TYPE:	2903, 8903, 2904, 8904	2903: N/A, 2904: for RGBW, 8903: N/A, 8904: N/A
Color	DECODER MODE COLOR:	MONO, DUAL, R GB, RGBW	MONO: N/A, DUAL: N/A, RGB: N/A, RGBW: for RGBW
Pixel Merging / Pi xel Size	DECODER MODE PIXEL MERGE:	1-100	Number of Pixels to merge together
RGB Sequence	DECODER MODE L ED RGB SEQ:	RGBW, BGRW, etc.	Sequence of RGBW, 24 possible combinations
Integral Control	DECODER MODE ALL CONTROL:	YES, NO	Yes: Merge all Pixels No: Maintain individual Pixels or Merged Pixels
Reverse Control	DECODER MODE REV-CONTROL:	YES, NO	Reverse program order
Overall Brightness	DECODER MODE BRIGHTNESS:	1-100	1: dimmest setting 100: brightest setting

**NOTE:** For Program Table Change: no fading/dimming between color changes Fade: fade/dim between color changes Chase: change pixel by pixel Chase with Trail: change pixel by pixel with fading between

## PROGRAM TABLE

PROGRAM NO.	PROGRAM DESCRIPTION
1	Solid color: Red
2	Solid color: Green
3	Solid color: Blue
4	Solid color: Yellow
5	Solid color: Purple
6	Solid color: Cyan
7	Solid color: White
8	RGB change
9	Full color change
10	RGB fading
11	Full color fading

12	Red chase with trail
13	Green chase with trail
14	Blue chase with trail
15	White chase with trail
16	RGB chase with trail
17	Rainbow chase with trail
18	RGB chasing and fading
19	Red chasing green, chasing blue
20	Orange chasing purple, chasing cyan
21	Rainbow chase (7 colors)
22	Random twinkle: white over red
23	Random twinkle: white over green
24	Random twinkle: white over blue
25	White fading

*\*LUMINII RESERVES THE RIGHTS TO CHANGE SPECIFICATION & INSTRUCTION WITHOUT NOTICE*



7777 Merrimac Ave  
Niles, IL 60714  
T 224.333.6033  
F 224.757.7557  
[info@luminii.com](mailto:info@luminii.com)  
[www.luminii.com](http://www.luminii.com)

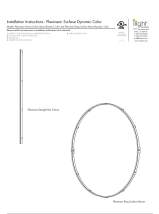

## Documents / Resources

	<p><a href="#">luminii Surface Dynamic Color Ring Surface Mount</a> [pdf] Instruction Manual Surface Dynamic Color Ring Surface Mount, Surface Dynamic Color, Ring Surface Mount, Surface Mount, Mount</p>
-------------------------------------------------------------------------------------	----------------------------------------------------------------------------------------------------------------------------------------------------------------------------------------------------------------

## References

-  [Home - Luminii](#)