



## luminii Plexineon Surface Static Color Instruction Manual

[Home](#) » [luminii](#) » luminii Plexineon Surface Static Color Instruction Manual 

### luminii Plexineon Surface Static Color Instruction Manual



#### Contents

- [1 Installation Instructions](#)
- [2 Documents / Resources](#)
  - [2.1 References](#)
- [3 Related Posts](#)

### Installation Instructions

**Please read all instructions prior to installation and keep for future reference!**

1. PRODUCT TO BE INSTALLED BY A QUALIFIED ELECTRICIAN.
2. USE ONLY WITH CLASS 2 POWER UNIT
3. 24 VOLTS DC
4. SUITABLE FOR WET LOCATIONS
5. SURFACE MOUNT ONLY



Plexineon Straight Run Fixture

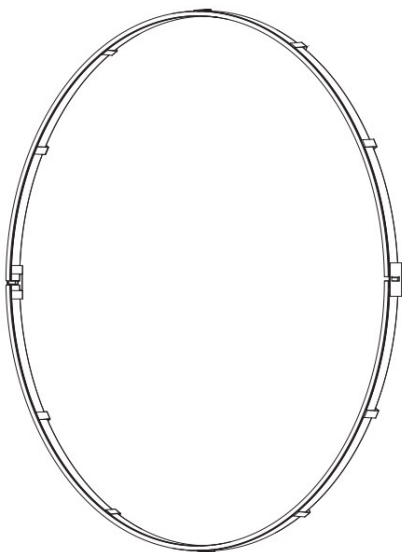

Plexineon Ring Surface Mount

**NOTE:** Prior to installation all 24VDC wires must be present within 72" of the installation. Refer to the power supply installation instruction for additional information.

**NOTE:** More than one person is recommended for this installation

Once the location or pattern is determined for Plexineon to be installed, start off by marking the area. Amount of mounting clips may vary dependant upon pattern. Reference diagrams below.

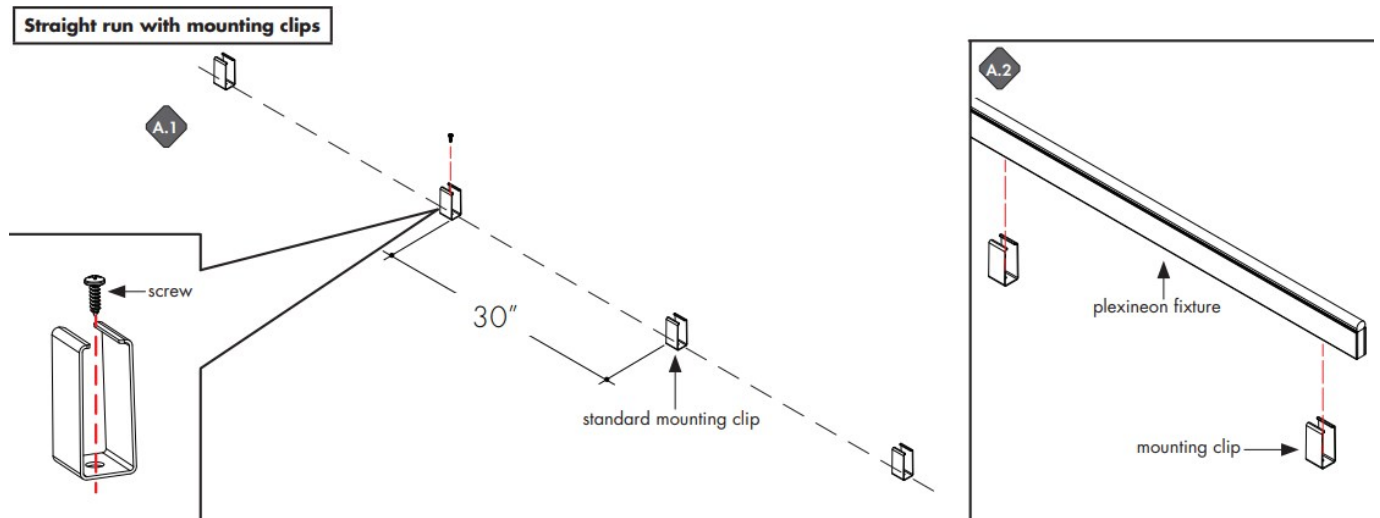

- Line up and screw on the mounting clips to the mounting holes with no greater than 30" apart. Make sure it is straight by using a level.
- Fix the plexineon fixture into installed mounting clips. See page 3 for clipping instructions

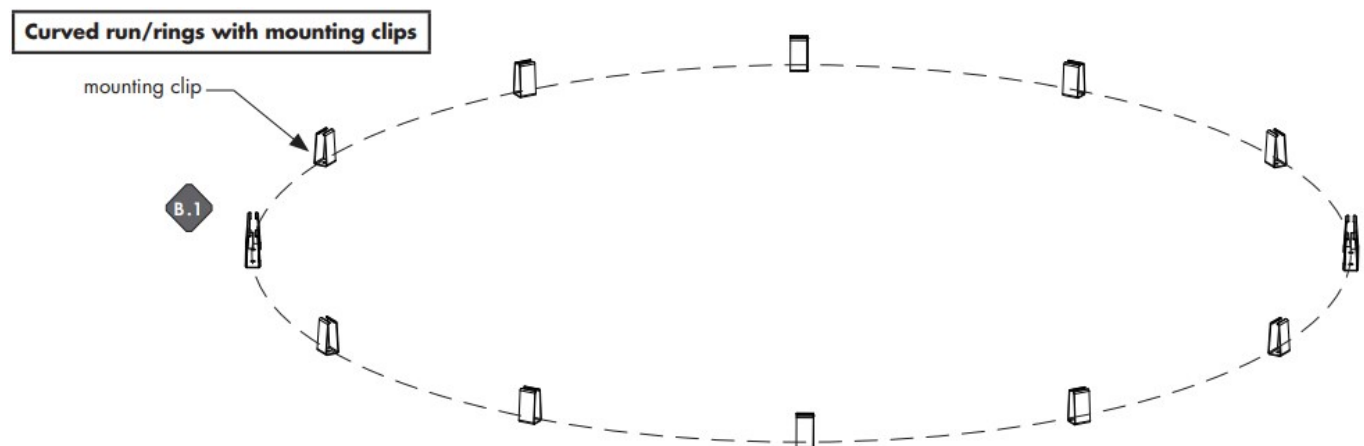

- Determine the shape of the plexineon layout, then mark the pattern onto the surface. Place the mounting clips with no greater than 30" apart. Screw onto surface.
- Fix the plexineon bend/ring fixture into installed mounting clips. See page 3 for clipping instructions.

**NOTE:** Standard Clips and Decorative Clips have different required spacing.

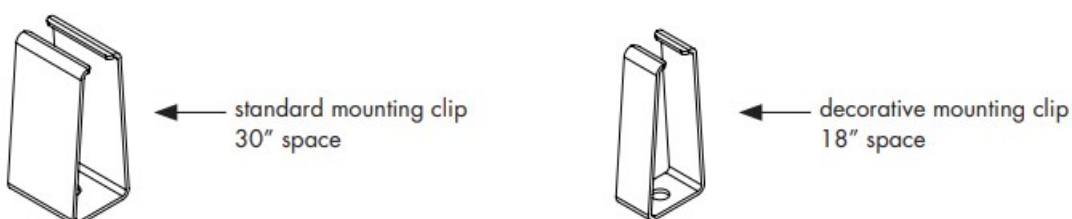

### Install Fixtures into Mounting Clips

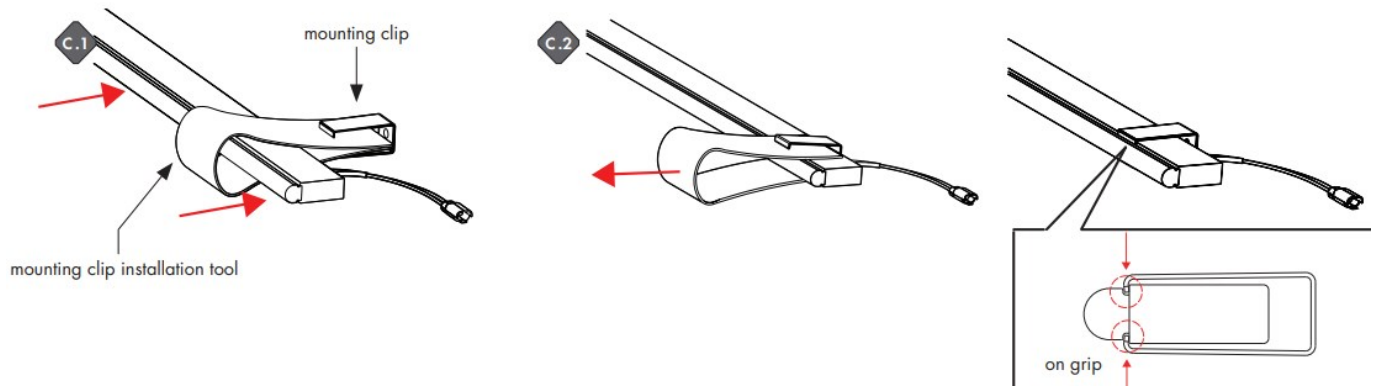

- Make an U shape with mounting clip installation tool, insert two edges into mounting clip. Place plexineon fixture inside the shape. Then push the fixture into clip.
- Remove the tool. Make sure mounting clip is clipped right on the grip.

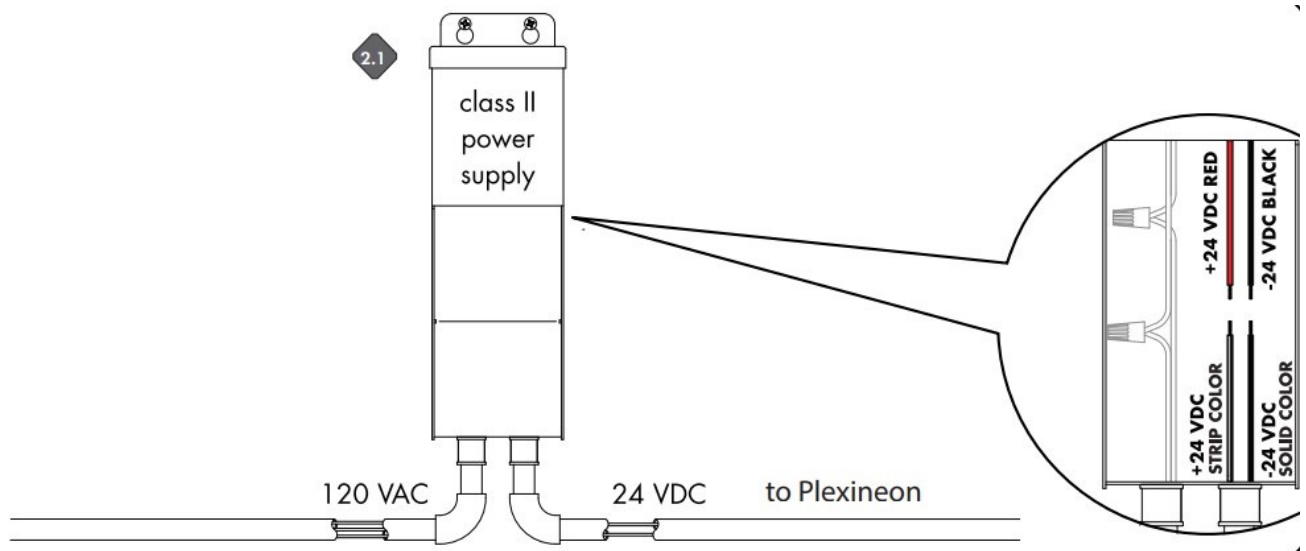

Connect +24 VDC strip color from the Plexineon to the power supply +24 VDC red wire. Connect -24 VDC solid color wire from the Plexineon to power supply -24 VDC black wire.

### Multiple Fixtures

#### Multiple Fixtures

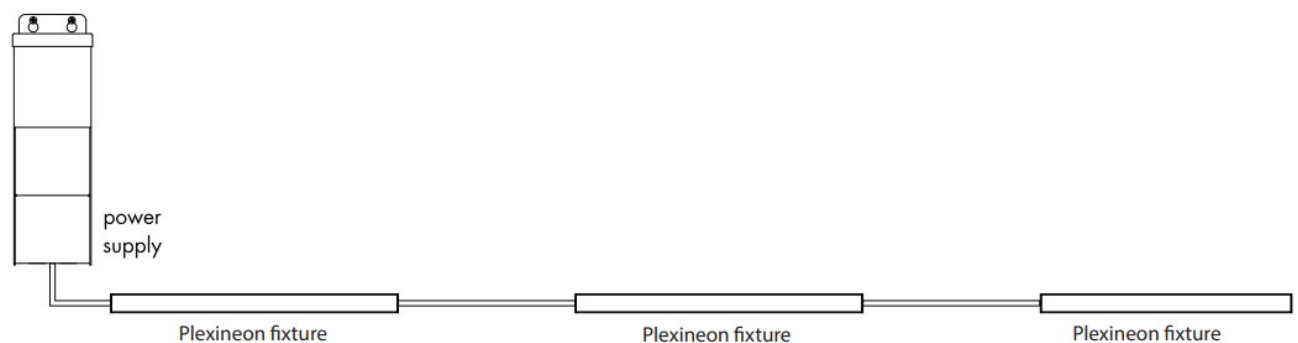

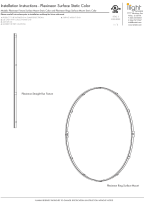

## Documents / Resources

	<p><a href="#">luminii Plexineon Surface Static Color</a> [pdf] Instruction Manual Plexineon Surface Static Color, Plexineon, Plexineon Static Color, Surface Static Color, Static Color</p>
---	--

## References

-  [Home - Luminii](#)

Manuals+