



# luminii B45C-XX Max Horizontal Flexible LED Strip Installation Guide

[Home](#) » [luminii](#) » luminii B45C-XX Max Horizontal Flexible LED Strip Installation Guide 



**B45C – Installation Instructions  
Models B45C-XX**

## Contents

- [1 B45C-XX Max Horizontal Flexible LED Strip](#)
- [2 Documents / Resources](#)
  - [2.1 References](#)
- [3 Related Posts](#)

## B45C-XX Max Horizontal Flexible LED Strip

**Please read all instructions prior to installation and keep for future reference!**

1. PRODUCT TO BE INSTALLED BY A QUALIFIED ELECTRICIAN.
2. USE ONLY WITH CLASS 2 POWER UNIT.
3. 24 VOLTS DC.
4. SUITABLE FOR DAMP LOCATIONS.
5. SURFACE MOUNT ONLY
6. SUITABLE FOR INSTALLATION WITHIN THE CLOSET STORAGE SPACE.
7. INHERENTLY PROTECTED

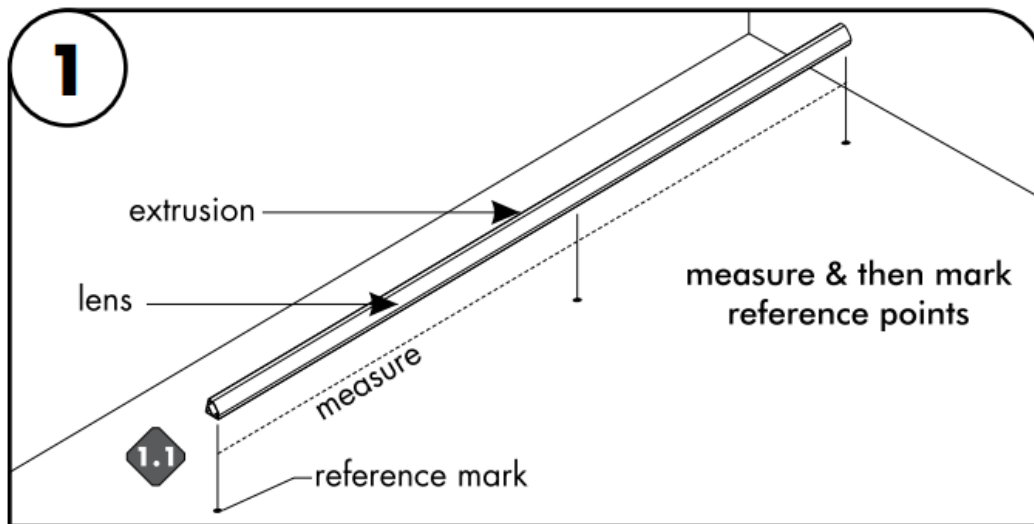

**Note:** Complete fixture must be built prior to installing. To make all necessary reference marks & to also ensure all parts are included. Then it can be taken apart for installation.

1.1 Snap lens into the extrusion, then align & center the extrusion to the determined location. Make all necessary markings to install to the surface. Prior to installation of extrusion, 24VDC power must be **present**.

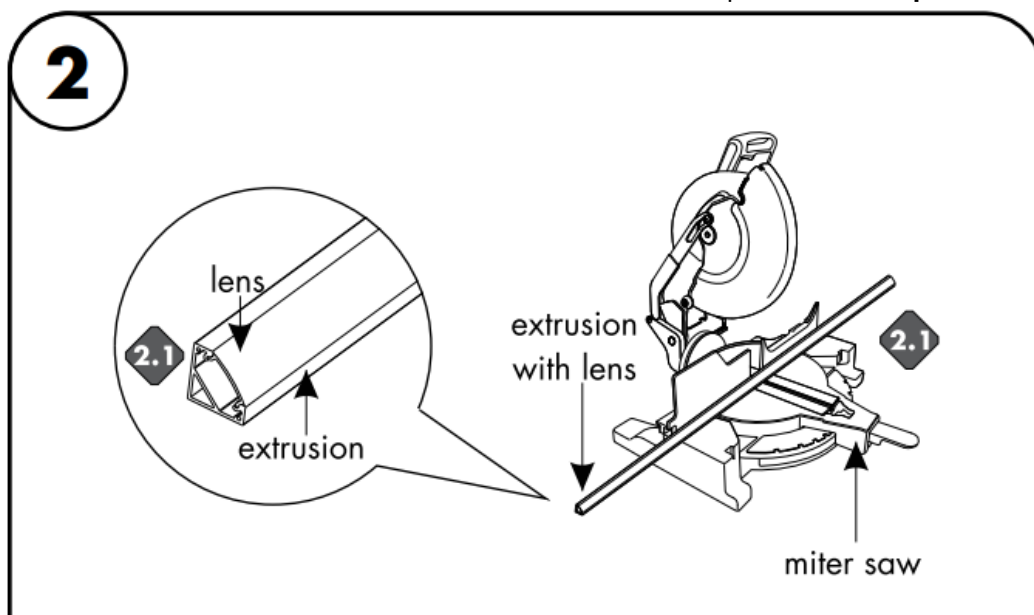

**Caution:** Safety equipment is recommended, when modifications are being made to the extrusion & lens.

2.1 If necessary extrusion, lens, & mounting channel (if applicable) can be cut in the field. Snap all parts together then using the proper blade for aluminum cut to the desired **length**.

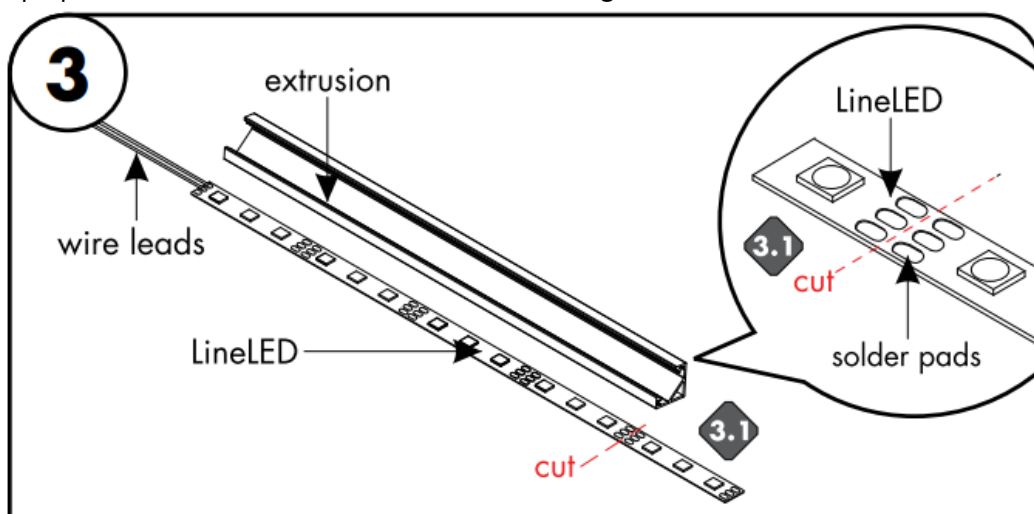

**Note:** Extrusion are not waterproof. If it is going to be installed facing up and in a wet location, drainage holes should be drilled along the inner corner of the extrusion every 12". Drill 1/16" to 1/8" diameters holes before installing LED strip

3.1 LineLED can be shortened by cutting along the dashed lines in between the solder pads. Make sure the cut is made on the side of the LineLED without the wire leads. LineLED cannot touch the metal endcap which will

shorten the circuit.

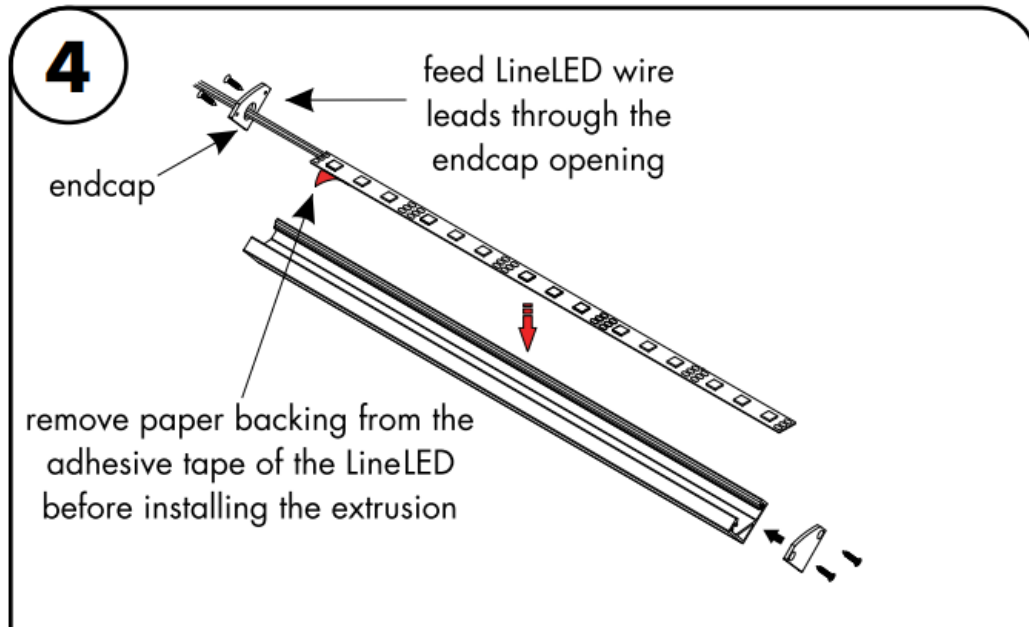

4.1 Prior to installing LineLED to extrusion, clean extrusion from any debris. Gently push LineLED onto aluminum extrusion. Then install endcaps at each ends of the extrusion.

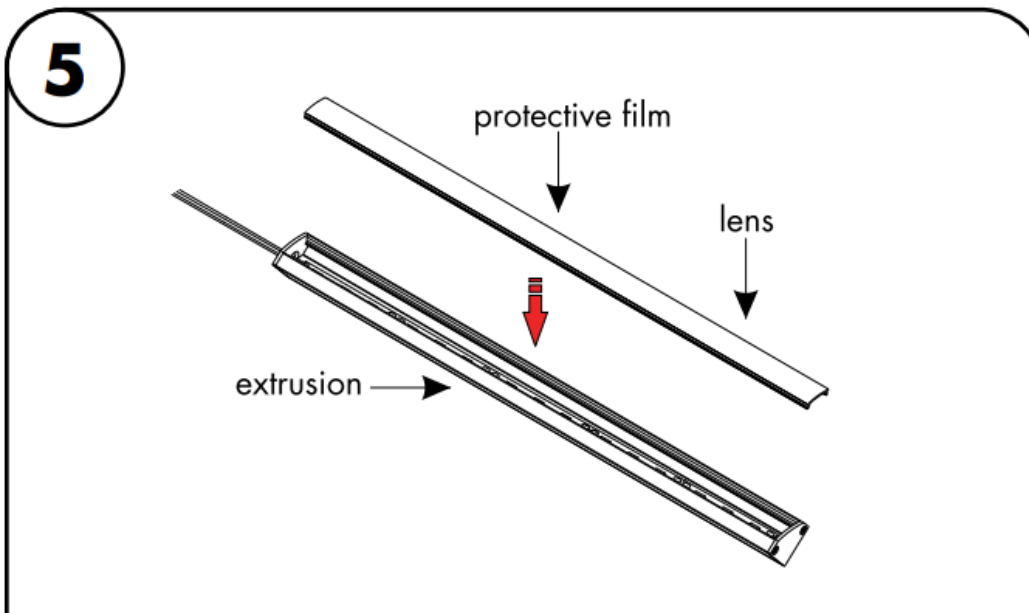

5.1 Remove the protective film from the diffuser lens. Snap the diffuser lens into the aluminum extrusion.

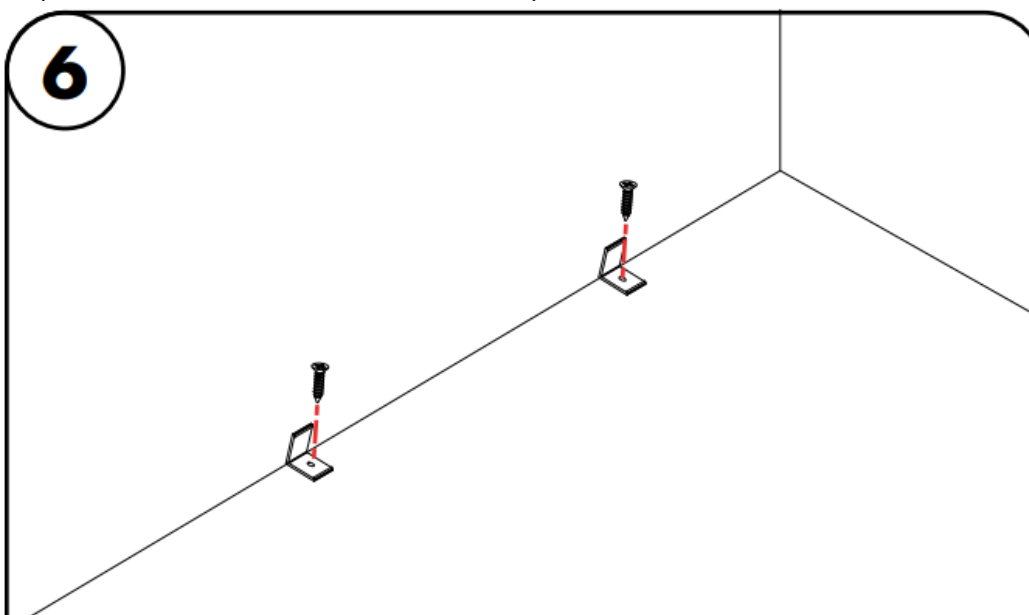

6.1 Screw mounting brackets into previously made markings from step 1, then clip the extrusion on to the mounting brackets.

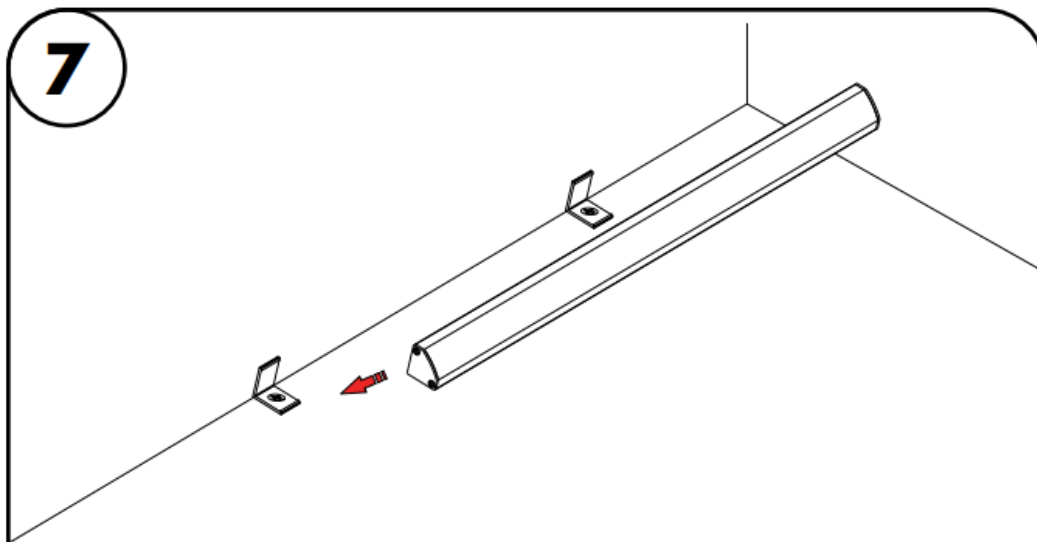

7.1 Snap the fixture into the installed mounting brackets.

**Note:** To remove the extrusion from the mounting brackets, carefully insert a flat screwdriver to the bottom edge of the extrusion then pull up until the extrusion pops up.

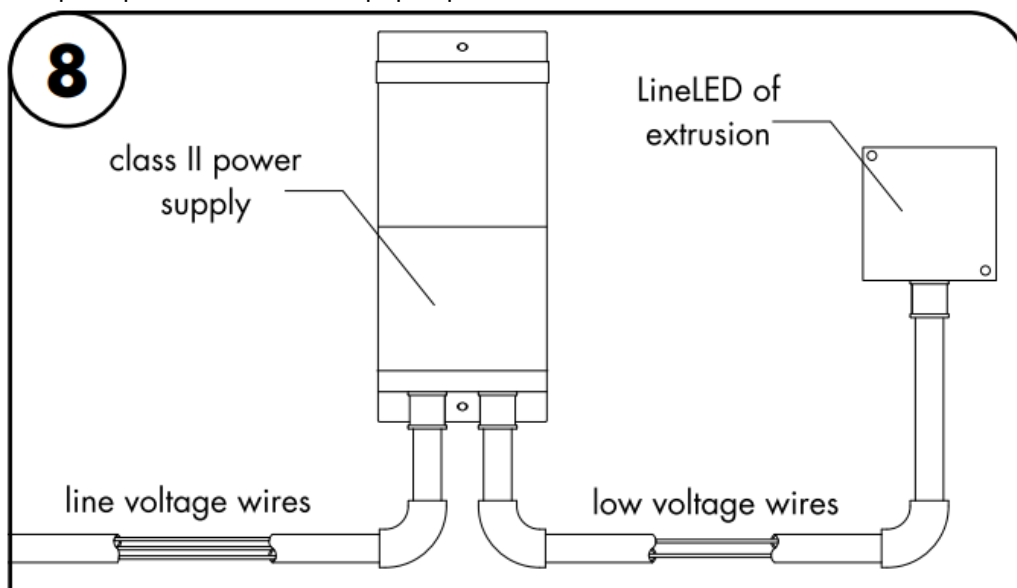

8.1 Ensure the correct (wattage & voltage) power supply is used to power LineLED.

Then proceed to connect LineLED wires from extrusion to power supply. For more information please refer to power supply and LineLED wiring instructions.

**B**basics  
by luminii



**LISTED**  
REV0.1

02222024

7777 Merrimac Ave Niles, IL 60714

T 224.333.6033

F 224.757.7557

[info@luminii.com](mailto:info@luminii.com)

[www.luminii.com](http://www.luminii.com)

---

## Documents / Resources

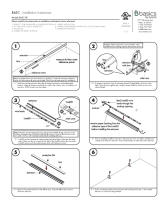
	<p><a href="#">Luminii B45C-XX Max Horizontal Flexible LED Strip</a> [pdf] Installation Guide B45C-XX Max Horizontal Flexible LED Strip, B45C-XX, Max Horizontal Flexible LED Strip, Horizontal Flexible LED Strip, Flexible LED Strip, LED Strip, Strip</p>
---	--

## References

- [Home - Luminii](#)
- [User Manual](#)

[Manuals+](#), [Privacy Policy](#)

This website is an independent publication and is neither affiliated with nor endorsed by any of the trademark owners. The "Bluetooth®" word mark and logos are registered trademarks owned by Bluetooth SIG, Inc. The "Wi-Fi®" word mark and logos are registered trademarks owned by the Wi-Fi Alliance. Any use of these marks on this website does not imply any affiliation with or endorsement.